

# Staggered T5 Strip **SS T5 Strip**

Page 1 of 2

3 1/8" Wide 1 7/16" Deep Channel, 26 1/2", 38 1/4" or 50" Lengths, 2 Lamp, T5

## Features

- Only 1 7/16" deep.
- Utilizes compact, high efficiency, T5 or T5HO lamps.
- Fully enclosed wiring.
- Push through rotary lock lamp holders for secure lamp retention.
- 4" lamp overlap when installed in row



## Dimensions

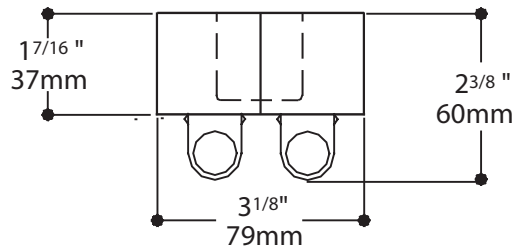
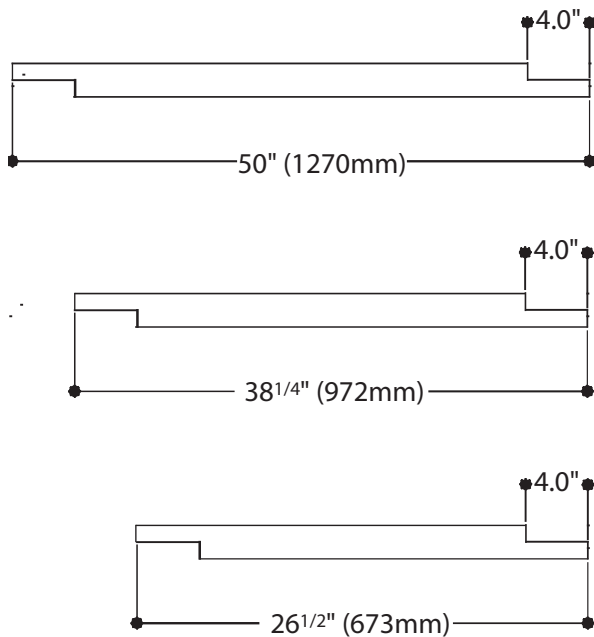

Job Information	Type:
<b>Job Name:</b>	
<b>Cat. No.:</b>	
<b>Lamp(s):</b>	
<b>Volts/Ballast:</b>	

**Lightolier** a Genlyte Thomas Company

[www.lightolier.com](http://www.lightolier.com)

Technical Information: (978) 657-7600 • Fax (978) 658-0595

631 Airport Road, Fall River, MA 02720 • (508) 679-8131 • Fax (508) 674-4710

We reserve the right to change details of design, materials and finish.

Copyright 2002 Lightolier

**Section 3A / H120-19**



# Staggered T5 Strip **SS T5 Strip**

## Photometry

Model No. SS4S228120PG

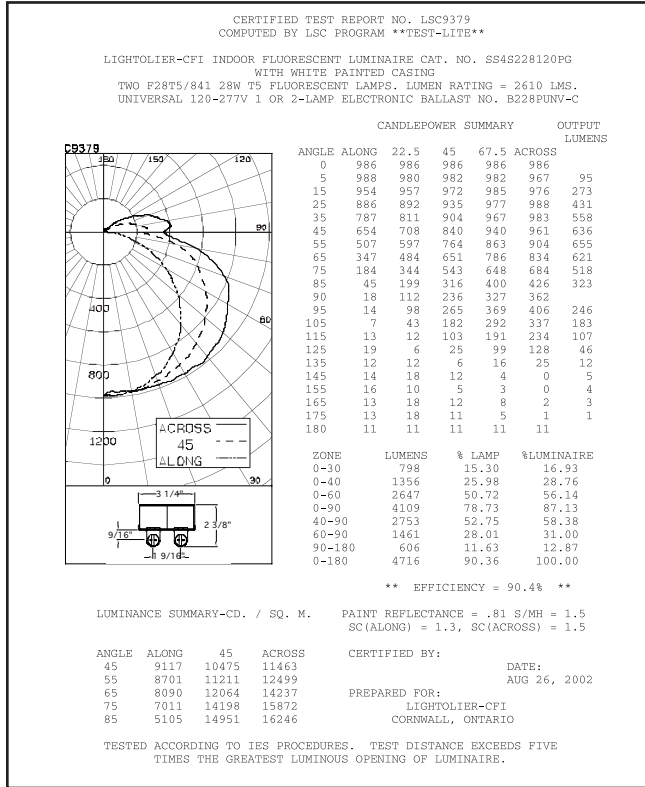

CERTIFIED TEST REPORT NO. LSC9379  
COMPUTED BY LSC PROGRAM \*\*TEST-LITE\*\*

LIGHTOLIER-CFI INDOOR FLUORESCENT LUMINAIRE CAT. NO. SS4S228120PG  
WITH WHITE PAINTED CASING  
TWO F28T5/841 28W T5 FLUORESCENT LAMPS. LUMEN RATING = 2610 LMS.  
UNIVERSAL 120-277V 1 OR 2-LAMP ELECTRONIC BALLAST NO. B228PUNV-C

CANDLEPOWER DATA

ANGLE	ALONG	22.5	45	67.5	ACROSS	AVERAGE	OUTPUT LUMENS
0	986	986	986	986	986	986	95
5	988	980	982	982	967	978	980
10	980	972	978	986	972	978	978
15	954	957	972	985	976	970	273
20	919	922	953	979	977	950	431
25	886	892	935	977	988	935	558
30	839	854	920	968	985	913	636
35	787	811	904	967	983	892	764
40	721	764	875	957	976	861	904
45	654	708	840	940	961	824	961
50	585	656	799	912	942	783	986
55	507	597	764	863	904	732	986
60	427	543	709	820	865	679	980
65	347	484	651	786	834	628	978
70	266	419	605	738	775	571	978
75	184	344	543	648	684	492	978
80	116	283	456	547	568	407	978
85	45	199	316	400	426	288	978
90	18	112	236	327	362	216	978
95	14	98	265	369	406	236	978
100	7	43	182	292	337	206	978
105	7	43	182	292	337	172	183
110	17	18	140	245	293	139	107
115	13	12	103	191	234	107	107
120	13	15	60	138	171	76	46
125	19	6	25	99	128	51	26
130	13	5	10	48	72	26	12
135	12	12	6	16	25	13	12
140	19	12	1	0	5	6	5
145	14	18	12	4	0	10	5
150	11	7	10	0	0	5	4
155	16	10	5	3	0	6	4
160	19	9	16	4	1	10	3
165	13	18	12	8	2	11	3
170	19	18	10	4	3	11	1
175	13	18	11	5	1	10	1
180	11	11	11	11	11	11	1

## Ordering Information

Explanation of Catalog Number. Example: SS4S228120PG

<b>SS</b>	<b>2</b>	<b>2</b>	<b>120/277V</b>	<b>PG</b>
Sidemount Strip Staggered Strip T5 2" wide x 1 3/8" deep channel	Lamp Quantity: 2	Lamp Configuration: S = Single Fixture	Voltage UNV = 120/277V 120 = 120V 277 = 277V	Ballast Type PG = Electronic T5 Program Start, Less than 10 THD PI = Electronic T5 Instant Start, <10 THD (14W, 21W or 28W only, no UNV voltage) PF = LOLT5 Power Spec Dimming (1-Lamp 54 watt only)
Nominal Fixture Length: 2 = Nominal 22 1/2" 3 = Nominal 38 1/4" 4 = Nominal 50 1/4"	Lamp Type: (Nominal 22") 14 = 14W T5 24 = 24W T5 HO (Nominal 34") 21 = 21W T5 39 = 39W T5 HO (Nominal 46") 28 = 28W T5 54 = 54W T5 HO	Options:		

## Options & Accessories

**Radio Interference Filter:** 120, 277 or UNV volt, 50 or 60 Hz. Suffix: **R**  
**Ballast Options:** For other ballast options, consult factory.

## Specifications

**Materials:** Chassis parts are die-formed heavy gauge cold rolled steel, 1-3/8" deep x 3 1/8" channel width.  
**Finish:** Chassis exterior - phosphate undercoating, baked white acrylic matte high reflectance paint finish.

## Specifications (continued)

**Electrical:** Rapid start HPF, thermally protected class "P" ballast. (Bi-tube type)  
If K.O.s are within 3" of ballast use wire suitable for at least 90°.  
**Labels:** Listed by



## Job Information

## Type:

Lightolier a Genlyte Thomas Company www.lightolier.com  
Technical Information: (978) 657-7600 • Fax (978) 658-0595  
631 Airport Road, Fall River, MA 02720 • (508) 679-8131 • Fax (508) 674-4710  
We reserve the right to change details of design, materials and finish.  
Copyright 2002 Lightolier **Section 3A / H120-19**

## Free Manuals Download Website

<http://myh66.com>

<http://usermanuals.us>

<http://www.somanuals.com>

<http://www.4manuals.cc>

<http://www.manual-lib.com>

<http://www.404manual.com>

<http://www.luxmanual.com>

<http://aubethermostatmanual.com>

Golf course search by state

<http://golfingnear.com>

Email search by domain

<http://emailbydomain.com>

Auto manuals search

<http://auto.somanuals.com>

TV manuals search

<http://tv.somanuals.com>