



LINN KARIK NUMERIK
COMPACT DISC PLAYBACK SYSTEM OWNERS MANUAL

Year 2000 Compliance

Linn has used all reasonable endeavours to ensure that the software in the products manufactured by it is capable of normal operation before, during and after 1 January 2000 and in respect of past, present and future dates without replacement, alteration or upgrade ("Year 2000 Compliant"). Linn, however, gives no express warranties, representations or undertakings and to the maximum extent permitted hereby excludes any terms, warranties, representations or undertakings implied by law to that effect. Linn cannot give any warranties, representations or undertakings that non Linn software is or will be Year 2000 Compliant or that Linn's software will be Year 2000 Compliant if used in conjunction with non Linn products, systems or software. The Purchaser, Installer, Retailer or Distributor will be solely responsible for ensuring that Linn's software will be Year 2000 Compliant when used in conjunction with such non Linn software, systems or products and for any failure if it is not Year 2000 Compliant in such circumstances. Except to the extent implied by law and which by law cannot be excluded, Linn shall not be liable to any party for any costs, claims, losses (including indirect and consequential losses) or liabilities arising from the failure of Linn's software to be Year 2000 Compliant if used in conjunction with non Linn products, systems or software.

IMPORTANT SAFETY INFORMATION

Explanation of symbols used in this manual and on the product:



This symbol is intended to alert the user to the presence of uninsulated dangerous voltages within the enclosure of sufficient magnitude to cause electric shock.



This symbol is intended to alert the user to the presence of important maintenance and servicing information in the instruction and service manuals.

CAUTION

TO REDUCE THE RISK OF ELECTRIC SHOCK DO NOT REMOVE THE COVER.
NO USER SERVICEABLE PARTS INSIDE.
REFER SERVICING TO QUALIFIED SERVICE PERSONNEL.

WARNING: SHOCK HAZARD. DO NOT OPEN.
AVIS: RISQUE DE CHOC ELECTRIQUE. NE PAS OUVRIR.

CAUTION: REPLACE FUSE WITH SAME TYPE AND RATING.
ATTENTION: UTILISER UN FUSIBLE DE RECHANGE DE MEME TYPE.

DISCONNECT SUPPLY CORD BEFORE CHANGING FUSE.
ATTENTION: DEBRANCHER AVANT DE REMPLACER LE FUSIBLE.

This equipment has been tested and found to comply with the limits for a Class B digital device, pursuant to Part 15 of the FCC Rules. These limits are designed to provide reasonable protection against harmful interference in a residential installation. This equipment generates, uses and can radiate radio frequency energy and, if not installed and used in accordance with the instructions, may cause harmful interference to radio communications. However, there is no guarantee that interference will not occur in a particular installation. If this equipment does cause harmful interference to radio or television reception, which can be determined by turning the equipment off and on, the user is encouraged to try to correct the interference by one or more of the following measures:

- Reorient or relocate the receiving antenna.
- Increase the separation between the equipment and receiver.
- Connect the equipment into an outlet on a circuit different from that to which the receiver is connected.
- Consult the dealer or an experienced radio/TV technician for help.

MAINS PLUGS

This appliance is supplied with a non-rewireable mains plug for the intended country.

Replacement mains leads can be obtained from your Linn retailer.

Should you need to change the plug please dispose of it carefully.

A plug with bared conductors is dangerous if engaged in a live socket.

The Brown wire must be connected to the Live (Line) supply pin.

The Blue wire must be connected to the Neutral supply pin.

The Green/Yellow wire must be connected to the Earth (Ground) supply pin.

Please contact your retailer or a competent electrician if you are in any doubt.

GENERAL SAFETY INSTRUCTIONS

1. Read Instructions. Read the safety and operating instructions before operating the appliance.
2. Retain Instructions. Retain the safety and operating instructions for future reference.
3. Heed Warnings. Observe all warnings on the appliance and in the operating instructions.
4. Follow Instructions. Follow all operating and use instructions.
5. Water and Moisture. Do not use the appliance near water, for example near a bathtub, washbowl, kitchen sink, laundry tub, in a wet basement or near a swimming pool and the like.
6. Carts and Stands. Use only with a cart or stand that is recommended by the manufacturer.
- 6a. An appliance and cart combination should be used with care. Quick stops, excessive force and uneven surfaces may cause the appliance and cart to overturn.
7. Wall or Ceiling Mounting. Mount to a wall or ceiling only as recommended by the manufacturer.
8. Ventilation. Site the appliance so that its location or position does not interfere with its proper ventilation. For example the appliance should not be situated on a bed, sofa, rug or similar surface that may block the ventilation openings; or placed in a built-in installation such as a bookcase or cabinet that may impede the flow of air through the ventilation openings.
9. Heat. Site the appliance away from heat sources such as radiators, heaters, stoves or other appliances (including amplifiers) that produce heat.
10. Power Sources. Connect the appliance to a power supply only of the type described in the operating instructions or marked on the appliance.

11. Grounding or Polarization. Do not defeat the precautions taken to ground or polarize the supply to the appliance.
12. Power Cord Protection. Route power cords so that they are not likely to be walked on or pinched by items placed upon or against them, paying particular attention to cords at plugs, power sockets and at the point where they exit from the appliance.
13. Protective Attachment Plug. As a safety feature the product is equipped with an attachment plug containing overload protection. See the instruction manual about resetting or replacing the plug. Should the plug need replacing ensure that a replacement is used which has the same overload protection as the original.
14. Cleaning. The product should be cleaned only as recommended by the manufacturer.
15. Power lines. An outdoor antenna should be located away from power lines.
16. Outdoor Antenna Grounding. If an outdoor antenna is connected to the tuner/receiver ensure that the antenna system is grounded to provide some protection against voltage surges and static build up.

In the USA see article 810 of the National Electrical Code ANSI/NFPA 70 concerning installation requirements.

17. Non-use periods. Unplug the power cord from the outlet if the product will be unused for a long period of time.
18. Objects and liquid entry. Take care not to let objects or liquids fall into the product.
19. Damage requiring service. The product should be serviced by qualified personnel if:
 - a) the power cord or plug has been damaged.
 - b) objects or liquid have fallen into the product.
 - c) the product has been exposed to rain.
 - d) the product does not appear to operate normally or exhibits a marked change in operation.
 - e) the product has been dropped or the enclosure damaged.
20. Servicing. Don't attempt to service the product beyond that described in the operating instructions. All other servicing should be referred to qualified service personnel.

UK USERS PLEASE READ THIS IMPORTANT SAFETY INFORMATION.

FUSE REPLACEMENT

This appliance is fitted with a non-rewireable 13 Amp mains plug. The plug contains a 5 Amp fuse.

If the fuse has blown it can be replaced:

- a) pull out the red fuse cover/carrier.
- b) remove and dispose of the blown fuse.
- c) fit a new 5 Amp BS1362 approved fuse into the carrier and push the carrier back into the plug.

Always ensure the fuse cover is fitted. If the fuse cover is missing do not use the plug. Contact your Linn retailer to obtain a replacement fuse cover. Fuses are for fire protection and do not protect against electric shock.

MAINS PLUG REPLACEMENT

Should your mains plug need replacing and you are competent to do this proceed as follows. If you are in doubt contact your Linn retailer or a competent electrician.

- a) Disconnect the plug from the mains supply.
- b) Cut off the plug and dispose of it safely. A plug with bared conductors is dangerous if engaged in a live socket.
- c) Only fit a 13 Amp BS1363A approved plug with a 5 Amp fuse.
- d) The cable wire colours or a letter will be marked at the connection points of most quality plugs.

Attach the wires securely to their respective points. The Brown wire must go to the Live pin, the Blue wire must go to the Neutral pin and the Green/Yellow wire must go to the Earth pin.

- e) Before replacing the plug top ensure that the cable restraint is holding the outer sheath of the cable firmly and that the wires are correctly connected.

MUSIC is very important for people. It stimulates the imagination, helps them relax, can change their mood, and of course provides entertainment and pleasure.

A good hi-fi works well enough to deliver these benefits. It also helps you appreciate music you never thought you would.

At Linn we devote our energy to improving standards of music reproduction, because we know that the better the sound the more you'll enjoy music at home.

The addition of any Linn component will improve the sound quality of your system. Linn has a policy of continuously improving its equipment allowing customers to retro-fit most product upgrades.

I**N****T****R****O****D****U****C****T****I****O****N** The Linn KARIK CD Transport and the Linn NUMERIK digital-to-analogue convertor represent the culmination of several years research and development, and achieve uncompromised performance standards providing you with an outstanding musical source.

The Linn KARIK CD Transport incorporates an internal digital-to-analogue convertor (DAC), enabling the KARIK to be used in its own right as a single-box CD player of the highest possible quality. Consistent with Linn's philosophy of ensuring long-term upgrade capability for all our products, the KARIK has the necessary digital outputs and **CD-SYNC** input to allow it to be connected to the Linn NUMERIK at any time in the future, without modification.

The KARIK operates to the highest level of the Compact Disc specifications. It features advanced error correction, making it tolerant of imperfect disc quality, giving a significant performance advantage with any chosen disc. It can be operated from the remote control handset supplied, or directly using the concealed controls on the front panel.

The Linn NUMERIK digital to analogue converter has been developed from our professional studio recording system to make this ultimate level of technology available to the home listener. The NUMERIK is an oversampled DAC using 20-bit convertors which eliminate the low-level distortions found on most multi-bit DACs. The NUMERIK introduces innovative clock circuitry which cuts out sound degradation caused by timing jitter. The performance of any high quality CD Transport with a digital output will be enhanced when combined with the NUMERIK. Optimum performance is achieved when the NUMERIK is partnered with the KARIK CD Transport.

INSTALLATION Unpack the KARIK and NUMERIK and retain the packing for future transportation.

Your Linn Dealer is responsible for ensuring correct installation of the KARIK and NUMERIK. He will be pleased to provide information, address your queries and resolve any problems. If this is not possible, please contact the Linn Products factory in Scotland, or your national distributor. For your information some tips regarding set-up, interconnections and operation are given below.

WARNING Use the earthed moulded mains lead supplied. Never use an unearthed plug or adaptor.

WARNING
THIS APPLIANCE MUST BE EARTHED

IMPORTANT

The wires in this mains lead are coloured in accordance with the following code:

Green-and-yellow:	Earth
Blue:	Neutral
Brown:	Live

As the colours of the wires in the mains lead of this appliance may not correspond with the coloured markings identifying the terminals in your plug, proceed as follows:

The wire which is coloured green-and-yellow must be connected to the terminal in the plug, which is marked with the letter E, or the earth symbol or coloured green or green-and-yellow.

The wire which is coloured blue must be connected to the terminal which is marked with the letter N or coloured black.

The wire which is coloured brown must be connected to the terminal which is marked with the letter L or coloured red.

SET-UP

KARIK OUTPUT CONNECTIONS The KARIK has two stereo **AUDIO OUTPUTS** provided for connection to your preamplifier and direct connection to another system such as a multi-room application.

The KARIK also has two high quality S/P-DIF digital audio outputs. The **ELECTRICAL OUTPUT** is connected to the NUMERIK via the 75 Ohm BNC - BNC lead provided, or to other external audio processors with phono inputs by the use of a BNC - Phono adaptor.

The **DIAGNOSTIC OUTPUT CONNECTOR** is used by your dealer to carry out diagnostic checks on your KARIK to guarantee quality. He will be able to check for tracking errors, error rates and most importantly, laser performance. This is an extremely efficient method of service back-up, assuring you of our continued product support.

KARIK INPUT CONNECTIONS The KARIK's **SYNC INPUT** connection is made from the NUMERIK by means of a high quality audio phono - phono lead. With this lead in place the NUMERIK adopts 'master' mode operation and superior audio performance is achieved. When this lead is not in place the NUMERIK will adopt 'slave' mode and will operate in a conventional manner.

SLEEP MODE If the **DISPLAY** switch on the back panel is in, and power is applied, the KARIK will enter a 'sleep' mode. Twenty seconds after the last operation the display will turn off (show two dashes). Actuation of the door, front panel controls or remote control will waken the display. This feature, shared by the Linn Kairn pre-amplifier and Kremlin tuner, saves power and draws less attention to the products, if required.

When the display switch is out, and power is re-applied, the display will remain lit continuously.

NUMERIK INPUT CONNECTIONS The NUMERIK has two S/P-DIF inputs, both on BNC connectors. **CHANNEL 1** is intended for use with the Linn KARIK CD transport. **CHANNEL 2** is provided for connection to any other high quality digital audio source.

NUMERIK OUTPUT CONNECTIONS Two stereo **AUDIO OUTPUTS** are provided for connection to your pre-amplifier, and direct connection to another system such as a multi-room application.

A **SYNC OUTPUT** is provided for each digital input. This should be connected to the corresponding **SYNC INPUT** on the Linn KARIK CD transport to facilitate Master Mode operation which eliminates data - related clock jitter.

INDICATOR LIGHTS These are located on the rear panel and are there to assist when setting up the NUMERIK.

When a particular input channel is selected the corresponding input channel indicator is lit.

When Master Mode is in operation, the indicator labelled **MASTER** is lit.

When the NUMERIK is correctly synchronised to an input signal, the indicator labelled **LOCK** is lit. When this light is off or flashing, the NUMERIK cannot synchronise to the input signal. This may be due to incorrect connections. Check all the leads are plugged into their correct sockets. If **LOCK** is still not achieved, there is a more fundamental problem, therefore please contact your Linn dealer.

When the sample rate is **44.1 kHz**, the light labelled 44.1 kHz is lit. When the sample rate is **48 kHz**, this light is off.

ADDITIONAL CONNECTIONS

REMOTE IN/OUT CONNECTIONS The remote in and out facility on the KARIK is intended for use in a distributed system. This facility enables quick and efficient access by remote control, to various Linn products throughout your home.

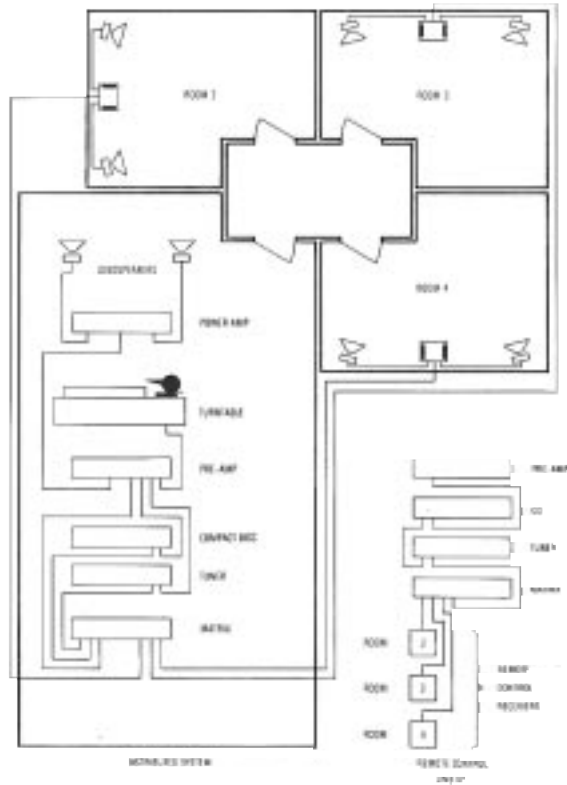

DISTRIBUTED SYSTEM

REMOTE CONTROL LINK UP

CD HANDLING

Forgetting all the hype that surrounded the launch of compact disc -

1. Never handle the playing surface of the disc.
2. Scratches on either side of the disc activate correction circuits on a transport. This process complicates the retrieval of information and may result in degradation of sound quality.
3. The perimeter of the CD centre hole must be kept in pristine condition, as a transport relies on an accurate fit of the hole to the spindle to maintain the highest performance.
4. Keep your disc away from excessive heat. Warped discs complicate the retrieval of information and may result in degradation of sound quality.

As a general rule CDs should be looked after with the same care as your records. Remember, the condition of both are vital in achieving the best results from your hi fi system.

OPERATION The KARIK and NUMERIK have been designed for low power consumption and cool running. We recommend that they are switched off when not in use.

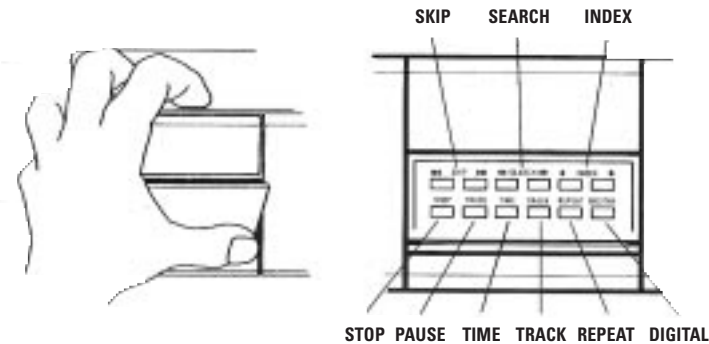

KARIK OPERATION Operating the KARIK with the remote control provides the most efficient method of accessing the functions, and you will probably use this method on a day-to-day basis. Manual operation of the KARIK, using the buttons on the control area, is described below.

DISPLAY MODES

TRACK shows TRACK and INDEX information.

At power-up the KARIK will select TRACK display mode. Whenever a disc stops playing, the KARIK will revert to TRACK mode. When enabled, this mode will display TRACK and INDEX information.



Disc Loaded

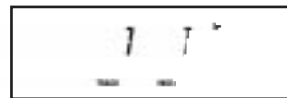

Play Selected

TIME shows TIME information.

There are four TIME modes: TRACK TIME, which shows time into track;

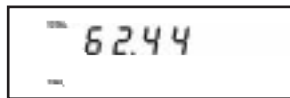

Disc Loaded



Play Selected

REMAIN TRACK TIME, which shows the remaining time on the track;

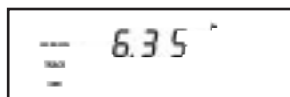

Only Active During Play

TOTAL TIME, which shows time into disc from start;

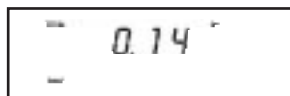

Only Active During Play

and TOTAL REMAIN TIME which shows the remaining time on the disc.

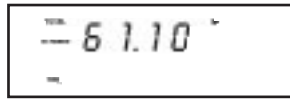

Only Active During Play

Repeated pressing of the **TIME** button selects the four time modes.

NOTE TRACK and TIME modes are accessed on the remote control handset via the **DISPLAY** button.

POWER ON

To switch the KARIK on, press the **POWER** button. When there is no disc in the drawer, TRACK, INDEX, DIGITAL and PLAY legends will light and TRACK display will show '00'. The PLAY legend will go out after approximately 8 seconds.

If there is a disc in the drawer (either open or closed) when the KARIK is switched on, the disc will be loaded and the first track will start to play automatically.

OPEN

Open the drawer by pressing **OPEN** once. The second press, or pushing the drawer, loads the disc into the KARIK.

When the disc is loaded, the TOTAL and TIME legends light and the display shows briefly the total playing time of the disc in minutes and seconds. TRACK and INDEX legends will then light and the total number of tracks on the disc will be displayed.

PLAY

To close the drawer and start play, press **PLAY** once. The TRACK, INDEX, PLAY and DIGITAL legends will light and the display will show TRACK 1, INDEX 1, if left to continue, all tracks on the disc will be played, the display incrementing at the start of each new track and index point.

If you wish to hear the current track from its start point, press **PLAY** a second time and the KARIK will return to the beginning of the track and play will resume. When in time mode, the display will show the current track number before reverting to the selected time mode.

After completing all the tracks on the disc, the display shows either the total number of tracks on the disc, or the total playing time of the disc followed by the total number of tracks on the disc, depending on TRACK or TIME mode selection.

PAUSE

For a break in play press **PAUSE**; the PAUSE legend will light. To release the pause function and continue play, press **PAUSE** or **PLAY**

SKIP or **SEARCH** commands can be used while in pause mode. This causes the pick-up to move to a new position. To start play from the new position press **PAUSE** or **PLAY**

If in TRACK mode, TRACK and INDEX display values will remain current until PAUSE or PLAY is pressed to continue play. When in TIME display mode, the display will show current selection time.

STOP

Press **STOP** once to stop the disc.

If in TRACK display mode, TRACK and INDEX legends are lit and the display shows the total number of tracks on the disc. When in TIME display mode, TOTAL and TIME legends are lit and the display will show the total playing time of the disc in minutes and seconds, before reverting to TRACK mode.

SKIP FORWARD/SKIP BACKWARD

To select a different track press **SKIP ►►** or **◄◄ SKIP** and the pick-up will advance to the start of the next track, or go back to the start of the current track.

Pressing and holding will go forwards or backwards through all the tracks in turn until the button is released.

SKIP ►► or **◄◄ SKIP** can be used in the same way when the disc is stopped and audio is muted. When the selected track is reached, press **PLAY** to start the disc.

If in TRACK display mode, the display will increment or decrement to the selected track number. PLAY, TRACK and INDEX legends will be lit. If in TIME display mode, the display will show the selected track and index numbers before reverting to the selected TIME display mode.

INDEX FORWARD/INDEX BACKWARD

Some tracks are sub-divided into smaller sections called index points.

To select a different index point press **INDEX ►** or **◄ INDEX** once, and the pick-up will jump forward to the next index point, or backward to the start of the current index point.

If in TRACK display mode, the INDEX display changes to the selected index number. The TRACK and INDEX legends are lit. When in TIME display mode, the selected index number is displayed, before reverting to the TIME mode previously selected.

SEARCH FORWARD/SEARCH BACKWARD

To scan through the disc, press and hold **SEARCH ►►** or **◄◄ SEARCH** for fast scan forward or backward through the tracks. The scanning rate will increase gradually. Audio level is reduced, but audible. Release the button to start play, audio will return to normal volume.

When searching forward and the end of the disc is reached, the display will show the total number of tracks on the disc or the total playing time of the disc depending on whether TRACK or TIME display mode is selected.

When searching backwards and the start of the first track is reached, the disc will start to play automatically.

If in TRACK display mode, the display will increment when the button is held past a track boundary. If in TIME display mode, the display will increment or decrement depending on the time mode selection.

REPEAT

To repeat all tracks, or selected sections of the disc, press **REPEAT**. To repeat the complete disc at any time during play, press **REPEAT**. The REPEAT legend will light.

To cancel disc repeat, and resume normal play, press **REPEAT** a further two times.

Play between two points can be repeated by selecting the start point using SKIP, SEARCH or INDEX. Press **REPEAT** to store the start point. The REPEAT legend will light. Select the end of the repeat section using SKIP, SEARCH or INDEX. Again press **REPEAT** to store the end point. **NOTE** Do not press **REPEAT** too quickly but allow time for the KARIK to return to play mode.

This passage will be repeated continually from the start point. To cancel repeat, press **REPEAT** again while in this mode; normal play will proceed.

If in TRACK display mode, the track numbers between the start and end points will be shown. The TRACK and INDEX legends will be lit. When in TIME display mode, the time display will increment or decrement depending on the time mode selection.

DIGITAL AUDIO OUTPUT

To switch the digital audio output on and off, press **DIGITAL**. Digital output is enabled at power-up and the DIGITAL legend is lit. When the KARIK is connected to **CHANNEL 1** on a NUMERIK, the **DIGITAL** button acts as an input selector for the NUMERIK.

DIGITAL OUTPUT 'ON' - KARIK selected on NUMERIK.

DIGITAL OUTPUT 'OFF' - Channel 2 (eg. DAT) selected on NUMERIK.

REMOTE CONTROL

One feature of the remote control is that you can enter a track number directly. Since the numeric section of the remote handset can be used for the Compact Disc, Preamp and Tuner functions, to link the numbers to the KARIK player the previous button pressed has to be one from the Compact Disc section of the handset.

To enter a track number from 1 to 9, press the corresponding digit on the remote control for less than 0.5 seconds. When the digit is pressed it is shown on the display. When the button is released, the KARIK plays the selected track.

To enter a track number from 10 to 99, press and hold down the button for the first digit. The digit will be shown on the display. After 0.5 seconds, the displayed digit will move one place to the left and a dash appears in the original digit position. Press the button for the second digit. The dash on the display is replaced by the second digit of the track number and the KARIK plays the track.

NUMERIK OPERATION To switch the NUMERIK on, press the **POWER** button. The power indicator light will illuminate. After about five seconds, the audio output will unmute, and the NUMERIK is ready for operation.

Channel 1 is selected if there is an S/P-DIF signal on the Channel 1 input, otherwise Channel 2 is selected. This allows the **DIGITAL AUDIO OUTPUT** enable facility on the KARIK to be used as an input selector on the NUMERIK.

44.1 kHz or 48 kHz sample rates are automatically selected.

The KARIK's **SYNC** Input connection is made from the NUMERIK with a high quality audio phono-phono lead. With this lead in place the NUMERIK adopts 'master' mode operation and superior audio performance is achieved. When this lead is not in place the NUMERIK will adopt 'slave' mode and will operate in a conventional manner. If the currently selected input has the Master Mode (CD Sync) link connected, Master Mode will be selected.

In case of difficulty when setting up the NUMERIK, indicator lights are provided on the rear panel. See the SET-UP section for details.

GENERAL SYSTEM INSTALLATION

KARIK AND NUMERIK The KARIK and NUMERIK should be positioned on a level surface. Extensive internal screening in the KAIRN preamp, KREMLIN tuner, KARIK and NUMERIK facilitates stacking the products one on top of the other without interference, if desired.

POWER SUPPLIES Take care not to position too close to signal leads, turntables or pre-amplifier.

AMPLIFIERS Pre and power amplifiers may hum if positioned too close together. For minimum hum experiment by moving the components with the system at full volume but not playing music (although it is best to turn the volume down whilst actually moving the components).

LOUDSPEAKERS Loudspeakers should be positioned correctly. They should be mounted on rigid stands, and not subject to any rocking movement.

CLEAN CONTACTS It is important that the electrical contacts in a hi-fi system are kept mechanically sound and clean. Occasionally unplugging and replugging all the connectors will effectively clean contacts.

WARNING This should be carried out after the mains supply has been switched off.

INTERCONNECT LEADS Correct cables should be used. We recommend good quality copper cable for interconnect leads and advise 4mm² multicore copper cable, such as Linn K20, for speaker leads.

Your Linn dealer can supply high quality interconnects for linking all your hi-fi components.

PROGRAMMING THE KARIK

The KARIK can be programmed from the remote control to play a selection of tracks.

TO PLAY A SELECTION OF TRACKS make sure the disc is loaded but not playing. You can tell that this is the case if the ► indicator is not lit and the display is showing the number of tracks on the disc. (If you have just put the disc in, allow the KARIK the few seconds necessary to read and display the number of tracks). Press and hold the button marked DISPLAY for about 2 seconds until the display shows

P - - A

which indicates that programming mode A has been entered. (If the display shows "P--b" you've held DISPLAY too long. Press OPEN twice, and start again). Release DISPLAY and the display will show

P 00

which indicates that the KARIK is ready for you to enter your selection. Use SKIP ►► or ◀◀ SKIP to enter a track number, or press the appropriate digits on the remote control. Press DISPLAY again to enter this track as your selection. The display will show

P 01

indicating that your first selection has been accepted. Enter further track numbers the same way, pressing DISPLAY to store each track in sequence. You can enter up to 20 tracks.

The display will show P 02, P 03 ... and so on as each track is programmed in.

TO FINISH THE PROGRAM Press STOP ■. The display will show the total number of tracks you have entered.

TO CHECK OR ADD TO THE PROGRAM after you have pressed STOP ■, press SKIP ►► and the first track in the program will be shown. Pressing SKIP ►► again will display the second track, and so on. The display shows the track number, followed by its position in the program. So, "703" signifies that track 7 is 3rd in the program. If you want to add more tracks, press and hold

DISPLAY until "P--A" appears. Then release DISPLAY and the display will show "P" followed by the number of program slots used. Enter the additional tracks using SKIP and DISPLAY as described previously. Press STOP ■ when you have finished adding tracks.

TO PLAY THE SELECTION YOU HAVE MADE press PLAY ►.

TO PREPARE TO PLAY THE SELECTION YOU HAVE MADE press PAUSE ■■. This is useful when you are making a tape. When you are ready to listen or record, press PAUSE ■■ again or PLAY ► to start your selection.

TO ADD MORE TRACKS TO THE PROGRAM after it is playing press STOP ■. You can now check or add to the program as described above.

TO CANCEL THE PROGRAM press OPEN. The program is now cleared.

TO OMIT A SET OF TRACKS make sure the disc is loaded but not playing. Press and hold the button marked DISPLAY for about 4 seconds until the display shows

P - - b

which indicates that programming mode b has been entered. Release DISPLAY, and the display will show

P-00

indicating that the KARIK is ready for you to enter to your selection. Enter tracks in the same way as for programming mode A. When you now play the disc the tracks you have entered will not be played.

NOTES ON PROGRAM MODE While the KARIK is playing a stored program the A-B REPEAT function is disabled and SKIP ►► or ◀◀ SKIP will skip to the next or previous track in the programmed sequence. SEARCH ►► will search through the current track, and then into the next track in numerical, rather than program, sequence. So, you can use SEARCH ►► to break out of the stored program. If you do so though, the program will resume at the end of the track you used SEARCH ►► to get into.

MAINTENANCE

The KARIK and NUMERIK are designed for long life. To reinforce our commitment to customer satisfaction and extended product life, we have included in the design of the KARIK a **DIAGNOSTIC OUTPUT CONNECTOR** for ease of maintenance. We recommend that you contact your dealer approximately two years after purchase, to arrange for a free diagnostic check on your KARIK.

CLEANING Dust or finger marks can be removed using a soft, slightly damp cloth. Avoid the use of domestic cleaning fluids.

WARNING Disconnect the mains supply first.

FUSE If the fuse in the mains inlet connector should blow, replace it with the correct type only. To replace the fuse, first switch off and disconnect the mains lead. Open the fuse drawer on the mains inlet connector by grasping either side of the drawer front and pulling outwards. The drawer has two compartments, the inner one contains the active fuse and the outer one contains a spare fuse. Remove the blown fuse by poking it out from the under side of the drawer using a small screwdriver or the end of a pen. Insert the spare fuse into the inner compartment and close the drawer.

If the new fuse blows then there may be a fault and the complete unit should be returned to your Linn dealer.

GUARANTEE AND SERVICE

This product is guaranteed under the conditions which apply in the country of purchase.

In addition to any statutory rights the customer may have, we undertake to replace parts which have failed due to faulty manufacture for a period of time. To help us, please ask your Linn retailer about the Linn warranty scheme in operation in your country. In many countries registration of your purchase with Linn or its distributor will enable you to receive copies of the Linn Record Newsletter to keep you up to date with developments and products from Linn.

WARNING

Refer all enquiries to authorised Linn retailers only. Unauthorised servicing or dismantling of the product invalidates the manufacturer's warranty.

If you are in doubt, please contact your nearest Linn retailer. For information on your nearest retailer, contact the Linn Helpline in Scotland or your national distributor.

IMPORTANT

1. Please keep a copy of the sales receipt to establish the purchase date of the product.
2. Please ensure that your equipment is insured by you during any transit or shipment for repair.

LINN PRODUCTS LIMITED, FLOORS ROAD, WATERFOOT,
GLASGOW G76 0EP, SCOTLAND.

FREEPHONE (GERMANY): 0130 822156

TELEPHONE: 44-(0) 141-307-7777

FAX: 44-(0) 141-644-4262

EMAIL: helpline@linn.co.uk

INTERNET: <http://www.linn.co.uk/linn>

KARIK SPECIFICATIONS

DIMENSIONS

Width - 320mm Depth - 325mm Height - 80mm
Weight - 5.3kg

TRANSPORT

Linn MEKK 001

FOCUS SYSTEM

Triple Beam Laser Pickup

INPUTS

CD SYNC INPUT

Master/Slave Input Connection

Connector - RCA Phono

Level - 0-10V DC

REMOTE INPUT

Current loop remote control input

Maximum DC current source - 40 mA (short circuit protected)

Sensitivity - 5 mA differential signal current

Bias voltage - 10V (to power remote IR sensor)

OUTPUTS

S/P DIF DIGITAL AUDIO ELECTRICAL OUTPUT

Connector - 75 ohm BNC

Level - 0.5 V pp (75 ohms)

DIAGNOSTIC OUTPUT

Interface to Linn KARIK test equipment

Connector - 9-way D-type

Level - TTL

REMOTE OUTPUT

Current loop remote control output

Connector - RCA Phono

Level - 6mA output signal current

NUMERIK SPECIFICATIONS

DIMENSIONS

Width - 320mm Depth - 325mm Height - 80mm

Weight - 4.1kg

CONVERSION TECHNOLOGY

20 BIT 8x oversampling, dual convertor

INPUTS

2 DIGITAL AUDIO S/P-DIF INPUTS

Connector - 75 ohms BNC

Level - 0.2 V to 1 V pp (75 ohms)

Frequency - 44.1 kHz or 48 kHz sample rate \pm 150 ppm

OUTPUTS

2 STEREO AUDIO OUTPUTS

Connector - RCA Phono

Output Level - 2.1V rms (peak code)

Output Impedance - 75 ohms

Minimum Load - 1 kohm

2 CD SYNC OUTPUTS

Master/Slave output connection

Connector - RCA Phono

Control Signal - 0-10V DC

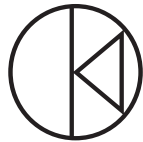

Free Manuals Download Website

<http://myh66.com>

<http://usermanuals.us>

<http://www.somanuals.com>

<http://www.4manuals.cc>

<http://www.manual-lib.com>

<http://www.404manual.com>

<http://www.luxmanual.com>

<http://aubethermostatmanual.com>

Golf course search by state

<http://golfingnear.com>

Email search by domain

<http://emailbydomain.com>

Auto manuals search

<http://auto.somanuals.com>

TV manuals search

<http://tv.somanuals.com>