

# LINN BASIK

OWNERS MANUAL

## **Intr**oduction

Thank you for buying the Linn BASIK turntable. We are sure it will provide you with musical pleasure for many years to come.

Linn Products have always stated that the turntable is the most important part of a high fidelity system. If you do not get a good signal from the record then the potential of the rest of your system will never be realised as neither the amplifier nor the speakers can improve the quality of the signal they receive.

The Linn BASIK is made to the highest engineering standards and brings a new level of performance to turntables in its price range.



## INSTALLATION

- ❖ Carefully remove all packing from box.
- ❖ Put all the oil from the phial supplied into the bearing housing - **NOTE** Remove bearing-housing dustcap.
- ❖ Carefully put the Inner Platter into the bearing housing supporting it as it sinks down to prevent damage to the bearing surfaces.
- ❖ Fit the Belt around the inner platter and motor pulley (see "Speed Selection"). **NOTE** - BE CAREFUL NOT TO GET OIL ON THE BELT
- ❖ Fit the **Outer Platter** and Mat onto the inner platter.

*If your deck is fitted with a Linn AKI TO tonearm, set the Tracking Weight as follows:-*

**NOTE** - the cartridge should be fitted to the arm prior to this procedure - remove the arm from the turntable when fitting the cartridge to the arm to prevent damaging the tonearm bearing during fitting.

- ❖ Make sure the arm is clipped into its rest, the bias is off and the lift/lower device is lowered. With tracking dial facing backward, screw the counterweight clockwise (as you look at the dial) onto the arm, pushing gently to engage the thread. Remove the stylus guard. Holding the fingerlift, unclip the arm and move it to between its rest and the platter.

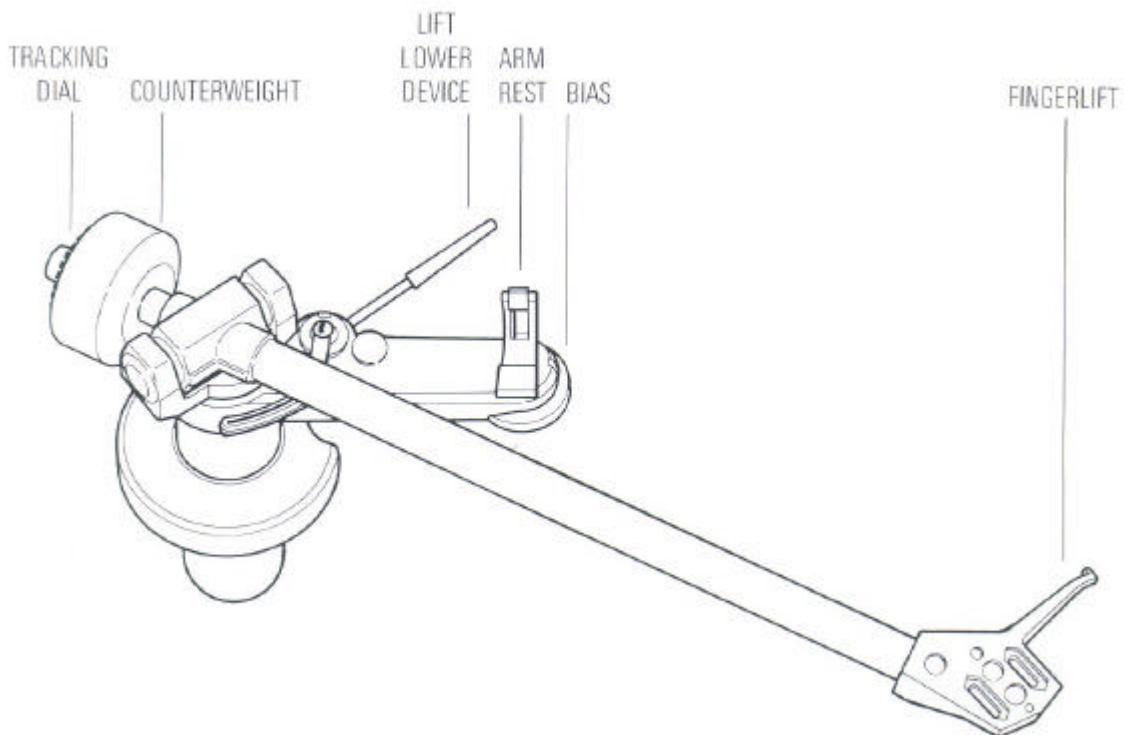

- ❖ Turn the counterweight to the position which balances the arm, i.e: where the stylus is floating at about record height. Clip the arm back into its rest. Turn the tracking dial while holding the counterweight until '0' is aligned with the line on top of the arm.
- ❖ Check the arm is still balanced. If not you have moved the counterweight when setting the tracking dial, so re-balance the arm and re-set the tracking dial to '0'. Turn the counterweight clockwise (as you look at the dial) to the desired tracking force. Set the bias to the same value. (See General Installation for more information).
- ❖ Check the arm height is correct. The arm-tube should be parallel to the record surface. Adjustment can be made by loosening the arm height adjustment screw with a 4mm hexagon key, moving the arm to the correct height and locking the screw. To set the correct torque tighten the screw firmly using the alien key in position 1, then turn the key to position 2 and tighten no more than a further 1/8 of a turn. OVERTIGHTENING CAN WRECK BEARINGS.

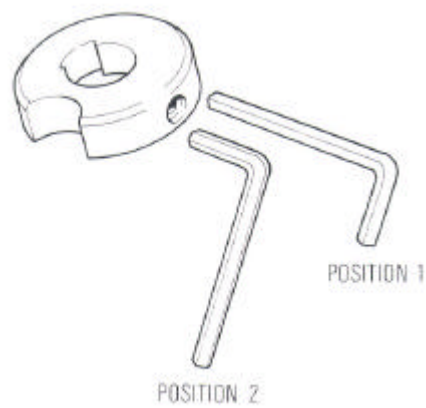

## SITING

Ensure the surface on which the turntable is to be used is level. For best results we recommend the following:-

**FLOOR MOUNTING** Place deck on a small, light, rigid table e.g. small coffee table. Ensure the table is sitting firmly on the floor and not rocking.

**WALL MOUNTING** Wall mounting may be preferable where a highly sprung floor exists or where there is risk of damage by children. The shelf used should be light and rigid, and it should be fully supported by, but not firmly screwed or glued to its brackets.

To allow the lid to open fully, a clearance of 3" (7.5cm) is required behind the plinth and at least 13" (33cm) above

Fit the arm cable to the arm pillar taking care to push it all the way home. The connector may be locked in place with the small Alien screw on the side of the pillar (don't over-tighten). Ensure that neither the mains cable nor the arm lead are under tension or interfere with the feet as this will prevent the suspension from working correctly.

## OPERATION

The power switch is on the underside of the plinth at the front left-hand side. A label indicates direction for ON and OFF. This label is removable.

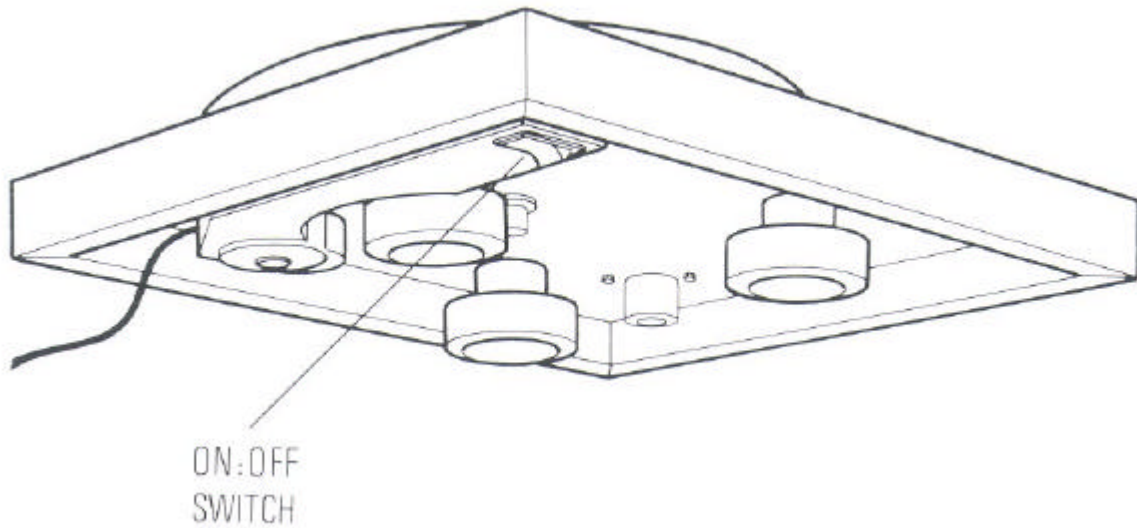

Lift and lower the lid carefully as it is coupled to the suspended plinth. If dropped or roughly handled it may cause the arm to jump.

**NOTE** You may notice a little noise from the motor at first. This should disappear when the motor has bedded-in for a few days.

## SPEED SELECTION

To change the speed of the BASIK turntable, switch off, remove the mat and outer platter and move the belt to the other level on the stepped pulley.

The larger diameter will give 45rpm, the smaller will give 33rpm.

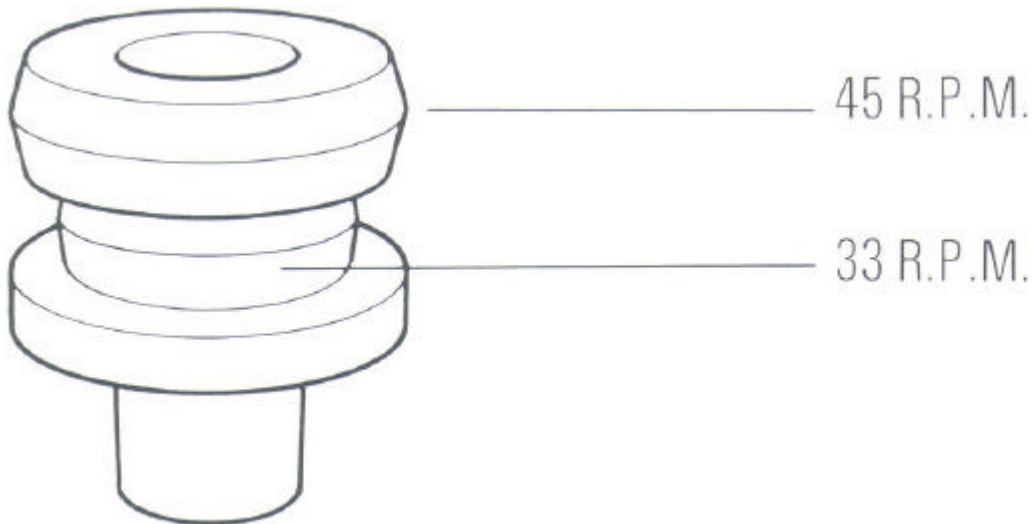

If changing to 45rpm it is advisable to start up the motor with only the inner platter in place, to allow the belt to find a stable position.

Once the belt is running straight, switch off, replace the outer platter and switch on again.

**NOTE** It is important to keep the belt clean - if it is contaminated with oil the sound quality will be degraded and the belt may jump off the 45rpm pulley. If this occurs, clean the belt and pulley with a little solvent - surgical spirits or other non-residue solvents.

## **TURNTABLE MAINTENANCE**

The BASIK is designed for a long operational life. To preserve the appearance and maintain the performance of your dock, you should note the following points:

- OUTER PLATTER**      Clean with a soft, dry cloth. **DO NOT** use any abrasive cleaner as this will remove the protective lacquer and cause corrosion.
- MAT**                      The felt mat can be cleaned with masking tape.
- MOTOR**                 The motor pulley should be cleaned periodically. Remove the outer platter and belt, and gently clean with a cloth impregnated with isopropyl alcohol or other non-residue solvents.
- PLINTH**                 This can be cleaned with a light duster or slightly damp cloth - make sure the stylus guard is in place before you start. If you have to remove an oil stain from the plinth, use a soft cloth and solvent.
- OIL**                      The oil supplied for the bearing provides life-long protection. If the oil is lost from the bearing housing it must only be replaced by factory-supplied oil which is available from your Linn dealer. The turntable should never be operated without oil.
- LID**                      The best method is to remove any dust with a damp cloth without any rubbing action and then use a soft duster. Lids are more often damaged by cleaning than in use.



## **GENERAL SYSTEM INSTALLATION**

### **TRACKING WEIGHT & BIAS**

Every arm and cartridge combination has an optimum tracking weight which your dealer will have advised you of.

### **RECORD CLEANING**

Most record cleaning devices do more harm than good. The best method of cleaning records is to let the stylus remove any dirt in the groove, then clean the stylus.

### **STYLUS CLEANING**

It is important that the stylus is kept scrupulously clean. We have found that dry vibrating pad cleaners work well. Alternatively, Linn dealers can supply cleaning paper which is easy to use and gives excellent results.

### **CLEAN CONTACTS**

Electrical contacts in a hi-fi system must be kept mechanically sound and clean. A poor contact between the cartridge and arm will degrade performance. Checks on all contacts should be performed periodically.

### **INTERCONNECT LEADS**

We recommend and supply good quality copper cable for interconnect leads and advise 4mm so multicore copper cable, such as Linn K20, for speaker leads.

### **SPEAKER PLACEMENT**

Speakers should be positioned correctly and should be mounted on rigid stands which are sitting firmly on the floor and not rocking.

NOTE Linn speakers are designed to be placed close to the wall

## **TRANSPORTATION**

Always keep all the packing for your BASIK turntable.

When transporting the BASIK turntable, remove the counterweight from the arm, remove the arm from the plinth, remove the inner platter from the bearing housing and place it in its position in the packing. Replace the bearing cap to prevent oil spillage.

If the deck is to be shipped anywhere it is important to pack it properly in the original packing, otherwise damage will occur.

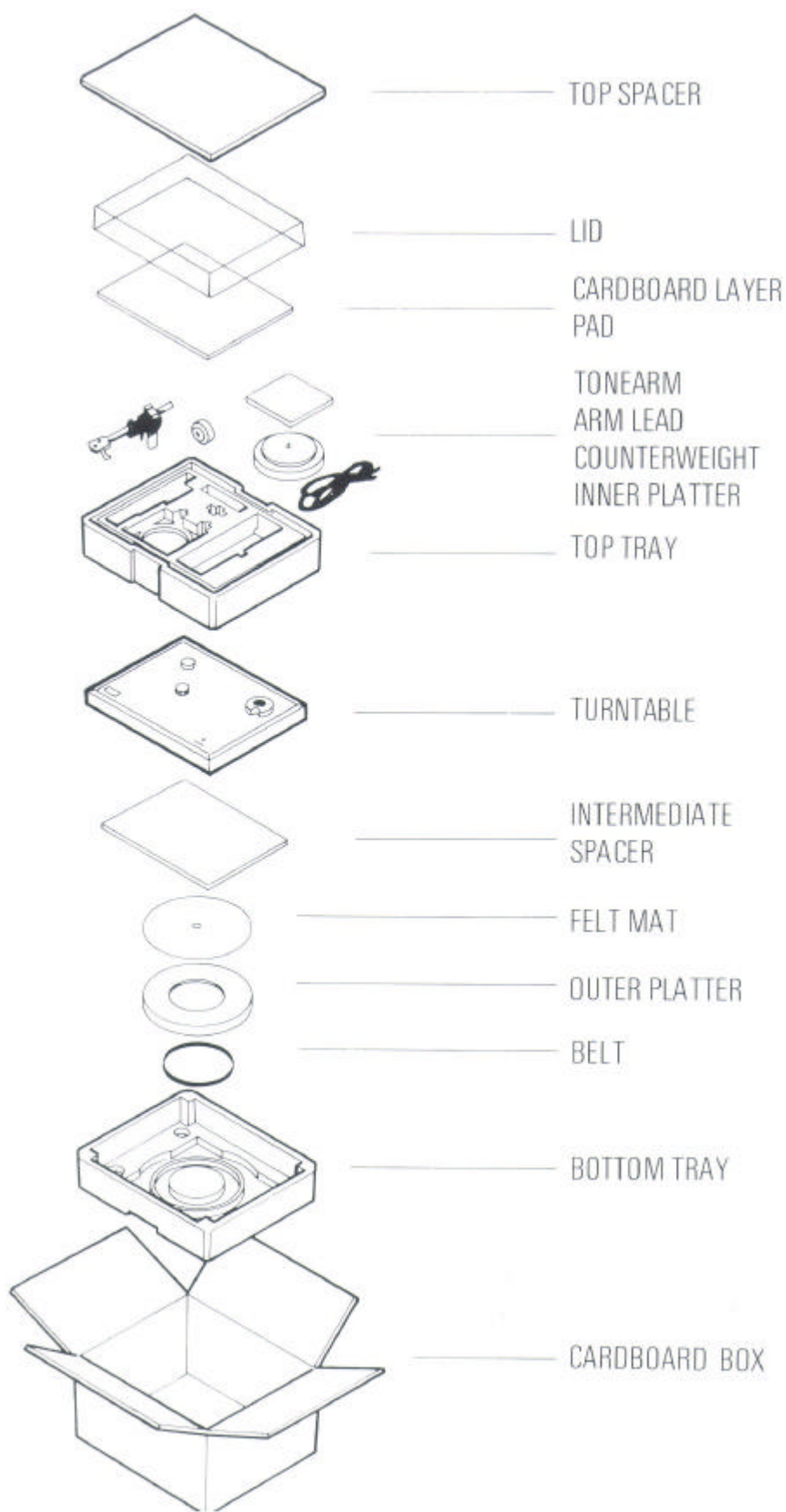

## **GUARANTEE**

The unit is guaranteed under the conditions that apply in the country of purchase.

Unauthorised servicing or dismantling of this turntable will invalidate the manufacturer's warranty. If you are in any doubt, please contact your nearest Linn dealer.

In addition to any statutory rights the customer may have, we undertake to replace any parts, which have failed due to faulty manufacture.

Keep a copy of the sales receipt, as this will establish the purchase date of the turntable.

Refer all enquiries to authorised dealers only. For information on your nearest dealer, contact the Linn factory in the UK or an overseas distributor.

LINN PRODUCTS LTD., FLOORS ROAD, WATERFOOT, EAGLESHAM,  
GLASGOW G76 OEP. SCOTLAND.  
TELEPHONE ++44 (0)141 307 7777  
FACSIMILE ++44 (0)141 644 4262

## Free Manuals Download Website

<http://myh66.com>

<http://usermanuals.us>

<http://www.somanuals.com>

<http://www.4manuals.cc>

<http://www.manual-lib.com>

<http://www.404manual.com>

<http://www.luxmanual.com>

<http://aubethermostatmanual.com>

Golf course search by state

<http://golfingnear.com>

Email search by domain

<http://emailbydomain.com>

Auto manuals search

<http://auto.somanuals.com>

TV manuals search

<http://tv.somanuals.com>