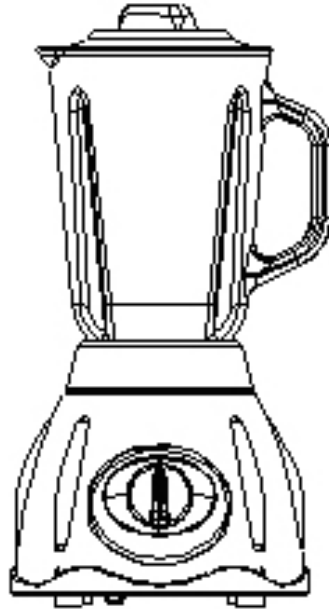



TABLE BLENDER

EWBL20SG

-HOUSEHOLD USE ONLY-



 **CAUTION:**

BEFORE USE, PLEASE READ AND FOLLOW ALL IMPORTANT SAFEGUARDS, PRECAUTIONS AND OPERATING INSTRUCTIONS.

Table of Contents

Safety Instructions	3-5
Parts and Features	6
Assembling & Operating Instructions	7
Cleaning and Maintenance	7-8
Warranty	9

What You Need to Know About Safety Instructions

Warning and Important Safety Instructions appearing in this manual are not meant to cover all possible conditions and situations that may occur. Common sense, caution and care must be exercised when installing, maintaining, or operating appliance.

Always contact your dealer, distributor, service agent or manufacturer about problems or conditions you do not understand.

Recognize Safety Symbols, Words, Labels

WARNING

WARNING-Hazards or unsafe practices which **COULD** result in severe personal injury or death.

CAUTION

CAUTION-Hazards or unsafe practices which **COULD** result in minor personal injury.

IMPORTANT SAFEGUARDS

WARNING

When using electrical appliances, basic safety precaution should always be followed, including the following:

IMPORTANT SAFEGUARDS

- 1) Read all instructions.**
- 2) This appliance is for household use only. Do not use outdoors.
- 3) Do not use this appliance for other than its intended use.
- 4) Before using for the first time, check if voltage indicated on the base of the appliance corresponds to the voltage in your home.
- 5) Do not turn the power on unless this appliance is properly assembled.
- 6) Close supervision is necessary when any appliance is used by or near children.
- 7) Do not operate any appliance with a damaged cord or plug, or after the appliance malfunctions or has been damaged in any manner.

Return appliance to authorized service center for examination, repair or adjustment.

- 8) The use of attachments or accessories not recommended or sold by the manufacturer may result in fire, electric shock or injury.
- 9) Unplug the appliance from the outlet when not in use, assembling and disassembling, and before cleaning. Make sure the appliance cools down completely before assembling, disassembling and cleaning.
- 10) Do not let cord hang over edge of table or counter, or touch hot surfaces.
- 11) Do not place the appliance on or near a hot gas or electric burner, or in a heated oven.
- 12) Do not use outdoors.
- 13) Do not touch the moving parts of the appliance when operating.
- 14) Do not put fingers or other objects into the appliance when operating.
- 15) Do not operate the appliance longer than 3 minutes without interruption.
- 16) Do not operate the appliance without any food or water.
- 17) Avoid using this appliance to process ingredients hotter than 127°F (80°C).
- 18) Keep hands and utensils out of jar while blending to prevent the possibility of severe personal injury or damage to the blender. Use a scraper only when the blender is not operating.
- 19) Blades are sharp. Handle carefully.
- 20) To avoid injury, never place cutting blade assembly on base without container properly attached.
- 21) Always operate lid with cover in place.



WARNING:

To protect against electric shock, fire, and injury to persons, do not immerse main cord, plug or unit in water or any other liquid.

**WARNING:**

This product is equipped with a polarized plug (one blade is wider than the other blade) as a safety feature to reduce the risk of electrical shock. This plug will fit into a polarized outlet only one way. This is a safety feature. If you are unable to insert the plug into the electrical outlet, try reversing the plug. If the plug still does not fit, contact a qualified electrician.

Never use the plug with an extension cord unless the plug can be fully inserted into the extension cord. Do not alter the plug of the appliance or any extension cord used with this appliance. Do not attempt to defeat the safety purpose of the polarized plug.

SAVE THESE INSTRUCTIONS

Parts and Features

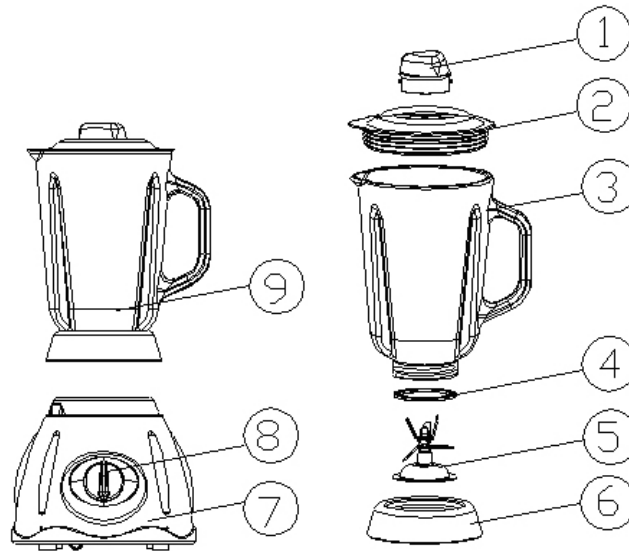

1. Measuring Cup
2. Lid
3. 48oz Glass Jar
4. Sealing Ring
5. 6pc Blade
6. Base
7. Motor Base
8. Control Knob
9. Glass Jar Assembly

SPECIFICATIONS:

- Power: 500 Watts
- Maximum capacity of jug: 1500ml / 48oz
- 6 pieces stainless steel blade
- Ice crush specification
- Built-in safety switch
- Stainless steel housing

Assembling and Operating Instructions

Before using for the first time, wash all parts and attachments in hot soapy water, rinse and dry thoroughly.

Assembling of the Glass Jar

1. Put the rubber sealing ring (4) on the inner edge of the blade unit (5).
2. Put the blade unit with sealing ring into the base (6).
3. Mount the glass jar (3) onto the base (6) and turn it clockwise until it is fixed.
4. After putting the ingredients in the jar, fix the lid (2) onto the jar by pressing down.
5. Insert the measuring cup (1) into the opening of the lid, and turn it counterclockwise until it is locked.

Inserting the Glass Jar

1. Make sure that the blender is switched to off position. (0 setting)
2. Place the jar assembly (9) on to the motor base (7) and press down until securely engaged.

Operating

1. Place the desired ingredients into the glass jar.
2. Put the lid on the glass jar and close securely. Place the

ICE CRUSHING

Put the ice (size 1in x 1in) into the jar and operate the switch "Pulse". Hold the "Pulse" switch until desired amount of ice has been crushed. Keep the toggle switch at 'Off" position.

 CAUTION:
• Never turn on the appliance until it is properly assembled.
• Never use boiling liquids.
• Do not operate for more than 90 seconds at one time.
• After 90 seconds of continuous use, allow few minutes to rest before the next usage.
• Use "Ice Crush" function when crushing ice.

Cleaning and Maintenance

COMPLETELY CLEAN AND DRY ALL PARTS AFTER EVERY USE.

Be sure to unplug the appliance before cleaning. To protect against electrical shock, do not immerse cord, plug or unit in water or other liquid.

Never use harsh abrasives, caustic cleaners on the interior surface. Wipe dry with clean cloth. For stubborn stains, use a nylon or plastic scouring pad or a powdered, non-abrasive cleaner. Dry thoroughly before closing.

To clean the exterior finish, simply wipe with a clean damp, cloth. After cleaning, re-fit the bowl. This keeps the mechanism underneath covered. For all other parts, wash by hands and dry thoroughly.

SAVE THESE INSTRUCTIONS

eWAVE

Limited Warranty

This **Ewave** product is warranted, to the original purchaser or gift recipient, to be free from any manufacturing defects under normal use and conditions for a period of one (1) year from the date of purchase as shown on retailer's receipt.

The obligation of **MC Appliance** under this warranty shall be limited to repair or replacement (at our option) during the warranty period, of any part that proves to be defective in material or workmanship under normal installation and use. The product is to be returned to **MC Appliance** or an Authorized Service Center **POSTAGE PREPAID**. A copy of the original receipt along with your name, address and phone number must accompany products returned. Include a description of the defect along with the date you purchased the product.

This warranty shall be invalid if the product is damaged as a result of misuse, abuse, negligence, defacement, destruction, accident, fire or other casualties or alterations in any manner. Improper repair, improper use of electrical voltages or currents, alteration of serial number, maintenance by any person or entity other than our own Service Facility or Center, or any use not in conformity with product instruction, shall render this warranty invalid.

MC Appliance assumes no responsibility for damage resulting from the use of this product in a manner or location other than that for which it was intended.
WARRANTY CONDITIONAL TO NORMAL AND NON-COMMERCIAL USE OF THIS APPLIANCE FOR DOMESTIC USE ONLY.

For the nearest Authorized Service Center, contact:
Ewave Customer Service: 1-888-775-0202
Or visit our website at www.mcappliance.com

Free Manuals Download Website

<http://myh66.com>

<http://usermanuals.us>

<http://www.somanuals.com>

<http://www.4manuals.cc>

<http://www.manual-lib.com>

<http://www.404manual.com>

<http://www.luxmanual.com>

<http://aubethermostatmanual.com>

Golf course search by state

<http://golfingnear.com>

Email search by domain

<http://emailbydomain.com>

Auto manuals search

<http://auto.somanuals.com>

TV manuals search

<http://tv.somanuals.com>