



COFFEE MAKER

10 Cup

INSTRUCTION MANUAL

Model: MCSCM10PGBST



THANK YOU FOR PURCHASING A MAGIC CHEF PRODUCT. PLEASE READ ALL INSTRUCTIONS CAREFULLY BEFORE USING THE PRODUCT.

CONTENTS

| | |
|-------------------------------------|-----------|
| SAFETY INSTRUCTIONS | 3 |
| IMPORTANT SAFEGUARDS | 4 |
| PARTS AND FEATURES | 6 |
| BEFORE USE | 7 |
| OPERATING INSTRUCTIONS | 8 |
| CARE AND MAINTENANCE | 11 |
| WARRANTY | 12 |

What You Need to Know About Safety Instructions

Warning and Important Safety Instructions appearing in this manual are not meant to cover all possible conditions and situations that may occur. Common sense, caution and care must be exercised when installing, maintaining, or operating appliance.

Always contact your dealer, distributor, service agent or manufacturer about problems or conditions you do not understand.

Recognize Safety Symbols, Words, Labels

WARNING

WARNING-Hazards or unsafe practices which **COULD** result in severe personal injury or death.

CAUTION

CAUTION-Hazards or unsafe practices which **COULD** result in minor personal injury.

IMPORTANT SAFEGUARDS

WARNING

**SAVE THESE INSTRUCTIONS
FOR HOUSEHOLD USE ONLY**

IMPORTANT SAFEGUARDS

When using an electrical appliance, basic safety precautions should always be followed including the following:

1. **READ ALL INSTRUCTIONS BEFORE USING.**
2. Do not touch hot surfaces. Use handles or knobs.
3. To protect against fire, electric shock and injury to persons, do not immerse cord or plug in the water or other liquid.
4. Not allow children to use without supervision.
5. The carafe is designed for use with this appliance. It cannot be used on a range top.
6. Overfilling can also cause scalding.
7. Unplug from the outlet when not in use and before cleaning. Cool the appliance before assembling or disassembling parts, and before cleaning the appliance.
8. Do not operate any appliance with a damaged cord or plug or after the appliance malfunctions, or is damaged in any manner. Return the appliance to the nearest authorized service facility for examination, repair or adjustment.
9. The use of accessory attachments not recommended by the appliance manufacturer may result in fire, electric shock, or injury to persons.
10. Do not touch the sharp grinder blades while it is in use. Handle with care.
11. Do not operate the grinder if it has any foreign objects inside other than compatible coffee beans.
12. Do not clean the carafe with cleansers, steel wool pads, or other abrasive materials.
13. This appliance can only be used with the carafe properly positioned on the stand.
14. Do not let the cord hang over the edge of table or counter, or touch hot surface.
15. Do not place on or near a hot gas or electric burner, or in a heated oven.
16. To disconnect, turn all control to "OFF", then remove the plug from the outlet.
17. Do not use a carafe that is cracked or has a loose or weakened handle.
18. Never leave an empty carafe on the warming plate, otherwise the carafe is prone to crack.
19. Do not set a hot carafe on a hot or cold surface.
20. Do not use this appliance for other than intended use.
21. Do not use outdoors.

Notes on the Polarized Plug

This appliance has a polarized plug. To reduce the risk of electric shock, this plug is intended to fit into a polarized outlet only in one way. If the plug does not fit fully into the outlet, reverse the plug. If it still does not fit, contact a qualified electrician. Do not attempt to modify the plug in any way.

Notes on the Cord:

- A. A shorter power-supply cord (or detached power-supply cord) is provided to reduce the risk resulting from being entangled in or tripping over a longer cord.
- B. Longer detachable power-supply cords or extension cords are available and may be used if care is exercised in their use.
- C. If a long detachable power-supply cords or extension cord is used:
 - 1. The marked electrical rating of the detachable power-supply cord or extension cord should be at least equal or great than the electrical rating of the appliance.
 - 2. If the appliance is a grounded type, the extension cord should be a grounding-type 3-wire cord.
 - 3. The longer cord should be arranged so that it will not drape over the counter top or table top where it can be pulled on by children or tripped over.

WARNING:

To protect against electric shock, fire, and injury to persons, do not immerse main cord, plug, or unit in water or any other liquid.

CAUTION:

Do not use an extension cord with the appliance. If necessary, an extension cord must have compatible rating for power and voltage. Do not modify the plug and extension cord with this appliance; including 3 prong grounded plug.

PARTS AND FEATURES

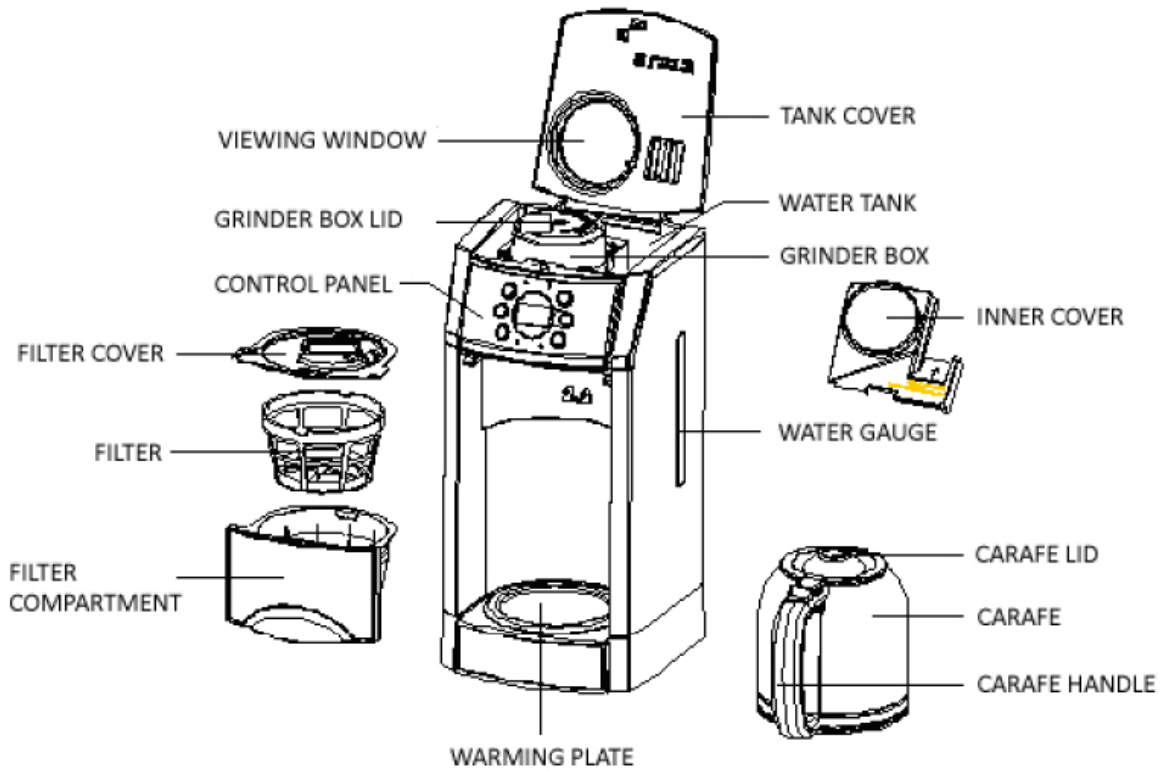

Control Panel

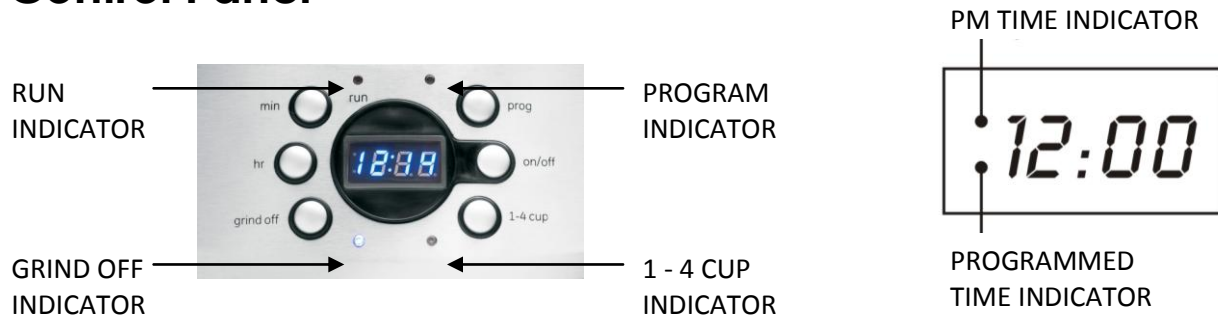

Specifications

- Voltage Rating: 120V
- Power Rating: 900 Watts
- Maximum Capacity: 10 Cups

BEFORE USE

Check that accessories are complete and the unit is not damaged. Do not brew the coffee until brewing clean water up to the marker indicated "MAX" then pouring out the water; follow the steps below for one or two times. Using warm water, thoroughly clean the carafe, carafe lid, funnel, and filter.

NOTE: The carafe lid is packaged separately. Before using, you must assemble the lid and the carafe.

Assemble according to the following:

1. Firstly remove the carafe lid from the package, and place the lid on the carafe; make sure the two tubers on the lid are aligned with the groove of carafe.
2. Then press the lid on the arrow position with a little force (see Fig.1); the notches will be pressed into the groove. The lid is assembled on the carafe.

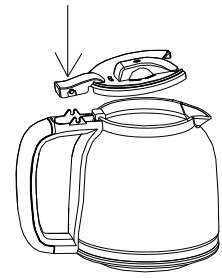

Fig.1

OPERATING INSTRUCTIONS

Setting the Clock

1. Once the appliance is connected to the power supply, "88:88" will display and flash on the LED display. After 5 seconds, "12:00" will display.

NOTE: If you do not set the clock, you can go directly to other settings.

2. Press the PROG button to begin the Time Set mode. Use HR (hour) or MIN (minute) button to set the time.

NOTE: The time cycle is 12 hours. Reference the LED indicator to determine AM and PM.

3. Confirm the clock setting by waiting for 15 seconds.

Programming the Auto-Start

If you do not want the coffee maker to start immediately, you may set the automatic start function as follows:

1. After setting the clock, Press the PROG button twice to preset the automatic start time. The desired time can be set by pressing the HR (hour) and MIN (minute) buttons to scroll forward through the digits.
2. When the desired time setting approaches, press the ON/OFF button twice; the program indicator will turn on. When the preset time reaches, the program indicator will turn off. The ON/OFF indicator will turn on and the Coffee Maker will start brewing.

NOTE: You can see the automatic start time by pressing the PROG button.

3. If you want to cancel the preset program, press the ON/OFF button twice. The Coffee Maker will start brewing immediately.

Brewing with Whole Coffee Beans

CAUTION: Before you make the first pot of coffee, start the coffee maker using water and paper filter only. This removes any residues in the unit from the manufacturing process.

Before brewing coffee, make sure the carafe is properly positioned on the warming plate.

1. Open the tank cover by pushing the release button. Lift and remove the grinder box. Open the lid and fill the grinder box with beans, referencing the side marks.

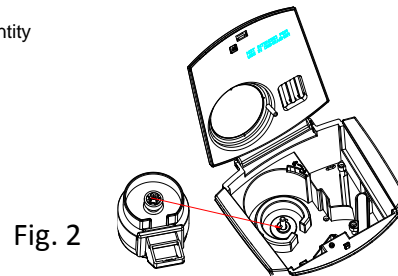
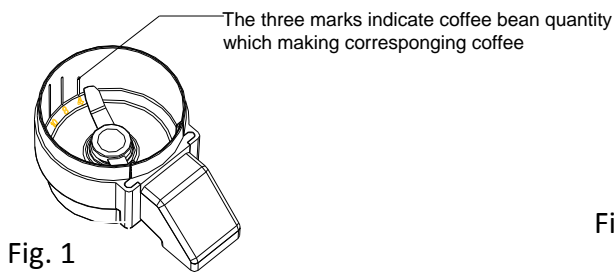

The marks indicate the bean quantity for making coffee (Fig. 1). Do not overfill. Assemble the grinder box into the coffee maker. The connector groove must be locked into the motor shaft (Fig. 2). Otherwise, the grinder box will not be assembled in place properly, and it may damage the grinder box.

NOTE: The grinder box must be removed for adding beans.

2. Replace the grinder box cover (Fig. 3) by turning the cover clockwise from UNLOCK to LOCK position. The cover must be locked in position in order to operate.

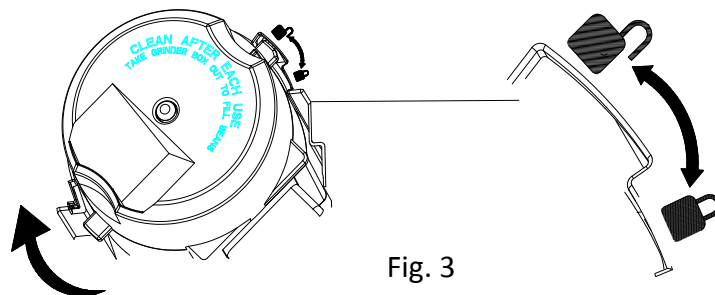

3. After adding beans, pour water in the water reservoir as indicated on the inner cover (Fig. 4). The water level can be gauged by marks on the right side of the tank.

NOTE: Before filling water, the inner cover must be assembled in place.

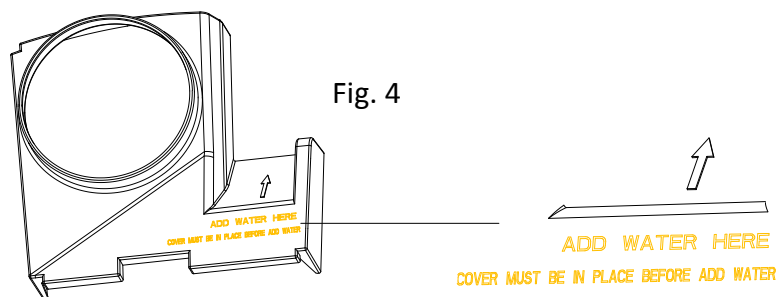

4. Place the permanent filter in the filter compartment and close the filter cover. Push the filter compartment in place.

NOTE: A permanent filter may allow some ground coffee to flow into carafe.

5. Close the water reservoir cover by pressing down until it locks; the appliance is equipped with a safety interlock system.

CAUTION: The appliance will not turn on if the water reservoir cover is not closed properly or the grinder box is not installed properly. Press ON/OFF button to continue brewing.

6. Plug the cord into an electrical outlet; “88:88” will display and flash on the LED. After 5 seconds, “12:00” will display. Set the clock as instructed in **Setting the Clock** above.
7. For immediate grinding and brewing, press the ON/OFF button. RUN indicator will turn on and the Coffee Maker will start brewing.

NOTE: When GRIND OFF indicator is on, the Coffee Maker will make coffee with pre-ground beans.

8. Choose the grinding amount of beans by pressing the 1-4CUP button or using the default setting of 5 to 12 cups.

NOTE: 1-4CUP setting runs for 30 seconds. 5-12CUP default setting runs for 40 seconds.

9. Brewing will start after grinding is completed.

CAUTION: Be cautious with the steam during the brewing process.

10. When the brewed coffee is ready, stirring is recommended for blending flavors. The coffee will be kept warm for 2 hours before the Coffee Maker shuts off automatically.

Brewing with Pre-ground Coffee Beans

1. Open the water reservoir by pushing the release button and lifting it up. Make sure the inner cover is in place and pour the desired amount of water in the reservoir by referencing the water level marks on the right side of the reservoir.

2. Pull out the filter compartment and add pre-ground coffee in the permanent filter.

CAUTION: The maximum capacity for ground coffee is 10 scoops using a permanent filter.

3. Replace the filter cover and push the filter compartment in place.
4. Before brewing coffee, make sure the carafe is properly positioned on the warming plate and the filter compartment setup properly.
5. Plug the cord into an electrical outlet; “88:88” will display and flash on the LED. After 5 seconds, “12:00” will display before setting the clock. See **Setting the Clock** above.
6. Press the GRIND OFF button until the indicator turns on. Press ON/OFF button to begin brewing without using the grinder.

CARE AND MAINTENANCE

CAUTION: Be sure to unplug this appliance from the electrical outlet before cleaning. To protect against the electrical shock, do not immerse the cord, plug, or unit in the water or other liquid.

1. After each use, use soapy water to clean: funnel, filter, carafe, carafe lid.
2. Wipe the product's exterior surface with a soft and damp cloth to remove stains.
3. Water droplets may buildup in the area above the filter and drip onto the product base while brewing. To manage the dripping, wipe off the area with a clean, dry cloth after each use of the product.
4. Use a soft and damp cloth to gently wipe the warming plate. Never use abrasive material to clean the appliance.

Cleaning Mineral Deposits

For efficiently operating the coffee maker, mineral deposits contained in the used water should be cleaned from the unit. Carefully clean the coffee maker as the following.

1. Fill the carafe with 1/4 of white vinegar and 3/4 of cold water.
2. Pour the water and vinegar mixture into the tank. Do not fill in the coffee ground.
3. Brew the water-vinegar solution per "**OPERATING INSTRUCTIONS**",
4. If necessary, repeat the process until no yellow liquid comes out.
5. Pour out the mixed solution.
6. Brew with tap water until no vinegar odor is left.



LIMITED WARRANTY

Unless otherwise prohibited, **MC Appliance Corporation** warrants each **10 CUP COFFEE MAKER MCSCM10PGBST** to be free from defects in material and workmanship and agrees to remedy any such defect or to furnish a new part(s) (at the company's option) of the unit that fails during the warranty period. **A copy of the dated sales receipt or invoice is required to receive warranty service or a refund.**

This warranty covers an appliance in use within the continental United States, Puerto Rico and Hawaii. The warranty does not cover the following:

- Damages due to shipping or improper installation.
- Damages due to misuse or abuse.
- Content losses due to failure of the unit.
- Repairs performed by unauthorized service agents.
- Service calls that do not involve defects in material and workmanship such as instruction on proper use of the product or improper installation.
- Failure of this product if used for other than for its intended purpose.
- Disposal costs for any failed unit not returned to our factory.
- Any delivery costs incurred as the result of a unit that fails to perform as specified.

This warranty is in lieu of any and all warranties expressed or implied and no representative or person is authorized to assume for us any other liability in connection with the sale of this product. Under no circumstances is the consumer permitted to return this unit to the factory without prior written consent from MC Appliance Corporation.

| Model | Parts & Labor | Type of Service |
|--------------|---------------|-----------------|
| MCSCM10PGBST | One-Year | Carry-In |

For Service or Assistance please call

888-775-0202

Or visit us on the web at www.magicchef.com to request warranty service

Free Manuals Download Website

<http://myh66.com>

<http://usermanuals.us>

<http://www.somanuals.com>

<http://www.4manuals.cc>

<http://www.manual-lib.com>

<http://www.404manual.com>

<http://www.luxmanual.com>

<http://aubethermostatmanual.com>

Golf course search by state

<http://golfingnear.com>

Email search by domain

<http://emailbydomain.com>

Auto manuals search

<http://auto.somanuals.com>

TV manuals search

<http://tv.somanuals.com>