

Installation Sheet

The DVU-2 is a Dual VPA Socket and USB Port Adapter. This unit can be mounted in two ways: Screw Mount and Velcro[®] Mount. Choose a mounting location that provides easy access and LED is clearly visible. Follow the diagrams below for proper installation.

Mounting the Unit

Screw Mount:

The DVU-2 comes with flat head screws to facilitate mounting the unit to the dashboard or some other accessible area in the vehicle.

1. Attached the mounting tabs to the unit with the screws provided.
2. Once tabs are attached use remaining screws to mount unit in an accessible area.

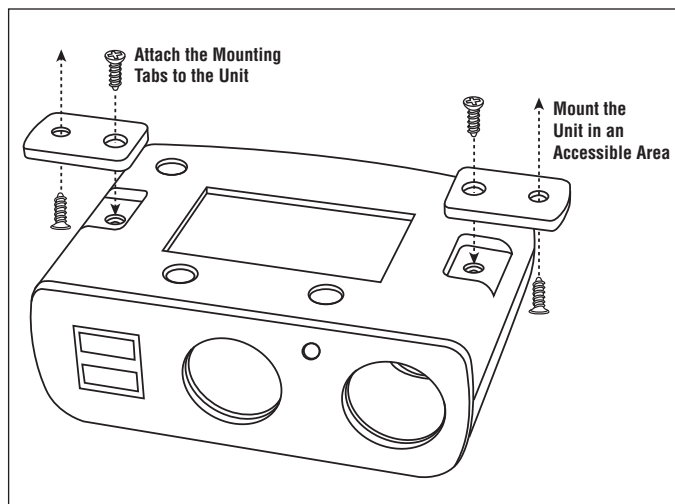

Velcro Mount:

The DVU-2 comes with a Velcro pad for mounting the unit to the dashboard or some other accessible area in the vehicle.

1. Make sure the surface area on the unit where the Velcro will adhere to, and the surface you are adhering it to are clean.
2. Remove the backing on one side of the Velcro pad.
3. Apply the Velcro pad to specified area on the unit.
4. Remove the backing on the other side of the Velcro pad and then press the unit firmly into the designated mounting location.

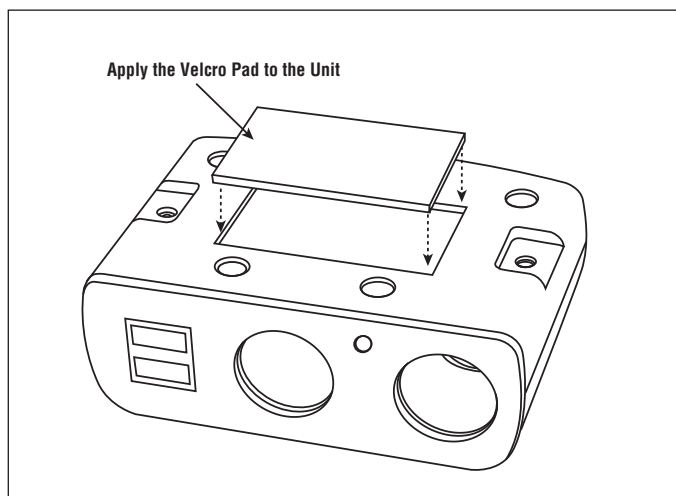

Optional Hard Wiring

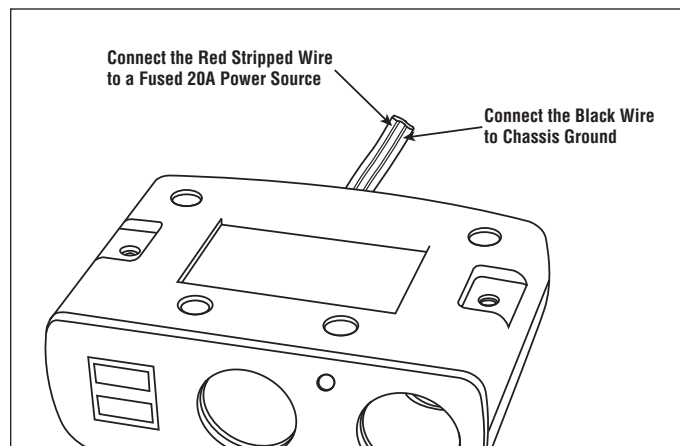

Hard Wiring:

The DVU-2 VPA plug can be removed to allow for hard wiring of the unit when permanently installing it in a vehicle.

1. Cut off the VPA connector making sure to leave the appropriate length of cable to reach your connection point.
2. Connect the red stripped wire to a fused 20A power source.
3. Connect the black wire to chassis ground.

Free Manuals Download Website

<http://myh66.com>

<http://usermanuals.us>

<http://www.somanuals.com>

<http://www.4manuals.cc>

<http://www.manual-lib.com>

<http://www.404manual.com>

<http://www.luxmanual.com>

<http://aubethermostatmanual.com>

Golf course search by state

<http://golfingnear.com>

Email search by domain

<http://emailbydomain.com>

Auto manuals search

<http://auto.somanuals.com>

TV manuals search

<http://tv.somanuals.com>