

Magnavox[®]
Smart. Very Smart.

DVD/VCR

combo

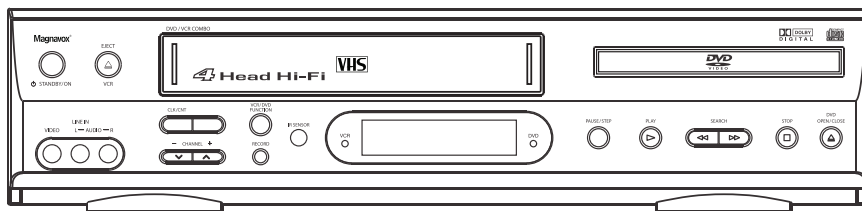

NEED HELP?

CALL THE CONSUMER HOTLINE

AUSTRALIA **1300 363 872**
NEW ZEALAND **0800 328 280**



MDVDVCR5

Introduction

Congratulations on the purchase of your Magnavox DVD and VCR player. It is hoped that you have a lot of enjoyment from your player.

Thank you very much for your purchase of this product.

To enjoy your player to the full from the very beginning, read this manual carefully and keep it handy for ready reference.

Important Safeguards

When using electrical appliances, in order to reduce the risk of fire, electric shock, and /or injury to persons, basic safety precautions should always be followed.

For Your Safety

Read all instructions carefully even if you feel you are quite familiar with the appliance.

- This appliance is not intended for use by young children or infirm persons unless they have been adequately supervised by a responsible person to ensure that they can use the appliance safely.
- Young children should be supervised to ensure that they do not play with the appliance.
- This appliance should be placed on a flat, stable surface before it is operated.
- **INDOOR USE ONLY** - this appliance is not intended for outdoor use.
- Do not expose this appliance to rain or moisture. Do not immerse.
- Do not place items filled with liquids, such as vases, on the appliance. Do not expose appliance to dripping or splashing liquids.
- Do not place naked flame sources, such as candles, on the appliance.
- Do not locate the appliance near heat sources such as radiators, heaters, air ducts or direct sunlight.



- Do not block and of the ventilation openings. Ensure that vents are not covered by newspapers, tablecloths, curtains, etc. Do not install in a tight fitting cabinet.
- Do not insert or allow foreign objects to enter any grill openings.
- This appliance is not intended for use in bathrooms, laundry areas or similar moist locations. Never locate this appliance in the immediate surroundings of ,or where it may fall into, a bath, basin, washtub, shower or swimming pool.
- Do not run the power cord under carpeting. Arrange the supply cord away from traffic areas and where it will not become a trip hazard.
- To disconnect the appliance, turn appliance off, switch off power outlet and remove plug from power outlet.
- Do not abuse the supply cord. Never carry the appliance by the supply cord. Never yank the supply cord from the power outlet; instead, grasp the plug and pull to disconnect. Keep supply cord away from heated surfaces.
- Do not operate the appliance with a damaged supply cord or plug or after the appliance malfunctions, has been dropped or damaged in any way. Consult an authorised service facility or similarly qualified person for examination.
- This product has not been designed for any other uses other than those specified in this booklet. This product is intended for household use only.
- Since movement of the CD mechanism and the sensitive circuitry may cause interference to a nearby radio tuner, switch this unit off while operating other radio devices.

Compulsory Warning

If the supply cord is damaged it must be replaced by the manufacturer or its service agent or a similarly qualified person in order to avoid a hazard.

Save These Instructions

Caution



- Do not open - do not attempt to repair, disassemble or modify this appliance.
- Dangerous high voltages exist inside this appliance.
- This appliance is only to be serviced by a qualified person.
- No user-serviceable parts inside.
- Class 1 laser product.
- Recording any broadcast may infringe copyright.

Warning

To prevent fire or shock hazard, do not expose this appliance to rain or moisture. The apparatus should not be exposed to dripping or splashing and that no objects filled with liquids, such as vases, shall be placed on the apparatus. The ventilation should not be impeded by covering the ventilation openings with items, such as newspapers, tablecloths, curtains, etc. No naked flame sources, such as lighted candles, should be placed on the apparatus.

Important

Since the CD circuitry may cause interference to other radio tuners nearby, switch this unit off when not in use or move it away from the affected radio tuner.

 <p>The lightning flash with arrowhead symbol, within an equilateral triangle, is intended to alert the user to the presence of uninsulated "dangerous voltage" within the product's enclosure that may be of sufficient magnitude to constitute a risk of electric shock to persons.</p>	<p style="text-align: center;">CAUTION</p> <p style="text-align: center;">RISK OF ELECTRIC SHOCK DO NOT OPEN</p> <p>WARNING: TO REDUCE THE RISK OF ELECTRIC SHOCK, DO NOT REMOVE COVER (OR BACK). NO USER-SERVICEABLE PARTS INSIDE, REFER SERVICE TO QUALIFIED SERVICE PERSONNEL.</p>	 <p>The exclamation point within an equilateral triangle is intended to alert the user to presence of important operating and maintenance (servicing) instructions in the literature accompanying the appliance.</p>
--	--	---

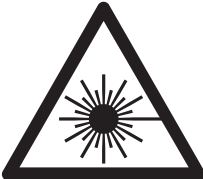
 <p>INVISIBLE LASER RADIATION WHEN OPEN AND INTERLOCK FAILED OR DEFEATED. AVOID DIRECT EXPOSURE TO LASER BEAM.</p>	<p style="text-align: center;">Laser Safety</p> <p>This unit employs an optical laser beam system in the CD mechanism, designed with built-in safeguards. Do not attempt to disassemble; refer to qualified service personnel.</p> <p>Exposure to this invisible laser light beam may be harmful to the human eye.</p> <p>THIS IS A CLASS-1 LASER PRODUCT. USE OF CONTROLS, OR ADJUSTMENTS OR PROCEDURE OTHER THAN THOSE SPECIFIED HEREIN, MAY RESULT IN HAZARDOUS LASER.</p>
---	---

**CLASS 1
LASER PRODUCT**

Advantages of This Product Are.....

- DVD, VCD, CD, CD-R(MP3), CD-RW, VHS playback function
- DVD one-touch record function
- Watching DVD for recording broadcast
- Integrated REMOTE (VCR, DVD)
- Index Search
- GUI (Graphical User Interface) OSD (On Screen Display)
- By using the [DISPLAY] button on the remote control, information on the DVD / VCD / CD player and disc, can be displayed on the TV screen.
- Screen saver function (DVD)
- Built-in Dolby Digital decoder (DVD)
- Analog audio 2-channels output for DOWNMIX (x1)
- Composite RCA video out (x1)
- Slow Forward / Reverse playback (DVD)
- Fast Forward / Reverse playback (DVD)
- Search of title, chapter, and time in DVD disc, and search of time and track time in CD
- Various TV aspect (DVD) 4:3 for Pan and Scan, 4:3 for Letter Box, and 16:9 for Wide
- Repeat playback for DVD
- 5 languages OSD (On Screen Display) function (DVD)
- You can select and display OSD in 5 languages.
- Parental Lock function (DVD)
- This function can prevent playback of software that may be unsuitable for children.
- Multi Audio function (DVD)
- The audio soundtrack can be heard in up to 8 languages and depends on the disc. (The number of audio languages depends on the software.)
- Multi Subtitle function (DVD)
- The subtitle can be seen in up to 32 languages and depends on the disc. (The number of subtitle languages depends on the software.)
- Multi Angle function (DVD)
- This function allows you to choose the viewing angle of scenes which were shot from a number of different angles. (The number of angles depends on the software.)
- Screen zoom function (DVD)

Read Carefully Before Using

Cautions in use of DVD-Video player are described below. Please read carefully before using a DVD-Video player.

Installation Place and Handling

- When you place this player near other devices, they may affect poorly together.
- When you place DVD-Video player and TV in the upper and lower sides, it may cause flickering of pictures or failure (tape is not ejected).
- When you place this player near strong magnetic materials, it may affect image or voice poorly or damage recording.
- Do not spill volatile liquids like insect spray over the player. Do not leave rubber or plastic products in contact with the player for a long time. They will cause deterioration or paint peel-off.

Not in Use

- When the unit is not in use, be sure to remove the disc or tape and turn off the power.
- If you do not use the unit for a long period, remove batteries in REMOTE to prevent leakage.

- In case you don't use the unit for a long time, the unit may not function properly in the future. Turn on and use the player occasionally.

Moving

- Repack the unit as it was originally packed at the factory. Alternatively, pack this product with towel not to be damaged.
- Eject any videotape.

Cleaning

- Dust off dirt in cabinet or control panel part smoothly with a soft cloth.
- For heavy dirt, soak the cloth in a weak detergent solution, wring it well and wipe. Use a dry cloth to wipe it out.
- Follow instructions in using chemical cleaners.
- Do not use any type of solvent such as gasoline or benzene, as they may cause deterioration or paint peel-off.

Checking

- Video is a high precision device. To obtain a clear screen, we recommend regular inspection and maintenance every 1,000 hours of use by technical engineers.
- For checking, contact your dealer or your nearest service center.

Checking and Replacement of Antenna

- Antenna is subject to change in its direction or damage by wind and rain. For clean screen, contact and consult your nearest service center about checking and replacement.

In recording important screen

- Be sure to record the screen and check whether recording is performed properly. Poor signal and bad tape quality will affect the quality of your recording.

Copyright

- Do not use your recordings without permission of the copyright owner.

Tape and Disc Handling

Do not use any tape and disc as below. Damage of video head or cut/coiling of tape may cause failure.

- Tape with mold
 - Tape or disc stained with juice or attachments
 - Tape having breakage
 - Disassembled tape
 - Disc with severe scratch
- Moisture condensation may occur in tape. Moisture condensation damages the tape. Please use the tape after the moisture condensation is disappeared.
 - After use, store tape vertically in a case to prevent damage & loss to data.
 - Do not store in the following places.
 - High temperature and humidity
 - Subject to generation of mold
 - Much dirt or dust
 - Near strong magnetic materials such as speaker

Identification of Controls

Main body (front panel)

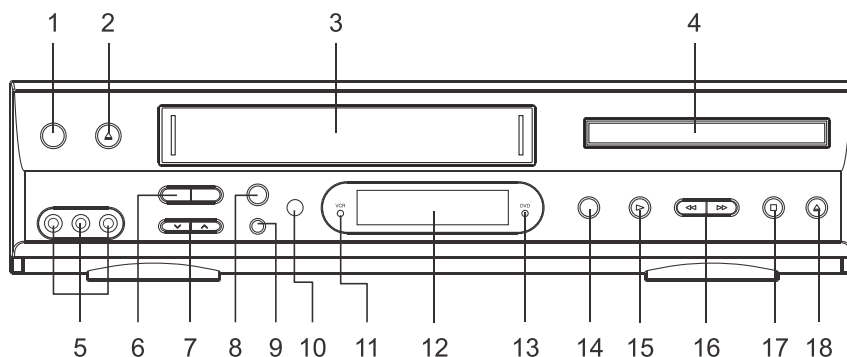

1. Standby/On button
Press to turn the VCR on or off.

NOTE: The Standby/On button is no function During OTR and Record mode.

2. Eject/VCR
Press to stop tape movement and eject a video cassette.
3. Cassette compartment
Insert a video cassette into this slot.
4. DVD tray
Open or close tray by pushing DVD open/close button, place a disc on the disc tray label side up.
5. Video/Line in/Audio in (L/R) (AV-F)
Attach the VCR's audio & video input at these terminals.
6. CLK/CNT
Press to change the channel.
7. Channel up/down
Press to change the channel.
8. VCR/DVD/Function
9. Record
Press to record the program currently airing on the channel. Press multiple times to process one-time-recording time options.
10. Remote sensor
This receiver receives a signal from your remote control.
11. VCR mode indicator
12. Display panel
Display system informations
13. DVD mode indicator
14. Pause/Step
15. Play (VCR/DVD)
Press to start playback, in VCR mode start to play VCR tape, in DVD mode start to play Disc.
16. Search (VCR/DVD)
Press (◀/▶) button to search rewind or forward the tape or DVD
17. Stop (VCR/DVD)
Stop playing the disc and tape.
18. Open/Close (DVD)
Use to open or close the tray.

Operation Display Window

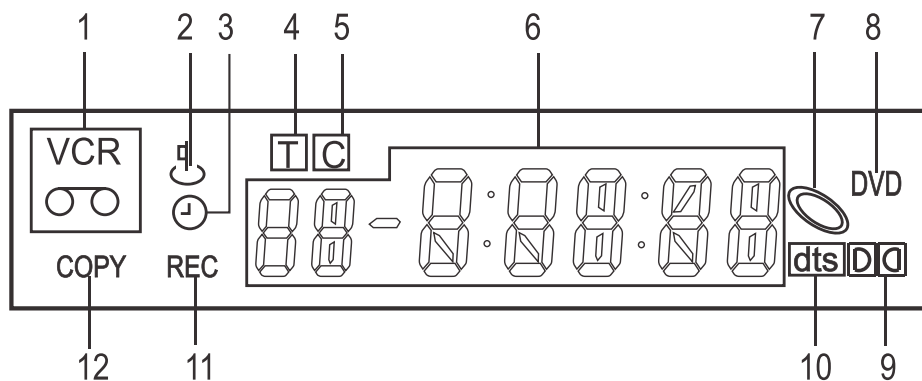

1. VCR Operation

2. Child (Lock)

3. TIMER REC display

- TIMER Recording,
- To be Timer-recorded,
- ☼: In Timer record state - will flash on/off indicating 'No tape' or 'Tape without tab'

4. Title

This is displayed in VCD and CD disc.

5. Chapter

This is displayed in DVD disc.

6. Time, Counter and Current Operation

POWER: Tray is opened

CLOSE: Tray is closed

LOAD: Disc is loaded

no DISC: There is no disc in tray

Error: Disc has some error

MENU: Menu screen is displayed

SETUP: Setup menu is displayed

ON: Power is ON

OFF: Power is OFF

7. Disc In Operation

8. DVD Disc Operation

9. Dolby Sound Indicator

10. dts Sound indicator

11. REC Indicator

12. Copying Indicator

Use to copy contents of disc into videotape.

Rear Panel

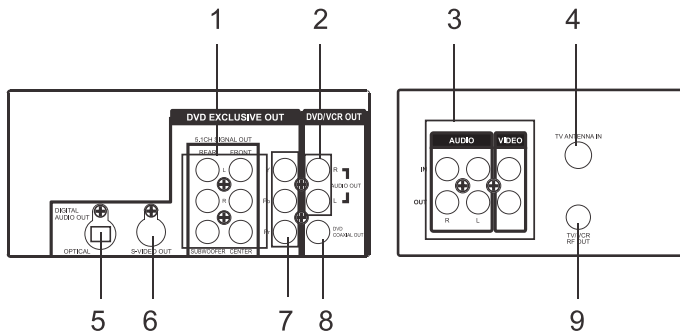

1. DVD 5.1 CH Audio Out
2. Audio Out (R/L)
3. Video/Audio RCA IN/OUT (AV)
4. TV Antenna In
5. DVD Digital Audio Out(Optical)
6. DVD S-Video Out
7. DVD Component Video Out (Green / Blue / Red)

Engineering note: Please check correct color on sockets. Y=Green(top) Blue(middle) Red(bottom)

8. DVD Digital Audio Out(Coaxial)
9. TV/VCR RF Out

Accessories



1. Remote

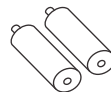

2. Batteries



3. RF wire



4. User manual



5. RCA cable

Remote Control

Remote

1. Display Button
2. Open/close Button (DVD) Eject (VCR)
3. +10 Button
4. SP/LP Button
5. Enter Button
6. Set up Button
7. Stop Button
8. Fast Backward Button
9. Fast Forward Button
10. PBC Button
11. Return Button
12. Root Button
13. Zoom Button
14. Angle Button
15. Audio Button
16. CLK Button
17. Subtitle Button
18. TV/AV Button
19. Standby/On Button

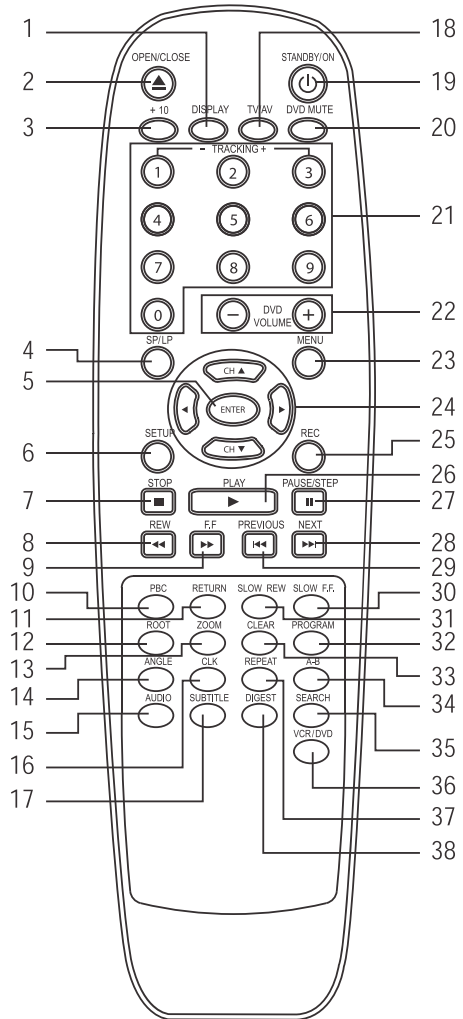

NOTE: The Standby/On switch is no function During OTR and Record mode.

20. DVD MUTE Button
21. Numeric Buttons (TRACKING)
22. DVD Volume Control Button
23. DVD Menu Button
24. Channel/Direction Buttons
(Up ▲ Down ▼ Left ◀ Right ▶)
25. REC Button
26. Play Button
27. Pause/STEP Button
28. Next Button
29. Previous Button
30. Slow F.F Button
31. Slow REW Button
32. Program Button
33. Clear Button
34. Repeat A-B Button
35. Search Button
36. VCR/DVD Select Button
37. Repeat Button
38. Digest Button

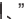

Child Lock!!!

Press the Standby/On [] button of the remote for about 8 seconds.

No buttons of front panel and remote can be operated now and Lock indicator ("  ") will be displayed on window display. To release child lock, press the power [] button of the remote control for about 8 seconds.

Instructions in Using Remote

- Operate REMOTE within 5m from the unit.
- Do not press 2 (two) buttons at the same time.
- Do not light up sending part of REMOTE.
- Do not keep in the place with much dust and humidity.

Setting Up Your Player

Connecting your TV thru Antenna and RCA cable (Recommended setup)

Option 1

- (1) Connect the AV cable lead from VCR "Audio/ Video Output" on the rear panel of the player to the TV AV In.
- (2) Change the TV to AV IN mode.

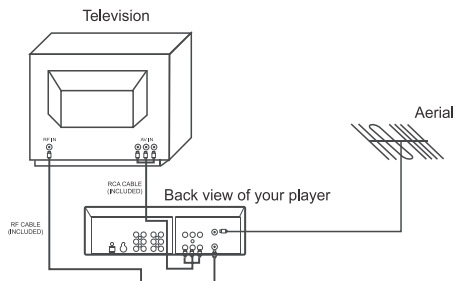

Connecting Your TV Through Antenna

- Before you start, unplug all the equipment from the mains supply.

Option 2

- (1) Insert the Aerial cable into the VCR "TV Antenna In".
- (2) Connect the RF cable from "VCR RF Out" into the TV RF In.
- (3) The TV stations will Re-search.

Please refer to the section of "TEST SIGNAL GENERATION MODE" on page 22

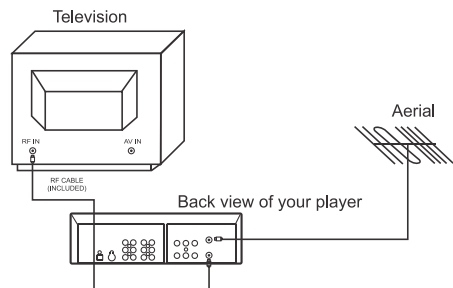

Setting Up Your Player

Connecting your player through extra equipment (satellite system)

- Before you start, unplug all the equipment from the mains supply.

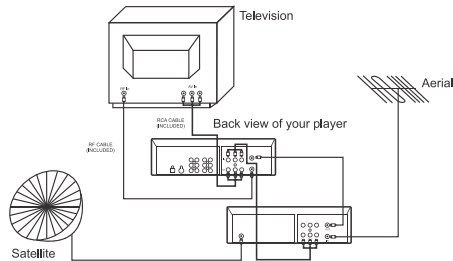

How to Connect Your Player to Another Player

- Before you start, unplug all the equipment from the mains supply.

How to Connect

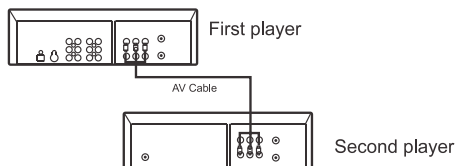

- 1) Insert the tape you wish to record on into the first player and press [TV/AV] until "AV" appears on the front display.
- 2) Insert the tape you wish to copy from into the second player. Press the [PLAY] button on the second player.
- 3) Press the [RECORD] button on the first player. The player will start recording.

How to Connect Your Player to a Camcorder

- Before you start, unplug all the equipment from the mains supply.

How to Connect

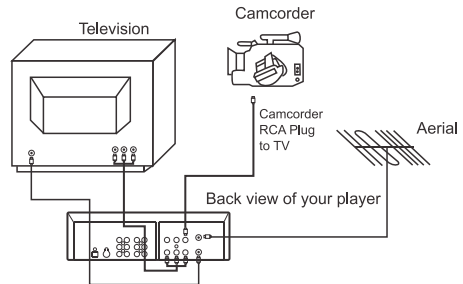

If you have connected your camcorder in this way, you can also connect a RCA lead from "AV" on the back panel of the player to the television. To use this function, you can also connect the camcorder by using a phono cable if your player has front input sockets. Check the front of your player for this connection.

Connecting Dolby Digital Amp with Digital Audio out Jack

How to Connect

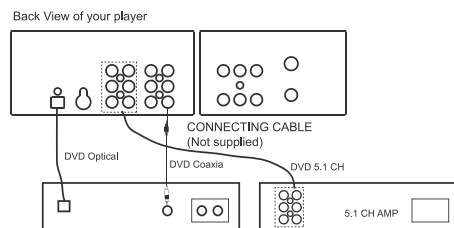

Home Theater Receiver with Dolby Digital decoding capability

AV RCA Connecting

How to connect

The product has the AV input, shown in the diagram below, you can connect other equipment. When connecting other equipment please refer to their manuals for further information.

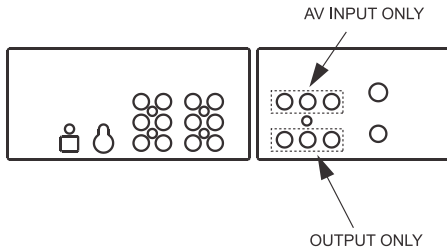

Recording from Other Equipment

Simple recording can be performed, ensure the equipment is turned on and is displaying the correct channel. Timer recording, set the video to perform a timed recording ensuring AV is selected as the channel to be recorded. Some equipment may have a timer which allows it to be powered on to the correct channel, if this feature is not available the other equipment should be left powered on.

Front AV

The product has front input sockets, it is possible to connect devices such as a camcorder to the video.

To watch a camcorder tape the video must be in AVF mode.

Recordings of this input are the same as described on pages 10-12.

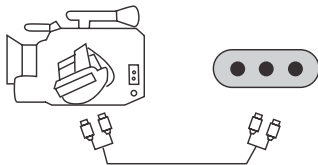

Auto Setting

(Only on the first time setup off the factory)

Option 1

Connecting your TV thru Antenna and RCA cable (Recommended setup) (please make sure that you connected your TV and VCR properly)

Select your TV to AV mode

Tuning the VCR on

- (1) Press Standby/On on the remote control. You can also press on the front panel.
- (2) Set the VCR/DVD to VCR mode by the remote control or front panel button.
- (3) VCR indicator light will be on in the panel.

Option 2

Connecting your TV thru Antenna

Turn on the TV

Turn the TV channel whichever channel you select when connecting thr VCR

- (1) Press Standby/On on the remote control. You can also press on the front panel.
- (2) Set the VCR/DVD to VCR mode by the remote control or front panel button.
- (3) VCR indicator light will be on in the panel.
- (4) Tune your TV to find the VCR channel, please refer to the section of "TEST SIGNAL GENERATION MODE" on page 22.

Option 3

Connecting your player through extra equipment (satellite system)

Select your TV to AV mode

Tuning the VCR on

- (1) Press Standby/On the remote control. You can also press on the front panel
- (2) Set the VCR/DVD to VCR mode by the remote control or front panel button
- (3) VCR indicator light will be on in the panel

1. Press the [▲ / ▼] buttons to select the desired country on the setup manu. And press the [ENTER] button to confirm the selected country. Then VCR will auto-search and setup all your channels automatically.
2. After the channel auto searching is completed, the "Please wait" screen will appear a while.
3. The auto searching is completed, the screen is change to "CLOCK SET". In case of setting the clock newly, press the [0-9] buttons as the following order:
hour -> minute -> day -> month -> year.
At that time, "--/--/----", this clock input guide will appear on the TV screen.
 - In case of correcting it, current date is displayed on the TV screen, then press the [▲ / ▼] buttons to move the current to the wanted position and input the new numbers.
 - The clock will work, although the VCR is in the clock setting state.
 - In the "year" display, press "04" will change to 2004. Likewise, press "99" will change to 2099.
4. The [ENTER] button is pressed to confirm the new clock. Press the [SETUP] button to leave the SETUP menu screen.

NOTE: This AUTO SETTING situation happens only on the first time setup off the factory. Should reset of clock or TV stations is needed, please refer to page 15 "MANUAL CLOCK SET" or page 22 "INSTALLATION"

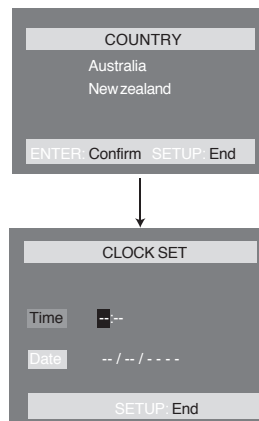

Setup Operation

1. Display Color

All lines have gray background and selected line have green background white characters.

2. Basic Operation

- (1) Press the [SETUP] button to display the SETUP menu on a TV screen.
- (2) Press the [▲ / ▼] buttons to select the desired function on the SETUP menu. And press the [ENTER] button to confirm the selected function.
- (3) Press the [SETUP] button to return to the SETUP menu at any time.
- (4) Press the [SETUP] button to leave the SETUP menu screen.

3. Manual Clock Set

- (1) Press the [SETUP] button to call the Main SETUP in TV mode.
- (2) Press the [▲ / ▼] buttons to select the line of "Clock Set" and press the [ENTER] button to confirm that.
- (3) In case of setting the clock newly, press the [0-9] buttons as the following order:
hour -> minute -> day -> month -> year.
At that time, "—/—/—", this clock input guide will appear on the TV screen.
 - In case of correcting it, current date is displayed on the TV screen, then press the [▲ / ▼] buttons to move the cursor to the wanted position and input the new numbers.
 - The clock will work, although the VCR is in the clock setting state.
 - In the "year" display, press "04" will change to 2004. Likewise, press "99" will change to 2099.
 - In the Clock Set mode, no data is inputted more than 60 seconds, the VCR goes to TV mode (real picture) from Clock Set mode automatically.
- (4) The [ENTER] button is pressed to confirm the new clock, the Main SETUP will appear after storing the changed data in VCR. And the [SETUP] button is pressed to interrupt before confirming the changed data and the main SETUP will appear without the data change.

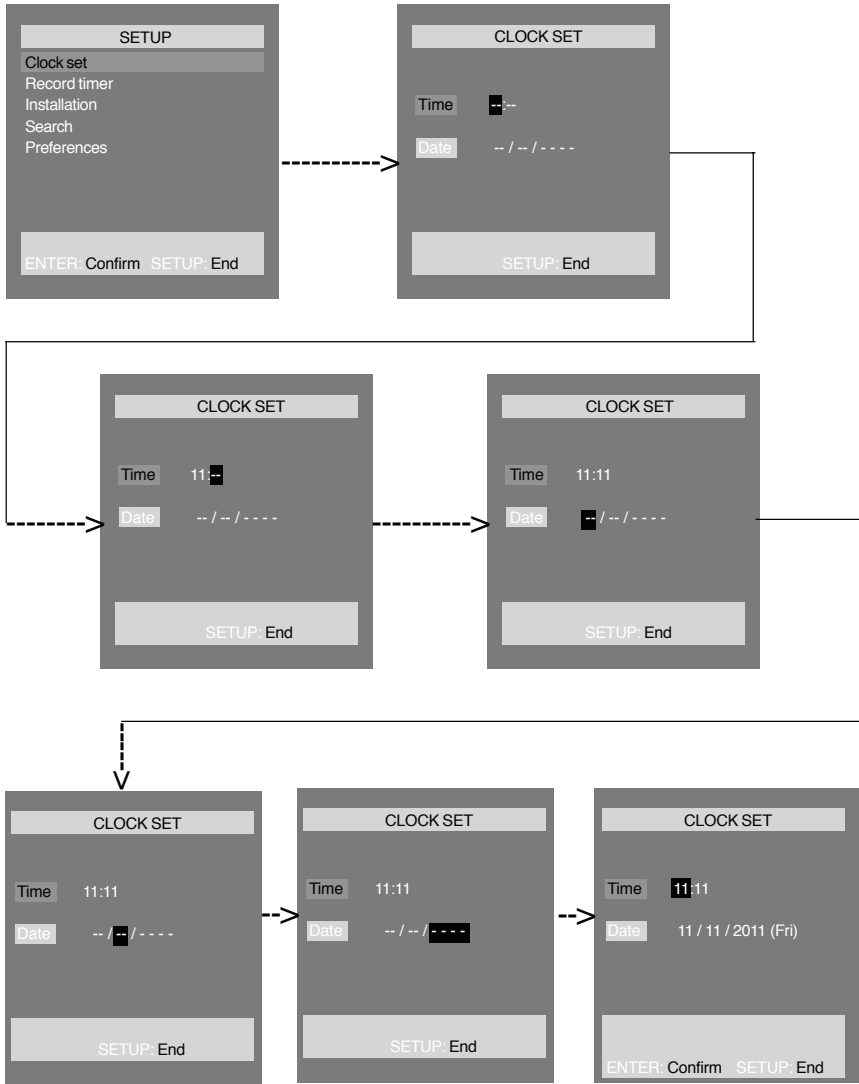

Record Timer

1. Recording Programming

1-1.MENU OPERATIONS

(1) Press the [SETUP] button to call the Setup Menu in TV state.

Press the [▲ / ▼] buttons to select the line of "Record Timer" and press the [ENTER] button to confirm that.

(2) At that time, the VCR will check whether there are some errors or not:

- If the clock has not been set, then it will change to "Clock Set" screen automatically.
- If the PRs have not been set, then it will change to "Installation" screen automatically.

If there is no error, (2) screen appears.

Press the [▲ / ▼] buttons to select the empty (not occupied) record timer program.

Press the [ENTER] button to confirm that.

(3) Press the [▲ / ▼] buttons to select the type of the wanted timer recording.

(4) The [ENTER] button is pressed to confirm that, the data input screen for the new timer programming will appear.

- ONCE (In the case of selecting the type to "Once")

(5) Press the [0-9] buttons to set a PR number or press the [◀ / ▶] buttons to select an external (AV). "PRs": To choice the recording signals from the own tuner, which is built-in VCR to tune and detect broadcasting signals.

(6) Press the [0-9] buttons in the following order: start time -> end time -> start date.

In initial state, the start date will be displayed a current date automatically.

Also, if the day or the month is changed at the start date, the day of the week will be changed too automatically, changed after inputting the day.

- DAILY(MON-FRI) [In the case of selecting the type to "DAILY(MON-FRI)"]

All the procedures of daily (Mon-Fri) recording are the same as "once timer recording".

- DAILY(MON-SAT) [In the case of selecting the type to "DAILY(MON-SAT)"]

All the procedures of daily (Mon-Sat) recording are the same as "once timer recording".

- DAILY(MON-SUN) [In the case of selecting the type to "DAILY(MON-SUN)"]

All the procedures of daily (Mon-Sun) recording are the same as "once timer recording".

- WEEKLY [In the case of selecting the type to "WEEKLY"]

All the procedures of daily (once a week) recording are the same as once timer recording.

Press the [▲ / ▼] buttons to select the tape speed and press the [◀ / ▶] button to input the next data.

Press the [ENTER] button at the screen to confirm that.

If the program overlaps with another one, which had already been programmed, the Error message will appear for 3 seconds and it will change to the screen for the "TIMER REVIEW" automatically.

If the program does not overlap, the Guide Message will appear for 3 seconds.

* ONCE

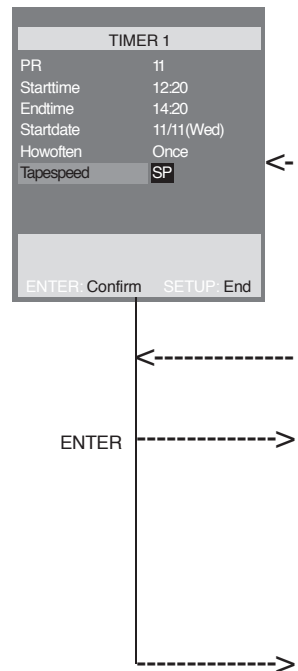
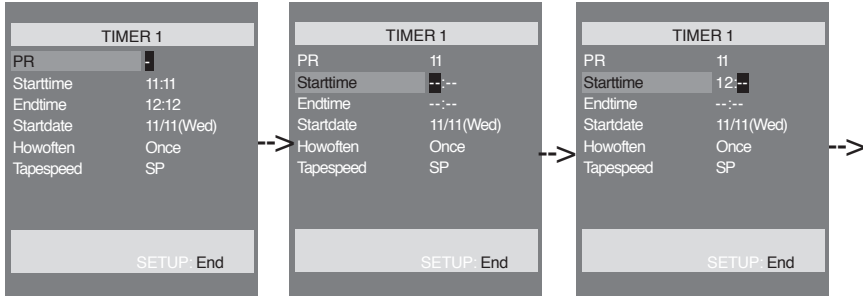

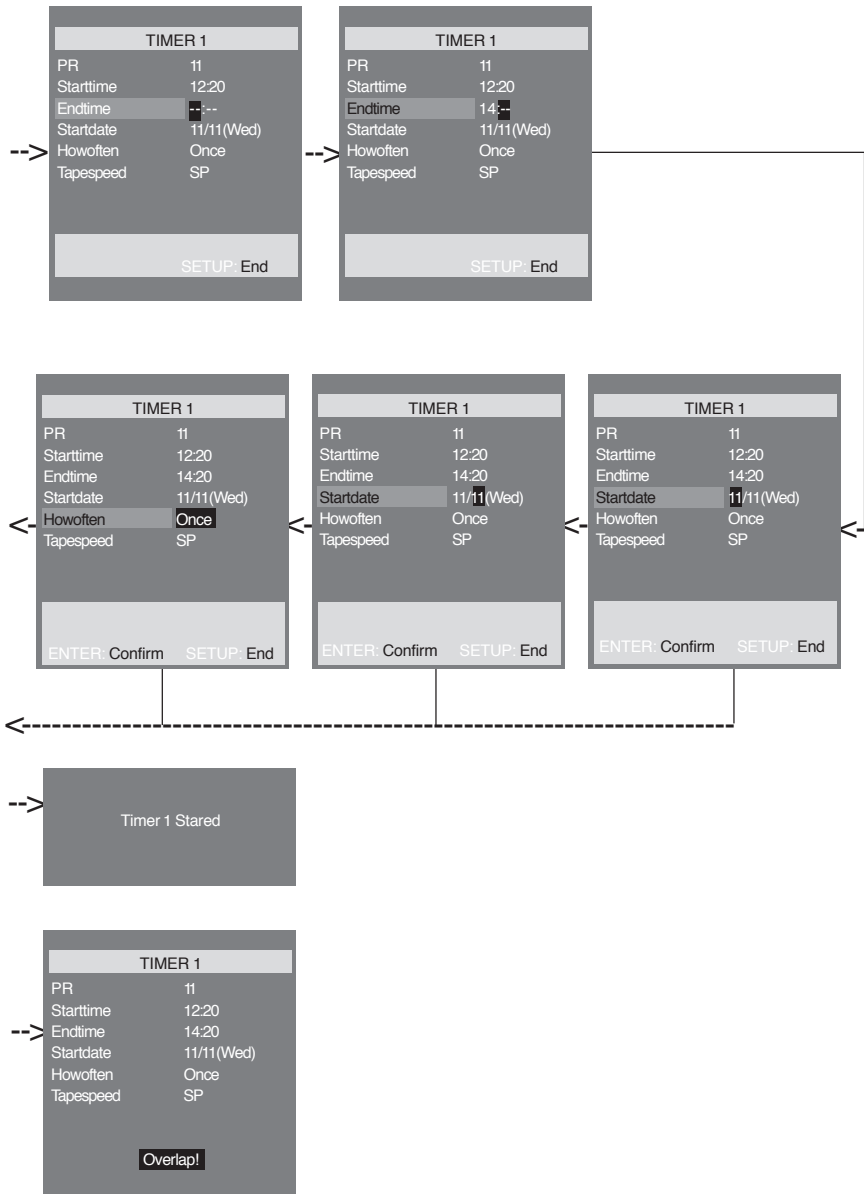

2. Timer Review (Erasure & Correction)

2-1.Erasure

(1) Press the [SETUP] button to call the SETUP menu in TV state or press the [PROGRAM] button.

Press the [▲ / ▼] buttons to select the line of "Record Timer" and press the [ENTER] button to confirm that.

(2) At that time, the VCR will check whether there are some errors or not:

- If the clock has not been set, then it will change to "Clock Set" screen automatically.
- If the PRs have not been set, then it will change to "Installation" screen automatically.

If there is no error, (2) screen appears.

Press the [▲ / ▼] buttons to select a erasing timer program.

The [ENTER] button is pressed to confirm that, the stored contents of the selected Timer program are displayed.

(3) The [CLEAR] button is pressed to erase.

2-2.Correction

(1) Press the [SETUP] button to call the SETUP menu in TV state or press the [PROGRAM] button.

Press the [▲ / ▼] buttons to select the line of "Record Timer" and press the [ENTER] button to confirm that.

(2) At that time, the VCR will check whether there are some errors or not:

- If the clock has not been set, it will change to "Clock Set" screen automatically.
- If the PRs have not been set, it will change to "Installation" screen automatically.
- If there is no error, (2) screen appears.

Press the [▲ / ▼] buttons to select a correcting record timer program.

The [ENTER] button is pressed to confirm that, the stored contents of selected Record Timer program are displayed on the TV screen.

(3) The [▲ / ▼] buttons are pressed to correct the record timer program, the OSD screen will be changed to the screen of (3).

(4) How to correct: See the NEW PROGRAMMING procedures. The next steps are same as the steps of New Programming.

(5) To correct the other record timer programs, repeat the procedure from the step (1) to step (4).

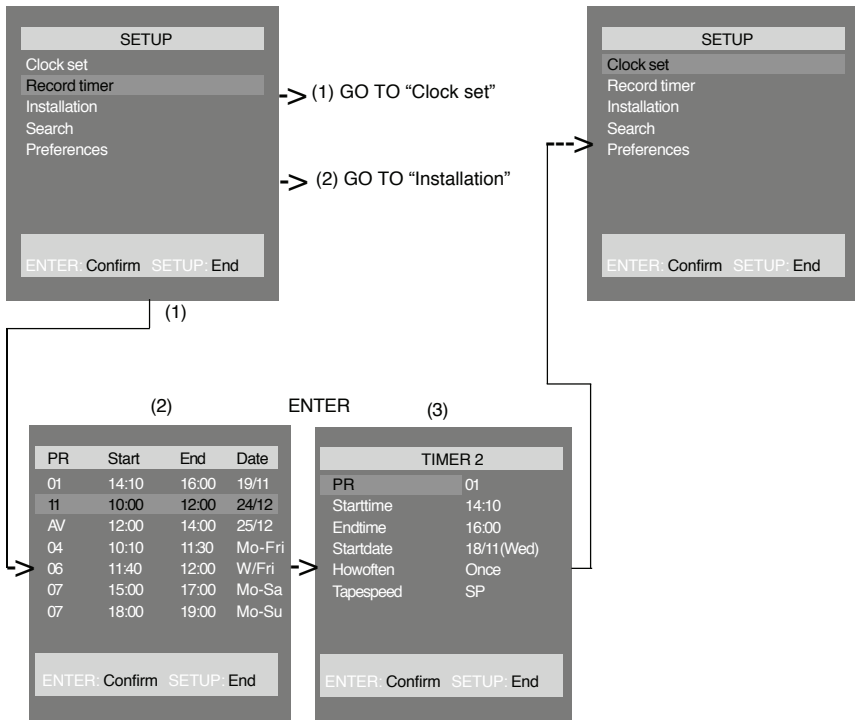

Installation

1. Auto Installation

- (1) Press the [SETUP] button to display the Setup Menu screen in TV mode.

Press the [▲ / ▼] buttons to select the line of "Installation" and press the [ENTER] button to confirm that.

- (2) Press the [▲ / ▼] buttons to select the line of "Auto Installation" and press the [ENTER] button to confirm that.
- (3) After the channel searching is completed, the "Please wait" screen will appear a while.
- (4) If other stations are positioned on near the current RF OUTPUT PR, the guide message appears automatically.

The VCR recommends the optimal RF OUTPUT PR number automatically.

Press the [ENTER] button to confirm the recommended PR.

If not, press the [0-9] button to change the recommended PR.

And then, press the [ENTER] button to confirm. If you don't want to exchange, press the [SETUP] button. (Please refer to the section of "RF OUTPUT SETUP" on page 25)

- (5) The Clock Set screen automatically appears for manual clock set.

How to set the clock: See the CLOCK SET procedures.

- (6) After completing the Auto Searching procedures, the "Manual Installation" screen appears. Whenever a channel is searched and memorized, the PR number will be increased from 01 to 99 on both LED and OSD.

During channel searching, you can press the [SETUP] button to interrupt it, then the VCR goes to the Real Picture.

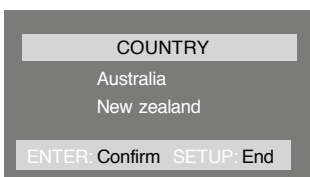

This function is for you tune your TV to find the VCR channel.

1. Test Signal Generation Mode

- (1) If you use the TV Aerial RF input for the VCR.

In power-on state, press the [ENTER] button for 5 seconds to go to the test signal generation mode.

If press the [ENTER] button for 5 seconds again or press the [SETUP] button, the real picture will appear.

- (2) Tune the TV till it gets the clear test signal, which has the black and white pattern (2 white bar pattern).

Check whether all the received stations have bad picture quality due to the interference between the modulated signal and through signals (general broadcasting signal).

If there is, adjust the RF output channel on LED or SETUP operation.

- On LED: "RF 36" is displayed ("RF" is blinking) and it can be adjusted directly by pressing [0-9] buttons on remote control.
- On SETUP: See the RF OUTPUT SET procedures.

2. Manual Installation

This function is for you to search new stations and add into the VCR.

- (1) Press the [SETUP] button to display the Setup Menu screen in TV state.

Press the [▲ / ▼] buttons to select the line of "Installation" and press the [ENTER] button to confirm that.

- (2) Press the [▲ / ▼] buttons to select the line of "Manual Installation" and press the [ENTER] button to confirm that.

Press the [▲ / ▼] buttons to select the re-searching channel and press the [ENTER] button to confirm that.

- Reception - The list is: AERIAL, CABLE If aerial is selected, CH is written before the channel number. If cable is selected, CC is written before the channel number. If the user changes the reception: "AUTO SEARCH" is set to "--"

- Auto search -The user can either launch the auto search using right and left keys, or directly enter the channel number. Auto search moves automatically from last cable to first antenna channel found and vice versa.
- Fine Tuning-The user can fine tuning using right and left keys.

3. Organizer

This function is for you to edit the name of channel and delete the channel.

Press SETUP button, goto Installation.

3-1.Name

- Creating of New Names :

Press the [▲ / ▼] buttons to select the wanted characters. (the [◀ / ▶] button will be used to move the position of digit).

The [ENTER] button is pressed to confirm that.

To make and memorize the new names for the other channels, repeat the procedure.

3-2. Delete PR

(1) Press the [SETUP] button to call the Main SETUP in TV mode.

Press the [▲ / ▼] buttons to select the line of "Installation" and press the [ENTER] button to confirm that.

(2) Press the [▲ / ▼] buttons to select the line of "Organizer" and press the [ENTER] button to confirm that.

(3) Press the [▲ / ▼] buttons to select the Delete PR..

(4) The [ENTER] button is pressed to confirm that. The [SETUP] button is pressed to interrupt before pressing the [ENTER] button , the real picture will appear without storing the data.

(5) To erase the another channel, repeat the procedure from the step (3) to step (4).

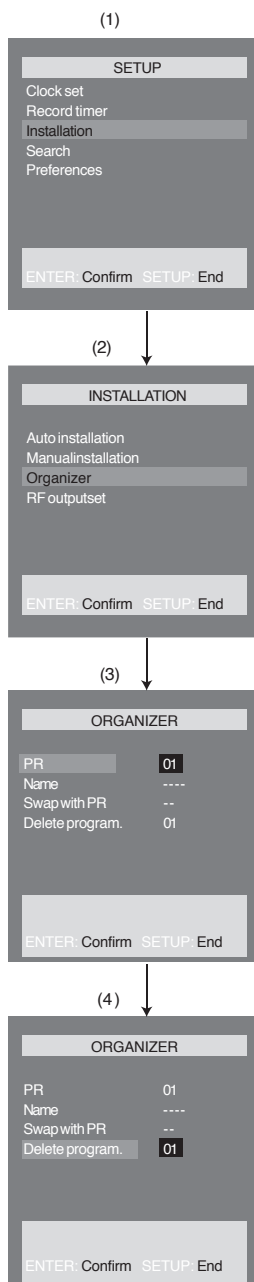

3-3. Swap With PR

(1) Press the [SETUP] button to call the Setup Menu in TV mode.

Press the [▲/▼] buttons to select the line of "Installation" and press the [ENTER] button to confirm that.

(2) Press the [▲/▼] buttons to select the line of "organizer" and press the [ENTER] button to confirm that.

(3) Press the [◀/▶] buttons to select the aligning channel and press the [ENTER] button to confirm that.

(4) The [◀/▶] buttons are pressed to move the selected PR.

The changed position of the PR number will be memorized whenever the PR is moved by pressing the [◀/▶] buttons.

(5) Press the [ENTER] button to confirm that or the [SETUP] button to finish the alignment without data change.

(6) To align the other channels, repeat the procedure from the step (3) to step (5).

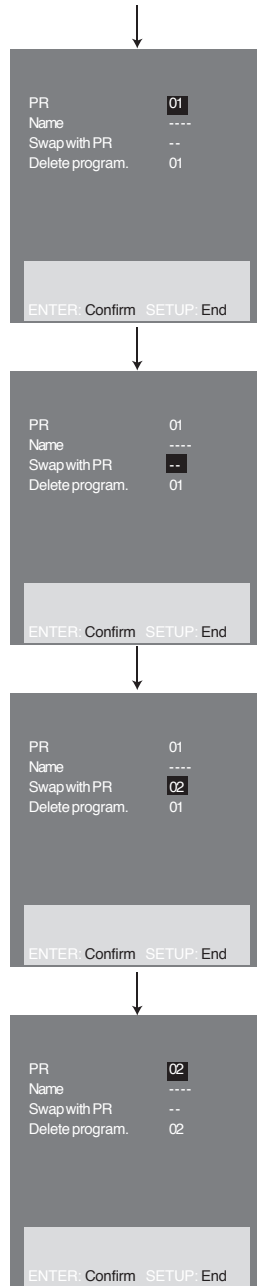
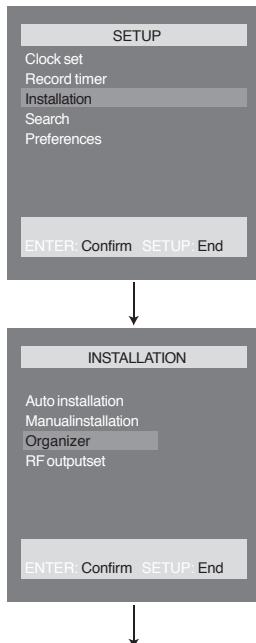

4. RF Output Set

In case, your VCR RF output interface the TV channel output, your need to change the RF setup as per following steps.

- (1) Press the [SETUP] button to call the Setup Menu in TV mode.

Press the [▲ / ▼] buttons to select the line of "Installation" and press the [ENTER] button to confirm that.

- (2) Press the [▲ / ▼] buttons to select the line of "RF Output Set" and press the [ENTER] button to confirm that.

- (3) The initial channel number is CH36 and it can be adjusted from CH21 to CH69.

Press the [0-9] buttons to setup the desired PR numbers.

And the [SETUP] button is pressed to interrupt before confirming the new data, the Main SETUP will appear without the data change.

Note: The 36 or BG means will blinks till 36 or BG input in the data.

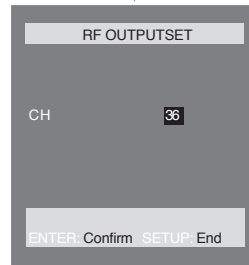
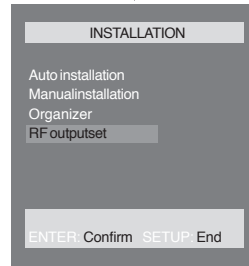
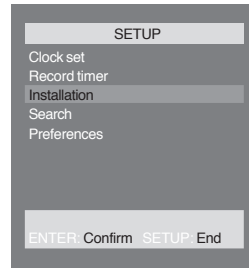

Preferences

1. OSD On/Off. (OSD - On Screen Display)

The OSD On/Off control is set to "ON" mode before shipping and it can be changed to "OFF" mode.

- (1) Press the [SETUP] button to call the Main SETUP screen. Press the [▲/▼] buttons to select the line of "Preference" and press the [ENTER] button to confirm that.
- (2) Press the [▲/▼] buttons to select the line of "OSD" and press the [ENTER] button to select.

Search

1. Go to Zero

- (1) Press the [SETUP] button to call the Main SETUP screen in [cassette-in] state. Press the [▲/▼] buttons to select the line of "Search" and press the [ENTER] button to confirm that.
- (2) Press the [▲/▼] buttons to select the line of "GO TO ZERO" and press the [ENTER] button to confirm that.

Then, the sub-SETUP picture will disappear and the VCR will wind a tape to the position, "0:00:00" and will play automatically. Also, the OSD picture will disappear after 3 seconds from stopping the wind.

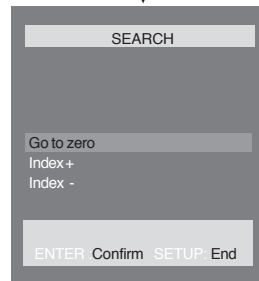
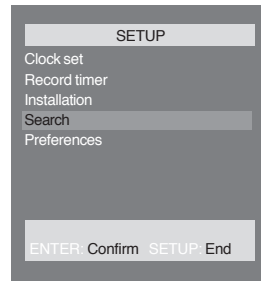

Super-Imposed (3)

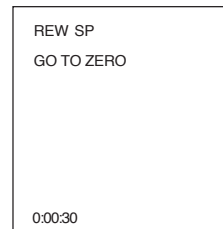

or

Super-Imposed

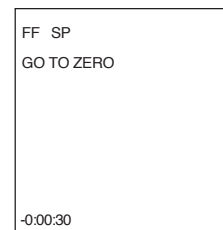

2. Index +

Searching a cassette tape for programs (indexing)

When you record a programs, the VCR places an index mark at the start of the recording.

To search for an index mark:

- (1) Press the [SETUP] button to call the Main SETUP screen in [cassette-in] state.

Press the [▲ / ▼] buttons to select the line of "Search" and press the [ENTER] button to confirm that.

- (2) Press the [▲ / ▼] buttons to select the line of "Index +" and press the [ENTER] button to confirm that.

Then, the sub-menu picture will disappear and the VCR will search the next biss mark, and if it find biss mark, then the Play back picture will appear automatically.

And this process will be repeated continuously. If you want stop this process then press the key related to the tape function. (ex: stop, play, ff, rew....)

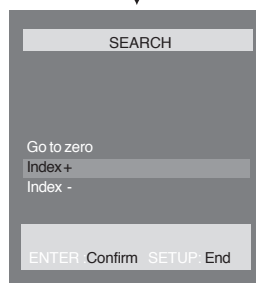

Super-Imposed

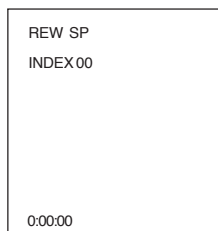

After ↓ 3 Sec
Real picture



3. Index-

(1) Press the [SETUP] button to call the Main SETUP screen in [cassette-in] state.

Press the [▲ / ▼] buttons to select the line of "Search" and press the [ENTER] button to confirm that.

(2) Press the [▲ / ▼] buttons to select the line of "Index -" and press the [ENTER] button to confirm that.

Then, the sub-menu picture will disappear and the VCR will search the previous BISS mark, and if it find biss mark, then the Play back picture will appear automatically.

And this process will be repeated continuously. If you want stop this process then press the key related to the tape function. (ex: stop, play, ff, rew....)

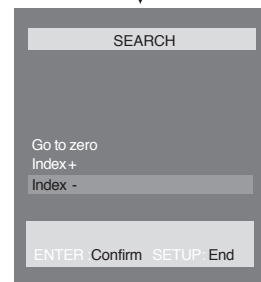
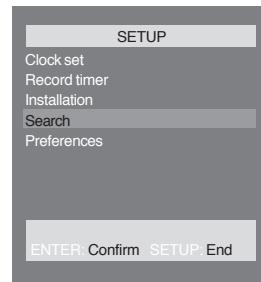

Super-Imposed

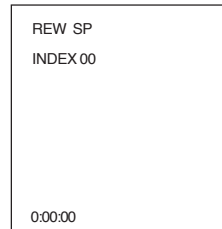

After ↓ 3 Sec

Real picture

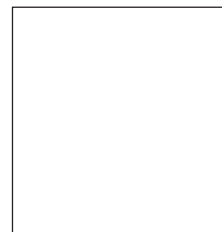

4. VISS (VHS Index Search System)

Remarks : Subtitle after the point 4 diagrams.

(1) Under the following conditions, VISS can be executed.

- Power On
- Cassette In
- Except for recording mode
- Except for performing a Timer Programming
- Except for channel setting

(2) The index marks are automatically recorded on the tape at the recording start time. It is impossible to record and erase the index marks at any time.

(3) Press the [INDEX+/-] buttons, the VCR will wind (fast forward or rewind) a tape and play the first part for 5 seconds whenever the index mark is found.

After 5 seconds it will wind (fast forward OR rewind) again until it reaches the next index mark.

If press the [PLAY] button during the temporary playback (within 5 seconds), the VCR will go to normal playback mode.

Press the [STOP] button to stop the VISS operation.

(4) During the operation of VISS, the mode displayed contents are as follow:

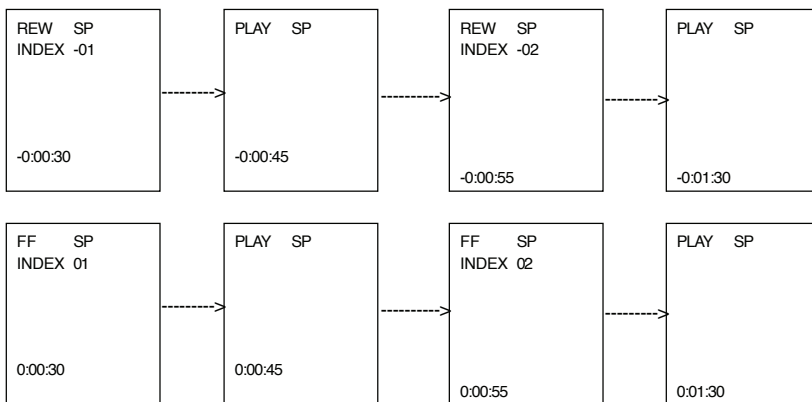

Remarks:

- If two recordings overlap, the index mark for the second program will be erased. Therefore, when you use the index feature to find the second program, the VCR will skip over it.
- If you record multiple programs in one recording session, the VCR will only find the index mark that was placed on the video cassette tape when the recording session began.

Some index marks that may be missed by the VCR:

- A mark too close to your location on the tape.
- The mark of the beginning of a recorded segment of the minutes or less.
- The first index mark on the tape when you start at the beginning of the tape.

Special Playback/ Picture Search

1. Variable Slow

- (1) During playback mode, press the [SLOW] button once to see the slow picture.

Whenever the [SLOW] button is pressed in slow mode, the slow speed will be changed:
1/15 -> 1/10 -> 1/5 -> 1/30 -> 1/25 -> 1/20 -> 1/15 ->

And the VCR goes to playback mode automatically, if the slow mode exceeds 5 minutes without any mode changes.

- (2) Press the [PLAY] button to switch it back to normal playback mode.

2. Pause / Still / Frame Advance

- (1) During playback mode, press the [PAUSE] button once to see the still picture.

Whenever the [PAUSE] button is pressed in still mode, the picture will advance frame by frame.

The still mode is automatically changed to playback mode when this mode is continued for more than 5 minutes without any mode changes.

- (2) Press the [PAUSE] button to switch it back to normal playback mode.

3. Two Step Picture Search

3-1.Cue

- (1) During playback mode, press the [FFORWARD] button once, VCR will search the picture forward: SP (x3), LP (x5).
- (2) Press the [F/FORWARD] button again, the tape will advance more rapidly. : SP (x7), LP (x15)

The cue mode is automatically changed to playback mode, when this mode is continued for more than 5 minutes without any mode changes.

- (3) Press the [PLAY] button to switch it back to normal playback mode.

3-2.review

- (1) During playback mode, press the [REW] button once, VCR will search the picture backward: SP (x3), LP (x5).
- (2) Press the [REW] button again, the tape will advance more rapidly. : SP (x7), LP (x15)

The review mode is automatically changed to playback mode, when this mode is continued for more than 5 minutes without any mode changes.

- (3) Press the [PLAY] button to switch it back to normal playback mode.

Picture Adjustment

1. Tracking

1-1. Auto Tracking

- (1) Under the following cases, the auto tracking operation is performed automatically.
 - When a pre-recorded cassette tape is inserted and is played back.
 - When the playback speed is changed during continuous played back.
 - When signal is detected again after the signal temporarily disappeared during continuous playback.
 - When the cassette tape, which has a signal, is playedback firstly after power on.
 - When the cassette tape, which has a signal, is playedback firstly after recording.

- (2) During auto tracking, if press the [STOP] button, the auto tracking operation will be stopped.

However, if press the [PLAY] button again, the auto tracking will be performed again.

1-2. Manual Tracking

- (1) In playback mode, press the [1] or [3] buttons to adjust tracking manually.

But, unfortunately, the optimal tracking position can be recognized by TV screen only because there is no display for this operation.

(2) In special playback mode, tracking data is obtained in slow mode.

2. V-LOCK Control

In still mode, press the [▲/▼] buttons to adjust V-LOCK.

But, the optimal V-LOCK position, which has no picture movement in still mode, can be recognized by TV screen only because there is no display for this operation.

Operating a Tape Mode

When the VCR operates a tape, the tape mode display, the tape speed indicator and the tape counter will be displayed.

When the VCR playbacks a Hi-Fi tape, the detected conditions are displayed on TV screen for 3 sec and be changed by pressing the [AUDIO] button manually.

(1) In the case of playingback a Monaural tape:

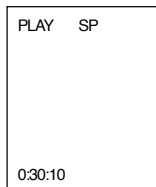

(2) In the case of playingback a Hi-Fi tape:

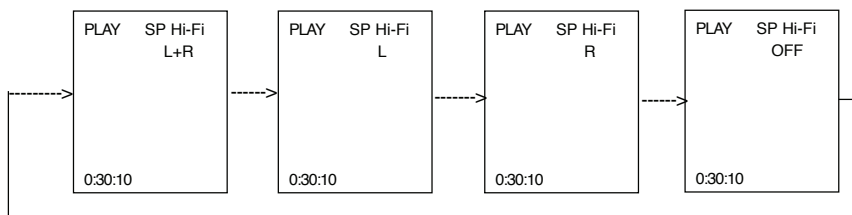

Front Display (Array)

Synopsis

1. TAPE running mode

The tape running displays (PLAY, FF, REW,) appear.

2. TV tuning mode

The PR number appears for 3 seconds and it will be changed to the clock automatically.

The Other Operations

1. Child Lock

In power-off state, if press the [STANDBY/ON] button for 5 seconds sequentially, the VCR will switch to power-on state, and then will go to the child lock mode.

In power-on state, If press the [STANDBY/ON] button for 5 seconds sequentially, the VCR will switch to power-off state, and then will go to the child lock mode.

In child lock mode, no keys can be operated and LOCK INDICATOR ("LOCK") will be displayed on LED display.

And if press the [POWER] button for 5 seconds sequentially again, the lock mode will be released, and then will go to power on mode automatically.

2. Auto Power Off

No signal is continuously detected for more than 5 minutes in RF (PR, Antenna) mode, the VCR goes to power-off mode automatically.

3 Select the External Line (AV)

There are 3 cases. It is changed by toggling.

- Press the [AV] button.
----->AV ----->AVF----->PR01(last tuned PR)
- Press the [▲ / ▼] button.
----->AV ----->AVF----->PR01(last tuned PR)
- Input the [00].
----->AV ----->AVF----->PR01(last tuned PR)

VCR Playback

1. Press [⏻] button to power on.

Press [VCR] button of remote control to change into VCR mode.

2. Insert the desired tape.
3. If you want to playback it, press [PLAY] button.

When the operational picture status is flickering or poor, adjust with [▲/▼] button.

Recording

To Record With VCR

1. Press [] button to power on.
 - Press [VCR/DVD] button of remote control to change into VCR mode.
 - Power on TV and select CH36, or press [INPUT] button of TV set to select External Input mode.
2. Insert a recordable tape.
 - Insert a tape with recording tab.
3. With [CHANNEL], [NUMBER] button, select the desired broadcasting channel or external input unit to record.
4. Select the desired speed (SP or LP) button.
5. Press [REC] button.
 - Then, it starts recording.
6. If you want to pause recording, press [PAUSE] button.
 - After pressing [PAUSE] button, if the pause status continues for five minutes, the recording is released automatically.
7. To exit recording, press [STOP] button.

To Enjoy Another TV channel or DVD during recording

If you want to playback DVD during recording with video, insert a DVD disc.

- Place the desired DVD disc on DVD tray, press [VCR/DVD] button to DVD mode and press [PLAY] button. Then, you can watch DVD.

To Copy From DVD To Videotape

1. Insert the desired DVD disc and press [PLAY] button.
 - When it is a DVD disc with copy protect function, you can't copy it.
2. Insert a recordable tape.
3. Press [REC] button on the front panel.
 - DVD plays and VCR starts recording.
4. To exit copy, press [■] button.

To VCR recording pause mode, Press [REC] button once.

This product incorporates copyright protection technology that is protected by method claims of certain U.S patents and other intellectual property rights owned by Macrovision Corporation and other right owners Use of this copyright protection technology must be authorized by Macrovision Corporation, and is intended for home and other limited viewing uses only unless otherwise authorized by Macrovision Corporation. Reverse engineering or disassembly is prohibited.

One Touch Timer Recording (OTR)

When your urgent business happens suddenly in watching TV or you want to record the current TV program for the desired time, follow the procedures below.

1. First, follow the steps 1 to 4 in "Recording With VCR".

2. Press [REC] button as much as you want.

- See the "Recording Times Table" below.

Button Press Times

- Operational Status

Once

- Continuous recording until you press STOP button

Twice

- Recording for thirty minutes from current time

3 (times)

- Recording for one hour

5 (times)

- Recording for one hour and thirty minutes

6 (times)

- Recording for two hours and thirty minutes

7 (times)

- Recording for three hours

8 (times)

- Recording for three hours and thirty minutes

9 (times)

- Recording for four hours

10 (times)

- Recording to the status of Once Press

3. To stop Recording mode, press [STOP] button more than 8 seconds.

About VCR

Video Head Cleaning

The video heads enable the VCR to read video information pictures from the tape during playback. In the unlikely event that the heads become clogged with dirt video playback will be impossible. This can easily be determined during playback of a known good tape, there is good sound, but the picture is extremely snowy. If this is the case, have the video cassette recorder checked by qualified service personnel.

NOTES:

During normal operation of the VCR, the video and audio heads can accumulate dirt over a period of time, especially when using an old or poor quality tape. When the heads are dirty, the picture can get snowy and the tracking control will have little or no effect. If this condition occurs, head cleaning cartridges may take care of the problem and restore normal picture. We recommend that head cleaning cartridges be used sparingly since they are very abrasive and can damage the video heads during prolonged use. If the problem is not resolved with the head cleaning cartridge then the unit needs to be checked by a qualified service personnel.

Erasure Protection

Video cassettes are equipped with a safety tab to prevent accidental erasure. When the tab is removed, recording can not be performed.

To Prevent Accidental Erasure

- After recording, break off the safety tab with a screwdriver if you don't want to record over the tape.

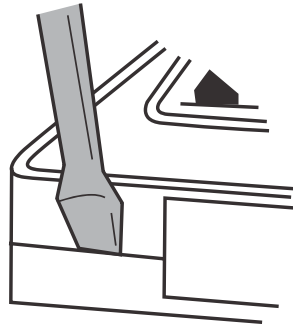

To Record Again

- Cover the hold with cellophane tape.

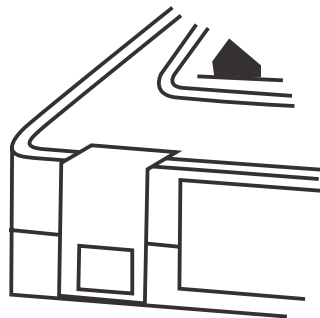

What Is Dew Condensation Symptom?

If a VCR is moved from a cool place to a warm and damp place or a place facing a direct cool wind from air-conditioner...and others, temperature varies sharply, which makes dew on head drums of VCR.

If Dew Condensation Occurs,

1. First, turn it on for one or two hours before using it.
2. Do not use it because it may develop troubles of a VCR or videotape.

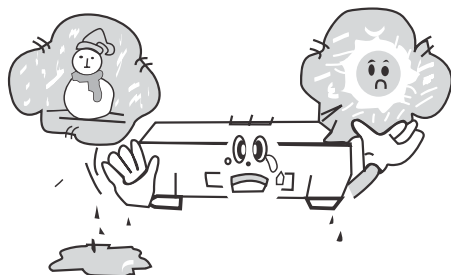

DVD Player Operation

Basic Operation

1. Press "VCR/DVD" button on the unit or press the VCR/DVD button on the remote handset to turn on DVD.
2. Press "OPEN / CLOSE" button to load disc in disc tray.
3. Press "OPEN / CLOSE" button to close the tray.
 - Hold the disc without touching either of its surfaces, position it with the printed title side facing up.

Play Discs

1. Press the OPEN / CLOSE Button on the front panel and load the Disc on the tray.

The label side should be facing upwards. For a Double-sided DVD Disc, put the disc with label A/1 up.

2. Press the OPEN/CLOSE button again to close the tray and the disc will be loaded.

3. The Disc will be played automatically.
 - If it is a DVD disc, it will show the Menu/ Title Page on the screen.
 - If it is a CD, it will play the first track directly.
4. Press the STOP Button if you want to stop the Disc playback You can resume playback by pressing the PLAY button and it will start at the location where you have pressed stopped (Resume Play).
5. Press the STOP Button twice to have the Disc really stopped.

|| (PAUSE) / STEP

This function is applicable for DVD and CD audio.

- For DVD, the picture will become static.
 - For CD audio, it will become silent.
1. Press the (||) Button will cause the player to enter PAUSE/STEP mode.
 2. Press the PLAY Button again will resume to Play State.

DVD Setup Mode

- Setup Mode provides the menu for the configuration of TV DISPLAY Mode, OSD LANGUAGE mode, DOLBY Mode, AUDIO Mode, PARENTAL Mode, PASSWORD, etc.
- Item selection in the SETUP menu is done by using the Direction button and the ENTER button.
- To exit the SETUP Mode to press the SETUP button again.
- The initial password for PARENTAL Mode is set at 1379.

Note: To setup the TV display mode must be in stop mode.

DVD Player Operation

Set Menu Items:

Press the SETUP Button on the remote controller. The following menu will be shown:

1. GENERAL SETUP

TV DISPLAY

- Normal/PS

This is selected when the DVD player is connected to a normal TV. Wide-screen images are shown on the screen, but with some parts cut automatically.

- Normal/LB

This is selected when the player is connected to a normal TV. Wide-screen images are shown on the screen, with black belt on the top and bottom.

- Wide

This is selected when the player is connected to a wide-screen TV.

Angle Mark

This only works when there is an angle mark on the disc. Select On, the screen shows the mark when playing DVD.

- On
- Off

OSD Language





This is used to select the OSD language.

- English
- French
- German
- Italian
- Dutch

Captions

This option can show or hide the captions.

- On (Show captions)
- Off (Hide captions)

    	
.. General Setup Page ..	
TV Display	PS
Angle Mark	On
OSD Lang	ENG
Captions	On
Screen Saver	Off
Go To General Setup Page	

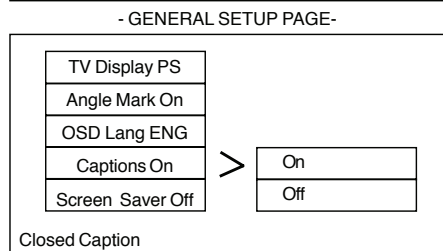
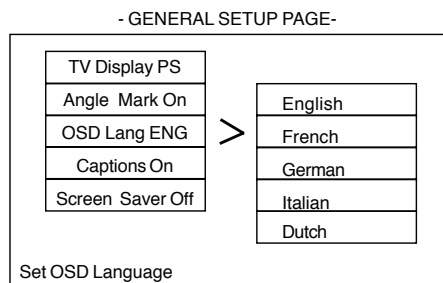
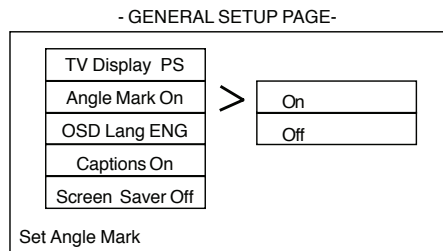
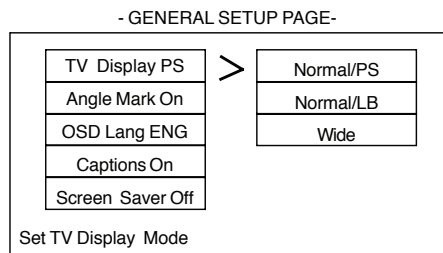

Screen Saver

Start the screen saver, the screen saver image appears when the player stops or the image is frozen for a few minutes. This saver can keep the screen from being damaged.

- On (Start the screen saver).
- Off (Remote the screen saver).
- Back to the feature bar, press ◀ key

2. AUDIO SETUP

When AUDIO SETUP option is selected, the following menu will be shown.

Speaker Setup

Downmix

- LT/RT

A disc recorded multi channel soundtrack, the output signal will be incorporated to left and right channel.

- **STEREO**

A disc recorded multi channel soundtrack, the output signal will be incorporated to stereo.

- **OFF**

Disable DOWNMIX.

(If you connect this player to 5.1CH external Amp, please turn it to this mode.)

Front Speaker

User can setup the front speakers.

- LARGE
- SMALL

They are for 5.1 Channel speaker output only.

Center Speaker

User can setup the center speakers.

The option is available when DOWNMIX is off.





- LARGE
- SMALL
- OFF

They are for 5.1 Channel speaker output only.

- GENERAL SETUP PAGE-

TV Display PS	
Angle Mark On	
OSD Lang ENG	
Captions On	
Screen Saver Off	>
	On
	Off

Screen Saver

    
.. Audio Setup Page ..
Speaker Setup Dolby Digital Setup
Go To Audio Setup Page

- SPEAKER SETUP PAGE-

Downmix STR	>	LT/RT
Front Speaker LRG		Stereo
Center Speaker SML		Off
Rear Speaker SML		
Subwoofer On		

Set Downmix Mode

- SPEAKER SETUP PAGE-

Downmix STR	>	Large
Front Speaker LRG		Small
Center Speaker SML		
Rear Speaker SML		
Subwoofer On		

Setup Front Speaker

- SPEAKER SETUP PAGE-

Downmix STR	>	Large
Front Speaker LRG		Small
Center Speaker SML		Off
Rear Speaker SML		
Subwoofer On		

Set up Center Speaker

Rear Speaker

User can setup the rear speakers. The option is available when DOWNMIX is off.

- LARGE
- SMALL
- OFF

They are for 5.1 Channel speaker output only.

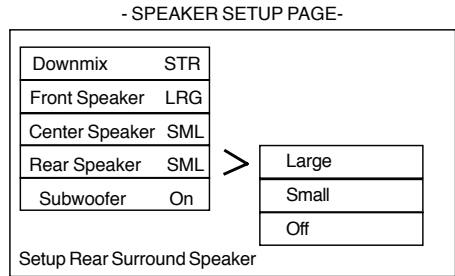

Subwoofer

User can turn on/off the subwoofer through this option.

- ON
- OFF

They are for 5.1 Channel speaker output only.

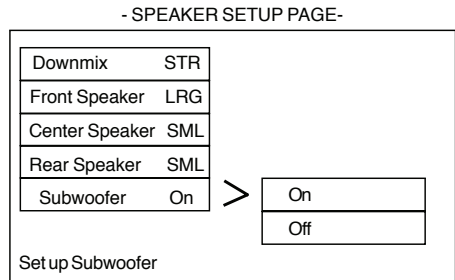

Dynamic

This option is used to set the compression ratio in order to control the sound (volume) contrast.

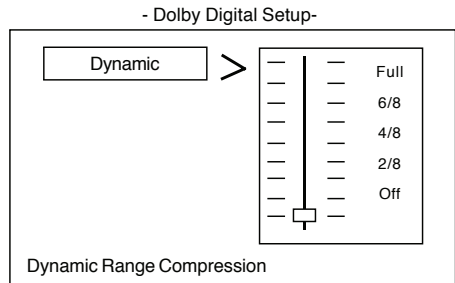

3. Video Setup

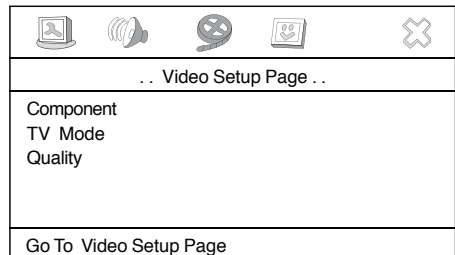

Component

User can set the S-Video or YUV video output.

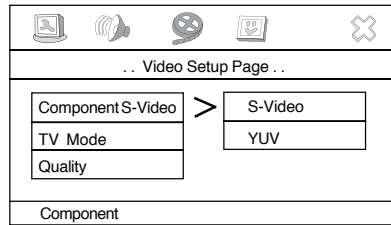

TV Mode

In YUV video mode, user can select Interlace or Progressive scan mode.

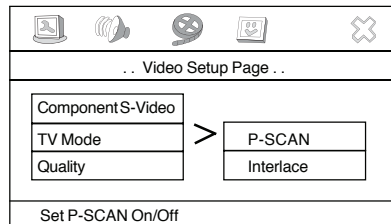

Sharpness

User can set the level of sharpness for the image displayed. There are three different levels.

- HIGH
- MEDIUM
- LOW

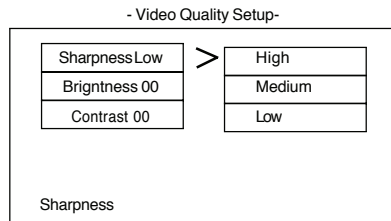

Brightness

User can set the level of brightness for the image displayed. It is ranged from -20 to 20.

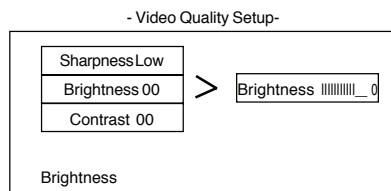

Contrast

User can set the level of contrast for the image displayed. It is ranged from -16 to 16.

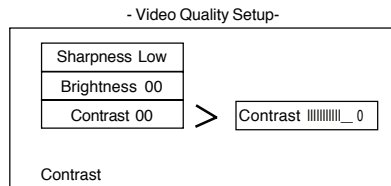

4. Preference Setup

(Under in DVD Stop mode)

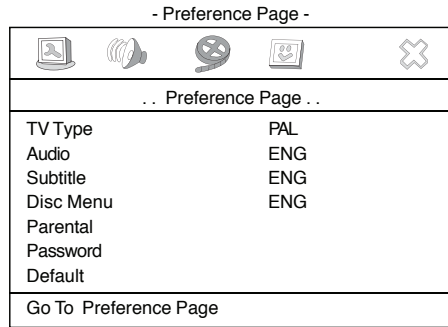

TV Type

The DVD player supports PAL, Multi and NTSC system TV type

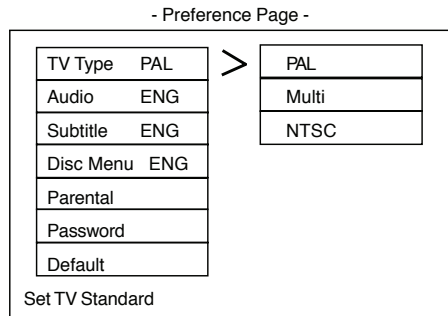

Audio

If a language listed below is recorded on the disc, you can play the sound in such language.

If not, the language recorded will be used.

- English
- French
- German
- Italian
- Dutch

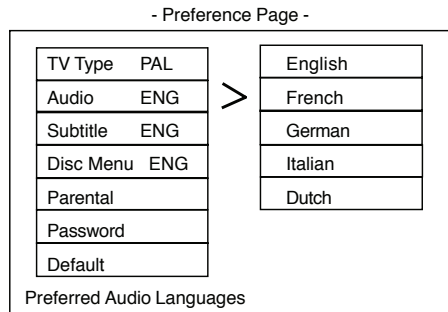

Subtitle

If a language listed below is recorded on the disc, you set the subtitle to be displayed in such language. If not, the language recorded will be used.

- English
- French
- German
- Italian
- Dutch
- OFF

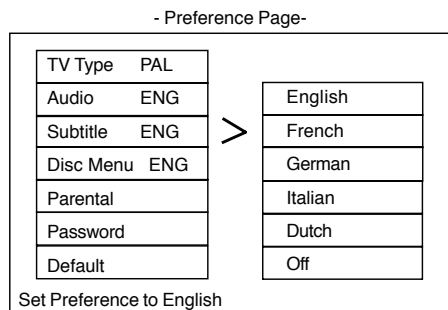

Disc Menu

If a language listed below is record on the disc, you can set the Menu to be displayed in such language. If not, the language recorded will be used.

- English
- French
- German
- Italian
- Dutch

- Preference Page-

TV Type	PAL
Audio	ENG
Subtitle	ENG
Disc Menu	ENG
Parental	
Password	
Default	

>

English
French
German
Italian
Dutch

Preferred Menu Language

Parental

When playing disc with parental lock function, you may select an age control grade according to grade of disc and your own preference. For example, if PG is selected, DVD Video disc rated higher than the PG grade cannot be played. Initial password: 1379

1. KID SAF
2. G
3. PG
4. PG 13
5. PGR
6. R
7. NC 17
8. Adult
- Off

- Preference Page -

TV Type	PAL
Audio	ENG
Subtitle	ENG
Disc Menu	ENG
Parental	
Password	
Default	

>

1. KID SAF
2. G
3. PG
4. PG 13
5. PGR
6. R
7. NC 17
8. Adult
Off

Set Parental Control

Password

Some DVD have a parental level assigned to the complete disc or particular scenes on the disc. This feature allows the viewing limit to be set and settings are region specific. To activate the parental settings.

- Preference Page-

TV Type	PAL
Audio	ENG
Subtitle	ENG
Disc Menu	ENG
Parental	
Password	
Default	

>

Change

Change Password

Default

User can load the original factory setting by choose RESET and press ENTER.

- RESET

6. Exit Setup

Quit the Setup Menu.

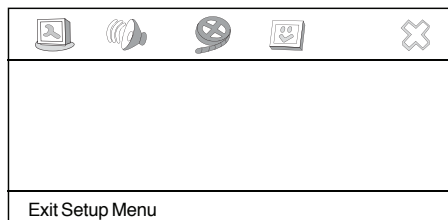
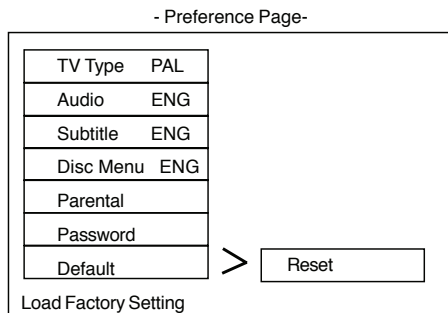

DVD Root menu

The DVD Menu Play function is only applicable for DVD movie. User can access the casting information, Production History, Movie Introduction etc. directly through this function.

1. Press the DVD ROOT Button on the remote controller to enter the Root Menu.
2. Use the Direction button (←↑→↓) or input the item index through the Number keys (0-9) to do the selection.
3. Press ENTER to confirm the selection.

Progressive Scan

Progressive scan creates a picture with double the scan lines of traditional component video pictures and creates a sharper image. The advantages of progressive scan video output are reduced picture flickering and motion artifacts as well as a sharper image on large screens.

Audio

This function is applicable for DVD and CD audio but with different effects.

- Pressing the AUDIO Button will change the Audio channel.

REW / F.F (◀▶)

This function is applicable for DVD and CD audio but with different effects. The FAST FORWARD key and FAST BACKWARD key are used to achieve fast play function.

- For DVD , there are 5 different levels of speed (2x, 4x, 8x, 16x,32x). Every successive key press will increment the speed of quick play.
- For CD audio, the FORWARD/BACKWARD will perform quick rolling on the music output.

Note : Press PLAY Button at any stage will resume to normal speed.

PREV./NEXT (◀/▶)

During playback, press one of the PREV./NEXT buttons (PREVIOUS button and NEXT button)

- When the PREV. button is pressed once, the pickup returns to the beginning of the PREVIOUS playing chapter or track.
- When the NEXT button is pressed once, the pickup will go to the beginning of next chapter or track.

Slow F.F

The Slow Forward is applicable for DVD. There are 4 steps of slow motion speed, 1/2, 1/4, 1/8, 1/16. Successive key presses will decrement the playback speed.

Note: Press Play Key to switch back to normal playback speed.

Repeat Mode

This function is applicable for DVD and CD audio but with different effects.

- For DVD disc playback, user can choose to repeat the current chapter, the current title or disc. Subsequent key press of the REPEAT key can change between these three options.
- For CD, user can choose to repeat the current track or the whole disc (Repeat All). Subsequent key press of the REPEAT key can change between these two options.

A - B

This function is applicable for DVD and CD audio. User can specify the repeating interval by marking the starting point and the end point.

1. Press the A - B Button to mark the starting point. (Playback will continue).
2. Press the A - B Button to mark the end point. (The marked part will be repeated automatically)

Note : Press the A - B Button during repetition will disable the Repeat mode.

Subtitle

This function is only applicable for DVD disc. It can change the subtitle language shown on the screen.

Note : Number of subtitle available depends on the DVD disc.

Angle

Some discs may have multiple viewing angles during production. The ANGLE button is to select the viewing angle shown on the screen.

Note : The number of Angle of View depends on the Disc.

Search

This function is applicable for DVD and CD audio. Through this function, the user can access a specific location or a specific track by key in the target time or the track number.

1. Press the SEARCH Button Enter to search mode .
2. Input the target time though the number button (0~9) and the player will jump to the target location immediately.

Display (Remain Time)

This function is applicable for DVD only. It will display the timing information of the playback on the screen.

- For DVD playback, subsequent key press on the DISPLAY Button will show the Title Elapsed Time, Title Remain Time, Chapter Elapse Time and Chapter Remain Time one by one.

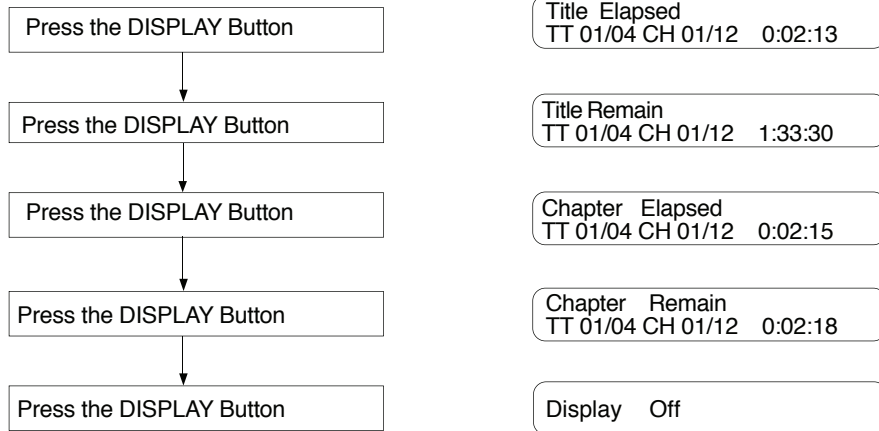

Play

This function is applicable for DVD and CD audio. During the disc playback, when the STOP Button is pressed once, the player will enter the Resume Play mode. At this time, if the PLAY Button is pressed, the player will resume playback at the location where the STOP Button is pressed. If the STOP button is pressed (i.e. STOP Button is pressed twice), the player will be Stop.

Zoom

This function is applicable for DVD. User can enlarge or reduce a static picture or a moving picture by pressing the ZOOM buttons. There are 6 levels of zooming (2x, 3x, 4x, 1/2x, 1/3x, 1/4x) and they can be achieved one by one through subsequent key presses on the ZOOM button.

NOTE: User can select the portion of the picture to be enlarged by using the Direction button (←↑→↓)

Program Mode

This function is applicable for DVD and CD audio. User can assign the playback sequence according to his/her preference. For CD audio, user can assign the track sequence while for DVD disc, user can assign both the Title and Chapter sequence.

1. Press the PROGRAM button. The Program Sequence table will be shown on the screen.
2. Enter the track numbers according to the user preference through the Number keys (0-9).
3. After assigning the playback sequence, move the highlight cursor to the START option by using the Navigation Arrows. Press ENTER on the remote controller to confirm.

To Remove the program move the highlight cursor to desire Program By use the Navigation arrows then press the clear button to Remove the selected program.

Digest Play

This function is applicable for DVD and CD audio but with different effects. Through this function, user can have a brief view of the content on the disc. For playing DVD, the screen will be divided into 6 sub-screens with each one showing different parts of the movie (depends on the mode selected).

- For DVD, there are 4 options: Time Interval, Chapter Digest, Title Interval and Chapter Interval.
- **Title Interval**

The movie will be divided into several parts according to the number of Titles it contains. Each of the 6 sub-screens will show one of the divided Titles. Each sub-screen will only play the first 4 seconds of the assigned Title.

The current title will be divided into several parts with all of them have the same length in time (10 mins). Each of the 6 sub-screens will show one of the divided parts. Each sub-screen will only play the first 4 seconds of the assigned part.

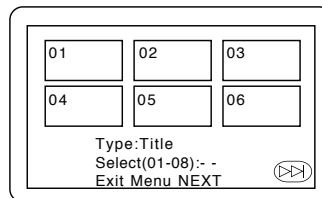
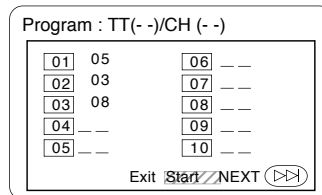
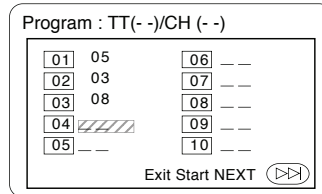
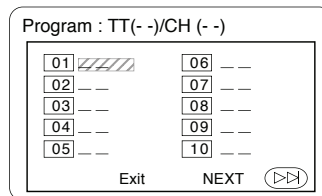

Chapter Interval

The current chapter will be divided into several parts with all of them have the same length in time. Each of the 6 sub-screens will show one of the divided parts. Each sub-screen will only play the first 4 seconds of the assigned part.

- For CD audio, this function only supports Intro Play. The player will play the first 6 seconds of each track sequentially.

Note:

- To switch off the digest features, choose EXIT in the Menu.
- Press the [ARRAY] and [ENTER] button to select the Title you want to play.

MP3 Operation

This unit can support ISO9660 file system CD-ROM navigation. Multi-Media files such as MP3 thus can be played in the player.

Operation

- Insert the MP3 disc into the tray. The navigation menu will be displayed. The menu will show the files in the root directory, and the MP3 files can then be played automatically.
- In the MP3 menu shows a blue and an orange cursor. The blue cursor indicates the currently playing MP3 song, the orange cursor indicates a title to be selected.

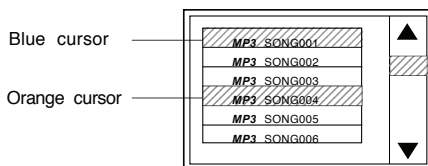

You can select the other songs by the direction buttons or directly input the song number by pressing the number keys. The orange cursor will move to the selected song. Then press ENTER to confirm.

Note: There are three digits displayed. If you want call up a title with only one or two digits, you can either start the entry with "0" or "00", or you can enter the number of the song and then wait a few seconds until the cursor skips to the selected title.

Press the repeat button to select: Random (playback in random order), Single (play one title, then stop), Repeat one (repeat the current title), Repeat Folder (repeat current folder) and Repeat ALL (repeat the current all title).

Picture CD

Digital picture (JPEG) from a digital camera can be burnt on to a disc and played on this TV. Insert a picture CD into the tray and the disc will be loaded automatically. If the disc type can be identified, the player will start showing the pictures one by one (Slide Show Mode).

Operations

During Slide Show Mode:

- Press the PAUSE Button will freeze the screen so that the current picture can be held for a long time. To resume the slide show mode, press PLAY Button.
- Press the NEXT Button on the remote controller will skip the next picture.
- Press the PREVIOUS Button on the remote controller will repeat the current picture.

Before Doubting About Troubles (DVD)

Symptom	Checks
The recorder does not play.	<ul style="list-style-type: none"> • If a DVD is from overseas, it may not be played. Please check a DVD's region code whether it has the relative region code. • Please check whether a DVD is inserted in a right direction. • If it is a CD-ROM for PC or DVD-ROM, it does not work.
No sound comes through.	<ul style="list-style-type: none"> • Play mode may be "SLOW" or "PAUSE" (In abnormal speed play, no sound comes through) • Did you connect the parts in right way? • Please check the operative condition of TV or amplifier. • From SETUP, please check "AUDIO" items.
A disc is playing but screen does not appear or poor screen appears.	<ul style="list-style-type: none"> • Did you turn on your TV sets? • Did you connect the parts in right way? • The play may be in "PAUSE". • Disc may have some contaminants or be damaged. • Disc may be bad one.
Sound is irregular.	<ul style="list-style-type: none"> • Please check the connection with Dolby Digital amplifier. • Please check the plugs are connected with one another tightly. • Some contaminants may be remained in connectin terminal.
REMOTE does not work.	<ul style="list-style-type: none"> • Please check the degree of remote control, distance or any interruption. • Battery may be weak or exhausted. • When you operate DVD, use it by pressing [VCR/DVD] button. • A receiver of remote control may be different with a sender.
"AUDIO" or "SUBTITLE" button does not work.	<ul style="list-style-type: none"> • If a DVD does not include language information, it does not support the function.
"ANGLE" button does not work while a DVD is playing.	<ul style="list-style-type: none"> • "ANGLE" is supported only in a DVD contains muilt angle scenes. Also a user can confirm the support with the "ANGLE" mark on screen.
"MENU" does not appear while a DVD is playing.	<ul style="list-style-type: none"> • Please check the degree of remote control, distance or any interruption. • Please check a battery in remote control whether it is exhausted or not. • DVD may not contain menu information.
The file name of MP3 (CD-R) appears with strange letters.	<ul style="list-style-type: none"> • The file name of MP3 recognize only the Alphabet (A-Z, az), number (0~9) and a special symbol on keyboard (~,!,@, #,\$,...) and 10 letters can be displayed in maximum.
Any MP3 (CD-R) file isn't displayed.	<ul style="list-style-type: none"> • The letters except above case will be displayed like "----". If the surface of disk is injured, the file display and playback can be impossible.

Symptom	Checks
"Power On" does not work. It does not work even in "Power On".	<ul style="list-style-type: none"> • Please check whether a power plug is inserted in an electric outlet. • Please check whether a videotape is inserted in. • Try to insert a plug again.
A videotape is not inputted in.	<ul style="list-style-type: none"> • Please check whether a power plug is inserted in an electric outlet. • Please check whether a videotape is in. • Please check whether a videotape is inserted in a right direction (a side of transparent window should be on the upside) • Have you inputted a videotape again just after the tape was ejected? Please try it again after fully ejecting it. • When a videotape forces to be ejected, the tape may not be inputted. In the case, please pull out an outlet, and then push the tape smoothly.
On inputting a videotape, the tape is re-ejected.	<ul style="list-style-type: none"> • That's why a safe mode to protect a videotape is operated automatically. Please pull out the tape and input is again.
A videotape is not ejected.	<ul style="list-style-type: none"> • In case the product is used for a long time, a videotape may not be ejected for a film inside may be stretched. In the case, please pull out a power plug for about 10mins and then press "EJECT" button.
A channel on video and a play screen does not appear.	<ul style="list-style-type: none"> • Please check your antenna's connection. • TV Channel should be fixed on video channel. • Please check your antenna's signal whether it may be weak. In case of its weakness, please use a frequency amplifier connected with the device.
Noise (screen noise) appears on screen.	<ul style="list-style-type: none"> • While in no use of VCR, was it turned on? • While in recording a program, do you watch another channel?
While in playing, noise appears.	<ul style="list-style-type: none"> • Please press "TRACKING" for better screen. Videotape may be poor. Try to change it to another one.
Sound and screen are irregular. Sound comes out but screen does not appear. Screen is irregular and stripes appears. "Screen Error" message is displayed in a screen.	<ul style="list-style-type: none"> • Please use a head-cleaner to clean VCR heads. VCR heads may be contaminated.

Symptom	Checks
While recording and playing, the top of screen extremely waves.	<ul style="list-style-type: none"> • Since VCR Play signals are not stable like a TV signals, screen may be unstable or curved while in playing. To fix the problem, please horizontal adjustment.
A screen is not clear.	<ul style="list-style-type: none"> • In case videotape is the one recorded by other products or old one, stripe may appear on the screen. • Try to adjust the screen by [TRACKING +/-] button • Try to use a head-cleaner.
A screen at pause is trembling or slow screen is not clear. While duplicating, screen is not clean and distorted.	<ul style="list-style-type: none"> • Try to adjust the screen by [TRACKING +/-] button. • Some tapes or discs distributed in the market for lending is set to prevent copy in manufacturing. These tapes cannot be duplicated in a good condition.
Recording a TV program is impossible.	<ul style="list-style-type: none"> • For recording, you should use videotape with a tab. • Please check whether a channel is fixed on video. If not, you have to turn it into "TV" by pressing "CH" button. • Please check whether a channel is fixed on video. If not, you have to turn it into "TV" by pressing "CH" button. • Please check whether the timer recording info is right. • Are RF cables inputted antenna connection terminal correctly? • Does a CH number selected in display section appear? • Please check a tab on a tape whether it is broken or not. (If it was broken, please scotch-tape it) • Check whether a tape attached with a recording tap is inserted. • Check whether the screen is displayed in VCR Only Channel. Press [CH] button in this remote controller to adjust in "General Broadcast" condition. • Is the rounded line (RF cable) connected in "ANT. IN" terminal? • Is the selected channel number shown in Display? • Is a tab of cassette tape broken? (Please cover a tab hole with cellophane adhesive tape (Scotch tape)
Once pressing "REC", a videotape is ejected automatically.	<ul style="list-style-type: none"> • Please check whether the clock is right. • Does the display on your video show "f" (Ready to timer recording)? Please make it out. • Please check whether the timer recording info is right. • Please check a tab on a tape whether it is broke or not. (If it was broken, please scotch-tape it)
Timer recording of Cable TV does not work.	<ul style="list-style-type: none"> • Was a cable data output code connected correctly? • Were a converter manufacturer setup and output channel right? • Did you enter a password? (Please cancel it.) • Did you turn off your player? (Please turn it on.) • You may not memorize channels.
In spite of pressing "CHANNEL", a channel can not be set.	<ul style="list-style-type: none"> • Please check your channel setting or press a number button.
While duplicating, screen is not clean and distorted.	<ul style="list-style-type: none"> • Some tapes or discs distributed in the market for lending is set to prevent copy in manufacturing. These tapes cannot be duplicated in a good condition.

Specifications

Power	240V~50Hz
Consumed electricity	50W
Weight	5.7kg
Dimension (WxHxD)	430mm x 91mm x 355.5mm
Operative temperature	+5°C~40°C
Installation condition	Horizontal/Relative humidity under 80%
Signal type	PAL B/G COLOR
Antenna Input/output	U/V-mixed:75Ω unbalanced
VIDEO input	1.0 Vp-p (unbalanced, RCA JACK)
AUDIO input	RCA JACK
UHF output	21~69 CH
VIDEO output (common use of DVD and VCR)	VIDEO output terminal 1.0Vp-p unbalanced, RCA JACK
VIDEO output (DVD only)	RCA or Y Pb Pr
AUDIO output (common use of DVD and VCR)	RCA Jack output terminal (2 kinds): RCA JACK
AUDIO output (DVD only)	Analogue AUDIO output(5.1CH) Digital audio output(OPTICAL, COAXIAL)
Playable type	Very high dense tapes with VHS marks
Playable disc	DVD, CD(12mm),CD(8mm), MP3, CD-R, CD-RW
Tape speed SP	SP: 23.39mm/s, LP: 11.70mm/s
Playtime	SP: 3hrs LP : 6hrs(use of E180tape)
Clock display	24hrs

- Design and specification are subject to change without notice

Warranty

The benefits conferred by this warranty are in addition to all implied warranties, other rights and remedies in respect of the product which the consumer has under the Trade Practices Act and similar State and Territory Laws.

The original purchaser of this Magnavox product is provided with the following warranty subject to the following conditions.

Mistral Housewares Pty Ltd warrant this product for a period of 1 year from the date of purchase for all parts defective in workmanship or materials. This product or defective parts will be replaced free of charge.

WARRANTY CONDITIONS

1. This warranty is only valid for appliances used according to the manufacturer's instructions
2. This appliance must not be modified or changed in any way.
3. Connection must be to the voltage requirements as specified in the ratings label located on the product.
4. The manufacturer does not accept liability for any direct or consequential damage, loss or other expense arising from misuse or incorrect installation and operation of the appliance.
5. Warranty will only be given where proof of purchase is provided, e.g. original invoice.
6. Not designed or warranted for industrial or commercial use.

DO NOT SEND IN THIS WARRANTY

Fill out the following details and file with your purchase invoice.

RETAIN & FILE WITH YOUR RECEIPT.

Your Purchase Receipt/Invoice is proof of date of purchase. You must be able to present it at the place of purchase to obtain a replacement or service under warranty.

Mistral Housewares Pty Ltd reserves the right to discontinue items, modify designs and change specifications without incurring obligation. Whilst every effort is made to ensure that descriptions, specifications and other information in this publication is correct, no warranty is given in respect thereof and the company shall not be liable for any errors therein.

Purchased from: _____

Co. Name: _____

Address: _____

Date of Purchase: _____

NOTE: Consistent with our continuing product development policy, improvements may have been made which render the contents of this package slightly different to that shown.

Cat. No. MDVDVCR5
June 2006

NEED HELP?
CALL THE CONSUMER HOTLINE
AUSTRALIA
NEW ZEALAND
1300 363 872
0800 328 280

mistral
GROUP OF COMPANIES

Another quality product from the Mistral Group of Companies.

Mistral Housewares Pty Ltd ABN 60 079 923 130 324 Frankston-Dandenong Rd., Dandenong South, Victoria, Australia 3175	RINGGRIP (NZ) Pty Ltd ACN 006 771 922 PO Box 33672 Takapuna, Auckland New Zealand	Mistral (UK) Ltd Crane House 730 Mandarin Court Centre Park, Warrington WA1 1GG United Kingdom
---	--	---

The Mistral Group of Companies has a policy of continual improvement throughout the product range. As such the unit contained within may differ slightly from the unit illustrated on the pack.

MADE IN CHINA for the Mistral Group of Companies
Magnavox is a registered trademark of Mistral (HK) Ltd.

www.mistral.com.au

Free Manuals Download Website

<http://myh66.com>

<http://usermanuals.us>

<http://www.somanuals.com>

<http://www.4manuals.cc>

<http://www.manual-lib.com>

<http://www.404manual.com>

<http://www.luxmanual.com>

<http://aubethermostatmanual.com>

Golf course search by state

<http://golfingnear.com>

Email search by domain

<http://emailbydomain.com>

Auto manuals search

<http://auto.somanuals.com>

TV manuals search

<http://tv.somanuals.com>