

Models No. ▶ BCG140 / BCG180 (LXGC01*1)

Description ▶ Cordless Caulking Gun

*1 Model number for North and Central American countries

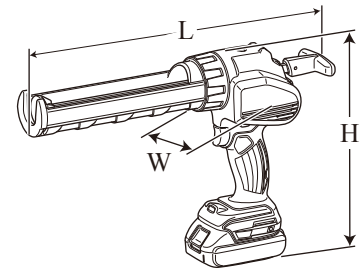

CONCEPT AND MAIN APPLICATIONS

Model BCG140 and BCG180 are Cordless Caulking Guns powered by 14.4V/18V Li-ion battery.

They are compatible with the following sealants by changing

Holder and Piston:

- 300ml/ 600ml cartridge
- Sausage pack
- Bulk sealant

Their other main features are:

- Compact and lightweight design
- High work efficiency
- Variable speed control by dial and trigger switch for constant bead of sealant
- Anti-drip function that stops excess sealant from oozing out just upon release of the switch trigger

(The image above is BCG180 with 300ml size holder and Battery BL1815.)

Dimensions: mm (")		
Model No.	BCG140	BCG180
Length (L)	404 (15-7/8)*2, 538 (21-1/4)*3	
Width (W)	108 (4-1/4)	
Height (H)	264 (10-3/8)*4/ 281 (11-1/8)*5	

*2 with 300ml size holder

*3 with 600ml size holder

*4 with 1.3Ah Li-ion battery of BL1415 or BL1815

*5 with 3.0Ah Li-ion battery of BL1430 or BL1830

Specification

Specification		Model	BCG140	BCG180
Battery	Cell		Li-ion	
	Voltage: V		14.4	18
	Capacity: Ah		1.3/ 3.0	1.3 (1.5*5)/ 3.0
	Energy capacity: Wh		19/ 44	24 (27*5)/ 54
	Charging time: min.		15, 22 with DC18RC	
Max output: W			130	150
Max pushing force: N (lbs)			5,000 (1,100)	
No load speed: mm/sec. (in/min.)			0 - 28 (0 - 66)	
Stroke length: mm (")	300ml holder model		214 (8-3/4)	
	600ml holder model		350 (13-3/4)	
Compatible sealant size	300ml holder model		Cartridge	
	600ml holder model		Cartridge, Sausage pack, Bulk sealant	
Variable speed control	by trigger		Yes	
	by dial		Yes	
Continuous run time (approx.) on a single full battery charge with 300ml cartridge: cartridge quantity			180/ 410	210/ 500
Anti-drip function			Yes	
Overload protection function			Yes	
Rubberized soft grip			Yes	
Trigger lock			Yes	
LED job light			Yes	
Weight according to EPTA-Procedure 01/2003: kg (lbs)			2.1/ 2.2 (4.6/ 4.9)*6, 2.5/ 2.6 (5.4/ 5.8)*7	2.1/ 2.3 (4.7/ 5.1)*6, 2.5/ 2.7 (5.5/ 6.0)*7

*5 for some countries only

*6 with 300ml size holder

*7 with 600ml size holder

Standard equipment

- Holder for 300ml type model
- Holder for 600ml type model
- Holder joint for 300ml type model
- Holder joint for 600ml type model
- Piston for cartridge
- Piston for sausage pack
- Piston for bulk sealant
- Rubber ring for sausage pack
- Rubber ring for bulk sealant
- Nozzle for sausage pack
- Nozzle for bulk sealant
- Plastic carrying case or Tool bag (for some countries only)

Note: The standard equipment for the tool shown above may vary by country.

Optional accessories

- Li-ion battery BL1415 (for BCG140)
- Li-ion battery BL1430 (for BCG140)
- Li-ion battery BL1815 (for BCG180)
- Li-ion battery BL1830 (for BCG180)
- Fast charger DC18RC
- Charger DC18SD
- Charger DC24SC
- Automotive charger DC18SE
- Holder sets
- Pistons
- Rubber rings
- Nozzles
- Rubber seal

► Repair

CAUTION: Repair the machine in accordance with “Instruction manual” or “Safety instructions”.

[1] NECESSARY REPAIRING TOOLS

Code No.	Description	Use for
1R026	Bearing Setting Pipe 16-8.2	removing Spur gear 10
1R027	Bearing Setting Pipe 18-10.2	holding Carrier A complete when mounting 9 pcs. of Pin 3
1R029	Bearing Setting Pipe 23-15.2	removing Ball bearing 6803LLU
1R031	Bearing Setting Pipe 28-20.2	separating Spur gear 10 from Ball bearing 6806LLU
1R258	V Block	setting Ball bearing 6806LLU when removing Spur gear 10

[2] LUBRICATION

Apply **Seal lubricant No.101** to the following portions designated with the black triangle to protect parts and product from unusual abrasion.

Item No.	Description	Portion to lubricate	Amount
②⑧	Internal gear 48	Teeth portion	approx. 1.5 g
③②	Carrier A complete	Pin (shaft) portion for accepting Spur gear 19B	a little
③⑨	Spur gear 9C complete	Drum portion where Spur gear 10 contacts	a little
④①	Spur gear 19A	Teeth portion	a little
④②	Spur gear 9B complete	a: Pin (shaft) portion for accepting Spur gear 19A	approx. 1.0 g
		b: Drum portion	approx. 1.0 g
④③	Spur gear 19A	Teeth portion	approx. 1.0 g

Fig. 1

Gear Assembly

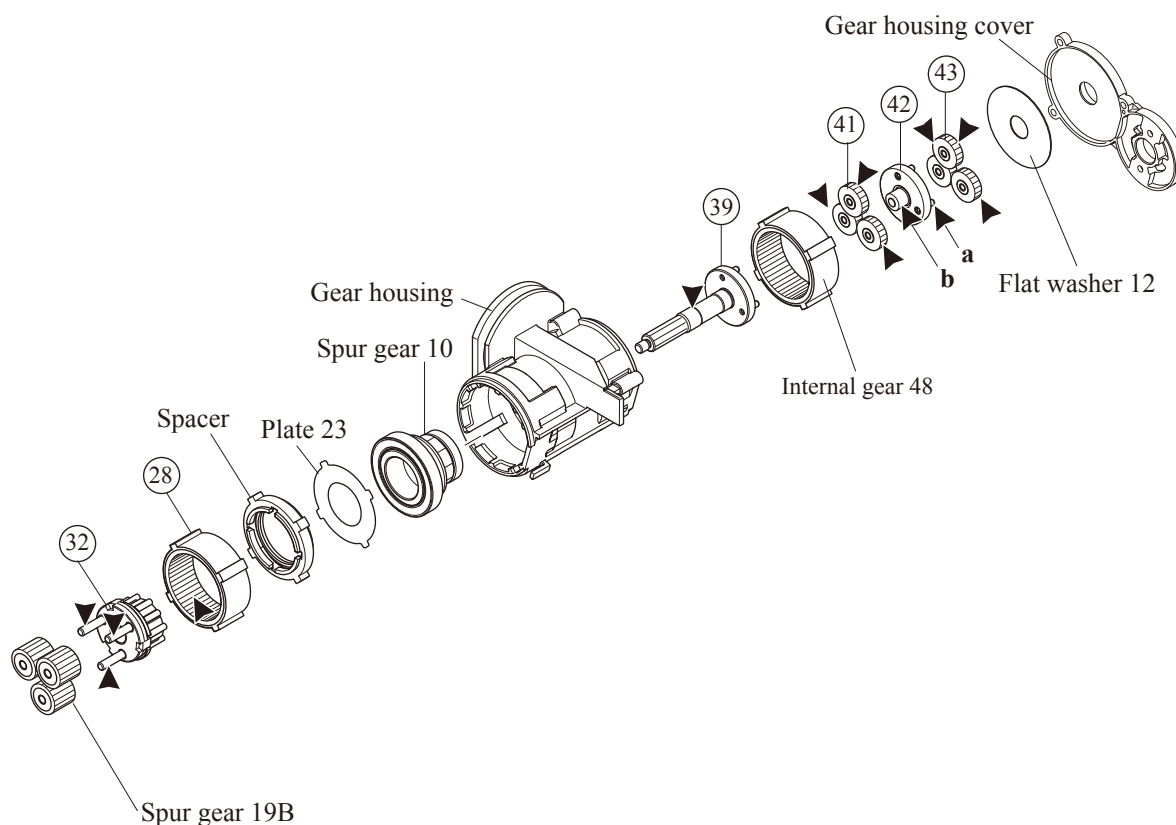

► **Repair**

[3] DISASSEMBLY/ASSEMBLY

[3] -1. Rack Complete

DISASSEMBLING

Disassemble Rack complete as drawn in **Fig. 2**.

Fig. 2

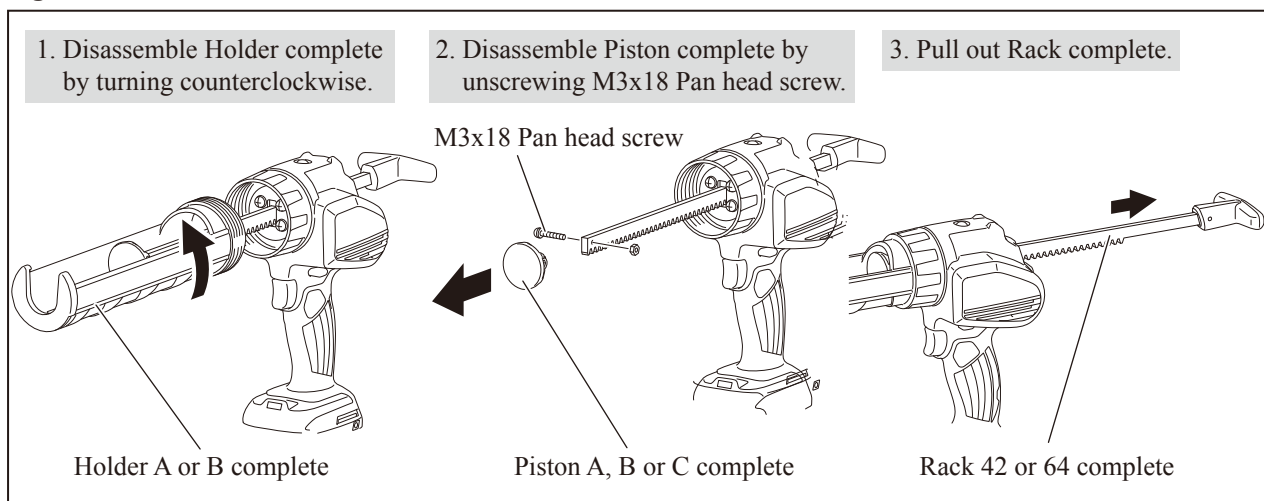

ASSEMBLING

Assemble by reversing the disassembly procedure. (Refer to **Fig. 2**)

[3] -2. Motor Complete, Gear Assembly

(1) Disassemble the drive section (Gear assembly, Motor complete) as drawn in **Fig. 3**.

Fig. 3

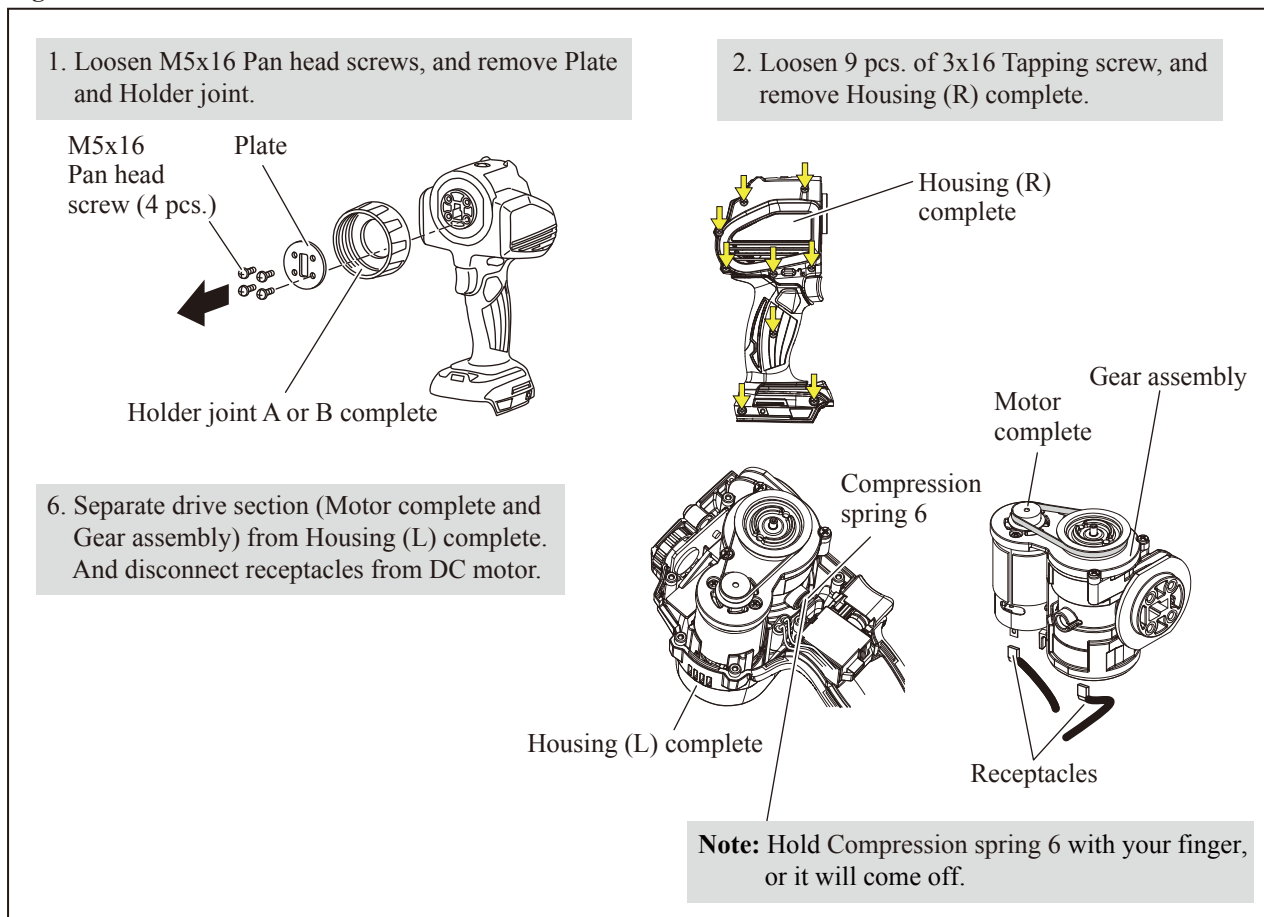

► **Repair**

[3] DISASSEMBLY/ASSEMBLY

[3] -2. Motor Complete, Gear Assembly (cont.)

DISASSEMBLING

(2) Remove Motor complete from Gear assembly as drawn in **Fig. 4**.

Fig. 4

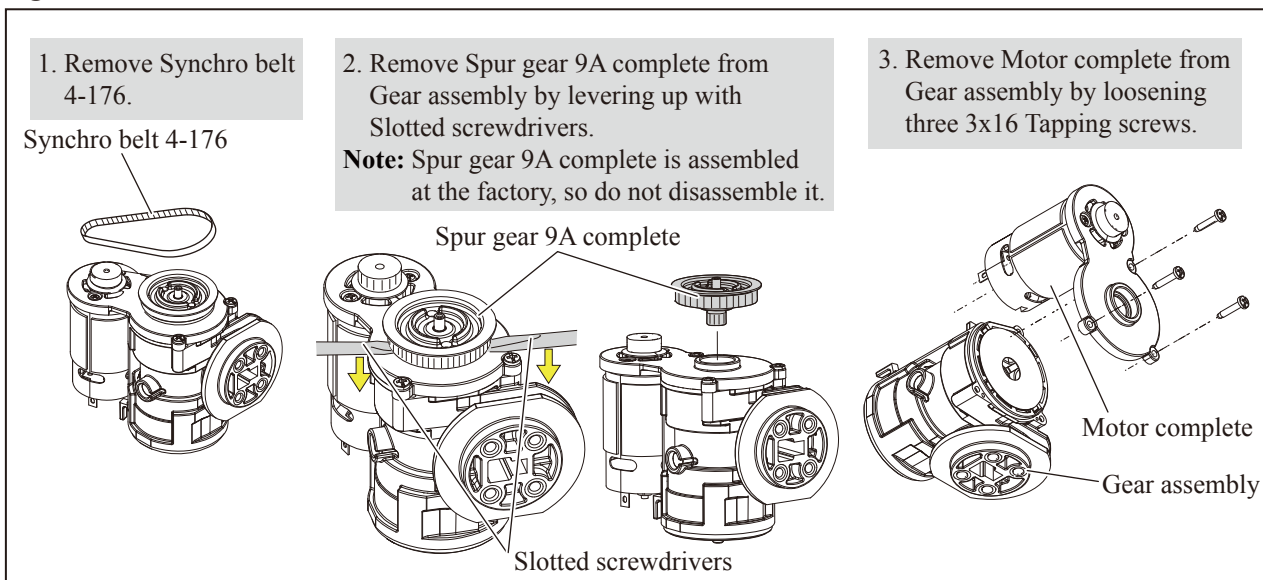

(3) Disassemble component parts of Gear assembly from Gear housing as drawn in **Fig. 5**.

Fig. 5

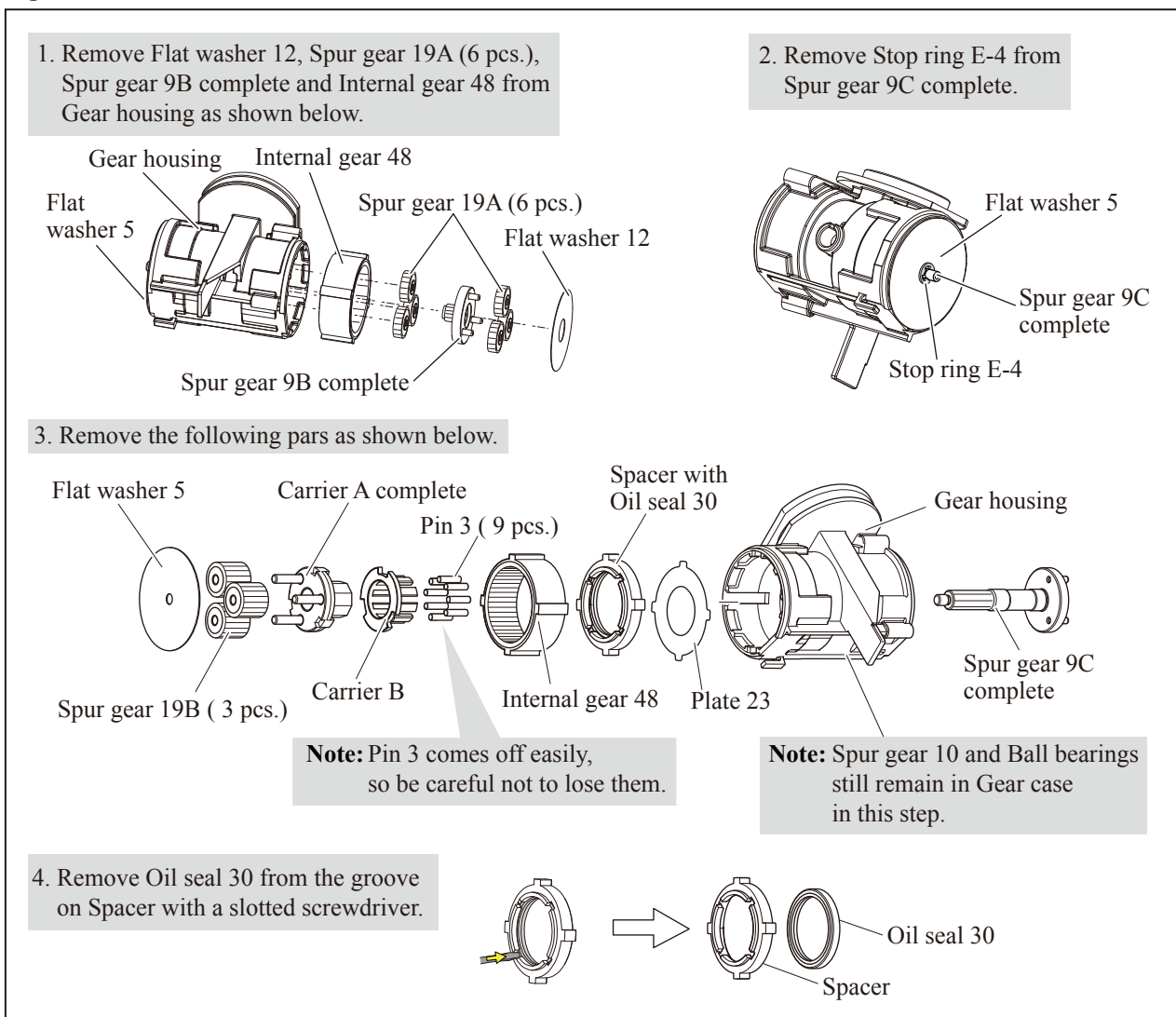

► **Repair**

[3] DISASSEMBLY/ASSEMBLY

[3] -2. Motor Complete, Gear Assembly (cont.)

DISASSEMBLING

(4) Remove Spur gear 10 and Ball bearings from Gear housing as drawn in **Fig. 6**.

Fig. 6

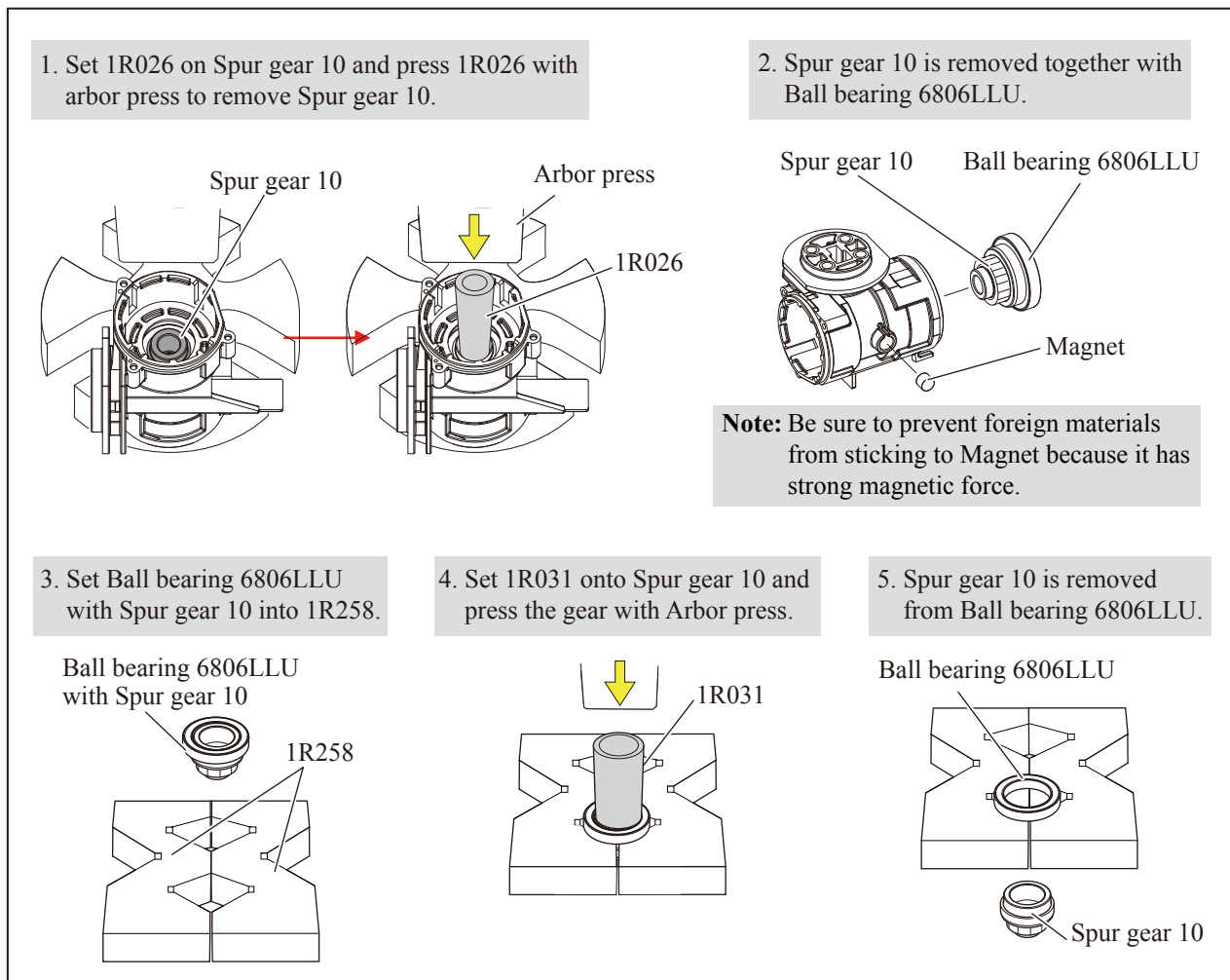

(5) Ball bearing 6803LLU still remains in Gear housing in the step of **Fig. 6**. This ball bearing can be removed as drawn in **Fig. 7**.

Fig. 7

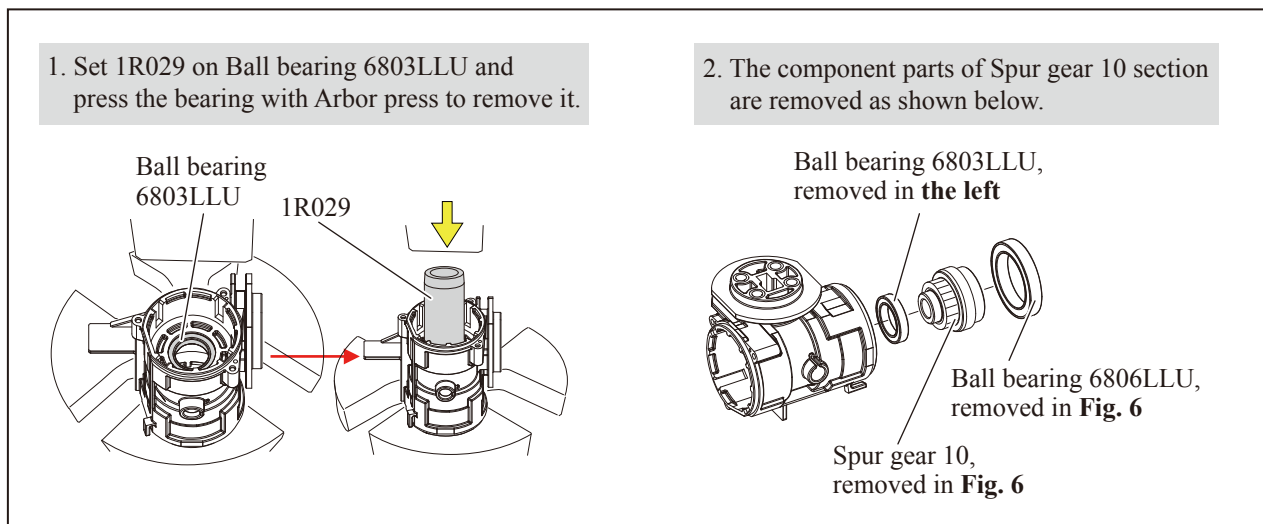

► **Repair**

[3] DISASSEMBLY/ASSEMBLY

[3] -2. Motor Complete, Gear Assembly (cont.)

ASSEMBLING

- (1) Assemble Ball bearing 6803LLU to Gear housing. Refer to the drawing on the left in **Fig. 7**.
- (2) Mount Ball bearing 6806LLU to Spur gear 10. Refer to the drawing on the bottom in **Fig. 6**.
- (3) Assemble the Spur gear 10 section to Gear housing. Refer to the drawing on the upper right in **Fig. 6**.
- (4) Mount Oil seal 30 to Spacer. Refer to the drawing on the bottom in **Fig. 5**.
- (5) Assemble Plate 23, Spacer, Internal gear 48 and Spur gear 9C complete to Gear housing as drawn in **Fig. 8**.

Fig. 8

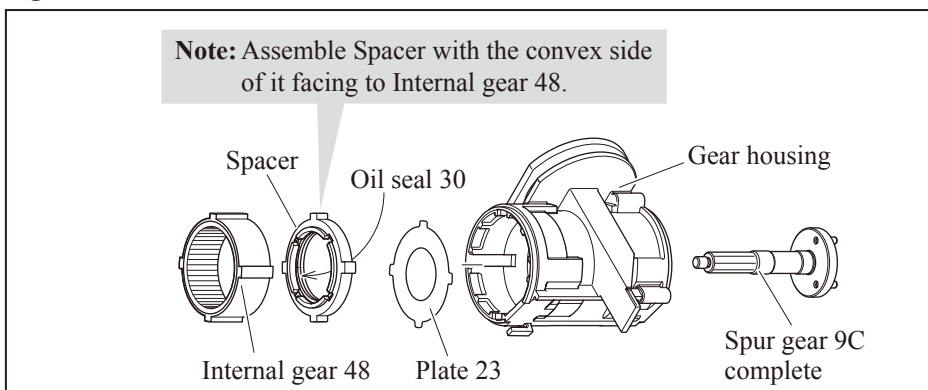

- (6) Assemble the parts on the Flat washer 5 side to Gear housing as drawn in **Fig. 9**.

Fig. 9

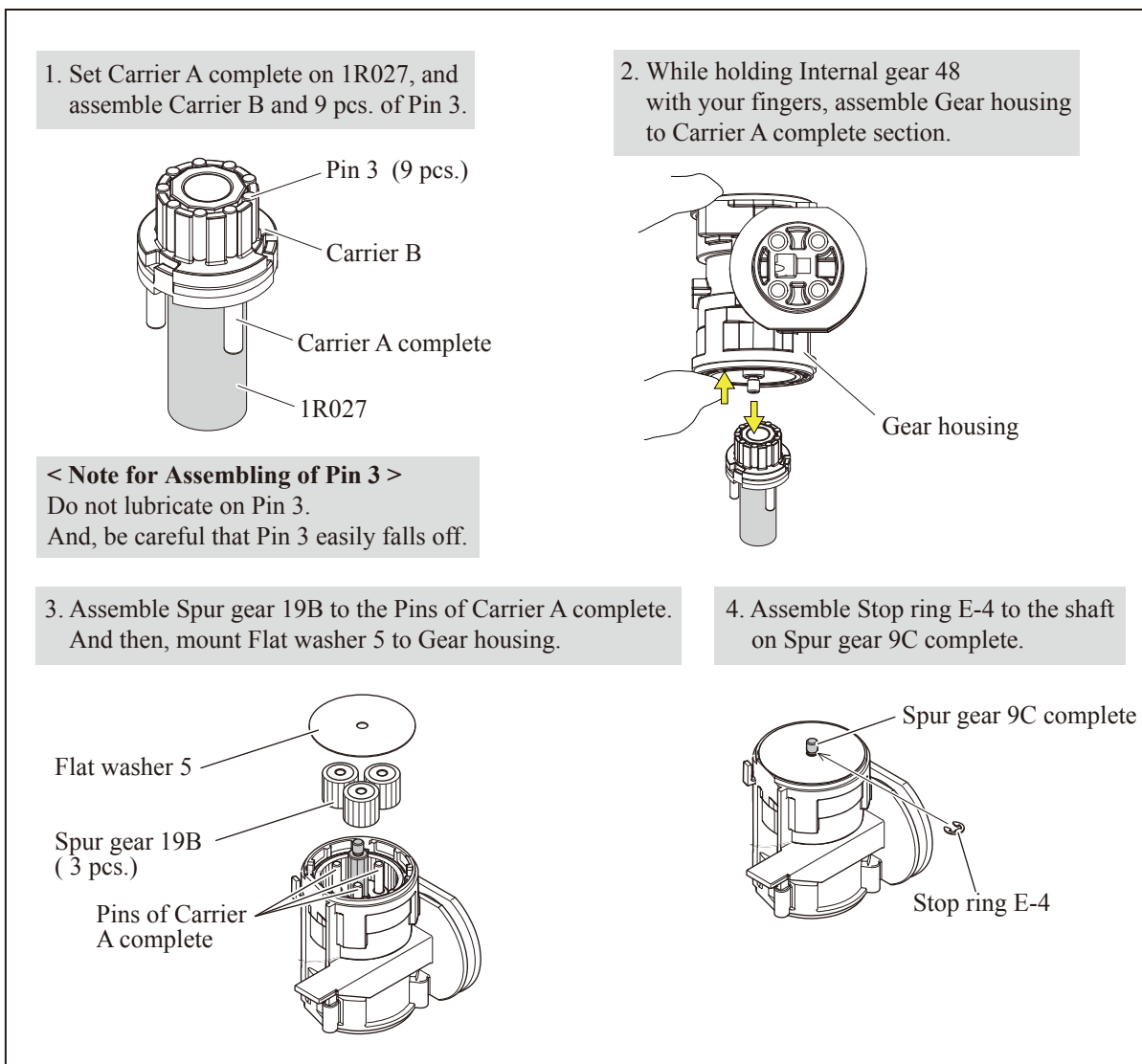

► Repair

[3] DISASSEMBLY/ASSEMBLY

[3] -2. Motor Complete, Gear Assembly (cont.)

ASSEMBLING

(7) Assemble the parts on the Flat washer 12 side to Gear housing as drawn in **Fig. 10**.

Fig. 10

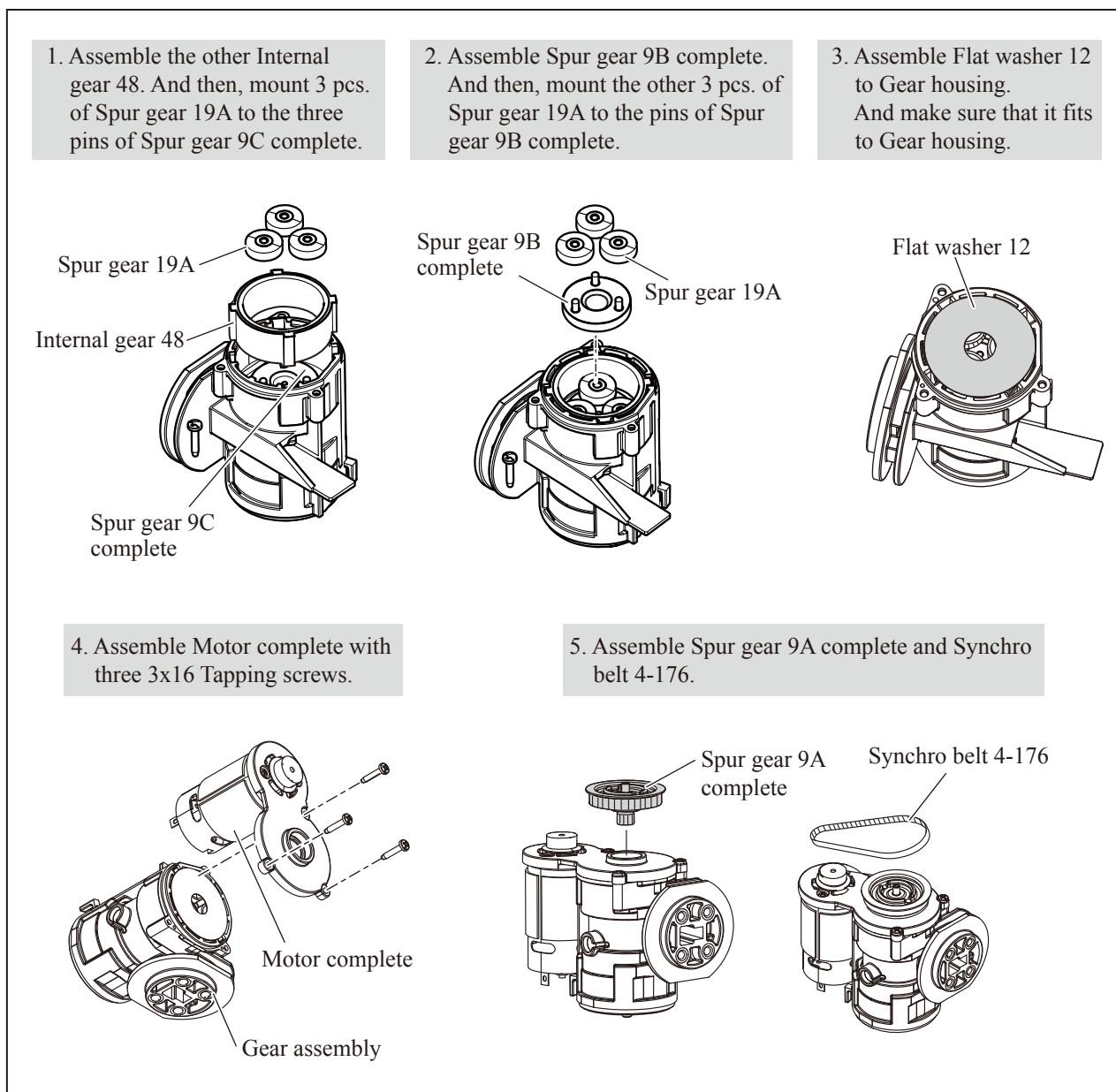

► Repair

[3] DISASSEMBLY/ASSEMBLY

[3] -2. Motor Complete, Gear Assembly (cont.)

ASSEMBLING

(8) Assemble the driving section (Gear assembly and Motor complete) to Housing (L) complete as drawn in **Fig. 11**.

Fig. 11

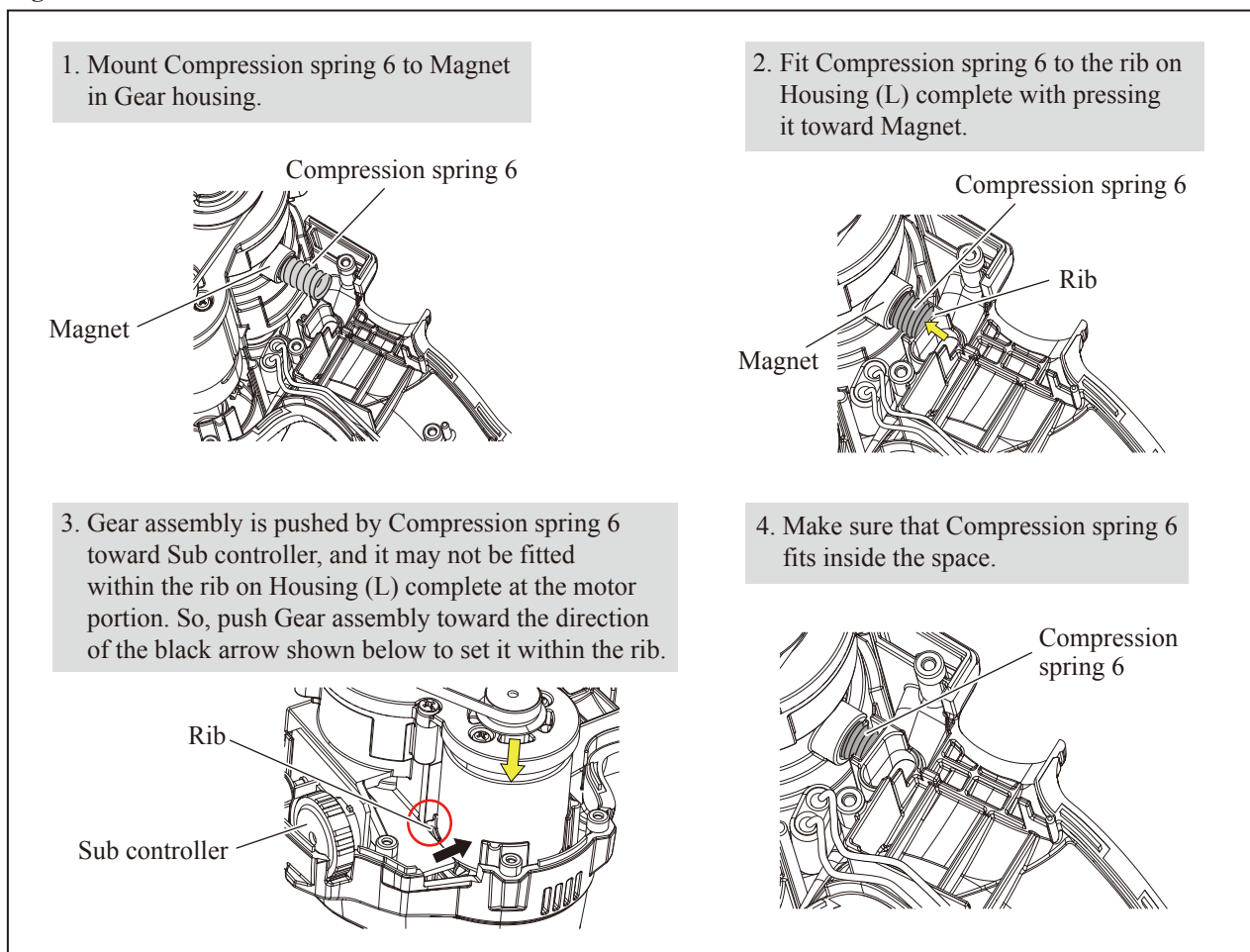

(9) When replacing the whole Gear assembly, use new Gear assembly as drawn in **Fig. 12**.

Fig. 12

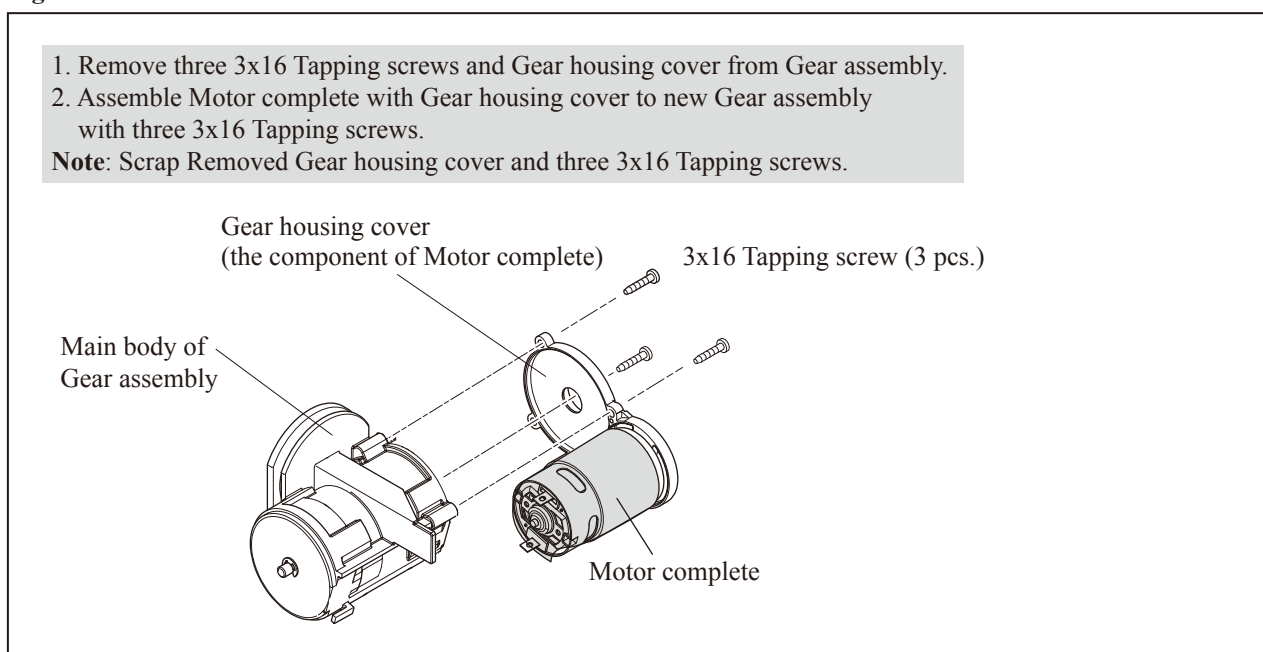

► **Circuit diagram**

Fig. D-1

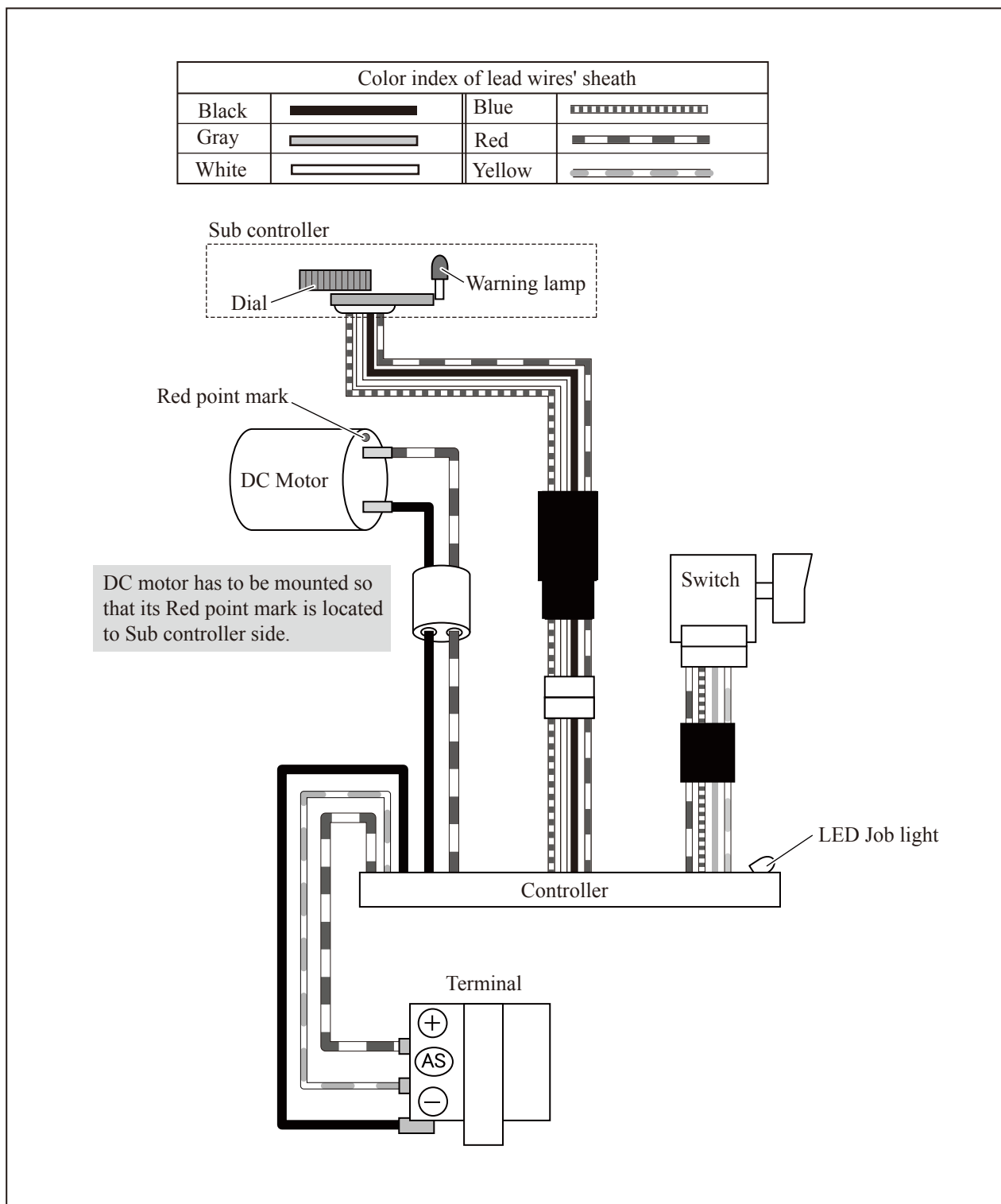

▶ Wiring diagram

Fig. D-2

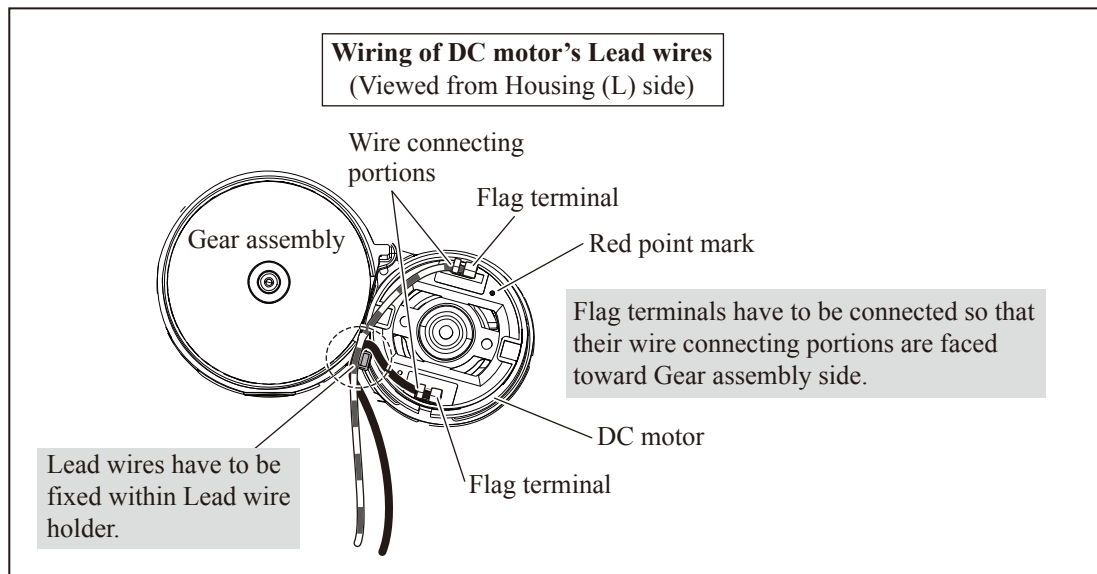
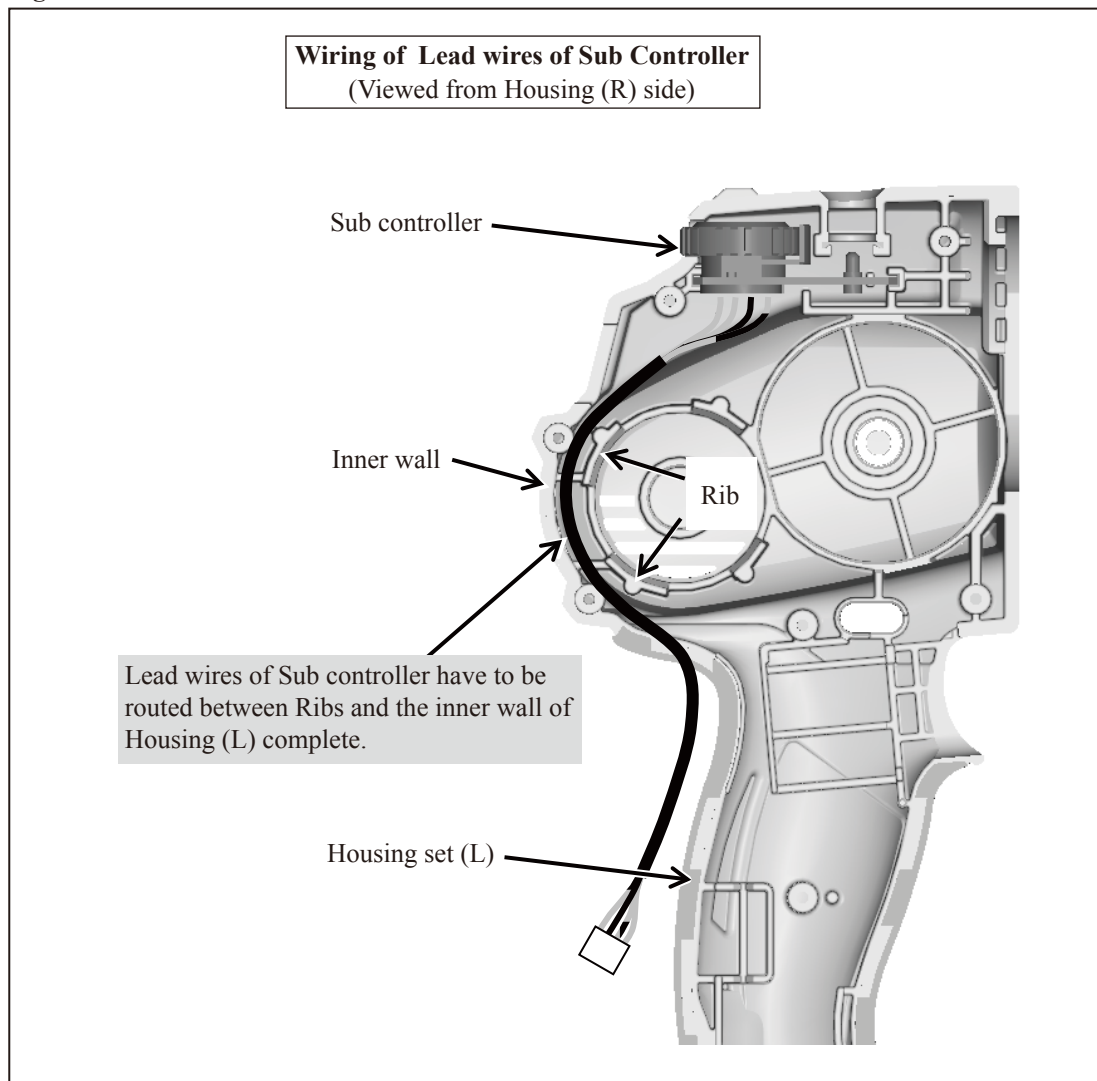
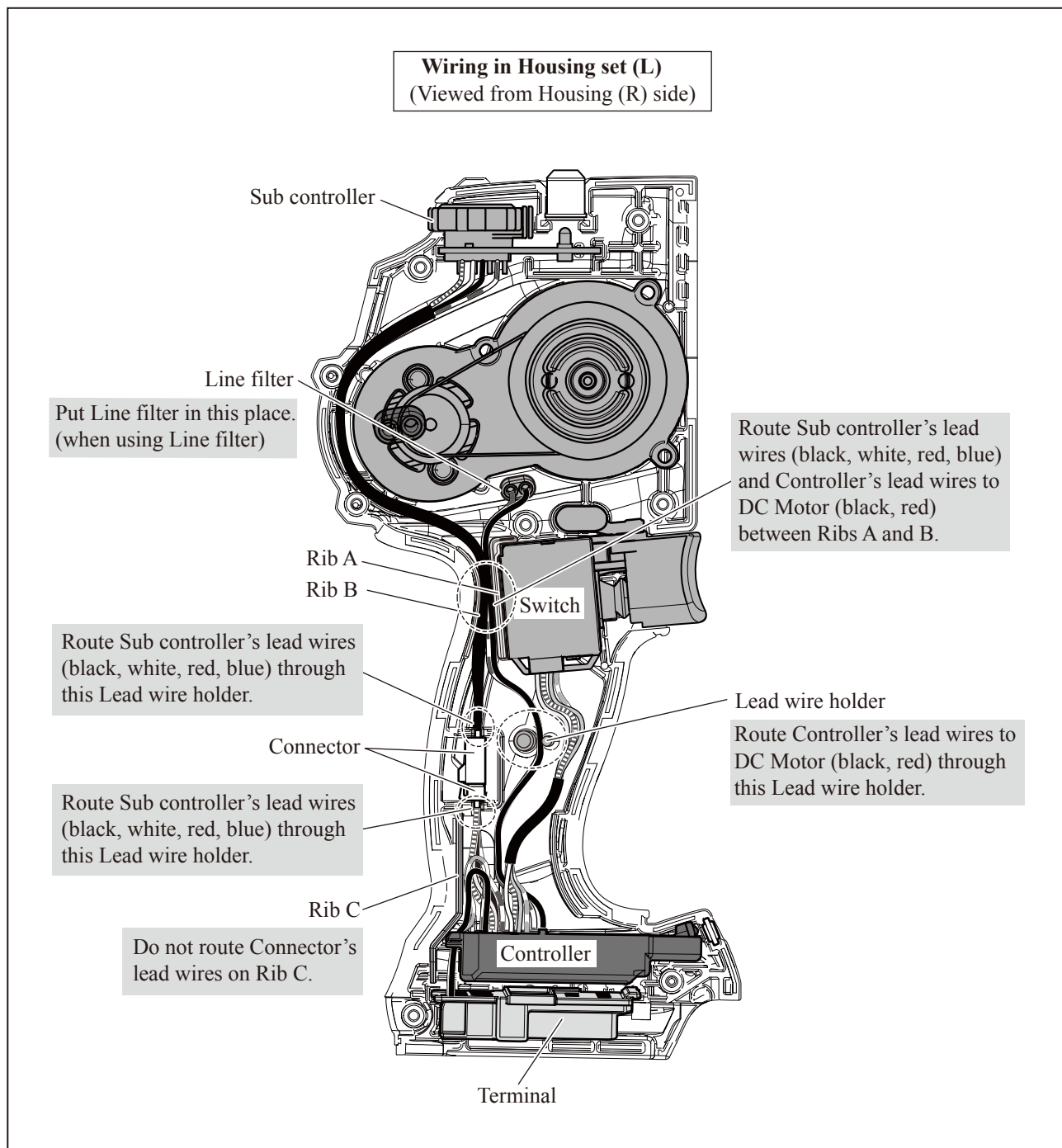

Fig. D-3



► **Wiring diagram**

Fig. D-4



Free Manuals Download Website

<http://myh66.com>

<http://usermanuals.us>

<http://www.somanuals.com>

<http://www.4manuals.cc>

<http://www.manual-lib.com>

<http://www.404manual.com>

<http://www.luxmanual.com>

<http://aubethermostatmanual.com>

Golf course search by state

<http://golfingnear.com>

Email search by domain

<http://emailbydomain.com>

Auto manuals search

<http://auto.somanuals.com>

TV manuals search

<http://tv.somanuals.com>