

WIRING DIAGRAM

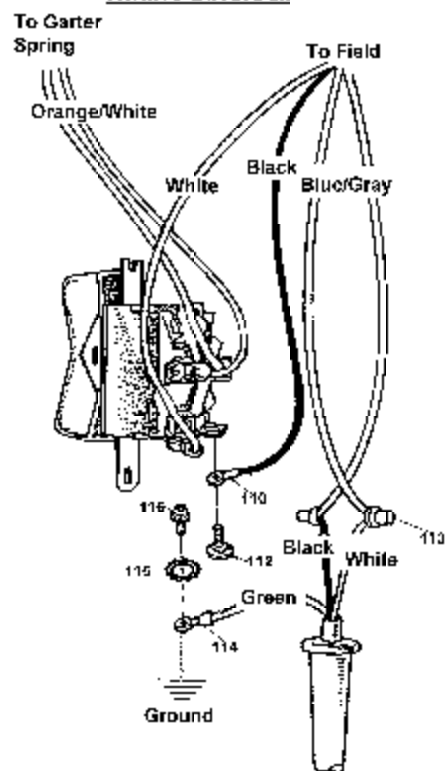

Item No.	Part No.	No. Used	Description	Item No.	Part No.	No. Used	Description
1	421120-1	1	Bumper	40	181047-4	2	CarbonBrush CB-154 (2pcs/Set)
2	156135-6	1	Hammer Case (Includes Items 53 & 54)		181048-2	2	Auto Cut-Off Carbon Brush CB-155 (Optional)
3	253909-7	1	Flat Washer 35	41	643650-4	2	Brush Holder Cap 6.5-13.5
4	231921-7	1	Ring Spring 22 (Type 2) *	42	341367-0	2	Brush Holder Cap Cover
5	*	1	Anvil	43	911121-2	2	P.H. Screw M4X14
6	253182-9	1	Flat Washer 36	44	682505-8	1	Cord Guard 10-90
7	221815-4	1	Internal Gear 82	45	664820-2	1	Cord With Plug 3P-14-2.5
8	256051-3	2	Pin 10	46	687600-9	1	Strain Relief
9	212063-6	2	Needle Bearing 1012	47	911116-5	2	P.H. Screw M4X12
10	221816-2	2	Spur Gear 37	48	911106-8	1	P.H. Screw M4X8
11	325416-1	1	Spindle	49	651554-6	1	Switch
12	216010-9	2	Steel Ball 10.3	50	312742-7	1	Handle Cover
13	253713-4	1	Flat Washer 35	51	911146-6	2	P.H. Screw M4X25
14	333112-7	1	Ring 79	52	654502-4	2	Solderless Connector P-2
15	231211-8	1	Compression Spring 36	53	213456-0	1	Oil Seal 35
16	231212-6	1	Compression Spring 49	54	257536-2	1	Sleeve 35
17	253712-6	1	Flat Washer 36	55	643653-8	2	Brush Holder 6.5-13.5
18	216002-8	32	Steel Ball 4.8	56	913206-0	2	Set Screw M5X8
19	325415-3	1	Hammer	57	951104-0	1	Spring Pin 4-12
20	211451-4	1	Ball Bearing 6007LLB	60	325365-2	1	Pin (Type 1) *
21	256040-8	2	Pin 5	61	231213-4	1	Spring (Type 1) *
22	312739-6	1	Bearing Housing	62	256710-9	1	Slotted Pin (Type 1) *
23	212217-2	1	Ball Bearing 1511LLB	100	273444-9	1	Grip 37
24	241613-0	1	Fan 90	102	923456-9	1	Cap Square Neck Bolt M8X35
25	613282-1	1	Armature Assy (Includes Items 23, 24, 38 & 39)	103	345097-5	1	Belt
26	265343-9	2	(+) Hex Bolt M5X80 (With Spring Washer & Glued)	110	654037-5	4	Insulated Eye Terminal FV1.25-M3
27	413009-7	1	Baffle Plate	112	652008-6	4	P.H. Screw M3.5X7(With Washer)
28	623252-2	1	Field (With Items 30 & 52)	113	654510-5	2	Closed End Connector 5.5-SD
29	953106-2	4	Rivet 0-5	114	654005-8	1	Solderless Eye Terminal 2-M4
30	654020-2	2	Garter Spring	115	943053-5	1	Toothed Lock Washer 4
31	942151-2	4	Spring Washer 6	116	652012-5	1	P.H. Screw M4X8
32	922382-9	4	Hex Socket Head Bolt M6X60				
33	156136-4	1	Motor Housing (With Items 55 - 57)	Accessories			
34	681002-1	2	Insulation Washer	A01	123018-5	1	Side Handle Assy (Includes 100, 102 & 103)
35	911216-1	2	P.H. Screw M5X14	A02	134870-6	1	Extension Bar 25.4 (Type 2) (Old 785209-2)
36	284016-5	1	Rear Cover	A03	783203-8	1	Hex Wrench 5
37	421075-0	1	Cushion Ring	A04	182363-7	1	Metal Carrying Case
38	211066-7	1	Ball Bearing 6200LLB				
39	213051-6	1	Dust Seal 10				

SERVICE CHANGES

1. Change on Anvil.

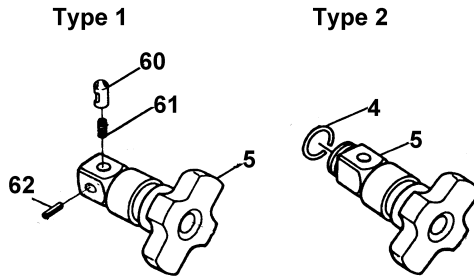

Item No.	Description	Type 1	Type 2
4	Ring Spring 22	-----	231921-7 (Added)
5	Anvil	325414-5 (No Longer Available)	325587-4
60	Pin	325365-2 (No Longer Available)	(Discontinued)
61	Spring	231213-4 (No Longer Available)	(Discontinued)
62	Slotting Pin	256710-9 (No Longer Available)	(Discontinued)

Above parts are completely interchangeable as a set.

When replacing Type 1 Anvil, replace it with complete set of Type 2 parts.

Free Manuals Download Website

<http://myh66.com>

<http://usermanuals.us>

<http://www.somanuals.com>

<http://www.4manuals.cc>

<http://www.manual-lib.com>

<http://www.404manual.com>

<http://www.luxmanual.com>

<http://aubethermostatmanual.com>

Golf course search by state

<http://golfingnear.com>

Email search by domain

<http://emailbydomain.com>

Auto manuals search

<http://auto.somanuals.com>

TV manuals search

<http://tv.somanuals.com>