

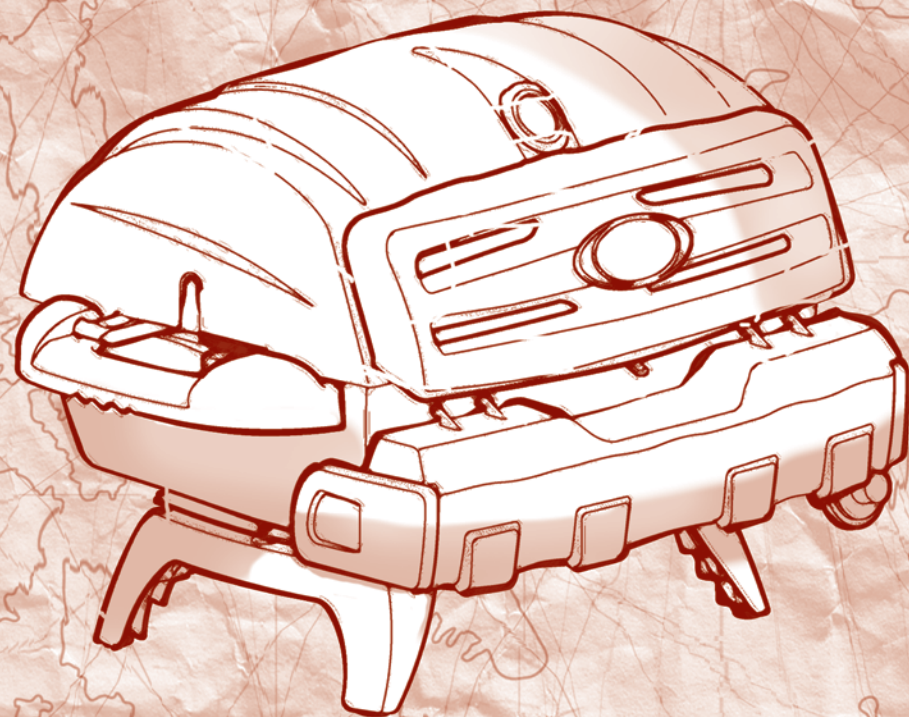

# TAILGATING TABLETOP GRILL

*The Best Cheeseburgers In Paradise  
Come From Margaritaville®*

**Model NBMGLG1000 & NBMGLG1900**  
User Manual





# WELCOME TO MARGARITAVILLE®



*Margaritaville® isn't a place, it's a state of mind ...  
it is an escape from the everyday! The Margaritaville® Tailgating Tabletop Grill  
makes it a short trip from here to there, where you can put on your no-worries  
attitude and enjoy perfectly grilled food on the go.*

The Tailgating Tabletop Grill instruction manual was developed to help quickly familiarize you with your grill. You're just a few short steps away from Margaritaville®, enjoying perfectly grilled food. To learn more or to purchase other Margaritaville® products, please visit us at

[www.margaritavillecarg.com](http://www.margaritavillecarg.com)



ANSI Z21.89a-2008/  
CSA 1.18a-2008  
Outdoor Cooking Specialty  
Gas Appliances

**CONSUMER/USER:** This instruction manual contains important information necessary for the proper assembly and safe use of the appliance. Read and follow all warnings and instructions before assembling and using the appliance. Follow all warnings and instructions when using the appliance. Keep this manual for future reference. Failure to follow these warnings and instructions may cause death, personal injury, or property damage.

If you have questions or need advice regarding your grill or its safe operation, please visit [www.margaritavillecarg.com](http://www.margaritavillecarg.com) or call 1-877-689-2737.

## Technical Characteristics

Input: 20,000 BTU/H

Category: Pressure regulated propane

Fuel: 16.4 oz. disposable propane cylinders



Regulator: RJ-B

**FOR OUTDOOR USE ONLY**

# Contents

General Safety Information.....	1-3
Portable L.P. (Propane) Gas Barbecue Cylinders .....	3
Assembly .....	4
Cooking .....	4
Operating Instructions.....	4
Grill Performance.....	4
Attaching The Propane Cylinder.....	4-5
Lighting .....	5
Removing The Propane Cylinder .....	6
Cleaning.....	6
Annual Maintenance .....	6
General Maintenance.....	7
Storage, Transport And/Or Non-Use.....	7
Replacement Parts List.....	8
Accessories.....	8
Troubleshooting .....	9
Warranty .....	9

## General Safety Information

This manual contains important information about the assembly, operation and maintenance of this product and system. General safety information is presented in these first few pages and is also located throughout the manual. Particular attention should be paid to information accompanied by the safety alert symbols: “ **DANGER**”, “ **WARNING**”, “ **CAUTION**”.

Keep this manual for future reference and to educate new users of this product. This manual should be read in conjunction with the labeling on the product.

Safety precautions are essential when any mechanical or propane fueled equipment is involved. These precautions are necessary when using, storing, transporting, and servicing. Using this equipment with the respect and caution demanded will reduce the possibilities of death, personal injury or property damage.

The following symbols shown next are used extensively throughout this manual. Always heed these precautions, as they are essential when using any mechanical or fueled equipment.

### **DANGER**

DANGER indicates an imminently hazardous situation which, if not avoided, will result in death or serious injury.

### **WARNING**

WARNING indicates a potentially hazardous situation which, if not avoided, could result in death or serious injury.

### **CAUTION**

CAUTION indicates a potentially hazardous situation which, if not avoided, may result in minor or moderate personal injury, or property damage.

### **DANGER**

**If you smell gas:**

- 1. Shut off gas to the appliance.**
- 2. Extinguish any open flame.**
- 3. Open lid.**
- 4. If odor continues, keep away from the appliance and immediately call your gas supplier or your fire department.**

**Failure to follow these instructions could result in fire or explosion which could cause property damage, personal injury or death.**

 **DANGER**

- 1. Never operate this appliance unattended. Keep children and pets away from the appliance at all times.**
- 2. Never operate this appliance within 10 feet (3.05 m) of any other gas cylinder.**
- 3. Never operate this appliance within 25 feet (7.5 m) of any flammable liquid.**
- 4. Heated liquids remain at scalding temperatures long after the cooking process. Never touch cooking appliance until liquids have cooled to 115°F (45°C) or less.**
- 5. If a fire should occur, keep away from the appliance and immediately call your fire department. Do not attempt to extinguish an oil or grease fire with water.**

**Failure to follow these instructions could result in fire, explosion or burn hazard, which could cause property damage, personal injury or death.**

Only persons who can understand and follow the instructions should use or service this outdoor grill.

If you need assistance or outdoor grill information such as an instruction manual or labels, visit [www.margaritavillecarg.com](http://www.margaritavillecarg.com).

 **DANGER**

**CARBON MONOXIDE HAZARD**

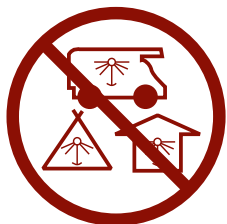

- **This appliance can produce carbon monoxide which has no odor.**
- **Using it in an enclosed space can kill you.**
- **Never use this appliance in an enclosed space such as a camper, tent, car or home.**
- **For outdoor use only.**

 **CAUTION**

- The use of alcohol, prescription or non-prescription drugs may impair your ability to properly assemble or safely operate the appliance.
- When cooking with oil or grease, always have a Type BC or ABC fire extinguisher readily available. In the event of an oil or grease fire, do not attempt to extinguish with water. Immediately call the fire department. A Type BC or ABC fire extinguisher may, in some circumstances, contain the fire.
- When cooking, the appliance must be on a level, stable surface in an area clear of combustible material. An asphalt surface (blacktop) may not be acceptable for this purpose.
- Do not leave the appliance unattended. Keep children and pets away from the appliance at all times.
- Do not move the appliance when in use.
- This appliance is not intended for and should never be used as a heater.



 **DANGER**  
**EXPLOSION - FIRE HAZARD**

- Never store propane near high heat, open flames, pilot lights, direct sunlight, other ignition sources or where temperatures exceed 120 degrees F (49°C).
- Propane gas is heavier than air and leaking propane will sink to the lowest level possible. It can ignite by ignition sources including matches, lighters, sparks or open flames of any kind many feet away from the original leak. If you smell gas, leave the area immediately.
- Never install or remove propane tank while outdoor grill is lighted, near flame, pilot lights, other ignition sources or while outdoor grill is hot to touch.
- During operation, this product can be a source of ignition. Never use the grill in or near areas that contain or may contain volatile or airborne combustibles, or products such as gasoline, solvents, paint thinner, dust particles or unknown chemicals. Minimum distance from sides and back of unit to walls or railings is 12 inches (30.5 cm). Do not use under overhead unprotected combustible construction.
- Provide adequate clearances around air openings into the combustion chamber.
- DO NOT use gas grill indoors or in garages, breezeways, sheds, enclosed areas or a covered porch or patio.
- Do not obstruct the flow of combustion and ventilation air.
- DO NOT put grill in storage or travel mode immediately after use. Allow grill to cool to touch before moving or storing. Failure to do so could result in fire resulting in property damage, personal injury, or death.

## **WARNING**

We cannot foresee every use which may be made of our products. **Check with your local fire safety authority if you have questions about use.**

Other standards govern the use of fuel gases and heat producing products for specific uses. Your local authorities can advise you about these.

- Never refill disposable cylinders.
- Use the preset regulator that came with the grill. Do not attempt to adjust.
- The installation and use must conform with local codes or, in absence of local codes, with the *National Fuel Gas Code, ANSI Z223.1/NFPA 54, Storage and Handling of Liquefied Petroleum Gases, ANSI/NFPA 58 or CSA B149.1, Natural Gas and Propane Installation Code.*
- This appliance is not intended to be installed in or on boats.
- This appliance is not intended for commercial use.
- DO NOT use this appliance under extended awnings. Failure to comply could result in a fire or personal injury.



## **DANGER** **CARBON MONOXIDE HAZARD**

- **For outdoor use only.**
- **Never use inside house, camper, tent, vehicle or other unventilated or enclosed areas. This grill consumes air (oxygen) and produces carbon monoxide. Do not use in unventilated or enclosed areas to avoid endangering your life.**
- This grill is a combustion appliance. All combustion appliances produce carbon monoxide (CO) during the combustion process. Do not block air flow into or out of the grill.
- Carbon Monoxide (CO) poisoning produces flu-like symptoms, watery eyes, headaches, dizziness, fatigue and possibly death. You can't see it and you can't smell it. It's an invisible killer. If these symptoms are present during operation of this product **get fresh air immediately!**

## **WARNING**

- This product is fueled by propane gas. Propane gas is invisible, odorless, and flammable. An odorant is normally added to help detect leaks and can be described as a "rotten egg" smell. The odorant can fade over time so leaking gas is not always detectable by smell alone.
- Use only propane gas set up for vapor withdrawal.

- Propane gas should be stored or used in compliance with local ordinances and codes or with ANSI/NFPA 58 and with the American Boat and Yacht Council (ABYC) Standards A-1 (9), Marine Liquefied Petroleum gas (LPG) Systems.
- Turn off propane and disconnect cylinder when not in use.
- Cylinders must be stored out of reach of children.

### **CALIFORNIA PROPOSITION 65:**

**WARNING:** This fuel, and byproducts of combustion of this fuel, contain chemicals known to the state of California to cause cancer, birth defects or other reproductive harm.

## **WARNING** **BURN HAZARD**

- Never leave grill unattended when hot or in use.
- Keep out of reach of children.



## **CAUTION** **SERVICE SAFETY**

- Keep all connections and fittings clean. Inspect propane cylinder and grill propane connections for damage before attaching.
- During set up, check all connections and fittings for leaks using soapy water. Never use a flame. Bubbles indicate a leak. Check that the connection is not cross-threaded and that it is tight. Perform another leak check. If there is still a leak, remove the cylinder and contact Jarden Consumer Solutions for service or repairs.
- Use as a cooking appliance only. Never alter in any way or use with any device or part not expressly approved by Jarden Consumer Solutions.
- Clean grill frequently to avoid grease accumulation and possible grease fires.
- Only use the pressure regulator and hose assembly provided with the unit. Replacement pressure regulators and hose assemblies must be those specified by Jarden Consumer Solutions (see replacement parts / accessories)

## **Portable L.P. (Propane) Gas Barbecue Cylinders**

Liquefied Petroleum Gas (abbreviated L.P. gas or propane) is highly flammable. It becomes liquid when stored under high pressure inside a cylinder and vaporizes when released. L.P. gas is heavier than air and tends to collect in low areas. It is important that there are no leaking connections on your gas grill that could cause a fire or explosion (see the section titled "LEAK CHECK").



## ASSEMBLY

- 1** Install legs using the 6 provided screws and a Phillips Head Screwdriver.

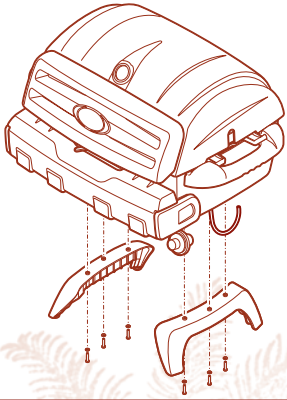

- 2** Snap Grease Vaporizer into the 4 mounting clips.

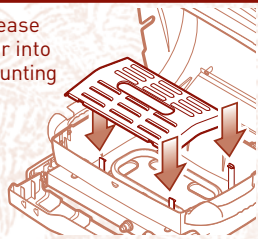

- 3** Battery Installation: Remove battery (AAA) from shipping packet and install in battery compartment. The battery compartment is located behind the electronic igniter push button on the control panel. Rotate the push button counter-clockwise to expose the battery compartment. When replacing the battery be sure to attach positive and negative ends correctly. Check the igniter by pressing the button. You should hear a "clicking spark" sound.

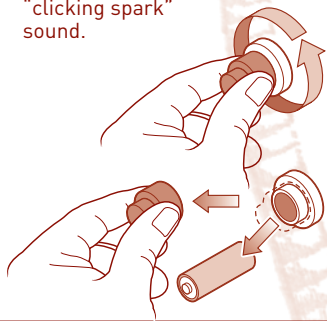

## COOKING - TABLETOP

- 1** Fold down the condiment holder to expose the electronic igniter and burner control knob. Make sure that the burner control knob is in the OFF position.

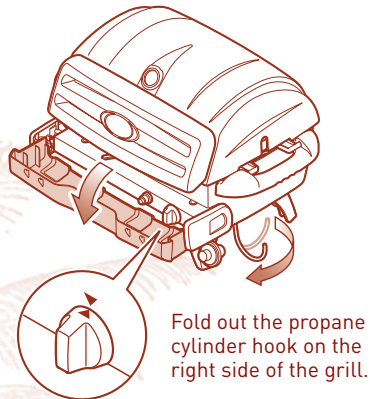

- 3** Unlatch the hood latch and open the grill hood.

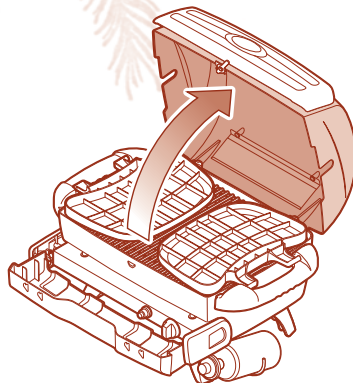

- 2** Attach a 1 lb. propane cylinder. See the instructions listed in this manual under "Attaching the Propane Cylinder".

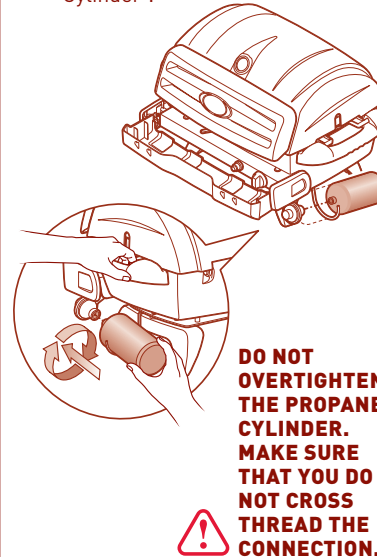

- 4** Fold out both side tables, slide drip pan into holder on the underside of the grill.

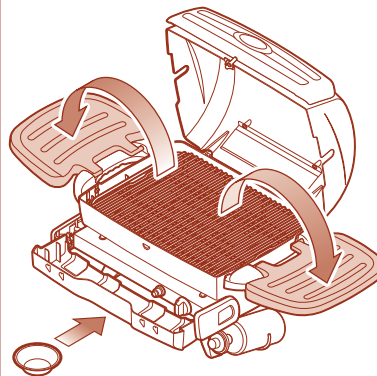

## OPERATING INSTRUCTIONS

### To light the grill:

Refer to the Lighting instructions in this owner's manual and printed on the control panel of your grill. Never light the grill without first folding out the side tables.

### To preheat the grill:

Light the grill according to the lighting instructions in this owner's manual. Close the lid and turn the burner control knob to Start/Hi. Preheat the grill for 5-10 minutes (depending on conditions such as air temperature and wind). Once the grill is preheated, set the burner control knob to the setting specified in the recipe.

**Note:** Wind and weather may require adjustment of the burner control knob to obtain the correct cooking temperature. If the burner goes out during cooking, open the lid, turn off the burner, and wait five minutes before relighting.

**Drippings and grease:** Excess drippings and grease will collect in the disposable drip pan. (Located on the underside of the grill). Use a new pan before each use and dispose of used pans properly.

### WARNINGS

- Check the drip pan and the bottom of the grill for grease build-up before each use. Remove excess grease to avoid a fire in the bottom of the grill.**
- Do not move the grill when operating or while the grill is hot.**
- Wait for the grill to cool before folding up the fold-out side tables.**
- Wait for the grill to cool before closing the arm assembly.**

### Grill Performance:

The burners are located toward the back of the grill. For indirect heat to keep food warm or cook slower, move food toward the front of the grill.

## ATTACHING THE PROPANE CYLINDER

Use 1 lb. propane cylinders. Use propane cylinders that are approximately 4 inches in diameter and 8 inches in length. The propane cylinder must fit through the cylinder hook.

**Note:** Your new grill is designed to be operated with 16.4 oz. disposable propane gas cylinders. The L.P. gas supply cylinder to be used must be constructed and marked in accordance with the specifications for L.P. gas cylinders of the U.S. Department of Transportation (DOT) or the National Standard of Canada. *CAN/CSA B339, Cylinders, Spheres and Tubes for the Transportation of Dangerous Goods.*

**CAUTION:** Use cylinders that are marked "Propane Fuel" only. Prior to installing the cylinder, check to make sure its fitting is not damaged or bent. If the propane cylinder is damaged, DO NOT install it on your grill.

When installing the cylinder, be sure that it screws in securely in a smooth and straight manner.

**DO NOT CROSS THREAD.**

Slide propane cylinder through cylinder hook, (Figure below). While holding carrying handle closest to propane cylinder with one hand, push propane cylinder into regulator and turn clockwise until tight.

The propane cylinder must be removed prior to storing or transporting your grill. **Do not carry or drive with the cylinder attached.**

**WARNING:** Do not use a wrench to tighten the connection. Using a wrench could damage the regulator coupling and could cause a leak.

**WARNING:** CHECK FOR GAS LEAKS BY WETTING THE CONNECTIONS WITH A SOAP AND WATER SOLUTION AND WATCHING FOR BUBBLES. IF BUBBLES FORM OR IF A BUBBLE GROWS, THERE IS A LEAK.

**NOTE:** ALL CONNECTIONS SHOULD BE RINSED WITH CLEAN WATER AFTER CHECKING FOR LEAKS.

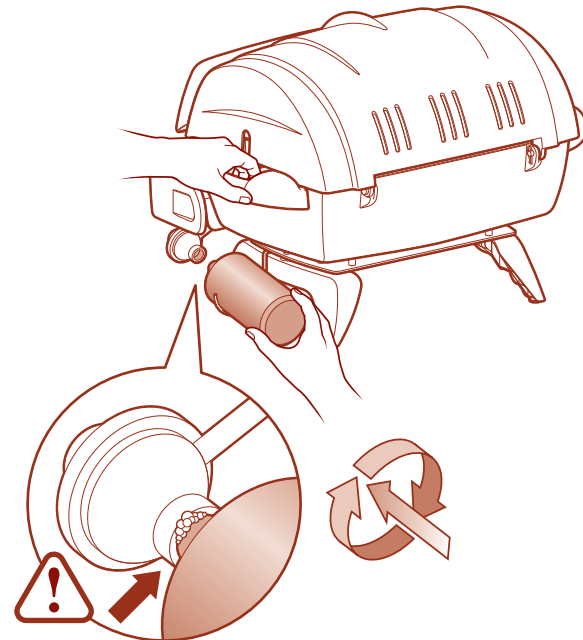

## Check for gas leaks:

**WARNINGS**  
You should check for gas leaks every time you disconnect and reconnect a gas fitting.

**Note:** All factory-made connections have been thoroughly checked for gas leaks. The burners have been flame tested.

As a safety precaution check all fittings for leaks before using your Grill. Shipping and handling may have loosened or damaged a gas fitting.

Perform these leak checks even though your grill has been pre-assembled.

Do not ignite burner while checking for leaks.

## Check connections:

1) Regulator to propane cylinder connection.

**WARNING:** If there is a leak at connection, remove propane cylinder. Do not operate grill. Use a different propane cylinder and recheck for leaks with soap and water solution. If a leak persists after retightening the propane cylinder, turn OFF the gas. DO NOT OPERATE THE GRILL.

2) Valve-to-regulator connections.

### WARNINGS

If there is a leak at the valve-to-regulator connection turn OFF the gas. DO NOT OPERATE THE GRILL.

When leak checks are complete, turn gas supply OFF at the source and rinse connections with water.

**DANGER** Do not use an open flame to check for gas leaks.

**DANGER** Be sure there are no sparks or open flames in the area while you check for leaks. Sparks or flames may result in a fire or explosion, which can cause serious bodily injury or death, and damage to property.

**DANGER** Do not store a spare L.P. gas cylinder under or near this appliance. 1 lb. cylinders are not refillable. If the instructions are not followed exactly, a fire causing death or serious injury may occur.

## LIGHTING

A summary of the lighting instructions is printed on the control panel.

- 1) Fold down the condiment holder to expose the burner control knob and electronic igniter button.
- 2) Make sure the burner control knob is turned OFF. (Push control knob in and turn clockwise to ensure that it is in the OFF position.)
- 3) Open the lid.
- 4) Unfold the side tables.

**WARNING:** Do not lean over the open grill. Keep your face and body at least one foot away from the grate when lighting the grill.

- 5) Push control knob in and turn counterclockwise to START/HI. (Figure below).
- 6) Push the electronic igniter button (you should hear a clicking sound). Burner should ignite.
- 7) Check that the burner is lit by looking down through the cooking grate. You should see a flame.

**WARNING:** If the burner does not light, turn the burner control knob to OFF and wait 5 minutes to let the gas clear before you try again or try to light with a match.

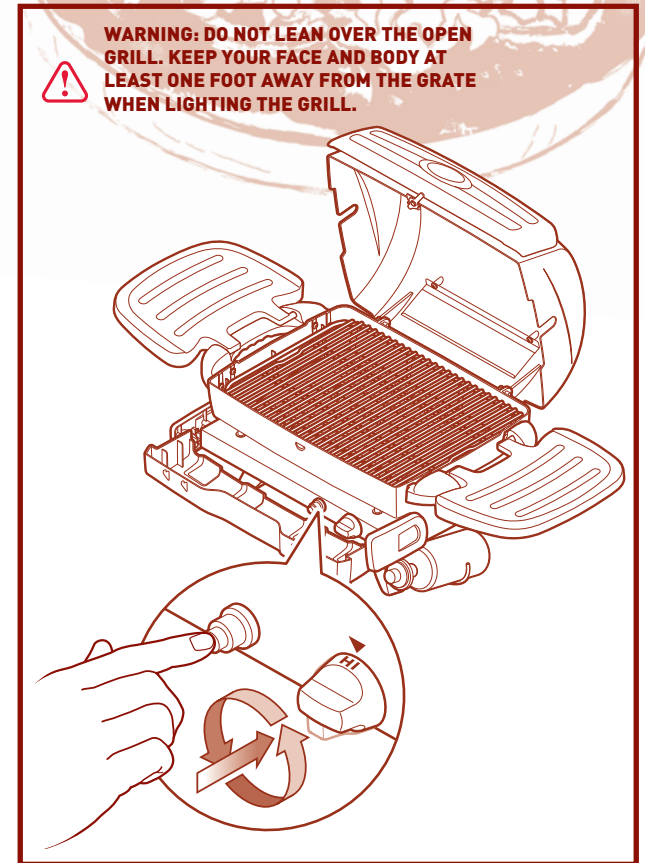

## To Extinguish:

Push in and turn burner control knob clockwise to the OFF position.

**CAUTION:** Do not fold in side tables until grill is cold.

Remove propane cylinder after use and before transporting.

## Manual Lighting:

**!** **DANGER** Failure to open the lid while igniting the grill's burner, or not waiting 5 minutes to allow the gas to clear if the grill does not light, may result in an explosive flame-up, which can cause serious bodily injury or death.

- 1) Fold down condiment holder to expose burner control knob.
- 2) Open the lid.
- 3) Unfold the side tables.
- 4) Make sure the burner control knob is turned OFF.
- 5) Strike a match and put the flame into the matchlight hole on the right side of the lower grill basin.
- 6) Push burner control knob in and turn to START/HI.
- 7) Check that the burner is lit by looking down through the cooking grate. You should see a flame.

**!** **WARNING:** If the burner does not light, turn the burner control knob to OFF and wait 5 minutes to let the gas clear before you try attempting to re-light.

**!** **WARNING:** DO NOT LEAN OVER THE OPEN GRILL. KEEP YOUR FACE AND BODY AT LEAST ONE FOOT AWAY FROM THE GRATE WHEN LIGHTING THE GRILL.

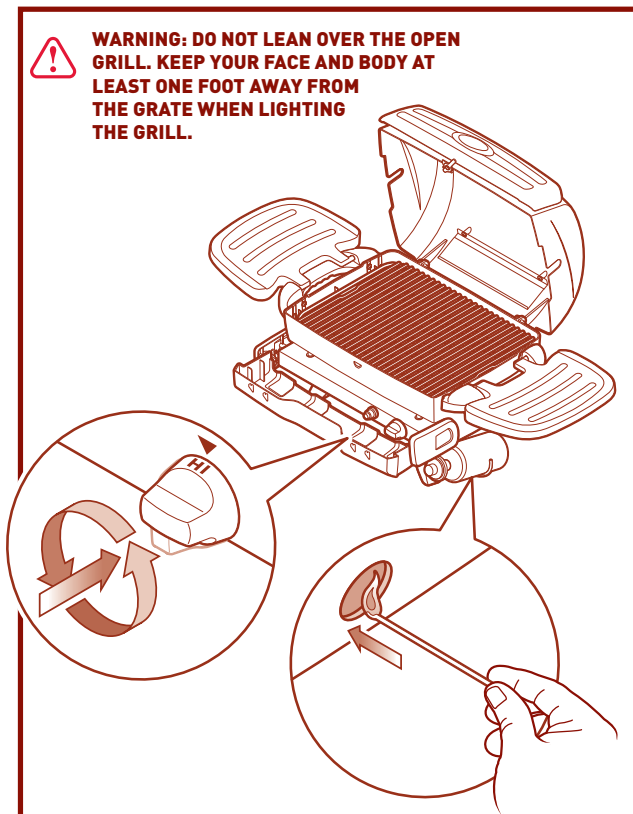

## To Properly Remove the Gas Cylinder for Cleaning, Transport, or Storage:

- 1) Make sure the burner knob is turned OFF. Push control knob in and turn clockwise to ensure that it is in the OFF position.
- 2) While holding the handle closest to the propane cylinder with one hand, turn cylinder counter-clockwise until removed.

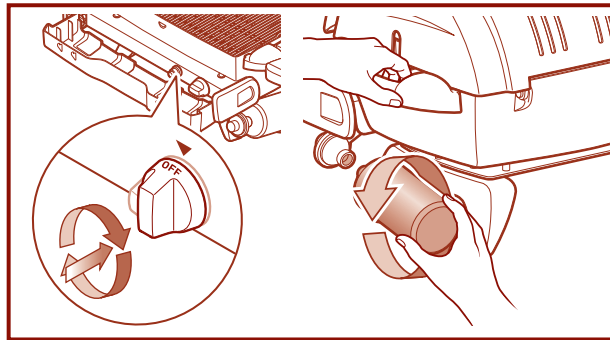

## CLEANING

**!** **WARNING:** Turn your grill OFF and wait for it to cool before cleaning.

For availability of replacement cooking grate go to [margaritavillecargo.com](http://margaritavillecargo.com) or call Margaritaville® Cargo directly at 1-877-689-2737.

**Outside surfaces:** Use a warm soapy water solution to clean, then rinse with water.

**Cooking grate:** Clean with a soft brass bristle brush. As needed, remove from grill and wash with warm soapy water then rinse with water.

**Drip pan:** A disposable drip pan is included with the grill. Foil pot pie pans (4 3/8") are available at most grocery stores or replacements can be ordered at [margaritavillecargo.com](http://margaritavillecargo.com) or call 1-877-689-2737. To clean the tray, wash with warm soapy water, then rinse.

**Inside grill basin:** Wash inside of grill basin with warm soapy water and a water rinse.

**Inside Lid:** While lid is warm, wipe inside with paper towel to prevent grease build-up.

**Fold out side tables:** Wash with a soft cloth and a soap and water solution. Do not use cleaners that contain acid or mineral spirits. Rinse well after cleaning.

**Fold out side tables are not to be used as cutting boards.**

## ANNUAL MAINTENANCE

After a period of nonuse, we recommend that you perform the following maintenance procedures for your safety. Inspect and clean the burner tube. Inspect the burner for correct flame pattern. Clean if necessary, following the procedures outlined in the "General Maintenance" section of this manual. Check all gas fittings for leaks following the instructions listed in this manual under "**Check for gas Leaks**".

### Inspection and cleaning of Burner Tube:

Your grill, as well as any outdoor gas appliance, is a target for spiders and other insects. They can nest in the venturi section of the burner tube. This blocks the normal gas flow, and can cause the gas to flow back out of the air shutter. This could result in a fire in and around the air shutter, causing serious damage to your grill.

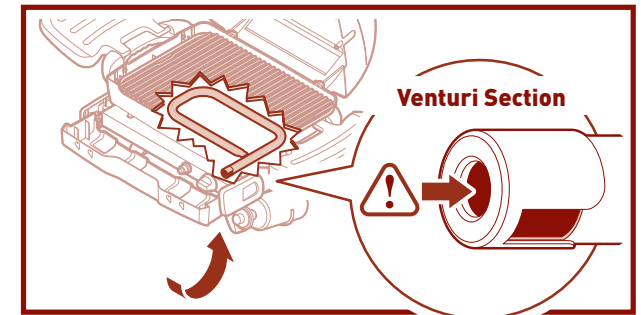

To inspect the burner tube, look up from directly below the burner control knob. If there is dust or dirt in the tube, remove the burner tube for cleaning.

**!** **CAUTION:** Do not clean the burner tube with hard or sharp tools.

Lightly tap the burner tube to get debris and dirt out. Once burner tube is clean replace it in the grill. If the burner tube becomes damaged or cannot be cleaned, visit [www.margaritavillecargo.com](http://www.margaritavillecargo.com) or call 1-877-689-2737 for replacement parts.

- 1) The smell of gas in conjunction with the burner flames appearing yellow and lazy.
- 2) Grill does not reach temperature.
- 3) Grill heats unevenly.
- 4) Burner does not ignite.

**!** **DANGER** Failure to correct the above mentioned symptoms may result in a fire, which can cause serious bodily injury or death, and cause damage to property.



## Main Burner Flame Pattern:

The grill's burner has been factory set for the correct air and gas mixture. The correct flame pattern is shown:

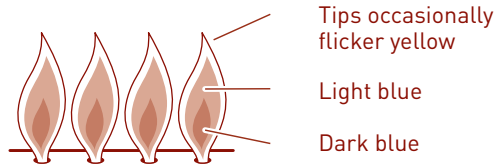

If the flames do not appear to be uniform throughout the burner tube, follow the instructions listed in this manual under "Main Burner Cleaning Procedure".

## Air Mixture Adjustment:

The air mixer sleeve for the burner has been pre-set at the factory for gas conditions at sea level. However, if the burner flame is too yellow (this may occur at higher altitudes) open the air mix sleeve slightly until the flame turns blue.

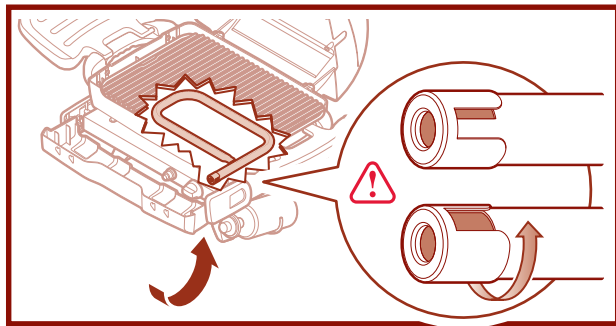

## GENERAL MAINTENANCE Main Burner Cleaning Procedure:

Turn off the gas supply. Remove the burner. (See below) Look inside the burner with a flashlight. Clean the inside of the burner with a wire. (A straightened-out coat hanger will work) Check and clean the opening at the end of the burner. Check and clean the valve orifice at the base of the valve. Use a Steel bristle brush to clean outside of burner. This is to make sure all the burner ports are fully open.

 **CAUTION: Do not enlarge the burner ports when cleaning.**

## Removing Burner Tube:

- 1) Your grill must be OFF and cool.
- 2) Unscrew and remove propane cylinder from the valve/regulator assembly.
- 3) Open the lid.
- 4) Remove cooking grate.
- 5) Remove the drip vaporizer.
- 6) Unscrew and remove the (3) 1/4" screws that hold the burner tube inside grill basin.
- 7) Carefully slide the burner tube out from the grill basin.
- 8) To reinstall the burner, reverse the above steps. Check proper assembly before fastening burner tube in place.

 **CAUTION: The burner opening must be positioned properly over the valve orifice.**

## Ignition System Operations:

This appliance has an electronic igniter that uses a triple A battery (AAA - V.), (battery should be checked periodically). The grill can also be lit using a match, via the flame view window. Follow the lighting instructions exactly when lighting the grill.

## Battery Check:

The battery compartment is located behind the electronic igniter push button on the control panel. Rotate the push button counter-clockwise to expose the battery compartment. When replacing the battery be sure to attach positive and negative ends correctly. Check the igniter by pressing the button. You should hear a "clicking spark" sound.

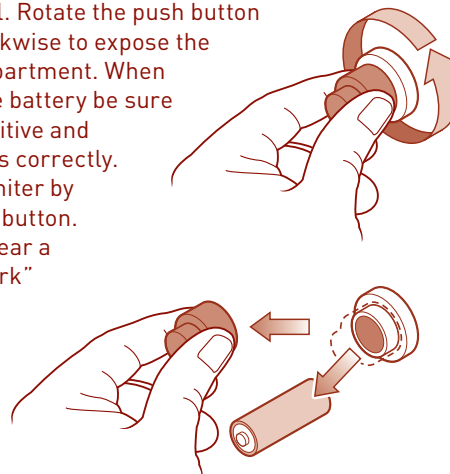





## Storage, Transport and/or Non-use

When the grill is not in use or is being transported, the propane cylinder must be **DISCONNECTED** and the propane cylinder stored in a well-ventilated space.

### DO NOT DRIVE WITH THE CYLINDER ATTACHED!

The grill should be checked for gas leaks and any obstructions in the burner tubes before using. (See Sections: "General Maintenance and Annual Maintenance.") The burner tube should also be checked for any obstructions. (See Section: "Annual Maintenance.")

If grill is to be stored for a long time, remove battery from electronic igniter.

-  **DANGER EXPLOSION - FIRE HAZARD** 
-  **Never store propane near high heat, open flames, pilot lights, direct sunlight, other ignition sources or where temperatures exceed 120 degrees F (49°C).**
-  **The cylinder must be disconnected when the grill is in storage.**
-  **Do not store a spare L.P. gas cylinder under or near this appliance. Failure to follow the above instructions exactly may result in fire causing death or serious injury.**

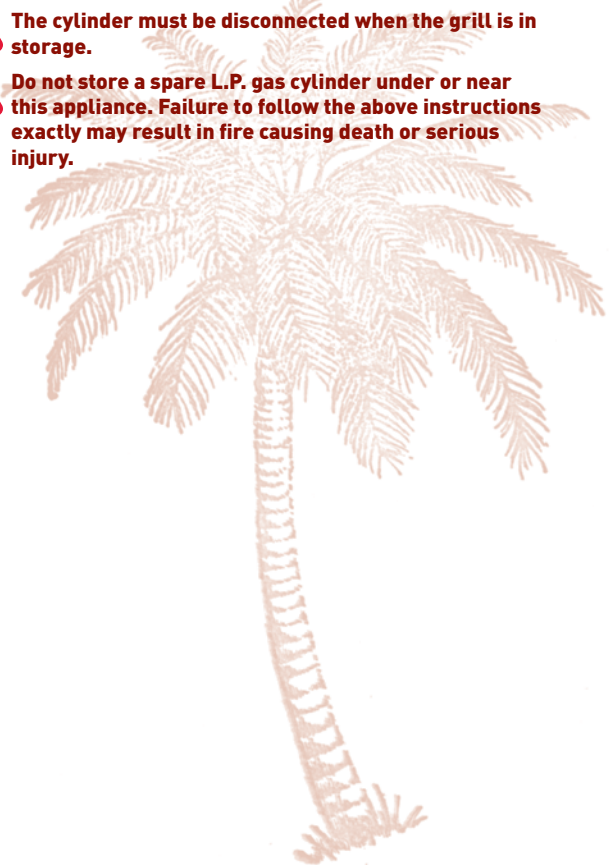

# PARTS CALLOUT LIST - LG1000 & LG1900 Series

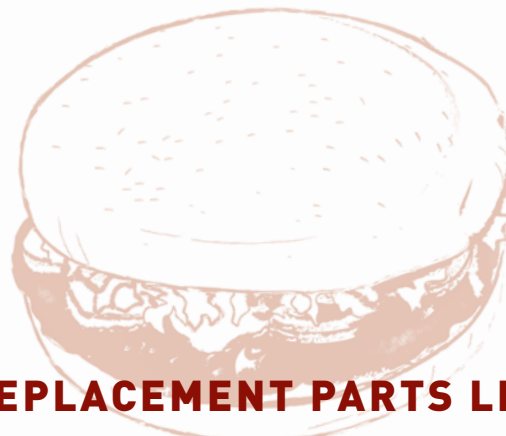
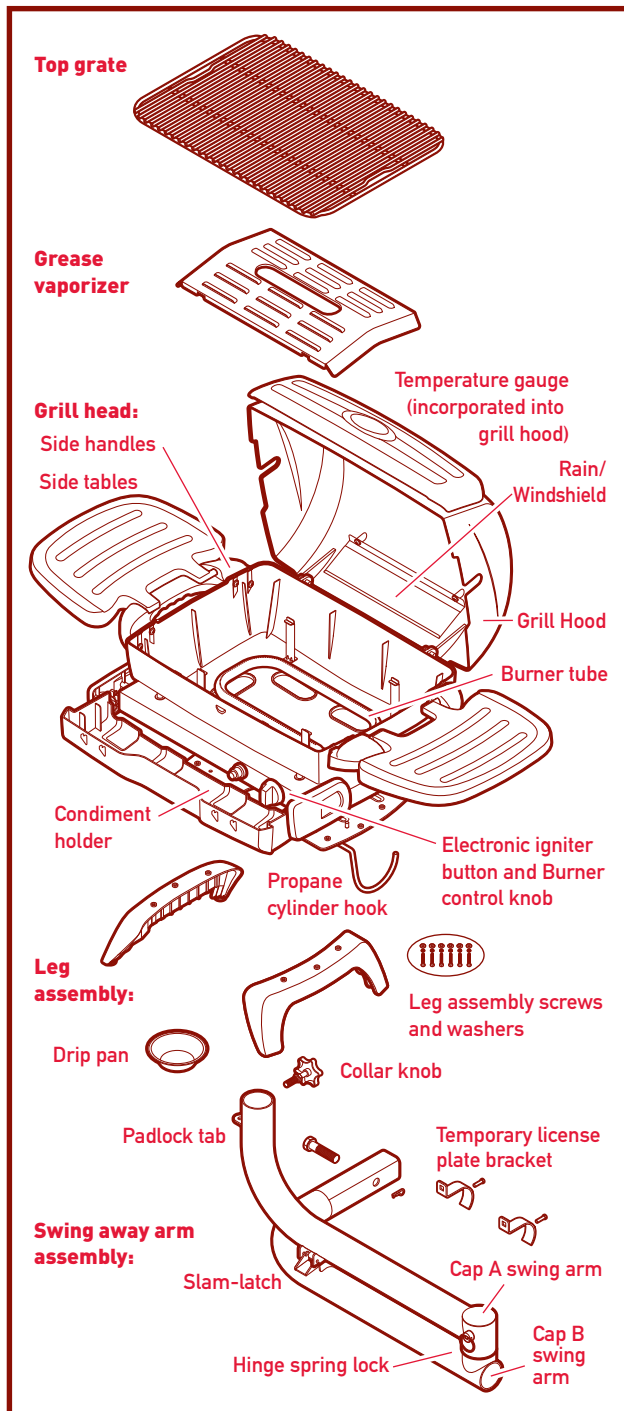

## REPLACEMENT PARTS LIST

DESCRIPTION	PART #
Instruction Manual	134912
Top Cooking Grate	134891
Grease Vaporizer	134893
Grill Hood	134910
Temperature Gauge Set	134894
Rain/Wind Shield	134895
Side Shelf/Table (2)	134902
Side Handle Assembly (2)	134903
SS Burner Tube Assembly	134897
Condiment Holder	134904
Electronic Igniter Electrode Set	134892
Burner Control Knob	134898
Propane Cylinder Hook	134899
Grill Legs (2)	134906
Drip Pan	134896
Collar Knob	134900
Stabilizer Bolt and Cotter Pin	134907
License Plate Bracket Assembly	134901
Plastic End Cap - A Swing Arm	134908
Plastic End Cap - B Support Arm	134909
Swing Away Arm Assembly	136562

## ACCESSORIES (Sold Separately) - LG1000 & LG1900 Series

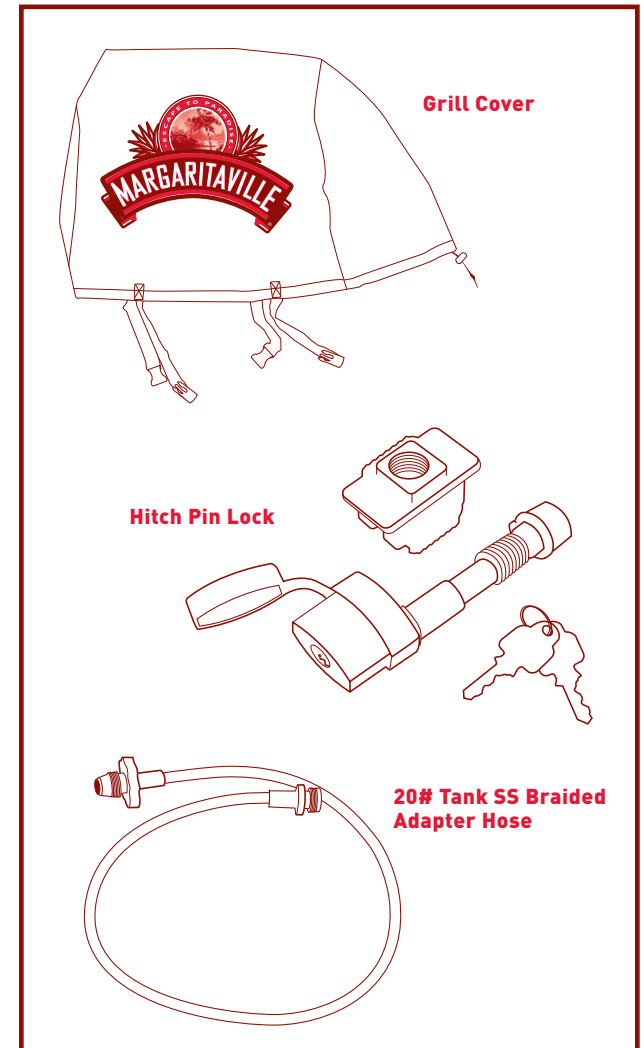

DESCRIPTION	PART #
Grill Cover	134905
Hitch Pin Lock	26130
20# Tank SS Braided Adapter Hose	100714-A00

To order replacement parts or accessories, visit  
[www.margaritavillecargo.com](http://www.margaritavillecargo.com)

# TROUBLESHOOTING

## PROBLEM OBSERVED

- Gas odor during set up.
- Gas odor before first ignition.
- When ignition button is pressed, there is no spark at burner electrode.
- When igniter button is pressed, there is spark at the electrode, but no ignition.
- Delayed ignition.
- Burner lights but does not stay lit.
- Incorrect burner flame.
- Backfire of burner.

## POSSIBLE CAUSE

- Gas leak.
- Gas leak.
- Battery dead or missing.
- Igniter electrode or switch wires not connected or damaged.
- Broken electrode or switch wires.
- Electrode positioned improperly.
- Faulty electronic igniter.
- Electronic ignition is wet.
- Gas supply not turned on.
- Burner control knob not in HIGH ON position.
- Air in gas lines not fully bled from system.
- Low gas pressure.
- Faulty Regulator.
- Electrode positioned improperly.
- Low gas pressure.
- Clogged or dirty burner ports.
- Blocked orifice.
- Faulty valve.
- Out of gas.
- Low gas pressure.
- Faulty valve.
- Clogged or dirty burner ports.
- Faulty regulator.
- Windy conditions.
- Out of gas.
- Incorrect gas supply or pressure.
- Incorrect primary air mix.
- Blocked orifice.
- Clogged or dirty burner ports.
- Faulty valve.
- Faulty regulator.
- High altitude.
- Blocked orifice.
- Clogged or dirty burner ports.
- Incorrect primary air mix.

## CORRECTIVE MEASURE

- Refer back to Page 1 "DANGER If you smell gas". Check all gas connections.
- Refer back to Page 1 "DANGER If you smell gas". Check all gas connections.
- Replace battery.
- Reconnect or replace electrode wires.
- Replace broken electrode or wires.
- Reposition electrode - 3/16" clearance.
- Replace electronic igniter.
- Keep ignition system dry.
- Turn on gas supply.
- Follow Operational Instructions.
- Bleed air from system.
- Check gas supply pressure.
- Replace regulator.
- Reposition electrode - 3/16" clearance.
- Check gas supply pressure.
- Clean burner ports - see manual section.
- Check orifice opening.
- Replace valve.
- Replace propane cylinder.
- Check gas supply pressure.
- If using the hose adaptor, refer to lighting instructions enclosed with the hose adaptor.
- Replace valve.
- Clean burner ports - see manual section.
- Replace regulator.
- Shield from wind.
- Replace propane cylinder.
- Check gas supply pressure.
- Adjust air mixer - see manual section.
- Check orifice opening.
- Clean burner ports - see manual section.
- Replace valve.
- Replace regulator.
- Adjust orifice size for altitude.
- Check orifice opening.
- Clean burner ports - see manual section.
- Adjust air mixer - see manual section.

## 3 Year Limited Warranty

Sunbeam Products, Inc., doing business as Jarden Consumer Solutions or if in Canada, Sunbeam Corporation (Canada) Limited doing business as Jarden Consumer Solutions (collectively "Jarden Consumer Solutions") warrants that for a period of three years from the date of purchase, this product will be free from defects in material and workmanship. Jarden Consumer Solutions, at its option, will repair or replace this product or any component of the product found to be defective during the warranty period. Replacement will be made with a new or remanufactured product or component. If the product is no longer available, replacement may be made with a similar product of equal or greater value. This is your exclusive warranty.

This warranty is valid for the original retail purchaser from the date of initial retail purchase and is not transferable. Keep the original sales receipt. Proof of purchase is required to obtain warranty performance. Jarden Consumer Solutions dealers, service centers, or retail stores selling Jarden Consumer Solutions products do not have the right to alter, modify or in any way change the terms and conditions of this warranty.

This warranty does not cover normal wear of parts or damage resulting from any of the following: negligent use or misuse of the product, road hazards, exposure to the elements and weather, use contrary to the operating instructions, disassembly, repair or alteration by anyone other than Jarden Consumer Solutions or an authorized Jarden Consumer Solutions service center. Further, the warranty does not cover: Acts of God, such as fire, flood, hurricanes and tornadoes.

### What are the Limits on Jarden Consumer Solutions' Liability?

Jarden Consumer Solutions shall not be liable for any incidental or consequential damages caused by the breach of any express, implied or statutory warranty or condition.

Except to the extent prohibited by applicable law, any implied warranty or condition of merchantability or fitness for a particular purpose is limited in duration to the duration of the above warranty.

Jarden Consumer Solutions disclaims all other warranties, conditions or representations, express, implied, statutory or otherwise.

Jarden Consumer Solutions shall not be liable for any damages of any kind resulting from the purchase, use or misuse of, or inability to use the product including incidental, special, consequential or similar damages or loss of profits, or for any breach of contract, fundamental or otherwise, or for any claim brought against purchaser by any other party.

Some provinces, states or jurisdictions do not allow the exclusion or limitation of incidental or consequential damages or limitations on how long an implied warranty lasts, so the above limitations or exclusions may not apply to you.

This warranty gives you specific legal rights, and you may also have other rights that vary from province to province, state to state or jurisdiction to jurisdiction.

### How to Obtain Warranty Service

If you have any question regarding this warranty or would like to obtain warranty service, please call 1-877-689-2737 and a convenient service center address will be provided to you.

In the U.S.A., this warranty is offered by Sunbeam Products, Inc., doing business as Jarden Consumer Solutions, located in Boca Raton, Florida 33431.

**PLEASE DO NOT RETURN THIS PRODUCT TO ANY OF THESE ADDRESSES OR TO THE PLACE OF PURCHASE.**

134912 Rev SUB





DO NOT RETURN THIS PRODUCT TO THE PLACE OF PURCHASE

For product questions:

Jarden Consumer Services U.S.A.  
1-877-689-2737

[www.margaritavillecargo.com](http://www.margaritavillecargo.com)

© 2009 Sunbeam Products, Inc. doing business as Jarden Consumer Solutions.  
All rights reserved. Distributed by Sunbeam Products, Inc. doing business as  
Jarden Consumer Solutions, Boca Raton, Florida 33431

Margaritaville® is a registered trademark of Margaritaville®.

Printed in China

134912 Rev SUB

CSDW 060509



## Free Manuals Download Website

<http://myh66.com>

<http://usermanuals.us>

<http://www.somanuals.com>

<http://www.4manuals.cc>

<http://www.manual-lib.com>

<http://www.404manual.com>

<http://www.luxmanual.com>

<http://aubethermostatmanual.com>

Golf course search by state

<http://golfingnear.com>

Email search by domain

<http://emailbydomain.com>

Auto manuals search

<http://auto.somanuals.com>

TV manuals search

<http://tv.somanuals.com>