



BMG-74



*The only bottom mounted glass door reach-ins with low maintenance bare tube condenser coils.*

## BMG SERIES

### Bottom Mounted Medium Temp Glass Door Merchandisers

#### MODELS

- BMG-27
- BMG-48
- BMG-52
- BMG-74
- BMG-80

## FEATURES

#### CONSTRUCTION

- 24 gauge painted steel interior and exterior
- Cord and plug standard on all self-contained models
- Replaceable magnetic vinyl door gaskets
- Five white epoxy-coated, heavy-duty, welded wire shelves with price tag molding per door (four cantilever and one bottom)
- Cantilever shelves are two-position and adjustable in 1" increments
- Equipped with high output 800 milliamp lamps and ballasts
- Independent on/off light switch
- 2" foamed-in-place "zero ODP" urethane insulation

#### FINISH

- Sparkling white polyester enamel interior and exterior

#### DOORS

- Door size:  
 BMG-27 ..... 30" x 63"  
 BMG-48/74 ..... 25<sup>1</sup>/<sub>8</sub>" x 63"  
 BMG-52/80 ..... 27<sup>1</sup>/<sub>8</sub>" x 63"
- Black door rails and handles
- Extra large, auto-close, triple pane, safety glass doors
- 90° hold-open feature
- Adjustable torsion bar hinges
- Door hinges easily adjustable for closing tension and leveling

#### REFRIGERATION

- Self-contained, factory tested, bottom mounted refrigeration system
- Top mounted low profile interior fan housing
- Automatic condensate evaporator
- Refrigerant: R-134a
- Temperature range:  
 34° to 41°F (1° to 5°C)

- R-factor (insulation efficiency rating): 17.24

#### WARRANTY

- Standard limited four year extended compressor and one year limited parts and labor

#### OPTIONS

- Add suffix "R" for remote system (For BMG-48 and BMG-74 only)
- Custom colors
- Baskets
- Casters
- Additional shelves



# BMG SERIES BOTTOM MOUNTED MEDIUM TEMP GLASS DOOR MERCHANDISERS

## TECHNICAL SPECIFICATIONS

MODEL	DIMENSIONS (in.)			DIMENSIONS (mm)			VOLTS	AMPS	UNIT H.P.	NO. OF DOORS	CAP. CU. FT.	SHIP CU. FT.	SHIP WT. (LB/KG)
	L	D	H	L	D	H							
BMG-27	31	36 <sup>3</sup> / <sub>4</sub>	79	787	933	2007	115	8.0	1/3	1	27.5	79.0	520/236
BMG-48	52	36 <sup>3</sup> / <sub>4</sub>	79	1321	933	2007	115	8.0	1/3	2	49.0	117.0	755/343
BMG-52	56	36 <sup>3</sup> / <sub>4</sub>	79	1422	933	2007	115	8.0	1/3	2	53.0	128.0	775/352
BMG-74	78	36 <sup>3</sup> / <sub>4</sub>	79	1981	933	2007	115	12.0	1/2	3	75.5	168.0	1025/466
BMG-80	84	36 <sup>3</sup> / <sub>4</sub>	79	2134	933	2007	115	12.0	1/2	3	81.6	185.0	1065/484

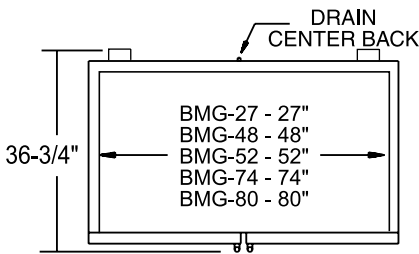

PLAN VIEW

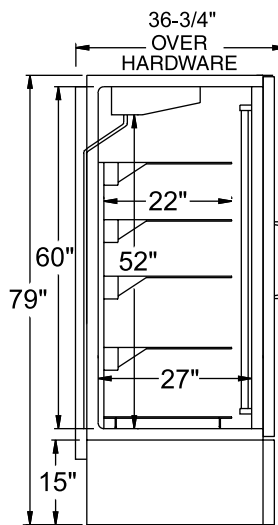

SIDE VIEW

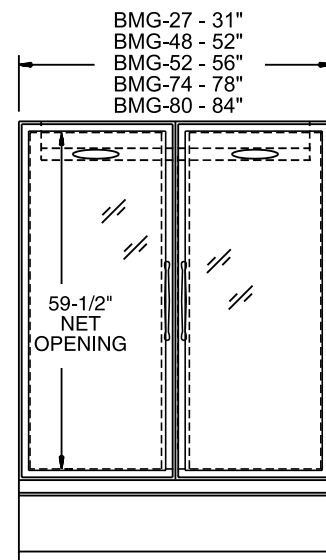

ELEVATION VIEW

## LISTINGS



## HOOKUP

Via plug in, 9 foot long, flexible three wire 14/3 cord with molded plug.



## BID SPECIFICATIONS

Item no. BMG-\_\_\_\_\_ .  
Provide \_\_\_\_\_ ( )  
Bottom Mounted Medium Temp Glass Door Merchandiser(s), Master-Bilt model no. BMG-\_\_\_\_\_ .

Merchandiser to be provided with adjustable torsion bar hinges, top mounted low profile interior fan housing, automatic condensate evaporator, 800 milliamp

bulbs, independent on/off light switch and black door rails and handles. Merchandiser also to be equipped with five white epoxy-coated shelves (four cantilever and one bottom) with price tag molding per door.

The refrigeration system is to be bottom mounted, self-contained and use R-134a refrigerant. System will contain a low main-

tenance bare tube condenser coil. The temperature range will be 34° to 41°F (1° to 5°C).

Merchandiser to have standard limited four year extended compressor warranty and one year limited parts and labor warranty. Merchandiser to be UL, C-UL and NSF listed.

**NOTE:** Cabinet designed for optimum performance in air-conditioned area at 75°F ambient and 55% relative humidity. All specifications subject to change without notice.



908 Highway 15 North • New Albany, MS 38652  
PHONE: 800-647-1284 or 662-534-9061 • FAX: 800-232-3966 or 662-534-6049 • www.master-bilt.com



## Free Manuals Download Website

<http://myh66.com>

<http://usermanuals.us>

<http://www.somanuals.com>

<http://www.4manuals.cc>

<http://www.manual-lib.com>

<http://www.404manual.com>

<http://www.luxmanual.com>

<http://aubethermostatmanual.com>

Golf course search by state

<http://golfingnear.com>

Email search by domain

<http://emailbydomain.com>

Auto manuals search

<http://auto.somanuals.com>

TV manuals search

<http://tv.somanuals.com>