

INSTRUCTION SHEET SPECIFICATIONS	
Toy:	BMB BATTLE CAPE
Toy No.:	N9303
Part No.:	0920
Trim Size:	A4
Folded Size:	A5
Type of Fold:	4
# colors:	One
Colors:	Black
Paper Stock:	White Offset
Paper Weight:	70 lb.
EDM No.:	

2.

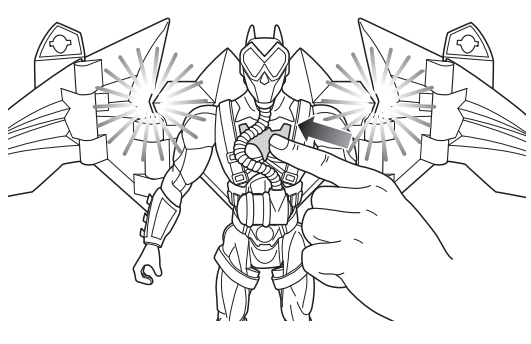

3.

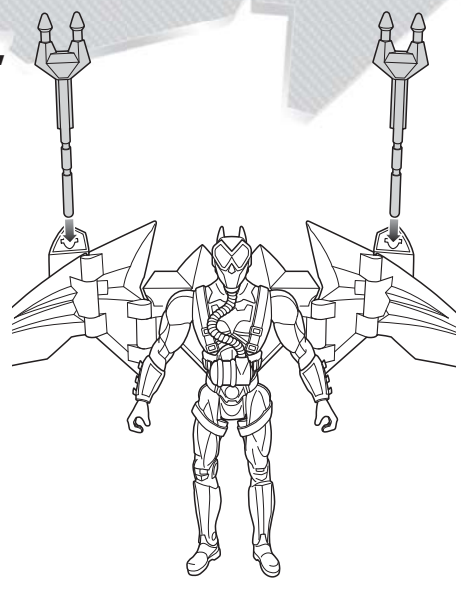

4.

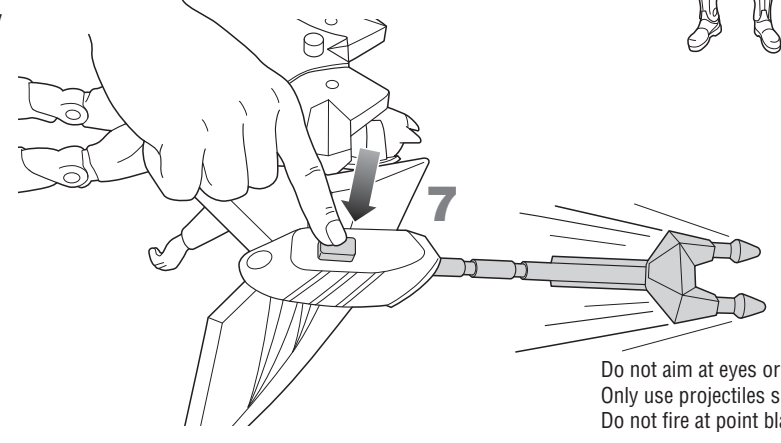

Do not aim at eyes or face.
Only use projectiles supplied with this toy.
Do not fire at point blank range.

RECYCLE INFORMATION (USA ONLY)

- Please recycle button cell battery(ies) contained in this product by:
- Visiting your nearest recycling center. For location of the nearest recycling center, visit us online at www.service.mattel.com.
 - If a recycling center is not available in your area, contact us for a pre-paid mailing label. Visit us online at www.service.mattel.com or call toll-free at 1-800-524-8697.
 - Valid in the US only. • Solo válido en los EE.UU. • Valable aux États-Unis seulement.

Mattel, Inc. All Rights Reserved.

Mattel, Inc., 333 Continental Blvd., El Segundo, CA 90245 U.S.A. Consumer Relations 1 (800) 524-8697. Retain this address for future reference. • Mattel Canada Inc., Mississauga, Ontario L5R 3W2. You may call us free at 1-800-524-8697. • Mattel U.K. Ltd., Vanwall Business Park, Maidenhead SL6 4UB. Helpline 01628 500303. • Mattel Australia Pty., Ltd., Richmond, Victoria. 3121. Consumer Advisory Service - 1300 135 312. • Mattel East Asia Ltd., Room 1106, South Tower, World Finance Centre, Harbour City, Tsimshatsui, HK, China. • Diimport & Diedarkan Oleh: Mattel SEA Ptd Ltd. (993532-P) Lot 13.5, 13th Floor, Menara Lien Hoe, Persiaran Tropicana Golf Country Resort, 47410 PJ. Tel: 03-78803817, Fax: 03-78803867.

BATMAN and all related characters and elements are trademarks of and © DC Comics. (s08)



INSTRUCTIONS

4+

Please keep these instructions for future reference as they contain important information.

CONTENTS

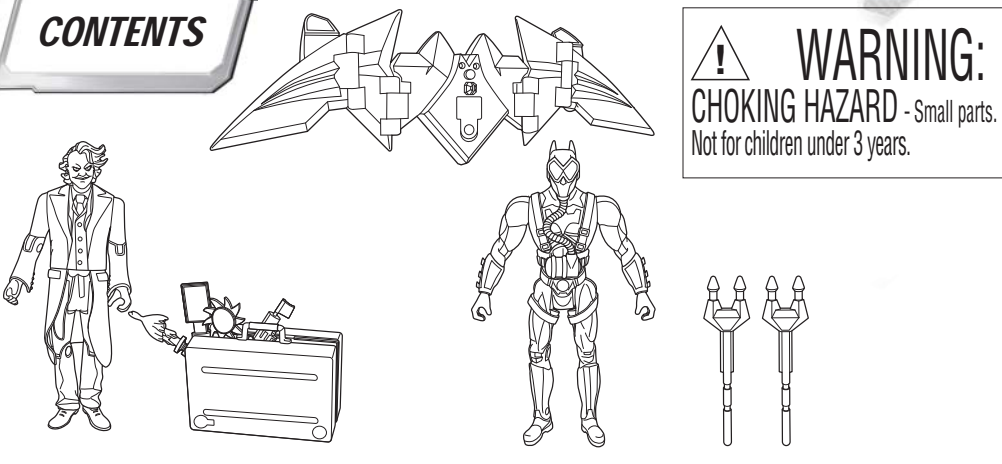

WARNING:
CHOKING HAZARD - Small parts.
Not for children under 3 years.

Requires 2 AG3 (LR41) or equivalent button-cell batteries. Batteries included are for demonstration purposes.

BATTERY INSTALLATION

Unscrew the battery cover with a Phillips head screwdriver (not included). Remove batteries included for demonstration purposes and dispose of them safely. Install 2 AG3 (LR41) or equivalent button-cell batteries in the orientation (+/-) shown. Replace battery cover and tighten screw. Replace the batteries if lights and sounds play slowly or distort.

1.

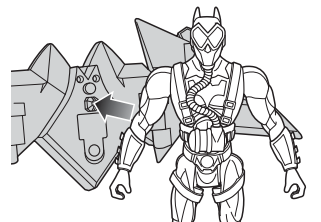

2.

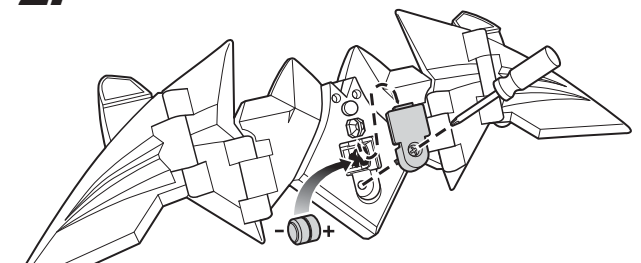

3.

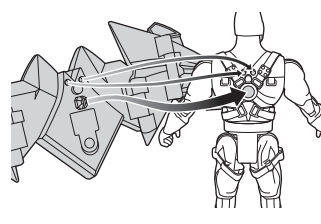

BATTERY SAFETY INFORMATION

- In exceptional circumstances batteries may leak fluids that can cause a chemical burn injury or ruin your product. To avoid battery leakage:
- Non-rechargeable batteries are not to be recharged.
 - Rechargeable batteries are to be removed from the product before being charged (if designed to be removable).
 - Rechargeable batteries are only to be charged under adult supervision (if designed to be removable).
 - Do not mix alkaline, standard (carbon-zinc), or rechargeable (nickel-cadmium) batteries.
 - Do not mix old and new batteries.
 - Only batteries of the same or equivalent type as recommended are to be used.
 - Batteries are to be inserted with the correct polarity.
 - Exhausted batteries are to be removed from the product.
 - The supply terminals are not to be short-circuited.
 - Dispose of battery(ies) safely.
 - Do not dispose of this product in a fire. The batteries inside may explode or leak.



Protect the environment by not disposing of this product with household waste (2002/96/EC). Check your local authority for recycling advice and facilities.

ASSEMBLY

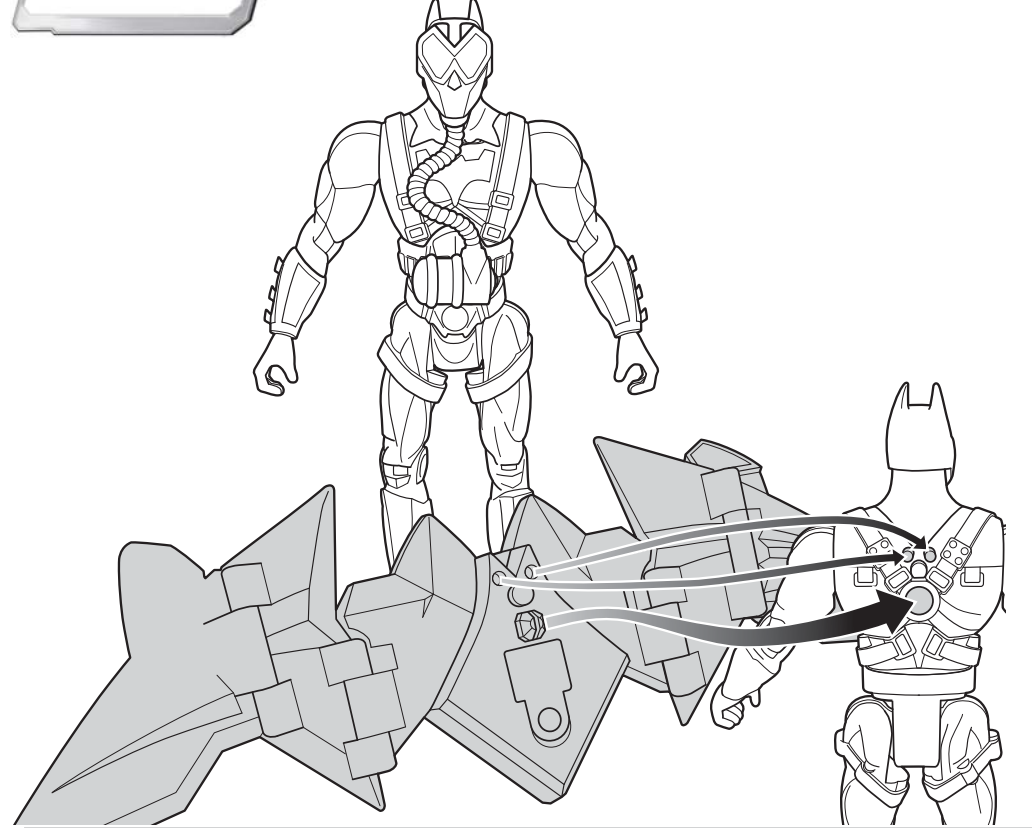

TO PLAY

1.

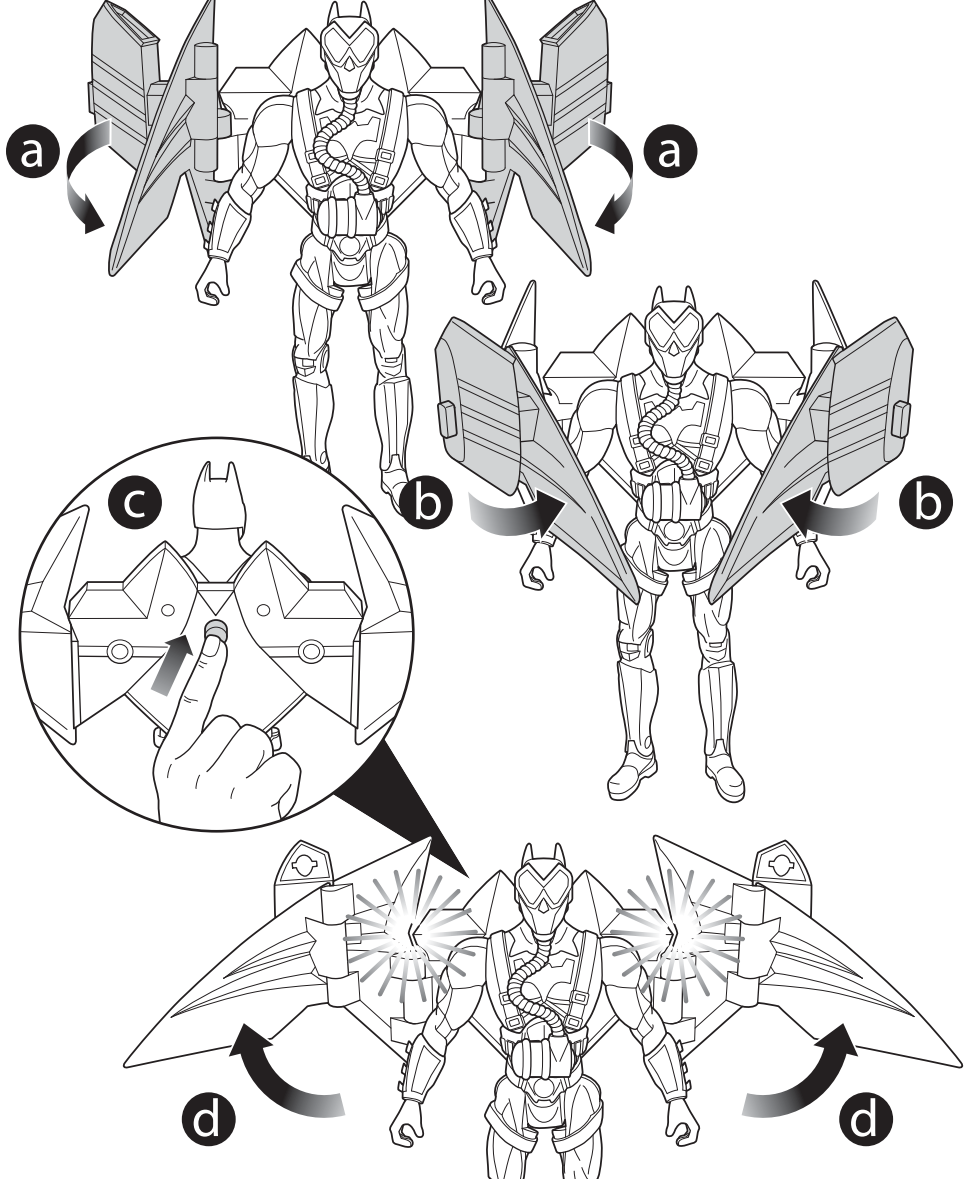

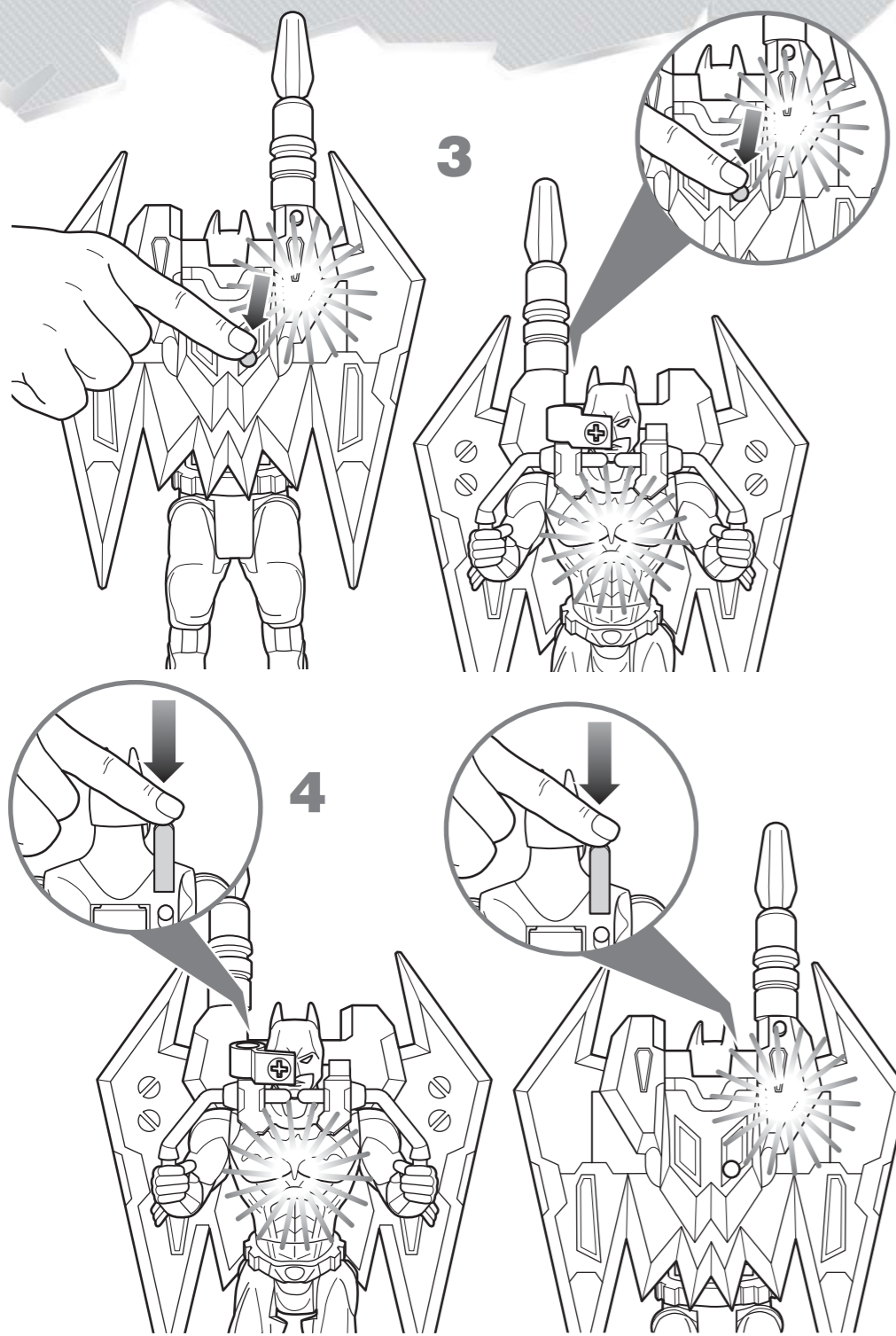

Page 5 of 6

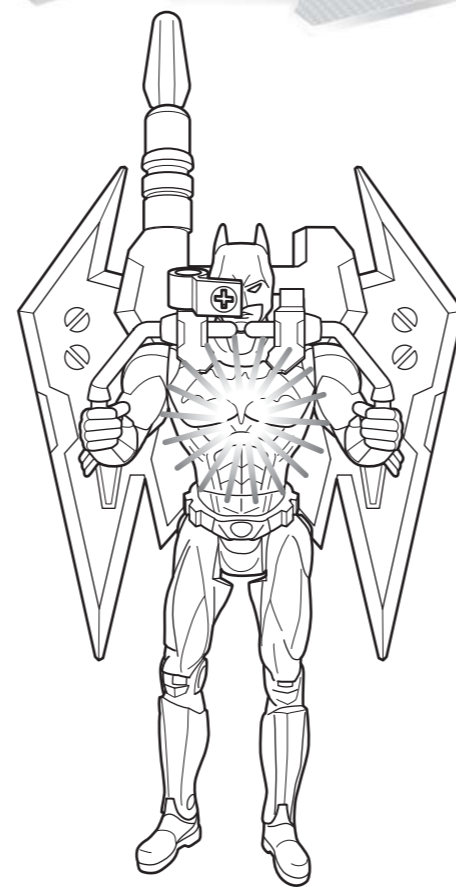

RECYCLE INFORMATION (USA ONLY)

- Please recycle button cell battery(ies) contained in this product by:
- Visiting your nearest recycling center. For location of the nearest recycling center, visit us online at www.service.mattel.com.
 - If a recycling center is not available in your area, contact us for a pre-paid mailing label. Visit us online at www.service.mattel.com or call toll-free at 1-800-524-8697.
 - Valid in the US only. • Solo válido en los EE.UU. • Valable aux États-Unis seulement.

Mattel, Inc. All Rights Reserved.

Mattel, Inc., 333 Continental Blvd., El Segundo, CA 90245 U.S.A. Consumer Relations 1 (800) 524-8697. Retain this address for future reference. • Mattel Canada Inc., Mississauga, Ontario L5R 3W2. You may call us free at 1-800-524-8697. • Mattel U.K. Ltd., Vanwall Business Park, Maidenhead SL6 4UB, Helpline 01628 500303. • Mattel Australia Pty., Ltd., Richmond, Victoria, 3121. Consumer Advisory Service - 1300 135 312. • Mattel East Asia Ltd., Room 1106, South Tower, World Finance Centre, Harbour City, Tsimshatsui, HK, China. • Diimport & Diedarkan Oleh: Mattel SEA Ptd Ltd. (993532-P) Lot 13.5, 13th Floor, Menara Lien Hoe, Persiaran Tropicana Golf Country Resort, 47410 P.J. Tel: 03-78803817, Fax: 03-78803867. N9304-0920 Asst. M4863

BATMAN and all related characters and elements are trademarks of and © DC Comics. (s08)



Page 6 of 6

INSTRUCTIONS 4+

THE DARK KNIGHT

Please keep these instructions for future reference as they contain important information.

CONTENTS



Requires 2 AG3 (LR41) or equivalent button-cell batteries. Batteries included are for demonstration purposes.

BATTERY INSTALLATION

Unscrew the battery cover with a Phillips head screwdriver (not included). Remove batteries included for demonstration purposes and dispose of them safely. Install 2 AG3 (LR41) or equivalent button-cell batteries in the orientation (+/-) shown. Replace battery cover and tighten screw. Replace the batteries if lights and sounds play slowly or distort.

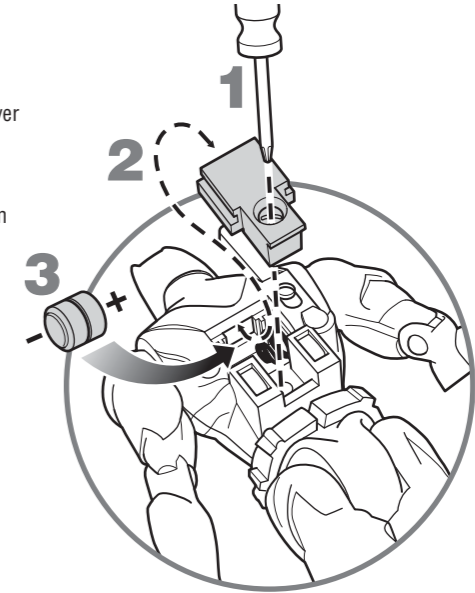

Page 1 of 6

BATTERY SAFETY INFORMATION

In exceptional circumstances batteries may leak fluids that can cause a chemical burn injury or ruin your product. To avoid battery leakage:

- Non-rechargeable batteries are not to be recharged.
- Rechargeable batteries are to be removed from the product before being charged (if designed to be removable).
- Rechargeable batteries are only to be charged under adult supervision (if designed to be removable).
- Do not mix alkaline, standard (carbon-zinc), or rechargeable (nickel-cadmium) batteries.
- Do not mix old and new batteries.
- Only batteries of the same or equivalent type as recommended are to be used.
- Batteries are to be inserted with the correct polarity.
- Exhausted batteries are to be removed from the product.
- The supply terminals are not to be short-circuited.
- Dispose of battery(ies) safely.
- Do not dispose of this product in a fire. The batteries inside may explode or leak.



Protect the environment by not disposing of this product with household waste (2002/96/EC). Check your local authority for recycling advice and facilities.

ASSEMBLY

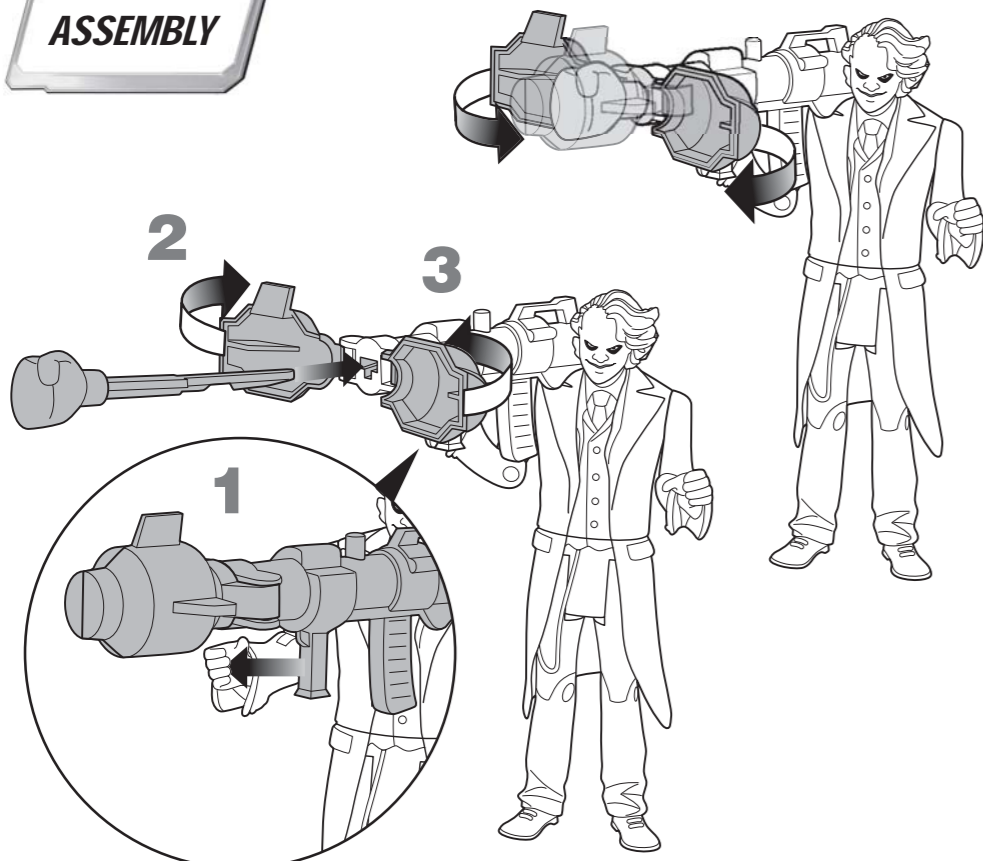

Page 2 of 6

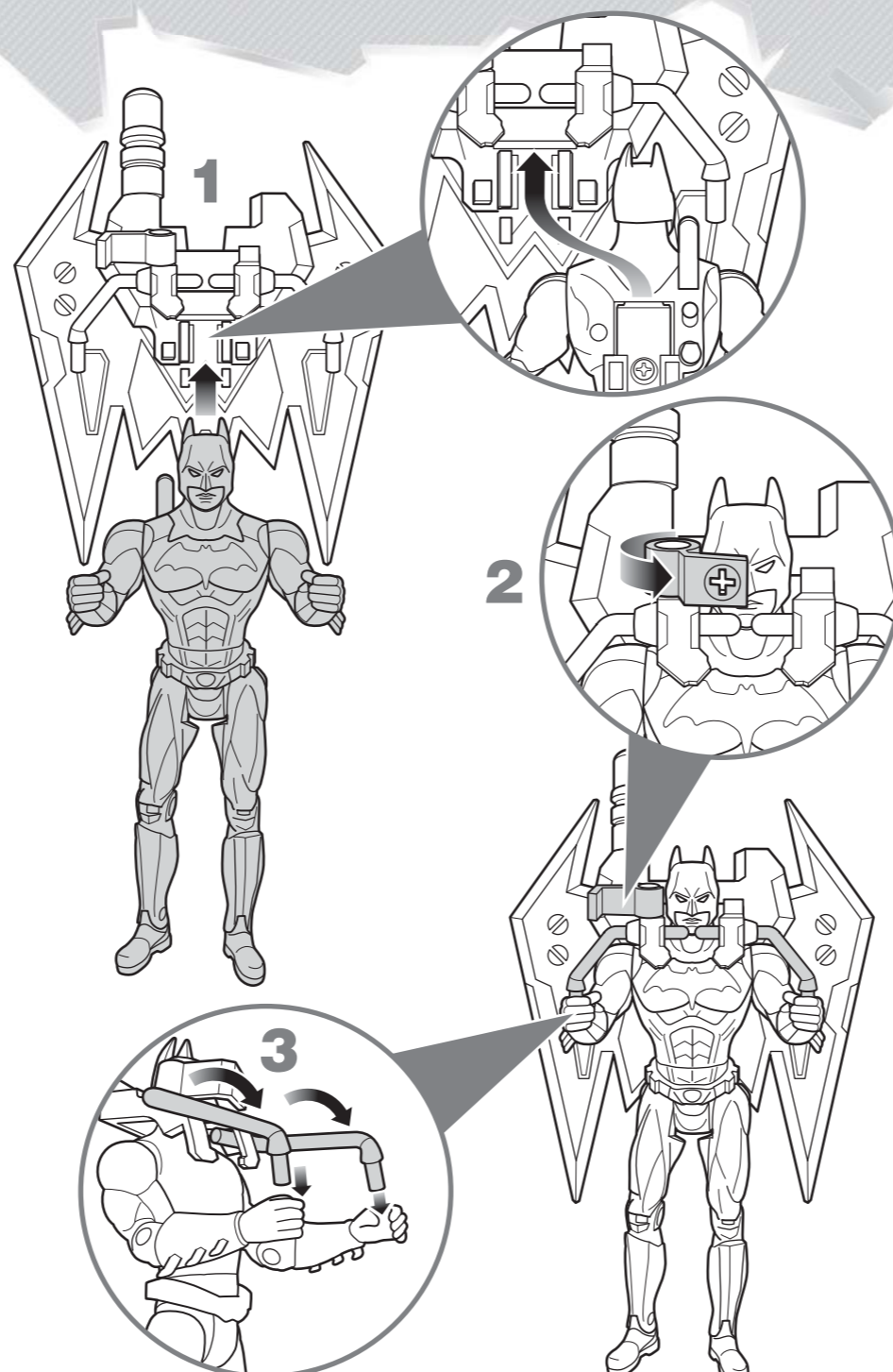

Page 3 of 6

TO PLAY

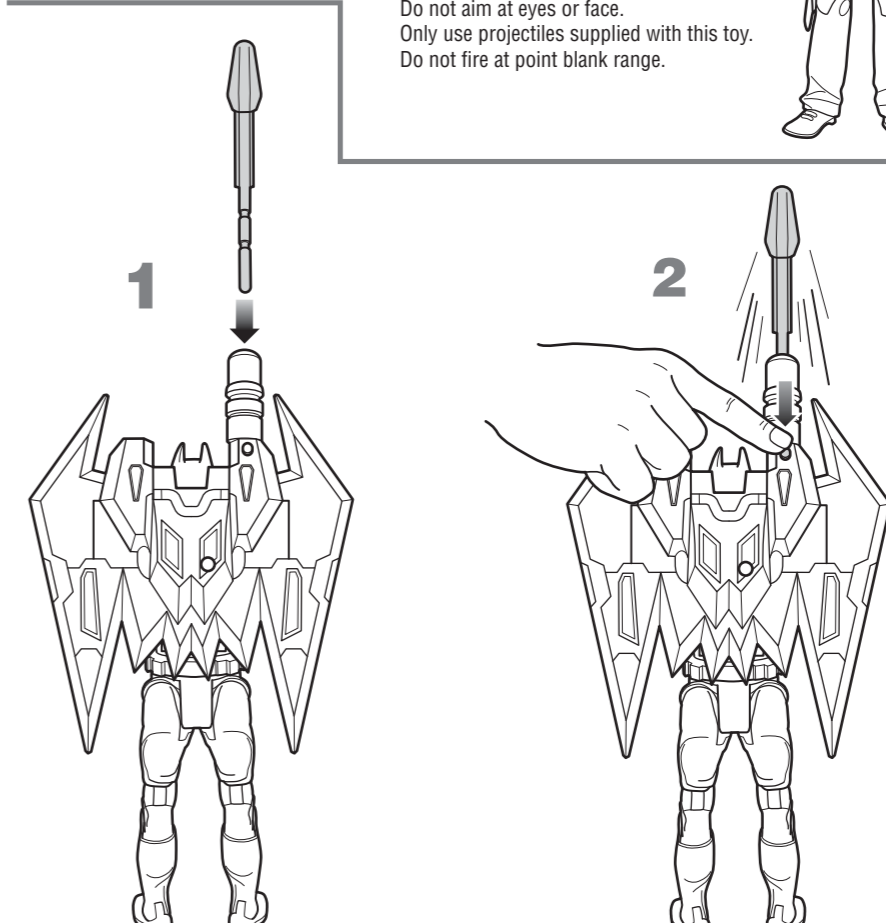
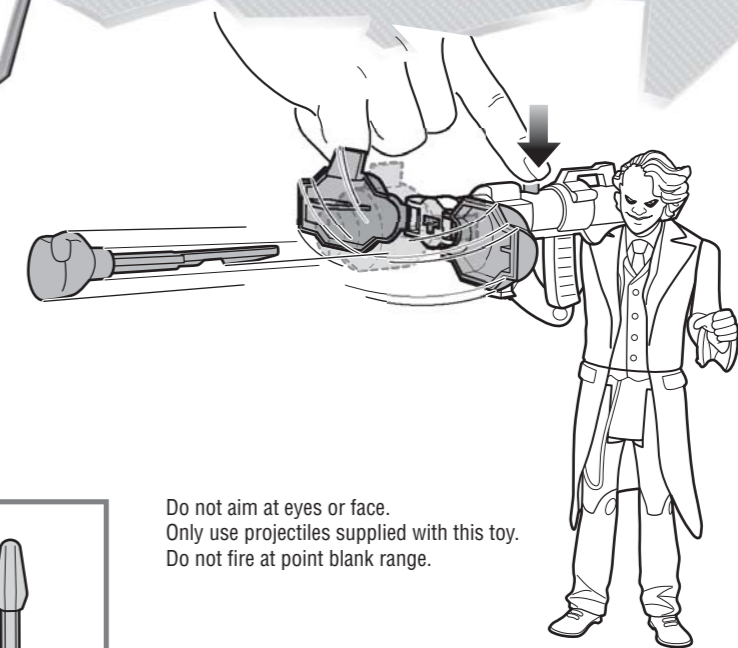

Page 4 of 6

INSTRUCTION SHEET SPECIFICATIONS

Toy:	BMB BATTLE CAPE
Toy No.:	N9304
Part No.:	0920
Trim Size:	17.5 x 8.25
Folded Size:	A5
Type of Fold:	4
# colors:	One
Colors:	Black
Paper Stock:	White Offset
Paper Weight:	70 lb.
EDM No.:	

Free Manuals Download Website

<http://myh66.com>

<http://usermanuals.us>

<http://www.somanuals.com>

<http://www.4manuals.cc>

<http://www.manual-lib.com>

<http://www.404manual.com>

<http://www.luxmanual.com>

<http://aubethermostatmanual.com>

Golf course search by state

<http://golfingnear.com>

Email search by domain

<http://emailbydomain.com>

Auto manuals search

<http://auto.somanuals.com>

TV manuals search

<http://tv.somanuals.com>