



mellerware®

EXECUTIVE
BRAVISSIMO II PRO - STEAM STATION



complies with
INTERNATIONAL
IEC60355
SAFETY SPECIFICATIONS

m
2100W

CE
2 - YEAR
GUARANTEE

Model:
23810

PLEASE READ ALL INSTRUCTIONS BEFORE USE

2 year guarantee





Dear Customer, thank you for having decided to purchase an appliance from the Mellerware range. The design, features and technology of this appliance as well as the strict quality controls used during manufacture will provide full satisfaction for many years. The packing materials used for this appliance are part of a pick-up, sorting and recycling system. If you wish to discard them, please use the public containers provided for each kind of material.

Description

- A Iron on/off switch.
- B Boiler on/off switch.
- C Boiler operation LED.
- D Iron operation LED.
- E Steam pressure indicator LED.
- F Water filling cap.
- G Mains connexion.
- H Iron steam switch.
- I Steam switch control (depending on the model).
- J Iron thermostat control.
- K Iron thermostat LED.
- L Iron housing.

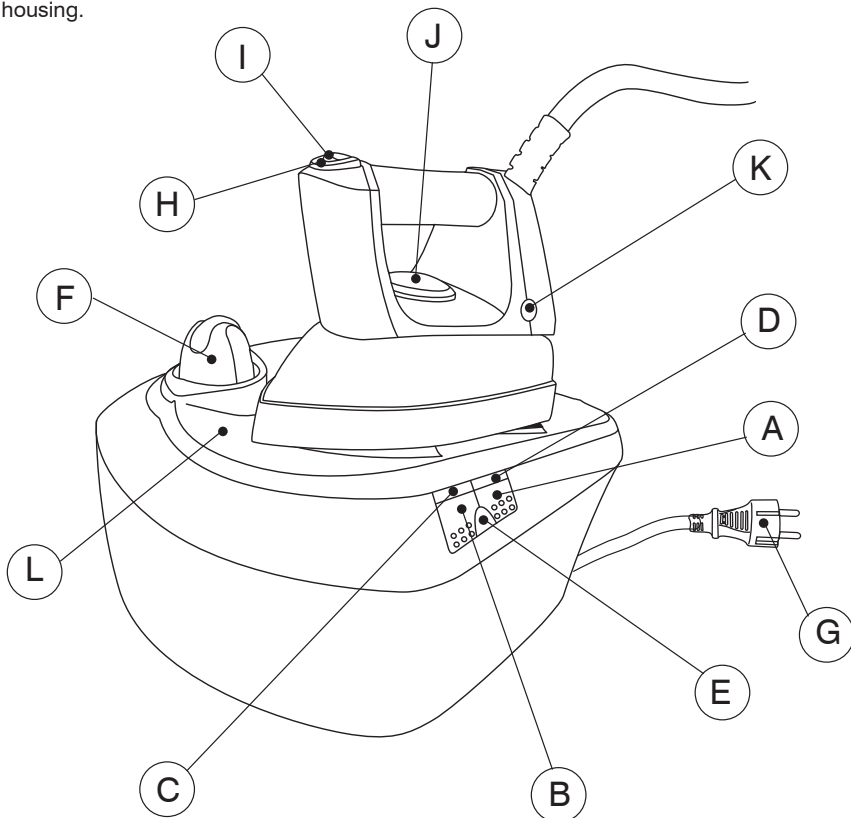

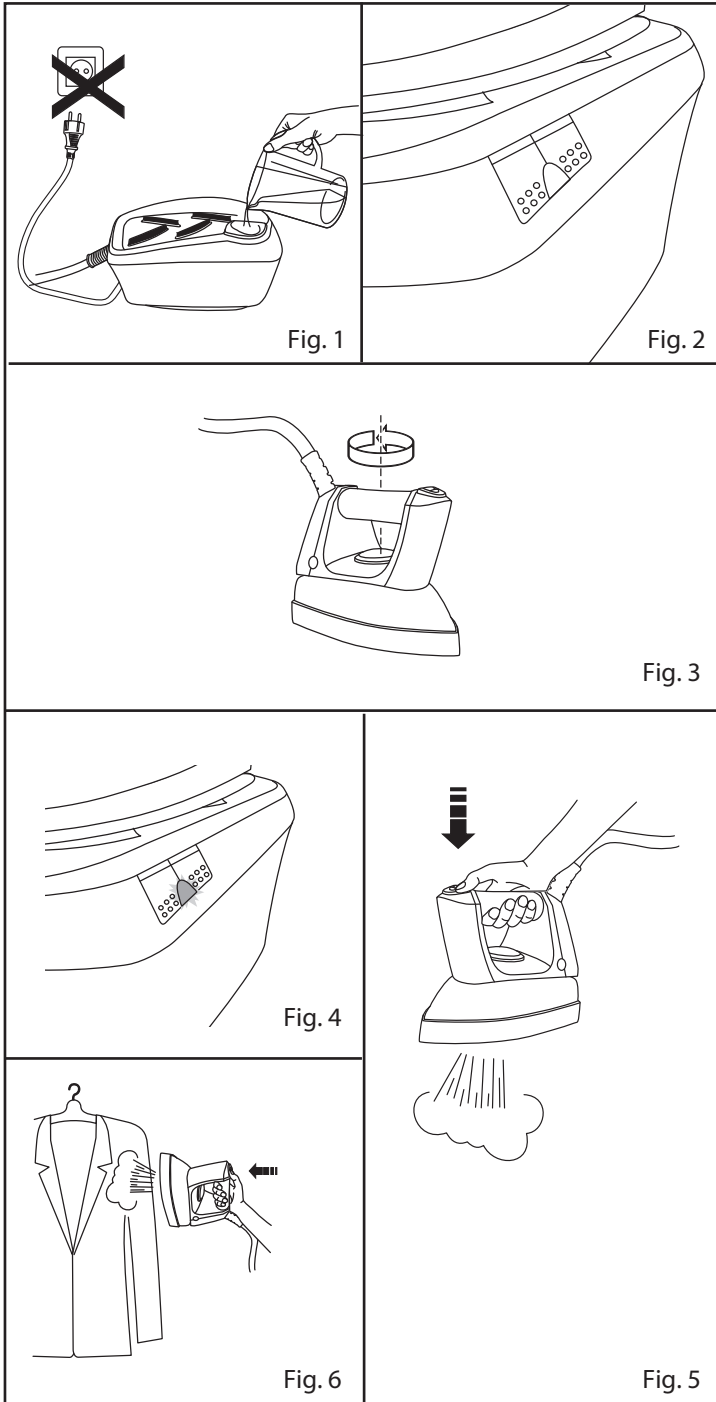



Tips and safety warnings

-This appliance is not intended for use by persons(including children)with reduced physical, sensory or mental capabilities, or lack of experience and knowledge, unless they have been given supervision or instruction concerning use of the appliance by a person responsible for their safety.

-Children should be supervised to ensure that they do not play with the appliance.

-Please read these instructions carefully before using the appliance and keep them for future reference.

-Unpack the appliance and check it is in perfect condition and working order, as any factory fault or damage caused by transport is covered by the MELLERWARE guarantee.

-This device has been designed for household use, not for commercial use.

-Do not leave the appliance without supervision if you are not going to use it immediately. This will save energy and prolong the working life of the appliance.

-Keep the appliance out of the reach of children.

-The appliance must not be connected to the mains while the boiler is being filled (Fig. 1).

-Before connecting the appliance to the mains, ensure the supply voltage is the same as that marked on the appliance. The water filling inlet must not be open during operation.

-This appliance must be connected to an electrical socket with an earth connection.

-Any improper use or failure to comply with the instructions for use will invalidate the warranty and free the manufacturer from any liability concerning the appliance.

-IF THE IRON IS IN ITS HOUSING AT MAXIMUM TEMPERATURE FOR A LONG TIME, IT MAY DISCOLOUR, BUT THIS HAS NO EFFECT ON THE PROPER OPERATION OF THE APPLIANCE.

- The appliance must be used and placed on a flat, stable surface

- When placing the appliance on its support, make sure the surface on which the support is fitted is stable.

- Do not use the appliance if it has been dropped, if there are visible signs of damage or if it leaks.

Before using the appliance for the first time

This professional iron works with tap water.

However, the use of distilled water is recommended in areas with a high lime level in the water. Some parts of the iron have been slightly greased.

They can therefore give off steam on first use, but this steam will disappear after a short time.

Practical tips

-Keep the sole plate smooth, do not apply it to metallic objects (i.e., to the ironing-board, buttons, zips...).

-Fit the iron in its housing (L) for transport and storage, in order to improve its stability.

-To avoid burns, do not lean Bravissimo 2 Pro's iron on its back.

Steam ironing

When you start to iron, proceed as follows:

-Unscrew the cap (F) and fill the boiler with water, using a jug (Fig. 1) (if you fill it with hot water, the appliance will be ready for use sooner).

-Even if the boiler has a certain level of water, it is always recommended to fill it to the top for a longer range, thanks to its large 1l capacity.

-Carefully close the cap (F), screwing it to the end.

-Place the boiler on a flat, stable surface.

-Plug the appliance into the mains.

-Switch on the boiler and the iron by pressing the relevant switches (B) and (A). The corresponding LEDs will light (Fig. 2).



Thermostat control position	Type of fabric	Steam
•	Nylon / Silk	No
..	Wool	No
...	Cotton, Linen	Yes

It is recommended not to use steam in the • and •• thermostat positions, as water could drip.

-Set the desired temperature with the thermostat control (J), depending on the type of cloth to be ironed (Fig. 3).

-The appliance will be ready for use when the pressure indicator LED (E) lights up (Fig. 4). While ironing, this LED (E) goes on and off automatically, this is normal.

-By pressing the steam switch (H) you will get a constant steam jet (Fig. 5). The steam stops when you release the switch.

How to fill the boiler while ironing

To fill the boiler, proceed as follows:

-Eliminate steam pressure from inside the boiler by switching on the steam switch (H) (Fig. 5).

-Turn off the boiler (B) and iron (A) switches.

-Unplug the appliance from the mains.

-Carefully unscrew the cap (F) to let the residual steam out of the boiler.

-Wait for some minutes and carefully pour 1l of water into the boiler using a jug (Fig. 1).

-Carefully close the cap (F) again, screwing it to the end.

Vertical ironing

It is possible to iron hanging curtains, garments on their own hangers... (Fig.6)

-Adjust the iron thermostat control (J) to the maximum temperature.

-Iron from top to bottom and press the iron steam switch (H).

Important: For cotton and linen clothes, it is recommended to put the base of the iron in contact with the fabric. For more delicate fabrics, it is recommended to keep the base of the iron at a distance of some centimetres.

Dry ironing

-Connect the professional iron to the mains.

-Turn on the iron switch (A).

-Set the iron temperature with the thermostat control (J), depending on the fabric to be ironed.

After each ironing

-Switch off the professional iron by pressing switches (B) and (A).

-Unplug the power cable (G) from the mains.

-Clean the base of the iron while it is still hot, using a damp cloth, after each use.

-The rest of the appliance can also be cleaned using a damp cloth.

Never submerge the appliance in water or any other liquid, or hold it under a running tap. Do not use solvents or abrasive products to clean it.

Maintenance

With the boiler's descaling system, limescale incrustations are reduced thanks to the exclusive features of the stainless material used. To clean the inside of the boiler, you simply have to proceed as follows every three months:

Fill the boiler with tap water, shake and empty. Repeat these steps two or three times consecutively.

To descale:

-Unplug. Empty the content of a bag into the boiler. Fill with water and select the steam position.

-Plug in. Switch the professional iron on.

-Place the iron in the ironing position. Activate the steam, shake the iron softly.

-Let the product work for 10 minutes.

-Rinse thoroughly with water & empty completely.





Breakdowns and repairs

In the event of any breakdown, check the following chart.

- In the event of malfunctions, take the appliance to an authorized Technical Support Service.
- Do not try to dismantle or repair it yourself as this may be dangerous.
- If the mains connection is to be replaced, proceed as in the event of a malfunction.

After each ironing

- Switch off the professional iron by pressing switches (B) and (A).
- Unplug the power cable (G) from the mains.
- Clean the base of the iron while it is still hot, using a damp cloth, after each use.
- The rest of the appliance can also be cleaned using a damp cloth.

Never submerge the appliance in water or any other liquid, or hold it under a running tap. Do not use solvents or abrasive products to clean it.

Maintenance

With the boiler's descaling system, limescale incrustations are reduced thanks to the exclusive features of the stainless material used. To clean the inside of the boiler, you simply have to proceed as follows every three months:

Fill the boiler with tap water, shake and empty. Repeat these steps two or three times consecutively.

To descale:

- Unplug. Empty the content of a bag into the boiler. Fill with water and select the steam position.
- Plug in. Switch the professional iron on.
- Place the iron in the ironing position. Activate the steam, shake the iron softly.
- Let the product work for 10 minutes.
- Rinse thoroughly with water & empty completely.

Breakdowns and repairs

In the event of any breakdown, check the following chart.

- In the event of malfunctions, take the appliance to an authorized Technical Support Service.
- Do not try to dismantle or repair it yourself as this may be dangerous.
- If the mains connection is to be replaced, proceed as in the event of a malfunction.



Breakdowns	Causes	Solutions
Water drips from the holes on the base of the iron when turning on the steam switch (H).	Iron thermostat control (J) set to the minimum position "...".	Set the thermostat control to the steam zone "...".
	The boiler is too full.	Remove some water.
	The boiler is in a tilted position.	Place it on a horizontal surface.
The iron does not heat and the LED (K) does not light up.	The switch (A) is "off".	Switch it to "on" (A).
	Iron thermostat control (J) set to the minimum position.	Adjust the thermostat control.
	Faulty power connection.	Check the power points.
No steam comes out when pressing the steam switch (H).	Empty boiler.	Fill the boiler with water.
	Switches (B) and (A) are "off".	Switch them on.
Leak from the boiler filling cap (F).	Cap (F) not properly closed.	Let the boiler cool and screw the cap (F) to the end again.
	Safety valve activated.	Go to an authorized Technical Service.
The boiler cap (F) does not unscrew easily.	There is steam remaining inside the boiler.	Press the steam switch (H) to let the steam out.



creative housewares

27 Nourse Avenue Epping 2 Cape Town
PO. Box 975 Eppindust 7475 South Africa
Tel: +27 21 534 8114 Fax: +27 21 534 8086
Service Centre Share Call: 086 111 5006
web: www.creativehousewares.co.za

Free Manuals Download Website

<http://myh66.com>

<http://usermanuals.us>

<http://www.somanuals.com>

<http://www.4manuals.cc>

<http://www.manual-lib.com>

<http://www.404manual.com>

<http://www.luxmanual.com>

<http://aubethermostatmanual.com>

Golf course search by state

<http://golfingnear.com>

Email search by domain

<http://emailbydomain.com>

Auto manuals search

<http://auto.somanuals.com>

TV manuals search

<http://tv.somanuals.com>