

**mellerware**<sup>®</sup>

makes life easier

PICCOLO  
mini  
kettle



0.9L Capacity

360° Cordless  
kettle base

Concealed  
element



complies with  
INTERNATIONAL  
IEC60335  
SAFETY SPECIFICATIONS

**m**  
1100-  
1300W

2 YEAR  
GUARANTEE

Model:  
33011

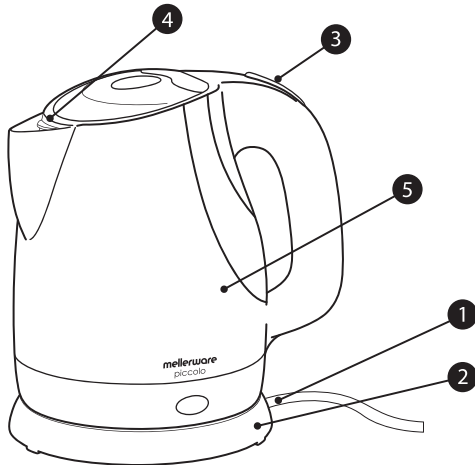

### Description:

1. Power cord
2. Base
3. On/Off switch
4. Safety lock for water container lid
5. Water container

### Important safety instructions

- This appliance is not intended for use by any person (including children) with reduced physical, sensory or mental capabilities, or lacking experience and knowledge, unless they have been given supervision or instruction concerning the use of the appliance by a person responsible for their safety.
- Children should be supervised to ensure that they do not play with the appliance.
- Do not leave the kettle unattended during use. When filling the kettle to the desired level, observe the Min. and Max. markings.
- Overfilling the kettle may cause boiling water to be ejected. Also beware of the danger of scalding from hot steam being emitted. Therefore, do not touch any parts of the appliance except the handle during use.
- The housing becomes hot during use.
- Caution! During the boiling process and when pouring out hot water, the lid must be kept closed at all times.
- The kettle may only be operated with the base provided with the appliance.
- The appliance must be used only on a heat-resistant and level surface.

- Do not allow the appliance or its power cord to come into contact with open flames or any hot surfaces.
- Always remove the plug from the wall socket after use, during cleaning of the appliance and after it malfunctions.
- This kettle is intended for domestic use only and not for commercial applications.
- In order to avoid any hazard or injury, repairs must be carried out by the manufacturer.

### Thermal safety cut-out

The preset thermal safety cut-out protects the kettle from overheating should the appliance be switched on without any water. Once the safety cut-out has switched off the kettle, it must be allowed to cool down sufficiently before being used again.

### Before first use:

Fill the kettle and boil 3 times. After this, throw the boiled water away. The kettle is now ready for use.

### Boiling water

- Never remove the kettle from the base while it is switched on.
- Remove the kettle from its base.
- Release and open the lid, and fill the kettle with the desired amount of water, observing the Min. and Max. markings.
- Close the lid and place the kettle back on its base, ensure that the appliance has not yet been switched on.
- Insert the plug into a suitable wall socket and press the On/Off switch.
- The boiling process begins. After reaching the boiling point, the appliance will automatically switch off.
- If you want to interrupt the boiling process, set the On/Off switch to its Off position.
- To pour hot water, remove the kettle from its base.
- To prevent hot steam from being emitted, ensure that the lid remains closed while pouring out the water.

### Descaling

Depending on the water quality in your area, lime deposits may build up on the heating element. It is advisable to remove any such deposits at regular intervals. A mixture of 0.5 liters of



water to two tablespoons of vinegar is suitable.

- Pour the solution into the kettle .
- Switch the appliance on and let the solution reach boiling point.
- Leave it to take effect for a short period.
- To clean the kettle after descaling, rinse thoroughly with clean water.

### **General cleaning and care**

- Before cleaning the appliance, ensure that the appliance is disconnected from the wall socket and that it has completely cooled down .
- To avoid the risk of electric shock, do not immerse the kettle or its base in water, wipe with a damp cloth.
- Do not use abrasives or harsh cleaning solutions when cleaning the kettle.





## creative housewares

 20 Tekstiel Street, Parow, Cape Town, 7493, South Africa

 P.O. Box 6156 Parow East, 7501, South Africa

 +27 21 931 8117       +27 21 931 4058

Service Centre Helpline: 086 111 5006

 [www.creativehousewares.co.za](http://www.creativehousewares.co.za)

## Free Manuals Download Website

<http://myh66.com>

<http://usermanuals.us>

<http://www.somanuals.com>

<http://www.4manuals.cc>

<http://www.manual-lib.com>

<http://www.404manual.com>

<http://www.luxmanual.com>

<http://aubethermostatmanual.com>

Golf course search by state

<http://golfingnear.com>

Email search by domain

<http://emailbydomain.com>

Auto manuals search

<http://auto.somanuals.com>

TV manuals search

<http://tv.somanuals.com>