

Memorex®

Is it live or is it Memorex?™

MC2864

User's Guide

*CD PLAYER, DUAL ALARM CLOCK,
STEREO AM/FM RADIO WITH DIGITAL
READOUT AND CALENDAR*

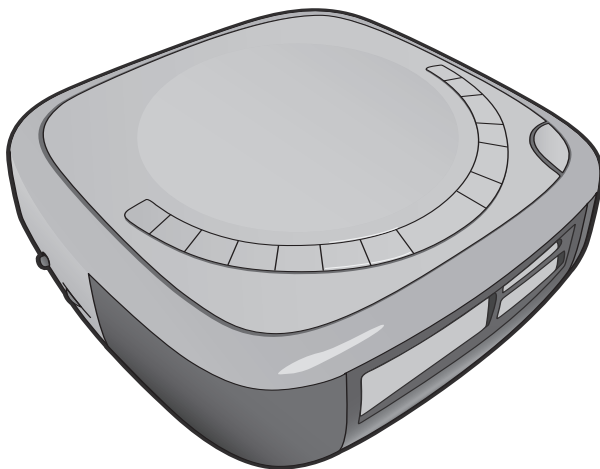

**Before operating this product,
please read these instructions completely.**

SAFETY PRECAUTIONS



CAUTION

**RISK OF ELECTRIC SHOCK
DO NOT OPEN**



CAUTION: TO REDUCE THE RISK OF ELECTRIC SHOCK, DO NOT REMOVE COVER (OR BACK). NO USER-SERVICEABLE PARTS INSIDE. REFER SERVICING TO QUALIFIED SERVICE PERSONNEL. This Caution Marking and Rating Label are located at the bottom enclosure of the unit.



The lightning flash with arrowhead symbol within an equilateral triangle is intended to alert the user to the presence of uninsulated dangerous voltage within the product's enclosure that may be of sufficient magnitude to constitute a risk of electric shock to persons.



The exclamation point within an equilateral triangle is intended to alert the user to the presence of important operating and maintenance (servicing) instructions in the literature accompanying the appliance.



Invisible and hazardous laser radiation when open and interlock failed or defeated. Avoid direct exposure to beam.

FCC WARNING:

This equipment may generate or use radio frequency energy. Changes or modifications to this equipment may cause harmful interference unless the modifications are expressly approved in the instruction manual. The user could lose the authority to operate this equipment if an unauthorized change or modification is made.

LASER SAFETY: This unit employs a laser. Only qualified service personnel should attempt to service this device due to possible eye injury.

CAUTION: USE OF CONTROLS, ADJUSTMENTS OR PERFORMANCE PROCEDURE HEREIN MAY RESULT IN HAZARDOUS RADIATION EXPOSURE.

SURGE PROTECTORS:

It is recommended to use a surge protector for AC connection. Lightning and power surges ARE NOT covered under warranty for this product.

INFORMATION:

This equipment has been tested and found to comply with the limits for a Class B digital device, pursuant to Part 15 of the FCC Rules. These limits are designed to provide reasonable protection against harmful interference in a residential installation. This equipment generates, uses and can radiate radio frequency energy and, if not installed and used in accordance with instructions, may cause harmful interference to radio communications. However, there is no guarantee that interference will not occur in a particular installation. If this equipment does cause harmful interference to radio or television reception, which can be determined by turning the equipment off and on, the user is encouraged to try to correct the interference by one or more of the following measures:

- Reorient or relocate the receiving antenna.
- Increase the separation between the equipment and receiver.
- Connect the equipment into an outlet on a circuit different from that to which the receiver is connected.
- Consult the dealer or an experienced radio/TV technician for help.

This Class B digital apparatus complies with Canadian ICES-003.

Cet appareil numérique de la classe B est conforme à la norme NMB-003 du Canada.

ATTENTION:

POUR ÉVITER LES CHOC ÉLECTRIQUES, INTRODUIRE LA LAME LA PLUS LARGE DE LA FICHE DANS LA BORNE CORRESPONDANTE DE LA PRISES ET POUSSER JUSQU'AU FOND.

IMPORTANT SAFETY INSTRUCTIONS

Before using the unit, be sure to read all operating instructions carefully. Please note that these are general precautions and may not pertain to your unit. For example, this unit may not have the capability to be connected to an outdoor antenna.

1. READ INSTRUCTIONS

All the safety and operating instructions should be read before the product is operated.

2. RETAIN INSTRUCTIONS

The safety and operating instructions should be retained for future reference.

3. HEED WARNINGS

All warnings on the product and in the operating instructions should be adhered to.

4. FOLLOW INSTRUCTIONS

All operating and use instructions should be followed.

5. CLEANING

Unplug this product from the wall outlet before cleaning. Do not use liquid cleaners or aerosol cleaners. Use a dry cloth for cleaning.

6. ATTACHMENTS

Do not use attachments not recommended by the product's manufacturer as they may cause hazards.

7. WATER AND MOISTURE

Do not use this product near water—for example: near a bathtub, washbowl, kitchen sink or laundry tub; in a wet

basement; or near a swimming pool.

8. ACCESSORIES

Do not place this product on an unstable cart, stand, tripod, bracket or table. The product may fall, causing serious injury and serious damage to the product. Use only with a cart, stand, tripod, bracket or table recommended by the manufacturer or sold with the product. Any mounting of the product should follow the manufacturer's instructions, and should use a mounting accessory recommended by the manufacturer.

- 8A. An appliance and cart combination should be moved with care. Quick stops, excessive force and uneven surfaces may cause the appliance and cart combination to overturn.

PORTABLE CART WARNING
(symbol provided by RETAC)



9. VENTILATION

Slots and openings in the cabinet and in the back or bottom are provided for ventilation, to ensure reliable operation of the product and to protect it from overheating. These openings must not be blocked or covered. The openings should never be blocked by placing the product on a bed, sofa, rug or other similar surface. This product should never be placed near or over a radiator or heat source. This product should not be placed in a built-in installation such as a bookcase or rack unless proper ventilation is provided or the

IMPORTANT SAFETY INSTRUCTIONS

manufacturer's instructions have been adhered to.

10. POWER SOURCES

This product should be operated only from the type of power source indicated on the marking label. If you are not sure of the type of power supply to your home, consult your appliance dealer or local power company. For products intended to operate from battery power, or other sources, refer to the operating instructions.

11. GROUNDING OR POLARIZATION

This product is equipped with a polarized alternating-current line plug (a plug having one blade wider than the other). This plug will fit into the power outlet only one way. This is a safety feature. If you are unable to insert the plug fully into the outlet, try reversing the plug. If the plug should still fail to fit, contact your electrician to replace your obsolete outlet. Do not defeat the safety purpose of the polarized plug.

12. POWER-CORD PROTECTION

Power-supply cords should be routed so that they are not likely to be walked on or pinched by items placed upon or against them, paying particular attention to cords at plugs, convenience receptacles, and the point where they exit from the appliance.

13. LIGHTNING

To protect your product from a lightning storm, or when it is left unattended and unused for long periods of time, unplug it from the wall outlet and disconnect the antenna or cable system. This will prevent damage to the product due to lightning and power-line surges.

14. POWER LINES

An outside antenna system should not be located in the vicinity of overhead power lines or other electric light or power circuits, or where it can fall into such power lines or circuits. When installing an outside antenna system, extreme care should be taken to keep from touching such power lines or circuits as contact with them might be fatal.

15. OVERLOADING

Do not overload wall outlets and extension cords as this can result in a risk of fire or electric shock.

16. OBJECT AND LIQUID ENTRY

Never push objects of any kind into this product through openings as they may touch dangerous voltage points or short out parts that could result in fire or electric shock. Never spill or spray any type of liquid on the product.

17. SERVICING

Do not attempt to service this product yourself as opening or removing covers may expose you to dangerous voltage or other hazards. Refer all servicing to qualified service personnel.

18. REPLACEMENT PARTS

When replacement parts are required, be sure the service technician uses replacement parts specified by the manufacturer or those that have the same characteristics as the original part. Unauthorized substitutions may result in fire, electric shock or other hazards.

19. SAFETY CHECK

Upon completion of any service or repairs to this

product, ask the service technician to perform safety checks to determine that the product is in proper operating condition.

20. WALL OR CEILING MOUNTING

The product should be mounted to a wall or ceiling only as recommended by the manufacturer.

21. DAMAGE REQUIRING SERVICE

Unplug the product from the wall outlet and refer servicing to qualified service personnel under the following conditions:

- When the power-supply cord or plug is damaged.
- If liquid has been spilled or objects have fallen into the product.
- If the product has been exposed to rain or water.
- If the product does not operate normally by following the operating instructions. Adjust only those controls that are covered by the operating instructions, as an adjustment of other controls may result in damage and will often require extensive work by a qualified technician to restore the product to its normal operation.
- If the product has been dropped or the cabinet has been damaged.
- When the product exhibits a distinct change in performance—this indicates a need for service.

22. HEAT

The product should be situated away from heat sources such as radiators, heat registers, stoves or other products (including amplifiers) that produce heat.

23. NOTE TO CATV SYSTEM INSTALLER

This reminder is provided to call the CATV system installer's attention to Article 820-40 of the NEC that provides guidelines for proper grounding and, in particular, specifies that the cable ground shall be connected to the grounding system of the building, as close to the point of cable entry as practical.

24. OUTDOOR ANTENNA GROUNDING

If an outside antenna is connected to the product, be sure the antenna system is grounded so as to provide some protection against voltage surges and built-up static charges. Section 810 of the National Electric Code, ANSI/NFPA 70, provides information with respect to proper grounding of the mast and supporting structure, grounding of the lead-in wire to an antenna discharge product, size of grounding conductors, location of antenna discharge product, connection to grounding electrodes and requirements for grounding electrodes.

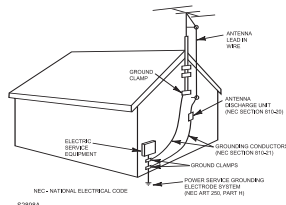

EXAMPLE OF ANTENNA GROUNDING AS PER NATIONAL ELECTRICAL CODE

Dear Customer:

Selecting fine audio equipment such as the unit you've just purchased is only the start of your musical enjoyment. Now it's time to consider how you can maximize the fun and excitement your equipment offers. This manufacturer and the Electronic Industries Association's Consumer Electronics Group want you to get the most out of your equipment by playing it at a safe level. One that lets the sound come through loud and clear without annoying blaring or distortion—and, most importantly, without affecting your sensitive hearing. Sound can be deceiving. Over time your hearing "comfort level" adapts to higher volumes of sound. So what sounds "normal" can actually be loud and harmful to your hearing. Guard against this by setting your equipment at a safe level BEFORE your hearing adapts.

To establish a safe level:

- Start your volume control at a low setting.
- Slowly increase the sound until you can hear it comfortably and clearly, and without distortion.

Once you have established a comfortable sound level:

- Set the dial and leave it there.

Taking a minute to do this now will help to prevent hearing damage or loss in the future. After all, we want you listening for a lifetime.

We Want You Listening For A Lifetime

Used wisely, your new sound equipment will provide a lifetime of fun and enjoyment. Since hearing damage from loud noise is often undetectable until it is too late, this manufacturer and the Electronic Industries Association's Consumer Electronics Group recommend you avoid prolonged exposure to excessive noise. This list of sound levels is included for your protection.

Decibel

<u>Level</u>	<u>Example</u>
30	Quiet library, soft whispers
40	Living room, refrigerator, bedroom away from traffic
50	Light traffic, normal conversation, quiet office
60	Air conditioner at 20 feet, sewing machine
70	Vacuum cleaner, hair dryer, noisy restaurant
80	Average city traffic, garbage disposals, alarm clock at two feet

THE FOLLOWING NOISES CAN BE DANGEROUS UNDER CONSTANT EXPOSURE:

90	Subway, motorcycle, truck traffic, lawn mower
100	Garbage truck, chain saw, pneumatic drill
120	Rock band concert in front of speakers, thunderclap
140	Gunshot blast, jet engine
180	Rocket launching pad

Information courtesy of the Deafness Research Foundation.



LOCATION OF CONTROLS

FRONT-LEFT

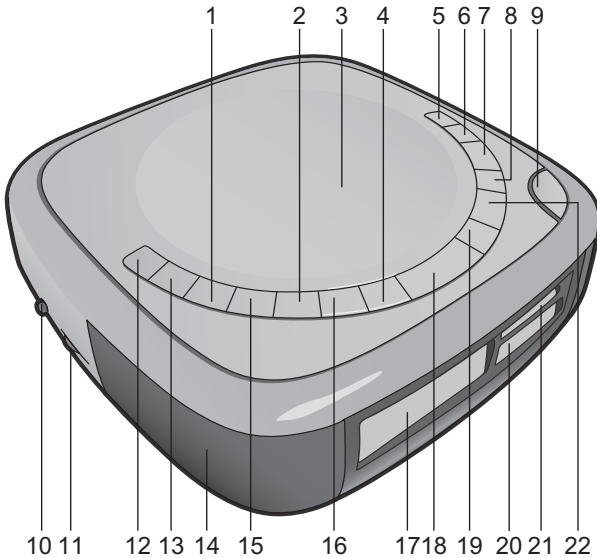

1. FUNCTION Button
2. TIME Button
3. CD Compartment
4. ALARM 1 Button
5. STOP (■) Button
6. SKIP/SEARCH ►► Button
7. Play/Pause (►||) Button
8. SKIP/SEARCH ◀◀ Button
9. OPEN Button
10. DIMMER Switch (LOW/HIGH)
11. VOLUME Control
12. POWER Button
13. REPEAT Button
14. Left Speaker
15. ALARM MODE Button
16. SLEEP Button
17. Display
18. SNOOZE Button
19. ALARM 2 Button
20. Alarm 2 Display
21. Alarm 1 Display
22. PROGRAM Button
23. Right Speaker
24. TUNING Control
25. Band Switch (AM/FM/FM ST.)
26. NATURE SOUND Switch
27. Battery Door/ Compartment (Bottom of Unit)
[Door Part No. 0210-0286400-0000*]
28. AUX IN Jack
29. Headphones Jack
30. AC Cord
31. FM Antenna Wire

REAR-RIGHT

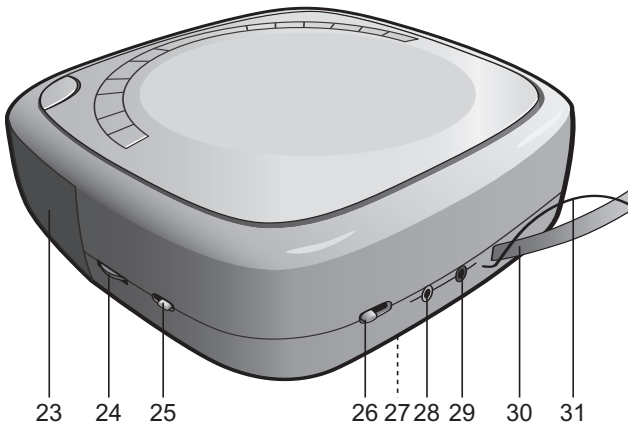

*Consumer Replaceable Part
(See page 23 to order.)

INSTALLATION

AC CONNECTION

CAUTION: TO PREVENT ELECTRIC SHOCK, MATCH WIDE BLADE OF PLUG TO WIDE SLOT, FULLY INSERT.

Unravel the AC cord and connect it to a conveniently located AC outlet having 120V and 60Hz only. "12:00" will appear in the display.

NOTE: If the AC plug does not fit into a nonpolarized outlet, do not file or cut the wide blade.

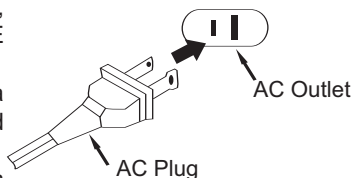

INSERTING BATTERIES

Two (2) "AAA" size batteries should be used to provide a backup for the clock and alarm time for this unit as follows:

1. Open the Battery Compartment door by pushing in on the tab, then removing the Battery Compartment door.
2. Insert two (2) "AAA" batteries as shown. Alkaline batteries are recommended for the longest playing time.
3. Replace the Battery Compartment door.

NOTES:

- The batteries are used to backup the clock and alarm time when the AC plug is disconnected or there is a power failure.
- If the batteries are low or no batteries are inserted, "BATT. LOW" will blink in the display.

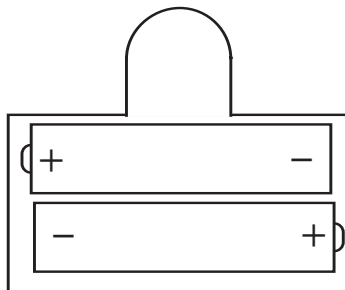

BATTERY PRECAUTIONS

Follow these precautions when using batteries in this device:

1. Use only the size and type of batteries specified.
2. Be sure to follow the correct polarity when installing the batteries as indicated in the battery compartment. Reversed batteries may cause damage to the device.
3. Do not mix different types of batteries together (e.g. Alkaline, Rechargeable and Carbon-zinc) or old batteries with fresh ones.
4. If the device is not to be used for a long period of time, remove the batteries to prevent damage or injury from possible battery leakage.
5. Do not try to recharge batteries not intended to be recharged; they can overheat and rupture. (Follow battery manufacturer's directions.)

OPERATION

TO LISTEN TO THE RADIO

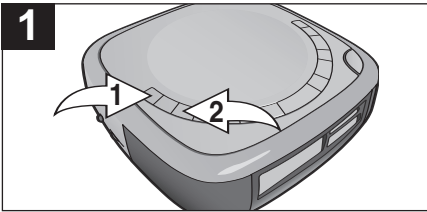

Press the POWER button ❶ to turn the unit on. Repeatedly press the FUNCTION button ❷ to select the radio; RADIO will appear in the display.

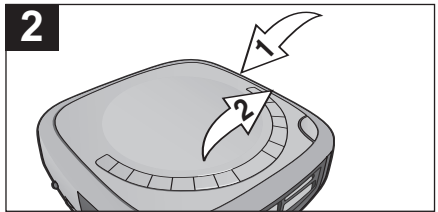

Slide the Band switch ❶ to select AM, FM or FM STEREO. Tune a station by turning the TUNING control ❷. When a strong FM stereo signal is received the FM Stereo icon will light.

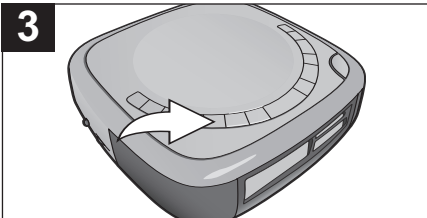

The time will appear on the display when listening to the radio. To view the station, press the TIME button; the tuned station will appear for approx. 10 seconds and then revert back to the time display.

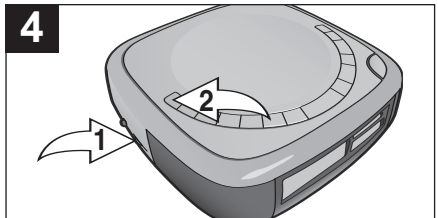

Adjust the volume using the VOLUME control ❶. To turn the unit off, press the POWER button ❷.

Antennas

FM: Unravel and extend the FM antenna wire for best reception.

AM: Turn the unit for better AM reception.

OPERATION (CONTINUED)

TO LISTEN TO THE NATURE SOUNDS

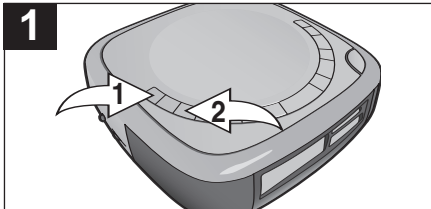

Press the POWER button ❶ to turn the unit on. Repeatedly press the FUNCTION button ❷ to select nature sounds; "NS" will appear in the display.

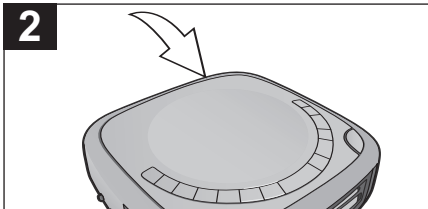

Slide the NATURE SOUND switch to the desired position (SONGBIRDS, OCEAN SURF, GENTLE RAIN, MOUNTAIN STREAM).

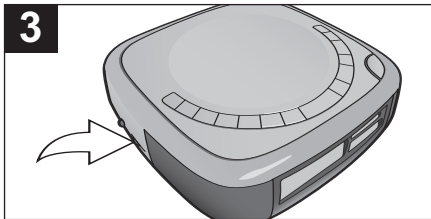

Adjust the volume using the VOLUME control.

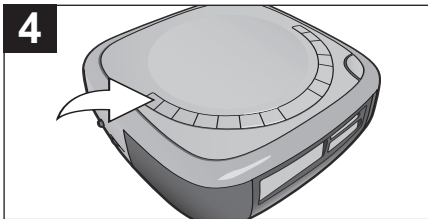

To turn the unit off, press the POWER button.

Note: A good use of this feature is to use it in conjunction with the Sleep feature on page 20.

OPERATION (CONTINUED)

TO PLAY A CD

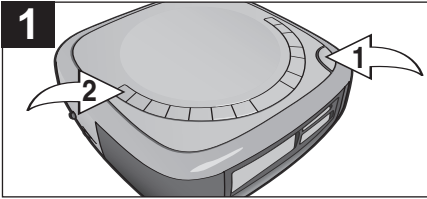

Press the OPEN button ❶ and gently insert a CD onto the spindle (label side facing up) until it clicks. Close the CD door. Press the POWER button ❷ to turn the unit on.

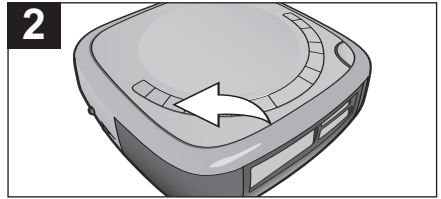

Repeatedly press the FUNCTION button to select CD; "CD" will appear in the display; the total number of tracks will appear in the display.

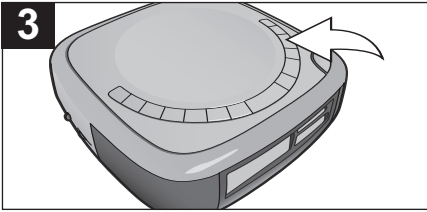

Press the Play/Pause (▶||) button to start playback; "PLAY" will appear in the display.

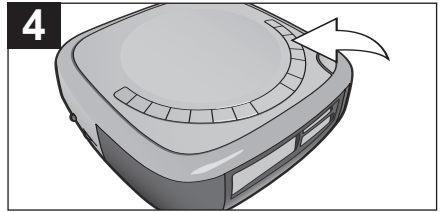

TO PAUSE PLAYBACK, press the Play/Pause (▶||) button again; "PAUSE" will appear in the display. Press again to resume playback.

CONTINUED ON THE NEXT PAGE

OPERATION (CONTINUED)

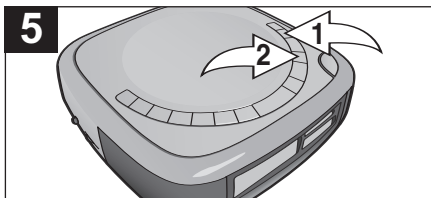

To **skip** to the beginning of the current track/previous or next track on the disc, press the Skip/ Search ►► ❶ or ◀◀ ❷ button. To **search** forward or backward through the tracks on the disc, press and hold the Skip/Search ►► ❶ or ◀◀ ❷ button.

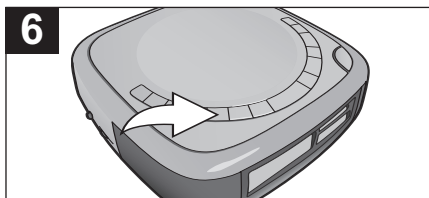

The time will appear on the display when listening to the CD. To view the playing track, press the TIME button; the track number will appear for approx. 10 seconds and then revert back to the time display.

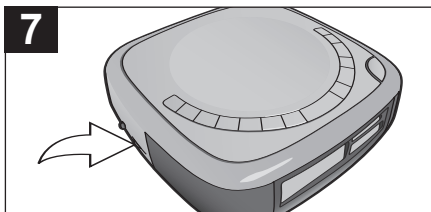

Adjust the volume using the VOLUME control.

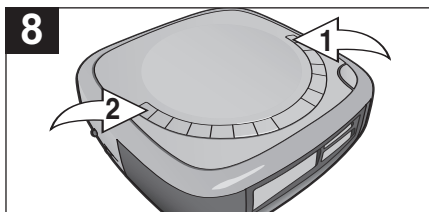

When the disc is through playing, it will stop. Press the STOP (■) button ❶ to stop the disc before it is finished. Press the POWER button ❷ to turn the unit off.

NOTES:

- If a disc is inserted incorrectly, dirty, damaged or not present at all, the display will show, "--" will blink in the display and then "no" will appear in the display for approx. 10 seconds. Then, the actual time will appear in the display.
- When you press the SKIP/SEARCH ►► or ◀◀ button, the track number will appear for approx. 10 seconds then revert back to the time display.
- If the CD door is opened, "OP" will appear for approx. 10 seconds on the display.

OPERATION (CONTINUED)

TO REPEATEDLY PLAY BACK ONE TRACK

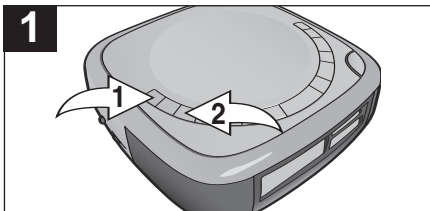

With a CD inserted, press the POWER button ❶ to turn the unit on. Repeatedly press the FUNCTION button ❷ to select CD; "CD" will appear in the display; the total number of tracks will appear in the display.

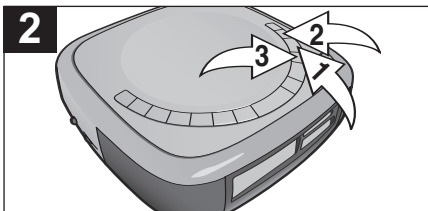

Press the Play/Pause (▶||) button ❶ to start playback; "PLAY" will appear in the display. Press the SKIP/SEARCH ▶ ❷ or ◀ ❸ button to select a track to repeat.

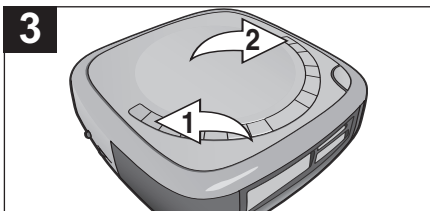

Press the REPEAT button ❶ once; "REPEAT" will appear in the display and the unit will play the same track over and over until the STOP (■) button ❷ is pressed.

TO REPEATEDLY PLAY BACK ALL TRACKS

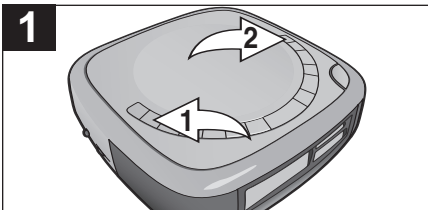

Follow steps 1 and 2 above, but do not select a specific track. Press the REPEAT button ❶ twice; "REPEAT ALL" will appear in the display and the unit will play all the tracks on the CD over and over until the STOP (■) button ❷ is pressed.

TO CANCEL REPEAT MODE, press the REPEAT button twice.
TO CANCEL REPEAT ALL MODE, press the REPEAT button once.

OPERATION (CONTINUED)

TO PROGRAM THE MEMORY (UP TO 32 TRACKS)

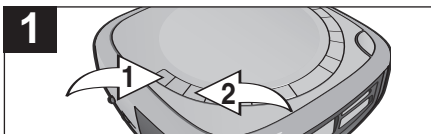

With a CD inserted, press the POWER button ❶ to turn the unit on. Repeatedly press the FUNCTION button ❷ to select CD; "CD" will appear in the display; the total number of tracks will appear in the display.

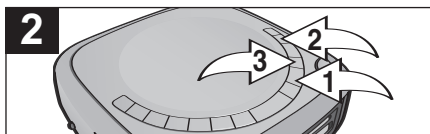

Press the PROGRAM button ❶ once; "PROG" will blink and "1" (program number) will appear in the display. Select the first track to be played back using the SKIP/SEARCH ►► ❷ or ◄◄ ❸ button ("PROG" will not blink while the track is being selected), then press the PROGRAM button ❶ again. Repeat this step to program additional tracks, up to 32 tracks.

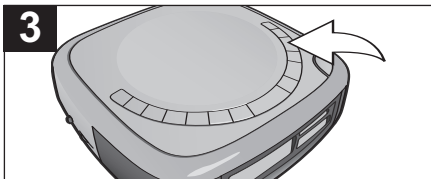

Press the PLAY/PAUSE (►||) button to begin playback. The unit will play all the tracks in the order you programmed them; both "PROG" and "PLAY" will appear in the display.

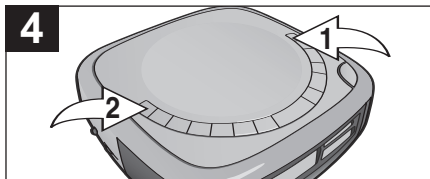

When the disc is through playing, it will stop. Press the STOP (■) button ❶ to stop the disc before it is finished. Press the POWER button ❷ to turn the unit off.

NOTES:

- To skip forward or backward through the programs, press the Skip/Search ►► or ◄◄ button.
- Programming is the ability to preselect the order in which a series of tracks will be played.

FAQ: *How do I clear the memory and exit the Program Playback mode?*
While in the Program Stop mode, press the STOP (■) button; "PROG" will disappear from the display.

OPERATION

TO LISTEN TO AN EXTERNAL UNIT

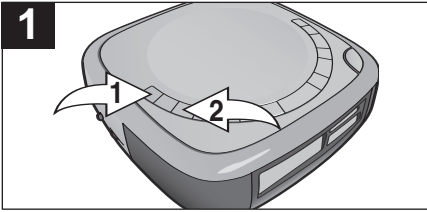

Press the **POWER** button ❶ to turn the unit on. Repeatedly press the **FUNCTION** button ❷ to select the radio; **RADIO** will appear in the display.

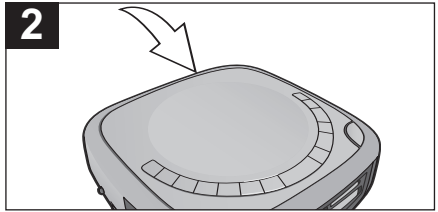

Connect the external unit's **AUDIO OUT** jack to the **AUX IN** jack on the rear of this unit via an audio cable (not included). Turn on the external unit and start playback.

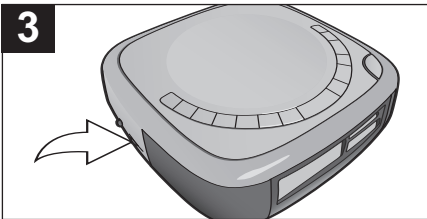

The sound will be heard through this unit's speakers. Adjust the volume using the **VOLUME** control.

NOTES:

- When you are done listening to the external unit, disconnect the audio cable from the **AUX IN** jack (rear of unit).
- If the external unit's cable is disconnected, this unit will turn off automatically.
- To turn on the unit again disconnect the audio cable and press the **POWER** button.

HEADPHONES Jack

For private listening, plug headphones (not supplied) into the Headphones jack on the rear of the unit. When the headphones are plugged in, the speakers will be muted.

OPERATION (CONTINUED)

TO SET OR RESET THE ACTUAL TIME, YEAR AND DATE

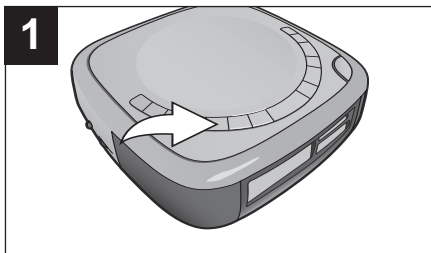

1 With the power off, press and hold the TIME button; the hour digits will blink. Release the TIME button.

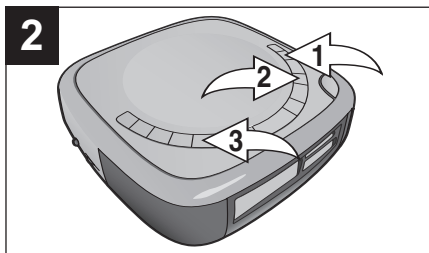

2 Within five seconds, press the SKIP/SEARCH ► 1 or ◀ 2 button to set the present hour. Make sure to set the correct AM/PM setting. When done, press the TIME button 3 again; the minute digits will blink.

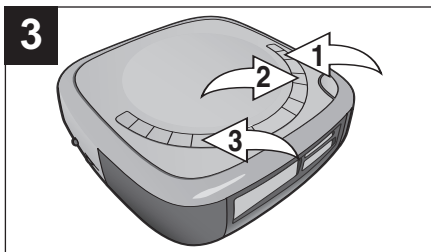

3 Within five seconds, press the SKIP/SEARCH ► 1 or ◀ 2 button to set the present minute. When done, press the TIME button 3 again; the year will blink.

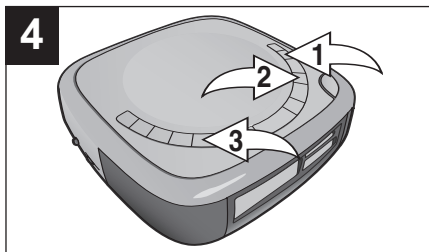

4 Within five seconds, press the SKIP/SEARCH ► 1 or ◀ 2 button to set the present year. When done, press the TIME button 3 again; the month will blink.

CONTINUED ON THE NEXT PAGE

OPERATION (CONTINUED)

5

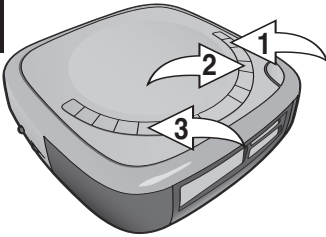

Within five seconds, press the SKIP/SEARCH ►► ❶ or ◀◀ ❷ button to set the present month. When done, press the TIME button ❸ again; the date will blink.

6

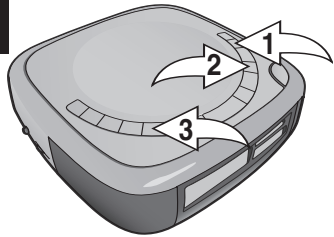

Within five seconds, press the SKIP/SEARCH ►► ❶ or ◀◀ ❷ button to set the present date. When done, press the TIME button ❸ again; the time will then be set.

TIME BUTTON

1

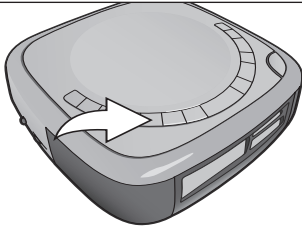

While the unit is off, press the TIME button to view the year, month and date in the Alarm 1 and 2 displays. After six seconds, the displays will revert back to showing the Alarm 1 and 2 settings (alarm time and type).

OPERATION (CONTINUED)

TO SET OR RESET THE ALARM TIME

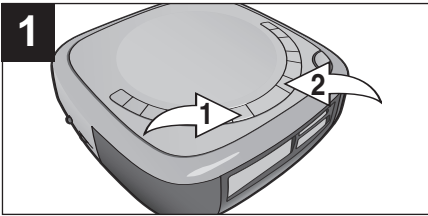

With the power off, press the desired ALARM 1 ❶ or ALARM 2 ❷ button; the hour and "AL1"/"AL2" will blink for five seconds. "PM" will also blink if the time is in the p.m.

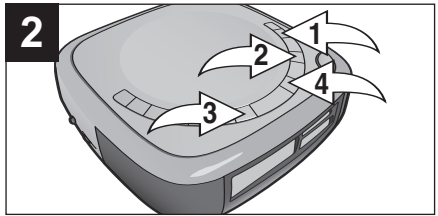

Within five seconds, press the SKIP/SEARCH ►► ❶ or ◄◄ ❷ button to set the alarm hour. Make sure to set the correct AM/PM setting. When done, press the ALARM 1 ❸ or ALARM 2 ❹ button again; the alarm's minute digits and "AL1"/"AL2" will blink for five seconds.

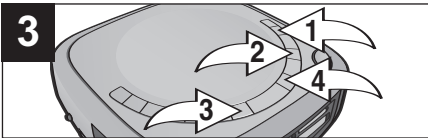

Within five seconds, press the SKIP/SEARCH ►► ❶ or ◄◄ ❷ button to set the alarm minute. When done, press the ALARM 1 ❸ or ALARM 2 ❹ button again; the alarm's function and "AL1"/"AL2" will blink.

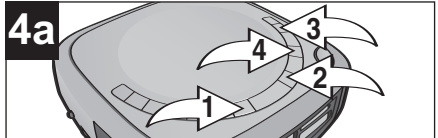

TO SET TO CD:

Within five seconds, press the SKIP/SEARCH ►► ❸ or ◄◄ ❹ button to select CD. Press the ALARM 1 ❶ or ALARM 2 ❷ button again to set the track; "ch" will appear, "1" & "ALR1" will blink. Press the SKIP/SEARCH ►► ❸ or ◄◄ ❹ button to select the track you would like to wake to. Make sure the volume is set as desired. Continue to Step 5.

CONTINUED ON THE NEXT PAGE

OPERATION (CONTINUED)

4b

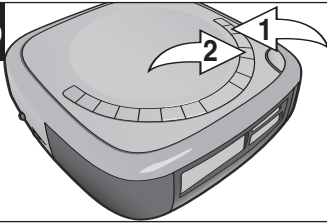

TO SET TO RADIO:

Within five seconds, press the SKIP/SEARCH ►► ❶ or ◀◀ ❷ button to select RADIO. Make sure the desired band and station are set, and the volume is set as desired. Continue to Step 5.

4c

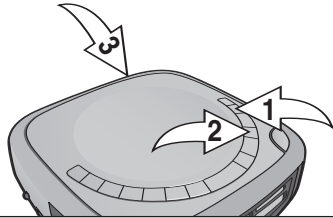

TO SET TO NATURE SOUNDS:

Within five seconds, press the SKIP/SEARCH ►► ❶ or ◀◀ ❷ button to select NATURE SOUND. Make sure the NATURE SOUND switch ❸ is set to the desired position and the volume is set as desired. Continue to Step 5.

4d

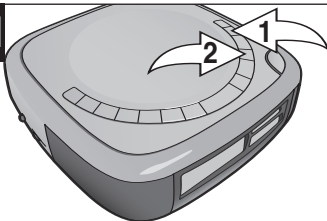

TO SET TO BUZZER:

Within five seconds, press the SKIP/SEARCH ►► ❶ or ◀◀ ❷ button to select BUZZER. Make sure the volume is set as desired. Continue to Step 5.

5

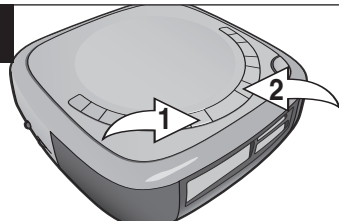

Press the ALARM 1 ❶ or ALARM 2 ❷ button again; the alarm indicator and the Wake Day indicator ("MON to FRI", "SAT & SUN" or "MON to SUN") will blink.

CONTINUED ON THE NEXT PAGE

OPERATION (CONTINUED)

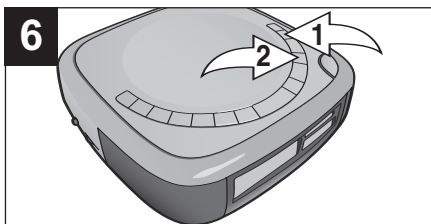

Press the SKIP/SEARCH **▶▶** ❶ or **◀◀** ❷ button to select the desired Wake Day indicator (i.e., to set the alarm to go off only from Monday to Friday, select "MON to FRI".)

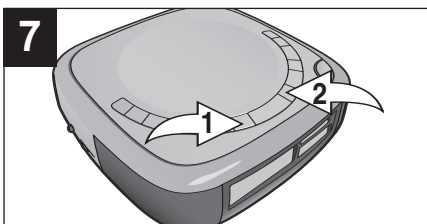

Press the ALARM 1 ❶ or ALARM 2 ❷ button again and the alarm will be set.

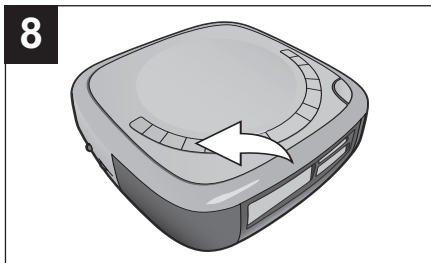

TO ACTIVATE ONE OR BOTH ALARMS: Press the ALARM MODE button once to activate Alarm 1, twice to activate Alarm 2, three times to activate both alarms and four times to deactivate both alarms.

NOTES:

- When the actual time matches the selected preset alarm time(s), **if set to Radio, Nature Sounds or Buzzer**, the unit will automatically turn on for 60 minutes and then shut off. **If set to CD**, without selecting a starting track, the unit will start playback on the first track and play up to 60 minutes. If you select a starting track, the unit will only playback the selected track and the tracks following it and then stop playback, up to 60 minutes. If you select a starting track higher than the track numbers on the CD, the unit will start playback on the first track and play up to 60 minutes.
- **TO SHUT OFF THE ALARM**, see TO SHUT THE ALARM OFF section on the next page.
- While the alarm is sounding, if the other alarm reaches the alarm time, the first alarm will stop sounding and the second alarm will start sounding.
- Make sure you have disconnected the headphones from the Headphones jack (rear of the unit) and disconnected the audio cable from the AUX IN jack (rear of the unit); otherwise, there will be no sound when the actual time matches the preset alarm time.

OPERATION (CONTINUED)

TO SHUT THE ALARM OFF

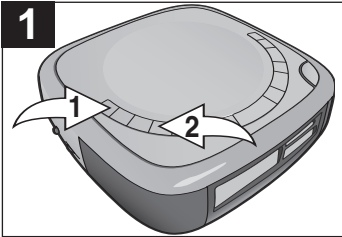

To shut the alarm off, press the POWER button **1** and the alarm time will be reset for the next day. Press the ALARM MODE button **2** repeatedly until the ALARM 1 or ALARM 2 indicator disappears from the display to turn off the alarm and not set it for the next day.

SNOOZE

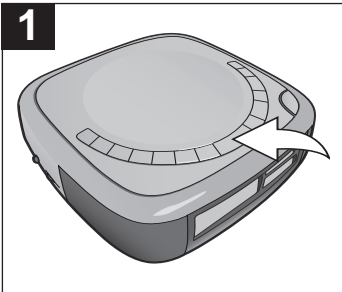

The alarm can be temporarily turned off manually by pressing the SNOOZE button (“SNOOZE” & “AL1”/“AL2” will blink in the display); the alarm will turn back on automatically nine minutes later. It can be repeated for one hour.

DIMMER BUTTON

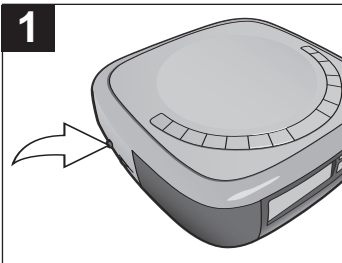

Slide the DIMMER switch to the LOW or HIGH position to adjust the dimmer of the display.

OPERATION (CONTINUED)

TO ACTIVATE THE SLEEP FUNCTION

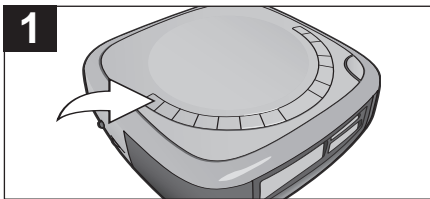

Press the POWER button to turn the unit on. Tune the desired radio station, select a nature sound or insert a CD as previously instructed.

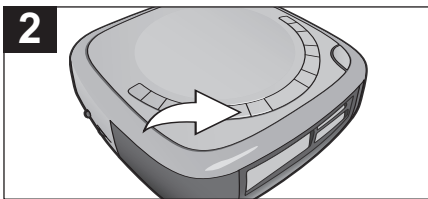

Press the SLEEP button and the sleep time will appear in the display.

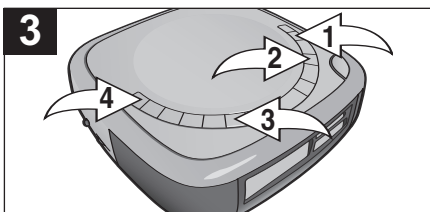

Select a desired sleep time (1 to 99 minutes) using the SKIP/SEARCH ►► ❶ or ◀◀ ❷ button. Press the SLEEP button ❸ to confirm the time setting; "SLEEP" will appear in the display. When the time setting is reached, the unit will turn off. Press the POWER button ❹ (or SNOOZE button) to cancel the sleep timer; the unit will turn off.

NOTE: If you press the SLEEP button again during Sleep mode, the sleep time will count from the beginning again.

CARE AND MAINTENANCE

Caring for Compact Discs

- Treat the disc carefully. Handle the disc only by its edges. Never allow your fingers to come in contact with the shiny, unprinted side of the disc.
- Do not attach adhesive tape, stickers, etc. to the disc label.
- Clean the disc periodically with a soft, lint-free, dry cloth. Never use detergents or abrasive cleaners to clean the disc. If necessary, use a CD cleaning kit.
- If a disc skips or gets stuck on a section of the disc, it is probably dirty or damaged (scratched).
- When cleaning the disc, wipe in straight lines from the center of the disc to the outer edge of the disc. Never wipe in circular motions.

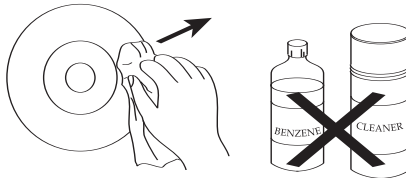
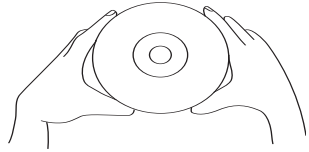

- This unit is designed to play only discs bearing the identification logo as shown here. Other discs may not conform to the CD standard and may not play properly.
- Discs should be stored in their cases after each use to avoid damage.
- Do not expose discs to direct sunlight, high humidity, high temperatures or dust, etc. Prolonged exposure or extreme temperatures can warp the disc.
- Do not stick or write anything on either side of the disc. Sharp writing instruments, or the ink, may damage the surface.



Cleaning the Unit

- To prevent fire or shock hazard, disconnect your unit from the AC power source when cleaning.
- The finish on your unit may be cleaned with a dust cloth and cared for as other furniture. Use caution when cleaning and wiping the plastic parts.
- Mild soap and a damp cloth may be used on the front panel.

TROUBLESHOOTING GUIDE

If you experience a problem with this unit, check the chart below before calling for service.

SYMPTOM	CAUSE	SOLUTION
Unit will not turn on.	AC cord not connected.	Check AC cord connection.
Disc will not play.	CD Compartment door not closed.	Close CD Compartment door.
	Disc inserted incorrectly.	Reinsert disc correctly.
	Dirty or defective CD.	Try another disc.
	Moisture condensation on disc.	Wipe disc with soft cloth.
No sound.	Volume setting is set to minimum.	Increase volume.
	Defective disc.	Try another disc.
Erratic playback.	Dirty or defective disc.	Clean or replace disc.
Time reset to "12:00".	Batteries connected improperly, not connected or dead.	Check the batteries.
	Clock not set.	Set the clock.
Alarm does not turn on.	Alarm is not activated or set properly.	Set and activate alarm as described on page 16.
	Clock is not set.	Set the clock.
AM or FM, no sound.	Power is not on.	Press POWER button to turn the unit on.
	Volume setting is set to minimum.	Increase volume.

SPECIFICATIONS

AUDIO

Frequency Range (AM)520–1710KHz
Frequency Range (FM).....87.5–108MHz

CD SECTION:

Disc Diameter4.72" (120mm)
3.15" (80mm) Single CD
Optical Source.....Semiconductor Laser
Wavelength780nm

GENERAL

Power Supply.....120V, 60Hz AC
Battery Backup 2 x 1.5V "AAA" size batteries
Dimensions..... 7.75 (W) x 2.5 (H) x 7.75 (D) Inches
Weight 3 lbs
Speaker2 x 8 ohms

**FOR ADDITIONAL SET-UP OR OPERATING ASSISTANCE, PLEASE VISIT
OUR WEB SITE AT**

WWW.MEMOREXELECTRONICS.COM

OR CONTACT CUSTOMER SERVICE AT (954) 660-7100.

**PLEASE KEEP ALL PACKAGING MATERIAL FOR AT LEAST 90 DAYS IN
CASE YOU NEED TO RETURN THIS PRODUCT TO YOUR PLACE OF
PURCHASE OR TO MEMOREX.**

**FOR CONSUMER REPLACEABLE PART(S), SEE PART NUMBER(S) ON
THE LOCATION OF CONTROLS, PAGE 5, AND THEN CONTACT FOX
INTERNATIONAL AT 1-800-321-6993.**

Memcorp, Inc.
Weston, FL
Printed in Hong Kong

Visit our website at www.memorexelectronics.com

Free Manuals Download Website

<http://myh66.com>

<http://usermanuals.us>

<http://www.somanuals.com>

<http://www.4manuals.cc>

<http://www.manual-lib.com>

<http://www.404manual.com>

<http://www.luxmanual.com>

<http://aubethermostatmanual.com>

Golf course search by state

<http://golfingnear.com>

Email search by domain

<http://emailbydomain.com>

Auto manuals search

<http://auto.somanuals.com>

TV manuals search

<http://tv.somanuals.com>