



SERVICE PARTS LIST

BUL. 54-16-200C

DIAMOND CORE DRILL

REVISED BUL 6162-1 DATE Feb. '68
WIRING INSTR.

Catalog No. 3820

Starting Serial No. **162-1001**

Both Model and Serial No. must be furnished to obtain correct parts.

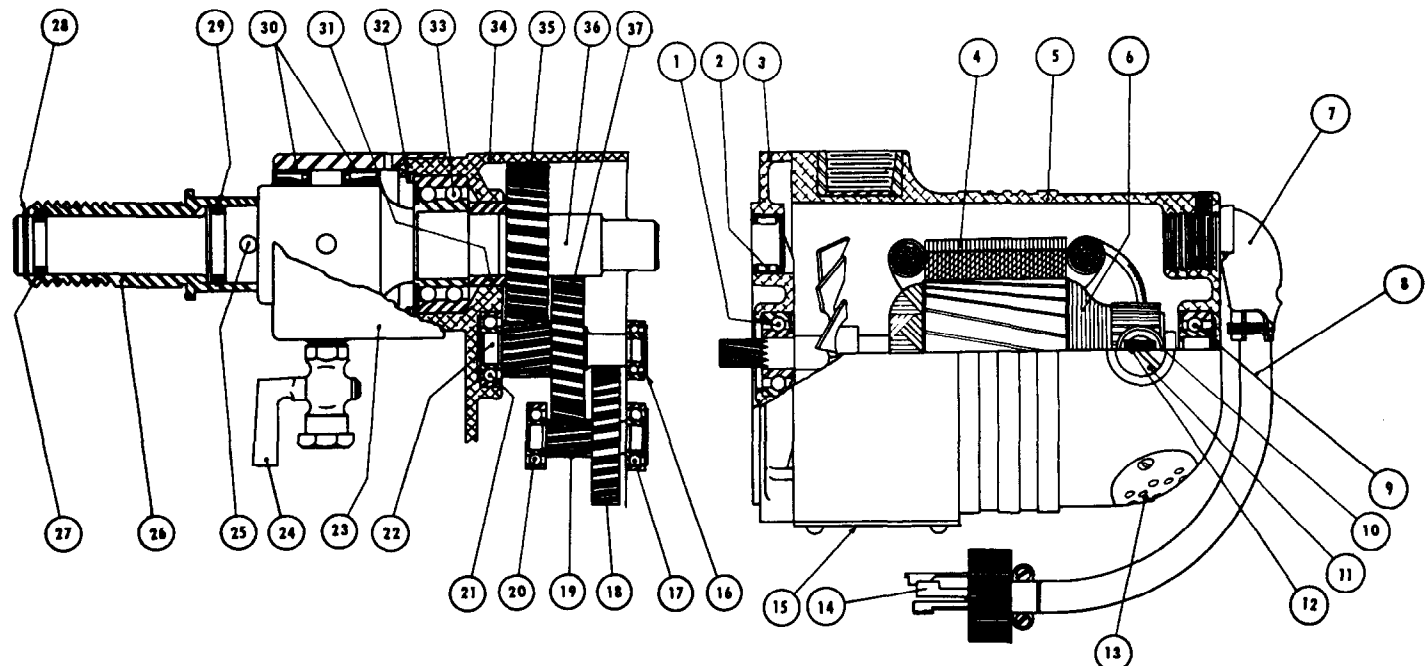

CORRECTS & SUPERCEDES SERVICE BULLETIN 6162-1 DATED 3/4/59

ILLUSTRATED PARTS

FIG.	PART NO.	DESCRIPTION OF PART	FIG.	PART NO.	DESCRIPTION OF PART
1	02-04-1140	Ball Bearing	19	36-66-3451	1st Inter. Pinion Shaft
2	02-50-4820	Needle Bearing	20	02-04-0910	Ball Bearing
3	28-28-0301	Diaphragm	21	02-04-1210	Ball Bearing
4	18-82-1070	Field Assembly	22	36-66-1301	2nd Intermediate Pinion Shaft
5	28-50-4121	Motor Housing	23	43-76-0051	Water Swivel Housing
6	16-82-1220	Armature Assembly	24	45-80-0060	Valve
7	22-56-0060	Right Angle Connector	25	44-60-0050	Shear Pin
8	22-64-0065	Cord (3-wire)	26	45-22-0050	Spindle Sleeve
9	02-04-1070	Ball Bearing (Comm. End)	27	34-40-1100	'O' Ring
10	22-22-0015	Brush Holder Assembly (2)	28	34-60-1800	Snap Ring
11	23-44-0030	Brush Retaining Screw Assy. (2)	29	34-40-1200	'O' Ring
12	22-18-0055	Carbon Brush Assembly (2)	30	45-06-0050	Water Seal
13	44-66-0180	Air Intake Cover Plate	31	45-36-0080	Spindle Spacer
14	23-36-0070	Twist Lock Plug	32	34-80-3800	Spindle Ball Ret. Ring
15	44-66-0050	Body Cover Plate	33	02-20-2520	Ball Bearing
16	02-04-0820	Ball Bearing	34	28-14-0041	Gear Case
17	02-04-0910	Ball Bearing	35	32-75-1261	Spindle Gear
18	32-42-1201	1st Intermediate Gear	36	38-50-0551	Spindle
			37	32-44-1281	2nd Intermediate Gear

MISCELLANEOUS PARTS NOT SHOWN

SIZE OR PART NO.	DESCRIPTION OF PART	SIZE OR PART NO.	DESCRIPTION OF PART
49-18-0050	Water Hose	06-81-8625	6-32x1/4 Rd.Hd.Sems
12-98-2000	Name Plate	06-97-3200	#8
06-85-0200	#6x1/4 P.K. Rd.Hd.	06-97-3800	#14
06-77-0450	#4x1/4 Driv-In	06-42-2000	#3
06-81-2100	1/4-20x3/4 Fil.Hd.	06-42-1200	#212
06-81-1975	1/4-20x2 1/2 Fil.Hd.	06-42-2400	#61
06-81-1150	10-24x3-18 Fil.Hd.	06-83-2650	1/4-20x3/8 Hd'less
06-83-2650	1/4-20x3/8 Hd'less	06-81-5000	1/4-20x3/8 Truss Hd
	Brush Holder Set Screws (2)		Brass Ground Wire Screws
			Kantlink Lock Washers (2)
			Kantlink Lock Washers (2)
			Woodruff Key
			Woodruff Key
			Woodruff Key
			Cord Clamp Set Screw (4)
			Screws

Free Manuals Download Website

<http://myh66.com>

<http://usermanuals.us>

<http://www.somanuals.com>

<http://www.4manuals.cc>

<http://www.manual-lib.com>

<http://www.404manual.com>

<http://www.luxmanual.com>

<http://aubethermostatmanual.com>

Golf course search by state

<http://golfingnear.com>

Email search by domain

<http://emailbydomain.com>

Auto manuals search

<http://auto.somanuals.com>

TV manuals search

<http://tv.somanuals.com>