



# SERVICE PARTS LIST

BULLETIN NO.  
54-06-2411

SPECIFY CATALOG NO. AND SERIAL NO. WHEN ORDERING PARTS		REVISED BULLETIN	DATE
<b>Cordless M12™ 3/8" Driver Drill</b>		54-06-2410	Feb. 2014
CATALOG NO. <b>2410-20</b>	STARTING SERIAL NO. <b>C10B</b>	WIRING INSTRUCTION <b>SEE PAGE 3</b>	

**EXAMPLE:**  

00	0
----	---

 Component Parts (Small #)  
 Are Included When Ordering  
 The Assembly (Large #).

★ = Part number change  
 from previous service  
 parts list.

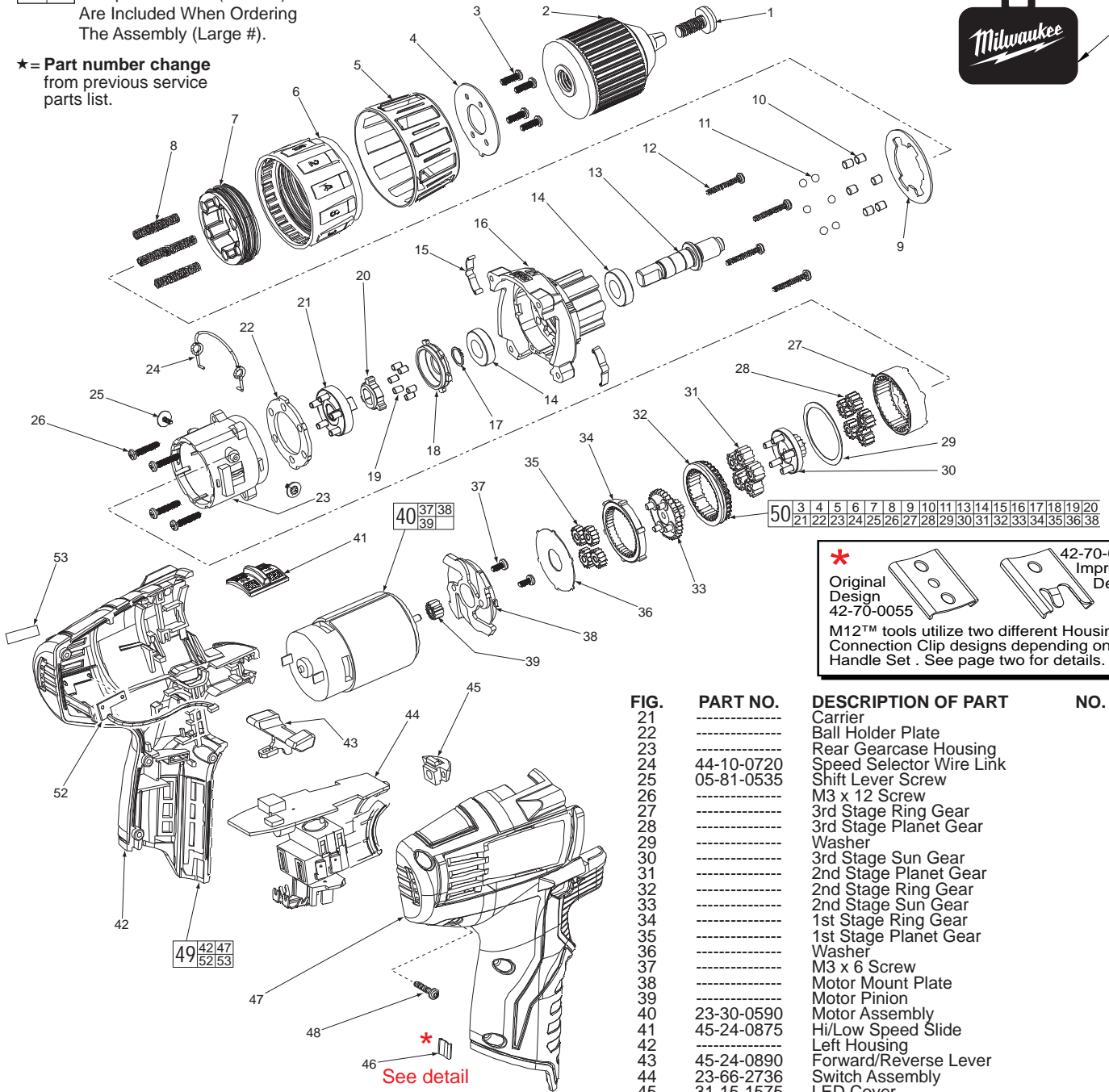

★ Original Design 42-70-0055  
 Improved Design 42-70-0058  
 M12™ tools utilize two different Housing Connection Clip designs depending on the Handle Set. See page two for details.

FIG.	PART NO.	DESCRIPTION OF PART	NO. REQ.
1	05-88-1680	Chuck Screw	(1)
2	42-66-0825	Chuck	(1)
3	-----	M3 x 10 Screw	(4)
4	-----	Spring plate Holder	(1)
5	-----	Clutch Ring Cap	(1)
6	-----	Clutch Ring Cup	(1)
7	-----	Sleeve	(1)
8	-----	Spring	(1)
9	-----	Clutch Washer	(6)
10	-----	Pin	(1)
11	-----	Ball	(6)
12	06-82-7336	Gearcase Screw	(4)
13	-----	Output Shaft	(1)
14	-----	Ball Bearing	(2)
15	-----	Stamping	(2)
16	-----	Front Gearcase Housing	(1)
17	-----	Retaining Ring	(1)
18	-----	Outer Bracket	(1)
19	-----	Locking Pin	(1)
20	-----	Cam Plate	(6)

FIG.	PART NO.	DESCRIPTION OF PART	NO. REQ.
21	-----	Carrier	(1)
22	-----	Ball Holder Plate	(1)
23	-----	Rear Gearcase Housing	(1)
24	44-10-0720	Speed Selector Wire Link	(1)
25	05-81-0535	Shift Lever Screw	(2)
26	-----	M3 x 12 Screw	(4)
27	-----	3rd Stage Ring Gear	(1)
28	-----	3rd Stage Planet Gear	(5)
29	-----	Washer	(1)
30	-----	3rd Stage Sun Gear	(1)
31	-----	2nd Stage Planet Gear	(5)
32	-----	2nd Stage Ring Gear	(1)
33	-----	2nd Stage Sun Gear	(1)
34	-----	1st Stage Ring Gear	(1)
35	-----	1st Stage Planet Gear	(4)
36	-----	Washer	(1)
37	-----	M3 x 6 Screw	(2)
38	-----	Motor Mount Plate	(1)
39	-----	Motor Pinion	(1)
40	23-30-0590	Motor Assembly	(1)
41	45-24-0875	Hi/Low Speed Slide	(1)
42	-----	Left Housing	(1)
43	45-24-0890	Forward/Reverse Lever	(1)
44	23-66-2736	Switch Assembly	(1)
45	31-15-1575	LED Cover	(1)
★46	42-70-0055	Housing Connection Clip	(1)
47	-----	Right Housing	(1)
48	06-82-6350	M3 T-10 Housing Screw	(5)
49	31-44-1240	Housing Kit	(1)
50	14-30-1000	Gearcase Assembly	(1)
51	42-55-2410	Carrying Case, Optional	(1)
52	-----	Fuel Gauge	(1)
53	-----	Fuel Gauge Label	(1)
-----	12-20-1850	Service Nameplate (Not Shown)	(1)
-----	10-20-2697	Warning Label (Not Shown)	(1)

FIG. 38,40,50  
 NOTES:  
 Service replacement gearcase assembly (50) comes with a motor mount plate (38) that must be removed and discarded when servicing. A motor mount plate already exists on the motor assembly (40).

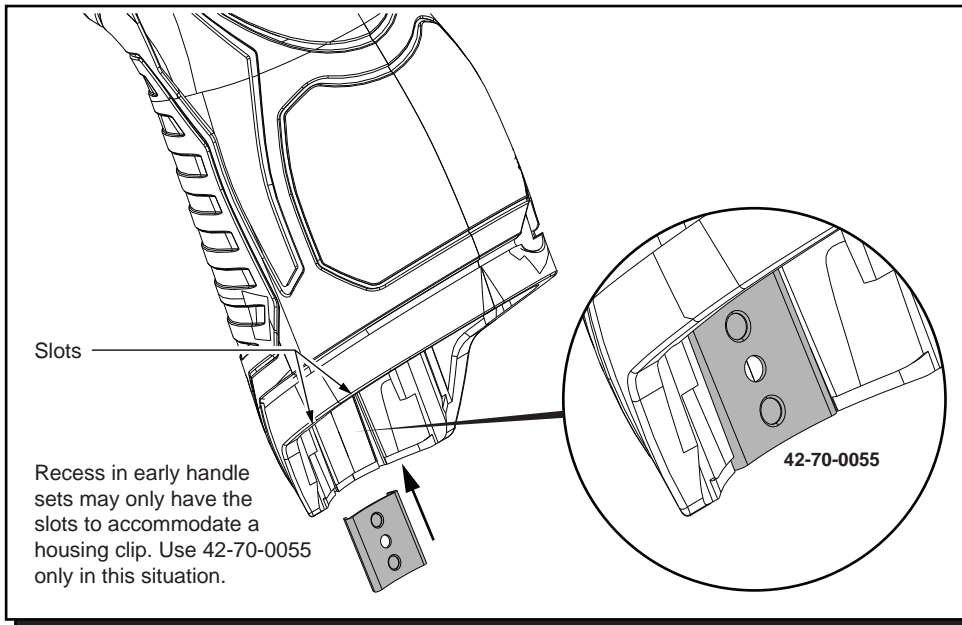

Early M12™ Handle Sets utilize **Housing Connection Clip No. 42-70-0055**. Install this clip design by aligning the side rails of the clip with the two slots in the handle set. Gently push into place with the aid of a small flat blade screwdriver or a similar instrument. Be sure that the clip is properly seated in both slots and that the clip is flush to sub-flush to the end of the handle set. To remove the clip, use the same small flat blade screwdriver or a similar instrument and push the clip out of the handle set. If the clip is loose or will not stay in place, a needle nose pliers can be used to gently bend/pinch the side rails of the clip. If the clip is damaged do not use, replace with a new 42-70-0055 housing clip.

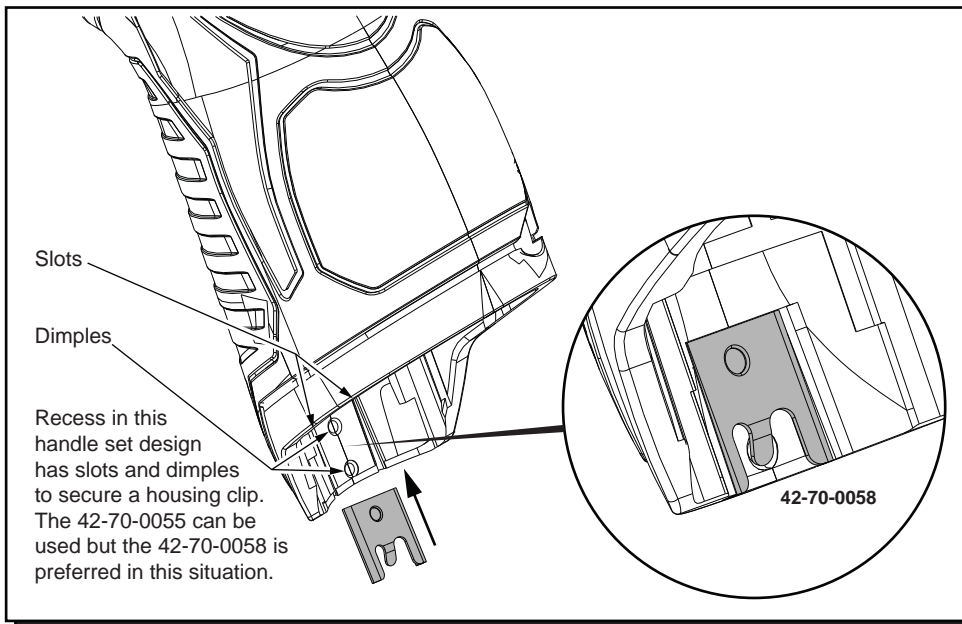

Updated M12™ Handle Sets utilize **Housing Connection Clips No. 42-70-0055 and 42-70-0058. (The 42-70-0058 is a preferred upgrade)**. Install this clip design by aligning the side rails of the clip with the two slots in the handle set. Gently push into place with the aid of a small flat blade screwdriver or a similar instrument. Be sure that the clip is properly seated in both slots and that the tab of the clip snaps down in the round dimpled cavity of the handle set. Be sure that the clip is flush to sub-flush to the end of the handle set. To remove the clip, use the same small flat blade screwdriver or a similar instrument and lift up on the clip tab while pushing the clip out of the handle set. Use a needle nose pliers to gently rebend the clip tab if necessary. If the tab on the clip is damaged during this process and is loose or will not stay in place, replace with a new 42-70-0058 clip.

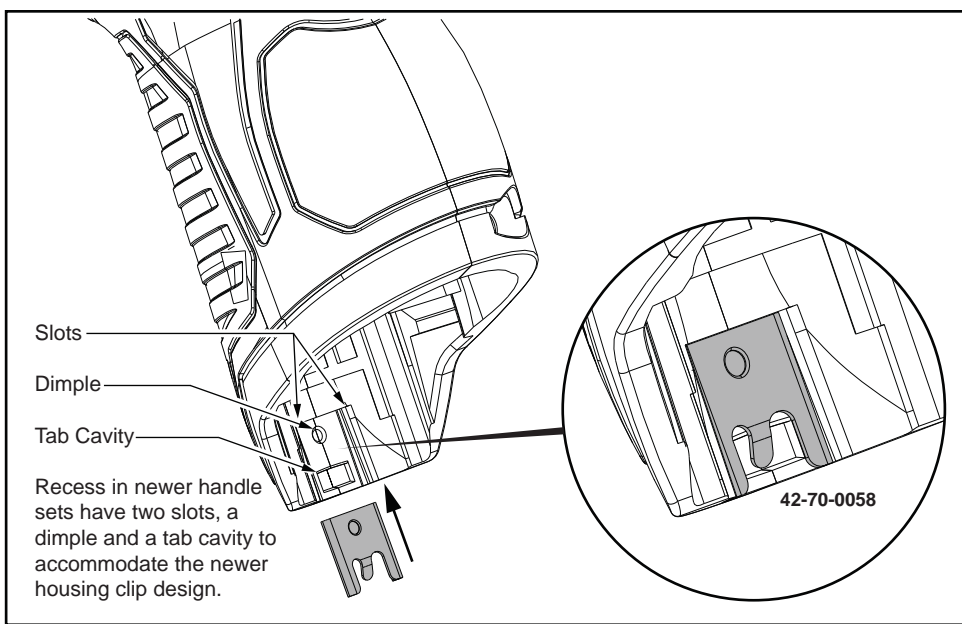

Newer M12™ Handle Sets utilize **Housing Connection Clip No. 42-70-0058**. Install this clip design by aligning the side rails of the clip with the two slots in the handle set. Gently push into place with the aid of a small flat blade screwdriver or a similar instrument. Be sure that the clip is properly seated in both slots and that the tab of the clip snaps down in the rectangular cavity of the handle set. Be sure that the clip is flush to sub-flush to the end of the handle set. To remove the clip, use the same small flat blade screwdriver or a similar instrument and lift the clip tab out of the cavity while pushing the clip out of the handle set. Use a needle nose pliers to gently rebend the clip tab if necessary. If the tab on the clip is damaged during this process and is loose or will not stay in place, replace with a new 42-70-0058 clip.

AS AN AID TO REASSEMBLY, TAKE NOTICE OF WIRE ROUTING AND POSITION IN WIRE GUIDES AND TRAPS WHILE DISMANTLING TOOL

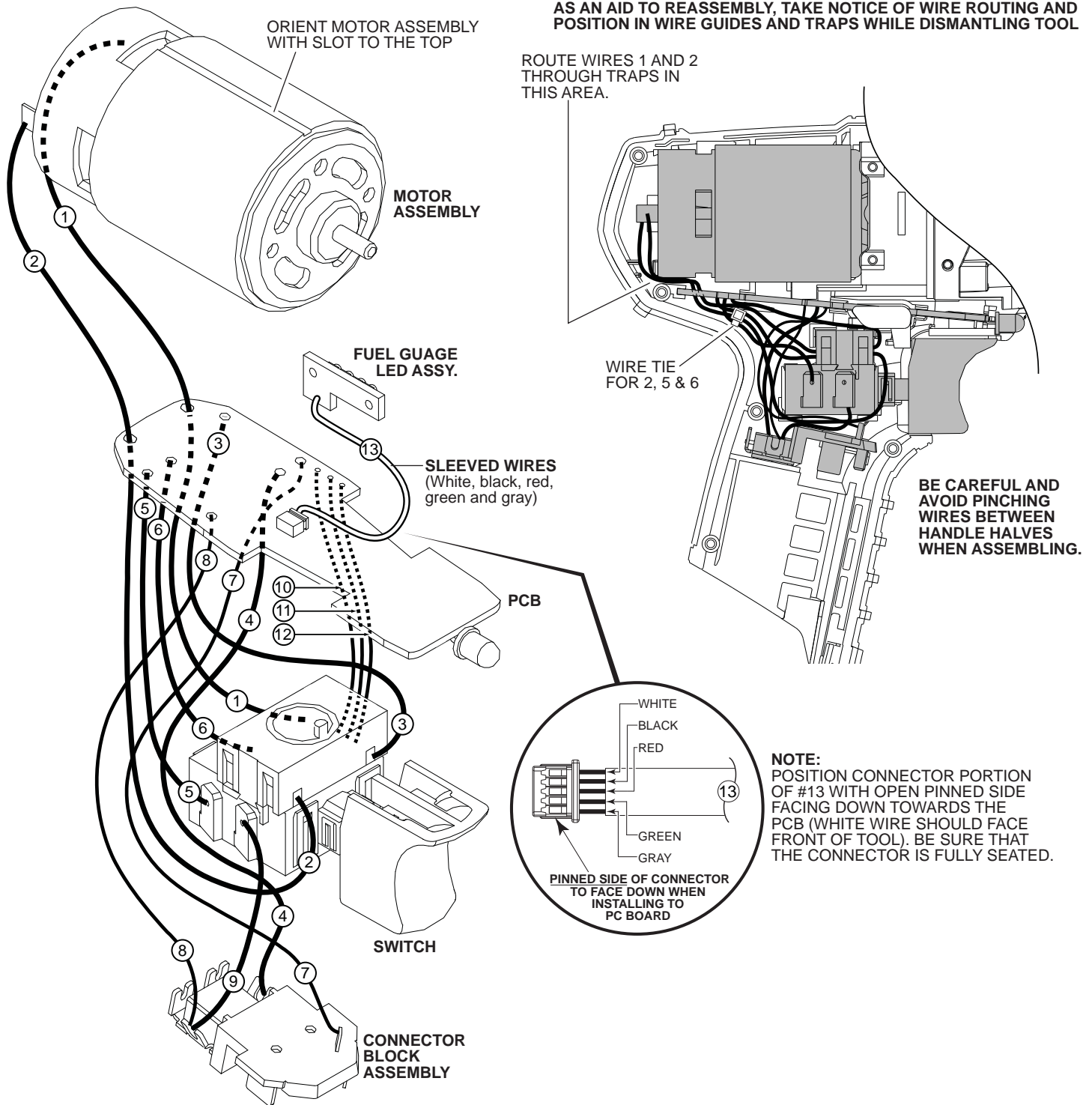

### WIRING SPECIFICATIONS

Wire No.	Wire Color	Origin or Gauge	Length	Terminals, Connectors and 1 or 2 End Wire Preparation
1	Black	23-30-0590	-----	Component of the motor assembly.
2	Red	23-30-0590	-----	Component of the motor assembly.
3	White	23-66-2736	-----	Component of the switch assembly.
4	Black	23-66-2736	-----	Component of the switch assembly.
5	Black	23-66-2736	-----	Component of the switch assembly.
6	Red	23-66-2736	-----	Component of the switch assembly.
7	White	23-66-2736	-----	Component of the switch assembly.
8	Red	23-66-2736	-----	Component of the switch assembly.
9	Red	23-66-2736	-----	Component of the switch assembly.
10	Yellow	23-66-2736	-----	Component of the switch assembly.
11	Blue	23-66-2736	-----	Component of the switch assembly.
12	Black	23-66-2736	-----	Component of the switch assembly.
13	Sleeve	23-66-2736	-----	Component of the switch assembly / fuel gauge LED.

## Free Manuals Download Website

<http://myh66.com>

<http://usermanuals.us>

<http://www.somanuals.com>

<http://www.4manuals.cc>

<http://www.manual-lib.com>

<http://www.404manual.com>

<http://www.luxmanual.com>

<http://aubethermostatmanual.com>

Golf course search by state

<http://golfingnear.com>

Email search by domain

<http://emailbydomain.com>

Auto manuals search

<http://auto.somanuals.com>

TV manuals search

<http://tv.somanuals.com>