



SERVICE PARTS LIST

BUL.54-46-0200

DRILL STAND

Catalog No. 3520

Starting
Serial No.

Both Model and Serial No. must be furnished to obtain correct parts.

REVISED BUL 6118-1	DATE Feb. '68
-----------------------	------------------

WIRING INSTR.

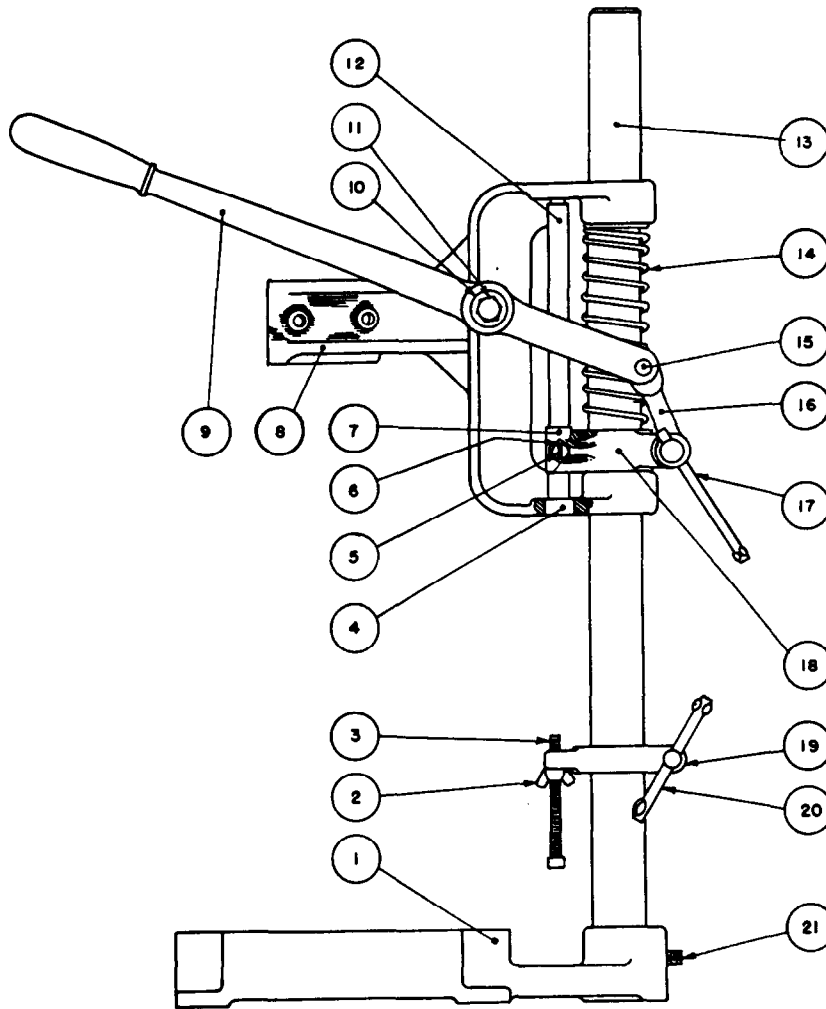

ILLUSTRATED PARTS

FIG.	PART NO.	DESCRIPTION OF PART	FIG.	PART NO.	DESCRIPTION OF PART
1	30-07-5201	Base	12	42-18-0050	Guide Bar
2	06-59-1500	5/16-18 Thr'd Collar Stop Set Sc. Wing Nut	13	44-74-0080	Post
3	06-83-4550	5/16-18x3 Collar Adj. Sc. (Sq. Hd.)	14	40-50-2700	Coil Spring
4	42-40-0150	Guide Bar Lock Bushing	*15	06-65-2800	7/16x1-1/4 Drivlok Pin
5	06-81-7850	1/4-20x1 Runner Adj. Sc. (Fil.Hd.)	16	30-59-0241	Handle Link
*6	06-55-1500	1/4-20 Lock Nut	17	45-04-0130	Bar Clamp T Screw Assembly
7	44-98-0050	Guide Bar Runner	18	30-20-0141	Bar Clamp
8	30-24-0561	Cradle	19	30-86-0141	Bar Collar Stop
9	30-44-0181	Handle	20	45-04-0150	Bar Collar Stop T Assembly
*10	45-88-5261	Handle Swivel Screw Washer	21	06-83-2940	3/8-16x1/2 Set Screw
11	06-75-0600	3/8-16x1-3/4 Handle Swivel Screws			

MISCELLANEOUS PARTS NOT SHOWN

PART NO.	DESCRIPTION OF PART	PART NO.	DESCRIPTION OF PART
42-40-0140	Swivel Screw Bushing	49-96-0070	Sawzall Socket Hd. Wrench
*06-77-0450	4x1/4 Driv-In Name Plate Scrs.	(2) *06-77-0450	4x1/4 Driv-In Spring Clip Scr.
12-17-0600	Name Plate	45-04-0160	Drill Clamping Screw
42-70-0050	Spring Clip	49-96-0085	3/16 Socket Hd. Wrench

Free Manuals Download Website

<http://myh66.com>

<http://usermanuals.us>

<http://www.somanuals.com>

<http://www.4manuals.cc>

<http://www.manual-lib.com>

<http://www.404manual.com>

<http://www.luxmanual.com>

<http://aubethermostatmanual.com>

Golf course search by state

<http://golfingnear.com>

Email search by domain

<http://emailbydomain.com>

Auto manuals search

<http://auto.somanuals.com>

TV manuals search

<http://tv.somanuals.com>