

WIRING INSTRUCTIONS

TITLE

PISTOL HANDLE TOOLS

BULLETIN

MILWAUKEE ELECTRIC TOOL CORP.

13135 WEST LISBON RD BROOKFIELD, WIS

DATE
Dec. '79

58-01-0646

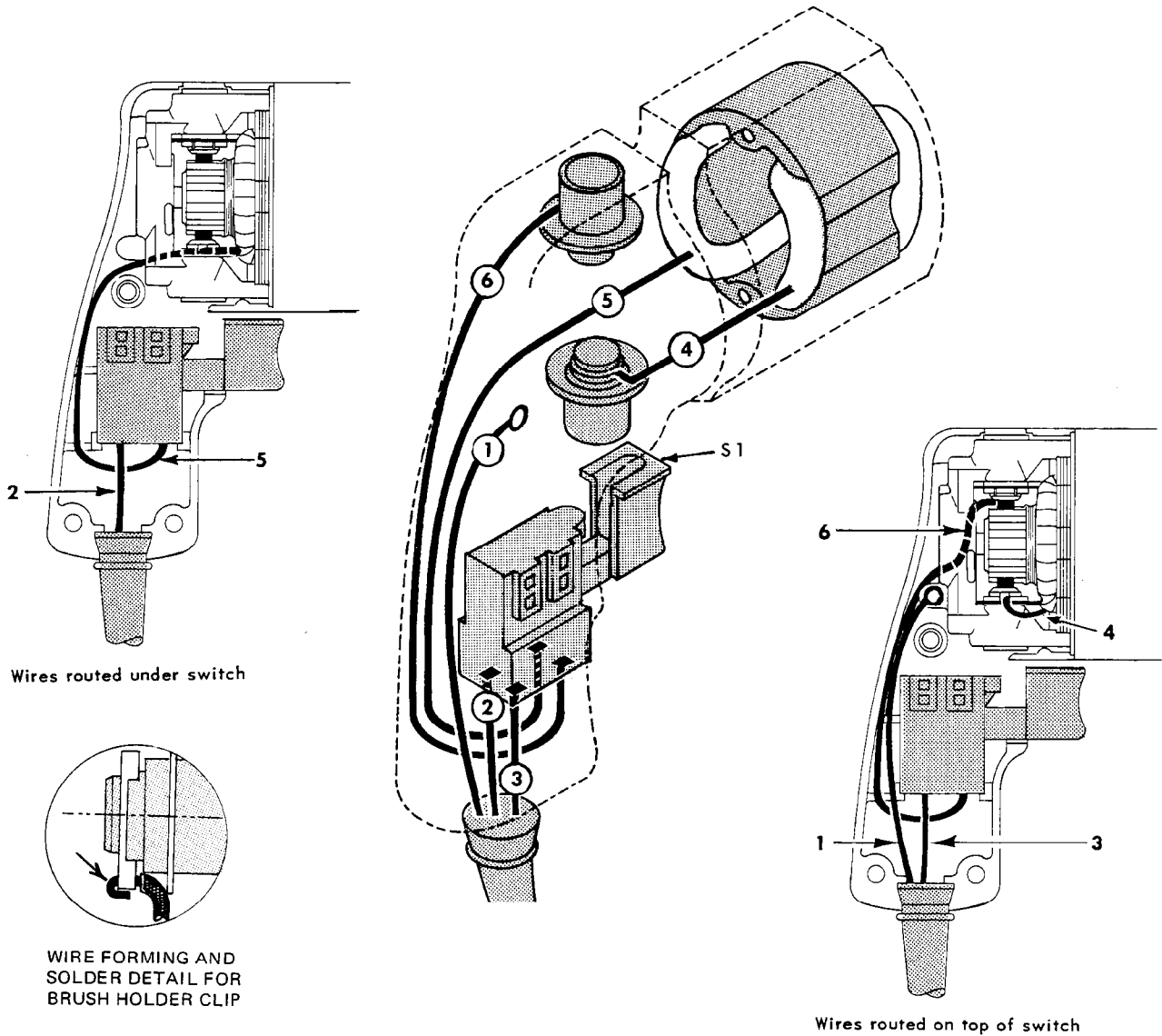

Wires routed under switch

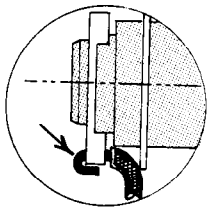

WIRE FORMING AND SOLDER DETAIL FOR BRUSH HOLDER CLIP

Wires routed on top of switch

WIRING SPECIFICATIONS

Wire No.	Wire Color	Origin or Gauge	Length	Terminals, Connectors and 1 or 2 End Wire Preparation.
1	GREEN	CORD	4"	STRIP 3/16" & USE T1
2	BLACK	CORD	1-3/4"	STRIP 3/8" & TIN
3	WHITE	CORD	1-3/4"	STRIP 3/8" & TIN
4	WHITE	FIELD	1-1/2"	STRIP 1/4" & SOLDER
5	BLUE	FIELD	7"	STRIP 3/8" & TIN
6	BLUE	BRUSH	7"	STRIP 3/8" & TIN/STRIP 1/4" & SOLDER

NOTE:

All leads must be held to $\pm 1/8"$.
All field leads to be measured from and perpendicular to laminations.
All lead lengths are before stripping.

TERMINAL DESCRIPTION

Code	Part No.	Qty.
T2	23-74-0390	1

CONNECTOR DESCRIPTION

Code	Part No.	Qty.

Free Manuals Download Website

<http://myh66.com>

<http://usermanuals.us>

<http://www.somanuals.com>

<http://www.4manuals.cc>

<http://www.manual-lib.com>

<http://www.404manual.com>

<http://www.luxmanual.com>

<http://aubethermostatmanual.com>

Golf course search by state

<http://golfingnear.com>

Email search by domain

<http://emailbydomain.com>

Auto manuals search

<http://auto.somanuals.com>

TV manuals search

<http://tv.somanuals.com>