

2-Slot Power Supply Installation Instructions

Document Number 9000-A2-GN1A-10

April 1998

Before You Begin

The 2-slot housing can hold one power supply, which is already installed in the housing. Should you need to replace this power supply, be sure to review the following information.

CAUTION:

Refer installation of power supplies to qualified service personnel.

⚠ HANDLING PRECAUTIONS FOR STATIC-SENSITIVE DEVICES

This product is designed to protect sensitive components from damage due to electrostatic discharge (ESD) during normal operation. When performing installation procedures, however, take proper static control precautions to prevent damage to equipment. If you are not sure of the proper static control precautions, contact your nearest sales or service representative.



Package Checklist

Verify that your package contains the following:

- An ac power supply (See following specifications.)
- An ac power cord

Technical Specifications

Specification	Criteria
Rated Voltage (nominal)	100–250 Vac, 50/60 Hz
Rated Current	1.0 Amps
Operating Voltage Range (limits)	90–265 Vac 47–63 Hz
Power Consumption (typical)	120 Vac 29.7 watts 452 mA 230 Vac 29.9 watts 270 mA Result: 102 Btu per hour

Installing a Replacement Power Supply

Install a replacement power supply using the following instructions.

⚠ WARNING:

Before you remove the power supply module, you *must* unplug the power cord from the power receptacle and from the rear of the housing before attempting to remove the module.

1. Unplug the power cord from the power receptacle and from the rear of the housing.
2. Remove the front bezel by depressing the latch at the top of the housing and lifting the bezel out of the two slots in the bottom of the housing.

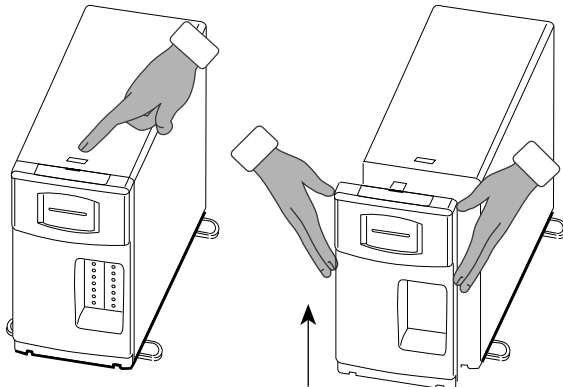

496-15123

3. Unscrew the two screws on the current power supply using a flatblade screwdriver.
4. Remove the current power supply by pulling on the handle.

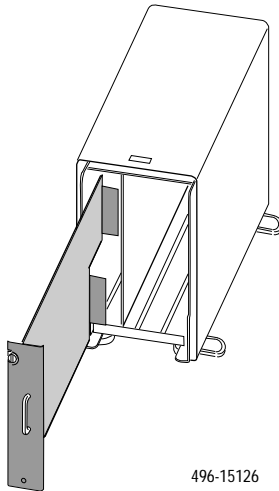

5. Remove the new power supply from its shipping box. Handle only by the top and bottom edges of the sheet metal bracket to avoid damaging it.
6. At the front of the housing, use the attached handle on the power supply to carefully slide the housing into the slot towards the midplane until you feel it connect. Be sure that you slide the power supply in using the guides provided on the housing.
7. Tighten the two screws on the power supply using the screwdriver.
8. Reattach the front bezel to the housing.
9. Reattach the power cord.

Power-Up Verification

⚠ WARNING:

The power cord contains a 3-wire grounding-type plug which has a grounding pin. This is a safety feature. Grounding of the carrier is vital to ensure safe operation. Do not defeat the purpose of the grounding plug by modifying it or by using an adapter.

Prior to installation, use an outlet tester or voltmeter to check the AC receptacle for earth ground. If the power source does not provide a ground connection, consult an electrician to determine another method of grounding the carrier before proceeding with the installation.

Verification Checklist

- Did the NAM's OK LED light? If not, see *Troubleshooting*.

Troubleshooting

Symptom	Possible Cause	Solutions
No power.	The power cord is not securely plugged into the wall receptacle, or is not connected to the power inlet at the rear of the housing.	Check that the power cord is securely attached at both ends.
	The wall receptacle has no power.	Check the wall receptacle power by plugging in some equipment that is known to be working. Check the circuit breaker.
	Power supply is not fully inserted into the housing.	Reinstall the power supply, making sure that you gently push it all the way into the housing.
	Power supply is defective.	Replace power supply.

If you are still having problems with the power supply, contact your service representative.

Power Failure Recovery

In cases of loss and restoration of nominal voltage conditions, this product automatically restores to service without manual intervention.



9000-A2-GN1A-10

Copyright © 1998 Paradyne Corporation

Free Manuals Download Website

<http://myh66.com>

<http://usermanuals.us>

<http://www.somanuals.com>

<http://www.4manuals.cc>

<http://www.manual-lib.com>

<http://www.404manual.com>

<http://www.luxmanual.com>

<http://aubethermostatmanual.com>

Golf course search by state

<http://golfingnear.com>

Email search by domain

<http://emailbydomain.com>

Auto manuals search

<http://auto.somanuals.com>

TV manuals search

<http://tv.somanuals.com>