



# DKW-1 WIRELESS MICROPHONE SYSTEM OPERATING INSTRUCTIONS

Congratulations on your purchase. The Nady DKW-1 is the perfect entry level professional wireless, and delivers clear, transparent audio for a variety of singing and speech applications. Although offered at a breakthrough new low price for a professional wireless, this system is loaded with features:

- High-band VHF (170-216 MHz) operation for interference-free performance
- Companding circuitry for a wide dynamic range (no overloading for loud inputs or background hiss during quiet use)
- Full frequency response from 40 -20,000 Hz
- 250 ft. typical, up to 500 ft. line-of-sight operating range
- Choice of transmitters:
  - WHT-14 Handheld mic with a powerful neodymium cartridge that delivers unsurpassed audio, low handling noise and enhanced feedback rejection
  - WLT-14 Bodypack for lavalier/lapel headworn mic
- DKW-1 receiver with unique vertical space-saving mini portable design and jumbo LED indicators for power ON, transmitter ON and audio peak. Special added circuitry eliminates transmitter ON/OFF "pop" noise.

## OPERATION

### A. DKW-1 RECEIVER

1. Plug the AC/DC adapter (provided) into the **12VDC INPUT JACK (3)** on the back of the receiver. Then plug the power supply into an AC outlet. Slide the **POWER SWITCH (1)** to the ON position. The **POWER ON LED (6)** will now light and the receiver is operational.
2. Rotate and extend **ANTENNA (7)** to the full vertical position.
3. The 1/4" **AUDIO OUTPUT JACK (2)** provides a fixed, unbalanced MIC level audio output for connection to your mixer with the 3 ft. 1/4" to 1/4" cord supplied. As when making any connection, make sure the mixing board's volume is at the minimum level before plugging in the receiver to avoid possible sound system damage.

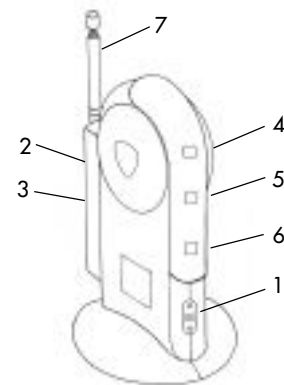

DKW-1

### B. WHT-14 HANDHELD MIC TRANSMITTER

1. Unscrew the **BATTERY COMPARTMENT COVER (8)** and remove, exposing the **BATTERY HOLDER (11)**. Insert a fresh **9V BATTERY (9)**, observing correct polarity as marked, and screw the cover back on to the microphone. To ensure proper battery contact, the cover must be screwed on completely.
2. Turn on the WHT-14 by sliding the **OFF/MUTE/ON SWITCH (10)** to the MUTE position (transmitter on, audio muted) or the ON position (transmitter and audio both on). The **BATTERY INDICATOR LED (12)** will give a single quick flash, indicating usable battery strength. In the case of a dead or low battery, the LED will either not go on at all or will stay on continuously, indicating that the battery should be replaced with a fresh one.
3. The microphone is now ready to use. The **TRANSMITTER SIGNAL RECEIVED LED (5)** on the DKW-1 receiver should now be lit. When ready to speak, slide the transmitter switch to the ON position and adjust the mixing board volume level as needed. The **AUDIO PEAK LED (4)** will flicker on the receiver with the audio peaks of the microphone input. This is normal. If the indicator lights continuously, it means the signal is too loud and there is the possibility of overload distortion. Back off from the microphone until the indicator only flickers on peaks. [Note: Observe care in selecting P.A. volume, transmitter location and speaker placement so that acoustic feedback (howling or screeching) will be avoided. See also Section C 3 below.]

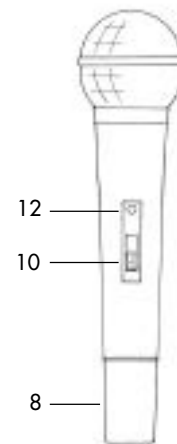

WHT-14

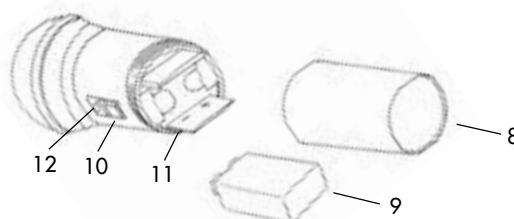

## WLT-14

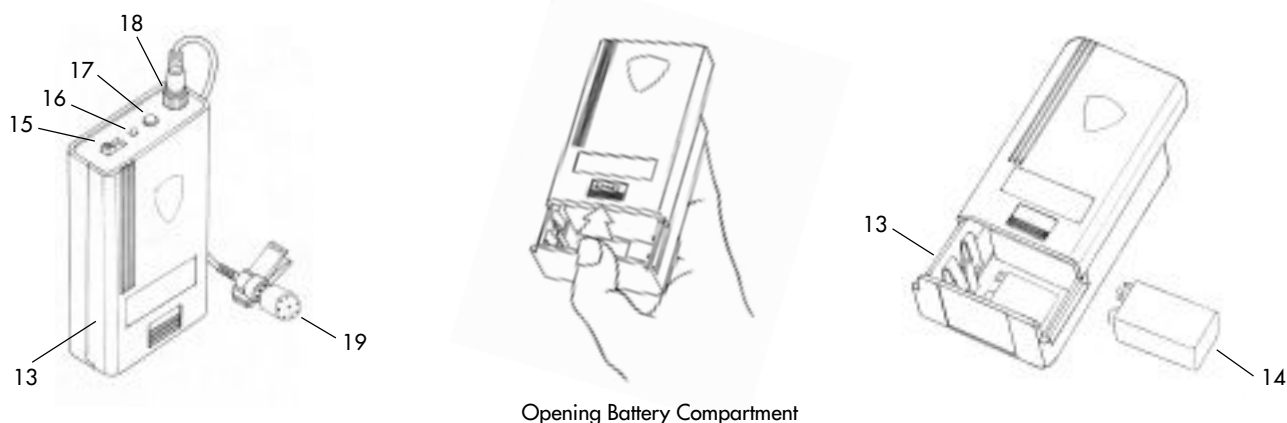

Opening Battery Compartment

### C. WLT-14 LAVALIER/LAPEL OR HEADWORN MICROPHONE BODYPACK TRANSMITTER

1. Snap open the **BATTERY COMPARTMENT (13)** and insert a fresh **9V BATTERY (14)**, observing the correct polarity. Close the compartment.
2. The WLT-14 is provided with a **3.5mm LOCKING JACK (18)** for connecting the microphone. Plug in either the **LAVALIER/LAPEL (19)** or the **HEADWORN MICROPHONE**, as supplied. To secure the connection, turn the metal slip ring on the plug clockwise to thread it on to the jack. To unplug, reverse the process. Slip the transmitter into a pocket or clip on to your clothes. To use the lavalier mic, attach it at chest level. Do not place too close to the mouth—a distance of about six inches usually works best. To use the headworn mic, place it on the head and adjust the mic boom so that the mic is about one inch to the side of the front of the mouth. (Note: the lavalier or headworn mic wire is also the transmit antenna, and rolling up or shortening the wire may reduce the effective operating range. Extend the wire fully during use, and keep it as straight as possible.)
3. Turn on the WLT-14 by sliding the **OFF/MUTE/ON SWITCH (15)** to the MUTE position (transmitter on, audio muted) or the ON position (transmitter and audio both on). The **BATTERY INDICATOR LED (16)** will give a single quick flash, indicating usable battery strength. In the case of a dead or low battery, the LED either will not go on at all or will stay on continuously, indicating that the battery should be replaced with a fresh one.
4. The microphone is now ready to use. The **TRANSMITTER SIGNAL RECEIVED LED (5)** on the DKW-1 receiver should now be lit. When ready to speak, slide the transmitter switch to the ON position and adjust the mixing board volume level as needed. [Note: Observe care in selecting P.A. volume, transmitter location and speaker placement so that acoustic feedback (howling and screeching) will be avoided. Please also observe the pickup patterns of the microphone selected: omnidirectional mics pick up sound equally from all directions and are prone to feedback if not used carefully. Unidirectional mics are more resistant to feedback, but pick up sound sources best that are directly in front of the mic. Also, mics that are farther from the sound source, such as lavaliers, require more acoustic gain and thus are also more prone to feedback than close-source mics such as handheld or headworn mics that are used close to the mouth.]
5. For optimum performance, an **AUDIO INPUT LEVEL CONTROL (17)** is provided. Adjust the microphone gain with a small slot-head screwdriver. Set for maximum possible gain without noticeable distortion on the high level peaks. Turning the trim control clockwise increases the audio level; turning it counterclockwise decreases the audio level. Experiment for the best sound for your application. The **AUDIO PEAK LED (4)** will flicker on the receiver with audio peaks on the microphone input. This is normal. If the indicator lights continuously, it means the signal is too loud and there is the possibility of overload distortion. Re-position the microphone farther from the source or adjust the **AUDIO INPUT LEVEL CONTROL (17)** until the indicator flickers only on the loudest inputs.

## SERVICE

(U.S.) Should your Nady DKW-1 Wireless Microphone System require service, please contact the Nady Customer Service Department via telephone: (510) 652-2411 or e-mail: [service@nadywireless.com](mailto:service@nadywireless.com).

(INTERNATIONAL) For service, please contact the Nady distributor in your country through the dealer from whom you purchased this product.

**The warranty card supplied with this system provides valuable warranty and service information. Store it in a safe place for future reference. Do not attempt to service this unit yourself as it will void your warranty.**



Nady Systems, Inc.  
6701 Shellmound Street  
Emeryville, CA 94608  
[www.nadywireless.com](http://www.nadywireless.com)

## Free Manuals Download Website

<http://myh66.com>

<http://usermanuals.us>

<http://www.somanuals.com>

<http://www.4manuals.cc>

<http://www.manual-lib.com>

<http://www.404manual.com>

<http://www.luxmanual.com>

<http://aubethermostatmanual.com>

Golf course search by state

<http://golfingnear.com>

Email search by domain

<http://emailbydomain.com>

Auto manuals search

<http://auto.somanuals.com>

TV manuals search

<http://tv.somanuals.com>