



KEY FEATURES

- ⊙ Make and receive VoIP calls from a single telephone handset
- ⊙ Landline backup in the event of a failure with your VoIP Service
- ⊙ 1 FXS, 1 FXO port and 1 LAN port
- ⊙ Simple web-based setup and configuration
- ⊙ Supports advanced Call services – Caller ID, Call On-Hold, Call Forward,
- ⊙ Call Waiting and Transfer – service provider dependent*

*Note: The availability of some listed call features are dependent on the service supported by your VoIP service provider. Please consult them for further information.

V210P VoIP technology

NetComm's V210P VoIP Telephone Adaptor has been designed for residential and small business users to deliver predictable real-time voice quality over the Internet. It connects directly to any broadband modem and service (Cable or DSL) plus an account with a VoIP Service Provider.

Suitable for those who want the convenience of a landline (PSTN) combined with the savings of VoIP in one compact unit. The V210P delivers both VoIP and landline calls to a single handset, giving you the cost savings of VoIP with the security of a landline backup if and when you need it. The V210P also features QoS functionality to maintain call quality.



TECHNICAL SPECIFICATIONS

NETWORK PROTOCOL

- SIP v1 (RFC2543), v2(RFC3261)
- IP/TCP/UDP/RTP/RTCP
- IP/ICMP/ARP/RARP/SNTP
- TFTP Client/DHCP
- PPPoE Client
- HTTP Server
- DNS Client
- NAT/DHCP Server

TONE

- Ring Tone
- Ring Back Tone
- Dial Tone
- Busy Tone
- Programming Tone

CODEC

- G.711: 64k bit/s (PCM)
- G.723.1: 6.3k / 5.3k bit/s
- G.726: 16k / 24k / 32k / 40k bit/s (ADPCM)
- G.729A: 8k bit/s (CS-A CELP)
- G.729B: adds VAD & CNG to G.729
- GSM

PHONE FUNCTION

- Volume Adjustment
- Speed dial key
- Phone book
- Flash

VOICE QUALITY

- VAD: Voice activity detection
- CNG: Comfortable noise generator
- LEC: Line echo canceller
- Packet Loss Compensation
- Adaptive Jitter Buffer

IP ASSIGNMENT

- Static IP
- DHCP
- PPPoE

CALL FUNCTION

- Call Hold
- Call Waiting
- Call Forward
- Caller ID
- 3-way conference

SECURITY

- HTTP 1.1 basic/digest authentication for Web setup
- MD5 for SIP authentication (RFC2069/RFC 2617)

DTMF FUNCTION

- In-Band DTMF
- Out-of Band DTMF
- SIP Info

NAT TRAVERSAL

- STUN

SIP SERVER

- Registrar Server
- Outbound Proxy

CONFIGURATION

- Web Browser
- IVR/Keypad

FIRMWARE UPGRADE

- TFTP
- HTTP

AUTO PROVISIONING

- HTTP
- FTP
- TFTP

MODEM & FAX MODES

- G.711 fax/modem pass-through with fax/modem detection
- T.38 support

INTERFACE

- 1 WAN port interface
- 1 LAN port interface
- 1 FXS port interface
- 1 FXO port interface

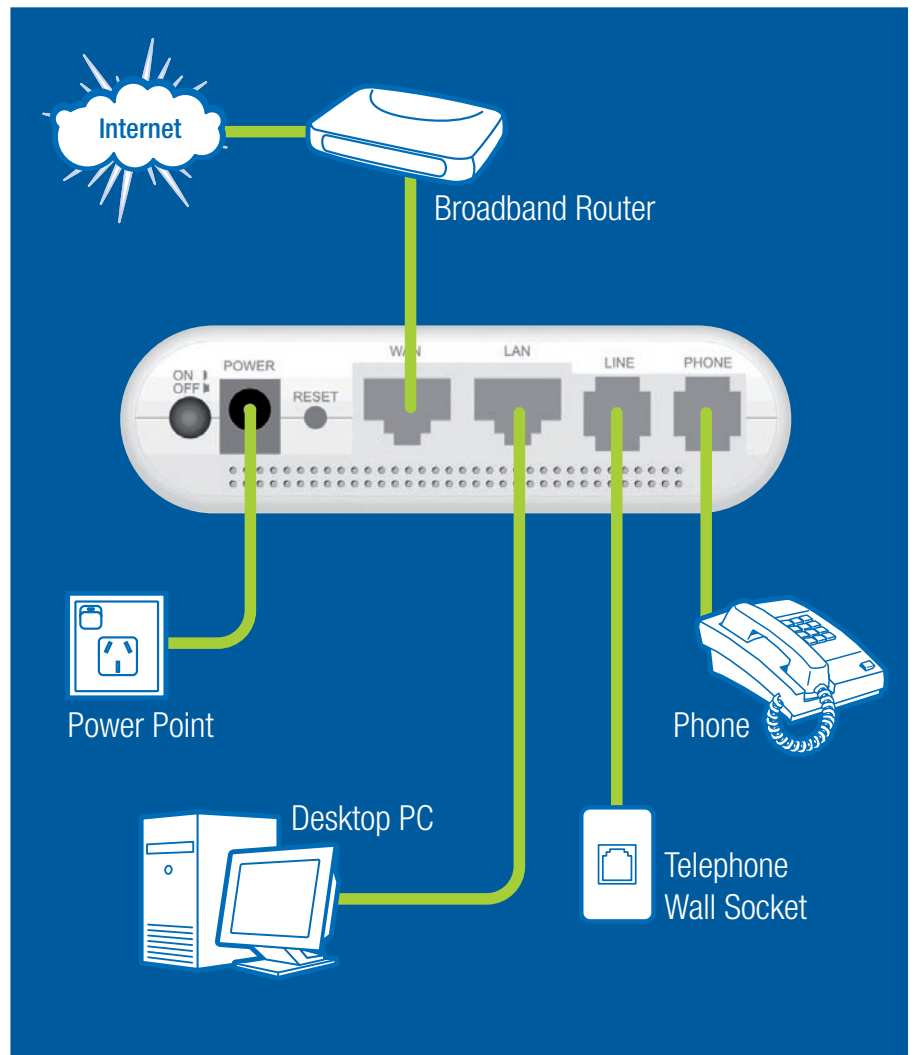

Free Manuals Download Website

<http://myh66.com>

<http://usermanuals.us>

<http://www.somanuals.com>

<http://www.4manuals.cc>

<http://www.manual-lib.com>

<http://www.404manual.com>

<http://www.luxmanual.com>

<http://aubethermostatmanual.com>

Golf course search by state

<http://golfingnear.com>

Email search by domain

<http://emailbydomain.com>

Auto manuals search

<http://auto.somanuals.com>

TV manuals search

<http://tv.somanuals.com>