

Nokia Wireless Headset (HS-56W) User Guide



DECLARATION OF CONFORMITY

We, NOKIA CORPORATION declare under our sole responsibility that the product HS-56W is in conformity with the provisions of the following Council Directive: 1999/5/EC. A copy of the Declaration of Conformity can be found at http://www.nokia.com/phones/declaration_of_conformity/.

CE 0560



The crossed-out wheeled bin means that within the European Union the product must be taken to separate collection at the product end-of-life. Do not dispose of these products as unsorted municipal waste.

Copyright © 2005 Nokia. All rights reserved.

Reproduction, transfer, distribution or storage of part or all of the contents in this document in any form without the prior written permission of Nokia is prohibited.

Nokia and Nokia Connecting People are registered trademarks of Nokia Corporation. Other product and company names mentioned herein may be trademarks or tradenames of their respective owners.

Bluetooth is a registered trademark of Bluetooth SIG, Inc.

Nokia operates a policy of continuous development. Nokia reserves the right to make changes and improvements to any of the products described in this document without prior notice.

Under no circumstances shall Nokia be responsible for any loss of data or income or any special, incidental, consequential or indirect damages howsoever caused.

The contents of this document are provided "as is". Except as required by applicable law, no warranties of any kind, either express or implied, including, but not limited to, the implied warranties of merchantability and fitness for a particular purpose, are made in relation to the accuracy, reliability or

contents of this document. Nokia reserves the right to revise this document or withdraw it at any time without prior notice.

The availability of particular products may vary by region. Please check with the Nokia dealer nearest to you.

Unauthorized changes or modifications to this device may void the user's authority to operate the equipment.

Export Controls

This device may contain commodities, technology or software subject to export laws and regulations from the US and other countries. Diversion contrary to law is prohibited.

9244443/Issue 1 EN

Contents

1. Introduction	5
Bluetooth wireless technology	5
2. Get started	6
Overview.....	6
Chargers and batteries.....	7
Charge the battery.....	7
Switch the headset on or off	8
Pair the headset with a compatible phone	9
Disconnect the headset.....	9
Reconnect the headset.....	10
3. Basic use	11
Wear the headset on either ear.....	11
Adjust the earphone volume	11
Call handling.....	11
Make a call.....	11
Answer a call.....	12
End a call.....	12
Mute or unmute the microphone.....	12
Switch the call between phone and headset.....	13
Use the headset with several phones	13
Reset the headset.....	13
Troubleshooting	13
4. Battery information	15
Care and maintenance	16

1. Introduction

The Nokia Wireless Headset (HS-56W) can be used with compatible phones that support Bluetooth wireless technology. This allows you the freedom to make and receive calls while on the move or in the office.

Read this user guide carefully before using the headset. Read also the user guide for your phone, which provides important safety and maintenance information. Keep the headset out of reach of small children.

■ Bluetooth wireless technology

Bluetooth wireless technology allows you to connect compatible communication devices without cables. A Bluetooth connection does not require that the phone and the headset be in line of sight, but both devices should be within 10 meters (30 feet) of each other. Connections may be subject to interference from obstructions, such as walls, or other electronic devices.

The headset is compliant with the Bluetooth Specification 1.2 supporting the following profiles: Headset Profile 1.1 and Hands-free Profile 1.0. Check with the manufacturers of other devices to determine their compatibility with this device.

There may be restrictions on using Bluetooth technology in some locations. Check with your local authorities or service provider.

2. Get started

■ Overview

The headset contains the following parts:

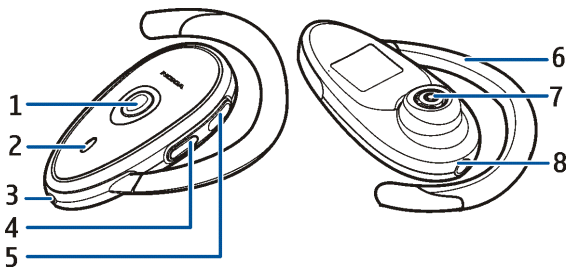

- Power/call key (1)
- Indicator light (2)
- Microphone (3)
- Volume down key (4)
- Volume up key (5)
- Earloop (6)
- Earphone (7)
- Charger connector (8)

Before you can start to use the headset, you must charge the battery, and pair the headset with a compatible phone.



Note: Parts of the headset are magnetic. Metallic materials may be attracted to the headset. Do not place credit cards or other magnetic storage media near the headset, because information stored on them may be erased.

■ Chargers and batteries

Check the model number of any charger before using it with this device. The Nokia Wireless Headset (HS-56W) is intended for use with the ACP-12 and LCH-12 chargers.



Warning: Use only batteries and chargers approved by Nokia for use with this particular enhancement. The use of any other types may invalidate any approval or warranty, and may be dangerous.

For availability of approved enhancements, please check with your dealer. When you disconnect the power cord of any enhancement, grasp and pull the plug, not the cord.

■ Charge the battery

The headset has an internal, nonremovable, rechargeable battery. Do not attempt to remove the battery from the device, as you may damage the device.

1. Connect the charger cable to the headset.
2. Connect the ACP-12 charger to a wall outlet or the LCH-12 charger to the accessory power outlet of your car. The red indicator light is displayed during charging. Charging the battery fully takes about 2 hours.
3. When the battery is fully charged, the red indicator light is dimmed. Disconnect the charger from the wall outlet or the accessory power outlet and the headset. When you disconnect the power cord of the charger, grasp and pull the plug, not the cord.

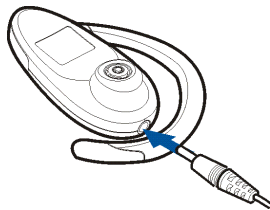

The fully charged battery has power for up to 10 hours of talktime or up to 250 hours of standby time. However, the talk and standby times may vary when used with different mobile phones, products that use a Bluetooth connection, usage settings, usage styles, and environments.

When the battery is running out of power, the headset beeps, and the red indicator light flashes every 5 seconds. Charge the battery.

■ Switch the headset on or off

To switch on, press and hold the power/call key. The headset beeps, and the blue indicator light starts to flash.

To switch off, press and hold the power/call key. The headset beeps, and the red indicator light is displayed briefly.

■ Pair the headset with a compatible phone

1. Switch on your phone and the headset.
2. Activate the Bluetooth feature on the phone. See the user guide of your phone for instructions.
3. Press and hold the volume up key and the volume down key simultaneously. The blue and red indicator lights start to flash alternately. When you release the two keys, the headset is ready to be paired.
4. Set the phone to search for Bluetooth devices. See the user guide of your phone for instructions.
5. Select the headset (Nokia HS-56W) from the list of found devices.
6. Enter the passcode 0000 to pair and connect the headset to your phone. In some phones you may need to make the connection separately after pairing. See the user guide of your phone for details. You only need to pair the headset with your phone once.
7. When the headset is connected to the phone and ready for use, the headset beeps, and the blue indicator light flashes every 3 seconds. The headset appears in the phone menu where you can view the currently paired Bluetooth devices.

Disconnect the headset

To disconnect the paired headset from your phone (for example, to connect the phone to another Bluetooth device), switch off the headset, or disconnect the headset in the Bluetooth menu of your phone.

You do not need to delete the pairing with the headset to disconnect it.

Reconnect the headset

To connect the paired headset to your phone, switch on the headset, or make the connection in the Bluetooth menu of your phone.

You can set your phone to connect with the headset automatically when the headset is switched on. To do this in Nokia phones, change your paired device settings in the Bluetooth menu.

3. Basic use

■ Wear the headset on either ear

The headset is ready to wear on the right ear (1). If you want to use it on the left ear, gently detach the earloop (2) and rotate it (3), and push it back into place (4). Place the headset over your ear (5).

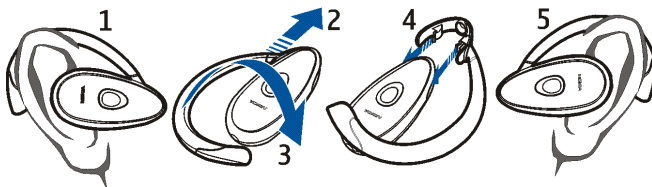

■ Adjust the earphone volume

Press the volume up key to increase or the volume down key to decrease the volume.

■ Call handling

Make a call

To make a call, dial the number with your phone, and press the answer key on your phone.

If your phone supports redialing, press and hold the volume up key of the headset until it beeps (when no call is in progress).

If your phone supports voice dialing with the headset, press and hold the volume down key of the headset until it beeps (when no call is in progress), and proceed as described in the user guide of your phone.

Answer a call

To answer a call, press the power/call key, or press the answer key on your phone. If the automatic answer function is set on in your phone, the phone automatically answers the incoming call after one ring.

If you do not want to answer a call, press and hold the power/call key for 3 seconds.

End a call

To end the currently active call, press the power/call key, or press the end key on your phone.

Mute or unmute the microphone

To mute or unmute the microphone during a call, press and hold the power/call key and the volume up key simultaneously, until you hear a beep.

Switch the call between phone and headset

To switch the call from the headset to a compatible phone, press and hold the power/call key and the volume down key simultaneously until the headset beeps, or use the respective function in your phone.

To switch the call from a compatible Nokia phone to the headset, press and hold the volume down key. On some phones you may need to press and hold the power/call key and the volume down key simultaneously until the headset beeps.

■ Use the headset with several phones

You can pair the headset with up to eight phones but connect it to only one phone at a time.

If the headset is switched on within 10 meters (30 feet) of several paired phones, the headset tries to connect to the phone that was used most recently with it.

If the headset cannot connect to the most recently used phone, it can be connected to other paired phones within about 10 minutes. If the headset is not connected to a phone during this time, the headset is switched off.

■ Reset the headset

If the headset stops functioning, although it has been charged, you need to reset it. Press and hold the volume up key, and plug the charger to the headset (see [‘Charge the battery’](#) on page 7).

■ Troubleshooting

If you cannot connect the headset to your phone, do the following:

- Ensure that the headset is charged, switched on, and paired with and connected to your phone.
- Ensure that the Bluetooth feature is activated on your phone.
- Check that the headset is within 10 meters (30 feet) of your phone and that there are no obstructions between the headset and the phone, such as walls or other electronic devices.

4. Battery information

Your device is powered by a rechargeable battery. The full performance of a new battery is achieved only after two or three complete charge and discharge cycles. The battery can be charged and discharged hundreds of times, but it will eventually wear out. Recharge your battery only with Nokia approved chargers designated for this device.

Unplug the charger from the electrical plug and the device when not in use. Do not leave a fully charged battery connected to a charger, since overcharging may shorten its lifetime. If left unused, a fully charged battery will lose its charge over time.

Use the battery only for its intended purpose. Never use any charger or battery that is damaged.

Leaving the device in hot or cold places, such as in a closed car in summer or winter conditions, will reduce the capacity and lifetime of the battery. Always try to keep the battery between 15°C and 25°C (59°F and 77°F). A device with a hot or cold battery may not work temporarily, even when the battery is fully charged. Battery performance is particularly limited in temperatures well below freezing.

Do not dispose of batteries in a fire as they may explode. Batteries may also explode if damaged. Dispose of batteries according to local regulations. Please recycle when possible. Do not dispose as household waste.

Care and maintenance

Your device is a product of superior design and craftsmanship and should be treated with care. The suggestions below will help you protect your warranty coverage.

- Keep all accessories and enhancements out of the reach of small children.
- Keep the device dry. Precipitation, humidity, and all types of liquids or moisture can contain minerals that will corrode electronic circuits. If your device does get wet, allow the device to dry completely.
- Do not use or store the device in dusty, dirty areas. Its moving parts and electronic components can be damaged.
- Do not store the device in hot areas. High temperatures can shorten the life of electronic devices, damage batteries, and warp or melt certain plastics.
- Do not store the device in cold areas. When the device returns to its normal temperature, moisture can form inside the device and damage electronic circuit boards.
- Do not drop, knock, or shake the device. Rough handling can break internal circuit boards and fine mechanics.
- Do not use harsh chemicals, cleaning solvents, or strong detergents to clean the device.
- Do not paint the device. Paint can clog the moving parts and prevent proper operation.

All of the above suggestions apply equally to your device, battery, charger, or any enhancement. If any device is not working properly, take it to the nearest authorized service facility for service.

Free Manuals Download Website

<http://myh66.com>

<http://usermanuals.us>

<http://www.somanuals.com>

<http://www.4manuals.cc>

<http://www.manual-lib.com>

<http://www.404manual.com>

<http://www.luxmanual.com>

<http://aubethermostatmanual.com>

Golf course search by state

<http://golfingnear.com>

Email search by domain

<http://emailbydomain.com>

Auto manuals search

<http://auto.somanuals.com>

TV manuals search

<http://tv.somanuals.com>