

Install the handset bulkhead mount

1. Hold the handset bulkhead mount at the chosen location and use a soft pencil to mark the 2 screw hole positions.
2. Drill 2 pilot holes for the screws.
3. Screw the handset bulkhead mount to the chosen location using the screws, nuts and washers provided.
4. Hang the handset on the bulkhead mount.

Connect the docking cable to the radio

1. Locate the handset connector at the rear of the radio.
2. Take the protective end cap off of the handset connector, then push the end of the docking cable into the handset connector.

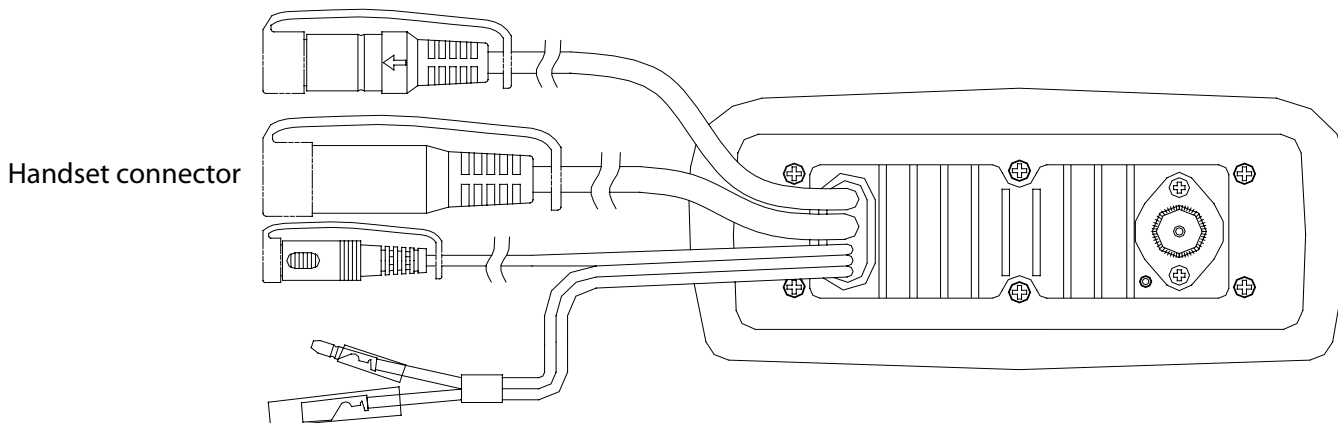

Example of a completed installation with a Northstar Explorer 721

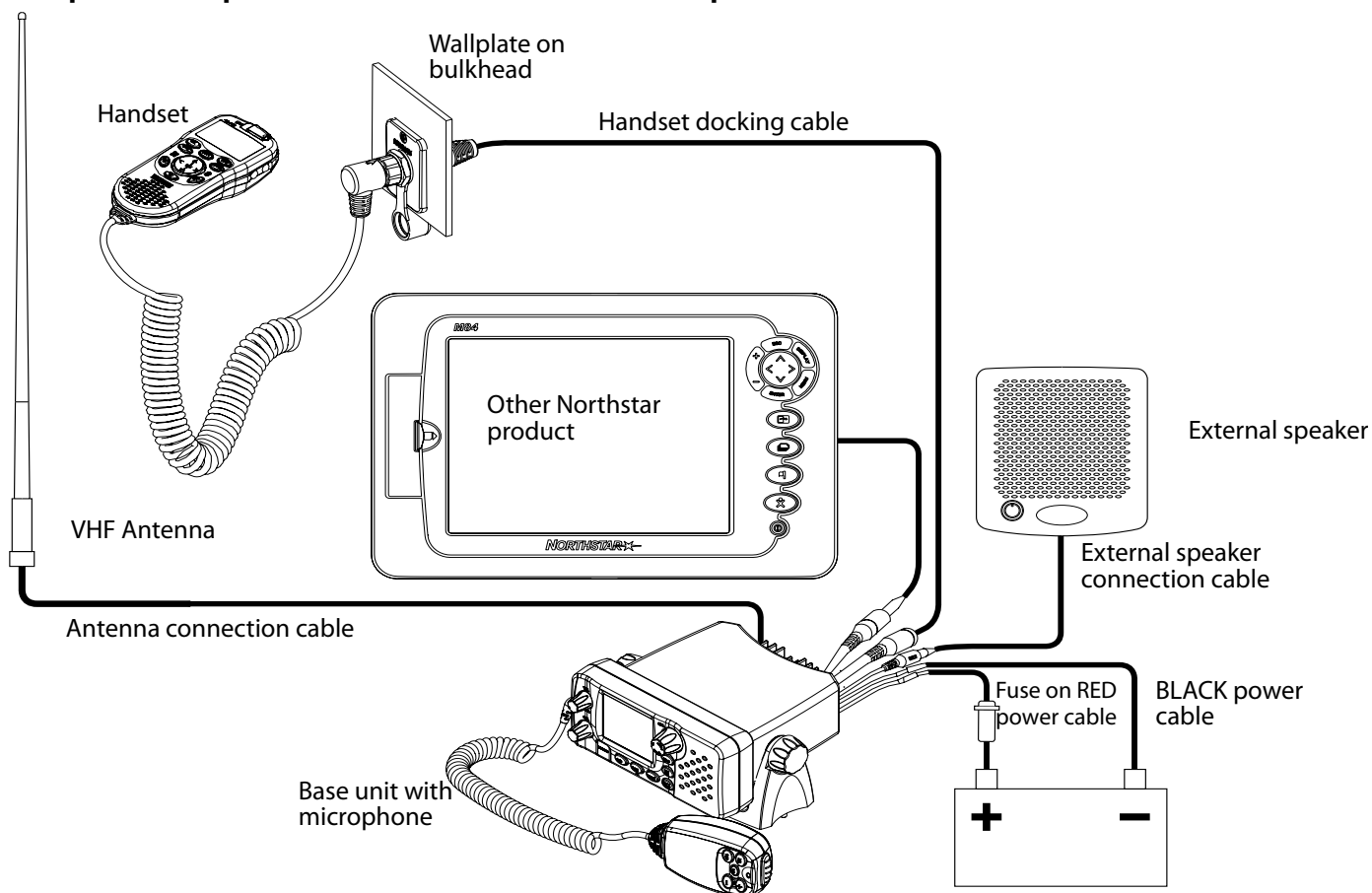

It is the owner's sole responsibility to install and use the instrument in such a manner that will not cause accidents, personal injury or property damage.

Brunswick New Technologies Inc. and its subsidiaries and affiliates disclaim all liability for any use of this product in a way that may cause accidents, damage or that may violate the law.

Governing Language: This statement, any instruction manuals, user guides and other information relating to the product (Documentation) may be translated to, or has been translated from, another language (Translation). In the event of any conflict between any Translation of Documentation, the English language version of the Documentation will be the official version of the Documentation.

This manual represents the product at the time of printing. Brunswick New Technologies Inc. and its subsidiaries and affiliates reserve the right to make changes to specifications without notice.

Copyright © 2006 Brunswick New Technologies Inc. Northstar™ is a registered trademark of Brunswick New Technologies Inc.

Free Manuals Download Website

<http://myh66.com>

<http://usermanuals.us>

<http://www.somanuals.com>

<http://www.4manuals.cc>

<http://www.manual-lib.com>

<http://www.404manual.com>

<http://www.luxmanual.com>

<http://aubethermostatmanual.com>

Golf course search by state

<http://golfingnear.com>

Email search by domain

<http://emailbydomain.com>

Auto manuals search

<http://auto.somanuals.com>

TV manuals search

<http://tv.somanuals.com>