



All products are trademarks of Nostalgia Products Group, LLC.
Worldwide design & utility patented or patents pending.
© 2011 Nostalgia Products Group, LLC.

www.nostalgiaelectrics.com

(rev. 05/09/11)



HKP200

Hollywood by Nostalgia Electrics™ Kettle Popcorn Maker

Instructions and Recipes

CONTENTS

IMPORTANT PRECAUTIONS	3
IMPORTANT SAFEGUARDS	3
INTRODUCTION	4
PARTS & ASSEMBLY	5
HOW TO OPERATE	7
HELPFUL TIPS	8
CLEANING & MAINTENANCE	8
RECIPES	9
RETURNS & WARRANTY	11

SAFETY

Your safety and the safety of others are very important.

We have provided many important safety messages in this manual and on your appliance. Always read and obey all safety messages.



This is the safety alert symbol.

This symbol alerts you to potential hazards that can kill or hurt you and others.

All safety messages will follow the safety alert symbol.

All safety messages will tell you what the potential hazard is, tell you how to reduce the chance of injury, and tell you what can happen if the instructions are not followed.

Appliance Specifications:

120 Volts, 60 Hertz

375 Watts, ETL Approved

IMPORTANT PRECAUTIONS

1. NEVER immerse in water.
2. NEVER use near water.
3. NEVER use an abrasive sponge or cloth.
4. NEVER use a scouring pad on the appliance.
5. NEVER leave appliance unattended while in use.
6. NEVER force Kettle in or out of the brackets as this may cause gears to become misaligned and appliance will not operate properly.
7. Unplug unit from outlet when not in use and during cleaning.
8. DO NOT operate this appliance with a damaged cord or plug, nor if the appliance ever malfunctions.
9. DO NOT clean any parts of this appliance in a dishwasher.
10. Keep out of reach of children.
11. This appliance is NOT A TOY.
12. Unsupervised young children and cognitively challenged individuals should never operate this appliance.
13. Young children should be supervised while in proximity of the appliance to ensure that they do not play with it.

IMPORTANT SAFEGUARDS

Basic safety precautions should always be followed when using electrical appliances, including the following:

1. Read all instructions before operating this appliance.
2. Keep door of Main Unit closed while operating. Do not touch Kettle while operating; it gets very HOT.
3. To protect against electrical shock do not immerse cord, plug or any part of this appliance in water or other liquids.
4. Close supervision is necessary when any appliance is used near children.
5. Unplug from outlet when not in use, before removing parts and before cleaning.
6. DO NOT operate any appliance with a damaged cord or plug, nor if the appliance has been damaged in any manner. Return the appliance to the nearest repair shop for examination or repair.
7. The manufacturer does not recommend the use of accessory attachments. Use of accessory attachments may cause injuries.
8. DO NOT use outdoors.
9. Position the appliance as close to the outlet as possible to prevent injury due to tripping over cord.
10. DO NOT leave Kettle motor running once popping has ceased.
11. Extreme caution must be used when moving this appliance.

12. DO NOT use the appliance for other than its intended use.
13. An appliance that is plugged into an outlet should not be left unattended while in operation.
14. Check Kettle for presence of foreign objects prior to use.
15. Make sure the Kettle is properly attached to brackets before operating and that the motor plug is plugged into the Kettle.
16. A short power supply cord is provided to reduce the risk resulting from becoming entangled or tripping over a long cord.
17. Longer detachable power supply cords can be used if care is exercised in their use.
18. The marked electrical rating of an extension cord should be at least as great as the electrical rating of the appliance.
19. This appliance has a polarized plug (one blade is wider than the other). To reduce the risk of electrical shock, this plug is intended to fit into a polarized outlet only one way. If the plug does not fit fully into the outlet, reverse the plug. If it still does not fit, contact a qualified electrician. Do not attempt to modify the plug in any way.
20. Do not attempt to service this appliance yourself, as opening or removing covers may expose you to dangerous voltage or other hazards. Refer all servicing to qualified service personnel.

SAVE THESE INSTRUCTIONS!

INTRODUCTION

Thank you for purchasing the HOLLYWOOD by NOSTALGIA ELECTRICS™ KETTLE POPCORN MAKER! With its classic style reminiscent of the movie palaces of Hollywood's golden era, this popcorn maker will be the hit of all your star-studded affairs! It features a large, stainless steel kettle with a built-in stirring system and pops up to 8 cups of popcorn per batch. It includes a Measuring Spoon for oil and a Measuring Cup for corn kernels, so every batch pops perfectly. A vented, tempered window and marquee light allows you to watch the popcorn popping, and the handy drawer simplifies serving. Over 150 reusable vinyl letters allow you to customize the marquee. With the HOLLYWOOD by NOSTALGIA ELECTRICS™ KETTLE POPCORN MAKER, popcorn has never tasted so good at home!

PARTS & ASSEMBLY

ASSEMBLY

Your HOLLYWOOD KETTLE POPCORN MAKER comes fully assembled. Simply insert the Kettle into brackets and screw in the crank handle.



ON / OFF & Light Switches

Stainless Steel Kettle

Crank Handle

Drawer

PARTS

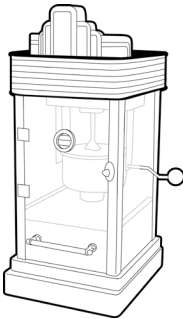

(A) Main Unit

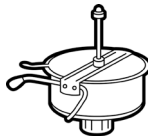

(B) Kettle
(2 oz Capacity)



(C) Kernel Measuring Cup
($\frac{1}{4}$ cup = 2 oz)



(D) Oil Measuring Spoon (1 tbsp)

SWITCH LOCATION

There are separate ON/OFF switches for the light and the main unit. The switches are located on the top of the Marquee. The unit comes with a 20 Watt Lightbulb (installed). Follow directions in Changing the Lightbulb section to change the bulb.



CUSTOMIZING THE MARQUEE

The unit comes with a sheet of reusable vinyl letters and characters to customize the Marquee. Simply peel and stick the letters to the Marquee. If you have trouble peeling the letters, try using an exacto knife or letter opener. You can also print messages from the computer and insert the paper into the Marquee slots. Use your imagination and have fun!



HOW TO OPERATE

Before first use, clean the inside of the unit by wiping with a moist, non-abrasive sponge, towel or cloth and then wipe with a non-abrasive dry towel. Wipe down the inside of the Kettle and be sure it is properly placed in the brackets before starting.

1. First, find a flat surface near an electrical outlet before starting. Make sure your cord is away from any water source. It is acceptable to use an extension cord if needed.
2. Gather your popcorn making supplies: popcorn, seasonings, bowls or bags for holding the popcorn, cooking oil, Kernel Measuring Cup and Oil Measuring Spoon. (Kernel Measuring Cup and Oil Measuring Spoon are included with your unit)
3. Plug in the appliance while switch is flipped to OFF position.
4. Make sure Kettle is properly secured in support brackets.
5. Make sure Kettle motor is plugged in.
6. Turn appliance ON by flipping the switch on the top of the machine. Allow the appliance to run 3-5 minutes to heat up Kettle.
7. Turn unit OFF.
8. Use the Oil Measuring Spoon supplied with your HOLLYWOOD KETTLE POPCORN MAKER to add 1 tablespoon of your favorite popcorn cooking oil to the Kettle. For best popping results, it is suggested to use light vegetable oil.
9. Add $\frac{1}{4}$ cup popcorn kernels to the Kettle using supplied Kernel Measuring Cup.



10. Turn the unit ON and close the door. In no time at all, you will hear the popping begin. Fresh, hot popcorn will begin to burst out of the flip lids on the Kettle - just like at the theater!
11. Once the kernels have stopped popping, tip the Kettle using the red knob on the Crank Handle to release the popcorn.
12. To serve popcorn, simply pull out drawer. The door to the Main Unit locks magnetically which helps seal in the heat so that popcorn stays warm longer.



HELPFUL TIPS

SMOKING

If your HOLLYWOOD KETTLE POPCORN MAKER begins to smoke during cooking, it may be due to grease build up. In order to reduce smoking, make sure that you clean the inside of the Kettle between uses.

CLEANING & MAINTENANCE

1. Make sure appliance is unplugged and completely cooled before cleaning. Unplug the outer plug to the outlet as well as the Kettle motor plug inside the Main Unit.
2. Use slightly damp, non-abrasive sponge, towel or cloth to wipe down the inside and outside of Main Unit, then wipe with a non-abrasive towel to dry.
3. After Kettle motor has been unplugged and Kettle has completely cooled, turn Crank Handle clockwise to loosen and remove from Kettle.
4. Remove Kettle from support brackets.
5. Take Kettle out of the Main Unit. After removing Kettle from Main Unit, fill $\frac{2}{3}$ of Kettle with hot, soapy water.
6. Let the Kettle sit for 15 – 20 minutes to cut the grease. (time may vary – use your own judgment depending on the amount of cleaning necessary)
7. Empty water. If necessary, use the scrubber side of a cleaning sponge to scrub inside of Kettle.
8. Rinse inside carefully and dry.
9. Wipe outside of Kettle with damp cloth and dry.
10. Reattach Kettle to Main Unit and then reattach the Crank Handle by inserting Crank Handle into the Kettle. Turn the Crank Handle counter-clockwise to tighten.

NOTE: To protect the motor plug from getting wet, **never immerse the Kettle in any liquid**. Never place any parts in the dishwasher. Always wash by hand.

CHANGING THE BULB

The unit comes with a 20 watt lightbulb installed to make the Marquee light up. When the bulb goes out, you may change it. Use a regular lightbulb up to 20 watts or a compact fluorescent lightbulb up to 20 watts for greater light intensity (a compact fluorescent lightbulb is the equivalent of 150 watts with a 20 watt output).

Follow the steps below to change the lightbulb:

1. While unit is turned off and has cooled completely, unscrew the nine screws underneath the Marquee using a Phillips head screwdriver. There are three screws on the front underside of the Marquee, three on the right underside of the Marquee and three on the left underside of the Marquee.
2. Lift top of Main Unit to expose the bulb.
3. Unscrew lightbulb and replace with either a regular lightbulb up to 20 watts or a compact fluorescent lightbulb up to 20 watts.
4. Replace top of Main Unit and replace screws.

RECIPES

The HOLLYWOOD KETTLE POPCORN MAKER makes hot, fresh, theater-style popcorn anytime! Enjoy your freshly popped corn in a variety of ways:

- Regular theater style popcorn – add butter and salt.
- Add a pinch of sugar and salt to popcorn for a sweet kettle corn taste.
- Flavored popcorn – add seasoning from any gourmet popcorn seasoning kit.
- Try some of these fun recipes
- 1 Gallon = 16 Cups

PARMESEAN POPCORN

- 1 Gallon of Popped Corn Pop corn kernels using the HOLLYWOOD KETTLE POPCORN MAKER as directed on page 7.
- 1 Tsp Garlic Powder Combine garlic powder, green onions, cracked pepper, sea salt and parmesan cheese. Set aside.
- 3 Green Onions, finely chopped In a large mixing bowl, drizzle hot olive oil over popcorn.
- ½ Tsp Cracked Pepper Toss until well coated.
- 1 Tsp Sea Salt Slowly add in dry ingredients while continuously stirring popcorn until well coated.
- 1 Cup Parmesan Cheese, grated (more or less to taste) You may also shake the dry ingredients over popcorn in a large paper or muslin bag.
- 3 Tbsps Olive Oil, heated

TRADITIONAL POPCORN BALLS

- ½ Cup Popcorn Pop corn kernels using the HOLLYWOOD KETTLE POPCORN MAKER as directed on page 7.
- ½ Cup Corn Syrup
- ½ Cup Granulated Sugar Mix corn syrup, sugar and salt together in pot and dissolve over medium heat for about 3 minutes.
- ½ Teaspoon Salt Add popcorn to pot, stirring and tossing consistently until popcorn is evenly coated at low heat.
- 1 Stick of Butter, softened Remove from heat.

Use softened butter to form balls while popcorn mixture is still warm.

Wrap individual balls in plastic wrap, tie and store at room temperature.

CHUNKY MONKEY

- 1 Gallon Popcorn
Pop corn kernels using the HOLLYWOOD KETTLE POPCORN MAKER as directed on page 7.
- 1 12-oz bag Semi-Sweet Chocolate Chips
Melt chocolate chips and peanut butter morsels over stove, as packaging recommends.
- 1 12-oz bag Peanut Butter Morsels
Line cookie sheet with wax paper.
- 4.2 oz bag Banana Chips, broken into small pieces
Toss together popcorn and banana chips.
- 11-oz bag Peanuts
Spread popcorn and banana chip mixture evenly over cookie sheet.
Drizzle melted chocolate and peanut butter mixture over popcorn and banana chips.
Sprinkle peanuts over chocolate and peanut butter mixture.
Allow to cool.
When chocolate and peanut butter has hardened, break up the Chunky Monkey into pieces.
Can be stored in plastic freezer bags.

POPCORN PEPPERMINT BARK

- 1 Gallon Popped Corn
Pop corn kernels using the HOLLYWOOD KETTLE POPCORN MAKER as directed on page 7.
- 1 12-oz bag Semi-Sweet or Dark Chocolate Chips
Melt chocolate chips over stove, as packaging recommends.
- 1¼ cup Peppermint Sticks, crushed
Line cookie sheet with wax paper.
Spread popcorn evenly over cookie sheet.
Drizzle melted chocolate over popcorn.
Sprinkle crushed peppermints over chocolate.
Allow to cool.
When chocolate has hardened, break up Popcorn Peppermint Bark into pieces.
Can be stored in plastic freezer bags.

RETURNS & WARRANTY

SHOULD YOUR UNIT NOT WORK OR IS DAMAGED WHEN YOU FIRST TAKE IT OUT OF THE BOX, PLEASE RETURN IT TO THE PLACE OF PURCHASE IMMEDIATELY.

HOLLYWOOD by NOSTALGIA ELECTRICS™ KETTLE POPCORN MAKER / HKP200

Should you have any questions, please contact us via email or at the customer service number listed below between the hours of 8:00 AM and 5:00 PM, Monday through Friday, Central Standard Time.

Distributed by:

Nostalgia Products Group LLC
1471 Partnership Dr.
Green Bay, WI 54304-5685
Customer Service
Phone: (920) 347-9122
Web: www.nostalgielectrics.com

Customer Service Inquiry

To submit a Customer Service inquiry, go to www.nostalgielectrics.com and fill out the Customer Service Inquiry form and click the Submit button.

A representative will contact you as soon as possible.

This appliance is designed and built to provide many years of satisfactory performance under normal household use. The distributor pledges to the original owner that should there be any defects in material or workmanship during the first 90 days of purchase, we will repair or replace the unit at our option. Our pledge does not apply to damages caused by shipping, mishandling or unit being dropped. A product deemed defective either from manufacturing or being mishandled is up to the distributor's discretion. In order to obtain service under this warranty, please contact Nostalgia Products Group, LLC at the telephone number listed above or by filling out the Customer Service Inquiry Form located at www.nostalgielectrics.com.

This warranty does not apply to re-manufactured merchandise.

Please read these instructions carefully. Failure to comply with these instructions, damages caused by improper replacement parts, abuse or misuse will void this pledge to you and is being made in place of all other expressed warranties.

Free Manuals Download Website

<http://myh66.com>

<http://usermanuals.us>

<http://www.somanuals.com>

<http://www.4manuals.cc>

<http://www.manual-lib.com>

<http://www.404manual.com>

<http://www.luxmanual.com>

<http://aubethermostatmanual.com>

Golf course search by state

<http://golfingnear.com>

Email search by domain

<http://emailbydomain.com>

Auto manuals search

<http://auto.somanuals.com>

TV manuals search

<http://tv.somanuals.com>