

OLYMPUS MAUSB-200

USB Read/Write Memory Adapter

Start Guide

OLYMPUS IMAGING CORP.

Shinjuku Monolith, 3-1 Nishi-Shinjuku 2-chome,
Shinjuku-ku, Tokyo, Japan
Customer support (Japanese language only):
Tel. 0426-42-7499

OLYMPUS IMAGING AMERICA INC.

Two Corporate Center Drive, P.O. Box 9058,
Melville, NY 11747-9058 U.S.A.
Tel. 1-631-844-5000
24/7 online automated help:
<http://www.olympusamerica.com/support>
Phone customer support: Tel. 1-888-553-4448 (Toll-free)

OLYMPUS IMAGING EUROPA GMBH

Wendenstr. 14-18, D-20097 Hamburg, Germany
Tel: +49 40-23 77 3-0 / Fax: +49 40-23 07 61
Technical Customer Support: Please visit our
homepage: <http://www.olympus-europa.com>
or call NUMBER: 00800 - 67 10 83 00 (Toll-free)
+49 180 5-67 10 83 or +49 40-237 73 899 (Charged)

Introduction

Thank you for purchasing our product. The MAUSB-200 USB Read/Write Memory Adapter (hereinafter referred to as "the adapter") is designed exclusively for reading and writing data to an xD-Picture Card™ (hereinafter referred to as "card"). You can transfer large amounts of data to and from the card quickly and easily using a computer equipped with a USB port.

- Before using the adapter, read this Start Guide carefully.
- For more details, refer to the Reference Manual (PDF file) on the OLYMPUS web site or contact our Customer Support.

MAUSB-200 Reference Manual: <http://www.olympus.com.jp/en/support/imgs/digicamera/download/manual/#mausb>

- Every effort has been made to ensure that the information in this leaflet is correct. If you find errors or anything else questionable, please contact our Customer Support.
- Olympus shall not be liable for any damages, passive damages, or demands from a third party resulting from improper use of the adapter.

For customers in North and South America

For customers in USA

Declaration of Conformity
Model Number : MAUSB-200
Trade Name : OLYMPUS
Responsible Party : OLYMPUS IMAGING AMERICA INC.
Address : 2 Corporate Center Drive, P.O. Box 9058, Melville, NY 11747-9058 U.S.A.
Telephone Number : 631-844-5000

Tested To Comply With FCC Standards
FOR HOME OR OFFICE USE

This device complies with Part 15 of the FCC rules. Operation is subject to the following two conditions:

- (1) This device may not cause harmful interference.
- (2) This device must accept any interference received, including interference that may cause undesired operation.

For customers in Canada

This Class B digital apparatus meets all requirements of the Canadian Interference-Causing Equipment Regulations.

For customers in Europe

"CE" mark indicates that this product complies with the European requirements for safety, health, environment and customer protection.

This symbol [crossed-out wheeled bin WEEE Annex IV] indicates separate collection of waste electrical and electronic equipment in the EU countries. Please do not throw the equipment into the domestic refuse. Please use the return and collection systems available in your country for the disposal of this product.

What's included

The MAUSB-200 Start Guide is included with the adapter. Make sure all the following items are included. If any items are missing, immediately inform the shop where you purchased the adapter.

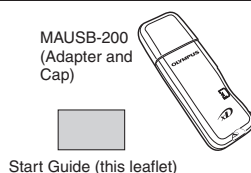

Names of parts

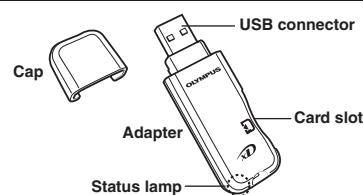

Before getting started

System requirements

Your computer must conform to the following minimum standards in order to use it with the adapter.

- Supported computers
 - Any computer equipped with a USB interface as standard (USB Ver. 2.0 or Ver. 1.1 compliant)
- Compatible operating systems
 - Windows 98/98SE/Me/2000 Professional (hereinafter referred to as Windows 2000)/XP
 - Mac OS 9.0 - 9.2.2/X (v10.1.2 or later)
 - Versions of Windows 98/Me upgraded from Windows 3.1/95, or Windows 2000 upgraded from Windows 95/NT 4.0/NT 3.51 may not work properly. In this case, you may need to reinstall your OS.
 - Windows 98/98SE requires you to install a device driver. You can download this from OLYMPUS web site.

MAUSB-200 Device Driver: <http://www.olympus.com.jp/en/support/imgs/digicamera/download/software/#mausb>

Supported cards

xD-Picture Card
16MB/32MB/64MB/128MB/256MB/512MB/1GB (3.3 V)

Precautions

- Before using the adapter, make sure there is adequate space around the computer's USB port so that the adapter can be connected properly. Plugging in the adapter forcibly may damage the adapter and/or USB port.
- In some cases, depending on your computer system's operating environment (i.e. hardware, software, and device drivers), the adapter may not work properly.
- The adapter may not function properly when connected to a PC via a USB port on a USB hub, keyboard or display. In this case, connect the adapter directly to the computer's USB port.
- **Do not pull the card out of the card slot, or unplug the adapter while the status lamp is blinking.** Doing so may destroy data on the card or damage the card.
- The adapter does not support computer power-saving functions. Turn off the power-saving function before you use the adapter with your computer.
- It is not possible to connect two or more MAUSB-200 adapters to a single PC at the same time.
- Do not swing the strap while attaching it to the adapter. Avoid banging the adapter against hard objects.
- To attach the cap, align the front of the cap with the front of the adapter and slide it into place.



Trademarks

- Microsoft and Windows are either registered trademarks or trademarks of Microsoft Corporation in the United States and/or other countries.
- Apple, Mac, Macintosh, Mac OS are trademarks of Apple Computer, Inc., registered in the U.S. and other countries.
- xD-Picture Card and other company and product names are registered trademarks and/or trademarks of their respective owners in Japan and/or other countries.

Safety Precautions <Be Sure to Read This Section>

Please follow the precautions below to ensure proper use and to avoid injury to yourself or others and damage to property.

Signs used in this section

	If the adapter is used without observing the information given under this sign, injury or death may result.
	If the adapter is used without observing the information given under this sign, minor personal injury, damage to the equipment, or loss of valuable data may result.

Symbols requiring a specific action	
Mandatory	Unplug from power outlet
Symbols prohibiting a specific action	
Prohibited	Do not disassemble

WARNING

- **Keep the adapter away from infants or toddlers as it could be accidentally swallowed.** If this happens, call a doctor, emergency or poison control center immediately.
- **Do not disassemble or modify the adapter.** Doing so may cause an electric shock, fire, equipment failure, or accident.
- **Do not spill liquid or let metallic objects or anything flammable get inside the adapter.** This could result in a fire, electric shock, equipment failure, or accident.
- **Do not insert anything other than the card into the card slot.** Doing so may cause equipment failure or fire.

If any devices make strange noises or produce smoke, or if a foreign object gets inside the adapter, turn off the device connected to the adapter and unplug it from the power outlet. Then contact your dealer or authorized Olympus service center.

Before cleaning the adapter, disconnect the USB connector from the PC. Cleaning the adapter while it is still connected to the PC via the USB connector may cause an electric shock.

CAUTION

Precautions on Operating and Storage Environment

- Avoid using or storing the adapter in extremely hot or cold places.
- Avoid using or storing the adapter in places with excessive dirt and dust, or in direct sunlight.
- Avoid using or storing the adapter in places with strong vibrations or on unstable surfaces. This may cause equipment failure.
- Avoid using the adapter near the objects with strong magnetism (motors, transformers, televisions, speakers, magnets, etc.). This may cause malfunctions.
- Avoid using the adapter in a sealed environment.

Precautions on Transportation

- Before transporting the adapter, make sure that the card has been removed.
- Pack the adapter so as not to allow foreign objects get inside the card slot.
- This adapter is a precision instrument. Do not expose it to vibrations, shocks, or impacts.

Cleaning Precautions

- Do not apply organic solvent such as thinner, benzene, or insecticide to the adapter. This may cause the surface of the adapter to deteriorate and its coating to peel off.
- Use a soft cloth to wipe the adapter. If it is very dirty, wipe it with a soft cloth moistened with a small amount of diluted neutral detergent first, then wipe off any moisture with a dry cloth.

Card Handling Precautions

- **Be sure to format the card on a digital camera regularly.** For details on formatting with a camera, refer to the camera's instruction manual.
- If your camera does not recognize a card formatted on another device, **re-format the card with your camera.** (Cards formatted with non-DOS formatting systems are not recognized by the adapter.)
- The contacts on the card are exposed. Take extra care when you handle it.

USB Connector Handling Precautions

- Do not touch the terminal end of the USB connector. Doing so may cause the adapter and/or the PC to fail.
- When disconnecting the adapter from the computer's USB port, hold the connector firmly and pull it out gently to unplug it.

Other Precautions

Carefully read "Precautions" in "Before getting started" in this leaflet.

Notes on formatting the card

- When formatting the xD-Picture Card, make sure that there is no important data on it. **Existing data will not be usable after the card has been formatted.**
- **You must format the card on a digital camera regularly.** If the card inserted into the adapter has been formatted with the connected computer, it may not be recognized by a digital camera.

Specifications

Supported Cards	xD-Picture Card 3.3 V 16/32/64/128/256/512MB/1GB
Interface	USB Ver. 2.0 or Ver. 1.1
Operating voltage	5V ±10% (Powered via USB port)
Consumption current	0.5A Max.
Operating environment	Temperature: 0°C - 40°C (41°F - 104°F) Humidity: 20% - 80% (No condensation)
Storage environment	Temperature: -20°C - 60°C (-4°F - 140°F)
Dimensions (L x W x H)	Main unit: 71.0 mm x 25.0 mm x 10.1 mm (Not including the cap and protrusions)
Weight	Main unit: Approx. 13 g Cap: Approx. 2 g

Supported computers	Any computer equipped with a USB interface as standard (USB Ver. 2.0 or Ver. 1.1 compliant)
Supported operating systems	Any of the following pre-installed operating systems · Windows 98* · Windows 98SE* · Windows Me · Windows 2000 Professional · Windows XP · Mac OS 9.0 - 9.2.2 · Mac OS X (v10.1.2 or later)

*Windows 98/98SE requires you to install a device driver.

- The specifications are subject to change without prior notice.
- For the latest information, visit the OLYMPUS web site: <http://www.olympus.com/>

Using the adapter (for Windows/Macintosh)

① Insert a card into the adapter.

Make sure the card is level and that the gold-colored contact area is facing **down**. Insert the card all the way into the card slot.

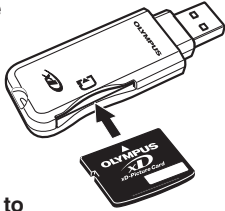

② Connect the adapter to the computer.

Connect the adapter's connector to the computer's USB port. (You can plug in the USB connector while the computer is in use.) The status lamp lights up. (When there is no card in the adapter, the status lamp does not light.)

For Windows

When the adapter is recognized by the computer, the [Removable Disk] icon will be added to [My Computer].

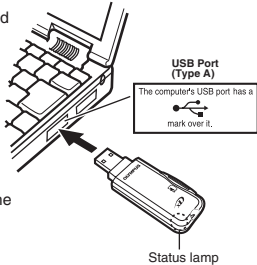

For Macintosh

When the card is inserted correctly and the adapter is recognized by the computer, the card icon appears on the desktop.

Status lamp

Lights : When the adapter is connected to the computer and is ready to use.
Blinks : When reading/writing to a card.
Goes out : When there is no card in the adapter, or when performing the procedure* in "③ Remove the card." or "④ Disconnect the adapter from the computer".
 * Depending on your Mac OS version, the status lamp may go out when you drag & drop the card's icon onto the Trash icon.
Goes out after lighting : When the card is not recognized.

③ Remove the card.

Attention! If you do not follow the steps below, the data on the card may be damaged.

For Windows

1. **Double-click** [My Computer] on the desktop.
2. **Right-click** the corresponding [Removable Disk] icon, then click [Eject] in the pop-up menu.
 - The card will not be ejected when [Eject] is clicked in this step.
 - If you are using a Windows 2000/XP and you want to remove the card, log on with the user name [Administrator] or a user name with administrator privileges. Without these privileges, you cannot perform [Eject] operation.
3. Make sure that the lamp is **NOT on**, then pull the card out of the card slot as shown in the illustration.

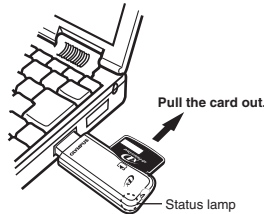

For Macintosh

Drag & drop the card's icon onto the Trash icon. Make sure that the status lamp is **NOT blinking**, then pull the card out of the card slot as shown in the above illustration.



④ Disconnect the adapter from the computer.

- You can unplug the adapter with the computer's power on. (You do not need to turn off the computer, restart it, or put it in the sleep mode.)
- Close all software programs that are using data on the card (e.g. graphics applications). Otherwise, you cannot perform this step.

For Windows

If a card is inserted in the adapter, follow steps 1 and 2 in "③ Remove the card".

[Windows 98/98SE]

Make sure that the status lamp is **NOT on**, then unplug the adapter from the computer's USB port.

[Windows Me/2000/XP]

1. Left-click the [Safely Remove Hardware] icon on the taskbar.
 - The message that appears with the [Safely Remove Hardware] icon may differ depending on the computer you are using.
2. A message titled [Safely remove USB Mass Storage Device - Drive (K:)] appears on the taskbar. Click on it.
 - The drive letter (K:) above will differ depending on the computer you are using.
3. Make sure that the status lamp is **NOT on**, then click the [OK] button.
 - For Windows XP, the message appears in the balloon help.
4. Unplug the adapter from the computer's USB port.

For Macintosh

1. Drag & drop the card's icon onto the Trash icon.
2. Make sure that the status lamp is **NOT blinking**.
3. Unplug the adapter from the computer's USB port.

⑤ Copy files. You can copy files the same way as you would copy files from a floppy disk, etc. Simply drag & drop the original files you want to copy onto the hard drive or other storage medium.

For Windows

1. **Double-click** [My Computer], then double-click the corresponding [Removable Disk (F:)] icon.
2. **Drag & drop the files onto the hard drive or other storage medium.**

For Macintosh

1. **Double-click** the corresponding icon.
2. **Drag & drop the files onto the hard drive or other storage medium.**

● Drag & Drop

To perform a drag & drop, press and hold the mouse button over the selected file(s), then move the mouse (drag) to the desired location and release the button to copy (drop).

Notes on inserting/removing a card (For Windows/Macintosh)

- **NEVER pull a card out of the card slot or unplug the adapter from the computer while the status lamp is blinking.** Doing so may destroy the data on the card or the card itself, or cause the computer to malfunction.
- When removing a card, be sure to follow the procedure in "③ Remove the card". Otherwise, the data on the card may be damaged.
- Before removing a card, close all software programs that are using data on the card (e.g. Explorer, graphics applications).
- DO NOT apply force to the computer's USB port or the adapter when removing/inserting a card from/into the adapter if it is directly connected to the computer's USB port.
- Make sure that the card is facing the right way.
- DO NOT insert the card at an angle. Forcing a card in diagonally may damage the adapter and/or the card.

Troubleshooting

	PROBLEM	CAUSE	SOLUTIONS
Windows	The [Removable Disk] icon does not appear after installation and connection. [!] or [?] appears in Device Manager.	The adapter's USB connector is not connected properly to the computer. The Universal Serial Bus Controller is disabled. (Only for Windows Me/2000/XP)	Insert the USB connector fully into the computer's USB port to ensure that it is firmly connected. Change the Controller settings on [Universal Serial Bus Controllers] by selecting [Start] - [Setting] (only for Windows Me/2000) - [Control Panel] - [System] - [Hardware] - [Device Manager]. (X) appears on the controller's name. Select [Enable] by right-clicking from the pop-up menu.)
		The USB port is disabled in the BIOS settings.	Set the USB port to "Enable" in the BIOS settings. Take extra care when making this setting, referring to your computer's instruction manual.
	The adapter does not recognize the card. [Please insert a disk into drive.] appears.	The card is not inserted correctly.	Make sure the card is properly oriented (front/reverse face, top/bottom part), then insert it slowly into the adapter until it is secure.
Macintosh	No card icon appears on the computer's screen.	The card is not inserted correctly. File Exchange is not installed on your computer. (Mac OS 9)	Make sure the card is properly oriented (front/reverse face, top/bottom part), then insert it slowly into the adapter until it is secure. You must have File Exchange (provided with Mac OS) to read/write a DOS/Windows formatted card. (Check Control Panels under the Apple menu to see if File Exchange is installed. For more details, refer to Mac OS [Help].)
Common	The status lamp does not light.	The adapter is not connected correctly to the computer's USB port. The power supply from the USB port is insufficient.	Make sure that the adapter is facing the right way and connect it to the computer's USB port firmly. If you are using a USB hub, connect the adapter directly to the computer's USB port.
		The card is not inserted correctly.	Make sure the card is properly oriented (front/reverse face, top/bottom part), then insert it slowly into the adapter until it is secure.
	The status lamp goes out after lighting.	The card is not recognized correctly.	Disconnect the adapter from the computer, pull the card out of the adapter, then wipe the contact area with a dry cloth, and insert the card again. If the problem persists, the card may be damaged.
	You can read a card, but not write to it.	There is a problem with the card.	Save the data to another storage medium, then use the new card for writing.

Free Manuals Download Website

<http://myh66.com>

<http://usermanuals.us>

<http://www.somanuals.com>

<http://www.4manuals.cc>

<http://www.manual-lib.com>

<http://www.404manual.com>

<http://www.luxmanual.com>

<http://aubethermostatmanual.com>

Golf course search by state

<http://golfingnear.com>

Email search by domain

<http://emailbydomain.com>

Auto manuals search

<http://auto.somanuals.com>

TV manuals search

<http://tv.somanuals.com>