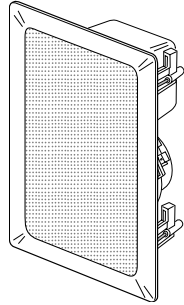

OPTIMUS®

Cat. No. 40-1425

2-Way In-Wall Speaker System

Your Optimus 2-Way In-Wall Speaker System features a 6½-inch driver, adjustable wide-angle monopole tweeter, and crossover for rich lows and crisp, clean highs. It can handle 50 watts of amplifier power.

You can mount your speaker almost anywhere, making it ideal for use in a surround-sound system. The speaker mounts flush with the ceiling or wall, and you can paint its frame and grille to match the room's decor. It is a tasteful addition to any room.

You need these items to mount your speaker:

- Drywall or keyhole saw
- Wire stripper
- Phillips screwdriver
- Pencil
- 18- to 20-gauge wire

Note: You can find wire and wire strippers at your local RadioShack store.

PREPARING THE LOCATION

Be sure the mounting surface is between ½ and 1¼ inches thick, and that there is at least 5 inches of clearance behind the mounting surface. Also, be sure no wall studs or other objects will block the back of the speaker and no AC wiring is near.

Follow these steps to prepare the mounting location.

1. Remove the cardboard mask from inside the supplied template and keep it for later use as a paint mask.
2. Use the template to mark the position for the mounting hole at the selected location.
3. Cut the mounting hole with a dry-wall or keyhole saw.

PAINTING THE FRAME AND GRILLE

If you choose to paint the frame and grille, remove the grille by carefully inserting a small screwdriver between the top part of the frame and grille then carefully pulling up on the grille. Then place the cardboard mask over the driver and tweeter before painting.

© 1997 Tandy Corporation.
All Rights Reserved.

Optimus and RadioShack are registered trademarks used by Tandy Corporation.

Caution: Be careful not to get paint on the speaker elements.

Note: We recommend spray painting the grille to prevent blocking the grille holes with paint.

After the paint dries, remove the paint mask.

Replace the grille after mounting the speaker.

CONNECTING THE SPEAKER WIRE

We recommend you use wire that is color-coded or marked on one side.

Follow these steps to connect the speaker to your receiver/amplifier.

1. Route the speaker wire from your receiver/amplifier to the speaker.

Notes:

- Avoid routing the speaker wire near electrical wire.
- Do not nail or staple the speaker wire.

2. Separate about 4 inches of speaker wire at each end.
3. Using a wire stripper, remove about $\frac{1}{4}$ inch of insulation from both ends of each conductor, then twist the strands of each conductor.

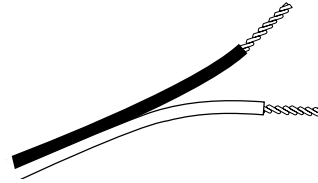

4. Connect the wire to the terminals on the back of the speaker by pressing the red terminal's tab, inserting one end of the marked conductor, then releasing the tab.

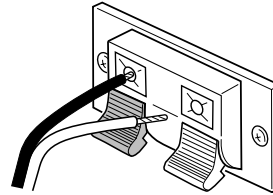

Repeat this procedure to connect the unmarked conductor to the black terminal.

5. Using the wire's color-coding or marking as a guide, connect the conductor that is connected to the speaker's red (+) terminal to your amplifier/receiver's positive (+) terminal. Then connect the negative (-) conductor to your receiver/amplifier's negative (-) terminal.

MOUNTING THE SPEAKER

Note: Before mounting the speaker, connect and test it.

1. Remove the grille, if you have not already (see "Painting the Frame and Grille").

2. Be sure the mounting tabs are in place (parallel with the edge of speaker, not pointing outward), then plug the speaker into the mounting hole.

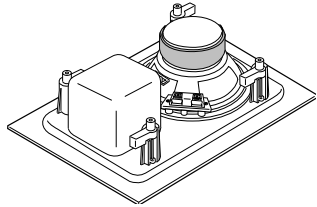

3. Use the four supplied mounting screws to secure the mounting tabs to the wall or ceiling.
4. If desired, tilt the tweeter toward the listening area. You can tilt the tweeter two steps up or down.

Caution: When you move the tweeter, *do not touch* the thin, vibrating part. Hold only the outer, hard plastic portion.

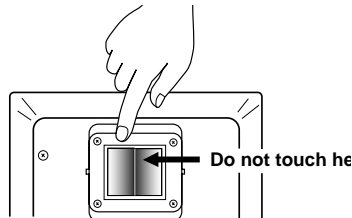

5. Replace the grille.

CARE AND MAINTENANCE

Your speaker is an example of superior design and craftsmanship. These suggestions will help you care for it so you can enjoy it for years.

- Keep the speaker dry. If it gets wet, wipe it dry immediately. Liquid can contain minerals that can corrode electronic circuits.
- Keep the speaker away from dust and dirt which can cause premature wear of parts.
- Wipe the speaker frame occasionally with a damp cloth to keep it looking new. Do not use harsh chemicals, cleaning solvents, or strong detergents.

Caution: You might permanently damage your speaker's grille or speaker elements by cleaning them with a vacuum cleaner. Instead, use a feather duster or soft cloth.

SPECIFICATIONS

Resonant Frequency	55 Hz ±20%
Frequency		
Response	65 Hz–25 kHz
Power Handling	50 Watts RMS
Maximum Power	100 Watts
Impedance	8 Ohms
Sensitivity	88 dB ±2 dB
Voice Coil	1 inch
Magnet Size:		
Woofer	3 ¹ / ₈ (diameter) × ⁵ / ₈ Inches
Tweeter	1 ³ / ₄ × ⁷ / ₈ × ³ / ₈ Inches
Magnet Weight	Woofer 10 oz Tweeter 2.8 oz

Specifications are typical; individual units might vary. Specifications are subject to change and improvement without notice.

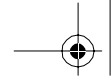

Limited One-Year Warranty

This product is warranted by RadioShack against manufacturing defects in material and workmanship under normal use for one (1) year from the date of purchase from RadioShack company-owned stores and authorized RadioShack franchisees and dealers. EXCEPT AS PROVIDED HEREIN, RadioShack MAKES NO EXPRESS WARRANTIES AND ANY IMPLIED WARRANTIES, INCLUDING THOSE OF MERCHANTABILITY AND FITNESS FOR A PARTICULAR PURPOSE, ARE LIMITED IN DURATION TO THE DURATION OF THE WRITTEN LIMITED WARRANTIES CONTAINED HEREIN. EXCEPT AS PROVIDED HEREIN, RadioShack SHALL HAVE NO LIABILITY OR RESPONSIBILITY TO CUSTOMER OR ANY OTHER PERSON OR ENTITY WITH RESPECT TO ANY LIABILITY, LOSS OR DAMAGE CAUSED DIRECTLY OR INDIRECTLY BY USE OR PERFORMANCE OF THE PRODUCT OR ARISING OUT OF ANY BREACH OF THIS WARRANTY, INCLUDING, BUT NOT LIMITED TO, ANY DAMAGES RESULTING FROM INCONVENIENCE, LOSS OF TIME, DATA, PROPERTY, REVENUE, OR PROFIT OR ANY INDIRECT, SPECIAL, INCIDENTAL, OR CONSEQUENTIAL DAMAGES, EVEN IF RadioShack HAS BEEN ADVISED OF THE POSSIBILITY OF SUCH DAMAGES.

Some states do not allow the limitations on how long an implied warranty lasts or the exclusion of incidental or consequential damages, so the above limitations or exclusions may not apply to you.

In the event of a product defect during the warranty period, take the product and the RadioShack sales receipt as proof of purchase date to any RadioShack store. RadioShack will, at its option, unless otherwise provided by law: (a) correct the defect by product repair without charge for parts and labor; (b) replace the product with one of the same or similar design; or (c) refund the purchase price. All replaced parts and products, and products on which a refund is made, become the property of RadioShack. New or reconditioned parts and products may be used in the performance of warranty service. Repaired or replaced parts and products are warranted for the remainder of the original warranty period. You will be charged for repair or replacement of the product made after the expiration of the warranty period.

This warranty does not cover: (a) damage or failure caused by or attributable to acts of God, abuse, accident, misuse, improper or abnormal usage, failure to follow instructions, improper installation or maintenance, alteration, lightning or other incidence of excess voltage or current; (b) any repairs other than those provided by a RadioShack Authorized Service Facility; (c) consumables such as fuses or batteries; (d) cosmetic damage; (e) transportation, shipping or insurance costs; or (f) costs of product removal, installation, set-up service adjustment or reinstallation.

This warranty gives you specific legal rights, and you may also have other rights which vary from state to state.

RadioShack Customer Relations, Dept. W, 100 Throckmorton St., Suite 600, Fort Worth, TX 76102

We Service What We Sell

3/97

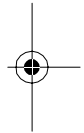
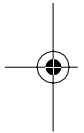

RadioShack
A Division of Tandy Corporation
Fort Worth, Texas 76102

6A7

Printed in Malaysia

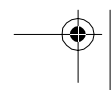
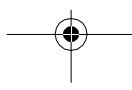

Free Manuals Download Website

<http://myh66.com>

<http://usermanuals.us>

<http://www.somanuals.com>

<http://www.4manuals.cc>

<http://www.manual-lib.com>

<http://www.404manual.com>

<http://www.luxmanual.com>

<http://aubethermostatmanual.com>

Golf course search by state

<http://golfingnear.com>

Email search by domain

<http://emailbydomain.com>

Auto manuals search

<http://auto.somanuals.com>

TV manuals search

<http://tv.somanuals.com>