

TRUMPET SPEAKER MOUNTING PARTS

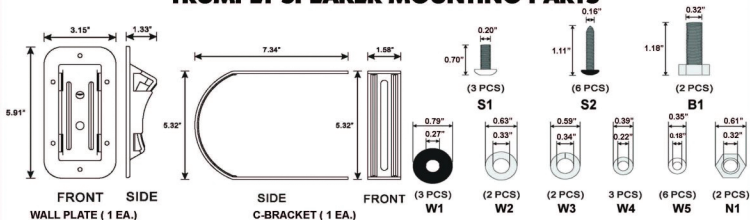

INSTALLATION INSTRUCTION

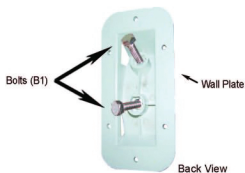

STEP 1. Insert the two bolts (B1) at the two holes at the back of the wall plate as shown on top photo.

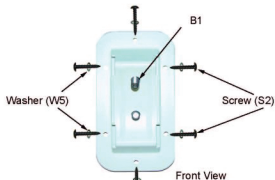

STEP 2. Install the wall plate at the designated wall or ceiling using the six screws (S2) together with the six washers (W5).

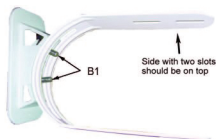

STEP 3. Get the "C" mounting bracket and mount it on the two bolts (B1) on the wall plate as shown.

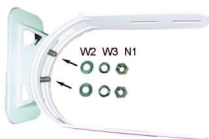

STEP 4. Place the washers and the nuts on the two bolts as shown and then tighten the nuts after determining the vertical angle of the speaker.

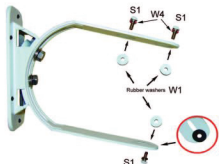

STEP 5. Peel off the white sticker cover on the rubber washer (W1) and stick the washer aligned on the hole of the "C" bracket.

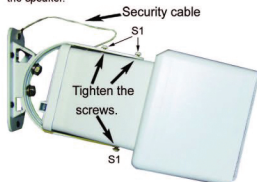

STEP 6. After properly connecting the speaker wires, place the Trumpet Speaker in-between the "C" bracket and tighten the three screws (S1).

Free Manuals Download Website

<http://myh66.com>

<http://usermanuals.us>

<http://www.somanuals.com>

<http://www.4manuals.cc>

<http://www.manual-lib.com>

<http://www.404manual.com>

<http://www.luxmanual.com>

<http://aubethermostatmanual.com>

Golf course search by state

<http://golfingnear.com>

Email search by domain

<http://emailbydomain.com>

Auto manuals search

<http://auto.somanuals.com>

TV manuals search

<http://tv.somanuals.com>