



EN

**Dual-Band RF
Projection Clock with FM Radio
Model: RRM326P
USER MANUAL**

CONTENTS

Introduction 2
Product Overview 2
 Front View 2
 Back View 3
 LCD Display 3
Getting Started 4
 Batteries 4
 AC Adaptor 4
About RF Reception 4
 Turn the Radio Reception ON / OFF 5
Clock / Calendar 5
 Clock / Calendar Display 5
 Set Clock / Calendar 5
FM Radio 6
 Operating the Radio 6
 Radio Stations 6
 Sleep 6
Backlight 6
Alarm 7
 Alarm Display and Sound 7
 Set the Alarm(s) 7
 Activate / Deactivate the Alarm(s) 7
 Snooze / Turning the Alarm OFF 7

Projection Unit 7
Reset the Clock 8
Warnings 8
Troubleshooting 9
Technical Specifications 9
Notices 10
 Statement of Responsibility 10
About Oregon Scientific 10
EC-Declaration of Conformity 10



INTRODUCTION

Thank you for selecting the Oregon Scientific™ Dual-Band RF Projection Clock with FM Radio. This device is designed to give you many years of reliable service, including the following conveniences:

- Radio-controlled calendar clock
- Rotating projection unit with vertical or horizontal projection
- FM radio
- Sleep function
- Buzzer or radio alarm with 8-minute snooze function
- Time / alarm status projection unit
- Time zone hour offset function
- Backlight for clock

In the box, you will find:

- Clock Unit
- 2 x UM-3 / AA 1.5V batteries
- 4.5V AC / DC adaptor

Keep this manual handy as you use your new product. It contains practical step-by-step instructions, as well as technical specifications and warnings you should know.

PRODUCT OVERVIEW

FRONT VIEW

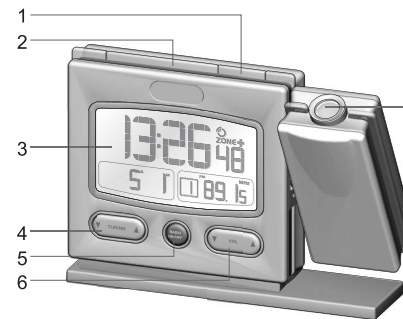

1. **SLEEP**: Activate sleep function
2. **SNOOZE / LIGHT**: Activate 8-minute snooze function, or backlight and projector
3. **LCD display**
4. **TUNING ▲ / ▼**: Toggle up or down through radio frequencies
5. **RADIO ON / OFF**: Switch radio on or off
6. **Volume ▲ / ▼**: Increase or decrease volume
7. **Projector**: Projects time and alarm status



BACK VIEW

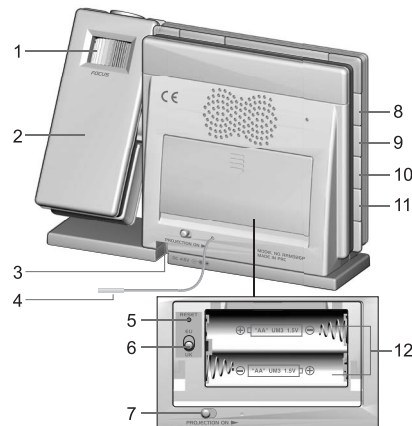

1. **FOCUS:** Turn to focus the projected image
2. **Image Rotation:** Twist to rotate the image display between the vertical and horizontal
3. **4.5V AC / DC Adaptor Socket**
4. **FM Radio Antenna Wire**
5. **RESET:** Press to return all values to the default settings
6. **EU / UK:** Select nearest radio signal base i.e. England or Germany

7. **PROJECTION ON:** Slide to ON for continuous image projection when the AC power is connected
8. **ALARM ON / OFF:** Switch alarm on or off
9. **ALARM:** Toggle between alarm and calendar display
10. **STATION:** Toggle through preset radio stations
11. **MODE:** Toggle between setting modes / confirm settings
12. **Battery Compartment (cover on):** 2 x UM-3 / AA 1.5V batteries

LCD DISPLAY

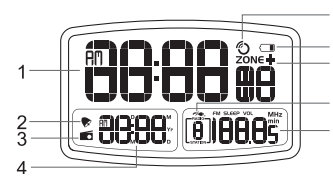

1. Time
2. Alarm on / off
3. Radio alarm on / off
4. Alarm time
5. RF clock reception
6. Battery status
7. Offset time zone
8. AC adaptor is disconnected
9. FM radio display / sleep / volume level

GETTING STARTED

BATTERIES

Batteries are supplied with this product:

- 2 x UM-3 / AA 1.5V batteries

NOTE It is recommended that you use alkaline batteries with this product for longer performance.

Insert batteries before first use, matching the polarity (+ and -) as shown below. Press **RESET** after each battery change.

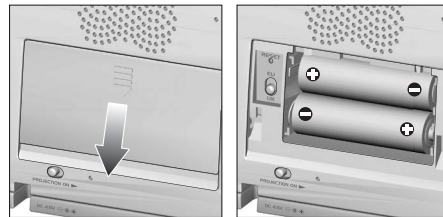

NOTE Do not use rechargeable batteries with this product.

BATTERY ICON	MEANING
	Batteries are low, or there are no batteries installed and only the adaptor is connected

AC ADAPTOR

The batteries serve as a back-up power supply. For continuous use of the projector, install the AC adaptor at the base of the unit as shown below.

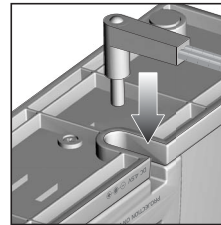

NOTE To help conserve energy, turn the **PROJECTION ON** switch to OFF when you do not wish to use it.

ABOUT RF RECEPTION

This clock can automatically synchronize the date and time with official time-keeping organizations in Frankfurt (Germany) and Rugby (England). The unit can pick up a Radio Frequency (RF) signal when it is within 1500km (932 miles) of these locations.



ZE

To select the most suitable radio signal for your location, slide the **UK / EU** switch to the appropriate setting. Press **RESET** whenever you change the selected setting.

NOTE For best results, place the clock away from metal or electrical objects, and near a window with a clear view to the sky.

TURN THE RADIO RECEPTION ON / OFF

To turn the radio reception ON:

- Press **VOL ▲** and hold for 2 seconds.
- The RF reception icon will appear and flash on the display to indicate it is searching for the RF signal.

Once batteries have been installed in the clock, the reception icon will flash to indicate it is searching for a signal.

When the reception signal has been received the reception icon will show the signal strength by displaying between 0 and 3 waves:

STRONG SIGNAL	WEAK SIGNAL	NO SIGNAL

To turn the radio reception OFF:

- Press and hold **VOL ▼** for 2 seconds.
- The RF reception icon will disappear from the display.

CLOCK / CALENDAR

CLOCK / CALENDAR DISPLAY

Press **MODE** to toggle between 3 types of display (Clock with seconds, Clock with day, Clock with time zone offset).



SET CLOCK / CALENDAR

1. Press and hold **MODE** for 2 seconds. The time zone offset hour digits will flash. When an offset hour has been set (e.g. +1), the time displayed will be the RF clock time plus 1 hour.





2. Press **VOL** ▲ or ▼ to change the setting.
3. Press **MODE** to confirm the setting and move onto the next one.
4. The settings appear in the following order: Time zone hour offset, 12 / 24 hour format, hour, minute, year, MM / DD or DD / MM format, month, day and language for day of the week.
5. Press **ALARM**, **ALARM ON / OFF**, **TUNING** ▲ or ▼, **SLEEP**, or **RADIO** to exit the Clock Setting Mode.

FM RADIO

This product has a built-in FM radio for your entertainment. In order to conserve power, the FM radio only works when the AC adaptor is plugged in.

OPERATING THE RADIO

1. Press **RADIO** to switch the radio on.



2. Press **VOL** ▲ or ▼ to change the radio volume.



3. Press **TUNING** ▲ or ▼ to change radio frequency, press and hold for 2 seconds to enable auto-search for an available frequency.
4. Press any key to stop auto-search.

RADIO STATIONS

To set a radio station, press and hold **STATION** while on a frequency. The unit can store up to 8 preset stations in chronological order.

Press **STATION** to return to the last station that you listened to. Use the **STATION** button to scroll through the 8 preset stations.

SLEEP

The radio is equipped with a countdown sleep timer that can be set to switch the radio off after up to 120 minutes.

1. Press **SLEEP** to enter sleep mode.
2. Use the **SLEEP** button to change the sleep time setting (120, 90, 60, 45, 30, 15, 0).
3. Press any key to exit sleep mode – the sleep timer will be automatically activated.

BACKLIGHT

Press **SNOOZE / LIGHT** to activate the backlight for 5 seconds.

ALARM

ALARM DISPLAY AND SOUND

This product has two types of daily alarm that can be set to go off at the same time every day. You can choose to be woken up by the radio or by a buzzer alarm. Press **ALARM** at any time to toggle between the calendar and the alarm display.

NOTE If the radio alarm time is reached when the AC adaptor is not connected the unit will default to buzzer alarm.

SET THE ALARM(S)

1. Press and hold **ALARM** for 2 seconds.
2. Use **VOL ▲** or **▼** to change the flashing setting.



3. Press **ALARM** to confirm the setting and move onto the next one.
4. The settings appear in the following order: Hour, minute, alarm type (i.e. radio alarm or buzzer alarm).
5. If radio alarm is selected, preset station and preset volume can also be altered.

6. Press **ALARM** to exit alarm setting mode.
7. The daily alarm will be on automatically after setting.

ACTIVATE / DEACTIVATE THE ALARM(S)

- Press the **ALARM ON / OFF** to enable or disable the daily alarm.
- When the buzzer alarm / radio alarm icon appears on the display the alarm is activated. When the icons do not appear the buzzer alarm / radio alarm is deactivated.

SNOOZE / TURNING THE ALARM OFF

When activated, the alarm icon flashes, the backlight and projector turn on for 8 seconds. The buzzer alarm sounds for 2 minutes if no key is pressed. The radio will remain on for 120 minutes if no key is pressed.

To silence the alarm:

- Press **SNOOZE / LIGHT** to silence it for 8 minutes. The buzzer alarm or radio alarm icon will flash to show snooze is enabled.

OR

- Press any key except **SNOOZE / LIGHT** to mute the alarm and activate it again in 24 hours.

PROJECTION UNIT

The projection unit can display both time and alarm status. To use this feature:



- Slide the **PROJECTION** switch **ON** to activate continuous projection. However, this function will not work unless the AC / DC adaptor is used.
- Adjust the **FOCUS** knob to make the image clearer.
- Manually tilt the projection unit to position the image.

NOTE You can also press the **SNOOZE / LIGHT** button to project the time and alarm status for 5 seconds.

RESET THE CLOCK

Insert a thin blunt instrument into the hole below **RESET** to return to the default settings.

The default settings are:

EU Clock Time:	12:00
UK Clock Time:	12:00 pm
Date:	1st January 2005
Language:	English
Time Offset:	+0
Alarm Time:	6.00 AM
Daily Alarm(s):	Disabled
EU Display Setting:	24hr, DD / MM
UK Display Setting:	12hr, DD / MM



WARNINGS

This product is designed to give you years of service if handled properly. Oregon Scientific will not be responsible for any deviations in the usage of the device from those specified in the user instructions or any unapproved alterations or repairs of the product. Observe the following guidelines:

- Do not clean any part of the product with benzene, thinner or other solvent chemicals – this may cause permanent damage that is not covered by the guarantee. When necessary, clean it with a damp cloth.
- Never immerse the product in water. This can cause electrical shock and damage the product.
- Do not subject the product to extreme force, shock, or fluctuations in temperature or humidity.
- Do not tamper with the internal components.
- Do not mix new and old batteries or batteries of different types.
- Do not use rechargeable batteries with this product.
- Remove the batteries if storing this product for a long period of time.
- Do not scratch the LCD display.

NOTE The technical specification of this product and contents of this user manual are subject to change without notice. Images not drawn to scale.



TROUBLESHOOTING

PROBLEM	SYMPTOM	REMEDY
Clock time is not correctly set	No radio signal reception	Place the clock far away from PCs, phones, and other electronic equipment and near a window sill. Wait for at least 24 hours
No alarm	Alarm does not sound	Turn on the setting
Operation not normal	Certain functions do not perform	Reset the clock
Calendar	Strange day	Check it is set to your own language
Clock	Cannot change clock	Disable the radio signal and set manually
Clock / Calendar	Cannot auto-synchronize the clock	1. Adjust batteries 2. Press RESET

TECHNICAL SPECIFICATIONS

TYPE	DESCRIPTION
Main Unit Dimensions	
L x W x H	161 x 30 x 103 mm (6.34 x 1.18 x 4.06 inches)
Weight (without battery)	235 g (0.52 lbs)
Main Unit RF	
RF Clock Frequency System	DCF77 (EU) or MSF60 (UK)
Synchronization	Auto or disabled
FM Band Range	87.5-108.0 MHz
Main Unit Display	
Clock	HH:MM:SS HH:MM: Day of week HH:MM: Timezone hour offset
Hour Format	12hr AM / PM (MSF Format) 24hr (DCF Format)
Calendar	DD / MM or MM / DD, user selectable. Weekday language: E, D, F, I, S.
Alarm	<ul style="list-style-type: none"> • 2-minute alarm • 8-minute snooze
Power	
Main Unit	2 x UM-3 / AA 1.5V batteries or 4.5V AC / DC adaptor

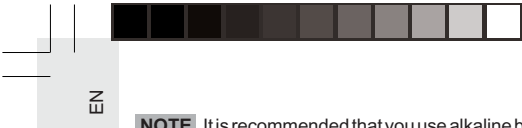

NOTE It is recommended that you use alkaline batteries with this product for longer performance.

NOTE Design and specifications are subject to change without notice.

NOTICES

STATEMENT OF RESPONSIBILITY

Oregon Scientific will not be held liable for any bodily injury, death, property damages, or any other claims of whatever nature resulting from the misuse or negligence of the product, whether intentional or unintentional.

Oregon Scientific will not be responsible for any deviations in the usage of the device from those specified in the user instructions or any unapproved alternations or repairs of the product.

ABOUT OREGON SCIENTIFIC

Visit our website (www.oregonscientific.com) to learn more about Oregon Scientific products such as digital cameras; MP3 players; children's electronic learning products and games; projection clocks; health and fitness gear; weather stations; and digital and conference phones. The website also includes contact information for our customer care department in case you need to reach us, as well as frequently asked questions and customer downloads.



We hope you will find all the information you need on our website, however if you're in the US and would like to contact the Oregon Scientific Customer Care department directly, please visit: www2.oregonscientific.com/service/support

OR

Call 949-608-2848.

For international enquiries, please visit: www2.oregonscientific.com/about/international/default.asp

EC-DECLARATION OF CONFORMITY

Hereby, **Oregon Scientific**, declares that this Dual-Band RF Projection Clock with FM Radio RRM326P is in compliance with the essential requirements and other relevant provisions of Directive 1999/5/EC.

A copy of the signed and dated Declaration of Conformity is available on request via our Oregon Scientific Customer Service.



COUNTRIES RTTE APPROVAL COMPLIED

All EC countries, Switzerland (CH) and Norway (N)





**Dual-Band RF Projection Clock with FM Radio
Model: RRM326P
USER MANUAL**

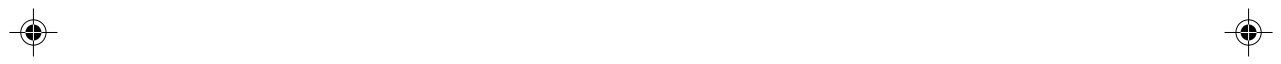

© 2005 Oregon Scientific. All rights reserved.
086-003827-010

Free Manuals Download Website

<http://myh66.com>

<http://usermanuals.us>

<http://www.somanuals.com>

<http://www.4manuals.cc>

<http://www.manual-lib.com>

<http://www.404manual.com>

<http://www.luxmanual.com>

<http://aubethermostatmanual.com>

Golf course search by state

<http://golfingnear.com>

Email search by domain

<http://emailbydomain.com>

Auto manuals search

<http://auto.somanuals.com>

TV manuals search

<http://tv.somanuals.com>