

Heavy-Duty Detachable Blade Clipper Instruction Manual

• For Commercial Use Only •

Model 10 - 76010



Oster
Professional

IMPORTANT SAFEGUARDS

Commercial Clipper • When using an electrical appliance, basic precautions should always be followed, including the following:
Read all instructions before using this appliance.

DANGER

To reduce the risk of electric shock:

- Do not reach for an appliance that has fallen into water. Unplug immediately.
- Do not use while bathing or in a shower.
- Do not place or store appliance where it can fall or be pulled into a tub or sink.
- Do not place in or drop into water or other liquid.
- Always unplug this appliance from the electrical outlet immediately after using.
- Unplug this appliance before cleaning, putting on or taking off parts.

WARNING

To reduce the risk of burns, fire, electric shock, or injury to persons:

- An appliance should never be left unattended when it is plugged in.
- Close supervision is necessary when this appliance is used by, on, or near children or invalids.
- Use this appliance only for its intended use as described in this manual. Do not use attachments not recommended by the manufacturer.

- Never operate this appliance if it has a damaged cord or plug, if it is not working properly, if it has been dropped or damaged, or dropped into water. Return the appliance to a service center for examination and repair.
- Keep cord away from heated surfaces.
- Never operate the appliance when air openings are blocked or while on a soft surface (such as a bed or couch).
- Never drop or insert any object into opening.
- Do not use outdoors or operate where aerosol spray products are being used or where oxygen is being administered.
- Do not use this appliance with a damaged or broken comb or blade, as cut or scratched skin may occur.
- To disconnect, move all controls to "OFF", then remove plug from outlet.
- Do not wrap cord around unit when storing. Continuous stress on the cord can damage cord insulation and result in a shock hazard.
- Avoid contact with moving blades.
- Avoid tangling or kinking the cord while clipping. Should the cord become tangled or kinked, stop clipping and straighten the cord.

SAVE THESE INSTRUCTIONS

THE FOLLOWING PARAGRAPH IS FOR 120-VOLT MARKETS ONLY

To reduce the risk of electrical shock, this appliance has a polarized plug (one blade is wider than the other). This plug fits a polarized outlet only one way. This is a safety feature intended to help reduce the risk of electrical shock. If the plug does not fit fully into the outlet, reverse the plug. If it still does not fit, contact a qualified electrician. Do not attempt to defeat this safety feature.

ABOUT YOUR CLIPPER

Although your clipper has been thoroughly tested and inspected at every stage of its manufacturing and assembly, it is recommended that you lubricate it, as instructed in this manual, after 4-6 weeks of extensive use. This will ensure you obtain optimum performance and prolong the life of your clipper.





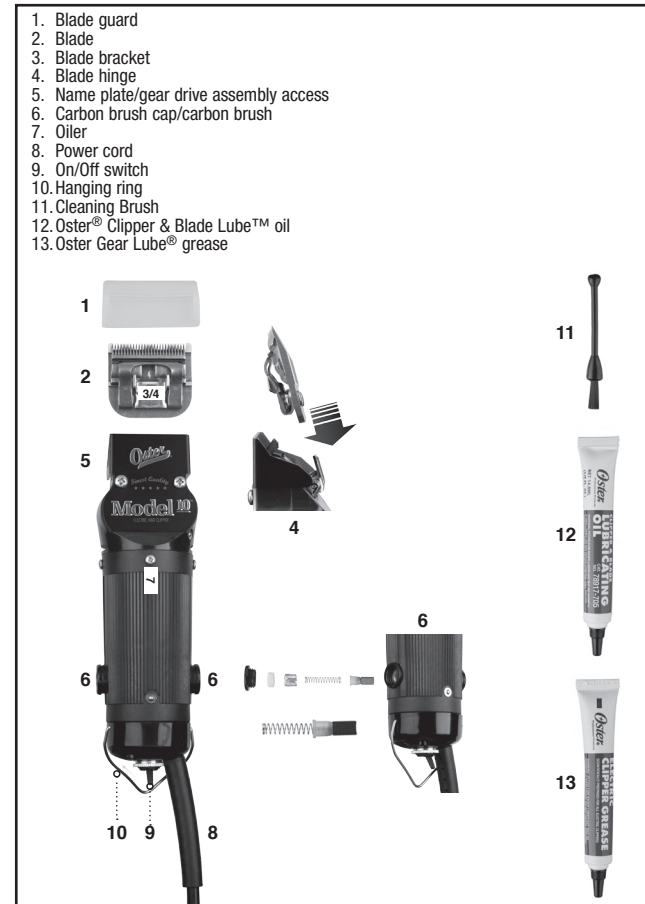

GETTING FAMILIAR WITH YOUR CLIPPER

Due to continuous product improvement, product may vary slightly from what is illustrated.



AVAILABLE OSTER® LUBRICANTS & CLEANERS, & REPLACEMENT PARTS

Regular use of the following products will help you enjoy optimum performance from your clipper and prolong its functionality.

 <p>Oster 5-in-1® (076300-107) All-purpose clipper & blade lubricant and disinfectant.</p>	 <p>Kool Lube® 3 76300-101 Lubricates and cools down blade.</p>	 <p>Spray Disinfectant 76300-102 Minimizes bacteria buildup between upper and lower blades.</p>	 <p>Blade Wash® Cleaning Solution 76300-103 Flushes away accumulated hair and removes dirt buildup trapped between upper and lower cutting blades.</p>
 <p>Blade Lube™ Oil 76300-104 Lubricates between upper and lower blades to keep them sharper longer and produce a smoother clipping action.</p>	 <p>Gear Lube® (076300-105) Specially designed to prolong the life of gears, bearings and the motor.</p>	 <p>Replacement carbon brushes (076917-710) Set of replacement carbon brushes and springs</p>	
<p>To order any of these products, please call 1-800-830-3678 or visit www.osterstyle.com</p>			

USING YOUR CLIPPER

Important:

- Before using your clipper, apply 1 or 2 drops of Oster® Clipper & Blade Lube™ Oil to the blade (refer to Taking Care of Your Clipper section).
 - For best results, hair should be clean and free from styling agents.
 - During use, apply Kool Lube® coolant occasionally to the blades to keep them cool.
- Plug unit into an AC electrical outlet.
 - Move On/Off switch to turn clipper on.
 - Remove blade guard.
 - Insert blade. Holding blade sides, slide blade bracket into hinge.
 - Push blade toward the clipper until it snaps into place

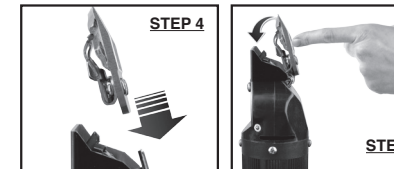

- When finished clipping, turn clipper off and unplug cord from electrical outlet.
- Cover blade with blade guard to keep it protected.

TAKING CARE OF YOUR CLIPPER

Note: Any other maintenance not explained in this manual must be performed by an Oster-Direct® Authorized Service Center.

Important: Make sure clipper is turned off and unplugged from electrical outlet before removing, replacing or cleaning any parts.

Lubricating Motor

If you hear a "squeal" or a dry bearing noise from the motor, it is a signal that the motor needs lubricating.

Remove cap from Oster® Clipper and Blade Lube™ tube and insert tip into oiler to apply 1 drop of oil. Be careful not to over lubricate.

Greasing Gear Drive Assembly

We recommend checking the gear drive assembly every six months for greasing.

Caution: Grease only when necessary as over-greasing may cause leakage and reduce clipper's efficiency.



- Using a small Phillips-head screwdriver, unscrew name plate mounting screws.
- Remove name plate to expose gear drive assembly.
- Remove cap from Oster® Gear Grease tube and apply a generous amount of grease to eccentric, gears and bearing, as illustrated.
- Once finished greasing, replace name plate and tighten screws.



Removing and Replacing Worn Out Carbon Brushes

Your clipper contains a carbon brush that will wear out with normal use. When this begins to occur, the clipper will operate intermittently. If the clipper does not turn on, this is a sign that the carbon brush is worn out and needs to be replaced.

Important:

- You will need to replace both carbon brushes at the same time, even if only one brush is worn out.
- Use only Oster® carbon brushes. Carbon brushes used in electric motors are carefully selected for size and grain to ensure optimum performance. Using other brushes will compromise your clipper's performance.



To remove and replace carbon brush, follow below instructions:

- Unscrew and remove brush cap.
Tip: A dime is an ideal tool for loosening the cap.
- Pull out nylon cap and brass cap with your fingers by using a "picking" action.
- Remove spring and carbon brush.
- Inspect length of carbon brush. Replace if length is reduced to 5 mm or less.
- To insert new carbon brush, hold the brush and turn it until it falls into place.
- If spring became loose, insert it into brush tube.
- Place brass cap over the spring, pressing down to seat brass cap into the brush tube.
- Insert nylon cap over brass cap.
- Replace brush cap and turn clockwise to screw securely into place.

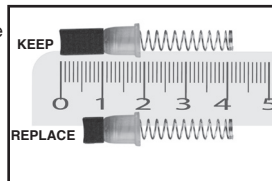

Blade Care and Cleaning

Lubricating

Blades should be oiled regularly to reduce heat and maintain sharpness. Before removing the blade, be sure it has cooled down.

- With clipper in off position, push blade away from clipper with your thumb.
- Place 1 or 2 drops of Oster® Clipper and Blade Lube™ oil on the blade. Wipe excess oil with a dry, soft cloth.
- Turn on clipper and push blade toward clipper until it snaps securely into place.

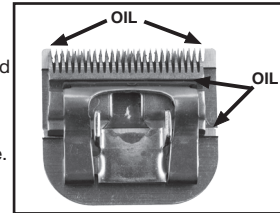

Cleaning

- Clean the excess hair from your blades by using the cleaning brush.
- To clean the blades, plug clipper into electrical outlet and turn on.
- In a shallow pan, immerse blade teeth into Oster® Blade Wash® cleaning solution.

CAUTION: DO NOT IMMERSE THE CLIPPER.

- Remove blade from cleaning solution and while holding clipper blade end down, wipe the blades with a dry, clean cloth.
- If after cleaning, you find that the blades still do not cut properly, it is possible that a few fine pieces of hair are still trapped between the blades.
- If this occurs, remove the blade. Without loosening the tension springs screws, slide the upper blade to one side but not completely out from under the tension spring.
- Wipe the surface between the blades clean with a dry cloth. Place a drop of oil where the upper and lower blades meet and in the guide slot of the tension spring.
- Slide upper blade to the other side and repeat process.

Sharpening

Oster® cutting blades are of individual hollow-ground design, hardened to extend cutting life. As with any cutting tool, the cutting edges will become dull after extensive use. If sharpening is necessary, send blades to an Oster Authorized Service Center.

Storing Your Clipper

Store your clipper in a clean, dry space. Be careful not to tangle the cord while storing the clipper. Do not wrap cord around the clipper when storing. This can damage the cord insulation.

Servicing of a Double Insulated Appliance

In a double insulated appliance, two systems of insulation are provided instead of grounding. No grounding means is provided on a double-insulated appliance, nor should a means for grounding be added. Servicing a double-insulated appliance requires extreme care and knowledge of the system and should be done only by qualified service personnel.

Replacement parts must be identical to those parts being replaced.

A double-insulated appliance is marked with the words "DOUBLE INSULATION" or "DOUBLE INSULATED"

The symbol may also be marked on the appliance. 

WARNING



When using or cleaning this clipper, do not use any non Oster approved aerosol sprays or blade washes, especially those containing methylene chloride, dimethyl benzyl ammonium chloride, or 1-1-1 trichloroethylene. Damage caused by these chemicals will void your warranty. You may use Oster® Blade Wash® cleaner and Oster® Blade Lube™ oil, which do not harm the product.

How to Obtain Warranty Service

Oster DIRECT™

Or an Authorized Service Center

Send this product to our Oster Direct® service center located at 904 Red Road, McMinnville, TN 37110-8653 U.S.A. or to an authorized service center for Oster® Professional Products as indicated below:

In the U.S.A.

If you have any question regarding this warranty or would like to obtain warranty service, please call 1 800 830-3678 and a convenient service center address will be provided to you.

In Canada

If you have any question regarding this warranty or would like to obtain warranty service, please call 1 800 830-3678 and a convenient service center address will be provided to you. When sending the product to the service center:

- Fill out and attach the Service Information Form (found at the end of this manual) to the Product.
- If returning a clipper, include blades.
- When ordering parts, please specify the model number and series letter indicated on your product.
- Include a copy of the original sales receipt.
- Carefully package the product and send either mail or courier with shipping and insurance prepaid to the service center.

WARRANTY: U.S. and CANADA: 1 Year Limited Warranty

Sunbeam Products, Inc. doing business as Jarden Consumer Solutions or if in Canada, Sunbeam Corporation (Canada) Limited doing business as Jarden Consumer Solutions (collectively "JCS") warrants that for a period of one year from the date of purchase, this product will be free from defects in material and workmanship. JCS, at its option, will repair or replace this product or any component of the product found to be defective during the warranty period. Replacement will be made with a new or remanufactured product or component. If the product is no longer available, replacement may be made with a similar product of equal or greater value. This is your exclusive warranty. Do NOT attempt to repair or adjust any electrical or mechanical functions on this product. Doing so will void this warranty.

This warranty is valid for the original retail purchaser from the date of initial retail purchase and is not transferable. Keep the original sales receipt. Proof of purchase is required to obtain warranty performance. JCS dealers, service centers, or retail stores selling JCS products do not have the right to alter, modify or any way change the terms and conditions of this warranty.

This warranty does not cover normal wear of parts or damage resulting from any of the following: negligent use or misuse of the product, use on improper voltage or current, use contrary to the operating instructions, disassembly, repair or alteration by anyone other than JCS or an authorized JCS service center. Further, the warranty does not cover: Acts of God, such as fire, flood, hurricanes and tornadoes.

What are the limits on JCS's Liability?

JCS shall not be liable for any incidental or consequential damages caused by the breach of any express, implied or statutory warranty or condition.

Except to the extent prohibited by applicable law, any implied warranty or condition of merchantability or fitness for a particular purpose is limited in duration to the duration of the above warranty.

JCS disclaims all other warranties, conditions or representations, express, implied, statutory or otherwise.

JCS shall not be liable for any damages of any kind Resulting from the purchase, use or misuse of, or inability to use the product including incidental, special, consequential or similar damages or loss of profits, or for any breach of contract, fundamental or otherwise, or for any claim brought against purchaser by any other party.

Some provinces, states or jurisdictions do not allow the exclusion or limitation of incidental or consequential damages or limitations on how long an implied warranty lasts, so the above limitations or exclusion may not apply to you.

This warranty gives you specific legal rights, and you may also have other rights that vary from province to province, state to state or jurisdiction to jurisdiction.

How to Obtain Warranty Service

In the U.S.A.

If you have any question regarding this warranty or would like to obtain warranty service, please call 1 800 830-3678 and a convenient service center address will be provided to you.

In Canada

If you have any question regarding this warranty or would like to obtain warranty service, please call 1 800 830-3678 and a convenient service center address will be provided to you.

In the U.S.A., this warranty is offered by Sunbeam Products, Inc. doing business as Jarden Consumer Solutions located in Boca Raton, Florida 33431. In Canada, this warranty is offered by Sunbeam Corporation (Canada) Limited doing business as Jarden Consumer Solutions, located at 20 B Hereford Street, Brampton, Ontario L6Y 0M1. If you have any other problem or claim in connection with this product, please write our Consumer Service Department. **PLEASE DO NOT RETURN THIS PRODUCT TO ANY OF THESE ADDRESSES OR TO THE PLACE OF PURCHASE.**

For service, please contact:

North America:

Oster Direct® Services
904 Red Road, McMinnville, TN 37110
(800) 830-3678
or an Authorized Service Center

Oster
Professional®

© 2012 Sunbeam Products, Inc. doing business as Jarden Consumer Solutions. All rights reserved. Distributed by Sunbeam Products, Inc. doing business as Jarden Consumer Solutions, Boca Raton, Florida 33431. Printed in USA

GCDS-OST26509-AB

PN 155512

Free Manuals Download Website

<http://myh66.com>

<http://usermanuals.us>

<http://www.somanuals.com>

<http://www.4manuals.cc>

<http://www.manual-lib.com>

<http://www.404manual.com>

<http://www.luxmanual.com>

<http://aubethermostatmanual.com>

Golf course search by state

<http://golfingnear.com>

Email search by domain

<http://emailbydomain.com>

Auto manuals search

<http://auto.somanuals.com>

TV manuals search

<http://tv.somanuals.com>