

# Panasonic®

## Digital Imaging Systems Operating Instructions (For Copier)

Model No. DP-1510P/1810P/2010E

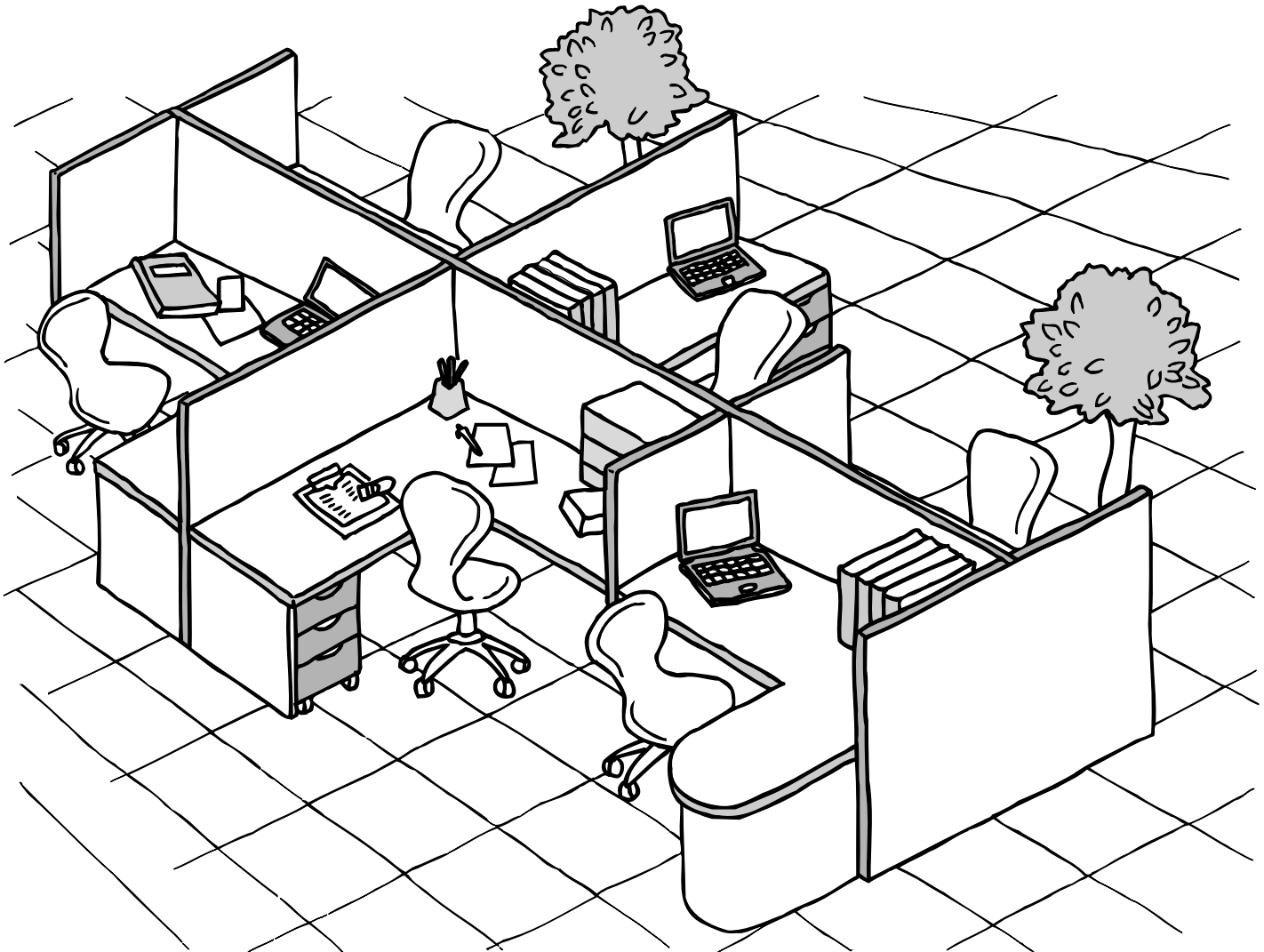

Before operating this equipment, please read these instructions completely and keep these operating instructions for future reference.

English

## IMPORTANT INFORMATION

When requesting information, supplies or service always refer to the model and serial number of your machine. The model and serial number plate (Main Name Plate) is located on the rear side of machine. For your convenience, space is provided below to record information you may need in the future.

Model No.

---

Serial No.

---

Date of Purchase

---

Dealer

---

Address

---

Telephone Number

(     )

---

Supplies Telephone Number

(     )

---

Service Telephone Number

(     )

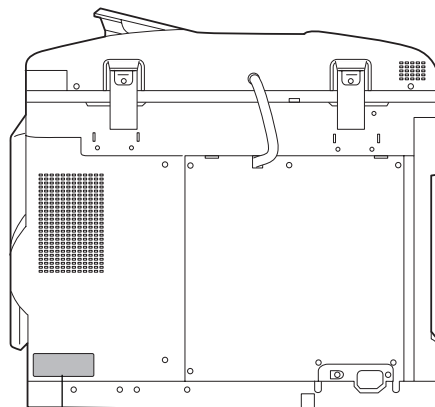

(Digital copier with ADF option)

### Model and Serial Number

Copyright © 2002 by Matsushita Graphic Communication Systems, Inc.  
All rights reserved. Unauthorised copying and distribution is a violation of law. Printed in Japan.  
The contents of these Operating Instructions are subject to change without notice.

# Operation Chart

## Common Features and Usage

### Basic Operation

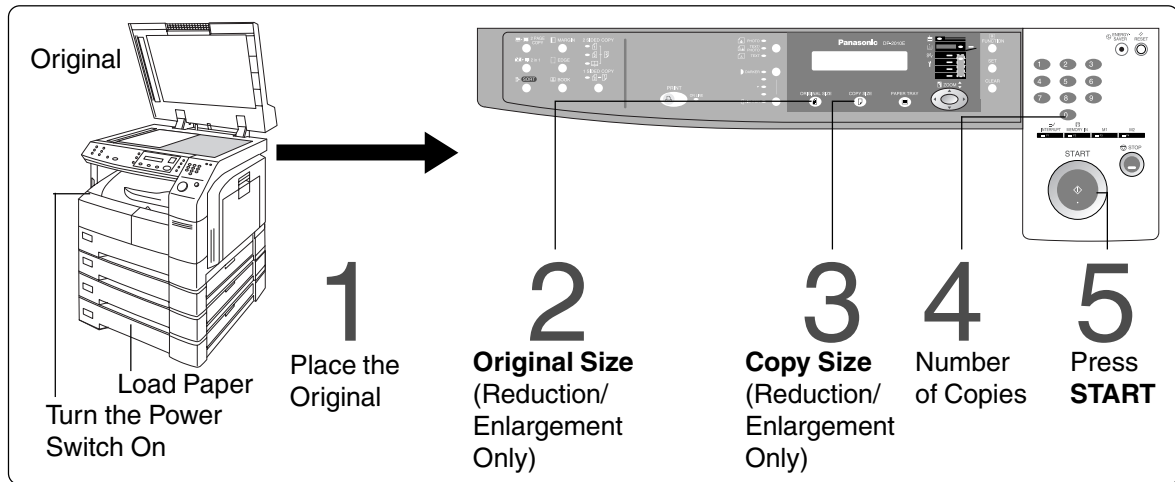

### Position of the Original

#### From ADF (or i-ADF)



ADF Tray

#### Original Guides

Adjust to the original's width

#### From Platen

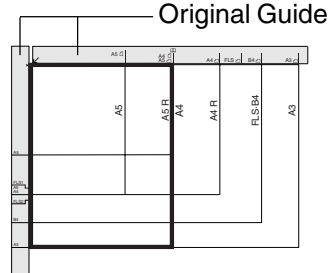

- Place originals face down on the platen or face up on the ADF.
- If the original is not positioned properly, a portion of the original may not be copied.
- For originals smaller than A5 size, position the original within the area of A5 and select A5.

### Commonly Used Functions and Operating Procedures

#### Full Size

Makes a copy that is the same size as the original

1 → 4 → 5 (See page 12)

#### Reduction or Enlargement

Copies the original at a fixed reduction or enlargement ratio

1 → 2 → 3 → 4 → 5 (See page 13)

### Memory Capacity

When the memory becomes full during original scanning, the message "OUT OF MEMORY" "CONTINUE? 1: YES 2: NO" will be displayed in the message display. In this case, follow the operating instruction in the message display.

When additional memory is required, consult with an authorised servicing dealer.

# Energy Star



As an **ENERGY STAR**<sup>®</sup> Partner, Panasonic has determined that this product meets the **ENERGY STAR**<sup>®</sup> guidelines for energy efficiency.

This voluntary program specifies certain energy consumption and usage standards. This product will automatically “power down” after a specified period of non-use. The use of this **ENERGY STAR**<sup>®</sup> compliant product will reduce energy consumption and ultimately benefit the environment.

The default functions can be adjusted depending on your office requirements. Please ask your authorised Panasonic dealer for more details.

# Table of Contents

## Getting To Know Your Machine

Operation Chart .....	3
■ Common Features and Usage .....	3
Energy Star .....	4

## Before Starting

Precautions .....	7
■ For Your Safety .....	7
■ Handling .....	8
■ Toner and Paper .....	8
■ Ventilation .....	8
■ Installation .....	9
Control Panel .....	10

## Making Copies

Basic Copy .....	12
■ Full Size Copying .....	12
■ Reduction or Enlargement Copying .....	13
■ Zoom Copying .....	14
■ Using the Sheet Bypass .....	15
Creative Features .....	16
■ 2 in 1 Copy .....	16
■ 2 Page Copy .....	17
■ Book/Edge/Margin .....	18
■ 2-Sided/1-Sided Copy .....	19
■ 1 → 2/2 → 1/2 → 2 Copy .....	20
■ Book → 2 Copy .....	21
■ Job Memory .....	22
■ Sort Copy .....	23
Other Features .....	24
■ Energy Saver/Interrupt Mode .....	24
■ Skyshot Mode .....	25
Combined Function Table .....	27
Function .....	28
■ Checking the Copier's Total Counter .....	28
■ General Functions .....	29
■ Copier Settings .....	30
■ General Functions for Key Operator .....	31
■ Copier Settings for Key Operator .....	32
■ Function Setting .....	33
■ Function Setting for Key Operator .....	34

# Table of Contents

## Options

<b>Accessories</b> .....	39
■ <b>Components</b> .....	39
■ <b>Automatic Document Feeder</b> .....	40

## Problem Solving

<b>Problem Solving</b> .....	42
■ <b>Adding Paper (📄)</b> .....	42
■ <b>Adding the Toner and Replacing Waste Toner Container (🗑️)</b> .....	43
■ <b>Removing a Misfed Paper</b> .....	45
<b>Troubleshooting</b> .....	52
■ <b>Before Calling Service</b> .....	52
■ <b>User Error Codes (U Code)</b> .....	54

## Others

<b>Specifications</b> .....	55
<b>Options and Supplies</b> .....	57

# Precautions

## For Your Safety

### ■ Laser Safety

#### LASER SAFETY

This unit employs a laser. Only qualified service personnel should attempt to service this device due to possible eye injury.

#### CAUTION:

USE OF CONTROLS, ADJUSTMENTS OR PERFORMANCE PROCEDURES OTHER THAN THOSE SPECIFIED HEREIN MAY RESULT IN HAZARDOUS RADIATION EXPOSURE.



### ■ Caution Label

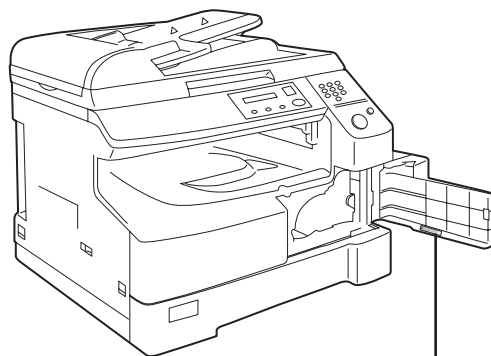

(Digital copier with ADF option)

- **DANGER** : Invisible laser radiation when open and interlock defeated. AVOID DIRECT EXPOSURE TO BEAM.
- **CAUTION** : Invisible and hazardous laser radiation when interlocks defeated. AVOID EXPOSURE TO BEAM.
- **ATTENTION** : Rayonnement laser invisible dangereux lorsque la sécurité est neutralisée. EXPOSITION DANGEREUSE AU FAISCEAU.
- **VORSICHT** : Unsichtbare Laserstrahlung, wenn Sicherheitsverriegelung überbrückt. NICHT DEM STRAHL AUSSETZEN.
- **PELIGRO** : Cuando se invalida el bloqueo, se producen radiaciones invisibles de láser. EVITESE LA EXPOSICIÓN DIRECTA A TALES RAYOS.
- **VARO!** : Näkymätöntä ja vaarallista laser säteilyä suojalukitus ohitettaessa. Vältä suoraa altistumista säteelle.
- **ADVARSEL** : USYNLIG LASERSTRÅLING NÅR SIKKERHEDS-ÅF-BRYDERE ER UDE AF FUNKTION. UNDGÅ UDSETTELSE FOR STRÅLING.
- **ADVARSEL** : OSYNLIG LASERSTRÅLING NÅR SPARRÅRÅR URKOPPLADE. STRÅLEN ÅR FARLIG.
- **WARNING** : OSYNLIG LASERSTRÅLING NÅR SPARRÅRÅR URKOPPLADE. STRÅLEN ÅR FARLIG.
- **注意** : 为阻止激光照射，当连接本机时，请勿暴露在光柱下。
- **주의** : 연결장치가 고장 되었을 때에는 눈에 보이지않고 위험한 레이저 방사선이 빛에 직접 닿지않도록 해 주십시오.

FBS8902

## Precautions

### Handling

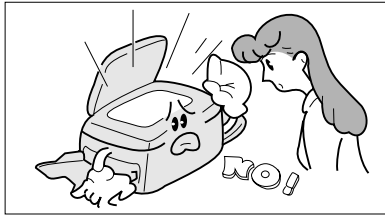

- Do not look directly at the exposure lamp when copying.

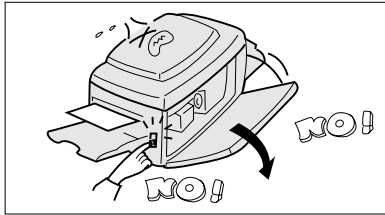

- Do not turn the power switch Off or open the front panel during copying.
- Do not drop paper clips or other metal objects into the copier.

### Toner and Paper

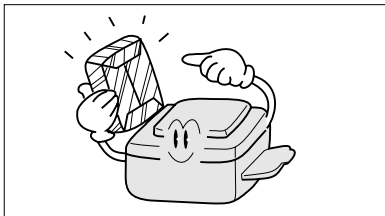

- Store toner, drum and paper in cool areas with low humidity.
- Use high quality 60 - 90 g/m<sup>2</sup> (Sheet Bypass: 56 - 128 g/m<sup>2</sup>) paper.
- For optimum performance, it is recommended that only Panasonic Brand supplies are used in the copier.

### Ventilation

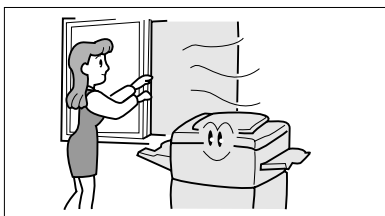

- The copier should be installed in a well-ventilated area to minimise the ozone density in the air.

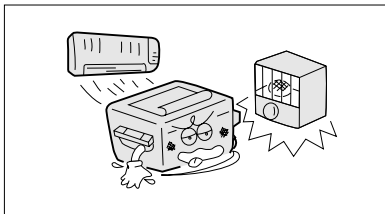

- The copier should not be installed in areas with the following conditions:
  - Extremely high or low temperature and humidity.  
Ambient conditions  
Temperature: 10 – 35°C  
Relative humidity: 45 – 80%



- Where temperature and humidity can change rapidly, causing condensation.
- Direct exposure to sunlight.
- Directly in the air conditioning flow.
- In areas of high dust concentration.
- In areas of poor ventilation.
- In areas with chemical fume concentration.
- In areas with extreme vibration.
- With unstable or uneven conditions (floors, etc.).



## Installation

- The maximum power consumption is 1.2 kW.  
A properly wired (grounded), dedicated, 6A, 220-240 V AC outlet is required.  
Do not use an extension cord.  
The power cord on this equipment must be used to disconnect the main power.  
Please ensure that the socket outlet is installed near the equipment and is easily accessible.

## FOR YOUR SAFETY

**Caution Note:** Disconnect from the mains supply before removing covers.

The mains plug on this equipment must be used to disconnect mains power. Please ensure that the socket outlet is installed near the equipment and shall be easily accessible.

### For U.K.

This appliance is supplied with a moulded three pin mains plug for your safety and convenience. A 13 amp fuse is fitted in this plug.

Should the fuse need to be replaced please ensure that the replacement fuse has a rating of 13 amps and that it is approved by ASTA or BSI to BS1362

Check for the ASTA mark  or the BSI mark  on the body of the fuse.

If the plug contains a removable fuse cover you must ensure that it is refitted when the fuse is replaced.

If you lose the fuse cover the plug must not be used until a replacement cover is obtained. A replacement fuse cover can be purchased from your local Panasonic Dealer.

**IF THE FITTED MOULDED PLUG IS UNSUITABLE FOR THE SOCKET OUTLET IN YOUR OFFICE THEN THE FUSE SHOULD BE REMOVED AND THE PLUG CUT OFF AND DISPOSED OF SAFELY. THERE IS A DANGER OF SEVERE ELECTRICAL SHOCK IF THE CUT OFF PLUG IS INSERTED INTO ANY 13 AMP SOCKET.**

If a new plug is to be fitted please observe the wiring code as shown below.

If in any doubt please consult a qualified electrician.

**WARNING: THIS APPLIANCE MUST BE EARTHED.**

**IMPORTANT:** The wires in this mains lead are coloured in accordance with the following code:

Green and Yellow: Earth

Blue : Neutral

Brown : Live

As the colours of the wires in the main lead of this appliance may not correspond with the coloured markings identifying the terminals in your plug, proceed as follows:

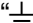
The wire which is coloured GREEN-AND-YELLOW must be connected to the terminal in the plug which is marked by letter E or by the safety Earth symbol "" or coloured GREEN or GREEN-AND-YELLOW.

The wire which is coloured BLUE must be connected to the terminal in the plug which is marked with the letter N or coloured BLACK.

The wire which is coloured BROWN must be connected to the terminal in the plug which is marked with the letter L or coloured RED.

How to replace the fuse.

Open the fuse compartment with a screwdriver and replace the fuse.

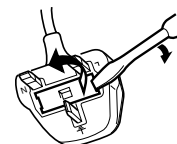

# Control Panel

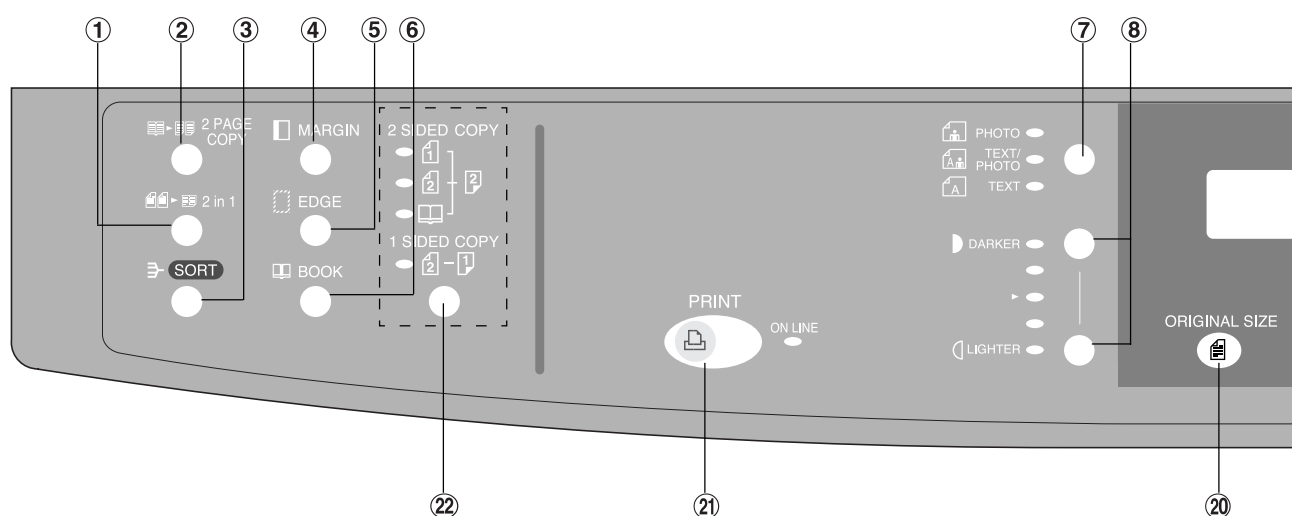

(For DP-2010E only)

No	Contents	Refer to
①	<b>2 in 1 Key</b> ● From two 1-sided originals, side by side, to 1-sided copies.	Page 16
②	<b>2 Page Copy Key</b> ● Copying two facing pages on a A3 size original on two separate A4 size sheets.	Page 17
③	<b>Sort Key</b> ● When using Electric Sorting Mode. Optional memory is required.	Page 23
④	<b>MARGIN Key</b> ● Shifts the image to the right or left.	Page 18
⑤	<b>EDGE Key</b> ● Creates a blank edge.	Page 18
⑥	<b>BOOK Key</b> ● Eliminates dark inner binding shadows.	Page 18
⑦	<b>Photo; Text/Photo; Text Keys</b> ● Select the type of original(s) for image density adjustment. PHOTO : Originals are mainly composed of photo. TEXT/PHOTO: Combined originals with text and photo. TEXT : Originals are mainly composed of text.	Page 12
⑧	<b>Exposure Keys (DARKER, LIGHTER)</b>	Page 12
⑨	<b>SET Key</b> ● Set the present selection.	—
⑩	<b>FUNCTION Key</b> ● Use when changing the paper size, initial values for functions (default values) and key operator settings.	Pages 28 – 37
⑪	<b>CLEAR Key</b> ● Clears the copy count in the display.	—
⑫	<b>ENERGY-SAVER Key</b> ● Can save power while the copier is not in use.	Page 24
⑬	<b>RESET Key</b> ● Resets all features to the initial power-on state.	—

## NOTE

- The Control Panel displayed above shows only copier functions. Please refer to the appropriate operating instructions for other control panel functions or in the Panasonic Document Management System CD-ROM for the Printer control panel functions.
- The illustration above shows the DP-2010E control panel.

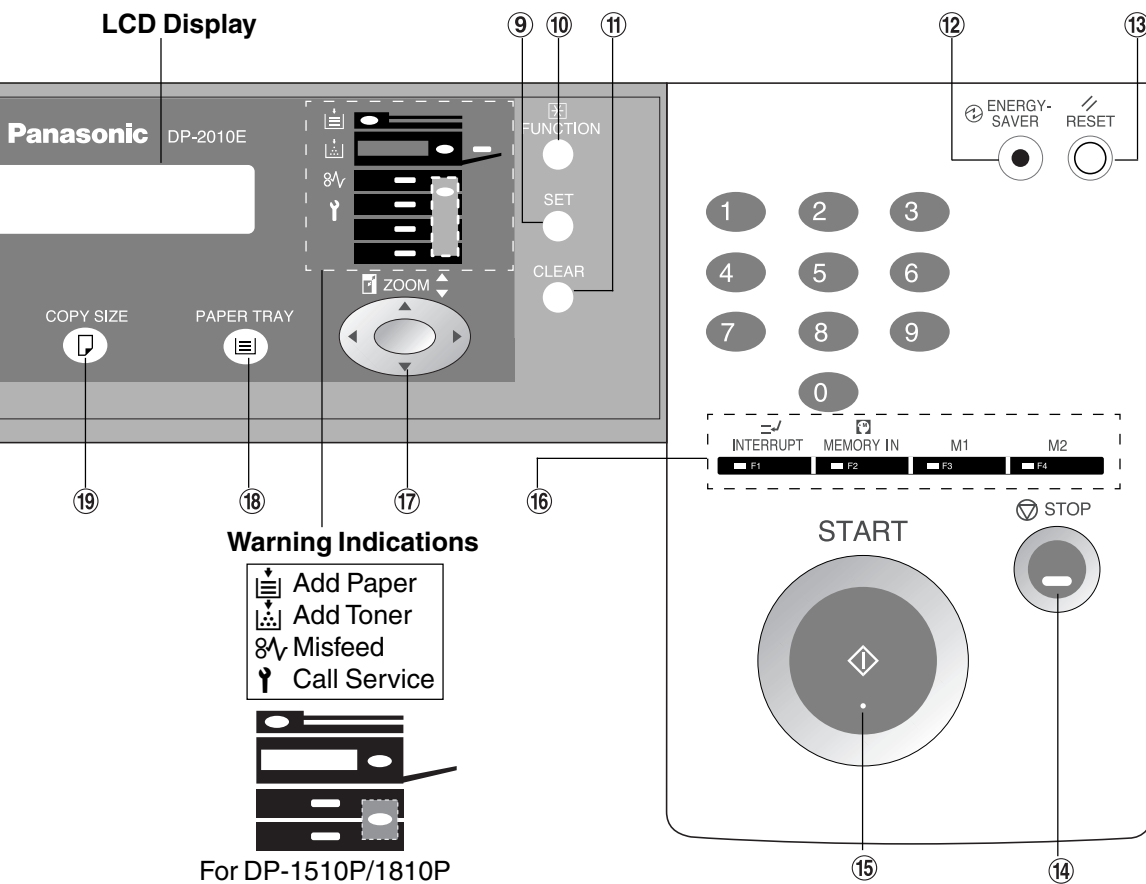

No	Contents	Refer to
14	<b>STOP Key</b> ● Stops the copy run.	—
15	<b>START Key</b> ● Used to start an operation.	—
16	<b>INTERRUPT Key, MEMORY IN Key, M1/M2 Keys</b> ● Interrupt Key interrupts other copy or print jobs while making copies. ● Memory In Key registers two copy jobs for recall at a later time. ● M1/M2 Keys are used to store a Job in Memory or to recall a Job stores in Memory.	Pages 22, 24
17	<b>Cursor Keys</b> ● Select copy ratio and function modes using (▼ or ▲).	—
18	<b>PAPER TRAY Key</b> ● Used to select the paper tray manually.	—
19	<b>COPY SIZE Key</b> ● Used to select Reduction/Enlargement only. For additional details, see page 13.	—
20	<b>ORIGINAL SIZE Key</b> ● Used to select the original size manually. For additional details, see page 13.	—
21	<b>PRINT Key</b> ● When selecting the Printer ON/OFF Line.	—
22	<b>2-Sided/1-Sided Copy Key</b> ● Used to select 1 → 2, 2 → 2 and 2 → 1, Book → 2 copying	—

**NOTE**

● The Control Panel displayed above shows only copier functions. Please refer to the appropriate operating instructions for other control panel functions or in the Panasonic Document Management System CD-ROM for the Printer control panel functions.

# Basic Copy

## Full Size Copying

### ■ Copying the Same Size Originals (1:1)

Copy size is automatically selected.

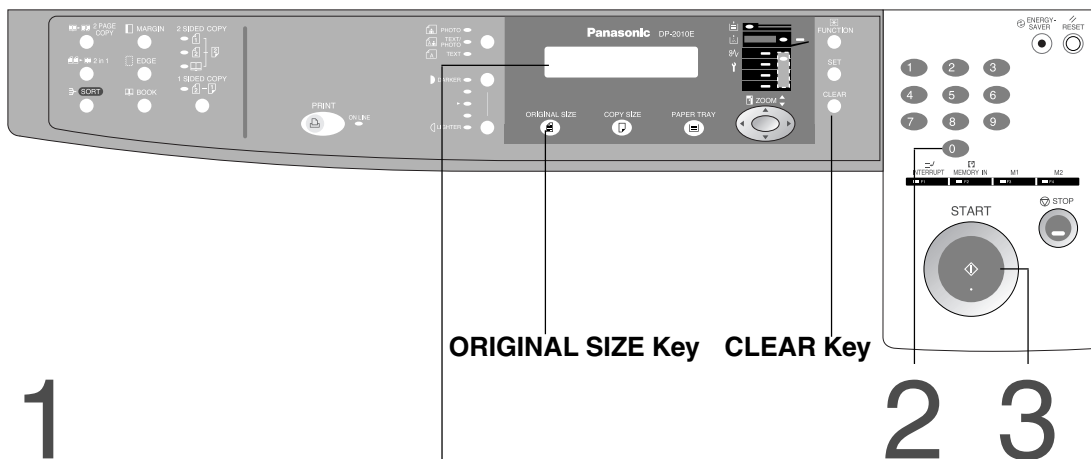

1 Place the Original

ORIGINAL SIZE Key CLEAR Key

Number of Copies\* Press START\*\*  
Up to 999

LCD Display (Sample)

READY TO COPY  
COPIES:001

Select the Original Size on units without the ADF/i-ADF Option.

### ■ Manually Selecting Exposure Control or Original Type

- 1 Select the Original Type**  
PHOTO : Originals are mainly composed of photo.  
TEXT/PHOTO: Combined originals with text and photo.  
TEXT : Originals are mainly composed of text.
- 2 Select Exposure Control**  
Press the DARKER/LIGHTER keys to adjust the exposure.

#### NOTE

- \* Use Clear key when cancelling the copy count.
- \*\* While the copier is warming up, you may position your original on the copier, enter your copy job selections and press the Start key. The COPY JOB RESERVED indicator displays until the warm up cycle is completed and the copy job is automatically started.

## Reduction or Enlargement Copying

### ■ Copying with Preset Ratios

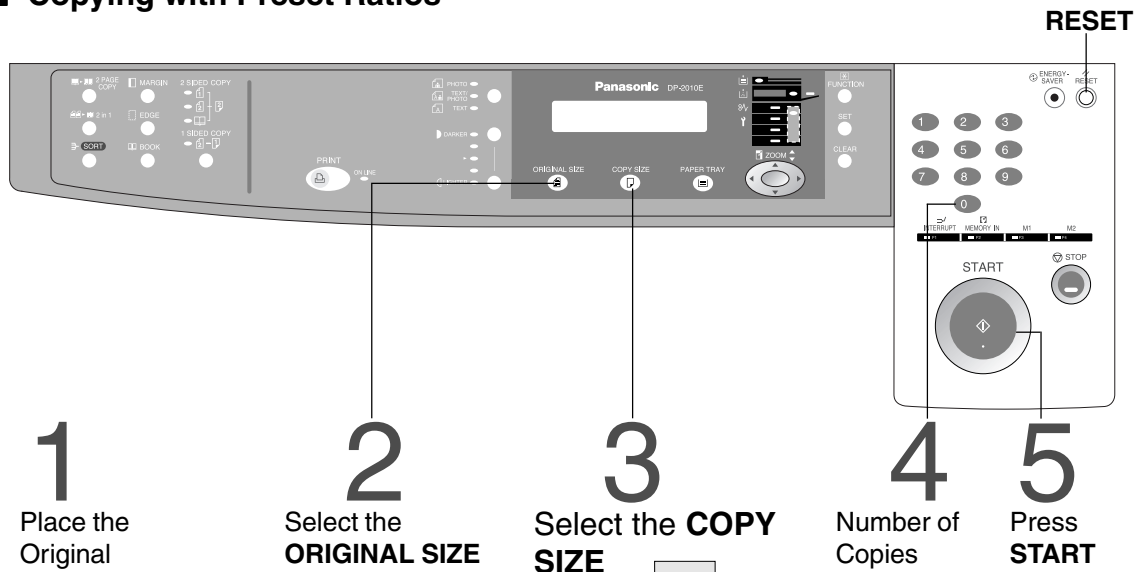

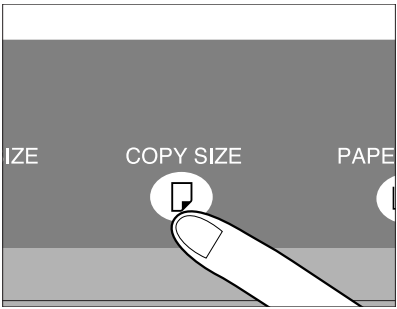

**Example: Reduction**

Original size → Copy size

A3

→

A4

A3 → A4 C[A4 ]  
ZOOM: 71% COPIES:001

The correct ratio is automatically selected.

Reduction and enlargement ratios (%)

Original Size	Copy Size			
	A3	B4	A4	A5
A3	100	87	71	50
B4	115	100	82	58
A4	141	122	100	71
A5	200	173	141	100

● When changing the paper tray, press the Paper Tray key.

**NOTE**

- If the desired copy size is different from the paper size loaded in the paper tray, use the sheet bypass. (See page 15)
- Press the **RESET** key to cancel all job settings.

# Basic Copy

## Zoom Copying

### Zoom

Copies with variable zoom ratios from 50 % to 200 % in 1 % increments.

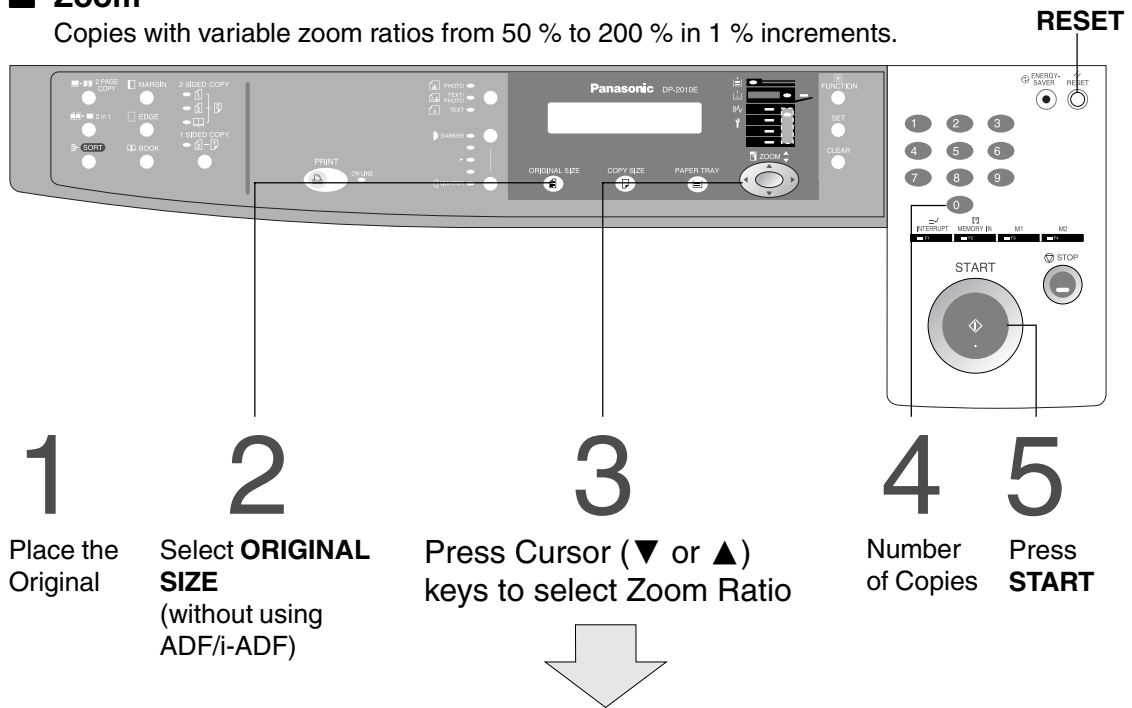

A4 [ ] → A4 [ ] [A4 [ ] ]  
ZOOM: 125% COPIES: 001

(Example: 125 % Zoom)

#### ATTENTION

- When changing the paper size after setting the zoom ratio, please use the paper tray key.

#### NOTE

- Press the **RESET** key to cancel all job settings.

## Using the Sheet Bypass

### ■ Copying on Special Paper, etc.

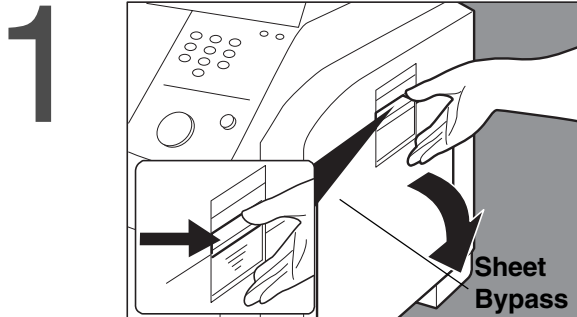

Place the original.

Open the sheet bypass.

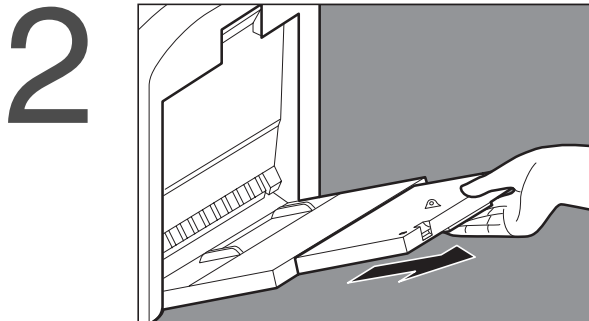

Pull out the sheet bypass tray until it stops.  
(For A3 size only)

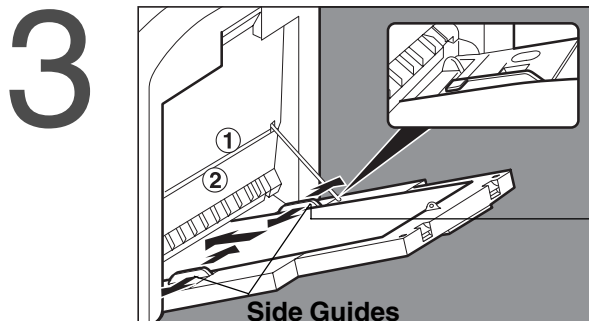

① Place the sheets of paper into the tray. (approximately up to 50 A4 size sheets 80 /gm<sup>2</sup>)

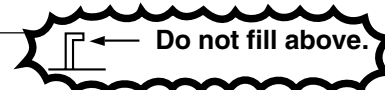

Insert the paper until it stops.

② Adjust the side guides.

Incorrect adjustment may cause the paper to wrinkle, misfeed or skew.

Press **START**.

#### ATTENTION

- Do not feed curled paper through the sheet bypass to avoid misfeed.

#### NOTE

- Adjust the side guides properly to avoid skewing, wrinkling or misfeeding.

# Creative Features

## 2 in 1 Copy

### ■ 2 in 1 Copy

From two 1-Sided originals, side by side, to 1-Sided pages.

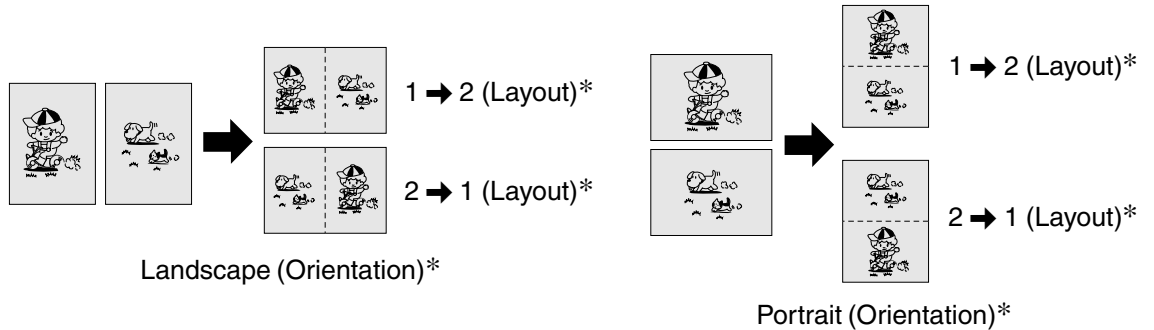

### ■ Procedure

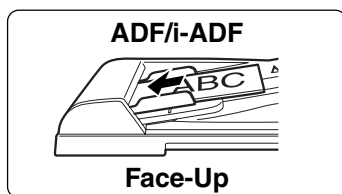

1

Place the  
Originals

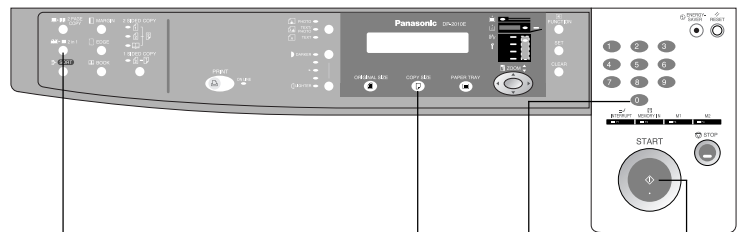

2

Press **2  
in 1** key

(3)

**COPY SIZE**  
(Reduction/  
Enlargement  
Only)

4

Number of  
Copies

5

Press  
**START**

#### NOTE

- The ADF/i-ADF is required for 2 in 1 copy.
  - Press the **RESET** key to cancel all job settings.
  - Numbers in parenthesis “ ( ) ” represent that, an additional step is required to activate the feature.
- \* The Orientation and Layout can be set in the Copier Settings function mode.  
(See page 30)



## 2 PAGE COPY

### ■ 2 PAGE Copy

Copying two facing pages on a A3 size original on two separate A4 size sheets.

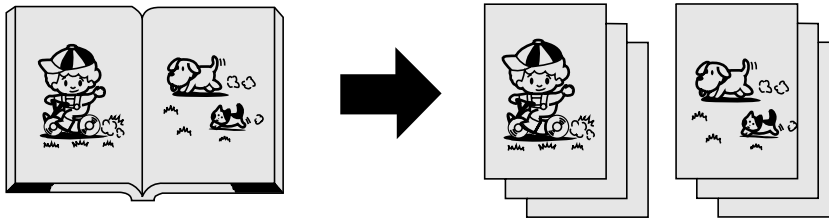

### ■ Procedure

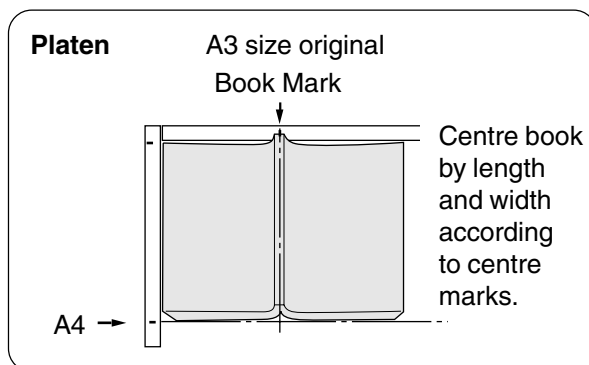
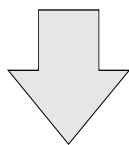
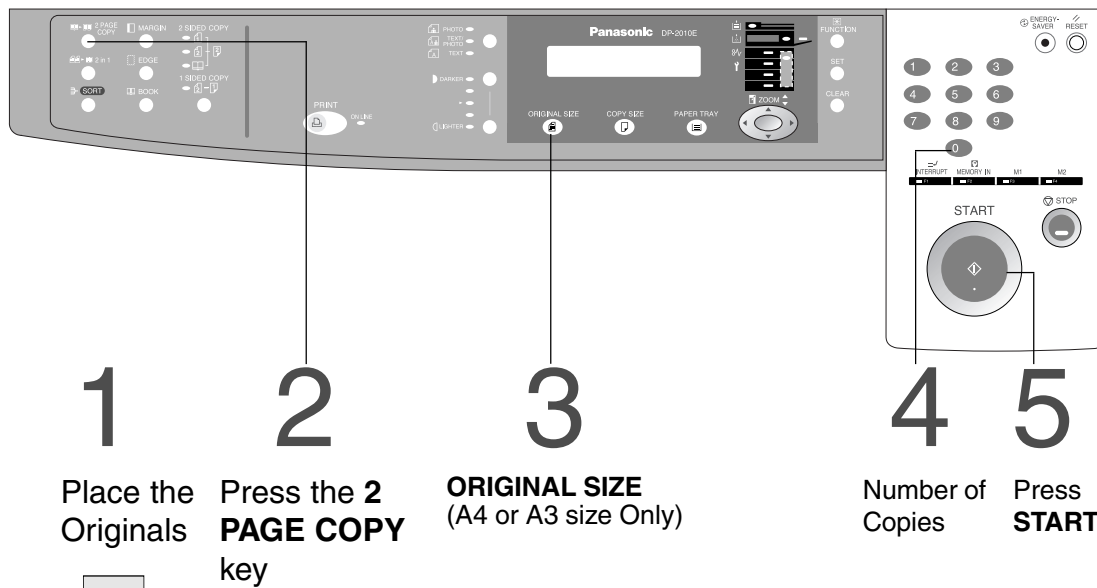

#### NOTE

● To reset all job settings, press the **RESET** key.

## Creative Features

### BOOK/EDGE/MARGIN

#### ■ BOOK Key

Eliminates dark inner binding shadows when copying from a book.

#### ■ EDGE Key

Creates a blank edge.

#### ■ MARGIN Key

Shifts the image to the right or left.

#### ■ Procedure

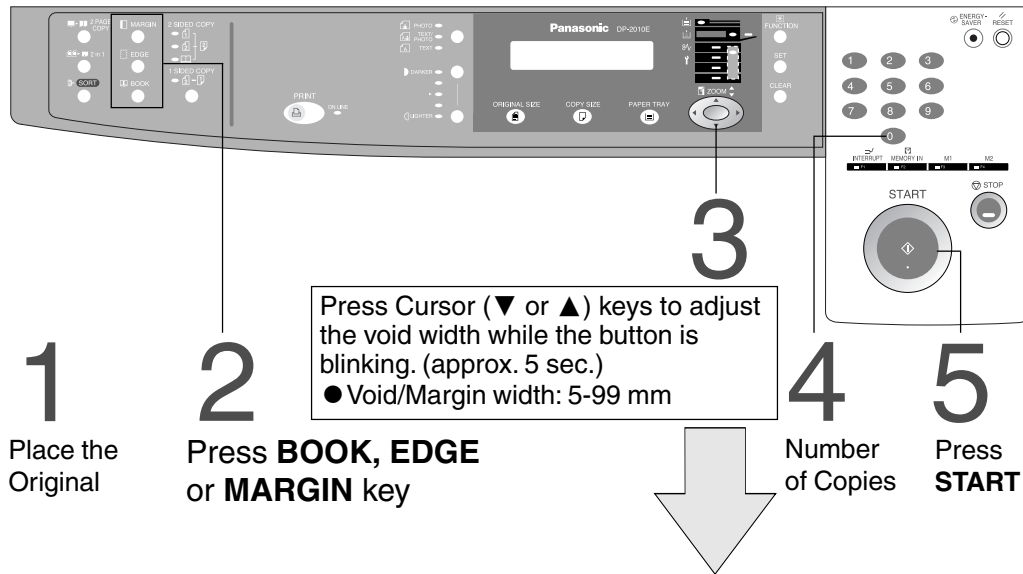

#### Book

BOOK MARGIN  
CENTER VOID = 20mm ▼▲

\* Initial Book Margin setting (Factory setting): 20 mm

#### Edge

EQUAL RATE  
VOID MARGIN = 5mm ▲

\* Initial Equal Rate setting (Factory setting): 5 mm

#### Margin\*\*

LEFT MARGIN  
10mm ▼▲

\* Initial Left Margin setting (Factory setting): 10 mm

#### NOTE

- \* Initial setting (Factory setting) can be changed in the Copier Settings function mode. (See page 30)
- \*\* If a part of the copied image is missing when using the Margin mode, change the Frame Reduction setting to ON. (See page 30)
- Press the **RESET** key to cancel all job settings.

## 2-Sided/1-Sided Copy (For DP-2010E)

### ■ Key Operation

Press 2-Sided/1-Sided Copy key (circulation) to select a 2-Sided/1-Sided Copy function.



2-Sided/1-Sided Copy key

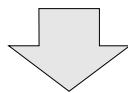

1 → 2

From 1-Sided originals to 2-Sided copies.

(See page 20)

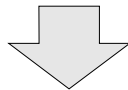

2 → 2

From 2-Sided originals to 2-Sided copies.

(See page 20)

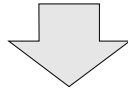

Book → 2

From book originals to 2-Sided copies.

(See page 21)

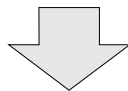

2 → 1

From 2-Sided originals to 1-Sided copies.

(See page 20)

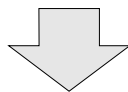

#### NOTE

- 2-Sided originals may be handled either manually or automatically using the i-ADF (DA-AR201).
- 2-Sided/1-Sided Copy function is only available for DP-2010E.

## Creative Features

### 1 → 2 / 2 → 1 / 2 → 2 Copy (For DP-2010E)

#### ■ 1 → 2 Copy

From 1-Sided originals to 2-Sided copies.  
(From Copier Platen & i-ADF/ADF)

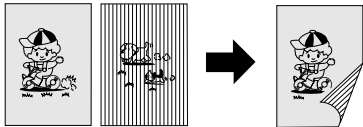

Long Edge (Binding)\*

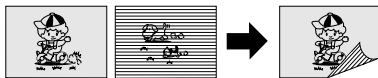

Short Edge (Binding)\*

#### ■ 2 → 1 Copy

From 2-Sided originals to 1-Sided copies.  
(Using i-ADF)

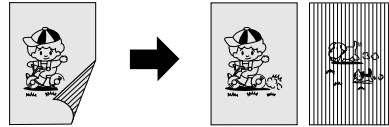

Long Edge (Binding)\*



Short Edge (Binding)\*

#### ■ 2 → 2 Copy

From 2-Sided originals to 2-Sided copies.  
(Using i-ADF)

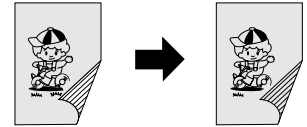

Long Edge (Binding)

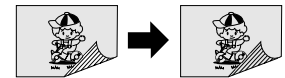

Short Edge (Binding)

#### ■ Procedure

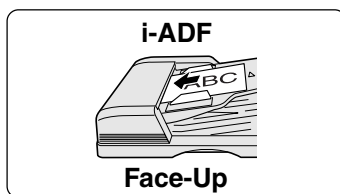

1

Place the Originals

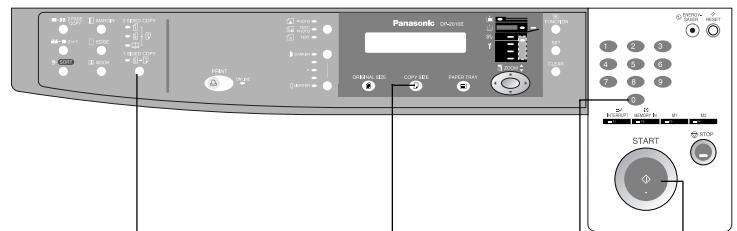

2

Press **2-Sided/1-Sided Copy** key (circulation) to select 1 → 2, 2 → 2 or 2 → 1

(3)

**COPY SIZE** (Reduction/Enlargement Only)

4

Number of Copies

5

Press **START**

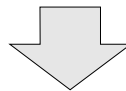

BINDING: LONG EDGE  
PRESS < > TO SELECT

Press the ◀ or ▶ key to select the binding location.

(When selecting 1 → 2 Copy or 2 → 1 Copy)

#### NOTE

- To reset each selection, press the **RESET** key.
- \* The initial setting of binding location for 1 → 2 Copy and 2 → 1 Copy (Long edge or Short edge) can be set in function mode. (See page 30)
- 1 → 2, 2 → 2, 2 → 1 Copy function is only available for DP-2010E.

**Book → 2 Copy (For DP-2010E)**

■ **Book → 2 Copy**

From book originals to 2-Sided copies.  
A3 size originals only.

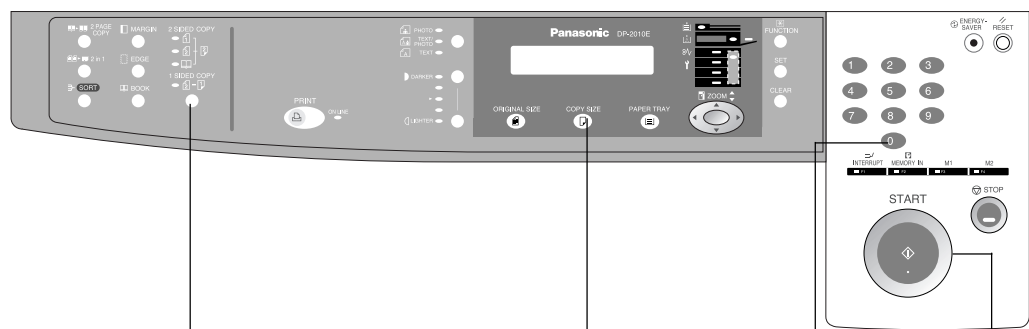
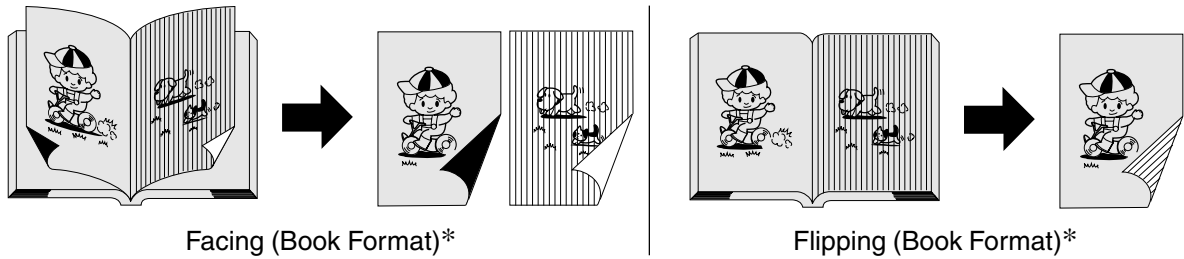

- 1 Place the Original on the Platen
- 2 Press **2-Sided/1-Sided Copy** key (circulation) to select **Book → 2**
- (3) **COPY SIZE** (Reduction/Enlargement Only\*)
- 4 Number of Copies
- 5 Press **START**

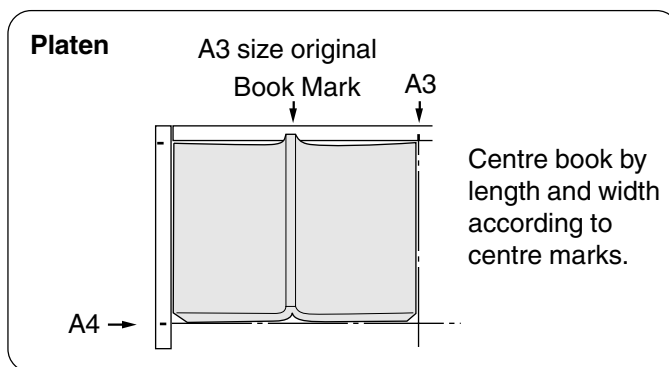
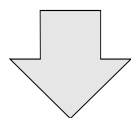

**NOTE**

- To reset each selection, press the **RESET** key.
- A3 and FLS/B4 copy sizes cannot be selected.
- \* The book format and page order can be set in function mode. (See page 30)
- Book → 2 Copy function is only available for DP-2010E.

## Creative Features

### Job Memory

- Two Copy Jobs Can Be Programmed in Memory (M1, M2) for recall at a later time.

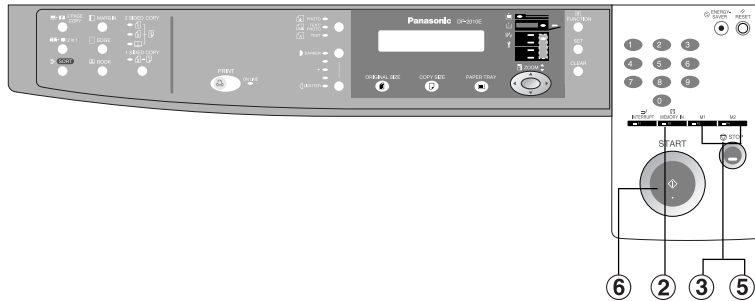

JOB MEMORY  
PRESS M1, M2 TO STORE.

RECALL JOB MEMORY  
LOADING...

#### To Store a Job in Memory

- ① Set up the copy job to be stored in memory, by first selecting each function you wish the copier to perform.
- ② Press the **MEMORY IN (F2)** key.
- ③ Press the **M1 (F3)** or **M2 (F4)** key.

#### To Recall a Job Stored in Memory

- ④ Place the Original
- ⑤ Press the **M1 (F3)** or **M2 (F4)** key.  
The stored contents will be displayed.
- ⑥ Press **START**

#### NOTE

- Stored job(s) will not be deleted even if the power switch is turned Off.
- When storing a new job into programmed memory, the previously stored job will be overwritten.

# Sort Copy

## Sort Copy

The sort copy has 2 available electronic sorting functions as follows:

**Note:** Before using the sort copy, select the desired sorting mode by setting its function first (See page 29).

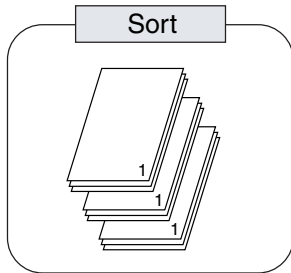

Multiple copies sorted automatically.

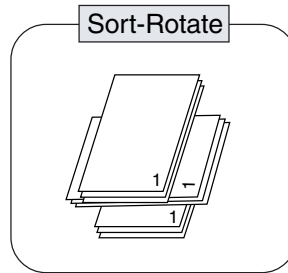

Multiple copies sorted automatically and Stacked in alternate direction.

(Up to A4 size)

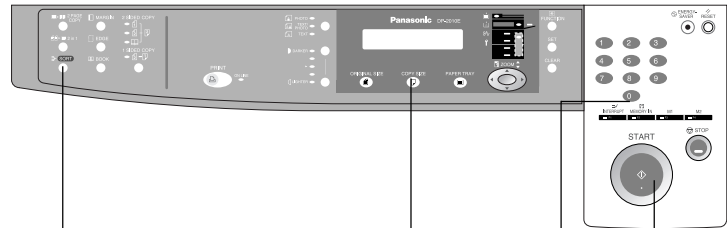
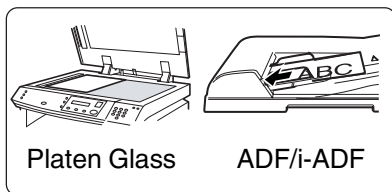

1

ADF/i-ADF: Place the Originals  
Platen: Place the First Original

2

Select the **SORT** Mode

(3)

**COPY SIZE**  
(Reduction/Enlargement Only)

4

Number of Copies

5

Press **START**



**From Platen Glass only:**

6

ANOTHER ORIGINAL?  
1: YES 2: NO

Press "1" key.

7

Place next Original

8

Press **START**

9

Repeat steps 6 and 7 until all originals are scanned and stored into the copier's memory.

10

ANOTHER ORIGINAL?  
1: YES 2: NO

Press "2" key.

**NOTE**

- When the memory becomes full during original scanning, the message "OUT OF MEMORY" "CONTINUE? 1: YES 2: NO" will be displayed in the message display. If this occurs, follow the instructions in the message display. For additional memory consult your authorised servicing dealer.
- To reset all job settings, press the RESET key.
- Electronic sorting function is available for DP-1810P/2010E.

# Other Features

## Energy Saver/Interrupt Mode

INTERRUPT (F1) Key ENERGY-SAVER Key

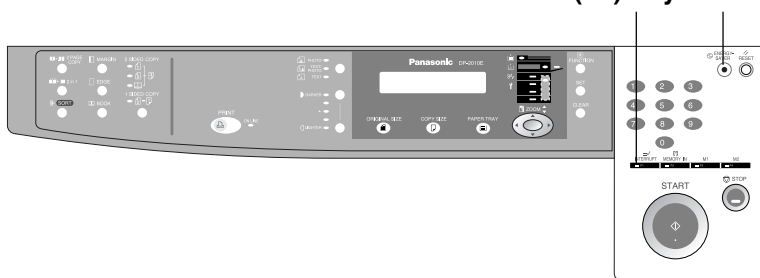

### ENERGY SAVER



■ These modes can save power while the copier is not in use.

#### Energy Saver Mode

- ① To enter this mode  
Press the **ENERGY-SAVER** key or the copier will automatically enter the ENERGY-SAVER Mode after 15 minutes\* from the last copy. The indicator will flash.
- ② To cancel this mode and make copies  
Press the **ENERGY-SAVER** key again.

#### Sleep Mode

- ① Automatically enters the Sleep Mode after 30 minutes from the last copy. The copier power will drop and the indicator will light.
- ② To make copies, press the **ENERGY-SAVER** key.

### INTERRUPT

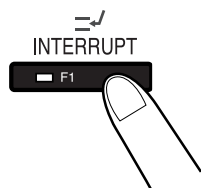

#### Interrupt Mode

- This mode can interrupt other copy jobs while making copies.
- ① Press the **INTERRUPT (F1)** key, the indicator will light.
  - ② Make another copy job using the platen glass.
  - ③ Press the **INTERRUPT (F1)** key again to continue the original job.

**Note:** The ADF/i-ADF can not be used with interrupt.  
(Use only the Platen)

#### NOTE

\* Energy saver time (15 minutes) and Sleep time (30 minutes) can be changed by the key operator. (See page 31)

Modes	Power Consumption	Warm Up Time
Normal Operation	Approximately 90 Wh	N/A
Energy Saver Mode	Approximately 38 Wh	17 sec. recovery
Sleep Mode	Approximately 2.2 Wh	30 sec. recovery



## Skyshot Mode

- **Skyshot allows copying a manuscript without generating dark borders even if the platen cover or ADF/i-ADF is opened.**

Skyshot mode eliminates dark borders around the originals, and is especially convenient for copying small-sized originals like bank checks or documents with unusual shapes (round, oval, etc.). These documents can be reproduced without generating any unnecessary black areas simply by making a copy with the cover open.

Two types of Skyshot modes can be selected;

Digital Skyshot Mode : The scanning area (size) is not pre-determined.

Manual Skyshot Mode : The scanning area (size) is pre-registered into memory (M1 and M2) in advance. (See page 30)

### ■ Digital Skyshot Mode

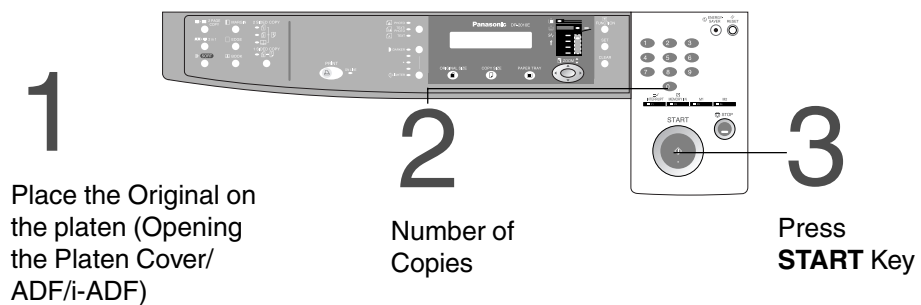

**Note:** The default setting of Digital Skyshot Mode is "NORMAL". In this setting, the unit scans once. If there are black areas around the borders in the copies, set the Digital Skyshot Mode to "QUALITY" to soften the dark borders. In this setting, the unit scans twice.

FUNCTION MODE (1-2)  
ENTER NO. OR ∨ ∧

2: COPIER SETTINGS  
PRESS SET TO SELECT

COPIER PARAM. (00-14)  
ENTER NO. \_ OR ∨ ∧

06 DIGITAL SKYSHOT  
2: NORMAL

- ① Press the **FUNCTION** key.
- ② Press the **2** key to select COPIER SETTINGS.
- ③ Press the **SET** key.
- ④ Press **6** and **SET** key to select DIGITAL SKYSHOT.
- ⑤ Press **1-3** key to select the Digital Skyshot Mode.
  - 1: OFF NONE
  - 2: NORMAL Default setting (usually select this mode).
  - 3: QUALITY For better definition, select the Quality mode.
- ⑥ Press the **SET** key.
- ⑦ Press the **RESET** key.

**NOTE**

- An incorrect exposure may occur when there is a black line at the edge of the original or an image which the copier interprets as a black pattern in the Skyshot mode.
- An incorrect position detection of the original may occur when a strong light shines onto the glass during Skyshot mode.

## Other Features

### Skyshot Mode

#### Manual Skyshot Mode

When using this function, the custom size should be registered into memory (M1, M2) in advance. (See page 32)

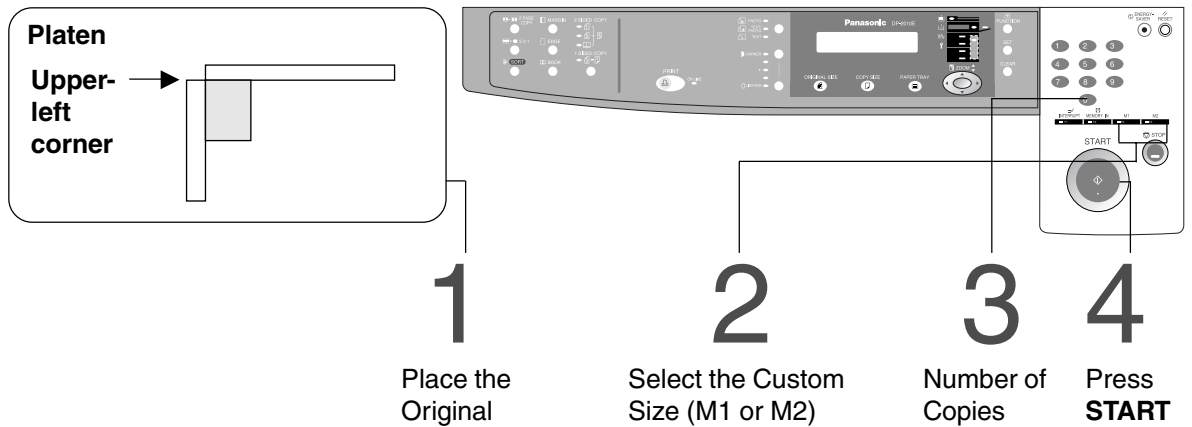

# 2

FUNCTION MODE (1-2)  
ENTER NO. OR  $\vee$   $\wedge$

2: COPIER SETTINGS  
PRESS SET TO SELECT

COPIER PARAM. (00-14)  
ENTER NO. \_ OR  $\vee$   $\wedge$

07 MANUAL SKYSHOT  
1: OFF

- ① Press the **FUNCTION** key.
- ② Press the **2** key to select COPIER SETTINGS.
- ③ Press the **SET** key.
- ④ Press **7** and **SET** key to select MANUAL SKYSHOT.
- ⑤ Press **2** or **3** key to select the Custom Size.  
1: OFF            NONE  
2: M1 ON        M1 size is ON\*  
3: M2 ON        M2 size is ON\*  
4: M1, M2 ON   Both sizes are ON
- ⑥ Press the **SET** key.
- ⑦ Press the **RESET** key.

#### NOTE

- \* The default size for M1 is: 70(X) × 160(Y) mm, and M2 is: 95(X) × 220(Y) mm
- When changing the M1 or M2 size, consult with the key operator.
- When using the Manual Skyshot mode, M1 and M2 are turned ON and other job memory cannot be used.
- Press the **RESET** key to cancel all job settings.

# Combined Function Table

Next Selections First Selections		2-ORIGINAL ▶ COPY						Margin			SORT			Other Functions			Remarks	
		Zoom Copy	2 in 1 Copy	2 Page Copy	1 → 2	2 → 2	Book → 2	2 → 1	Book	Edge	Margin	Non-Sort	Sort	Sort-Rotate	Manual Skyshot	Job Memory Retrieval		Job Memory Storing
Zoom Copy	A	○	○	○	○	○	○	○	○	○	○	○	○	○	A	A	○	
2-ORIGINAL ▶ COPY	2 in 1 Copy	○	A	A	○	A	A	A	○	○	○	○	○	○	A	A	○	
	2 Page Copy	○	A	A	A	A	A	A	○	○	○	○	○	○	A	A	○	
	1 → 2	○	○	A	A	A	A	A	○	○	○	○	○	○	A	A	○	
	2 → 2	○	○	A	A	A	A	A	○	○	○	○	○	○	A	A	○	
	Book → 2	○	○	A	A	A	A	A	○	○	○	○	○	○	A	A	○	
	2 → 1	○	○	A	A	A	A	A	○	○	○	○	○	○	A	A	○	
Margin	Book	○	○	○	○	○	○	○	A	○	○	○	○	○	A	A	○	
	Edge	○	○	○	○	○	○	○	○	A	○	○	○	○	A	A	○	
	Margin	○	○	○	○	○	○	○	○	○	A	○	○	○	A	A	○	
SORT	Non-Sort	○	○	○	○	○	○	○	○	○	○	A	A	A	A	A	○	
	Sort	○	○	○	○	○	○	○	○	○	○	A	A	A	A	A	○	
	Sort-Rotate	○	○	○	○	○	○	○	○	○	○	A	A	A	A	A	○	
Other Functions	Manual Skyshot	○	×	×	A	A	A	A	○	○	○	-	-	-	A	A	×	
	Interrupt	○	×	○	×	×	×	×	○	○	○	-	-	-	×	×	×	

○ : Possible Combined Functions.

× : Unavailable Combined Functions.

A : Next Selection is Carried Out.

- : Indicates that SORT mode cannot be used. Non-sort operation is carried out.

# Function

## ■ Using Function Modes to Change the Initial Copy Modes

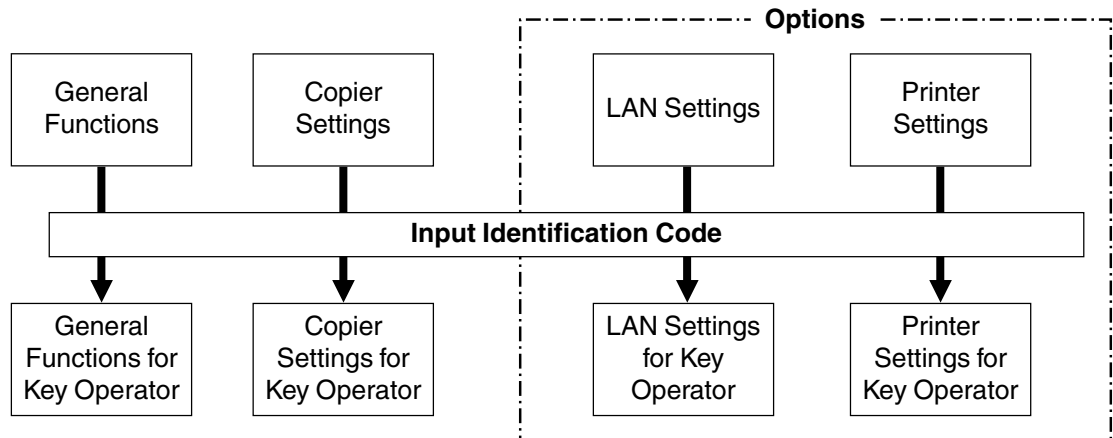

## ■ Procedure

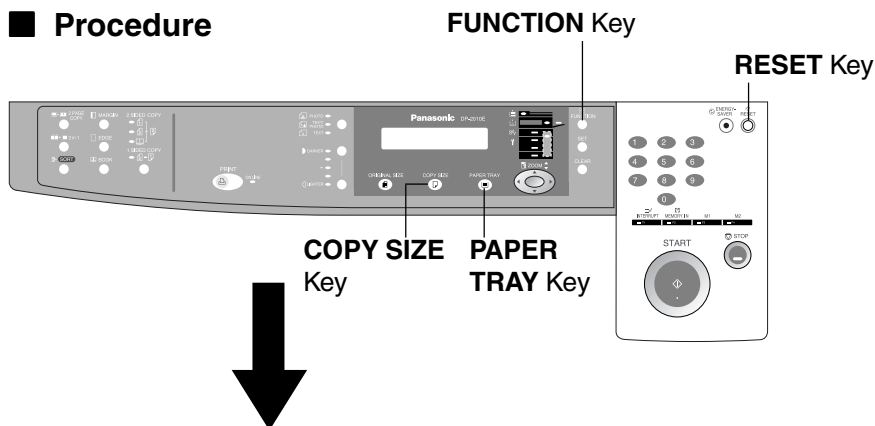

FUNCTION MODE (1-2)  
ENTER NO. OR ▼ ▲

- ① Press the **FUNCTION** Key
- ② Press **1** (GENERAL FUNCTIONS) or **2** (COPIER SETTINGS) key. You may also use the (▼ or ▲) keys.
- ③ Press the **SET** key.
- ④ Press the **Keypad** to select function modes or use the (▼ or ▲) keys.
- ⑤ Follow the on screen instructions.
- ⑥ After setting, press the **SET** key to set up the function.

## ■ Checking the Copier's Total Counter

To display the copier's Total Counter, press the **COPY SIZE** and **PAPER TRAY** keys simultaneously.

### NOTE

- Please refer to each option's operating instructions for function settings.

## General Functions

No.	Modes	Function	Initial Setting
00	SORT MODE DEFAULT	Selects the sort mode. ● NON-SORT, SORT (For DP-1810P/2010E)	NON-SORT
05	SORT MEMORY USAGE	Displays the amount of sort memory used on the panel. ● OFF, DISPLAY (For DP-1810P/2010E)	OFF
06	DEPT. COUNTER	Copy usage and copy limit of the selected department and total copy usage will appear on the screen.	Consult your service technician.
08	SORT-ROTATE DEFAULT	Select Sort-Rotate mode. ● OFF, ON (For DP-1810P/2010E)	OFF
09	KEY OPERATOR MODE	Input the key operator ID code.	

## Function

### Copier Settings

No.	Modes	Function	Initial Setting
00	MARGIN DEFAULT	Selects the margin position and shift value. ● POSITION (Left, Right, Top, Bottom) ● VALUE (5 - 99 mm)	POSITION 10 mm
01	EDGE DEFAULT	Selects the edge mode ( <b>Equal Rate</b> = set the same value for X & Y or <b>Individual</b> = set the value for X & Y individually) and width. ● EQUAL RATE (X & Y), INDIVIDUAL ● 5 - 99 mm	EQUAL RATE 5 mm
02	BOOK MARGIN DEF.	Selects the book Centre Void margin width. ● 5- 99 mm	20 mm
03	FRAME MARGIN	Select the reduction ratio in margin mode. ● INVALID, VALID	INVALID
04	2-SIDED MODE DEF.	Function sets the duplex priority mode. ● OFF, 1 → 2, 2 → 2, Book → 2 (For DP-2010E)	OFF
05	2 in 1 WITH FRAME	Selects whether or not to disable edge deletion. ● INVALID, VALID	INVALID
06	DIGITAL SKYSHOT	Enables or disables the use of skyshot mode. ● OFF, NORMAL, QUALITY	NORMAL
07	MANUAL SKYSHOT	Enables or disables the use of Manual Skyshot. ● OFF; M1 ON; M2 ON; M1, M2 ON	OFF
08	AUTO EXPOSURE	Automatically adjusts the copy density for text and photographic originals. ● INVALID, VALID	VALID
09	1 → 2 BINDING DEF.	Selects the binding location for 1 → 2 Copy. ● LONG EDGE, SHORT EDGE (For DP-2010E)	LONG EDGE
10	2 → 1 BINDING DEF.	Selects the binding location for 2 → 1 Copy. ● LONG EDGE, SHORT EDGE (For DP-2010E)	LONG EDGE
11	BOOK → 2 DEFAULT	Selects the page order and book format for Book → 2 Copy. 1. BOOK FORMAT (1: FACING, 2: FLIPPING) 2. PAGE ORDER (1: L → R, 2: R → L) (For DP-2010E)	FLIPPING L → R
12	2 in 1 DEFAULT	Selects the orientation and layout for 2 in 1 Copy. ● ORIENTATION (Portrait, LANDSCAPE) ● LAYOUT (L → R, R → L)	ORIENTATION L → R
13	2 PAGE MODE DEF.	Selects the 2 page mode. ● L → R, R → L	L → R
14	KEY OPERATOR MODE	Input key operator ID code.	

#### NOTE

- Certain Functions or Parameters are available for selection only when their respective option is installed.

## General Functions for Key Operator

No.	Modes	Function	Initial Setting
00	PAPER SIZE	Sets the paper size of each paper tray. ● Tray-1, Tray-2, Tray-3, Tray-4	Consult your service technician.
01	AUTO RESET TIME	Selects the Control Panel reset time. ● OFF, 30 sec, 1 min., 2 min., 3 min., 4 min.	1 min.
02	ENERGY SAVER MODE	Sets the Energy Saver mode and time. ● INVALID, ENERGY-SAVER, SLEEP Energy save mode timer : 1-120 minutes Sleep mode timer : 1-120 minutes	SLEEP
04	LANGUAGE DEFAULT	Selects the message language of the display. ● A-ENGLISH, C-FRENCH, SPANISH	A-ENGLISH
05	SPECIAL TRAY 1	Sets the paper tray for special paper (ex: coloured). ● NONE, TRAY 1, TRAY 2, BYPASS	NONE
06	SPECIAL TRAY 2	Sets the paper tray for special paper. ● NONE, TRAY 1, TRAY 2, BYPASS	NONE
09	KEY/TOUCH BEEP	Sets the panel touch sound. ● OFF, SOFT, LOUD	SOFT
10	BYPASS SET BEEP	Sets the sound when put paper(s) on bypass tray. ● 1: INVALID 2: VALID	INVALID
11	ORIG. SET BEEP ADF	Sets the sound when put paper(s) on ADF. ● 1: INVALID 2: VALID	VALID
14	DEPT. COUNTER MODE	Monitors copy usage of each department. (1) TOTAL COUNTER (2) DEPT. COUNTER (3) DEPT. COUNTER LIST	Consult your service technician.
15	TOTAL COUNT	Total print out volume from the main unit.	
16	PC PRINT COUNT	Total print out volume from the PC.	
22	TCP/IP ADDRESS	* Sets the IP Address assigned to your machine. ● 3 digit × 4 (Use the MEMORY IN key to enter the "." between each set of 3-digit numbers)	Contact your Network Administrator.
23	TCP/IP SUBNET MSK	* Sets the Subnet Mask. ● 3 digit × 4 (Use the MEMORY IN key to enter the "." between each set of 3-digit numbers)	Contact your Network Administrator.
24	TCP/IP G/W ADDR.	* Sets the Subnet Mask. ● 3 digit × 4 (Use the MEMORY IN key to enter the "." between each set of 3-digit numbers)	Contact your Network Administrator.
25	COPY SETTING LIST	Prints list containing Current Setting and Standard Setting.	

### NOTE

- It is necessary to input the Key Operator ID code before changing items on this page.
- The Special Tray 1 and 2 are not auto-selectable in the switching mode.
- \* Not available for plain copier, but will be available when installing options with advanced functions. (See page 57)

## Function

### Copier Settings for Key Operator

No.	Modes	Function	Initial Setting
01	ORIGINAL (HOME)	Selects original setting ● TEXT, T/P (Text/Photo), PHOTO	T/P (Text/Photo)
02	TEXT CONTRAST	Selects contrast for Text mode ● 1 ~ 5	3
03	T/P CONTRAST	Selects contrast for Text/Photo mode ● 1 ~ 5	3
04	PHOTO CONTRAST	Selects contrast for Photo mode ● 1 ~ 5	3
10	MAX. COPY SETTING	Determines whether to limit number of copies ● 1 ~ 999	999
12	M1, SIZE	Input a size in memory 1 for frequent usage size. ● X: 5~432/Y: 5~297 mm (See page 22)	70 × 160 mm (X) (Y)
13	M2, SIZE	Input a size in memory 2 for frequent usage size. ● X: 5~432/Y: 5~297 mm (See page 22)	95 × 220 mm (X) (Y)
16	MEM. FULL ACTION	Selects the memory full action ● PRINT, CANCEL	Print

#### NOTE

- It is necessary to input the Key Operator ID code before changing items on this page.



## Function Setting

### ■ Changing the Auto Exposure Setting

You can select whether the copying density is adjusted automatically for text and photographic originals.

# 1

Press the **FUNCTION** key.

**FUNCTION** Key

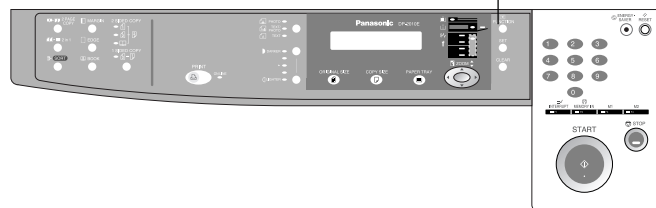

# 2

Proceed as Follows:

```
FUNCTION MODE (1-2)
ENTER NO. OR ∨ ^
```

① Press the **2** key to select COPIER SETTINGS.

```
2:COPIER SETTINGS
PRESS SET TO SELECT
```

② Press the **SET** key.

```
COPIER PARAM. (00-14)
ENTER NO. _ OR ∨ ^
```

③ Press **8** and **SET** key to select AUTO EXPOSURE MODE.

```
08 AUTO EXPOSURE
2:VALID
```

④ Press **1** or **2** key to select whether Auto Exposure is to be carried out or not.

⑤ Press the **SET** key to set up the AUTO EXPOSURE MODE.

⑥ Press the **RESET** key to exit the Function mode.

## Function

### Function Setting for Key Operator

#### ■ Changing the Paper Size

The Paper Trays are designed to accommodate A5, A4, A4 R, FLS/B4 and A3 size paper. To change the paper size, perform the steps shown below.

# 1

Press the **FUNCTION** key.

**FUNCTION** Key

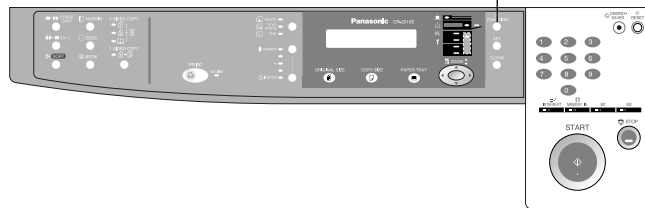

# 2

Proceed as Follows:

```
FUNCTION MODE (1-2)
ENTER NO. OR v ^
```

① Press the **1** key to select GENERAL FUNCTIONS.

```
1:GENERAL FUNCTIONS
PRESS SET TO SELECT
```

② Press the **SET** key.

```
GENERAL PARAM. (0-9)
ENTER NO. _ OR v ^
```

③ Press **9** key.

```
09 KEY OPERATOR MODE
ENTER PASSWORD=- ■ ■
```

④ Input the Key Operator ID code (3 digit) and the **SET** key.

```
KEY OPR. MODE (00-25)
ENTER NO. _ OR v ^
```

⑤ Press **00** and **1** or **2** key to select the PAPER SIZE.

```
00 PAPER SIZE
1:TRAY-1 [A3□]
```

⑥ Press **SET** to select the paper tray and press (**▼** or **▲**) keys to set the paper size. Paper size changes are as follows.



⑦ Press the **SET** key to set up the PAPER SIZE.

⑧ Press the **RESET** key to exit the Function mode.

## Function Setting for Key Operator

# 3

## Changing the Paper Guide and Paper Size Indicator in the Paper Tray

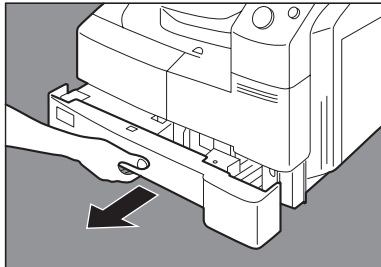

- ① Pull the Paper Tray out and remove paper.

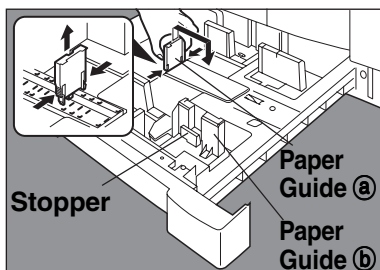

- ② Adjust the paper guide (a) to the required paper length.

- ③ Adjust the Paper Guide (b) to the required paper width. Pinch the stopper to move the Paper Guide (b).

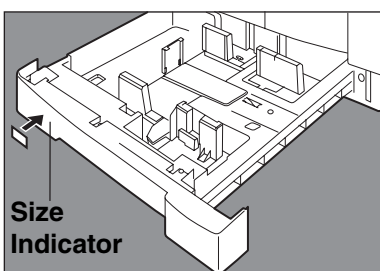
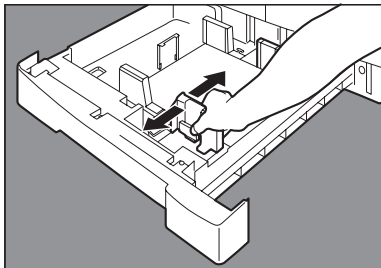

- ④ Change the Paper Size Indicator.

- ⑤ Close the Paper Tray.

### NOTE

- It is recommended that the paper guide (b) be fixed in place with screws. Consult an authorised servicing dealer for details on how to fasten with screws.

## Function

### Function Setting for Key Operator

#### ■ Department Counter

The Key Operator can manage, limit copies, counters and code numbers for each department.  
(Maximum department counters: 50)

# 1

Press the **FUNCTION** key.

**FUNCTION** Key

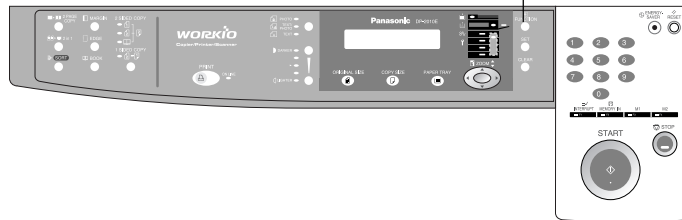

# 2

Proceed as Follows:

```
FUNCTION MODE (1-2)
ENTER NO. OR v ^
```

① Press the **1** key to select GENERAL FUNCTIONS.

```
1: GENERAL FUNCTIONS
PRESS SET TO SELECT
```

② Press the **SET** key.

```
GENERAL PARAM. (0-9)
ENTER NO. _ OR v ^
```

③ Press **9** key.

```
09 KEY OPERATOR MODE
ENTER PASSWORD=- ■ ■
```

④ Press the Key Operator ID code (3 digit) and **SET** key.

```
KEY OPR. MODE (00-25)
ENTER NO. _ OR v ^
```

⑤ Press **14** and the **SET** key to select DEPT. COUNTER MODE.

#### NOTE

- To reset the function mode, press the **RESET** key.
- Contact your authorised servicing dealer to enable the Department Counter feature.

## Function Setting for Key Operator

### 3

#### Select the Department Counter Mode.

```
DEPT. COUNTER MODE
1: TOTAL COUNTER
```

```
DEPT. CODE (01-50)
ENTER NO. OR v ^
```

Press **2** and the **SET** key.

### 4

#### Change the Department ID Code, limit the maximum number of copies and Department Counter number.

```
ID CODE
01:1234
```

- ① Press the **Keypad** and the **SET** key to input the Department ID Code.

```
01: 1234 ← Department ID Code
  ↑
  Department No.
```

```
MAX COPIES
01:123456
```

- ② Press the **Keypad** and the **SET** key to input the maximum number of copies.

```
01: 123456 ← Maximun number of copies (6 digits)
  ↑
  Department No.
```

```
DEPT. COUNTER
01:123456
```

- ③ Press the **Keypad** and the **SET** key (**▼** or **▲** keys) to select the Department No.

```
01: 123456 ← Counter (6 digits)
  ↑
  Department No.
```

- ④ Press **0** and the **SET** key (Input "0") to clear the counter.

#### NOTE

- To reset the function mode, press the **RESET** key.

memo

# Accessories

## Components

### i-ADF (Inverting Automatic Document Feeder)

(DA-AR201)

- Feeds original automatically
- Duplexing
- 2:1 Copy
- 2 in 1 Copy

### ADF (Automatic Document Feeder)

(DA-AS180)

- Feeds originals automatically.
- 2 in 1 Copy

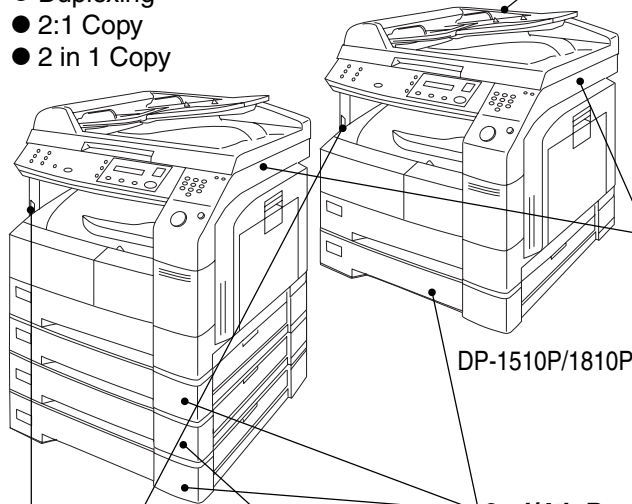

### Image Memory

(DA-SM08B/SM16B/SM64B/SM28B)

- 8/16/64/128 MB
- To increase the memory capacity for electronic sorting and sort printing. (For DP-1810P/2010E)
- To increase the memory capacity for sort printing. (For DP-1510P)

DP-1510P/1810P

### 2nd/4th Paper Feed Module

(DA-DS182)

- To increase the paper feed sources and capacity.  
Paper Feed Module × 1 (550 sheets)

DP-2010E

### 3rd Paper Feed Module

(DA-DS183)

- To increase the paper feed sources and capacity.  
Paper Feed Module × 1 (550 sheets)

### PCL6 Emulation Kit

(DA-PC210)

- Printer Controller for PCL6\*

### 10/100 Ethernet Interface/

### Internet Fax Kit

(DA-NE200)

- Network Interface Board

## NOTE

\* PCL6 is a Page Description Language of the Hewlett-Packard Company.

- The table below shows the options which are required for various functions.
- Contact your authorized servicing dealer for details on combinations of options.

Function	2-ORIGINAL COPY ▶						Margin			SORT		Other Functions	
	Zoom Copy	2 in 1 Copy	2 Page Copy	1 ↑ 2	2 ↑ 2	Book ↑ 2	2 ↑ 1	Book	Edge	Margin	Non-Sort		Sort
ADF		<input type="radio"/>											
i-ADF		<input type="radio"/>		<input type="radio"/>	<input type="radio"/>		<input type="radio"/>						<input type="radio"/>

○:Required

## Accessories

### Automatic Document Feeder

#### ■ ADF (DA-AS180) / i-ADF (DA-AR201)

##### 1. Features

###### ① Automatic Original Feeding

- The ADF/i-ADF tray can hold up to 50 A4 size originals of 80 g/m<sup>2</sup> paper (up to 30 FLS/B4 or A3 size originals). It can accommodate from A5 to A3 size originals.
- Automatic original size detection.

###### ② 2 in 1 Copy

- To make a 1-Sided copy (full size or reduction), from two 1-Sided originals side-by-side.

###### ③ Duplex Copying (DA-AR201)

- The i-ADF allows you to copy 2-sided originals either manually or automatically.

##### 2. Components

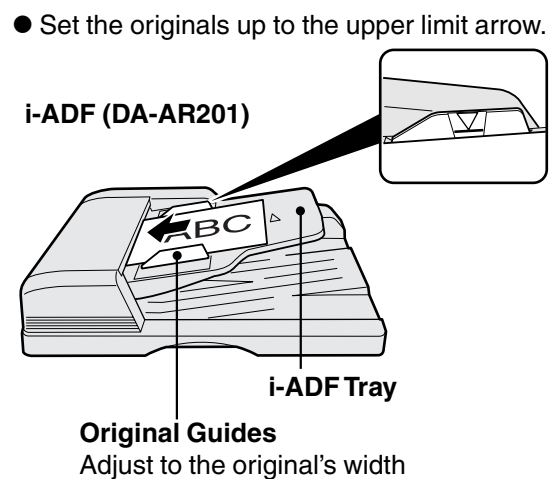
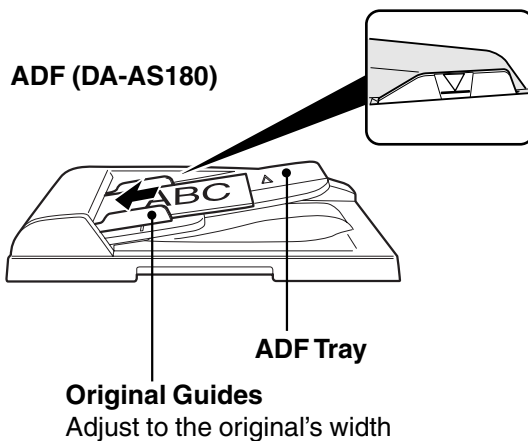



## 3. Operation

### ■ Operation Procedure

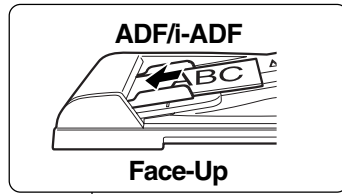

1

Place the  
Original

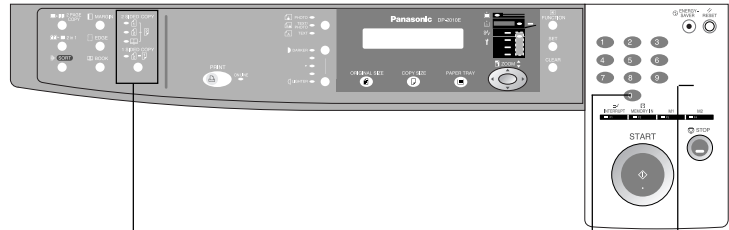
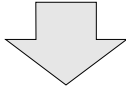

(2)

For Duplex Copy  
(If required)

3 4

Number of  
Copies      Press  
**START**

#### Inappropriate Originals

- Paper with a smooth surface such as glossy and coated papers
- Transparencies
- Originals with a lead edge that is "creased", "folded", "punched" or "glued"
- Paste-ups
- Pressure sensitive or carbon backed papers
- Paper with excessive curl
- Stapled originals
- Freshly printed copies from a laser printer

#### NOTE

- To copy these kinds of originals, use the Platen Glass instead.

# Problem Solving

## Adding Paper (📄)

### ■ 550-Sheet Paper Tray

1

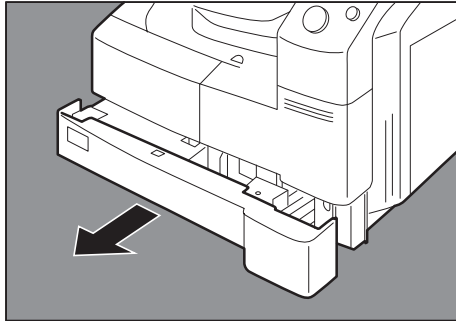

Pull the Paper Tray out.

2

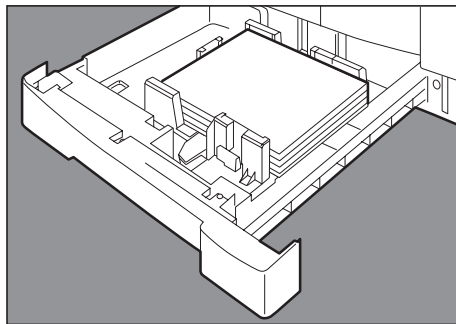

Place the paper with the copying surface facing upward.  
Special papers, like glossy paper, mailing labels and transparencies cannot be used in the paper tray.  
Use the Sheet Bypass for special paper.

3

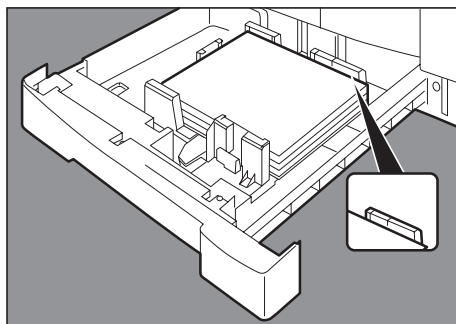

Make sure paper is not loaded above the overfill indicator located in the Paper Tray.

4

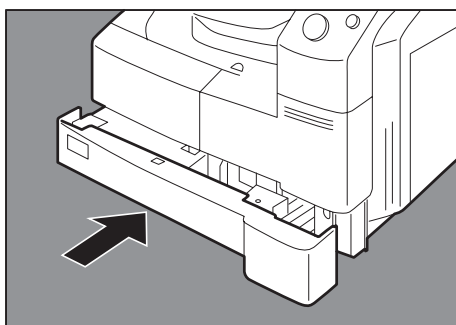

Firmly push the Paper Tray back into the copier.

#### ATTENTION

- Do not use paper with folds or wrinkles. Refer to page 35 for details on adjusting the paper tray size.
- Unused paper should always be placed into a bag and the opening should be sealed for storage. If the paper is left exposed, problems such as paper curl, paper jams, wrinkles or loss of copied image quality may occur.

Adding the Toner and Replacing Waste Toner Container (🗑️)

1

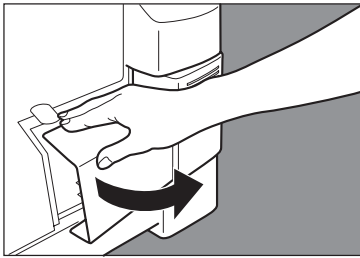

Open the Front Cover.

2

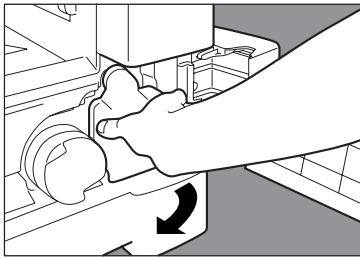

Remove the Waste Toner Container by slowly pulling it towards the left as illustrated.

3

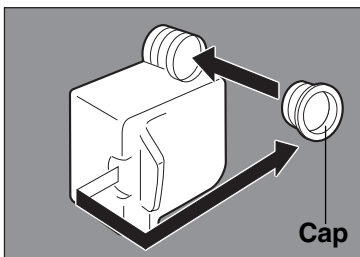

Seal the container with the enclosed cap and dispose of it properly.

4

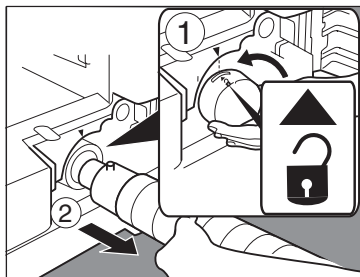

① Turn the empty Toner Bottle counter-clockwise until it stops. The Arrow mark (**Unlocked** symbol 🗝️) visible on the end of the Toner Bottle is aligned with the Arrow mark on the machine.

**Note:** To prevent toner spill, ensure that the key is facing upwards before removing the toner bottle.

② Pull the empty Toner Bottle out.

**Note:** If the bottle will not pull out from the machine, turn the bottle slightly in either direction to release the key and try it again.

Continued on the next page...

**ATTENTION**

- For optimum copy quality use the recommended Panasonic toner. Store toner in a cool dark place. Do not unseal toner before use. Use it as fast as possible after unsealing.
- When U13 is displayed the Add Toner Warning Indicator will begin to flash. This message is to prompt you that the toner bottle is nearly empty (approx. 300-sheets can be printed). This message will continue to be displayed until the bottle is replaced. When the count-down counter reaches 0, the copier will stop operating. To clear the message and enable the copier to operate, replace the empty toner bottle with a new one.

## Problem Solving

### Adding the Toner and Replacing Waste Toner Container (🗑️)

5

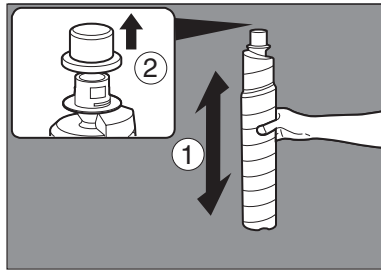

① Shake the new Toner Bottle four or five times to loosen the contents.

② Remove the cap from the Toner Bottle.

6

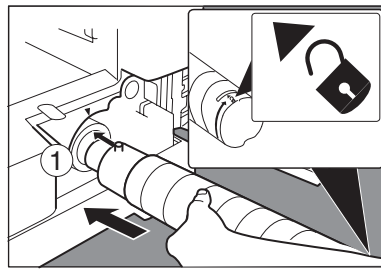

① Align the Key of the bottle, also represented by the Arrow mark (**Unlocked** symbol 🗝️) visible on the end of the Toner Bottle with the Arrow mark on the machine.

**Note:** To prevent toner spill, ensure that the key is facing upwards before installing the bottle.

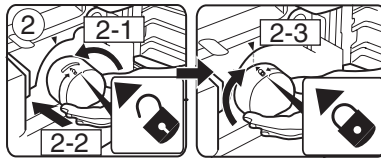

② Insert the bottle as far as it will go, then turn it clockwise (160°, approx. 1/2 turn) until it locks (**Locked** symbol 🗝️).

**Note:** If the bottle is not inserted all the way into the machine as illustrated, turn the bottle slightly in either direction to engage the key and try it again.

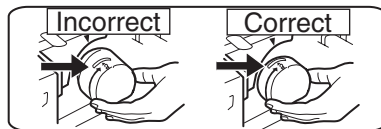

7

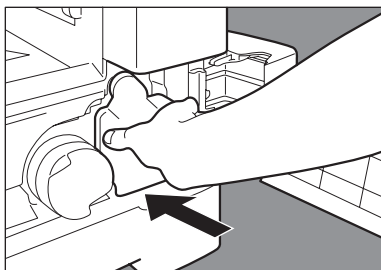

Install a new Waste Toner Container.

8

Close the Front Cover.

#### ATTENTION

- Do not reuse the toner from the Waste Toner Container.

## Removing a Misfed Paper

### ■ Paper Misfeed Indicators and Locations

When a paper misfeed occurs, the misfeed indicator and the misfeed location(s) will be displayed on the panel display.

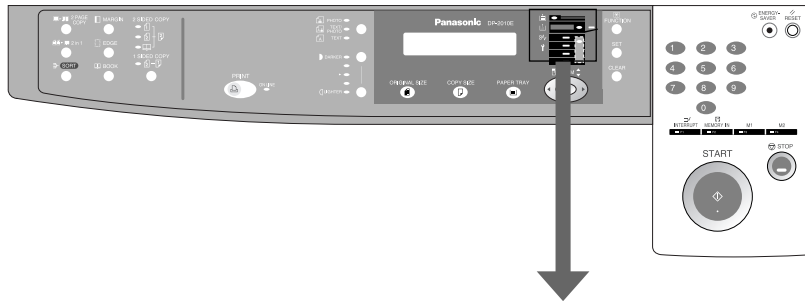

 Misfeed Indicator

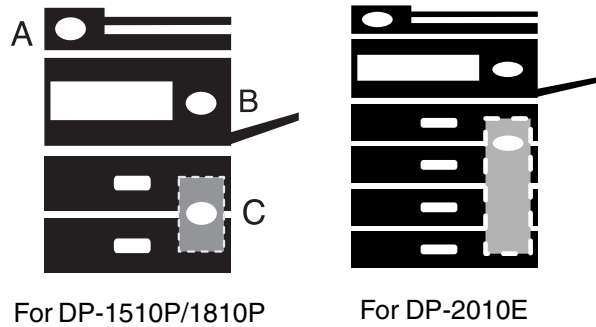

### Paper Misfeed Locations

- A: ADF (see page 51), i-ADF(see page 50) (J70, J71)
- B: Copier (Paper Exit, Paper Entry/Transport, ADU) areas (see page 46-48) (J51 - J59, J80)
- C: Paper Feed Module (see page 49) (J00 - J50, J81-J89)

#### NOTE

- Make sure that the misfeed indicator goes off after removing the misfed paper.
- The misfeed indicator will not go off if the paper is still jammed in the copier. Check again and remove all misfed paper.



## Problem Solving

### Removing a Misfed Paper

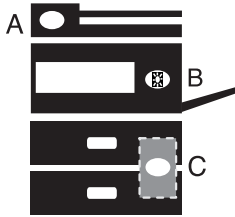

For DP-1510P/1810P

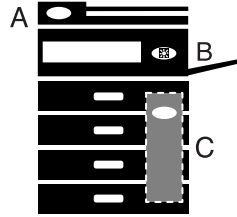

For DP-2010E

#### ■ Paper Exit Area

- Make sure that the misfeed indicator goes off after removing all misfed paper.

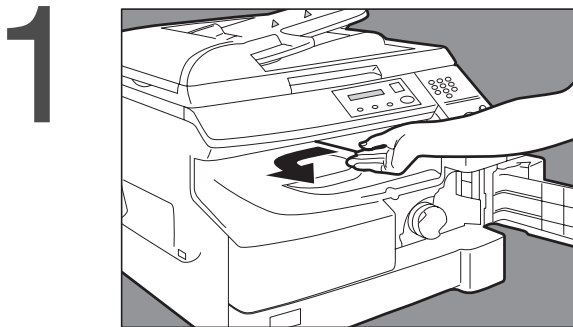

Remove the misfed paper.

#### ATTENTION

- Make sure that the misfeed indicator goes off after removing all misfed paper.

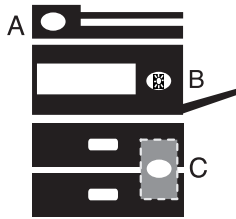

For DP-1510P/1810P

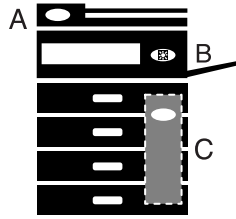

For DP-2010E

## ■ Paper Entry/Transport Area

- Make sure that the misfeed indicator goes off after removing all misfed paper.

# 1

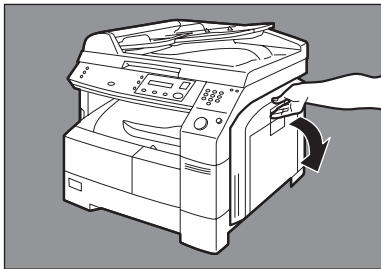

Open the Right Cover.

# 2

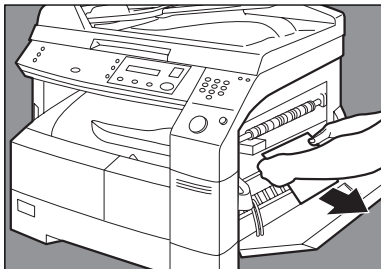

Remove the misfed paper.

# 3

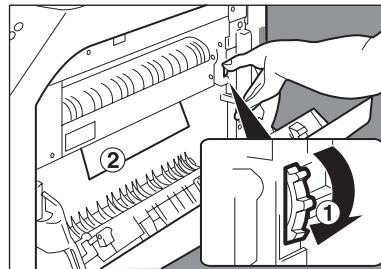

If copy paper is fed far into the copier:

- ① Turn the right paper clearing knob.
- ② Remove the misfed paper.

# 4

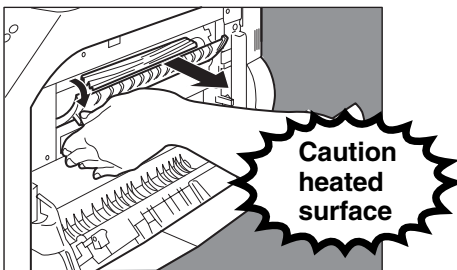

- ① Open the Heat Roller Cover.
- ② Remove the misfed paper.
- ③ Close the Right Cover.

**Caution: This fuser area may be hot.**

### ATTENTION

- Make sure that the misfeed indicator goes off after removing all misfed paper.

## Problem Solving

### Removing a Misfed Paper

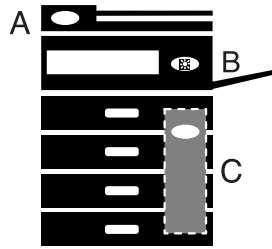

#### ■ ADU Area (For DP-2010E only)

- Make sure that the misfeed indicator goes off after removing all misfed paper.

1

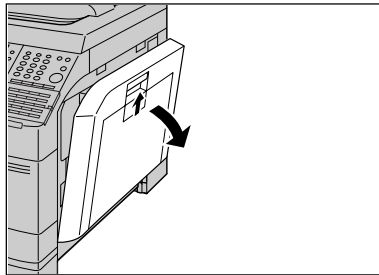

Open the Right Cover.

2

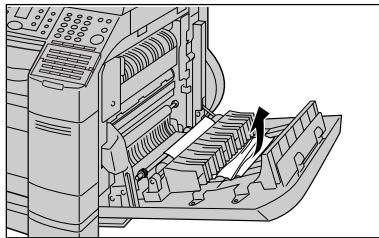

Remove the misfed paper.

3

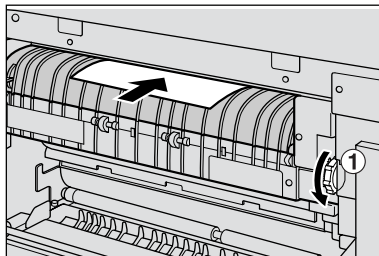

If copy paper is fed far into the copier;  
① Turn the right paper clearing knob.

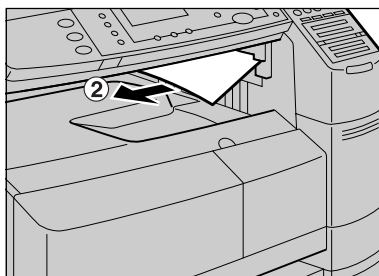

② Remove the misfed paper.

4

Close the Right Cover.



## Problem Solving

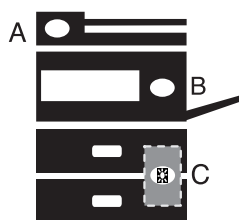

For DP-1510P/1810P

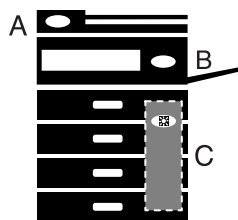

For DP-2010E

### ■ Paper Feed Module

- Make sure that the misfeed indicator goes off after removing all misfed paper.

# 1

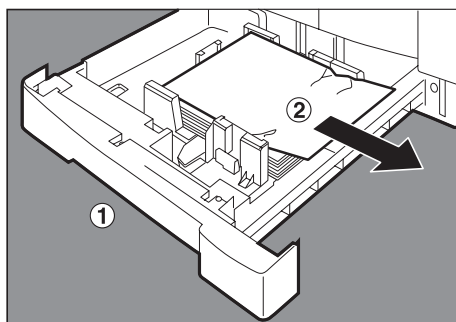

- ① Pull the paper tray out.
- ② Remove the misfed paper.
- ③ Return the Paper Tray to the original position.

# 2

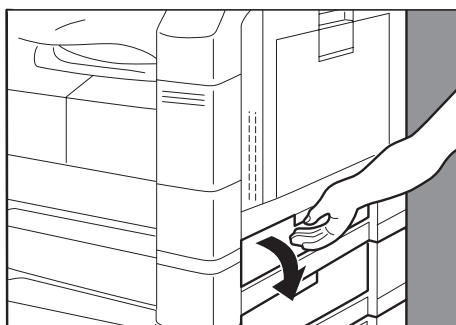

- ① Open the Feed Cover.
- ② Remove the misfed paper.
- ③ Close the Feed Cover.

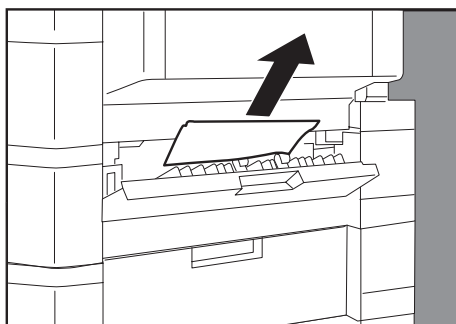

### ATTENTION

- Make sure that the misfeed indicator goes off after removing all misfed paper.

## Problem Solving

### Removing a Misfed Paper

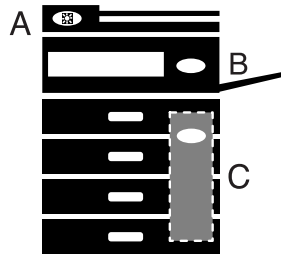

#### ■ i-ADF (For DP-2010E only)

- Make sure that the misfeed indicator goes off after removing all misfed paper.

1

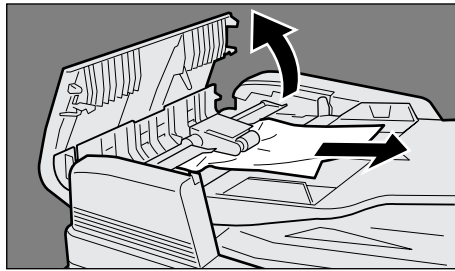

- ① Open the Entry Cover.
- ② Remove the misfed paper.
- ③ Close the Entry Cover.

2

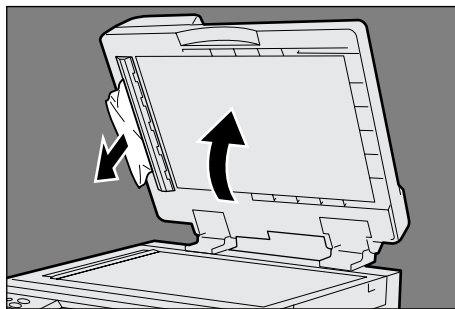

- ① Open the ADF Cover.
- ② Remove the misfed paper.
- ③ Close the ADF Cover.
- ④ Open and close the Entry Cover to reset the error.

3

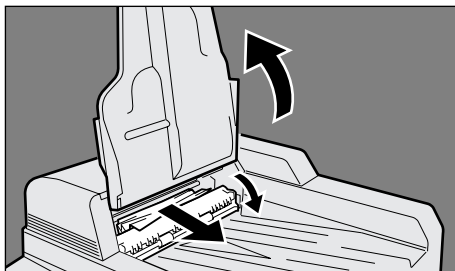

- ① Lift up the ADF Input Tray.
- ② Open the ADF exit cover.
- ③ Remove the misfed paper.
- ④ Close the ADF exit cover.
- ⑤ Close the ADF Input Tray.

#### ATTENTION

- Push the tab  on the centre of the Entry Cover to close it.
- To prevent original(s) damage, please make sure to open the ADF Cover before removing misfed original(s).

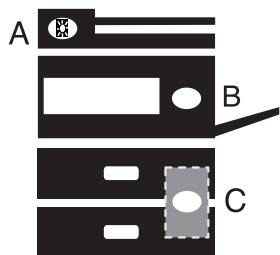

For DP-1510P/1810P

## ■ ADF

- Make sure that the misfeed indicator goes off after removing all misfed paper.

# 1

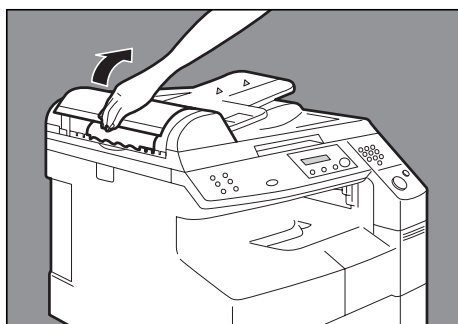

- ① Open the Entry Cover.
- ② Remove the misfed paper.
- ③ Close the Entry Cover.

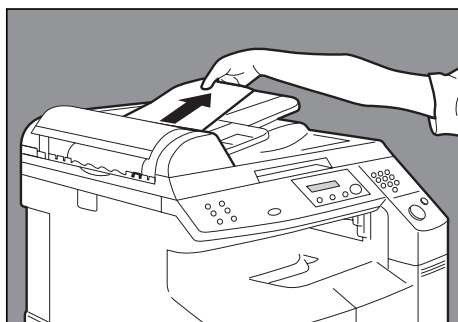

# 2

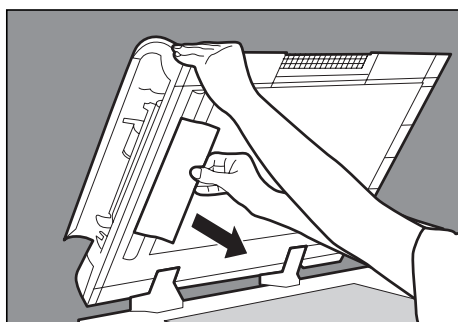

- ① Open the ADF Cover.
- Note:** To prevent damaging the originals, open the ADF Cover before removing the misfed original(s).
- ② Remove the misfed paper.
  - ③ Close the ADF Cover.
  - ④ Close the ADF.

### ATTENTION

- To prevent original(s) damage, please make sure to open the ADF Cover before removing misfed original(s).

# Troubleshooting

## Before Calling Service

Check	Action
<b>Unit Does Not Operate</b>	
Does the display light? ↓ (No)	➔ Check if the Power Switch is turned On and that the power cord is connected into the outlet. (Yes)
Does the Energy Saver key flash (or light) and displays are turned OFF? (See page 24) ↓ (No)	➔ Press Energy Saver key on the Control Panel. (Yes)
Does any of the U## codes and messages appear on the display? (U01, U07, U13, U14, U20 and U21) (See page 54) ↓ (No)	➔ Perform actions in accordance with each message. (Yes)
Does the add paper indicator and message appear on the display? (📄)* ↓ (No)	➔ Add paper. (See page 42) (Yes)
Does the paper misfeed indicator and message appear on the display? (8V) ↓ (No)	➔ Remove the misfed paper. (See page 45) (Yes)
Does E### indicator and message appear on the display?	➔ Turn the copier Off, then On. If the Error Code does not clear, call for service. (Yes)

When the Add Toner Warning Indicator begins to flash\* or is lit, replace the toner bottle with a new one. After this warning is activated, machine operation will begin with the Toner Charging Mode (approximately 3 minutes to complete) each time the power switch is turned Off then On or if the Front/Right Cover is opened and then closed.

**Note:** \*When the warning indicator starts flashing, a 300-sheet count-down counter is activated, and upon reaching 0 the machine will stop operating. The 300-sheet counter is based on 6 % fill, depending on the density some pages may print Blank.

Machine operation and displays are as follows:

1. When turning the power switch to On or opening and then closing the Front/Right Cover, the machine starts to warm-up and the LCD displays:

PLEASE WAIT...

2. The Toner Charging Mode starts and the LCD displays:

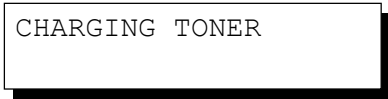

**Add Toner Warning Indicator:**

- Flashing = Toner Bottle is nearly empty
- Lit = Toner Bottle is empty

3. This message is displayed for approximately 200 seconds.



\* Each "■" is approximately 10 sec.

4. This message will continue to be displayed until the warm-up cycle is completed, and if the toner bottle was replaced. Upon completion, the Add Toner Warning Indicator automatically turns Off.

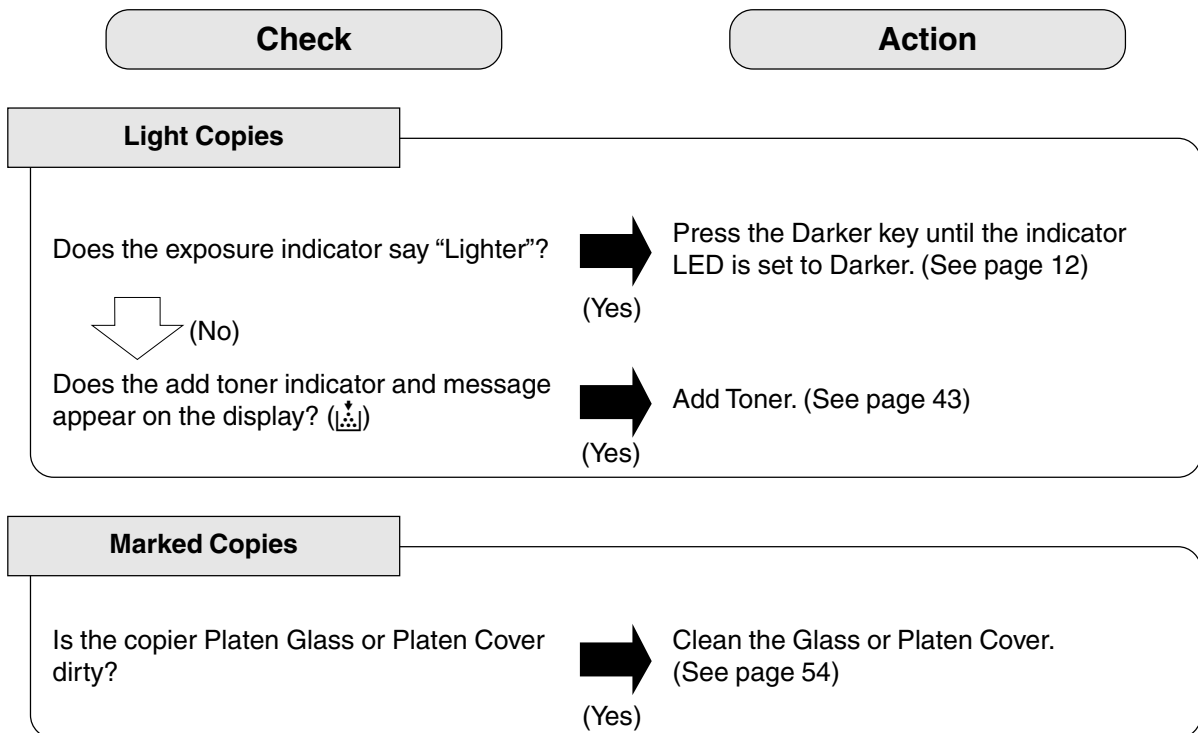

## Troubleshooting

### User Error Codes (U Code)

The self-diagnostic functions detect troubles in the important components of the copier. When any trouble occurs, the copier stops.

Code	Display Message	Check Points
U01	CLOSE FRONT/RT COVER	Front Cover is open.
U07	CLOSE FEED COVER	Feed Cover is open.
U13	TONER IS RUNNING LOW NO WASTE TONER BOX	1. Toner Cartridge is incorrectly installed. 2. Low Toner or No Toner Waste Container.
U14	WASTE TONER BOX IS FULL	1. Toner Waste Container is incorrectly installed. 2. Toner Waste Container is full of toner.
U20	CLOSE ADF COVER	ADF Cover is open.
U21	CLOSE PLATEN COVER	While the copier is initializing, the ADF Cover was opened. (Optional ADF installed)

■ If the measures outlined above do not solve the problem, call your Service provider.

### Copier Care

■ As a rule, clean weekly.

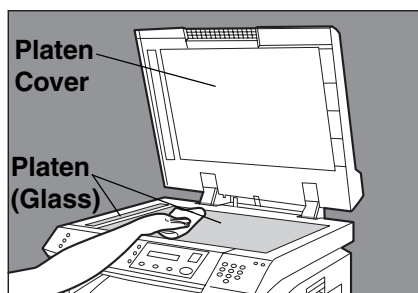

Platen/Platen Cover

- ① Wipe marks off with a cloth and a neutral detergent.
- ② Wipe again with a dry cloth.

# Specifications

## ■ DP-1510P/1810P/2010E (Copier)

<b>Type</b>	Desktop
<b>Platen Type</b>	Fixed
<b>Acceptable Originals</b>	Sheets, Books (max. A3)
<b>Copying Method</b>	Laser Electrophotography
<b>Fixing Method</b>	Heat Roller Fixing
<b>Imaging Method</b>	Dry-Type Single component imaging
<b>Resolution</b>	Max. 600 dpi
<b>Maximum Copy Size</b>	A3
<b>Void Area</b>	Max. 5 mm
<b>Warm Up Time</b>	Approx. 30 seconds (20°C)
<b>First Copy Time</b>	Approx. 6.5 seconds (A4 <input type="checkbox"/> , from 1st tray)
<b>Multi-Copy Speed</b>	DP-1510P : 15 cpm (A4 size) DP-1810P : 18 cpm (A4 size) DP-2010E : 20 cpm (A4 size)
<b>Enlargement Ratios</b>	Preset: 115 %, 122 %, 141 %, 173 %, 200 % Variable: from 101 to 200 % in 1 % increments
<b>Reduction Ratios</b>	Preset: 87 %, 82 %, 71 %, 58 %, 50 % Variable: from 99 to 50 % in 1 % increments
<b>Paper Feed</b>	Paper Tray (550 sheets × 1) + Sheet Bypass (50 sheets) 2nd Paper Feed Module (550 sheets - option) 3rd Paper Feed Module (550 sheets - option) 4th Paper Feed Module (550 sheets - option)
<b>Paper Weight</b>	Paper Tray: 60 - 90 g/m <sup>2</sup> (Sheet Bypass: 56 - 128 g/m <sup>2</sup> )
<b>Quantity Selector</b>	Max. 999 sheets (Output Tray capacity is 250 sheets)
<b>Electrical Consumption</b>	AC 220 - 224 V, 50/60 Hz, 6.0 A
<b>Energy Consumption</b>	Max. 1.2 kW, 2.2 Wh in Sleep Mode
<b>Dimensions (W × D × H)</b>	DP-1510P/1810P: 588 × 605 × 458 mm DP-2010E: 588 × 605 × 458 mm
<b>Weight</b>	DP-1510P/1810P: 41 kg DP-2010E: 42 kg
<b>Operating Environment</b>	Temperature: 10 - 35°C Relative Humidity: 45 - 85 % (However, the humidity should be 70 % or less at a temperature of 30°C, and the temperature should be 30°C or less at a humidity level of 85 %.)

- Specifications are subject to change without notice.

## Specifications

### ■ ADF (DA-AS180)

	<b>DA-AS180</b>
<b>Tray Capacity</b>	A4, A5: 50 sheets (70 g/m <sup>2</sup> ) FLS/B4, A3: 30 sheets (70 g/m <sup>2</sup> )
<b>Paper Size</b>	A5/A4/FLS/B4/A3
<b>Paper Weight</b>	50 – 110 g/m <sup>2</sup>
<b>Electrical Requirements</b>	Supplied from the copier
<b>Dimensions (W × D × H)</b>	558 × 501 × 112 mm
<b>Weight</b>	5.0 kg

### ■ i-ADF (DA-AR201)

	<b>DA-AR201</b>
<b>Tray Capacity</b>	A4, A5: 50 sheets (70 g/m <sup>2</sup> ) FLS/B4, A3: 30 sheets (70 g/m <sup>2</sup> )
<b>Paper Size</b>	A5/A4/FLS/B4/A3
<b>Paper Weight</b>	50 – 110 g/m <sup>2</sup>
<b>Electrical Requirements</b>	Supplied from the copier
<b>Dimensions (W × D × H)</b>	552 × 520 × 135 mm
<b>Weight</b>	9.3 kg

### ■ 2nd/4th Paper Feed Module (DA-DS182)

	<b>DA-DS182</b>
<b>Paper Size</b>	A5/A4/FLS/B4/A3
<b>Paper Weight</b>	60 – 90 g/m <sup>2</sup>
<b>Electrical Requirements</b>	Supplied from the copier
<b>Dimensions (W × D × H)</b>	550 × 155 × 585 mm
<b>Weight</b>	9.5 kg

### ■ 3rd Paper Feed Module (DA-DS183)

	<b>DA-DS183</b>
<b>Paper Size</b>	A5/A4/FLS/B4/A3
<b>Paper Weight</b>	60 – 90 g/m <sup>2</sup>
<b>Electrical Requirements</b>	Supplied from the copier
<b>Dimensions (W × D × H)</b>	550 × 155 × 585 mm
<b>Weight</b>	9.5 kg

- Specifications are subject to change without notice.



# Options and Supplies

■ The DP-1510P/1810P/2010E is a digital photocopier which can produce images with great clarity. Furthermore, its copying functionality can also be greatly enhanced by the addition of the following options and supplies.

We hope you find that the wide ranging capabilities will make your office-place more productive and efficient.

## ■ Options

Part Name	Part No.	Remarks
Automatic Document Feeder	DA-AS180	Also referred as ADF
Inverting Automatic Document Feeder	DA-AR201	Also referred as i-ADF (For DP-2010E only)
2nd/4th Paper Feed Module	DA-DS182	4th Paper Feed Module is for DP-2010E only
3rd Paper Feed Module	DA-DS183	3rd Paper Feed Module is for DP-2010E only
Image Memory (8 MB)	DA-SM8B	For Electronic Sorting and Sort Printing (For DP-1810P/2010E) For Sort Printing (For DP-1510P)
Image Memory (16 MB)	DA-SM16B	For Electronic Sorting and Sort Printing (For DP-1810P/2010E) For Sort Printing (For DP-1510P)
Image Memory (64 MB)	DA-SM64B	For Electronic Sorting and Sort Printing (For DP-1810P/2010E) For Sort Printing (For DP-1510P)
Image Memory (128 MB)	DA-SM28B	For Electronic Sorting and Sort Printing (For DP-1810P/2010E) For Sort Printing (For DP-1510P)

## ■ For Printer

Part Name	Part No.	Remarks
PCL6 Emulation Kit	DA-PC210	Printer Controller for PCL6. (For Network Printing, DA-NE200 is also required)

## ■ For Network Printing

Part Name	Part No.	Remarks
10/100 Ethernet Interface/ Internet Fax Kit	DA-NE200	Network Interface Board

## ■ Supplies

Part Name	Part No.	Remarks
Toner Bottle	DQ-TU10C	Waste Toner Container included

### NOTE

\* PCL6 is a Page Description Language of the Hewlett-Packard Company.

memo

memo

For Service, Call: \_\_\_\_\_

Matsushita Electric Industrial Co., Ltd.  
Osaka 542-8588, Japan

S0602-1062  
DZSD001730-1  
June 2002  
Printed in Japan

## Free Manuals Download Website

<http://myh66.com>

<http://usermanuals.us>

<http://www.somanuals.com>

<http://www.4manuals.cc>

<http://www.manual-lib.com>

<http://www.404manual.com>

<http://www.luxmanual.com>

<http://aubethermostatmanual.com>

Golf course search by state

<http://golfingnear.com>

Email search by domain

<http://emailbydomain.com>

Auto manuals search

<http://auto.somanuals.com>

TV manuals search

<http://tv.somanuals.com>