

Instructions

Camera Adaptor AW-AD700BS for AW-F575 Series

Panasonic®

Before attempting to connect or operate this product, please read these instructions completely.



PREFACE

- The Camera Adaptor AW-AD700BS docks directly to the Color Camera AW-F575 series, making it a standard-alone camera for two-piece recording system applications.
Connection via a VTR cable for several different portable recorder is possible.
- Video Power (VP) Multiplex Operation is available using with the Power Separator WV-PS700.
- Possible to mount a lens having zoom, focus or servo functions.
- Pan/Tilt Control function is provided.

NOTE: Refer to the operating instructions of Color Camera AW-F575 series for details.



CAUTION
RISK OF ELECTRIC SHOCK
DO NOT OPEN



CAUTION:
TO REDUCE THE RISK OF ELECTRIC SHOCK,
DO NOT REMOVE COVER (OR BACK). NO
USER SERVICEABLE PARTS INSIDE.
REFER SERVICING TO QUALIFIED SERVICE
PERSONNEL.



The lightning flash with arrowhead symbol, within an equilateral triangle, is intended to alert the user to the presence of uninsulated "dangerous voltage" within the product's enclosure that may be of sufficient magnitude to constitute a risk of electric shock to persons.



The exclamation point within an equilateral triangle is intended to alert the user to the presence of important operating and maintenance (servicing) instructions in the literature accompanying the appliance.

For U.S.A.

Warning:
This equipment generates and uses radio frequency energy and if not installed and used properly, i.e., in strict accordance with the instruction manual, may cause harmful interference to radio communications. It has been tested and found to comply with the limits for a Class A computing device pursuant to Subpart J of Part 15 of FCC Rules, which are designed to provide reasonable protection against such interference when operated in a commercial environment.

For CANADA

This digital apparatus does not exceed the Class A limits for radio noise emissions from digital apparatus set out in the Radio Interference Regulations of the Canadian Department of Communications.

The serial number of this product may be found on the bottom of the unit.
You should note the serial number of this unit in the space provided and retain this book as a permanent record of your purchase to aid identification in the event of theft.

Model No. _____

Serial No. _____

WARNING:

TO PREVENT FIRE OR ELECTRIC SHOCK HAZARD, DO NOT EXPOSE THIS APPLIANCE TO RAIN OR MOISTURE.

MAJOR OPERATING CONTROLS AND THEIR FUNCTIONS

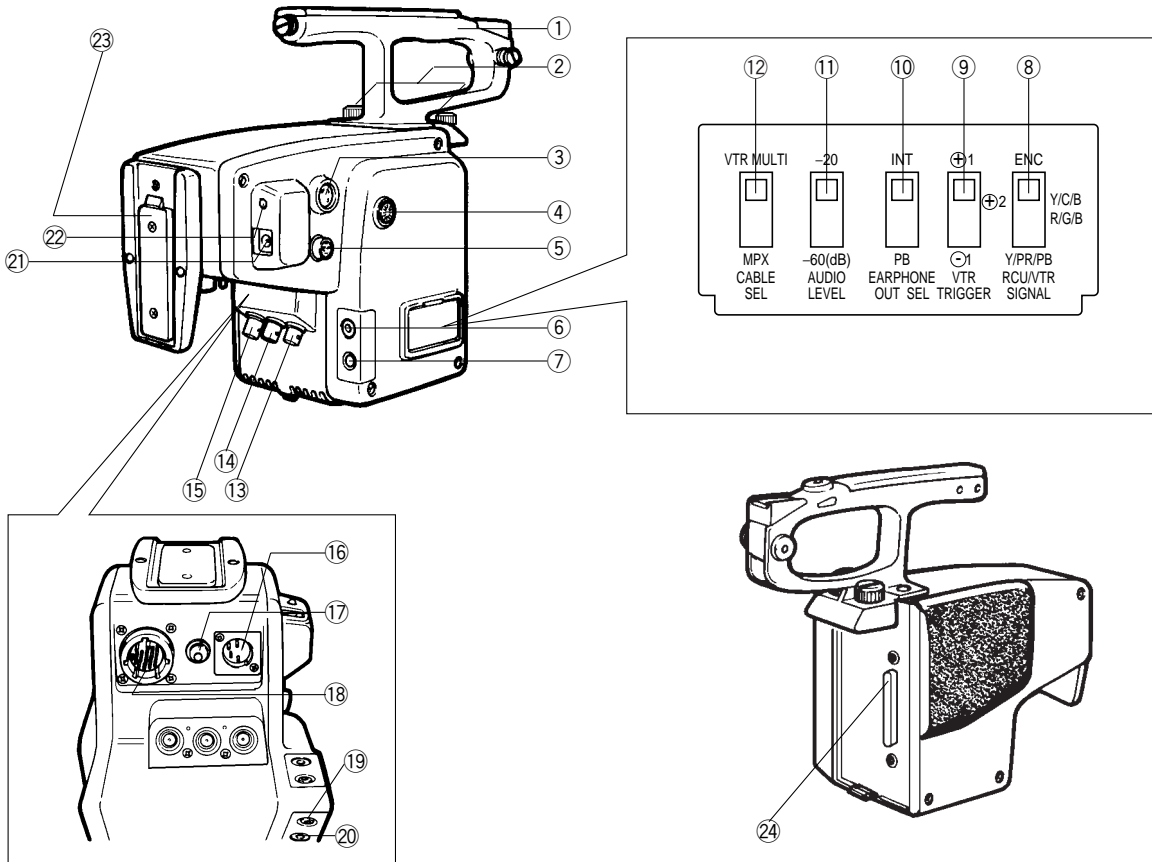

1. Camera Handle

2. Camera Adaptor Holding Screw/knob

The camera adaptor can be removed from the camera after loosening two knobs on top of the adaptor and then pressing the release button underneath of the camera while pulling on rear of camera adaptor.

3. VTR Start/Stop Button (VTR) (parallel operation)

This button is used to change the recorder mode from pause (Recording Pause) to recording and functions in the same way as the VTR Start/Stop Button on the lens. Press once to start recording. While recording, the Tally Indicator in the viewfinder lights and Tally Light on the viewfinder also lights.

When the button is pressed once more, the recorder is set to the Pause mode (Recording Pause), and the Recording/Tally Indicator and Tally Light will go off.

4. Intercom/Earphone Level Control (INCOM EARPHONE)

Use this control to freely adjust the volume level in the earphone connected to the Earphone Jack (7) or the headset connected to the Intercom Jack (6).

5. S-Video Output Connector (S-VIDEO OUT)

The luminance (Y) and chroma (C) signals for S-VHS VTR or monitor are provided at this connector.

6. Intercom Jack (M6) (INCOM)

This jack is used for communication between the camera operator and operators of Remote Control Unit (RCU) and Special Effect Generator in the system.

7. Earphone Jack (M3) (EARPHONE)

When an earphone is connected, the sound picked up by the microphone or the played back audio from a 3/4" U-vision recorder, connected to the camera through the VTR 14-pin camera connector, can be monitored. Selection of the audio source is enabled by the Earphone Out Selection Switch (10).

8. RCU/VTR Signal Selection Switch (RCU/VTR SIGNAL ENC, Y/C/B, R/G/B, Y/PR/PB)

This switch selects the video output signal supplied at the VTR/RCU Connector (18) on the adaptor and the Red, Green and Blue Output Connectors on the Remote Control Unit (RCU). The switch has been set to the R/G/B position at the factory.

ENC:

The composite output signal for the VTR, such as 1/2" VHS or 3/4" U Machic, is supplied.

Y/C/B:

The chrominance (C) and luminance (Y) signals are supplied from the R, G and B Output Connectors for S-VHS format VTR.

R/G/B:

The R, G and B signals are supplied from the R, G and B Output Connector.

Y/PR/PB:

The color difference (R-Y & B-Y) signals and luminance (Y) signal are supplied from the VTR/RCU Connector (18) and the R, G and B Output Connectors on the Remote Control Unit for MII and Betacam format VTRs.

9. VTR Compatibility Switch (⊕1/⊕2/⊖1)

Set this switch according to the VTR which is connected to the camera.

⊕1: For 1/2" VHS VTRs.

⊕2: For 3/4" U-vision VTRs, connected to the camera using a 14-pin connector, S-VHS VTRs and MII portable VTRs.

⊖1: If a VTR of other manufacture is used, and if this VTR pauses when the tape should be running and vice versa, this switch should be set to this position.

Notes:

- 1) The switch has been preset to the ⊕1 position at the factory.
- 2) Some VTRs may not operate properly when connected to this camera, even though the setting of this switch is changed. Please consult your dealer for further information.

10. Earphone Out Selection Switch (INT/PB)

This switch selects the audio signal from the Earphone Jack (7) to be monitored.

INT:

The sound picked up by the microphone can be monitored.

PB:

The played back audio can be monitored.

Note:

The camera has been preset to the INT position at the factory.

11. Audio Level Selection Switch (AUDIO LEVEL -20/-60 dB)

Two audio output levels to the VTR can be selected: -20 dB or -60 dB

The camera has been preset to -20 dB at the factory.

When using this adaptor with WV-RC700A, set this switch to the -20 dB position.

12. Cable Selection Switch (VTR MULTI/MPX)

This switch is used to select either the multi-cable VTR/RCU cable or the single coaxial multiplex cable. When using the multi-cable in the VTR or Remote Control Unit (RCU), set this switch to VTR MULTI position. In case of the multiplex or VP multiplex operation using a coaxial cable, set this switch to MPX position.

Note:

Video Power (VP) Multiplex system: multiplex signal and power are supplied using a single coaxial cable.

13. Video Output Connector (BNC) (VIDEO OUT)

A composite video signal is provided at this connector.

14. Gen-lock input connector (BNC) (GEN-LOCK)

The color video signal of the camera is automatically synchronized to the Gen-lock signal (composite or black burst) which is supplied to this connector. The gen-lock signal is used for system reference, such as when using a Special Effects Generator.

Caution:

If the gen-lock signal is jittery (such as when obtained from VTR playback), the camera may not be able to synchronize properly.

15. Multiplex Signal input Connector (MPX)

Communications between the camera side and the Remote Control Unit (RCU) are available through a single coaxial cable by using this connector as the composite signal, gen-lock signal, control signal and intercom/audio signal are multiplexed, and the composite signal is output from the Remote control Unit (RCU).

16. External DC Input Connector (XLR, 4-pin) (EXT DC)

This connector accepts the power cable from an external DC source supplying nominal power of 12 V, 2 A (a belt type battery or car battery for example). This connector also accepts the power cable from an AC adaptor. For powering the studio configuration, a 12 V DC, 2.5 A power source is required.

Cautions:

Use only with a 12V DC power source with a Class 2 rating. Do not use with an external storage battery unless provided with an 8A rated fuse, located within 5 inches of the battery connecting means.

An external DC source supplied to this connector gets the highest priority, i.e., it is selected before the battery connector or Multicore/VTR/DC source.

17. Circuit Protector (BREAKER)

When excessive current flows into the camera due to some fault, the red button of this circuit protector protrudes to cut off the circuit power. After solving the problem, press the red button again to reset the circuit protector.

Caution:

Refer servicing to qualified service personnel to solve the problem.

18. VTR/RCU Connector (26-pin) (VTR/RCU)

When using the camera together with a Panasonic portable color VTR, the specified VTR Cable should be connected between the camera and VTR. This connector is also used for connection with the 26-pin studio cable from the Remote Control Unit (RCU) for comprehensive system operation. When connecting the 26-pin studio cable to this connector, the camera is automatically set to the Remote Control Unit (RCU) operation mode.

- 1/2" VHS and 3/4" U-vision portable VTR (10-pin)
WV-CA26A10 (26p-10p cable)
- 3/4" U-vision portable VTR (14-pin)
WV-CA26A14 (26p-14p cable)

- MII portable VTR (26-pin)
- WV-CA26A26 (26p-26p cable)
- 26-pin Studio Cable (RCU Cable)
- WV-CA26U15
- WV-CA26U30
- WV-CA26U100

19. Lens Connector

This connector is used to connect the lens cable for zoom, focus or servo control.

20. Control Connector

This connector is used to connect the optional Pan/Tilt Control Cable WV-CA10U25.

21. Battery Connector (BATTERY)

Connect the cord from the Battery Pack to this connector.

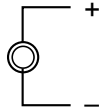

22. Recording/Tally Indicator (red) (REC TALLY)

This indicator lights when the VTR is set to the recording mode (through the VTR Start/Stop Button), and informs the person concerned of scenes being recorded. The Tally indicator also lights when the camera is in full system operation together with the Remote Control Unit and Special Effects Generator. In case a tape is not loaded or the tape end is reached, or if the servo mechanism is working improperly, this indicator will start blinking to warn the operator of such faults.

Note:

If a portable VTR is not connected to the camera, the Recording/Tally Indicator will not light.

23. Battery Pack Mounting Angle

Mount the Battery Pack WV-PS60/WV-PS33, the AC Adaptor/Charger WV-PS34 or Power Separator WV-PS700 on the camera by sliding it down along this mounting angle.

24. 68-pin Multi Connector

When mounting this adaptor, engage the 68-pin connectors on the camera and this connector.

Connector information

■ VTR/RCU Connector (18)

- Pin configuration

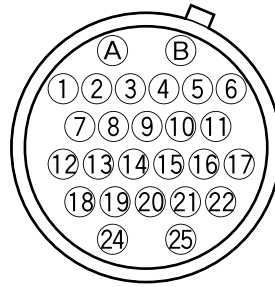

<Front View>

Pin No.		Pin No.	
A	12V IN	12	VTR TRIGGER
B	GND	13	VIDEO IN/OUT
1	ENC (NTSC OUT)	14	INTERCOM MIC
2	GND	15	TALLY WARNING
3	Not used	16	INTERCOM SPEAKER
4	ENC/G/Y/Y	17	GND
5	R/PR (R-Y)/CHROMA	18	PLAYBACK VIDEO
6	SENSING GND	19	GND
7	B/PB (B-Y)/B	20	PLAYBACK AUDIO
8	GND	21	TRANSMIT/RECEIVE
9	AUDIO+	22	BATTERY ALARM
10	AUDIO-	23	GEN-LOCK IN
11	AUDIO GND	24	+12V RETURN

■ Lens Connector (19)

- EPin configuration

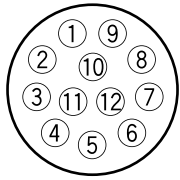

<Front View>

1	Not used
2	Not used
3	GND
4	Not used
5	Not used
6	+12V IN
7	+5V IN
8	FOCUS CONT
9	ZOOM CONT
10	Not used
11	+7.5V IN
12	+2.5V IN

- Control Voltage (each voltage is $\pm 0.5V$.) for the lens.

	Speed	
	Low	High
NEAR	4.0V	2.5V
FAR	6.0V	7.5V
WIDE	4.0V	2.5V
TELE	6.0V	7.5V

■ Pan/Tilt Control Connector (20)

- Pin configuration

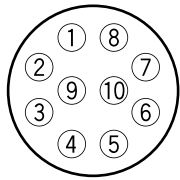

<Front View>

1	GND
2	COM (0V)
3	Not used
4	LEFT
5	RIGHT
6	UP
7	DOWN
8	DEFROSTER
9	WIPER
10	Not used

■ Optional Pan/Tilt Control Cable WV-CA10U25

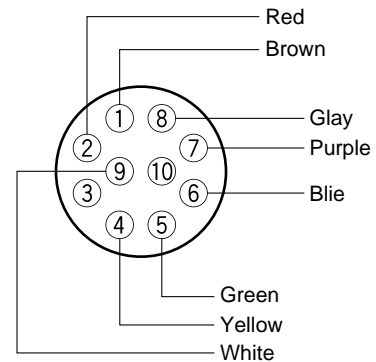

Note:

- Be sure to follow the conditions indicated below.
1. Functions are active at the Low control voltage.
 2. Open Collector Output (Withstand voltage of Transistor is maximum 30 V.)
 3. Current is maximum 20 mA.

Audio System Operation with the optional Remote Control Unit

The audio output to the Remote Control Unit WV-RC700A is available in the VP Multiplex operation.

1. Connect a coaxial cable between the Remote Control Unit WV-RC700A and Power Separator WV-PS700.
2. Connect the Multiplex Output Cable on WV-PS700 to the Multiplex Signal Input Connector (15) on this adaptor.
3. Set the Audio Level Selection Switch (11) to the -20 dB position.
4. Remove four screws from the side cover of this adaptor.
5. Set the Switch 1 on the Audio board inside this adaptor to the AUDIO position.
6. Set the Switch 2 on the MOD board inside the Remote Control Unit WV-RC700A to the AUDIO position.

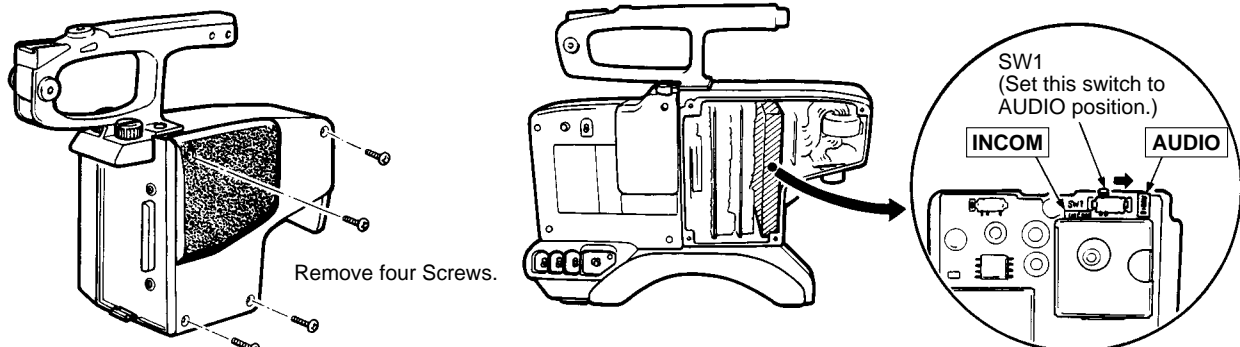

Notes:

1. At this time, the intercommunication system cannot function.
2. The Switch 1 on the Audio board is preset to the INCOM position at the factory.

INSTALLATION

Installation of the Camera Adaptor

1. Mounting the Camera Adaptor

1-1 Mount the Camera Adaptor with Camera Handle to the camera while engaging the 68-pin connector.

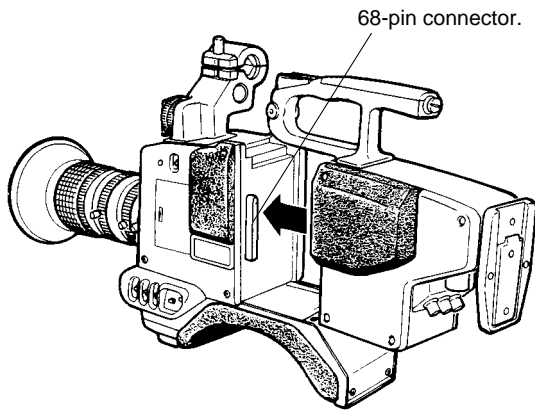

1-2 Tighten two Camera Adaptor Holding Screw/knob (2) firmly and make sure the adaptor is securely fixed to the camera.

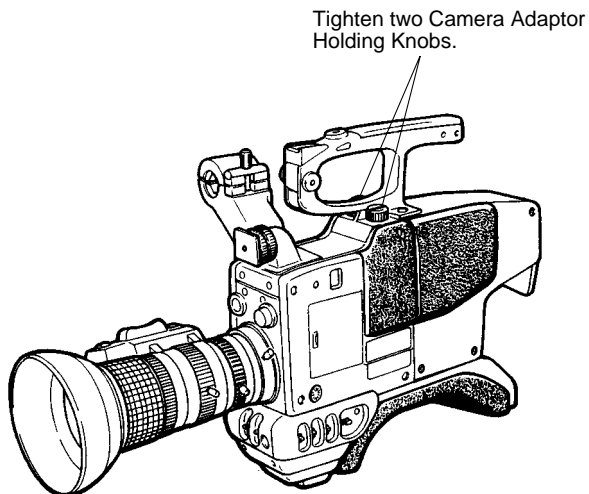

2. Removing the Camera Adaptor

2-1 Loosen two Camera Adaptor Holding Screw/Knob (2) on the Camera Adaptor.

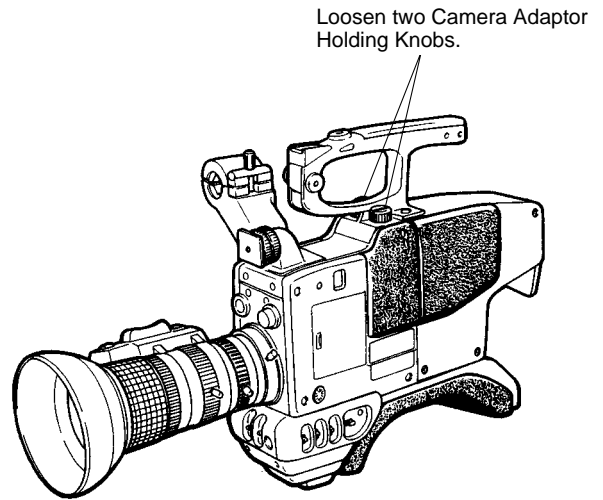

2-2 Remove the Camera Adaptor while pressing up the Release Button underneath the camera.

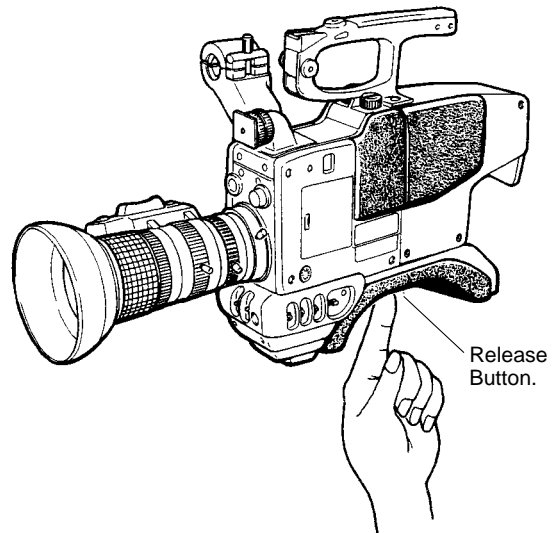

CAUTION:

Mount the Camera Adaptor by sliding it straight and engaging the connectors and lock mechanism in order not to bend the pins of the connector and not to make a short circuit.

SPECIFICATIONS

Camera Docked:	Color camera AW-F575 series connected through 68-pin connector
Gen-lock Input:	NTSC composite (VBS) signal or black burst signal
Video Output:	1.0 V[p-p] NTSC composite/75 Ω (BNC) connector Y/C (S-VIDEO) Output: (S-VIDEO Connector) 0.714 V[p-p] Video Level Luminance (Y) composite/75 Ω 0.286 V[p-p] Burst Level Chrominance/75 Ω VTR/RCU Output (26-pin connector) 1.0 V[p-p] NTSC Composite/75 Ω Composite, Y/C/B, R/G/B, Y/PR/PB Selectable Composite: 1.0 V[p-p] composite/75 Ω R/G/B: 0.714 V[p-p]/75 Ω x 1 each Y/PR/PB: Y: 1.0 V[p-p] (Sync 0.3 V)/75 Ω PR/PB: 0.486 V[p-p] (SMPTE Color bar)/75 Ω Y/C/B: Y: 0.714 V[p-p] Video Level Luminance (Y) composite/75 Ω C: 0.286 V[p-p] Burst Level Chrominance/75 Ω B: 0.7 V[p-p]/75 Ω 1.0 V[p-p] composite/75 Ω through 26-pin VTR/RCU connector
Auxiliary Input:	-20 dBm or -60 dBm/unbalanced, switchable (26-pin VTR/RCU Connector)
Audio Output:	Frequency Multiplex Signal (Composite Video, Gen-lock Video, Remote Control Signal, Intercom/Audio)/75 Ω , N connector
MPX Input/Output:	Zoom, Focus, Servo
Lens Output:	Open Collector
Control Output:	Audio Level Selection, Earphone Out Selection, RCU/VTR Signal Selection, Cable Selection, VTR Compatibility
Switches:	Earphone/Intercom Level
Controls:	12 V DC, 6 sources as follows:
Power Source:	(1) Battery Pack (2) AC Adaptor (3) External DC source through 4-pin DC connector (4) VTR (external AC adaptor) (5) Remote Control Unit through VTR/RCU connector (6) VP Multiplex from RCU
Ambient Operating Temperature:	-10°C - +45°C (14°F - +113°F)
Ambient Operating Humidity:	30% - 90%
Dimensions (without the Camera Handle):	125 (W) x 233 (H) x 299 (D) mm 4-7/8" (W) x 9-3/6" (H) x 11-3/4" (D)
Weight (exclude the Camera Handle):	1.8 kg (4.0 lbs.)

Dimensions and weights are approximate.
Specifications are subject to change without notice.

OPTIONAL ACCESSORY

Pan/Tilt Control Cable WV-CA10U25 (25m)

Panasonic

Broadcast & Television Systems Company

Division of Matsushita Electric Corporation of America

Executive Office: One Panasonic Way 3F-5, Secaucus, NJ 07094

Regional Offices:

EASTERN ZONE: 50 Meadowlands Parkway, Secaucus, NJ 07094 (201) 348-7620

CENTRAL ZONE: 1707 North Randall Road, Elgin, IL 60123 (847) 468-5200

SOUTHERN ZONE:

Atlanta Region: 1225 Northbrook Parkway, Suite 1-160, Suwanee, GA 30024

Panazip 11 (770) 338-6841, fax (770) 338-6741

Law Enforcement Video Products: 1225 Northbrook Parkway, Suite 1-160, Suwanee,

GA 30024, Panazip 11 (770) 338-6844, fax (770) 338-6721

WESTERN ZONE:

Seattle Region: 1200 Westlake Ave., North, Suite 508, Seattle, WA98109 (206) 285-8883

Los Angeles Region: 6550 Katella Ave. 17A-1, Cypress, CA 90630 (714) 373-7271

Government Marketing Department: 52 West Gude Drive, Rockville, MD 20850 (301) 738-3840

PANASONIC CANADA INC.

5770 Ambler Drive, Mississauga, Ontario, L4W 2T3 Canada (905) 624-5010

PANASONIC SALES COMPANY

DIVISION OF MATSUSHITA ELECTRIC OF PUERTO RICO, INC.

San Gabriel Industrial Park, 65th Infantry Ave. KM. 9.5 Carolina, Puerto Rico 00630 (809) 750-4300

Free Manuals Download Website

<http://myh66.com>

<http://usermanuals.us>

<http://www.somanuals.com>

<http://www.4manuals.cc>

<http://www.manual-lib.com>

<http://www.404manual.com>

<http://www.luxmanual.com>

<http://aubethermostatmanual.com>

Golf course search by state

<http://golfingnear.com>

Email search by domain

<http://emailbydomain.com>

Auto manuals search

<http://auto.somanuals.com>

TV manuals search

<http://tv.somanuals.com>