

# Panasonic®

Operating Instructions  
(Household) Sonic Vibration Toothbrush  
Model No. EW-DL80

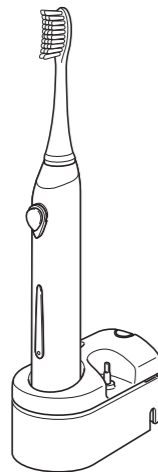

Before operating this unit, please read these instructions completely and save them for future use.

**IN USA CONTACT:**  
Panasonic Corporation of North America  
One Panasonic Way, Secaucus, NJ 07094

Service • Assistance • Accessories

Call 1-800-338-0552 (In USA)  
<http://www.panasonic.com/consumersupport/>

Manufactured for  
Panasonic Corporation  
33, Okamachi, Hikone, Shiga, Japan

## IMPORTANT SAFEGUARDS

When using electrical products when children are present, basic safety precautions should always be followed including the following:

**READ ALL INSTRUCTIONS BEFORE USING**

### DANGER

**In order to reduce the risk of electrocution:**

1. Do not place or store the charger where it can fall or be pulled into a tub or sink.
2. Do not place the charger in water or other liquid.
3. Do not reach for a charger that has fallen into water. Unplug immediately.
4. Do not wash the charger.
5. Do not use while bathing.

### WARNING

**To reduce the risk of burns, electrocution, fire or injury to persons:**

1. This appliance is not intended for use by children or persons with reduced physical or mental capabilities, unless they are supervised by a person responsible for their safety.
2. Use this product only for its intended use as described in this manual. Do not use attachments not recommended by the manufacturer.
3. Keep cord away from heated surfaces.
4. Never drop the appliance or insert any object into any opening of the appliance.
5. Never operate this product if it has been dropped or damaged, or if it is not working properly. If any of these occur, please contact a service center and return the product for examination and repair.
6. If the product is dropped, the brush head should be replaced before the next use even if no damage is visible.
7. This appliance is provided with a charger with integrated Safety Extra Low Voltage power supply. Do not exchange or manipulate any part of it otherwise there is the risk of electric shock. Periodically check the charger for damage. A damaged or non-functioning appliance should no longer be used. Take it to a service center.
8. Never use while drowsy.
9. Do not use outdoors or operate where aerosol(spray) products are being used or where oxygen is being administered.

### IMPORTANT

1. Do not touch the power plug with wet hands. This can cause an electric shock.
2. When unplugging, always hold the power plug instead of the cord.
3. Do not modify the product. Do not disassemble or repair. This may cause fire, electric shock or injury. Consult your dealer for repairs or contact a service center. Do not disassemble the product except when disposing of the battery.
4. When taking out the battery for disposal, use caution not to short the positive (+) and negative (-) terminals.
5. This product is not intended for use by children.

### CAUTION

If you are undergoing treatment for any oral care condition, consult your dental professional prior to use.

## SAVE THESE INSTRUCTIONS

### Introduction

#### ► For your personal dental care

Thank you for purchasing the Panasonic Sonic Vibration Toothbrush.

The Sonic Vibration Toothbrush is a new kind of electric toothbrush designed for those who wish to keep their teeth clean and healthy. This appliance will enable you to maintain good dental hygiene, which is as important as other forms of personal hygiene.

#### ► Sonic Vibration Toothbrush Technology

The Sonic Vibration Toothbrush incorporates the innovative motor technology that uses magnetic attraction and repulsion to provide outstanding performance. The brush's 26,000 horizontal strokes per minute help remove plaque gently yet effectively.

#### ► Before use

This high-speed, vibrating, electric toothbrush is different from conventional electric toothbrushes.

Therefore:

- You only need to lightly press the bristles against your teeth for brushing.
- When first using this appliance, some may experience a tickling or tingling sensation caused by the high-speed vibrations. The sensation should subside after you use the toothbrush several more times.

### Cautions regarding use

- Be sure to switch off the appliance and remove the plug from a household outlet before performing any maintenance. Failure to do so may result in electric shock.
- Cleaning and user maintenance should not be made by children.
- Keep the appliance away from children.
- Do not use the charger in the bath. Doing so may result in electric shock.
- Do not touch or pull out the plug with wet hands. Doing so may result in electric shock.
- If the power cord of the charger is damaged, the entire charger should be discarded. The charger should be replaced.
- Do not wrap the power cord around the charger.
- Always ensure the appliance is operated on an electric power source matched to its rated voltage. Failure to do so may result in fire or electric shock.
- Clean the plug periodically so that dust does not accumulate in it. Such dust buildup may trap moisture over time and reduce the effectiveness of the insulation, thus resulting in overheating and fire.
- Do not modify, disassemble, or repair the appliance at any time except when disposing of it. Doing so may result in fire, electric shock, and/or burns.
- Do not place any metal objects, such as coins and clips, on the charger. Doing so may cause the objects to heat up, resulting in burns.

### Parts identification

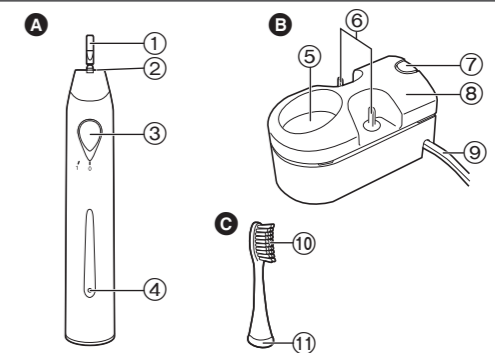

#### A Main unit

- ① Toothbrush shaft
- ② Waterproof rubber seal
- ③ Power switch [0/1]
- ④ Charge status lamp

#### B Charger (RE8-50)

- ⑤ Charging section
- ⑥ Brush stand
- ⑦ Charger cover release button
- ⑧ Charger cover
- ⑨ Power cord

#### Accessories

- ⑩ Triple-edged brush
- ⑪ Bristles
- ⑫ Identification ring

### Store and Charge

#### Storing and charging the toothbrush

You can fully charge the toothbrush in 15 hours.  
A full charge will supply enough power for 40 minutes use.

- 1 Pass the power cord through one of the cord guides on the right or left.**

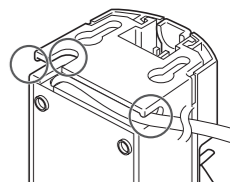

- 2 Turn off the main unit.**

- 3 Place the main unit upright on the charger and plug the power cord into a household outlet.**

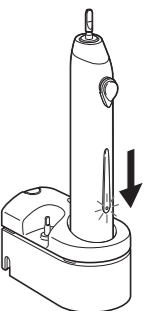

- The charge status lamp glows and the charging will start.
- The charge status lamp does not go off even after the toothbrush is fully charged.
- The toothbrush charges whenever it is placed in the charger.
- Adequate ambient temperature for charging is 0 - 35 °C (32 - 95 °F).
- The main unit may become warm during use and charging. However, this is normal.
- Do not use any charger other than this charger (RE8-50).
- When charging the toothbrush for the first time, or when it has not been in use for more than 6 months, the charge status lamp may not glow for a few minutes, or the operating time may shorten. Please charge it for more than 23 hours in such cases.
- The operating duration will become shorter as the battery gets older.
- If the toothbrush operates only for a short time after being fully charged, this means that the battery is nearing the end of its life cycle. Take the unit to an authorized service center to have the battery replaced.

► **Mounting the charger to the wall**

1. Attach two screws to the wall as illustrated.
  - Please be careful as to not drill a cable or water pipe in the wall.

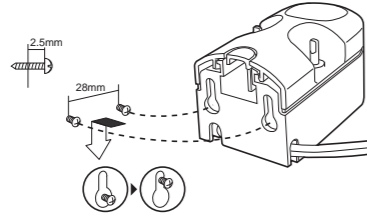

- Screws and anchors are sold separately. Use no. 6 by 1 in. round head screws when fixing to wood; or no. 4-6 Molly or Anchor bolts when fixing to Sheet rock.

2. Hook the charger onto these screws.
3. Plug the power cord into a household outlet.

**Use**

**Using the toothbrush**

**1 Place the brush head firmly onto the toothbrush shaft.**

- There will be a small gap between the brush head and the main unit.

**2 Place the toothbrush in your mouth before turning it on.**

- Apply a small amount of toothpaste to the brush head, if desired, before turning the power on to prevent the toothpaste from spattering.

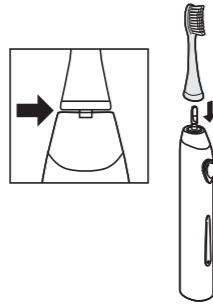

**3 Turn the power switch to "1" position to turn on the main unit.**

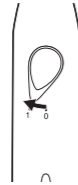

**4 Turn off the main unit when you have finished brushing.**

- Turn off the main unit before removing it from your mouth to prevent foam from spattering.

► **Precaution**

- When you first begin using the toothbrush, you may experience slight bleeding of the gums even though your gums may be healthy. This is because your gums are receiving stimulation by the toothbrush for the first time. The bleeding should stop after one or two weeks of use. Bleeding that persists for more than two weeks may be indication of an abnormal condition of your gums, such as pyorrhea. In this case, stop using the toothbrush and consult your dentist.
- Recommended ambient temperature for using is 0 - 35 °C (32 - 95 °F).
- Do not allow hair products (e.g., gel or oil) or hand lotion to come in contact with the unit as they may damage its surface.

**Tips on usage**

► **Triple-edged brush**

Brush carefully between teeth or around teeth that are not straight. Place the bristles of the brush gently against your teeth.

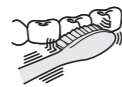

► **Front teeth, and between teeth and gums**

Place the bristles at 45°.

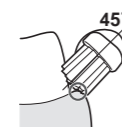

► **Brush the chewing surface of teeth**

Brush at a 90° angle.

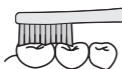

► **Brush the back of teeth or where teeth are not straight**

Brush vertically.

Move the toothbrush to match the angle of teeth.



**After use**

**Cleaning the main unit and the brush head**

► **Main unit**

1. Turn off the main unit.
2. Remove the brush head from the main unit.
3. Wash the main unit under running water.
  - Do not rub or damage the waterproof rubber seal.
  - Do not immerse the main unit under water.
  - Do not wash with water hotter than 40 °C (104 °F).

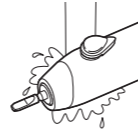

► **Brush head**

1. Turn off the main unit.
2. Remove the brush head from the main unit.

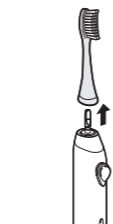

3. Wash the brush head under running water.

- Shake well to remove water after washing.
- Do not pull the bristles of the brush head.
- Do not wash with water hotter than 80 °C (176 °F).
- Do not shake the main unit strongly with the brush head attached.



► **After washing with water**

1. Wipe dry with a cloth.
  - Do not charge while it is wet.
2. Return the main unit and the brush head to the charger.
  - It is recommended to place the brush head facing toward the back of the charger when placing the brush head on the charger.

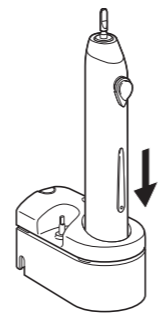

► **If the identification ring comes off**

Put the identification ring back on.

- Do not forcibly pull the identification ring since it can break easily.
- Using the toothbrush without the identification ring has no effect on its performance. The ring is simply for user identification purposes.

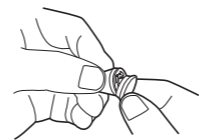

**After use**

**Maintenance**

► **Charger**

1. Pull the charger cover while pressing the charger cover release button.
2. Wipe off any dirt on the charger and the charger cover using a soft cloth.
3. Wipe the prongs of the plug with a dry cloth about once every 6 months.

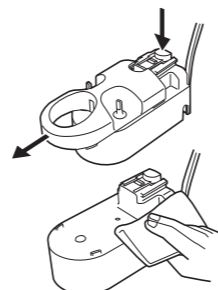

**Removing the Ni-MH battery before disposing of the product**

**WARNING**

Do not disassemble the product at any time other than when disposing of it. Failure to observe this point may result in short circuit, fire, or injury.

For repair or maintenance (such as battery replacement), take the product to an authorized service center.

**ATTENTION:**

A nickel metal hydride battery that is recyclable powers the product you have purchased. Please call 1-800-8-BATTERY for information on how to recycle this battery.



- Before removing the battery, be sure to completely drain the unit of power.
- Use a screwdriver to loosen the screw on the bottom of the product.
- Perform steps ① to ⑦, and then remove the battery.
- Be careful not to short-circuit the negative and positive poles of the battery.

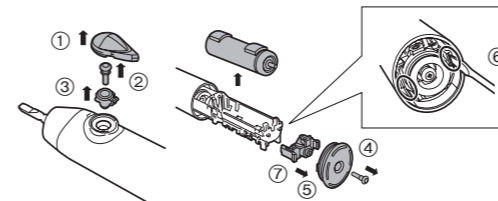

**Specifications**

Related voltage:

See the name plate on the product.  
(Automatic voltage conversion)

Battery: 1 Ni-MH battery (1.2 V---; 1100 mAh)

Charging time: approx. 15 hours

**Changing the brush head (Sold separately)**

Replacing the brush head every 3 months is recommended. If the bristles are bent to one side or worn, the toothbrush is not effective for brushing. Replace the brush head with a new one.

Part number	Replacement Brush for EW-DL80	Quantity
WEW0927	Triple-edged brush	3
WEW0933	Silicon brush *1	1
	Point brush *2	1
WEW0911	V-shaped brush	3

\*1 Silicon rubber provides gums with gentle and comfortable stimulation.

\*2 The conical brush-end easily reaches between teeth and cleans the misaligned-tooth area.

FOR YOUR CONVENIENCE, WE HAVE ESTABLISHED A TOLL-FREE (IN USA ONLY) NATIONAL ACCESSORY PURCHASE HOT LINE AT 1-800-332-5368.

## Free Manuals Download Website

<http://myh66.com>

<http://usermanuals.us>

<http://www.somanuals.com>

<http://www.4manuals.cc>

<http://www.manual-lib.com>

<http://www.404manual.com>

<http://www.luxmanual.com>

<http://aubethermostatmanual.com>

Golf course search by state

<http://golfingnear.com>

Email search by domain

<http://emailbydomain.com>

Auto manuals search

<http://auto.somanuals.com>

TV manuals search

<http://tv.somanuals.com>