

Facsimile

Quick Reference Guide

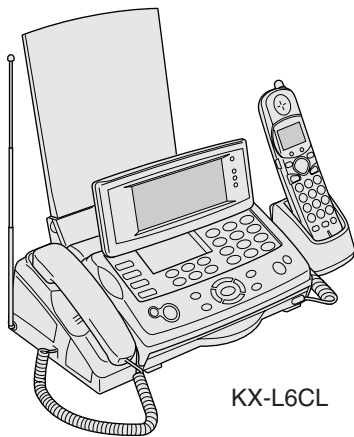

KX-L6CL

Model No. **KX-L6CL**
KX-L6CW

KX-L6CL has one portable handset.
 KX-L6CW has two portable handsets.

Thank you for purchasing a Panasonic facsimile.

Table of Contents

Finding the controls	2
Installations and connections	4
Setting the date and time	7
Adjusting volumes	7
Setting your logo and facsimile telephone number	8
Character input and command key table	9
Automatic dialing on the main unit.....	10
Automatic dialing on the portable handset	11
Intercom between the main unit and portable handset	12
Intercom between portable handsets	13
Sending faxes	14
Receiving faxes	15
Operating the built-in answering device	19
L-mode service	20
Specifications	27



- This guide explains some basic features and operations, but not all of them. For further details, see the Japanese operating instructions.
- This product is designed for use in Japan.
Panasonic cannot provide service for this product if used outside Japan.
- Any details given in this guide are subject to change without notice.

Finding the controls

Main unit (control panel)



(KX-L6CW is shown.)

- 1** **Liquid crystal display**(With color)
- 2** **Volume** button adjusts ringer, speaker and handset volume.
- 3** **Fax View** button displays received fax List and fax data.
- 4** **Book mark** button
- 5** **Mail** button
- 6** **Clear** button
- 7** **Monitor** button starts On-Hook Dialing.
- 8** **Intercom** button
- 9** **Copy** button starts copying.
- 10** **Start/Fax** button starts faxing.
- 11** **Redial** button
- 12** **Stop** button
- 13** **Back** button returns previous display.
- 14** **Hold** button.
- 15**  **Cursor** button to move forward and backward in a text entry.
- 16**  **Flash** button uses the waiting service.
- 17**  **Phonebook** button uses the phonebook.
- 18** **Menu** button
- 19** **Tone** button switches to tone dialing.
- 20** **Auto Answer** button
—light on: answering device activated.
—light off: used as a regular telephone.
- 21** **Replay** button records telephone calls.
Record button records telephone calls.
- 22** **Replay** button plays back recorded messages.
- 23** **Power** indicator
- 24** **Contrast Volume** for Liquid crystal display

Finding the controls

Portable handset

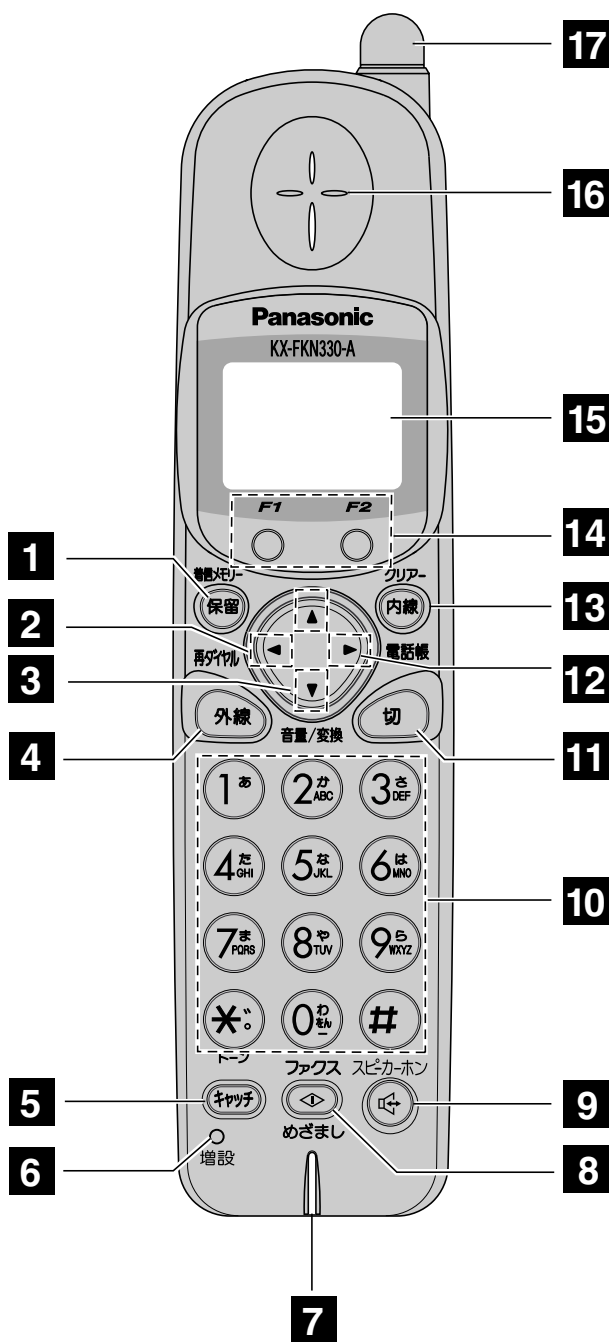

- 1 Caller information** button starts a search in the Number Display log. Hold button puts a call on hold.
- 2 Redial** button redials the last number dialed.
- 3 Volume** button adjusts the volume. **Search** button changes Hiragana into kanji.
- 4 Talk** button makes/answers calls.
- 5 Flash** button uses the call waiting service.
- 6** Used when installing additional portable handsets.
- 7 Microphone** [Do not cover the microphone while talking.]
- 8 Fax reception** receives faxes.
- 9 Speakerphone** button uses the speakerphone.
- 10 Dial** buttons
Tone button switches to Tone dialing mode.
Sharp button
- 11 Off** button ends a call, or ends/exits from editing and other operations.
- 12 Phonebook** button uses the phonebook.
- 13 Intercom** button pages the main unit or another portable handset.
- 14** Multi-operation buttons refer to the function displayed on the bottom of the display. They function differently depending on the mode.
- 15 Liquid crystal display** (with back light) displays battery strength, telephone numbers etc.
- 16 Speaker**
- 17 Call/charge indicator** will blink, when receiving a call or placed on a charger.

Installations and connections

Installing the ink film

- 1 Open the control panel.

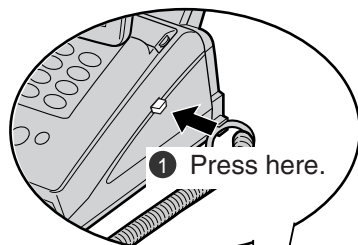

- 2 Open the control panel until it locks.

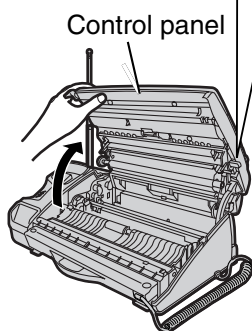

- 2 Insert the ink film.

- 1 Find the "T" shaped gear (blue).

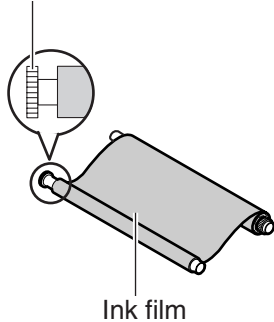

- 2 Insert the blue core into the right slot of the main unit.
- 3 Insert the "T" shaped gear (blue) into the left slot of the main unit.

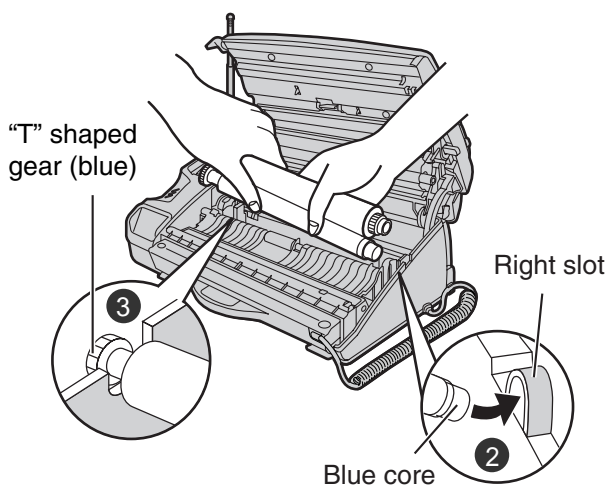

- 4 Insert the white core into the slots shown in the picture below.

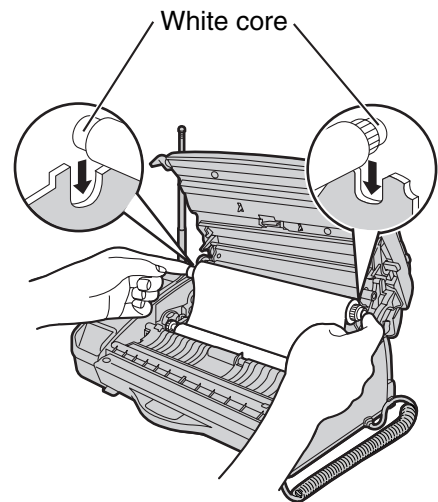

- 5 If the ink film is slack, tighten it by winding the "T" shaped gear (blue).

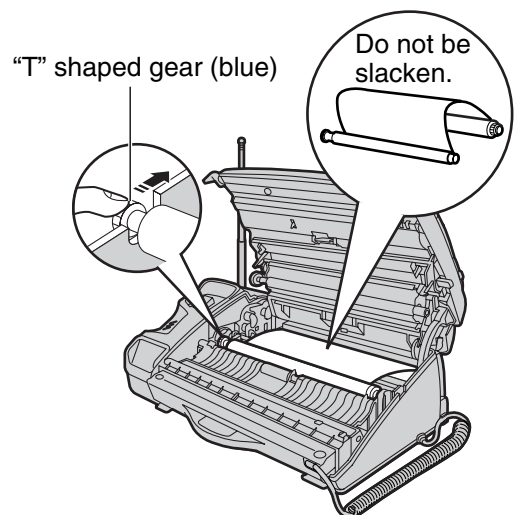

- 3 Close the control panel until it locks.

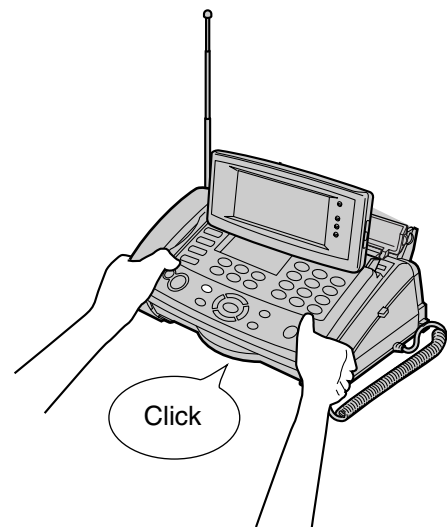

Installations and connections

Installing recording paper (A4 size)

1 Install the recording paper tray.

- 1 Remove the recording paper cover.
- 2 Insert the left tab on the recording paper tray into the left slot of the main unit.
- 3 Insert the right tab into the right slot of the main unit.

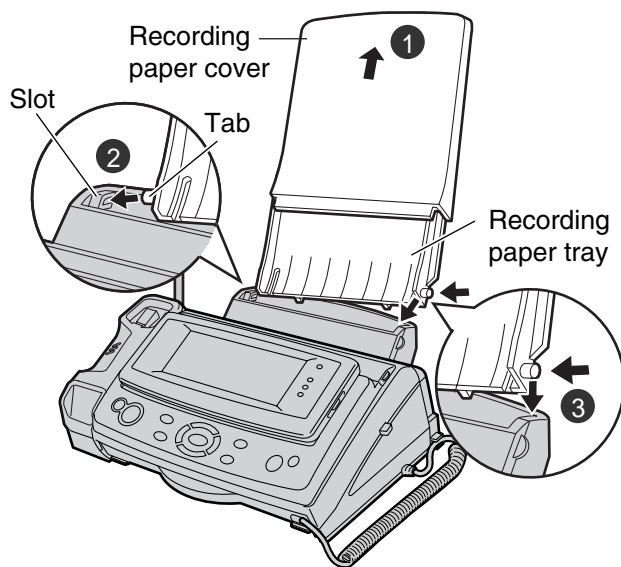

2 Insert the recording paper into the recording paper tray.

- 1 Open the paper entrance cover until it locks.

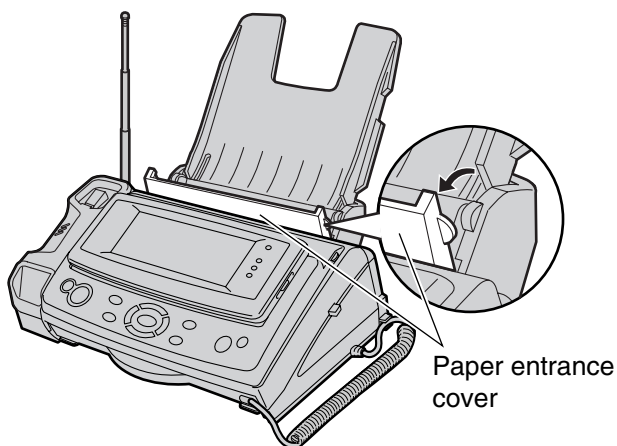

2 Fan the stack of recording paper (A4 size).

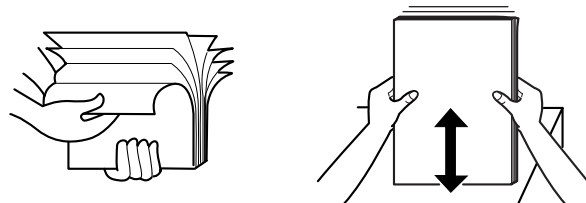

3 Insert the recording paper into the recording paper tray. (Up to 30 sheets)

4 Close the paper entrance cover by leaning it back.

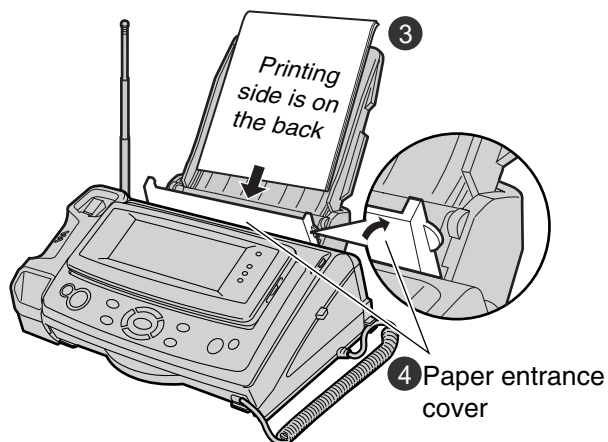

3 Install the recording paper cover on the recording paper tray by sliding it down from the top.

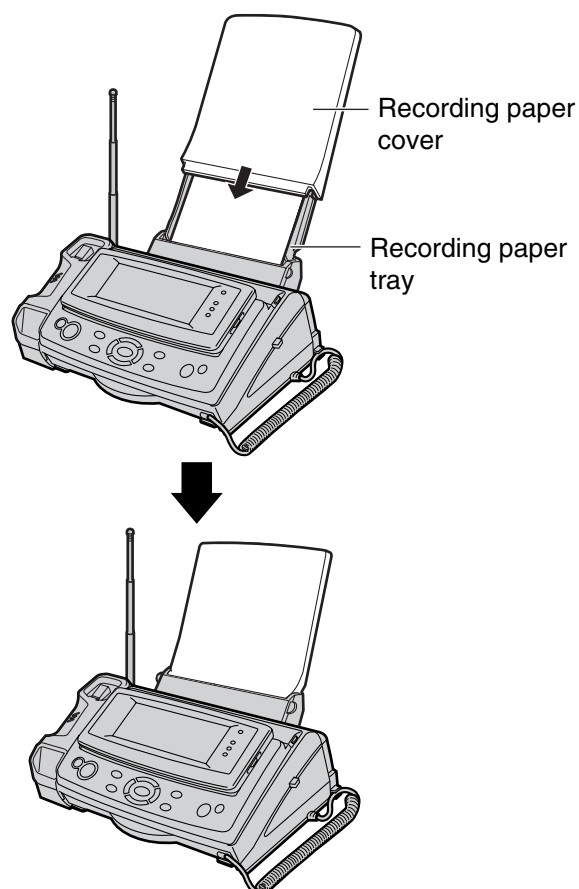

Installations and connections

Setting up the portable handset

1

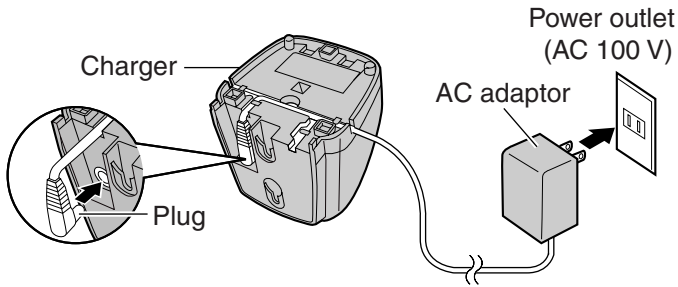

2

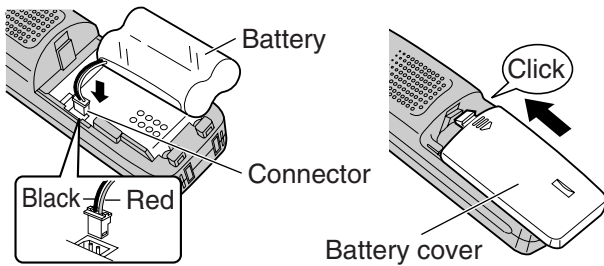

3 Charge the battery in the charger for 10 hours.

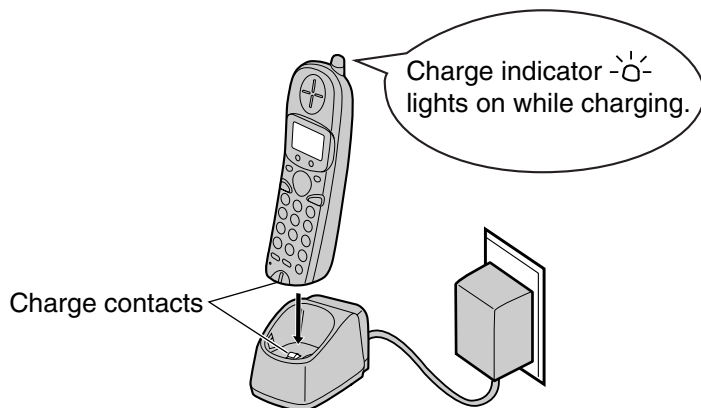

- After your Panasonic battery is fully charged, it will last up to about 7 hours of conversation.

Connecting the main unit

1

Raise the antenna.

2

Connect the cord and place the handset on the main unit.

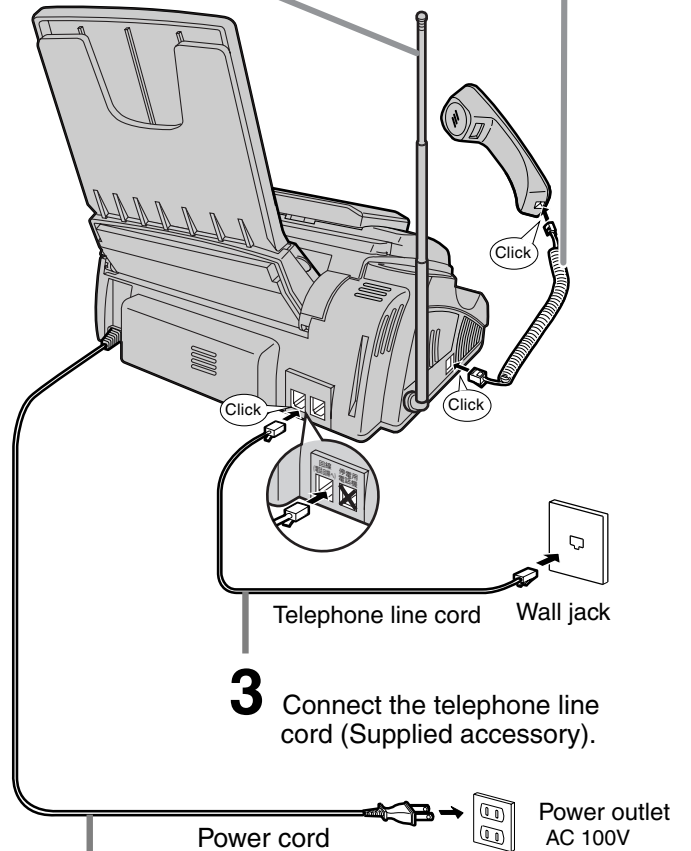

3

Connect the telephone line cord (Supplied accessory).

4

Connect the power cord.

After the Power On...

This unit will automatically select the dialing mode (Tone/Pulse).

Setting the date and time

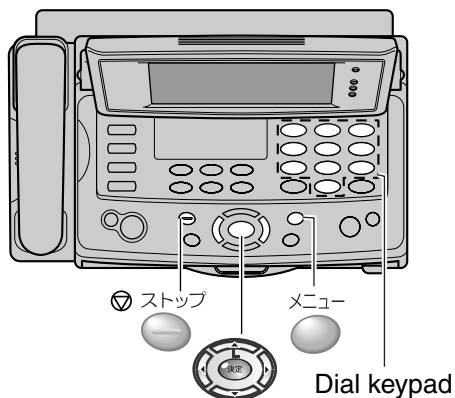

1 Press **メニュー** (Menu) and **5** **0**.

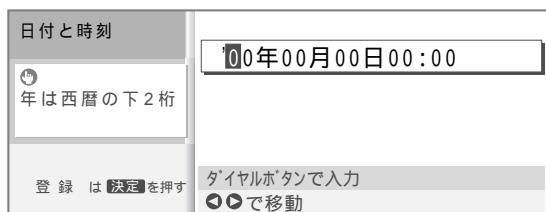

2 Enter the correct date (year/month/day) and time (hour/minute).

Example: November 1, 2002, 15:30 (3:30 PM)

Press **0** **2** **1** **1** **0** **1** **1** **5** **3** **0**.

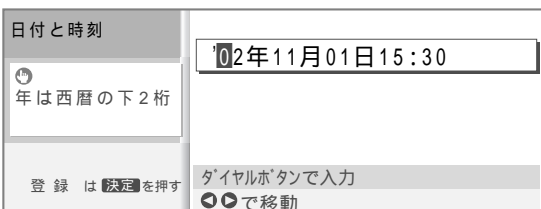

4 Press **決定** (Set).

5 Press **ストップ** (Stop).

Adjusting volumes

Main unit

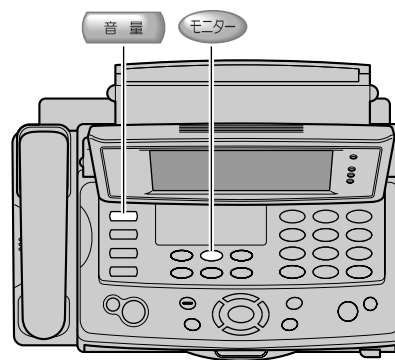

■ Ringer volume

5 levels (including off-position) are available.

Press **音量** (Volume) repeatedly while the unit is not in use.

■ Handset volume

4 levels are available.

Press **音量** (Volume) repeatedly during telephone conversation.

■ Speaker volume

4 levels are available.

Press **音量** (Volume) repeatedly while using **モニター** or listening to the recorded messages.

Portable handset

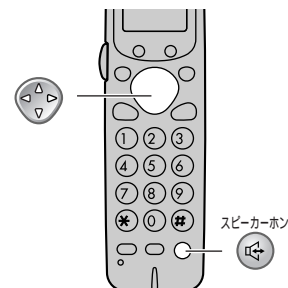

■ Ringer volume

4 levels (including off-position) are available.

Press **音量/変換** (Volume) repeatedly while the unit is not in use.

To turn the ringer off:

Press and hold **音量/変換** (Volume) until a beep sounds.

■ Handset volume

3 levels are available.

Press **音量/変換** (Volume) repeatedly during telephone conversation.

■ Speaker volume

2 levels are available.

Press **音量/変換** repeatedly while using **スピーカホン** or listening to the recorded messages.

Setting your logo and facsimile telephone number

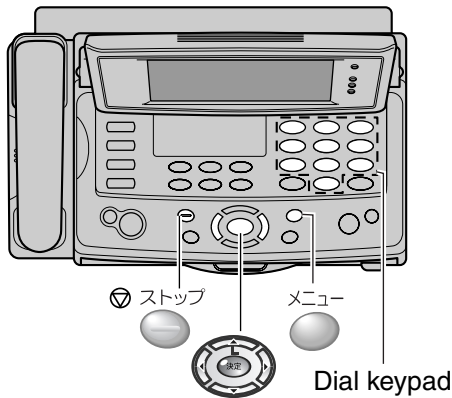

1 Press **メニュー** (Menu) and **5** **1** **1**.

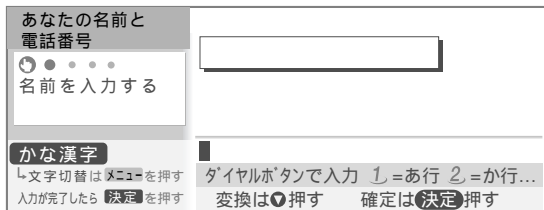

2 Enter your logo, up to 16 characters, using the dial keypad.

- To enter English characters, press **メニュー** (Menu), press **⏪** (down) three times to select “半角英字” (English and sign input mode), then press **決定** (Set).
- For details, see the table on page 9 for instructions.

Example: Micah



- To enter “M”, press **6** **は** once.
- To enter “i”, press **4** **た** six times.
- To enter “c”, press **2** **か** six times.
- To enter “a”, press **⏩** (right) to move the cursor to the next space and press **2** **か** four times.
- To enter “h”, press **4** **た** five times.

3 Press **決定** (Set) twice.

4 Enter your facsimile telephone number, up to 20 digits.

Example: 04671234••

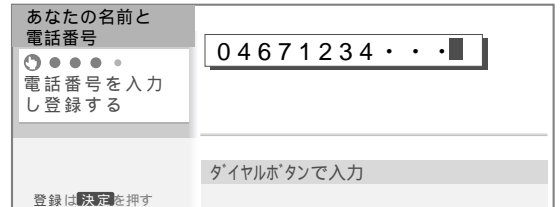



5 Press **決定** (Set).

6 Press **ストップ** (Stop).

Character input and command key table



Pressing the dial keys will select a character as shown below.

Main unit

Character Dial key	“かな漢” Hiragana	“半角カタカナ / 全角カタカナ” Katakana	“半角英字 / 全角英字” English	“半角数字 / 全角数字” Numbers
① あ	あいうえおあいうえお	アイウエオアイウエオ	@ . _ - & \$ ¥ % + = ^	1
② か	かきくけこ	カキクケコ	A B C a b c	2
③ さ	さしすせそ	サシスセソ	D E F d e f	3
④ た	たちつてとっ	タチツテトツ	G H I g h i	4
⑤ な	なにぬねの	ナニヌネノ	J K L j k l	5
⑥ は	はひふへほ	ハヒフヘホ	M N O m n o	6
⑦ ま	まみむめも	マミムメモ	P Q R S p q r s	7
⑧ や	やゆよやゆよ	ヤユヨヤユヨ	T U V t u v	8
⑨ ら	らりるれろ	ラリルレロ	W X Y Z w x y z	9
⑩ わ	わをんー！？、。・「」	ワヲンー！？、。・「」	! ? / - * # , ; : ' " () [] { } ` ~ ^	0
* 〃	〃 ° 、 。		、 。	
Command keys	 : Used to move the cursor to the left and right.  : Used to insert a space.		 : Used to delete a character.	

- A space is counted as one character in the number of the maximum input characters.
- When entering e-mail address, the small letters are displayed before the capital letters.

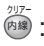
Portable handset

Character Dial key	“かな” Hiragana	“カナ” Katakana	“英” English	“数” Numbers
① あ	あいうえおあいうえお	アイウエオアイウエオ	@ . _ - & \$ ¥ % + = ^	1
② か	かきくけこ	カキクケコ	A B C a b c	2
③ さ	さしすせそ	サシスセソ	D E F d e f	3
④ た	たちつてとっ	タチツテトツ	G H I g h i	4
⑤ な	なにぬねの	ナニヌネノ	J K L j k l	5
⑥ は	はひふへほ	ハヒフヘホ	M N O m n o	6
⑦ ま	まみむめも	マミムメモ	P Q R S p q r s	7
⑧ や	やゆよやゆよ	ヤユヨヤユヨ	T U V t u v	8
⑨ ら	らりるれろ	ラリルレロ	W X Y Z w x y z	9
⑩ わ	わをんー！？ ()	ワヲンー！？ ()	! ? / - * # , ; : . ' " () [] { } ` ~ ^	0
* 〃	〃 ° 、 。		、 。	
Command keys	 : Used to change the character input mode.  : Used to delete a character.		 : Used to move the cursor to the left and right.  : Used to insert a space.	

- A space is counted as one character in the number of the maximum input characters.
- When entering e-mail address, the small letters are displayed before the capital letters.

Automatic dialing on the main unit

Storing names and telephone numbers in the phonebook

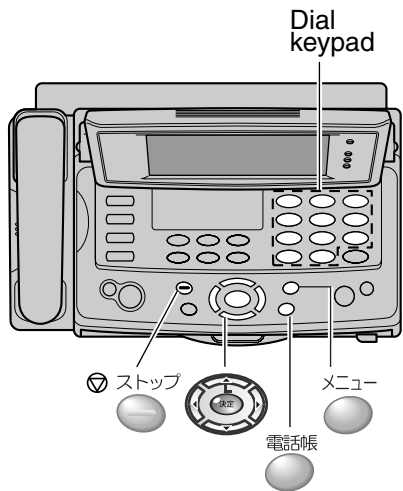

- Press (Phonebook), (Menu) and (Set).
 - You can program up to 150 stations, including 4 pre-programmed stations.

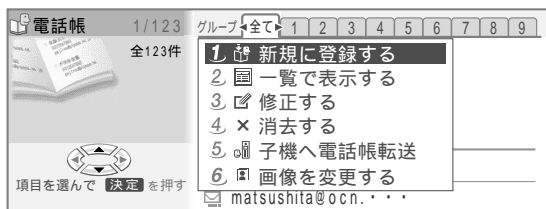

- Enter the name, up to 20 characters (see the table on page 9 for instructions).
 - To enter English characters, press (Menu), press (down) three times to select “半角英字” (English and sign input mode), then press (Set).
 - To correct a mistake, press (Clear).



- Press (Set) twice.

- Enter the telephone number, up to 24 digits.

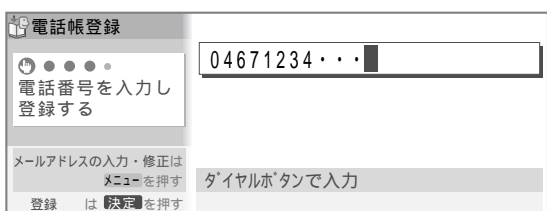

- Press (Set).

- Press (up or down) to select a group number (1–9).

- Press (Set).

- Press (Stop) to exit the program.

Making a voice call using the phonebook

- Press (Phonebook).

- Press (up or down) repeatedly until the desired name is displayed.

- Lift the handset.

Editing a stored name or number

- Press (Phonebook).

- Press (up or down) repeatedly until the desired name is displayed.

- Press (Menu) and (3).

- Edit the name (see the table on page 9 for instructions), then press (Set).

- Enter the correct kana, then press (Set).

- Enter the correct telephone number, then press (Set).

- Press (up or down) to select a group number, then press (Set).

- Press (Stop) to exit the program.

Automatic dialing on the portable handset

Storing names and telephone numbers in the phonebook

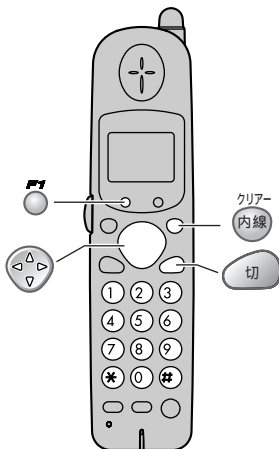

1 Press (Phonebook).

電話帳検索
名前?

2 Press (Register).

- “XXX” shows the remaining station numbers you can store.
- You can program up to 150 stations, including 4 pre-programmed stations.
- Press twice for entering English mode.

名前?
空き x x x 件

3 Enter the name, up to 20 characters (see the table on page 9 for instructions).

4 Press (Register) twice.

5 Enter the telephone number, up to 24 digits.

- To correct a mistake, press (Clear).

6 Press (Register).

7 Enter the group number (1–9).

8 Press (Register).

- To program other items, repeat steps 3 to 8.

9 Press (Off) to exit the program.

Making a voice call using the phonebook

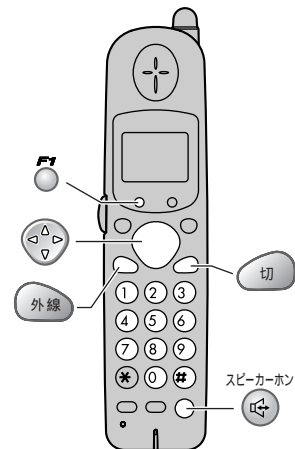

1 Press (Phonebook).

2 Press (up or down) repeatedly until the desired name is displayed.

3 Press (Talk) or press (Speakerphone).

Editing a stored name or number

1 Press (Phonebook).

2 Press (up or down) repeatedly until the desired name is displayed.

3 Press (Edit).

4 Edit the name (see the table on page 9 for instructions), then press (Register).

5 Enter the correct kana, then press (Register).

6 Enter the correct telephone number.
• To correct a mistake, press (Clear).

7 Press (Register).

8 Enter the correct group number.

9 Press (Register).

10 Press (Off) to exit the program.

Intercom between the main unit and portable handset

An intercom is available between the main unit and portable handset.

Using the main unit:

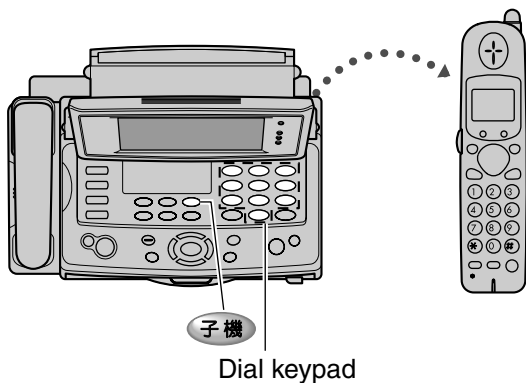

1 Lift the handset.

■ **For single portable handset users**

Press **子機** (Portable handset).

■ **For multiple portable handset users**

Press **子機** (Portable handset) and press the portable handset number (**1** あ to **4** た) which you want to call.

2 Start talking.

3 Replace the handset.

Using the portable handset:

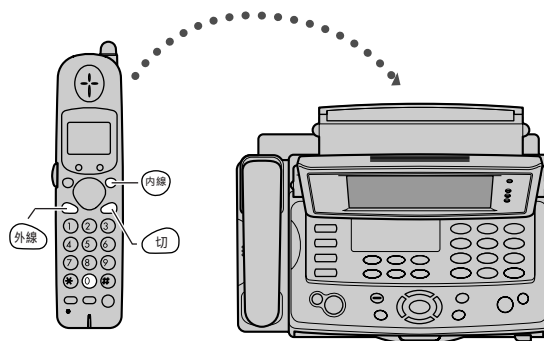

1 ■ **For single portable handset users**

Press **内線** (Intercom).

内線呼出



■ **For multiple portable handset users**

Press **内線** (Intercom), then press **0**.

2 Start talking.

- You can switch to the speakerphone by pressing

スピーカホン

スピーカホン (Speakerphone).

3 Press **切** (Off) to end the intercom call.

Intercom between portable handsets

A 2-way intercom is available between 2 portable handsets.

(For KX-L6CL users: An optional handset is needed when using this feature.)

Making an intercom call

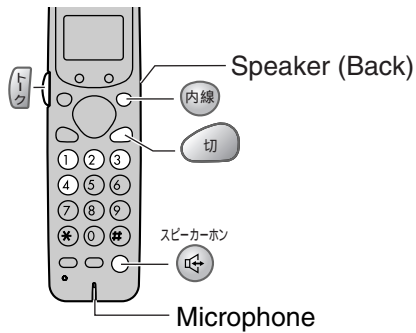

- 1 Press **内線** (Intercom) and the desired portable handset number (**1** to **4**).

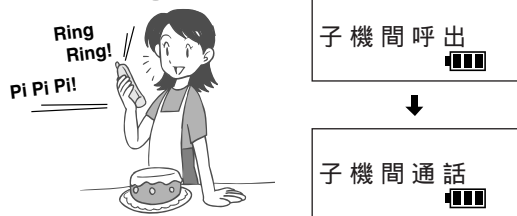

- 2 Start talking.

1. Press and hold **トク** (Talk) until a beep sounds.

- **スピーカーホン** light on

2. Start talking while holding down **トク** (Talk).

- Keep holding down **トク** (Talk) until you finish talking.

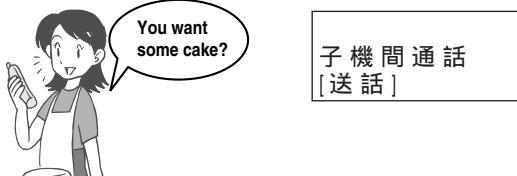

3. Release **トク** (Talk) after you finish talking.

- 3 Listen to the response.



- 4 If you want to continue the conversation, repeat steps 2 and 3.

- 5 Press **切** (Off) to end the intercom call.

Answering an intercom call

1

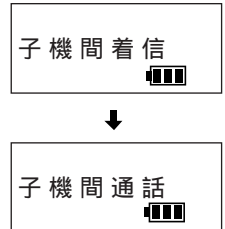
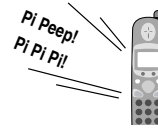

- 2 Listen to the caller.

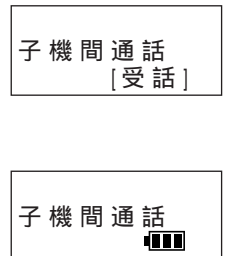

- 3 Respond to the caller.

1. Press and hold **トク** (Talk) until a beep sounds.

- **スピーカーホン** light on

2. Start talking while holding down **トク** (Talk).

- Keep holding down **トク** (Talk) until you finish talking.



3. Release **トク** (Talk) after you finish talking.

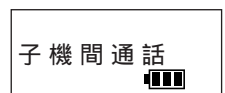

- 4 If you want to continue the conversation, repeat steps 2 and 3.

- 5 Press **切** (Off) to end the intercom call.

Sending faxes

Sending a fax manually

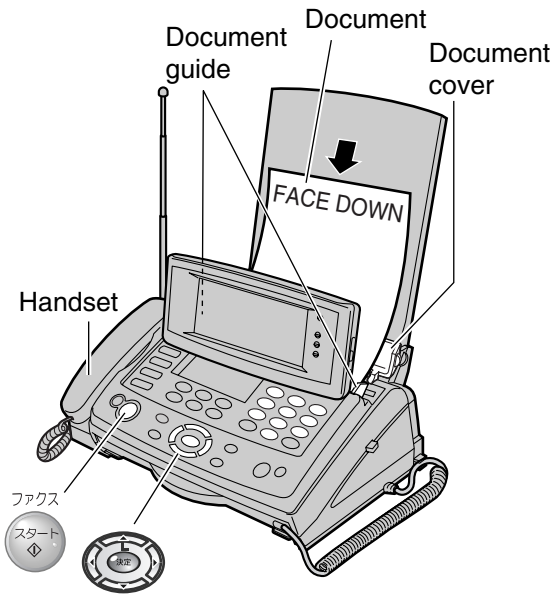

- 1 Open the document cover, and adjust the width of the document guides to the size of the document.
- 2 Insert the document (up to 5 pages) FACE DOWN until a single beep is heard.
- 3 If necessary, press (Resolution) and (up or down) to select the desired resolution (see below).
- 4 Dial the fax number.
- 5 Press (Fax).
 - The unit will start fax transmission.

Sending a fax using the phonebook

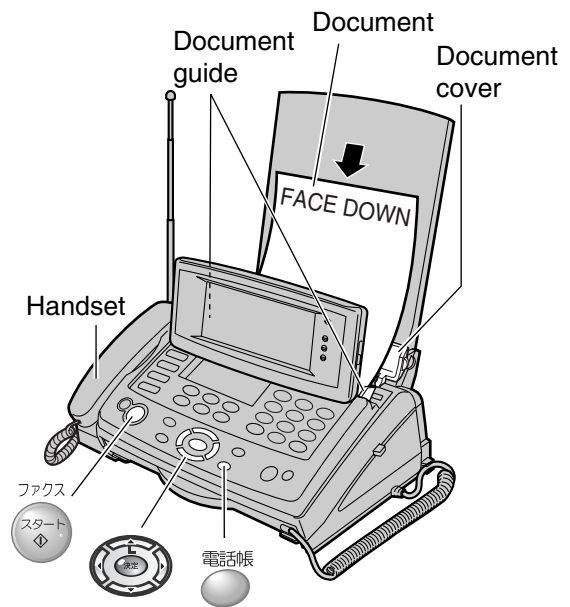

- 1 Open the document cover, and adjust the width of the document guides to the size of the document.
- 2 Insert the document (up to 5 pages) FACE DOWN until a single beep is heard.
- 3 If necessary, press (Resolution) and (up or down) to select the desired resolution (see below).
- 4 Press (Phonebook), then press (up or down) until the desired name is displayed.
- 5 Press (Fax).
 - The unit will start fax transmission.

To select the resolution

1. Press (Resolution) after loading documents.
2. Press (up or down) to select the desired resolution.

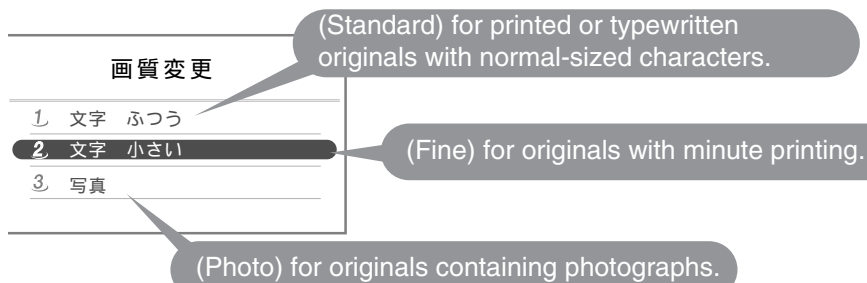

Receiving faxes

You can select beforehand whether to receive faxes by “Receive in memory” or “Receive on recording paper”.

Receive in memory: (Default setting)

The received fax will be stored in memory. You can check the contents on the display, then print them if necessary.

Receive on recording paper:

The received fax will be printed on recording paper.

Setting/canceling “Receive in memory”

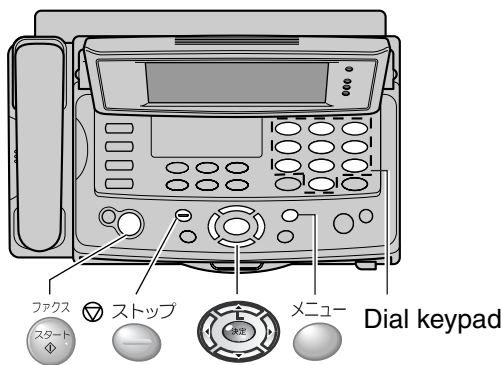

1 Press (Menu) and (6).

2 Press (up or down) to select either “Receive in memory” or “Receive on recording paper” and press (Set).



3 Press (Stop).



Receiving a fax manually (AUTO ANSWER off)

Using the main unit:

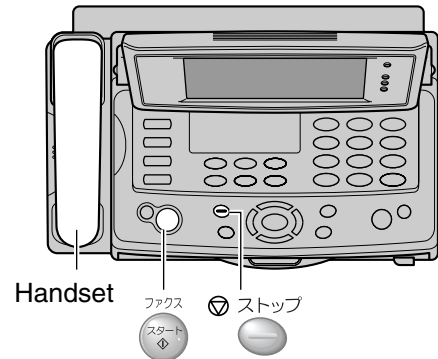

1 When you hear a ring, lift the handset to answer the call.

2 When: –document reception is required, –a fax calling tone (slow beep) is heard, or –no sound is heard, press (Fax).

3 Replace the handset.
• The unit will start fax reception.

Using the portable handset:

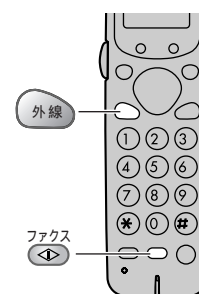

1 When you hear a ring, lift the portable handset from the charger to answer the call.
• If the portable handset is not set on the charger, press (Talk).

2 When: –document reception is required, –a fax calling tone (slow beep) is heard, or –no sound is heard, press (Fax reception) until a single beep is heard.
• The main unit will start fax reception.

Receiving faxes

Viewing faxes stored in memory

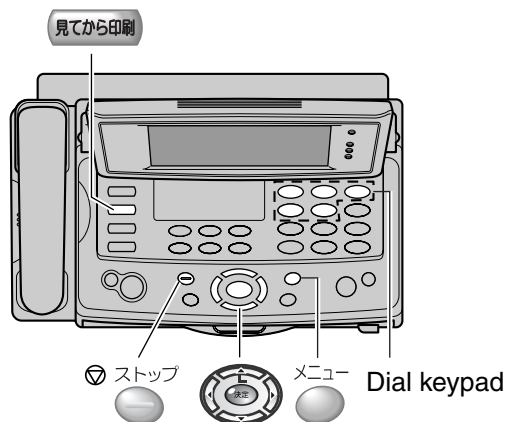

1 While “ファクスを受信しました” (A fax has been received) is displayed, press **決定** (Set).

- When “ファクスを受信しました” (A fax has been received) is not displayed, press **見てから印刷** (Fax list).

2 Press (up or down) to select the desired fax to display.

shows the fax has not been viewed yet.



3 Press **決定** (Set) to see the fax (follow the instructions on the right).



4 To close the fax, press **ストップ** (Stop).

Information about display

■ To scroll display contents

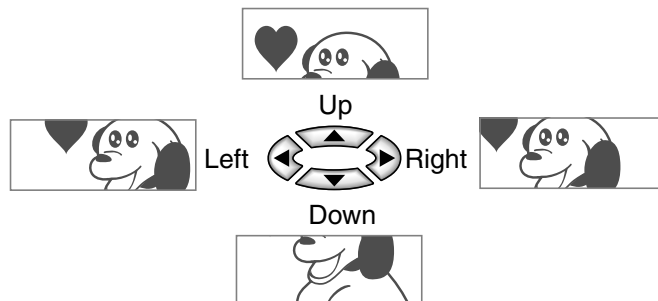

■ To enlarge or reduce content

1. Press **メニュー** (Menu) and **1**.
2. Press (up or down) to select the desired size and **決定** (Set).

(Example)



■ To turn display contents

1. Press **メニュー** (Menu) and **2**.
2. Press (up or down) to select the desired angle and **決定** (Set).

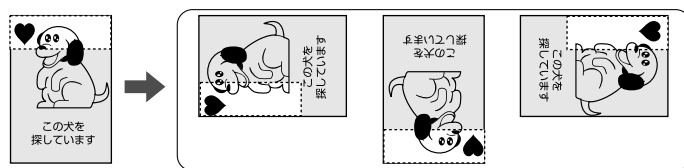

■ To view the next page

Press **メニュー** (Menu) and **3**.

■ To print the fax

1. Press **メニュー** (Menu) and **4**.
2. Press (up or down) to select either “すべてのページ” (All pages) or “現在のページ” (Current page).
3. Press **決定** (Set).

■ To delete all contents of the displayed fax

Press **メニュー** (Menu) and **5**.

Receiving faxes

Printing a specific fax stored in memory

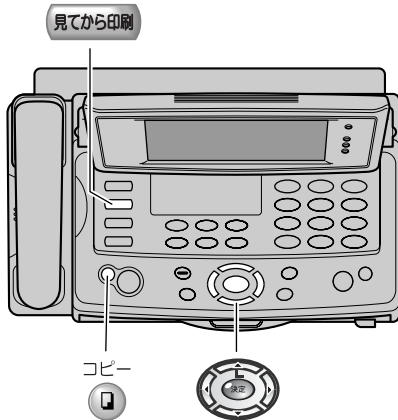

- 1 While “ファクスを受信しました” (A fax has been received) is displayed, press **決定** (Set).
 - When “ファクスを受信しました” (A fax has been received) is not displayed, press **見てから印刷** (Fax list).

- 2 Press (up or down) to select the desired fax to print.



- 3 Press **コピー** (Copy).

Deleting a specific fax stored in memory

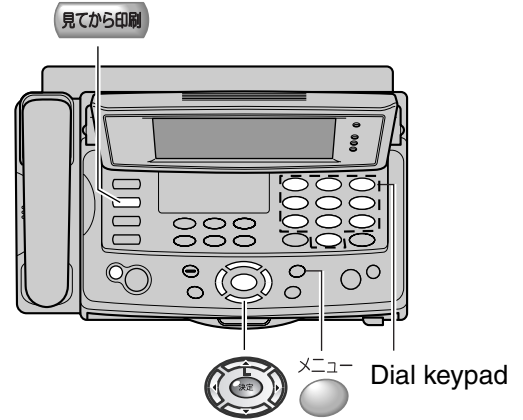

- 1 Press **見てから印刷** (Fax list).
- 2 Press (up or down) to select the desired fax to delete.
- 3 Press **メニュー** (Menu) and **2** (Delete a specific fax).

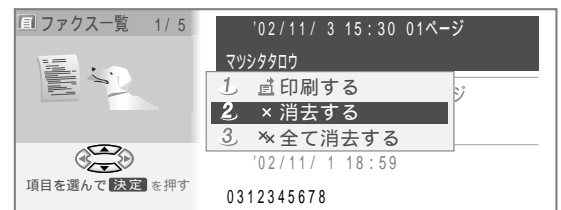

- 4 To delete the fax, select “はい” (Yes).

Deleting all faxes stored in memory

- 1 Press **見てから印刷** (Fax list).
- 2 Press **メニュー** (Menu) and **3** (Delete all faxes).
- 3 To delete all the faxes, select “はい” (Yes).

Receiving faxes

Setting ANSWER mode

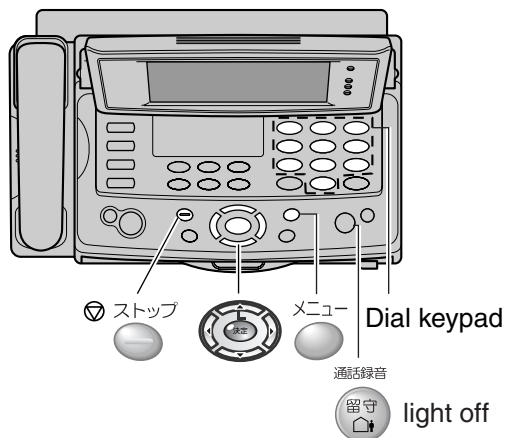

When AUTO ANSWER mode is off, the unit provides three types of receiving modes: “電話モード” (Telephone) mode, “ファクス優先” (Fax/Telephone) mode and “ファクス専用” (Fax only) mode.

- 1. Telephone mode (電話モード)** –Pre-selected setting:
Select this mode when you plan to answer the calls yourself.
When receiving calls, you have to answer all calls manually.
- 2. Fax/Telephone mode (ファクス優先):** Select this mode when you are near the unit and want to use it to receive voice calls yourself and fax calls automatically.
- 3. Fax only mode (ファクス専用):** Select this mode when you wish to use the unit only as a fax machine.

Changing the setting of ANSWER mode.

1. Press (Menu) and .
2. Press (up or down) repeatedly to select the desired mode.
3. Press (Set).
4. Press (Stop) to exit the program.

Setting AUTO ANSWER mode

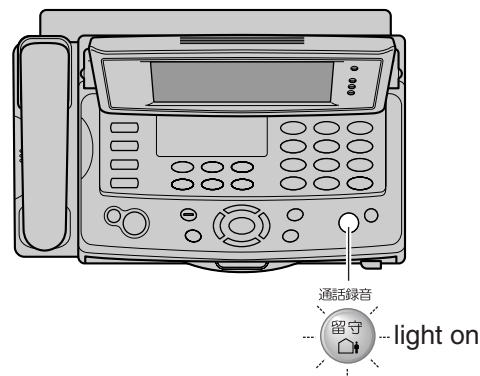

- 1** If the (Auto answer) light is off, turn it on by pressing .
- 2** When receiving a call, the unit will receive a fax document or record a voice message automatically depending on the caller's request.

Recording your own greeting message

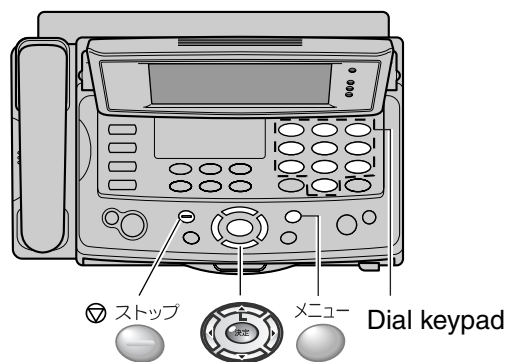

You can record your own greeting message. When receiving a call, it will be played to callers instead of the pre-recorded Japanese greeting message.

- 1** Press (Menu) and .
- 2** Lift the handset.
- 3** Press (Set) and record your greeting message, up to 30 seconds, using the handset.
- 4** When finished, replace the handset.
 - Your greeting message will be played back automatically.
- 5** Press (Stop) twice.

Operating the built-in answering device

Activating the answering device

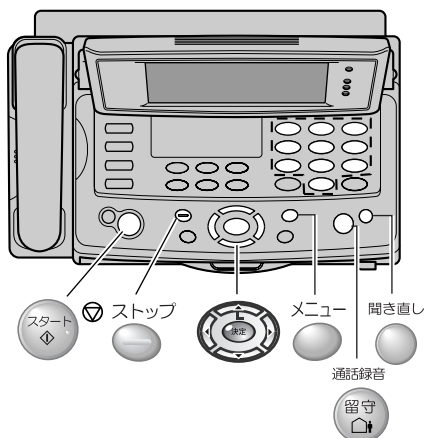

- 1 Turn the **留守** (Auto answer) light on by pressing **留守**.
- 2 When receiving a call, a greeting message will be played and the unit will record a voice message.
 - To record your own greeting message, see page 18.

Listening to recorded messages

When new messages are recorded, the **留守** (Auto answer) light will flash.

- 1 Press **留守** to listen to the recorded messages.
- 2 To erase the messages, press **決定** (Set) within 10 seconds after playing back.
To save the messages, press **ストップ** (Stop).

Listening to all of the recorded messages

Press **聞き直し** (Replay/Record).

While a message is played back, the following operations are available:

To listen to the next message, press **聞き直し** (right).

To listen to the previous message, press **聞き直し** (left).

To play back faster, press **1**.

To play back slowly, press **2**.

To erase the message being played back, press **3**.

To erase all the recorded messages, press

4.

To stop playing back, press **ストップ** (Stop).

Erasing all of the recorded messages

- 1 Press **メニュー** (Menu) and **5** **9** **9** **スタート**.
- 2 Press **ストップ** (Stop).

Erasing your own greeting message

- 1 Press **メニュー** (Menu) and **5** **9** **0** **スタート**.
- 2 Press **ストップ** (Stop).
 - The pre-recorded Japanese greeting message will be played when you receive a call.

Operating the answering device from a remote location

Preparation: Programming the remote operation ID

1. Press **メニュー** (Menu) and **5** **3** **0**.
2. Enter any 4-digit number (remote operation ID) except * or #.
3. Press **決定** (Set).
4. Press **ストップ** (Stop).

Operation: Listening to a recorded message from a remote location

Turn the **留守** (Auto answer) light on before you go out. Remote operations are available only from a touch tone telephone.

1. Call your unit.
2. Press **#** during the greeting message, then enter the remote operation ID and **#**.
3. Press **2** **#**.
 - The recorded messages will be played back.

L-mode service

Using L-mode service

“L-mode” is a convenient service of NTT offering with web browsing and e-mail.

To use L-mode service, please contract with NTT.

Application fee

Subscription fee/ Installation charge	Free
L-mode usage charge	200 yen/month
Internet connection charge	100 yen/month
Transmission charges	Call charges to the access point according to usage time

- According to charged sites, charges are added separately.

Setting up L-mode service

You should set up your unit before using L-mode service.

Important:

- You should set up your unit after subscription of “L-mode” service is completed.
You cannot set up your unit until the service becomes available.
- When your unit is turned off, the required data for L-mode is deleted and L-mode service will not be available.
The following setting is necessary to use L-mode service again after switching on the power supply.

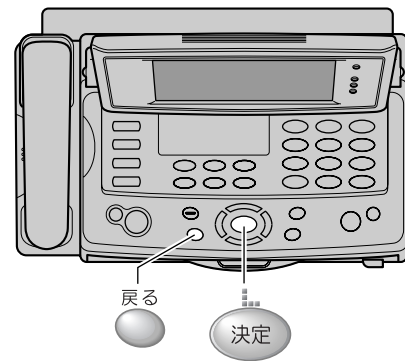

- 1 Press (L-mode) twice.
 - The required data for L-mode will be downloaded.

- 2 Press (Set) after “設定完了” is displayed.



- You can use L-mode service continuously.

- 3 Press (Back) repeatedly until the top menu is displayed.

- 4 Press (Back), then press (Set).

L-mode service

Sending an e-mail

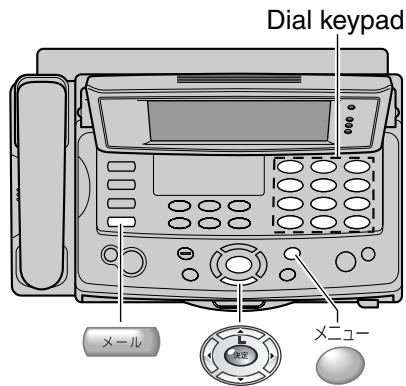

1 Press **メール** (Mail), then press **決定** (Set).

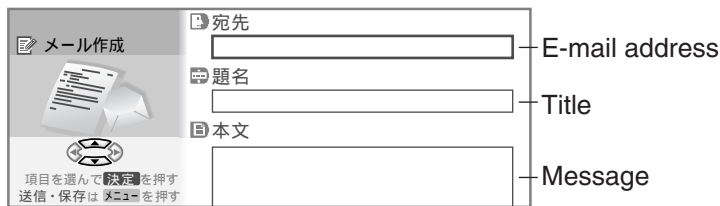

2 Press **決定** (Set).

3 Enter the desired e-mail address, up to 50 characters (see the table on page 9 for instructions), then press **決定** (Set).

• You can enter the e-mail address using the addressbook.

1. Press **メニュー** (Menu) and **3**.

2. Press **決定** (Down) to select the desired party.

3. Press **決定** (Set).

4 Press **決定** (Down) to select the title column, then press **決定** (Set).

5 Enter the title of your e-mail, up to 60 characters (see the table on page 9 for instructions), then press **決定** (Set).

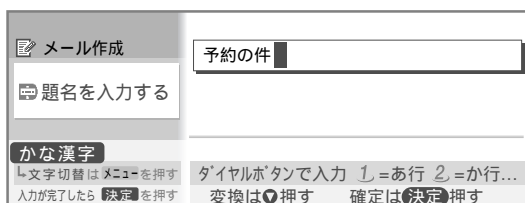

6 Press **決定** (Down) to select the message column, then press **決定** (Set).

7 Enter your e-mail message, up to 2000 characters (see the table on page 9 for instructions), then press **決定** (Set).

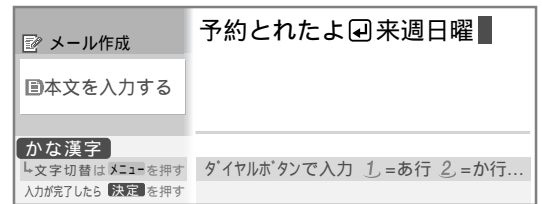

8 ■ To send the e-mail

Press **メニュー** (Menu) and **1**.
• Your e-mail will be sent.

■ To stop writing the e-mail and save it

Press **メニュー** (Menu) and **2**.

9 When the following is displayed, select “はい” (Yes) to disconnect the line.

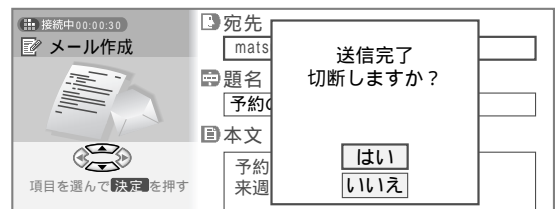

10 Press **決定** (Set).

L-mode service

Storing e-mail addresses in the addressbook

You can program up to 150 addresses.

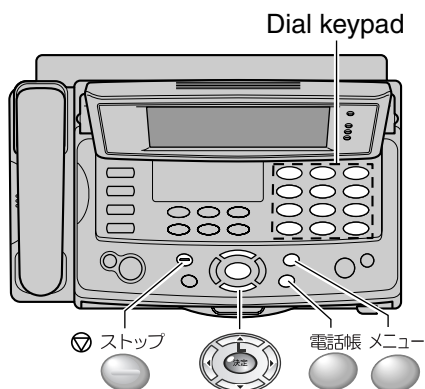

- 1 Press (Phonebook) and (Menu), then press (Set).
- 2 Enter the name, up to 20 characters (see the table on page 9 for instructions), then press (Set).
- 3 Confirm the kana, then press (Set).
- 4 Enter the phone number, up to 24 characters.
- 5 Press (Menu) and enter the e-mail address, up to 50 characters, then press (Set).



- 6 Press (up or down) to select the group number, then press (Set).
- 7 Press (Stop) to exit the program.

Editing/deleting a stored e-mail address

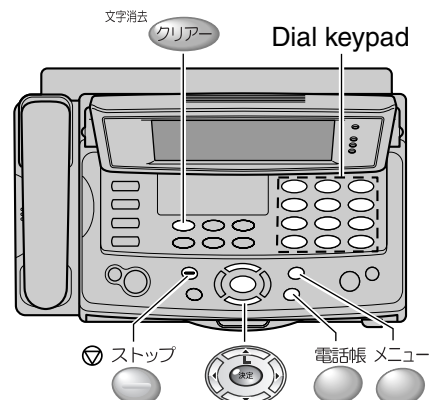

- 1 Press (Phonebook).
- 2 Press (up or down) repeatedly until the desired name is displayed.
- 3 Press (Menu) and .
- 4 Press (Set) twice.
- 5 Press (Menu).
 - To edit the party
Press (Clear) and edit the name (see the table on page 9 for instructions).
 - To delete the party
Press (Clear).
- 6 Press (Set) twice.
- 7 Press (Stop) to exit the program.

L-mode service

Receiving an e-mail

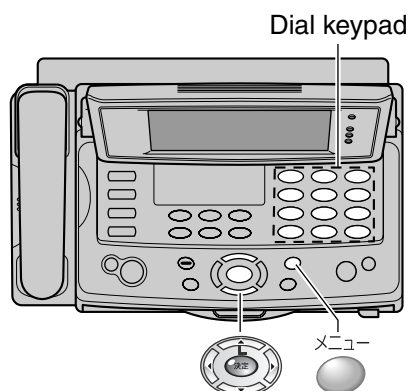

1 Press (L-mode).

- The new e-mail will be received.

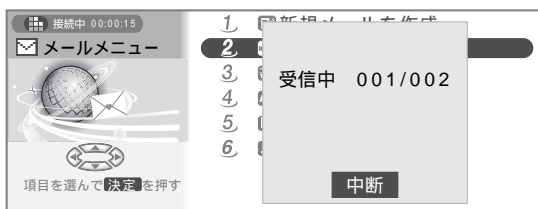

2 When the following is displayed, select “はい” (Yes) and

then press (Set).

- The connection with the L-mode gateway will be disconnected.

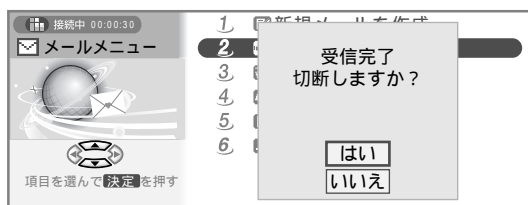

3 Press (up or down) to select the desired e-mail.

(Example)

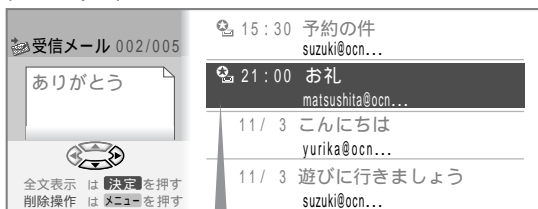

Selected e-mail

4 Press (Set) to read the e-mail.

- To print the e-mail, press (Menu) and , then press (Set).

- To delete the e-mail, press (Menu) and , and select “はい” (Yes) for deleting the e-mail.

■ To reply to the e-mail

- Press (Menu) and .
- Operate the steps 4–7 on page 21.
- Press (Menu) and .
- Select “はい” (Yes), then press (Set).

■ To forward the e-mail

- Press (Menu) and , then press (Set).
- Enter the desired e-mail address, up to 50 characters (see the table on page 9 for instructions), then press (Set).
- If necessary, edit the title and add your message.
 - Operate the steps 4–7 on page 21.
- Press (Menu) and .
- Select “はい” (Yes), then press (Set).

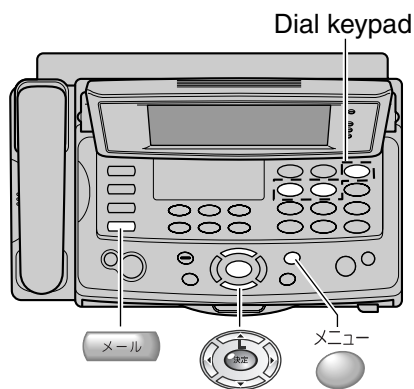

Viewing the received e-mail

1 Press **メール** (Mail), then press **3**.

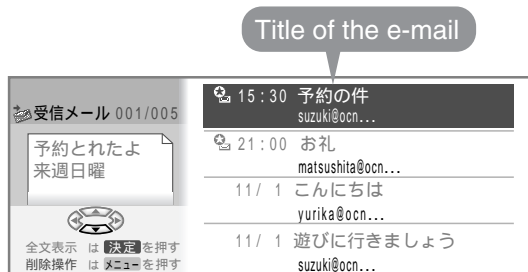

2 Press **決定** (up or down) to select the desired e-mail, then press **決定** (Set).



Viewing the sent e-mail

1 Press **メール** (Mail), then press **4**.

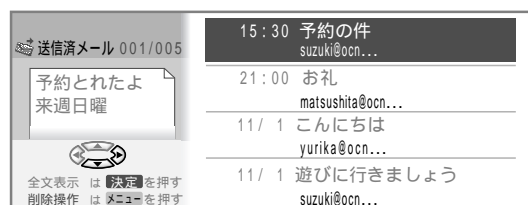

2 Press **決定** (up or down) to select the desired e-mail, then press **決定** (Set).



To print the displayed e-mail

Press **メニュー** (Menu) and **4**, then select “はい” (Yes) and press **決定** (Set).

To delete the displayed e-mail

Press **メニュー** (Menu) and **5**, then select “はい” (Yes) and press **決定** (Set).

Viewing the unsent e-mail

1 Press **メール** (Mail), then press **5**.



2 Press **決定** (up or down) to select the desired e-mail to display, then press **決定** (Set).



To edit the displayed e-mail and send it

Press **メニュー** (Menu) and **3**, then go to step 4 on page 21.

To print the displayed e-mail

Press **メニュー** (Menu) and **4**, then select “はい” (Yes) and press **決定** (Set).

To delete the displayed e-mail

Press **メニュー** (Menu) and **5**, then select “はい” (Yes) and press **決定** (Set).

L-mode service

Browsing the web using the L-mode menu

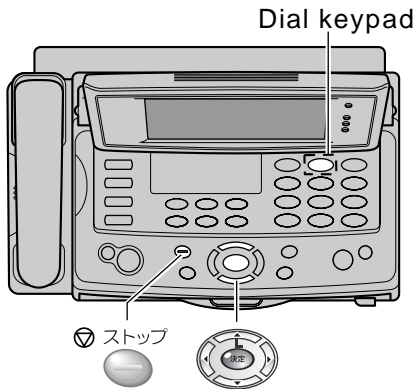

- 1 Press **決定** (L-mode), then press **2** .
 • The line will be connected to the L-mode gateway.

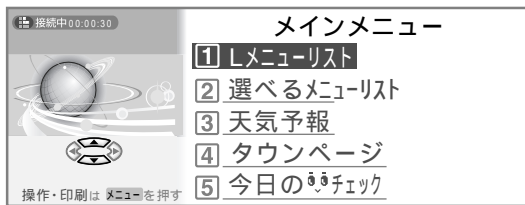

- 2 Press **↑** (up or down) to select the desired item to browse, then press **決定** (Set).
 (Repeat this operation to access the desired item.)

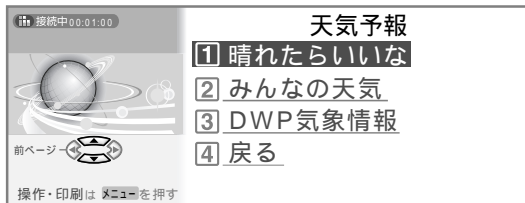
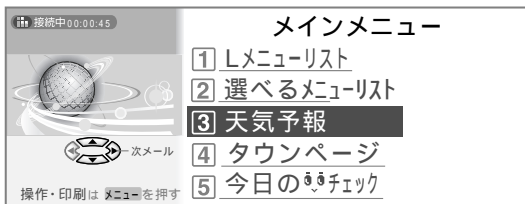

- 3 Press **ストップ** (Stop) to finish browsing.

Browsing the web by entering the URL

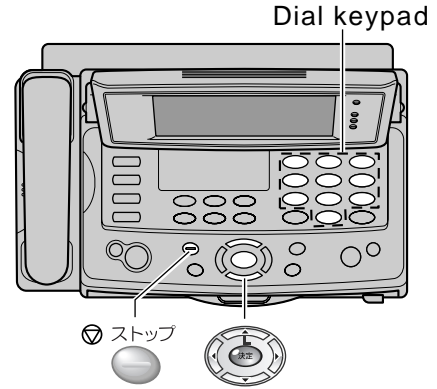

- 1 Press **決定** (L-mode), then press **4** .
- 2 Press **決定** (Set) and enter the URL, up to 500 characters (see the table on page 9 for instructions).



- 3 Press **↑** (up or down) to select "OK", then press **決定** (Set).

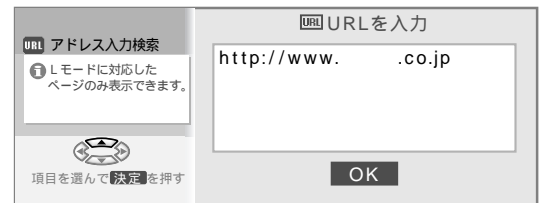

- 4 Press **ストップ** (Stop) to finish browsing.

Operation on the web

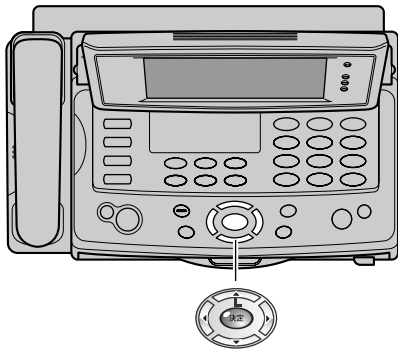

■ To scroll display contents

Press (up or down).

■ To browse the web which is linked

Press (up or down) to select the desired item (underlined), then press (Set).

■ To go back to the previous page

Press (left for back).

■ To go to the next page

Press (right for forward).

■ To enter the characters

1. Press (up or down) to select the desired text box to enter the characters.
2. Press (Set) and enter the characters (see the table on page 9 for instructions).

■ To select the item with the radio button

1. Press (up or down) to select the desired item.

性別を選ぶ

- 男性
 女性

2. Press (Set).

性別を選ぶ

- 男性
 女性

■ To select the item by checking the check box

1. Press (up or down) to select the desired item.

地域を選ぶ

- 北海道 東京
東北 大阪
関東

2. Press (Set).

地域を選ぶ

- 北海道 東京
東北 大阪
関東

■ To select the item from pull-down menu

1. Press (up or down) to select the desired item.

性別は？

男性

2. Press (Set).

- The choice (pull-down menu) is displayed.

性別は？

男性
女性

3. Press (up or down) to select the desired item.

4. Press (Set).

Specifications

KX-L6CL/L6CW	Main unit	Portable handset	Battery charger
Power supply	AC 100 V (50 Hz/60 Hz)	Ni-Cd battery (Part no. KX-FAN37) DC 2.4 V, 600 mAh	AC adaptor (Part no. PFAP1009) AC 100 V (50 Hz/60 Hz) DC 7.5 V, 100 mA
Power consumption	Transmission: Approx. 21 W Reception: Approx. 19 W Copy: Approx. 20 W Stand by: Approx. 2.0 W Maximum(*1): Approx. 100 W		<ul style="list-style-type: none"> • Charging: Approx. 1.1 W • Stand by: Approx. 0.4 W
Dimensions (H x W x D)	Approx. 151 X 344 X 262 mm (without projections) Approx. 378 X 344 X 310 mm (recording paper tray installed, without projections)	Approx. 181 X 44 X 40 mm (without projections) Approx. 190 X 44 X 40 mm (included call/charge indicator)	Approx. 72 X 72 X 90 mm
Mass (Weight)	Approx. 4.3 kg (10 m ink film installed)	Approx. 170 g (battery installed)	Approx. 77 g
Operating environment	5 °C – 35 °C, 45 % – 85 % RH (Relative Humidity)		

KX-L6CL/L6CW	Main unit
Applicable line	Public Switch Telephone Network (Tone/Pulse), F-Net, NCC Lines
DC resistance	249 Ω
Compatibility	G3 compatible
Document size	B4 – A5 (Max. 257 – Min. 146 mm in width, Max. 800 – Min. 128 mm in length)
Effective scanning size	252 mm (B4) 208 mm (A4)
Effective printing size	202 mm (A4 size plain paper)
Transmission time	Approx. 15 s/page (Original mode) (*2)
Modem speed	9,600 / 7,200 / 4,800 / 2,400 bps; Automatic fallback
Halftone level	64-level
Scanning density	Horizontal: 8 pels/mm Vertical: 7.7 lines/mm (Fine/Photo), 3.85 lines/mm (Standard)
Scanner type	Contact image sensor
Printer type	Thermal transfer printing on plain paper
Data compression system	Modified Huffman (MH), Original mode
Recording paper size	A4: 210 mm x 297 mm (Plain paper)
Error correction method	ECM
Answering device	Greeting message: Digital recording system Pre-recording greeting message ICM Recording: Digital recording system (Approx. 18 min. in total)
Memory capacity	Max. Approx. 96 pages (Only receiving fax etc.) (*3) Max. Approx. 18 min. (Only recording message) (*4)

*1 When copying a 100% black document.

*2 Transmission speed is based on an A4-size document sent in standard resolution at 9,600 bps. The actual transmission speed depends upon the contents of the page, resolution, telephone line conditions and capability of the other party's machine.

*3 The memory capacity is based on an A4-size document of 700 characters.

*4 If there is a silent pause, the total recording time will be longer.

Free Manuals Download Website

<http://myh66.com>

<http://usermanuals.us>

<http://www.somanuals.com>

<http://www.4manuals.cc>

<http://www.manual-lib.com>

<http://www.404manual.com>

<http://www.luxmanual.com>

<http://aubethermostatmanual.com>

Golf course search by state

<http://golfingnear.com>

Email search by domain

<http://emailbydomain.com>

Auto manuals search

<http://auto.somanuals.com>

TV manuals search

<http://tv.somanuals.com>