

USB/SD BELT DRIVE TURNTABLE PLAYER

PLTTB9U

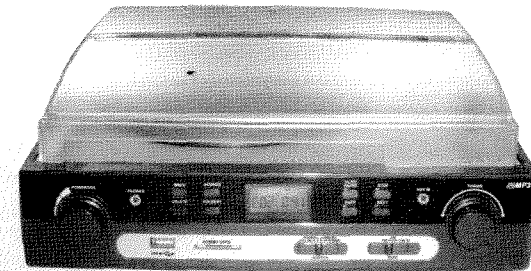

READ THIS INSTRUCTIONS CAREFULLY BEFORE USE
AND STORE IN A SAFE PLACE FOR FUTURE REFERENCE

BEFORE USE

Read this before operation

- Choose the installation location of your unit carefully. Avoid placing it in direct sunlight or close to a source of heat. Also avoid locations subject to vibrations and excessive dust, heat, cold or moisture.
- The ventilation holes should not be covered. Make sure there is enough space above and beside the amplifier/receiver (about 4 hours). Do not place a CD player or other equipment on top of the Turntable Player/Recorder/
- Do not open the cabinet as this might result in damage to the circuitry or electrical shock. If a foreign object gets into the set. Contact you dealer.
- When removing the power plug, never yank the cord.
- Do not attempt to clean the unit with the chemical solvents as this might damage the finish. Use a clean, dry cloth.
- Keep this manual in a safe place for future reference.



CAUTION
RISK OF ELECTRIC SHOCK
DO NOT OPEN



CAUTION : TO REDUCE THE RISK OF ELECTRIC SHOCK DO NOT REMOVE COVER (OR BACK). NO USER SERVICEABLE PARTS INSIDE, REFER SERVICING TO QUALIFIED SERVICE PERSONNEL.

DAANGEROUS VOLTAGE



Conducts dangerous voltage, that may be of sufficient magnitude to constitute a risk of electric shock to persons present within this product's enclosure.

ATTENTION



The owner's manual contains important operating and maintenance instructions, for your safety, it is necessary to refer to the manual.

WARNING : TO PREVENT FIRE OR SHOCK HAZARD, DO NOT EXPOSE THIS APPLIANCE TO DRIPPING OR SPLASHING.

Note :

This unit will become warm when used for a long period of time. This is normal and does not indicate a problem with the unit.

Automatic Stereo Turntable System

Installation and Operation

CAUTION: To avoid stylus damage, make certain the included stylus guard is in place whenever the turntable is being installed, moved or cleaned.

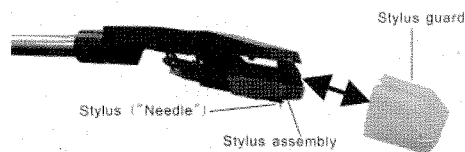

The turntable features:

1. 3-speed turntable fit for 33 1/3, 45, 78 RPM
2. belt-drive and semi-automatic play tone arm
4. ceramic stereo cartridge with jewel stylus
5. built-in 45 rpm adapter
6. slot-in USB/SD/MMC for encoding & decoding
7. analog AM/FM/FM stereo radio
7. Aux in and headphone sockets
8. full range stereo speakers
9. removable semi transparent plastic dust cover

LOCATION OF CONTROLS

1. Transparent dust cover
2. 45rpm adapter
3. Tone arm set
4. Full range dynamic stereo speakers
5. Play/pause lift lever
6. Auto/manual stop switch
7. Speed switch
8. Power/Volume knob
9. Tuner knob
10. USB socket
11. USB/MMC socket
12. Function switch
13. Tuner BAND switch
14. Headphone jack
15. Aux in jack
16. REC key
17. SOURCE key
18. DELETE key
19. FOLDER+ key
20. PLAY/PAUSE key
21. STOP key
22. PREV key
23. NEXT key
24. Diamond cartridge
25. The big platter

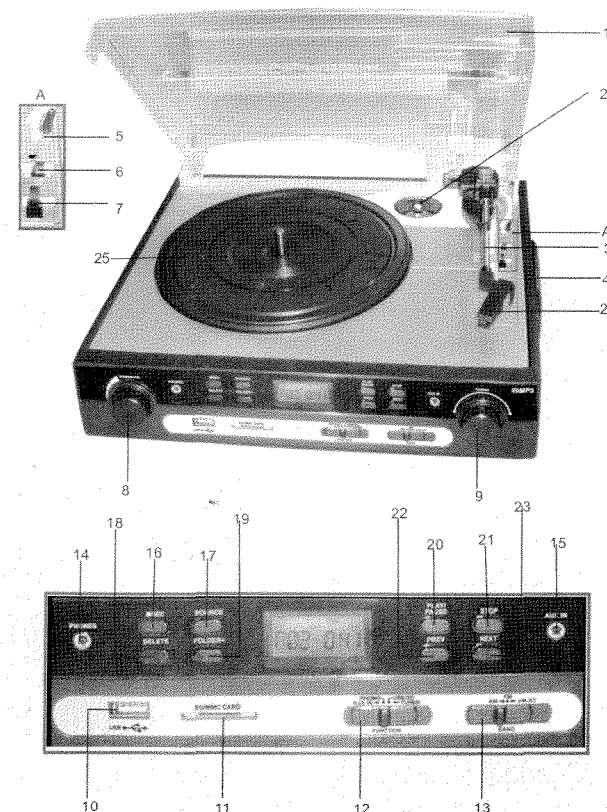

CAUTION:

Usage of controls or adjustments or performance of procedures other than those specified herein may result in hazardous radiation exposure.

This unit should not be adjusted or repaired by anyone except qualified service personnel.

CONNECTION

1. Connect the power cord to AC outlet
2. Switch the function selector to PHONO or USB/SD or TUNER function. Now your system is ready to play the music.

FM/AM OPERATION

1. Set FUNCTION switch to TUNER mode, then choose needed band (AM, FM and FM stereo) by BAND switch.
2. Search stations: Rotate the TUNER knob to choose request station, or press PREV/NEXT keys to choose idea stations. User can also press one of the two keys a little longer around 1.5s then the model will search automatically and it would stop at a clearest station.

PHONO OPERATION

1. Press the Function switch to PHONO position. Then put a record on the Platter lightly. In certain circumstances, 45 RPM adapter is needed;
2. Select the speed of record: 33 1/3, 45, 78rpm according to vinyl to played.
3. Remove the stylus guard and push the lift lever upward to raise the tone arm from the arm park, and then move the cartridge holder over the record gently, now the platter will run automatically (default set of Auto/Manual stop switch at ON position). Then put down the lever, the tone arm would drop and touch record surface gently. Now users can enjoy their favorite sons.
4. Select the auto/manual stop control: The turntable will stop automatically while the song on the record finished when the switch at ON position. The other side it will always play when it is at OFF position, this may helps to play some long recorded vinyl which can not be played to the end by normal way.
5. Rotate the volume control knob to get desired sound level.
6. Push the arm lift lever up to raise the arm, now platter will still running but play will pause. To continue the play, user just need to put down the lever.
7. Record vinyl: Firstly insert memory device (USB drive mp3 player or SD /MMC card). When turntable is working, press the REC key on front control board of the unit, then press SOURCE key to choose USB or CARD mode, later press REC key again now recording works will begin. To finish the work just need to press the STOP key.

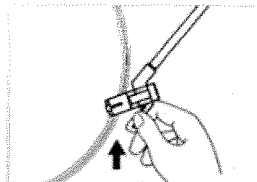

Note: Recorded file in mp3 format with 128bit.

USB/SD RECORDING AND PLAYING

PLAYING THE MUSIC FROM USB/SD/MMC DIRECTLY:

1. Be sure power is on, insert USB drive or Mp3 player into USB port and/or insert MEMORY

CARD (SD/MMC) into SD socket.

2. Set FUNCTION switch to USB/SD position, press SOURCE key to choose music source USB or SD.
3. The device supports for Mp3 and WMA formats. During play status, press PLAY/PAUSE button once to halt playing, press it again to continue.
4. Press PREV once to play the preview song, hold down continuously to speed up selecting backward. Press NEXT once to play next one, holds down continuously to speed up selecting forward.
5. Press FOLDER+ key, the unit will search music files from first folder to the last one on memory devices, then press continually to recycle overview all folders.
6. Press STOP to end up the play.

RECORD OPERATION:

1. Select Audio source: PHONO or External audio source through AUX IN jack and play it on.
2. Insert USB drive and/or memory card.
3. Now press REC key and press SOURCE to choose memory type USB or SD. Then press REC once again, it will start working now.
4. Press STOP key to end up the work..

Note:

The device also support for transit music files between SD and USB. Steps are similar to above operation.

The device supports for Mp3 and WMA formats playback.

PHONES OUTPUT/EARPHONE JACK

1. The turntable can be connected to amplifier or speakers by 3.5mm HEADPHONE jack.
2. Private listen of earphone also can be realized through this jack.

AUX IN JACK

1. The external sound sourcing can be played and recorded through the device.
2. The external sound sourcing can be recorded to the U stick or SD through the sockets..

REPLACING STYLUS

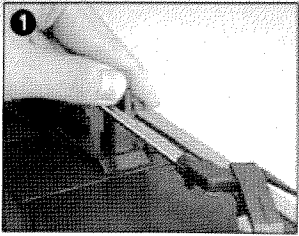

1. push the arm lock to release the tone arm.

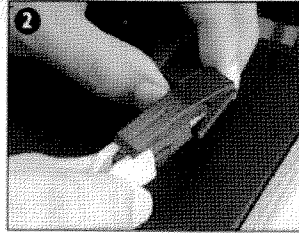

2. take off cap of the cartridge to expose the needle out.

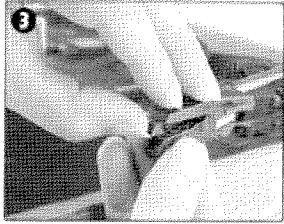

1. separate the cartridge from the socket lightly
2. take off the audio-line from the cartridge completely

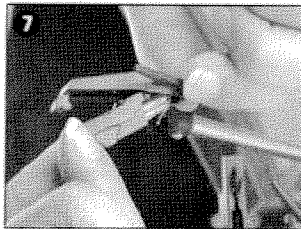
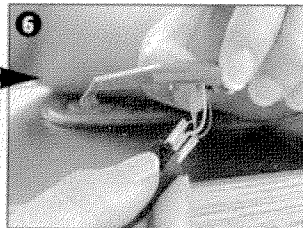
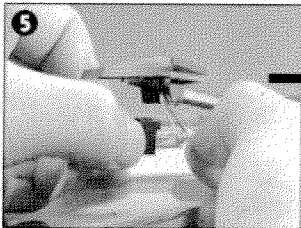
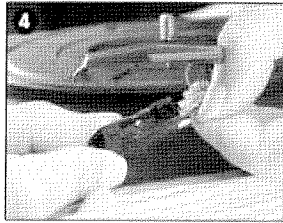

5. to fit a new cartridge just in opposite deals. Insert the audio-line accordingly, and install the cartridge to the socket lightly.

TIPS FOR BETTER PERFORMANCE

1. When opening or closing the turntable cover, handle it gently, moving it either at the center or equally from both sides.
2. Do not touch the stylus tip with your fingers; avoid bumping the stylus on the turntable mat or a

record's edge

3. Clean the stylus tip frequently, using a soft brush with a back-to-front motion only.
4. If you use a stylus cleaning fluid, use it very sparingly.
5. Wipe the dust cover and turntable housing gently with a soft cloth. Use only a small amount of mild detergent solution to clean the turntable and dust cover.
6. Never apply harsh chemicals or solvents to any part of the turntable system.
7. Prior to moving the turntable, always unplug it from the AC outlet and fasten the tone arm on the tone arm rest with the vinyl twist-tie.

MAINTENANCE AND CARE

Caring for the player

- Apparatus shall not be exposed to dripping or splashing and no objects filled with liquids, such as vases, shall be placed on the apparatus.
- The maximum ambient temperature: 35°C
- Electronic products of this kind should never be subjected to extreme temperatures or high humidity. For instance, this set should not be placed in bathing areas or around stoves and radiators.
- If anything falls into the cabinet, unplug the unit and have it checked by qualified personnel before operating it any further.

Cleaning the Unit

- To prevent fire or shock hazard, disconnect your unit from the AC power source when cleaning.
- The finish on your unit may be cleaned with a dust cloth and cared for as other furniture. Use caution when cleaning and wiping the plastic parts.
- Mild soap and a damp cloth may be used on the front panel.

Inclination

- Do not install the unit in a inclined position, It is designed to be operated in a horizontal position only.

Condensation

- If the unit is brought directly from a cold to a warm location, moisture may condense inside the player, and cause damage it. When you first install the unit, or when you move it from a cold to a warm location, wait for 30 minutes before operating the unit.

Disconnect Power

- If you are not going to use the player for long time, be sure do disconnect the player from the AC power source.

Free Manuals Download Website

<http://myh66.com>

<http://usermanuals.us>

<http://www.somanuals.com>

<http://www.4manuals.cc>

<http://www.manual-lib.com>

<http://www.404manual.com>

<http://www.luxmanual.com>

<http://aubethermostatmanual.com>

Golf course search by state

<http://golfingnear.com>

Email search by domain

<http://emailbydomain.com>

Auto manuals search

<http://auto.somanuals.com>

TV manuals search

<http://tv.somanuals.com>