

PYLE[®] **view**

2-DIN TFT-LCD Monitor with TV/Radio tuner

PL2DNTV7

Owner's manual

Please read it before using this equipment.

www.pyleaudio.com

CONTENTS

Welcome	1
Features	1
General Specifications	1
Operating Instructions.....	1
Safety Precautions	2
Display care & cleaning.....	2
Remote control button function.....	3
Using remote control.....	6
Front panel Button control.....	7
Basic operation.....	9
Connection Layout	13
Connect to your car.....	13
Troubleshooting	14

WELCOME

Thank you for purchasing the TFT-LCD wide screen MONITOR.
We are grateful for your support.

Please read this user's manual in its entirety before operating the unit.
After reading this manual, be sure to keep it in a handy place for future reference.
Check the contents of the enclosed warranty card and keep it carefully with this manual.

FEATURES

- 7" Wide-Screen Display Panel
- Auto Switch NTSC and PAL
- High Brightness: 450 cd/m²
- Telephone Mute Control
- Headlight Control
- Auto Radio Antenna Control
- Password Protection
- Adjustable Color/Contrast/Brightness/Tint
- IR Remote Control
- On Screen Display
- AM/FM Radio Tuner
- Radio Data System (RDS)
- 4 Channels x 40Watt Amplifier
- SANYO DVD/VCD/CD Changer Control
- Support RGB Input
- 3 RCA Video Input (for Rear View Camera, DVD changer and AUX)
- 2 RCA Stereo Audio Input
- 1 RCA Video Output
- 4 Channels Line-Out

General Specifications

Power Source:	Car Battery (DC 9-16V)
Operating Voltage:	DC 12V
Operating Current:	< 1A (Typical)
Operating Temperature:	0°C to 70°C
Storage Temperature:	-30°C to 80°C
Dimensions:	L178 x W100 x H154mm

*Specifications and design are subject to change without notice.

OPERATING INSTRUCTIONS

Please read all of these instructions regarding your LCD headrest and retain them for future reference.

1. Read this manual fully and carefully before operating the unit.
-

2. Keep this manual handy for future reference.
3. Pay close attention to all warnings in this manual and follow the instructions carefully.
4. Never allow others to use the system until they have read and understood the operation instructions.

SAFETY PRECAUTIONS

1. The unit is designed for using in DC12V, negative ground battery.
2. Do not disassemble or alter the unit in any way. Failure to do so can cause damage to the unit and invalidate your warranty.
3. Be careful not to run down the car battery while using the unit with the car engine stopped.
4. Never clean the surface of the screen with chemical solvent or corrosive detergent, which may cause permanent damage to TFT LCD screen.
5. Please note that the normal working temperature of the unit is between 0°C to 50°C. If the internal temperature of the vehicle is extremely high, a short cooling down period is necessary before operating the unit.
6. If the inside of the car is very cold and the monitor is used soon after switch on the heater, moisture may form on the unit. Turn off the unit immediately! Failure to do so may cause the internal components to short. Allow the unit to rest for about one hour to allow the condensation to disappear before continue operation.
7. In extremely cold temperatures, the movement of the picture may be slow and the picture may be dark. It is not a malfunction. The unit will work normally once it reaches its operating temperature.
8. Small black and shiny dots inside the liquid crystal panel are normal for liquid crystal panel are normal for liquid crystal product.
9. Do not drop or hit the LCD panel with a hard object, as it may cause permanent damage to the LCD panel. If you come into contact with the fluid, do flush and clean effect areas with plenty of water and seek medical attention immediately.
10. Kindly refer to authorized dealers if you get any questions.

DISPLAY CARE & CLEANING

- Wipe off dust gently with a soft, dry cloth.
- Avoid scratching: do not rub the display with hard objects.
- Do not use any chemical solvent, cleaning agent or corrosive detergent to clean the display and unit.

CAUTION! The material of display area is made by glass with a protector film attached on it. Do not use hard or sharp objects to strike or scratch the surface of the display area. Otherwise it may cause the picture distorted or have scars forever.

Remote Control Button Functions

1. Power

Turn on or off this unit.

2. Setup

(1) DVD/CD changer mode
DVD built-in functions menu (refer to SANYO DVD/CD changer Specification)

3. Up/Down

(1) DVD changer mode
It is the up/down button under **Setup/Menu** status.
Press and hold this button to choose the Previous/Next disc.
(2) TV mode
To choose the previous/next pre-set station

4. SEL (Selection)

(1) Press this button, to select

- Initial volume setup
- TA volume setup
- Bass adjustment(use VOL+/- to adjust)
- Treble adjustment(use VOL+/- to adjust)
- Balance adjustment(use VOL+/- to adjust)
- Fader adjustment (use VOL+/- to adjust)

(2) Push and hold this button to select

- Loud on/off

5. Enter

(1) under DVD menu state, to confirm your selected item.
(2) TV mode, press this button to affirm after input 0~9.

6. Left / Right

When startup the **Setup/Menu/P. Menu** function, to reduce/increase the system value or choose in the left/right direction.

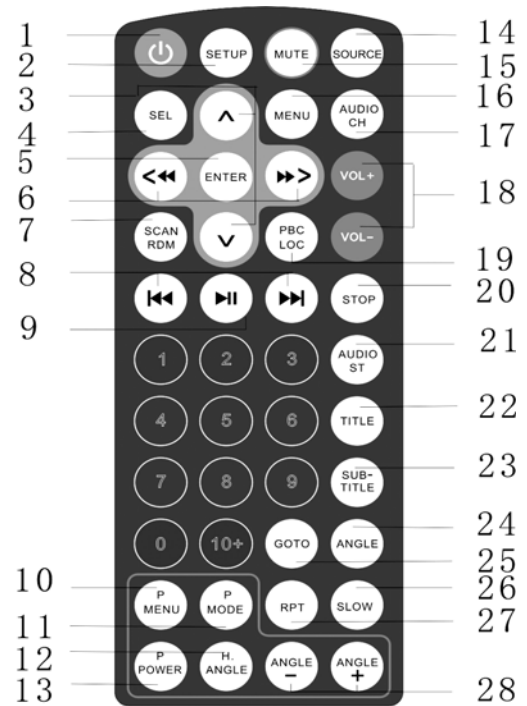

7. Scan /RDM

(1) DVD/CD changer mode

Press this button to switch scan on/off,
Press and hold to switch random on/off.

(2) Radio mode

Press this button to scan any available frequency and play each one in 5 seconds.

*During playing, will play the current frequency if you press this button again; if press other button, will stop this function and play the frequency at beginning of scan.

*During scanning, will stop scanning function and play the frequency at beginning of scan.

8. Previous/Next

(1) Under DVD/CD changer mode

Press this button to select the previous chapter/track or the next chapter/track;
Press and hold this button to fast forward or fast reverse.

(2) Under TV/Radio mode

Press this button to search by step or fine tune;

Press and hold this button to automatically search the previous station or the next station.

9. Play/Pause

(1) Under DVD/CD changer mode, to pause the playback or resume the playback.

10. P. Menu

(1) TFT-LCD display: picture adjustment (Brightness, Color, Contrast, Tint),
and select PAL/NTSC/AUTO.

(2) Including all functions on the SEL button.

11. P. Mode

TFT-LCD Display mode (Full, Normal).

12. H. Angle

It's not available.

13. P. Power

It's not available.

14. Source

(1) To select the mode in the following order:

Radio > TV > DVD > AUX IN > RGB IN > Radio

* The original mode is Radio mode.

15. Mute

mute on/off.

16. Menu/Band

(1) CDC mode

Return to the DVD main menu during playing DVD media.

(2) Radio mode

To switch the band in the follows order:

FM1 > FM2 > FM3 > MW1 > MW2

press and hold this button to automatically search all stations and store the stations on band FM3 or MW2.

17. Audio CH

Select Tone:

JAZZ-ROCK-CLASSIC-POP-VOCAL-FLAT-EQ OFF.

18. VOL+ / -

To increase volume or reduce volume.

19. PBC/LOC

(1) CDC mode

To select play mode: PBC on/PCB off.

(2) Radio mode

As PS function, to scan all pre-set station of the current band (M1~M6, step: 5seconds).

20. Stop

(1) CDC mode

To stop playback.

21. Audio

(1) CDC mode,

To select audio language when playing DVD disc.

(2) Radio mode

To select stereo / mono

22. Title

Under CDC mode, to display DVD title during playing DVD media.

23. Sub-Title

Under CDC mode, to select sub-title language during playing DVD media.

24. Angle

It's only available when playing DVD disc, which recorded some pictures from different angles. Press it to select from different filming angles stored on the DVD media during playback.

25. Go to

Under CDC mode, to select playtime and desired chapter.

26. Slow

It is not available.

27. RPT

Under DVD mode, allows the user to repeat playback:
repeat mode: disc, track/chapter

28. Angle + / -

It is not available.

USING REMOTE CONTROL

Aim the IR remote control directly at the unit, or video source with an IR input.

Tips:

- Maximum IR distance is 3 meters from the sensor.
- Direct sunlight or very bright light reduces sensitivity to the IR remote signal commands. Make sure the monitor is not located in direct sunlight.
- Obstruction between the remote sensor and remote control may disrupt reception.

BATTERY

If the remote control does not function the operating range is shortened, please change to a new battery.

1. Pull out the battery holder.

Follow the arrow 1 slide it to the right toward the battery while at the same time pull the battery holder away from the remote control.

2. Insert a new battery with the (+) side up. (The type of battery: Crd2025).

3. Push to close the holder.

You will hear a small clicks as the tray locks.

Batteries contain chemical substances, so they should be disposed of properly.

Tips:

- *Remove batteries if they are empty or if the remote control will not be used for a long time.*
- *Battery and small parts can be a choking hazard. Keep the remote control away from young children.*

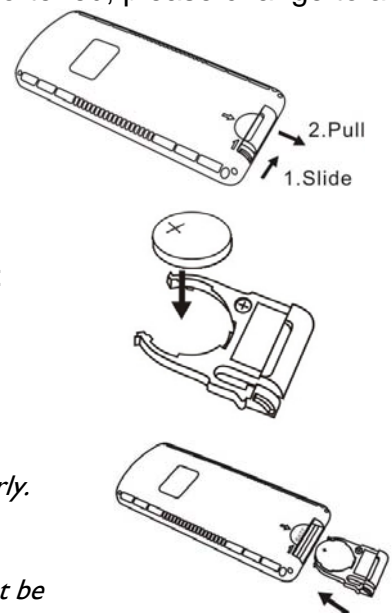

Front panel Button control



1. Remote sensor
2. Power ON/OFF (⏻)
3. Mode
4. Next/Down (⏪)
5. Previous/ UP (⏩)
6. Play / Pause (⏸)
7. CDC
8. Menu (📖)
9. Volume +/- or adjustment

1) **Remote sensor**

For remote control.

2) **Power on/off** ⏻

Press this power switch, the LCD monitor will turn on. Press again; the monitor will turn to "Mute on/off" mode. Press and hold for 3 seconds, the monitor will turn off.

3) **Mode**

Select the input signal source.

Radio > TV > DVD >AUX IN >RGB IN > Radio

4) **Next / Down** (⏪)

1.Press this button to select the item down under menu state.

2. Press this button to select the next track/chapter when playing disc under DVD mode, and hold to fast forward until you release it.
3. To select the Next preset station under Radio mode.
4. To fine the current program under TV mode.

5) Previous / UP (▶▶)

1. Press this button to select the item up under menu state.
2. Press this button to select the previous track/chapter when playing disc under DVD mode, and hold to fast backward until you release it.
3. To select the previous preset station under Radio mode.
4. To fine the current program under TV mode.

6) Play /Pause (▶||)

1. To play or pause the playback when playing disc.
2. under Radio and TV mode, press it to auto search stations and auto store them in memory.

7) CDC

To directly select the DVD mode.

8) Menu (☰)

Press it to setup initial volume, TA VOL, BASS, TREBLE, BALANCE, FADER.
Hold it to enter the system menu, and you can use [▶▶] and [◀◀] to select the item you like to adjust, and then use [- /+] to adjust the system value.

9) VOL - /+ or adjustment

Press it to reduce or increase the volume.
Press it under menu state to adjust the system value.

Basic Operation

System adjustment

Press [MODE] to change the mode from AUX IN, RGB IN, REAR VIEW, RADIO MODE, TV MODE and DVD MODE.

AUX IN

It will display "NO SIGNAL" when there is no AUX in.

RGB IN

It will display "NO SIGNAL" when there is no RGB in.

REAR VIEW

It will display "NO SIGNAL" when there is no rear view in.

RADIO MODE

When you enter radio mode, it will display as below:

RADIO	INFORMATION
BAND	FM1
RREQ	87.5MHZ
CHANNEL	PRESET 6
PS	
PTY	NONE
TA/AF/PTY/REG/EON	
LISTENING	

It will display "STERED" behind "LISTENING" when broadcasting a program.

When you select band of "MW1" or "MW2", "TA/AF/PTY/REG/EON" will not display on the above list.

Select stations

Press and hold [◀◀] or [▶▶] for 3 seconds to automatically search stations in the related band (such as FM1), and will automatically store the stations of strongest signal in related band; or press and hold [▶▶] for 3 seconds to search stations automatically and then will automatically store 6 stations of strongest signal in FM3.

Value adjustment

Press [□] repeatedly to change from Volume >TA VOL >Bass>Treble>Balance>Fader. You can change the value of these five items by pressing [+] and [-].

Press and hold [□] to activate the system menu.

BUZZER MODE -----500Hz

DISP MODE -----FULL

PASSWORD-----OFF

DISP TIME -----OFF
ADJ TIME -----00:25
RADIO AREA -----EUROPE
TV SYSTEM -----C.C.I.R
EXIT

And then, press [□] again; it will display another page as below:

RDS TA/TP -----OFF
RDS AF -----OFF
RDS PTY -----OFF
SEARCH PTY -----NEWS
RDS REG -----OFF
RDS EON -----ON
EXIT

You can adjust the values by pressing [▶▶] and [◀◀] as below in case of entering the related page.

BUZZER MODE: Select Off, 500Hz, 1KHz, 2KHz

DISP MODE: Select the Display mode: FULL NORMAL

PASSWORD: Password protection, select On/ Off

DISP TIME: Display current time, select On/Off

ADJ TIME: Time adjustment

RADIO AREA: Select the radio area: EUROPE, China, U.S.A, TAIWAN

TV SYSTEM: Select the TV system, C.C.I.R, U.S.A, China, Italy, Australia.

EXIT: To exit adjustment of this page

RDS TA/TP: Selecting OFF or ON

RDS AF: Selecting OFF or ON

RDS PTY: Selecting OFF or ON

SEARCH PTY: Selecting from

News>Affairs>Info>Sport>Educate>Drama>Culture>Science>Varied>
Pop M>Rock M>Easy M>Light M>Classics>Other M
>Weather>Finance>Children>Social>Religion>Phone in
>Travel>Leisure>Jazz>Country>Nation M>Oldies>Folk M
>Document>Test>Alarm.

RDS REG: Selecting OFF or ON

RDS EON: Selecting OFF or ON

EXIT: To exit adjustment of this page

Band change

You can change the bands from FM1, FM2, FM3, MW1 and MW2 by pressing [▶||] repeatedly.

EQ adjustment

Press [□] repeatedly when there is playing a program to change from Volume, TA VOL, Bass, Treble, Balance or Fader. And then press [+] and [-] to adjust the value of related EQ option above.



TV MODE

Select stations

Press and hold [▶▶] or [◀◀] for 3 seconds to automatically search stations and it will automatically store the stations of strongest signal in related band; or press and hold [▶||] for 3 seconds to search stations automatically and then it will automatically store stations of strongest signal.

If you want to stop searching, press and hold [▶||] for 3 seconds again.

Select the display mode FULL or NORMAL with menu.

Display Mode	Display	Note
Full		Input video signals 16:9 picture is fully displayed on screen.
Normal		When 4:3 picture is played on wide screen, black bands appear on both side of the picture.

Picture adjustment

Press and hold [□] to active the menu when there are some pictures on display.

You can use [▶▶] and [◀◀] to select the item you would like to adjust, and then use [-/+]
to adjust it.

COLOR -----18
CONTRAST-----18
BRIGHTNESS-----18
TINT-----18
NTSC PAL -----AUTO
RESET
EXIT

COLOR: Color adjustment

CONTRAST: Contrast adjustment

BRIGHTNESS: Brightness setting

TINT: Adjustment to color saturation

NTSC PAL: Select NTSC, PAL or AUTO format

RESET: Reset above menu to default value

EXIT: exit the menu

EQ adjustment

Press [EQ] repeatedly when there are some pictures on display to change from Volume, TA VOL, Bass, Treble, Balance or Fader. And then press [+] and [-] to adjust the value of related EQ option above.

CDC MODE

When you select CDC mode, it will display as below:

CDC	INFORMATION	
DISC No.:	01	
TRACK No.:	01	
PLAY TIME:	00:00	
PLAY MODE:	Repeat	OFF
	Intro	OFF
	Random	OFF
STATUS	DISC PLAY	

Note: When it is playing a disc, it will display “DISC PLAY” behind “STATUS” on the screen, and when it is changing discs, it will display “DISC CHANGE” behind “STATUS” on the screen.

EQ adjustment

Press [EQ] repeatedly when there is playing a program to change from Volume, TA VOL, Bass, Treble, Balance or Fader. And then press [+] and [-] to adjust the value of related EQ option above.

Change disc

Press and hold [▶▶] to change to next disc and press and hold [CDC] to change to previous disc.

Select track

You can select the desired track by pressing [▶▶] and [◀◀] repeatedly when a disc is playing.

Connection Layout

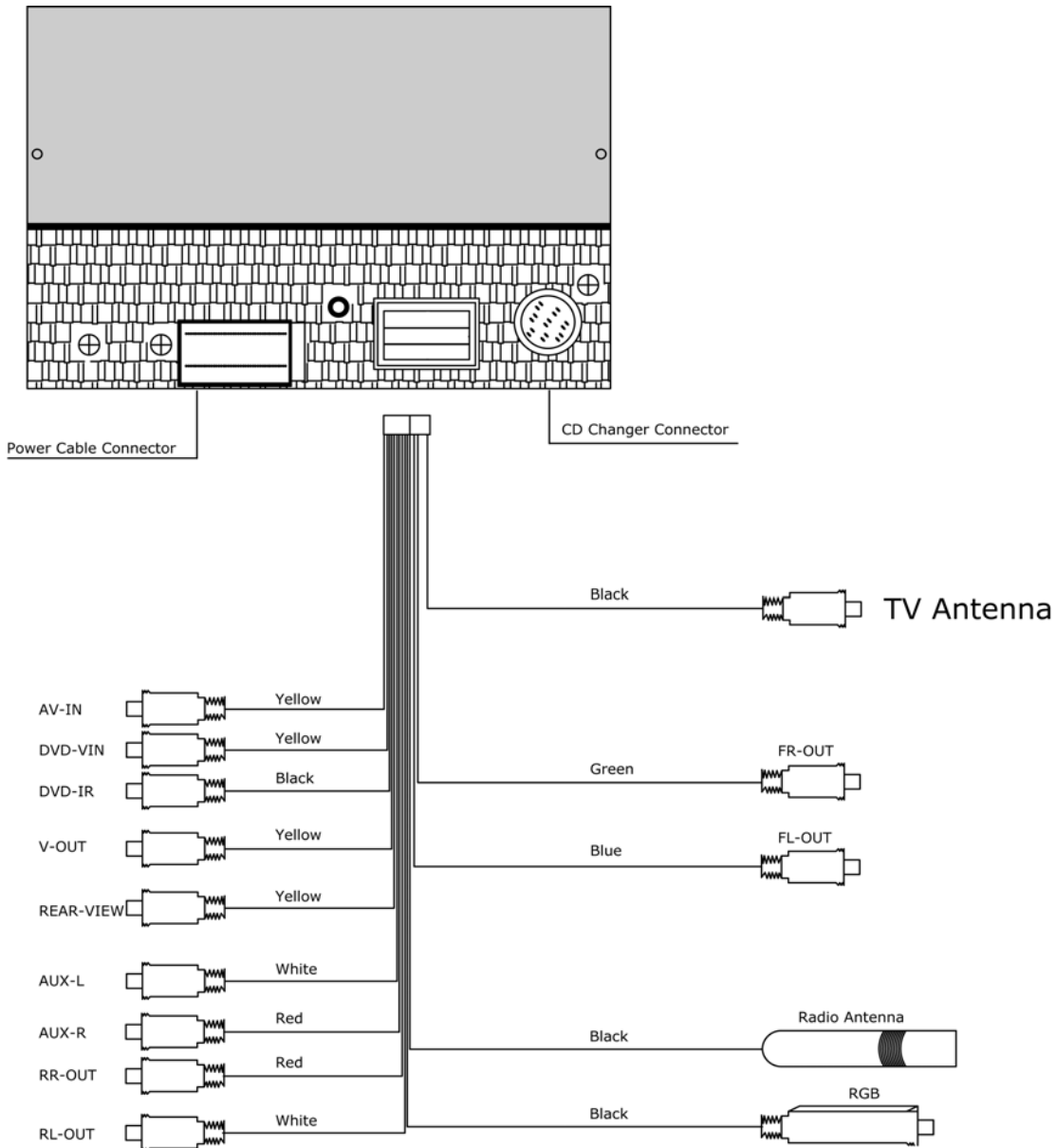

Connect to your car

1. To prevent short circuits, remove the key from the ignition and disconnected the terminal of the battery.
2. Connect the wiring harness cables in the following order: ground wire, battery wire, ignition wire. Connect the input and output cable correctly to each unit.
3. Connect the wiring harness connector to the monitor unit.

4. Reconnect the terminal of the battery of procedure.

Notes

- If your vehicle ignition does not come with an ACC position, connect the ignition cables to a power source that can be turned on and turned off with the ignition key. If you connect the ignition cable to a power source that receives a constant voltage supply, as with battery cable, the battery may be overloaded.
- If the fuse blows, first check whether the cables have caused a short circuit or not, then replace the old fuse with a new one of the same type.
- Do not let unconnected cables or terminals touch the metal on the car or anything else conducting electricity. Besides, to prevent short circuits, do not remove the caps from unused terminals or from the ends of the unconnected cables.
- After the monitor unit is installed, please check whether the brake lamps, blinkers, wipers, etc...on the vehicle can work properly.
- Please cover unconnected cables or terminals with rubberized tape or insulators.

Troubleshooting

Problems	Possible Cause	Remedy
No picture and sound when the monitor is turned on	<ol style="list-style-type: none">1. Power wire is connected improperly or fuse is blown.2. System cable isn't connected or contacts unwell.	<ol style="list-style-type: none">1. Check the power wire and replace the fuse.2. Check the system cable or replace a new one.
Blurry picture on the screen	Interfered by short-distanced strong interference (e.g. motorbike, high voltage wire, transformation station or aircraft etc...)	The reception of signal will get better immediately once leaving the interference area.
No function on the remote control (or operation distance is shortened)	<ol style="list-style-type: none">1. The battery of remote control has exhausted.2. Remote control is destroyed.	<ol style="list-style-type: none">1. Change a new rating battery.2. Contact with the dealer and then change a new remote control.
The picture on the screen is relatively dark.	The equipment locates at a low temperature area.	This is the character of LCD monitor in low temperature, it will restore to normal brightness after powering on the monitor for few minutes.

Free Manuals Download Website

<http://myh66.com>

<http://usermanuals.us>

<http://www.somanuals.com>

<http://www.4manuals.cc>

<http://www.manual-lib.com>

<http://www.404manual.com>

<http://www.luxmanual.com>

<http://aubethermostatmanual.com>

Golf course search by state

<http://golfingnear.com>

Email search by domain

<http://emailbydomain.com>

Auto manuals search

<http://auto.somanuals.com>

TV manuals search

<http://tv.somanuals.com>