

# PYLE® CYCLE SERIES

1600 63RD Street • Brooklyn • NY • 11204  
718 535-1800 • 800 444-5671  
Fax: 718 236-2400  
www.pyleaudio.com

# PYLE® CYCLE SERIES

**PLBKA100BK** 100 Watts Waterproof Portable Bicycle/Scooter MP3/  
Ipod Music Player (Black)

**PLBKA100SL** 100 Watts Waterproof Portable Bicycle/Scooter MP3/  
Ipod Music Player (Silver)



**USER'S MANUAL**

Congratulations on your purchase of this Pyle Cycle Series bike speaker system. Like all Pyle products, this bike speaker system has been thoroughly tested to ensure consistent, reliable performance under some rigorous conditions. Our systems were designed to withstand water, moisture, heat, and direct sun exposure. We pride ourselves in customer satisfaction. If you should have any questions regarding the installation and/or operation of your Pyle Cycle Series bike speaker system, which is not covered in this manual, please contact your Pyle Dealer or Pyle Technical Support.

### What is Included?

Upon un-packing your new Pyle Cycle Series audio system, please check to ensure you have all the included parts.

1. One piece portable MP3 loudspeaker player
2. One piece easy installation bicycle handlebar bracket.
3. One piece USB cable

### Device Features

- The high quality aluminum case is suitable for both indoor and outdoor environments.
- The internal superior Hi-Fi speaker produces excellent sound quality in both indoor and outdoor settings.
- With the special Amp. design, the speaker output quality will not decay during the life of battery.
- The internal rechargeable long-life Li-ion battery provides for extended use
- When the earphone is plugged in, the device switches from the speaker to the earphone automatically.
- Incorporating the USB, charging and earphone inputs into one jack results in an elegant appearance.
- The device supports MP3/WMA format.

### Product Specification

Model No.	PLBKA100BK/PLBKA100SL		
Speaker output	THD+N=0.15%	@ 1.5W	
	SNR=94dB	@ 1.5W	
Earphone Output	THD+N=0.6%	@ 32Ω	
	SNR = 92 dB	@ 32Ω	
Playing Time	Speaker: 8.5 hours(depends on the playing volume)		
	Earphone : 55 hours		
Charging Time	USB: 8 hours		
	USB(5V/1A) A/C commercial adaptor:3 hours		
Capacity	2G		
Interface	USB 2.0 Full speed		
File System	FAT16 / FAT32		
Music Format	MP3 / WMA (Below 384 kbps)		
Temperature	Function within -10°C - 50°C		
Size/Dimension	100 x 40 x 40 mm		
Weight	240g		

### Button Operations

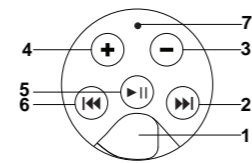

1. Shared Earphone/POWER/USB 3.5mm input with cover
2. SKIP Forward
3. VOLUME Decrease
4. VOLUME Increase
5. POWER On or Off, and Play or Pause
6. SKIP Backward
7. LED status indicator

### Charging the Device

- The device needs to be fully charged before its initial use 8 hours.
- To charge the battery, use the 3.5mm/USB cable.
- Attach the 3.5mm connector at one end of the cable to the device and the USB at the other end to a computer.
- The LED indicator will illuminate during charging, and it will go out when the device is fully charged.
- The device will shut off automatically when the USB cable is disconnected (including during charging or data transmission).

### Downloading Music

- Connect the device to a computer through the USB cable. The device can then be operated as a flash drive for downloading music.
- It is recommended to create separate folders for a variety of music and for easy access and downloading.
- The WMA format supports Window Media Audio up to and including version 9. It does not support "Digital Right Management (DRM)" format.

### Instructions for Operating the Device

1. Power on : Pressing the ►|| button lightly, the device will play song automatically after the LED indicator stays on for approximately 3 seconds.
2. Power off : Pressing the ►|| button for about 3 seconds, the LED indicator will flash rapidly and go out and the device is turned off.
3. Pause: Pressing the ►|| button lightly during playing will cause the LED to stay on and the player will enter the "Pause" mode. Pressing the ►|| button lightly again will return the player to normal play status. Please note that the system will turn itself off automatically after 1 minutes in "Pause" mode.
4. Change songs during the playing:
  - Pressing the ►► button lightly, the device will skip to the next song.
  - Pressing the ◀◀ button lightly, the device will skip to previous song.

### The LED Indicator

- The LED indicator will flash once every second when the device is playing normally.
- While no song in the memory, the LED indicator will illuminate for two seconds and flashes for one minute until the device shut down.
- The LED indicator will flash rapidly when the battery is low and it continues to flash rapidly until the battery is dead.
- The LED indicator flashes when the battery is charging and stays on when the charging is completed.
- The LED indicator will continue to flash while the songs are being downloaded.

### Trouble Shooting

- The LED indicator is functioning normally, but there is no sound: Check whether or not the earphone is plugged in and that the USB cable is still connected.
- When the device is not playing normally or behave abnormally when connected to the computer: Charge the device for approximately 30 minutes and then Reset the system.

### Installation Instructions

Securing the MP3 loudspeaker player into the handlebar bracket.

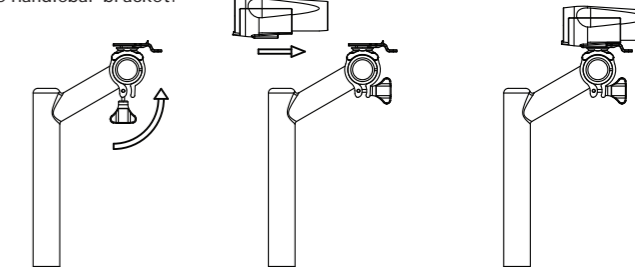

Releasing the MP3 loudspeaker player from the handlebar bracket.

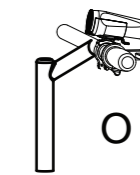
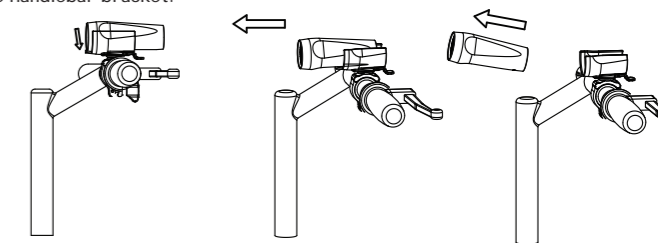

Correct angle

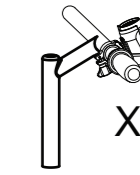

Wrong angle

## Free Manuals Download Website

<http://myh66.com>

<http://usermanuals.us>

<http://www.somanuals.com>

<http://www.4manuals.cc>

<http://www.manual-lib.com>

<http://www.404manual.com>

<http://www.luxmanual.com>

<http://aubethermostatmanual.com>

Golf course search by state

<http://golfingnear.com>

Email search by domain

<http://emailbydomain.com>

Auto manuals search

<http://auto.somanuals.com>

TV manuals search

<http://tv.somanuals.com>