

BLACK



CHAMPAGNE
SILVER

MAXIMUM LOAD 40LBS (18.2KG)

www.promounts.com

Universal Articulating Mount for 10" to 24" flat panels

An articulated and retractable wall mount for small flat panel displays up to **40lbs (18.2kg)**. The dual arm design allows either flush positioning or a maximum of 15" of extension from the wall for optimum viewing from any position in the room. It may also be corner mounted for multiple room viewing. Wall attachment is to a single wood stud or concrete.

- Multi-angle and multi-position viewing
- Rotates for portrait or landscape viewing and screen leveling
- "Quick Snap" covers for complete cable management
- Attractive screw caps conceal tensioning hardware
- VESA compliant 75, 100
- All panel and wall mounting hardware included
- Manufacturer's limited lifetime warranty

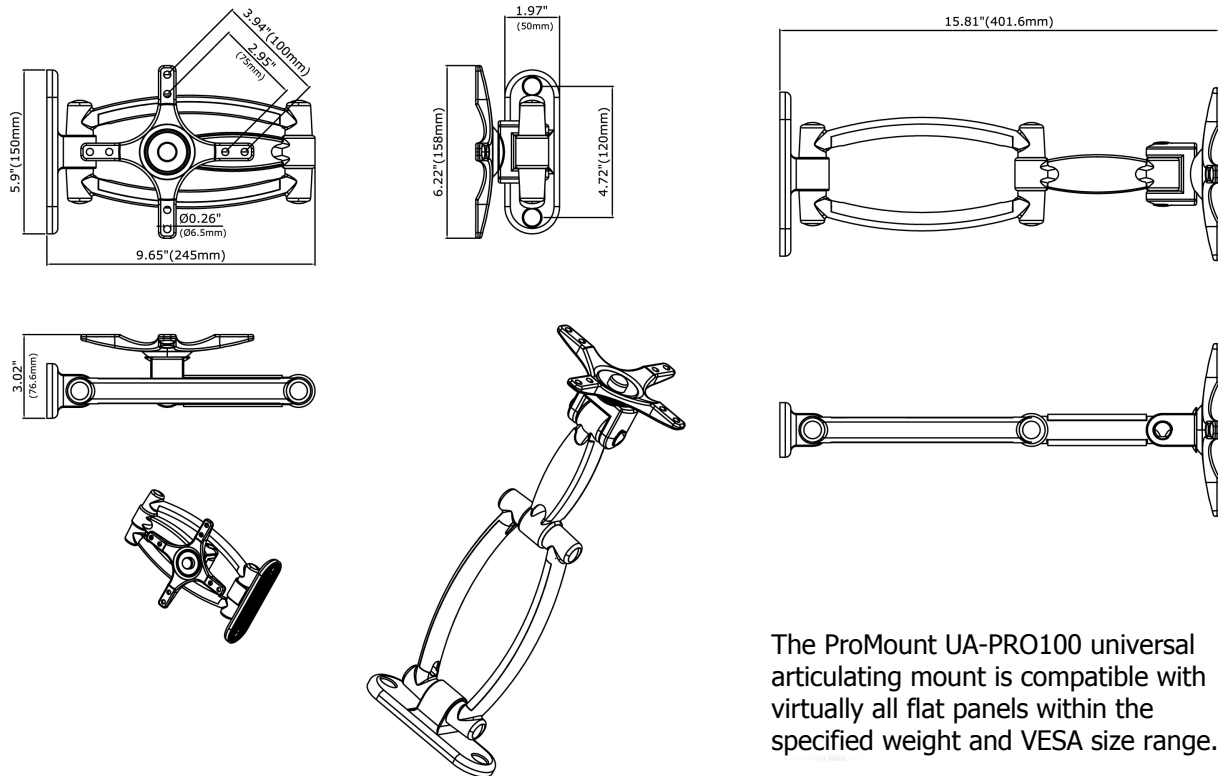

The ProMount UA-PRO100 universal articulating mount is compatible with virtually all flat panels within the specified weight and VESA size range.

MAXIMUM LOAD 40LBS (18.2KG)

Specifications

Fits most flat panels between 10" and 24"
Horizontal and vertical hole spacing:
2.95" (75mm) and 3.94" (100mm)
Tilts in any direction (360 degrees)
+20 to -20 degrees
VESA compliant: 75, 100

Weight

3.0lbs (1.4kg)

Architects and Consultants: please contact ProMounts customer service for necessary drawings and files. For complete high resolution images, technical specifications and drawings please visit www.promounts.com and click on Download Center.

ProMounts: 5741 Buckingham Parkway, Unit C, Culver City, CA 90230 **Phone:** 866 668 6872, or 310 645 6400 **Email:** info@promounts.com **Fax:** 310 645 0189 **ProMounts** is a division of Scadlock LLC

Dimensions

10.75"w x 8.5"d x 3.0"h
(273mm x 216mm x 76mm)

Wall Mounting

Single wood stud or concrete

Free Manuals Download Website

<http://myh66.com>

<http://usermanuals.us>

<http://www.somanuals.com>

<http://www.4manuals.cc>

<http://www.manual-lib.com>

<http://www.404manual.com>

<http://www.luxmanual.com>

<http://aubethermostatmanual.com>

Golf course search by state

<http://golfingnear.com>

Email search by domain

<http://emailbydomain.com>

Auto manuals search

<http://auto.somanuals.com>

TV manuals search

<http://tv.somanuals.com>