

## Performance Data for the Pelican Shower Filter PSF-1

Model	Replacement	Operating Pressure	Rated Capacity	Operating Temp	Rated Flow
PSF-1	PSF-1R	80 PSI	15,000 Gallons	115°F	2.5 GPM (High-Flow Setting)
Manufactured By: Pelican Water Systems – 3060 Performance Cir Ste 2, Deland, FL 32724 – 877-842-1635					

Congratulations on your purchase of the Pelican Premium Shower Filter. Your shower experience will never be the same again! This system has been tested according to NSF/ANSI 177 for reduction of free available chlorine by KDF Fluid Treatment Laboratory. The concentration of free available chlorine in water entering the system was reduced to a concentration less than or equal to the permissible limit for water leaving the system, as specified in NSF/ANSI 177.

The Pelican PSF-1 Shower Filter should be replaced every 9 months to ensure peak performance. If you use the filter more than twice each day, take showers longer than 10 minutes or your city uses surface (lake or river) water, it is recommended that the filter be changed more frequently. Surface water typically has higher levels of sediment and chlorine and will exhaust the filter media more rapidly.

For replacement filters for your PSF-1, please visit [www.pelicanwater.com/replacements.php](http://www.pelicanwater.com/replacements.php). We can also ship replacement filters to you on a regular basis with our **Water Shield Auto-Ship program**. No commitments, no hassles and no contracts. Cancel anytime! For more information, please visit [www.pelicanwater.com/watershield.php](http://www.pelicanwater.com/watershield.php).

In compliance with California State Law, this system has a maximum flow rate of 2.5 gallons per minute. The supplied shower head comes standard with two settings. Choose the high-flow 2.5 gallon per minute output or easily switch to the 2.0 gallon per minute water-conserving option.



***Do not use with water that is microbiologically unsafe or of unknown water quality without adequate disinfection before or after the system.***

***This system and installation shall comply with all state and local regulations.  
This system is not designed for use as a drinking water treatment system.***

For more information:  
[www.PelicanWater.com](http://www.PelicanWater.com)  
Toll free: (877) 842-1635



# Pelican Water Systems



## Installation Instructions

### PSF-1 Premium Shower Filter



[Facebook.com/PelicanWater](https://www.facebook.com/PelicanWater)

## 1 Unpack and Prepare Contents

Package contains:

- Pelican Shower Filter Body and Cartridge (already assembled)
- Pelican Shower Head
- Pelican Fragrance Block
- Plumbers Tape

 Make sure the rubber washer is in place in the chrome inlet collar

## 2 Shower Head Removal

Remove your existing shower head from the supply pipe.

## 3 Insert Fragrance Bar



## 4 Filter Attachment

1. Use plumbers tape by wrapping it 1 or 2 times around the shower pipe.
2. Attach the shower filter body to the shower pipe at the side with the chrome collar (Figure A).
3. Turn clockwise to tighten
4. Use a pair of pliers (if needed) to turn the chrome collar an additional 1/4 turn or until the filter system is firmly tightened.

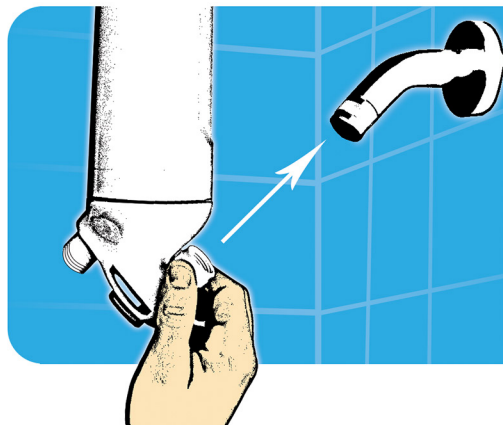

### DO NOT OVERTIGHTEN THE CHROME INLET COLLAR

Overtightening may cause the washer to compress into the inside of the shower pipe, resulting in leakage around the connector. If this occurs, unscrew the chrome inlet collar from the pipe, reinstall the washer and reconnect the shower pipe.

Figure A

## 5 Flush and Activate Filter Until Water Runs Clear

1. Use cold water for the initial flushing. After the water has turned clear, adjust the temperature up to a normal shower temperature. (Please see "Note" below)



### NOTE: THE INITIAL FEW GALLONS OF WATER WILL CONTAIN CARBON FINES AND MAY SOIL YOUR SHOWER STALL.

It's a good idea to place a container underneath the shower filter to catch the first few gallons of water. This carbonized water is great for plants and environmentally friendly. It can be safely discarded in a plant bed or down the drain.

2. Notice that there is a slight delay in temperature adjustment due to the volume of water in the filter; take this delay into account when making temperature adjustments.
3. Make slight adjustments and wait 30 seconds for temperature change. Run water until clear and then turn off and back on several times. Repeat this procedure until the initial surge of water is free of discoloration.

## 6 Shower Head Attachment

Attach the shower head to the filter (Figure B)

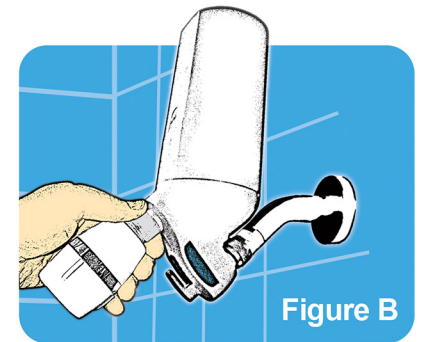

Figure B

The Pelican Shower Filter was designed to work with most shower heads, however for best results use the shower head provided with this system. Now you are ready to enjoy the benefits of showering in chlorine free water!



Caution: DO NOT use a shower head or wand with a shut-off valve.

## Free Manuals Download Website

<http://myh66.com>

<http://usermanuals.us>

<http://www.somanuals.com>

<http://www.4manuals.cc>

<http://www.manual-lib.com>

<http://www.404manual.com>

<http://www.luxmanual.com>

<http://aubethermostatmanual.com>

Golf course search by state

<http://golfingnear.com>

Email search by domain

<http://emailbydomain.com>

Auto manuals search

<http://auto.somanuals.com>

TV manuals search

<http://tv.somanuals.com>