



DRINKWELL® hy-drate™, Pet H₂O Filtration System

Model Numbers: PFD17-12901, PFD17-12902, PFD17-12903, PFD17-12904, PFD17-12899, PFD17-12900

protect. teach. love.

Thank you for choosing the PetSafe® brand. You and your pet deserve a companionship that includes memorable moments and a shared understanding together. Our products and training tools promote a lifestyle of protection, teaching, and love—essentials that influence memories for a lifetime. If you have any questions about our products or training your pet, please visit our website at www.petsafe.net or contact our Customer Care Center at 1-800-732-2677.

PRODUCT WARRANTY

To get the most protection out of your one-year warranty, please register your product within 30 days at www.petsafe.net. By registering and keeping your receipt, you will enjoy the product's full warranty and should you ever need to call the Customer Care Center, we will be able to help you faster. Most importantly, PetSafe® will never give or sell your valuable information to anyone. Complete warranty information is available online at www.petsafe.net.

INSTRUCTIONS PERTAINING TO; RISK OF FIRE, ELECTRIC SHOCK OR HARM TO PERSONS

IMPORTANT SAFETY INSTRUCTIONS

SAVE THESE INSTRUCTIONS

▲WARNING

When using electric appliances, basic precautions should always be followed, including the following:

- Read all the instructions before using appliance.
- To reduce the risk of injury, close supervision is necessary when an appliance is used near children.
- Only use attachments recommended or sold by the manufacturer.
- Do not use outdoors. INTENDED FOR INDOOR HOUSEHOLD USE ONLY.
- Do not unplug by pulling on the cord. To unplug, grasp the plug, not the cord.
- Do not operate any appliance with a damaged cord or plug, or after the appliance malfunctions or is dropped or damaged in any manner. Return appliance to the nearest authorized service facility for examination, repair, or electrical or mechanical adjustment.
- For a portable appliance – To reduce the risk of electrical shock, do not place or store appliance where it can fall or be pulled into a tub or sink.
- Always unplug any appliance when not in use, before putting on or taking off parts, and before cleaning. Never yank a cord to remove from the outlet.
- Do not contact moving parts.
- Always position power cords out of the way of foot traffic to avoid tripping.
- Do not allow your pet to chew on the power cord or hy-drate™ product.
- If the AC adapter gets wet, turnoff electricity to that outlet. Do not attempt to unplug.
- Examine this appliance after installation. It should not be plugged in if there is water on the cord or plug. To avoid the possibility of the plug or outlet getting wet, the outlet should always be above the level of the hy-drate™.
- Do not submerge AC power adapter into water.

Setup and Operating Instructions: Before using the hy-drate™, Pet H₂O Filtration System for the first time, it is important that you properly prepare the product for use. The hy-drate™ includes a filter that should be thoroughly rinsed to remove the carbon filter dust. Don't worry; the dust is not harmful to your pet. For smaller bowls you will find it helpful to adjust the flow control to prevent water from splashing from the bowl.

Begin by opening the hy-drate™, using your thumb to lift the snap located on the back to open the outer shell. Note the orientation of the internal parts and the location of the flow control on the side of the pump (See Fig. 1a & 1c). Remove the filter and rinse it under running water for approximately 20 seconds or until no carbon dust is showing in water. Gently shake excess water off filter and place back into the upper shell (See Fig. 1a). Close the hy-drate™ back together.

Fit the hy-drate™ to the bottom of your pet's bowl and push down until all three suction cups are secured to bottom. Use the suction cup on the pump's power cord to neatly attach cord to the outside of the bowl. Fill the bowl with water so the hy-drate™ is fully submerged. The low-voltage submersible pump is safe to fully go under water. Attach the pump's power cord to the AC adapter power cord, dry your hands and plug into a standard 120 volt AC circuit outlet. The hy-drate™ will start and within 20 seconds water will flow from the water flow opening. To turn off the hy-drate™, unplug from the outlet.

Some pets prefer drinking from a running source of water. To create a water stream effect, maintain a water level at the minimum H₂O level noted on the hy-drate™ (See Fig. 1a). Level of water above the hy-drate™ will give a rippling or bubbling effect on top of the water. Both options provide continuous movement and filtration for cleaner, fresher water. Now, adjust the flow control on the pump based on the size of the bowl, desired flow of water or to reduce water splattering from the bowl (See Fig. 1a & 1c). After beginning operation of the hy-drate™, simply allow your pet to adjust at his or her own pace. Some pets may take several days or longer to begin use. After your pet is acclimated to the hy-drate™, continue to replenish your pet's drinking water frequently for maximum hydration.

It is not recommended that any appliance be left running unattended for a prolonged period of time as the water may get consumed or evaporate, thus causing the motor to run dry and can reduce life of the pump.

Cleaning Instructions: The hy-drate™ upper shell, lower shell with suction cups and pump connector are dishwasher safe at low temperatures or can be hand washed with warm soapy water. THE PUMP IS NOT DISHWASHER SAFE! To remove pump from upper shell push in rubber fitting towards pump to release. Thread pump power cord through suction cup loop and pump cord pass-through (See Fig. 1a & 1b). The hy-drate™ pump should be disassembled and cleaned every two weeks (See Fig. 2 & 3). To remove "hard water" mineral build-up soak disassembled pump in regular white vinegar for several minutes and rinse thoroughly. Once the parts are clean, reassemble the pump by replacing the impeller, stator, flow control (See Fig. 4) and the intake plate. Thread pump power cord back through pump cord pass-through and suction cup loop, and position pump onto the pump connector post in the upper shell (See Fig. 1a & 1b). Grasp the rubber fitting and pull through hole in upper shell until it snaps into place sealing the opening (See Fig. 1a & 1b). The length of the pump power cord may need to be adjusted by pulling either end to position pump onto pump connector post.

The filter should be replaced every 2 - 4 weeks to maintain filtered, fresh and clean water. Small food particles and hair must be cleaned between the intake and filter as needed to maintain strong current flow.

IMPORTANT: Warranty may be voided if pump is not cleaned regularly.

Product Specifications:

Voltage/Power Consumption 120VAC 60Hz 3.3 WATTS
12 Volts low-level power adapter output

Accessories:

To purchase replacement parts or accessories, contact PetSafe® Customer Care Center at 1-800-732-2677 or by visiting www.petsafe.net.

Replaceable Filters, 3-pack

PFD17-12905

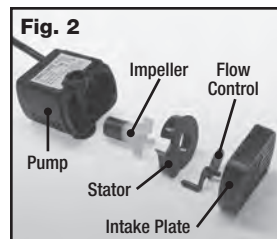
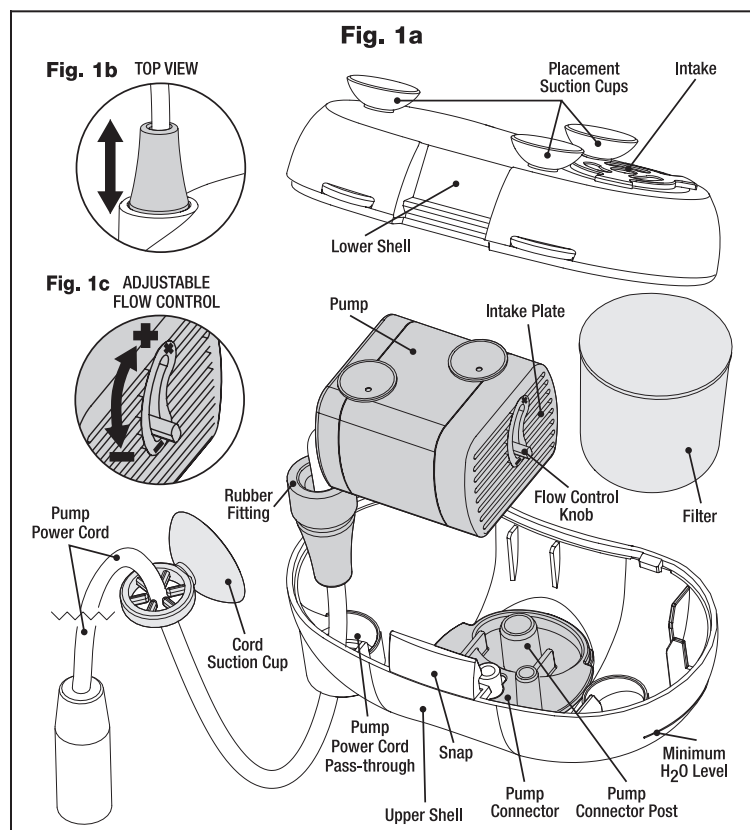

With your thumb and forefinger, gently squeeze the sides of intake plate, and pull off. Remove the flow control, stator and impeller. To remove impeller use a fingernail to lift out; it is held in magnetically.



Clean with warm soapy water. Use a cotton swab or a small cleaning brush to get into the motor cavity and remove any build-up.



Replace flow control by placing post into opening on the pump motor. Align flow control knob to opening on intake plate and attach intake plate to pump.

Terms of Use and Limitations of Liability

1. Terms and Use - This product is offered to you conditioned upon your acceptance without modifications of the terms, conditions and notices contained herein. Use of this product implies acceptance of all such terms, conditions and notices.
2. Proper Use - Includes reviewing the safety precautions listed.
3. No Unlawful or Prohibited Use - This product is designed for pets only. This device is not intended to harm, injure or provoke your pet. Using this product in a way that is not intended could result in violation of Federal, State or local law.
4. Limitations of Liability - In no event shall Radio Systems® Corporation be liable for any direct, indirect, punitive, incidental, special or consequential damages whatsoever arising out of or connected with the use or misuse of this product. Buyer assumes all risks and liabilities from the use of this product.
5. Modifications of Terms and Conditions - Radio Systems® Corporation reserves the right to change the terms, conditions and notices under which this product is offered.

Free Manuals Download Website

<http://myh66.com>

<http://usermanuals.us>

<http://www.somanuals.com>

<http://www.4manuals.cc>

<http://www.manual-lib.com>

<http://www.404manual.com>

<http://www.luxmanual.com>

<http://aubethermostatmanual.com>

Golf course search by state

<http://golfingnear.com>

Email search by domain

<http://emailbydomain.com>

Auto manuals search

<http://auto.somanuals.com>

TV manuals search

<http://tv.somanuals.com>