



BDP9000

www.usasupport.philips.com

For support call:

1-888-744-5477 (English, Español)

1-800-661-6162 (Français)

EN	Blu-ray Disc player	3
ES	Reproductor de Discos Blu-ray	44
FR	Lecteur de Disque Blu-ray	85

PHILIPS



Return your Product Registration Card today to get the very most from your purchase.

Registering your model with PHILIPS makes you eligible for all of the valuable benefits listed below, so don't miss out. Complete and return your Product Registration Card at once to ensure:

*Proof of Purchase

Returning the enclosed card guarantees that your date of purchase will be on file, so no additional paperwork will be required from you to obtain warranty service.

*Product Safety Notification

By registering your product, you'll receive notification - directly from the manufacturer - in the rare case of a product recall or safety defect.

*Additional Benefits of Product Ownership

Registering your product guarantees that you'll receive all of the privileges to which you're entitled, including special money-saving offers.

PHILIPS

*Congratulations on your purchase,
and welcome to the "family!"*

Dear PHILIPS product owner:

Thank you for your confidence in PHILIPS. You've selected one of the best-built, best-backed products available today. We'll do everything in our power to keep you happy with your purchase for many years to come.

As a member of the PHILIPS "family," you're entitled to protection by one of the most comprehensive warranties and outstanding service networks in the industry. What's more, your purchase guarantees you'll receive all the information and special offers for which you qualify, plus easy access to accessories from our convenient home shopping network.

Most importantly, you can count on our uncompromising commitment to your total satisfaction.

All of this is our way of saying welcome - and thanks for investing in a PHILIPS product.

P.S. To get the most from your PHILIPS purchase, be sure to complete and return your Product Registration Card at once.

Know these safety symbols



 This "bolt of lightning" indicates uninsulated material within your unit may cause an electrical shock. For the safety of everyone in your household, please do not remove product covering.

 The "exclamation point" calls attention to features for which you should read the enclosed literature closely to prevent operating and maintenance problems.

WARNING: To reduce the risk of fire or electric shock, this apparatus should not be exposed to rain or moisture, and objects filled with liquids, such as vases, should not be placed on this apparatus.

CAUTION: To prevent electric shock, match wide blade of plug to wide slot, fully insert.

ATTENTION: Pour éviter les choc électriques, introduire la lame la plus large de la fiche dans la borne correspondante de la prise et pousser jusqu'au fond.

For Customer Use

Enter below the Serial No. which is located on the rear of the cabinet. Retain this information for future reference.

Model No. _____

Serial No. _____

PHILIPS Visit our World Wide Web Site at <http://www.usasupport.philips.com>

Contents

What's in the box	6
Your product.....	7
BDP9000 Blu-ray Disc player	7
Before you start.....	8
Important safety instructions	8
Warnings and cautions.....	8
Product handling.....	9
North-American regulations	9
Need help?	10
Troubleshooting.....	10
Online help	10
Helpline.....	10
Overview	11
Blu-ray Disc player	11
Display.....	12
Universal remote control.....	12
Connect.....	13
Connect to the TV	13
Connect to the audio system (optional).....	15
Connect to the power outlet.....	18
Set up	19
Set the TV connection	19
Set the audio connection.....	19
Open the Settings menu.....	19
Overview.....	20
Navigation	20
Configure the languages.....	20
Configure the audio output.....	21
Configure the video output	23
Change the parental control	25
Enjoy	27
Turn the product on	27
Load a disc.....	27
Videos	28
Music	31
Pictures.....	32
Memory cards.....	33
Set to stand-by.....	33
Troubleshooting.....	34
Online help	34

Helpline.....	34
Problems and tips.....	34
Technical data.....	36
Dimensions.....	36
Operating environment.....	36
Power.....	36
Video output.....	36
Audio output.....	36
Playable discs.....	37
Playable memory cards.....	38
Information.....	39
Trademarks and licenses.....	39
Environmental information.....	39
Maintenance and service.....	39
Philips limited warranty one (1) year.....	39
Glossary.....	42
Terms and definitions.....	42

What's in the box

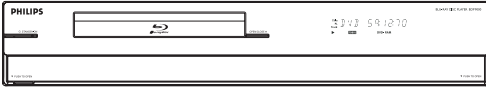

a. BDP9000
Blu-ray Disc player

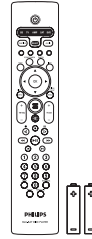

b. RC4380
Remote control

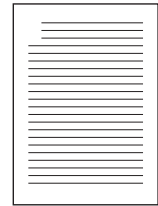

c. Quick start guide

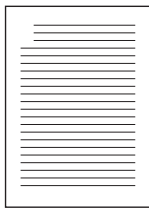

d. BDP9000
User manual

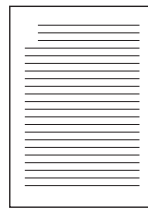

e. RC4380
User manual

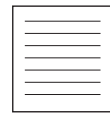

f. Product
registration card



g. HDMI cable

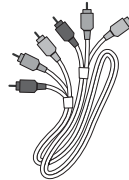

i. Component
video cable

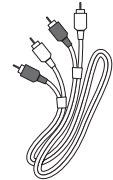

j. Audio cable

What else you'll need



HDTV
Television



AC
Power outlet

Result after installation

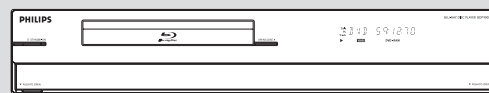

HDTV

Optional components (not supplied)

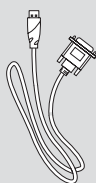

HDMI-DVI
cable

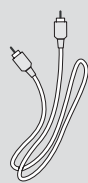

Composite
video cable

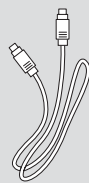

S-Video
cable

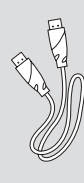

Additional
HDMI
cable

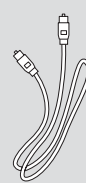

Optical
audio cable

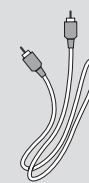

Coaxial
audio cable

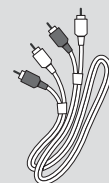

Audio cable
(2x)

BDP9000 Blu-ray Disc player

Watch movies in the highest picture quality available for your HDTV

The BDP9000 Blu-ray Disc player offers full high-definition video playback up to 1080p resolution for an amazing viewing experience. A highly detailed picture and increased sharpness delivers a more true-to-life picture.

Upconvert DVDs for enhanced picture quality

Your current DVDs will look even better than before thanks to video upconversion. Upconversion will increase the resolution of standard definition DVDs to high definition up to 1080p over an HDMI connection. The picture will be less jagged and more realistic for a near high-definition experience.

Enjoy your content on different kinds of media

Full backwards compatibility with DVDs, CDs ensures that you can continue to enjoy your current audio-video collection. Additionally, you can view JPEG digital pictures or listen to MP3 music files on popular memory card formats, thanks to the built-in memory card reader.

Listen to rich uncompressed multi-channel surround sound

The BDP9000 supports 5.1 channels of uncompressed audio, which realizes real-to-life sound and makes you feel that you are really there.

Intuitive User interface and universal Remote control

The Philips logical user interface allows you to easily navigate through your content and settings, so you can quickly find what you are looking for. With the included universal remote control, you can control multiple other audio/video devices, so you don't have to continuously switch remote controls.

Easy and simple connection to your HDTV via HDMI

Connect your BDP9000 to your HDTV with one single HDMI (High Definition Multimedia Interface) cable. The high definition video output signal will be transferred to your HDTV without conversion to analog signals, so you will get an excellent picture and sound quality, completely free from noise. Thanks to other multiple outputs, you can also easily connect to your home theater system or amplifier.

Before you start

Important safety instructions

- 1 Read these instructions.
- 2 Keep these instructions.
- 3 Heed all warnings and cautions.
- 4 Follow all instructions.
- 5 Do not use this apparatus near water.
- 6 Clean only with dry cloth.
- 7 Do not block any ventilation openings. Install in accordance with the manufacturer's instructions.
- 8 Do not install near any heat sources such as radiators, heat registers, or other apparatus (including amplifiers) that produce heat.
- 9 Do not defeat the safety purpose of the polarized plug. A polarized plug has two blades with one wider than the other. If the provided plug does not fit into your outlet, consult an electrician for replacement of the obsolete outlet.
- 10 Protect the power cord from being walked on or pinched particularly at plugs, convenience receptacles, and the point where they exit from the apparatus.
- 11 Only use attachments/accessories specified by the manufacturer.
- 12 Unplug this apparatus during lightning storms or when unused for long periods of time.
- 13 Refer all servicing to qualified service personnel. Servicing is required when the apparatus has been damaged in any way, such as power supply cord or plug is damaged, liquid has been spilled or objects have fallen into the apparatus, the apparatus has been exposed to rain or moisture, does not operate normally, or has been dropped.
- 14 Apparatus shall not be exposed to dripping or splashing.
- 15 Do not place any sources of danger on the apparatus (e.g. liquid filled objects, light candles).

Warnings and cautions

Warnings and cautions tell you that parts of procedures can be dangerous and/or cause damage. A warning means that injury or death is possible if the instructions are not obeyed. A caution means that damage to the equipment is possible.

Product handling

WARNING

- TO REDUCE THE RISK OF ELECTRIC SHOCK, DO NOT REMOVE THE COVER (OR THE BACK). NO USER-SERVICABLE PARTS ARE INSIDE. REFER SERVICING TO QUALIFIED SERVICE PERSONNEL.
- THIS UNIT EMPLOYS A LASER. DUE TO POSSIBLE EYE INJURY, ONLY A QUALIFIED SERVICE PERSON SHOULD REMOVE THE COVER OR ATTEMPT TO SERVICE THIS DEVICE.
- TO PREVENT DAMAGE WHICH MAY RESULT IN FIRE OR ELECTRIC SHOCK HAZARD, DO NOT EXPOSE THIS APPLIANCE TO RAIN OR MOISTURE.
- TO PREVENT THE SPREAD OF FIRE, KEEP CANDLES OR OTHER OPEN FLAMES AWAY FROM THIS PRODUCT AT ALL TIMES
- BEFORE YOU CONNECT THE PRODUCT TO A POWER SUPPLY, MAKE SURE THAT THE VOLTAGE ON THE TYPE PLATE OF THE PRODUCT IS THE SAME AS THE VOLTAGE OF THE POWER SUPPLY. WHEN THE VOLTAGES ARE NOT THE SAME, REFER TO YOUR DEALER
- TO REDUCE THE RISK OF ELECTRIC SHOCK, MAKE SURE THAT THE PRODUCT AND THE OTHER COMPONENTS ARE TURNED OFF BEFORE YOU CONNECT OTHER COMPONENTS TO THE PRODUCT.
- DO NOT PUT YOUR HAND IN THE DISC TRAY. IF YOU DO, YOU CAN GET STUCK IN THE DISC TRAY.

CAUTION

- ONLY LOAD DISCS WITH REGULAR SHAPES INTO THE PRODUCT. DISCS WITH IRREGULAR SHAPES CAN DAMAGE THE PRODUCT.
- DO NOT BLOCK THE VENTILATION OPENINGS. MAKE SURE THAT THERE IS ALWAYS AT LEAST 4 INCHES (10 CENTIMETERS) OF FREE SPACE BETWEEN THE REAR PANEL OF THE PRODUCT AND ANY OTHER OBJECT.
- ONLY LOAD PLAYABLE DISCS INTO THE PRODUCT. DISCS THAT CANNOT BE PLAYED OR OTHER OBJECTS CAN DAMAGE THE PRODUCT.
- DO NOT MOVE THE PRODUCT WHILE A DISC IS BEING PLAYED. IF YOU DO, YOU CAN DAMAGE THE PRODUCT AND THE DISC.

North-American regulations

This equipment has been tested and found to comply with the limits for a Class B digital device, pursuant to part 15 of the FCC Rules. These limits are designed to provide reasonable protection against harmful interference in a residential installation. This equipment generates, uses and can radiate radio frequency energy and, if not installed and used in accordance with the instructions, may cause harmful interference to radio communications. However, there is no guarantee that interference will not occur in a particular installation. If this equipment does cause harmful interference to radio or television reception, which can be determined by turning the equipment off and on, the user is encouraged to try to correct the interference by one or more of the following measures:

- Reorient or relocate the receiving antenna.
- Increase the separation between the equipment and receiver.
- Connect the equipment into an outlet on a circuit different from that to which the receiver is connected.
- Consult the dealer or an experienced radio/TV technician for help.

Need help?

Troubleshooting

Refer to page 34.

Online help

Refer to www.usasupport.philips.com for:

- Interactive help
- Frequently asked questions

Helpline

Language	Telephone number
English	1-888-PHILIPS (1-888-744-5477)
French	1-800-661-6162
Spanish	1-888-PHILIPS (1-888-744-5477)

Be prepared to give this information:

- A description of the problem and when it occurs
- The type number on the label of the product
- The date of purchase

Blu-ray Disc player

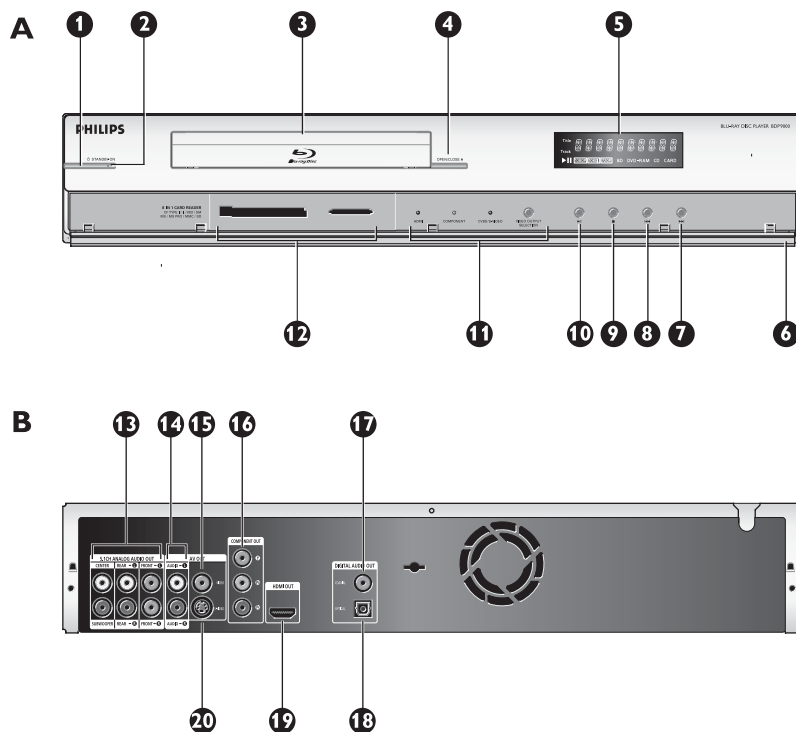

- 1 Standby/on button**
Turns the product on and off
- 2 Standby/on light**
Shows the on/off status of the product.
 - Off - Not connected to a power supply
 - Red - Stand-by mode
 - Blue - On
- 3 Disc tray**
- 4 Open/close button**
Opens and closes the disc tray.
- 5 Front display**
Shows information about the product and the disc.
- 6 Cover buttons**
Opens the user access panel.
- 7 Next/Forward button**
 - Videos, music, pictures - Next (short press)
 - Videos - Forward (long press)
- 8 Previous/Rewind button**
 - Videos, music, pictures - Previous (short press)
 - Videos - Rewind (long press)
- 9 Stop button**
- 10 Play/pause button**
- 11 Video output button & video output lights**
Selects the video output. The video output lights show the selected video output.
- 12 Memory card readers**
- 13 5.1 Analog audio ports**
Connects the audio output to an amplifier

14 Stereo analog audio ports

Connects the audio output to an amplifier

15 Composite video port (CVBS)**16 Component video ports (YPbPr)****17 Digital audio port - coaxial**

Connects the audio output to an amplifier

18 Digital audio port - optical

Connects the audio output to an amplifier

19 HDMI port

Connects the video and audio signals to a TV or amplifier. Recommended for HDTV.

20 S-Video port

Display

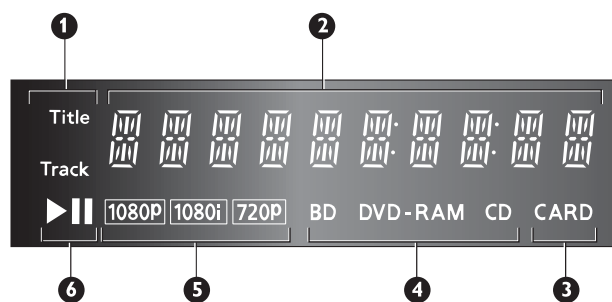
**1 Title/Track indicator****2 Status indicator**

Shows the information about playing time, clock and status.

3 Memory card indicator**4 Disc type indicator****5 Video output resolution indicator****6 Play mode indicator**

Universal remote control

Refer to the RC4380 User Manual.

Connect to the TV

This product is designed for high-definition televisions (HDTV).

Need help?

Refer to the documentation that came with your TV for information about:

- The devices that you can connect to your TV.
- The type of cables that you can connect to your TV.

Option 1 - Best quality (HDMI)

- 1 Take the supplied HDMI cable.
- 2 Plug one end of the HDMI cable into the **HDMI OUT** port.
- 3 Plug the other end of the HDMI cable into the HD compliant TV.

This type of connection requires no audio connection.

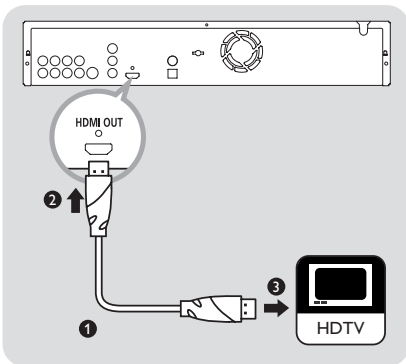

Option 2 - Best quality (HDMI to DVI)

- 1 Take a HDMI-DVI cable (not supplied).
- 2 Plug one end of the HDMI-DVI cable into the **HDMI OUT** port.
- 3 Plug the other end of the HDMI-DVI cable into the HD compliant TV.

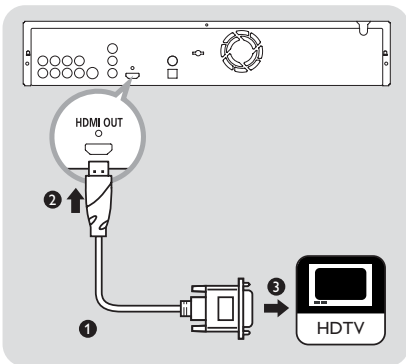

- 4 Take the supplied audio cable.
- 5 Plug one end of the audio cable into the **AUDIO-L** and **AUDIO-R** ports.
- 6 Plug the other end of the audio cable into the TV.

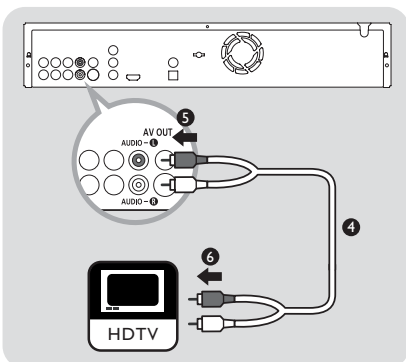

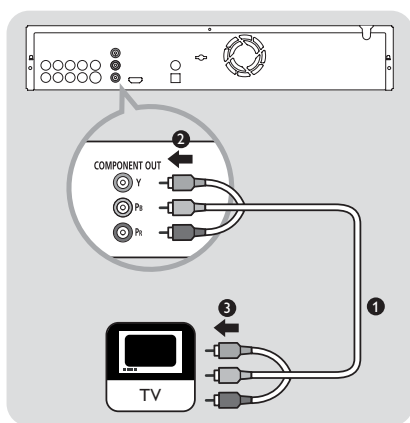

Option 3 - Good quality (Component video)

- 1 Take the supplied component video cable.
- 2 Plug one end of the component video cable into the **Y**, **Pb** and **Pr** ports.
- 3 Plug the other end of the component video cable into the TV.

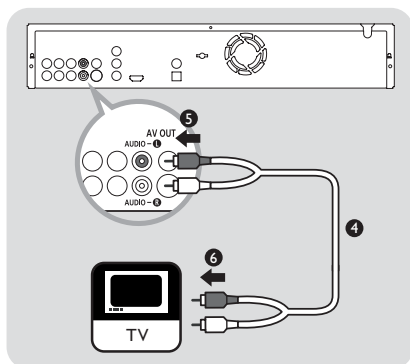

- 4 Take the supplied audio cable.
- 5 Plug one end of the audio cable into the **AUDIO-L** and **AUDIO-R** ports.
- 6 Plug the other end of the audio cable into the TV.

When a BD with Image Constraint Token or Digital Only Token is played, the output is disabled.

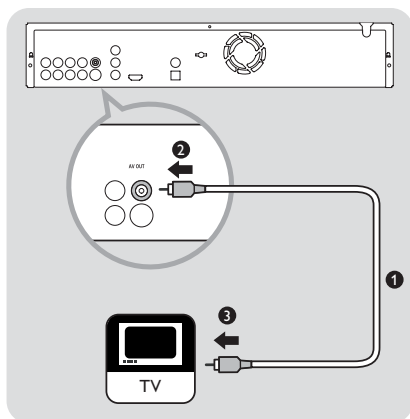

Option 4 - Standard quality (Composite video)

- 1 Take a composite video cable (not supplied).
- 2 Plug one end of the composite video cable into the **VIDEO** port.
- 3 Plug the other end of the composite video cable into the TV.

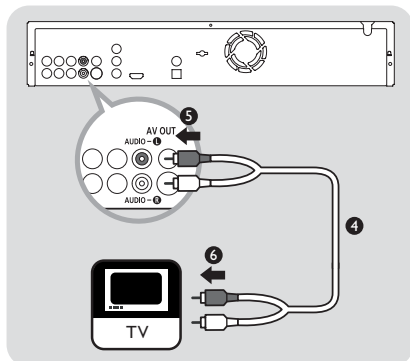

- 4 Take the supplied audio cable.
- 5 Plug one end of the audio cable into the **AUDIO-L** and **AUDIO-R** ports.
- 6 Plug the other end of the audio cable into the TV.

When a BD is played, the output is disabled.

Option 5 - Standard quality (S-Video)

- 1 Take an S-Video cable (not supplied).
- 2 Plug one end of the S-Video cable into the **S-VIDEO** port.
- 3 Plug the other end of the S-Video cable into the TV.

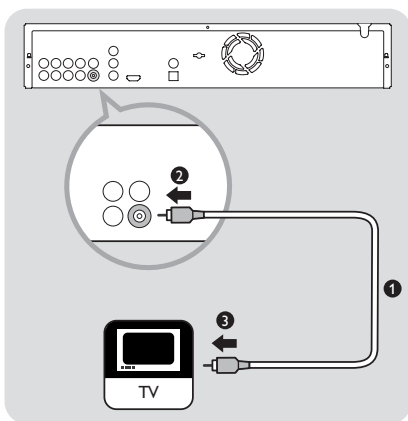

- 4 Take the supplied audio cable.
- 5 Plug one end of the audio cable into the **AUDIO-L** and **AUDIO-R** ports.
- 6 Plug the other end of the audio cable into the TV.

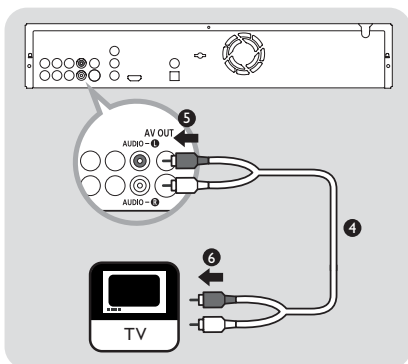

When a BD is played, the output is disabled.

Connect to the audio system (optional)

Need help?

Refer to the documentation that came with your audio system for information about:

- The devices that you can connect to your audio system.
- The type of cables that you can connect to your audio system.

Option 1 - Best quality (HDMI)

- 1 If you connected the TV to the **HDMI** port, unplug the HDMI cable on the TV.

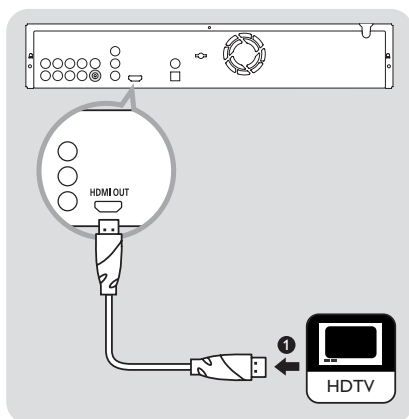

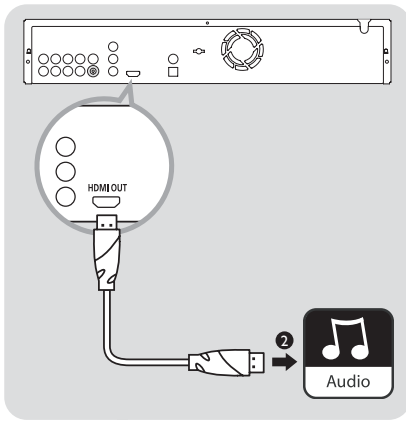

- 2 Plug the end of the HDMI cable into the HDMI input of the audio system.

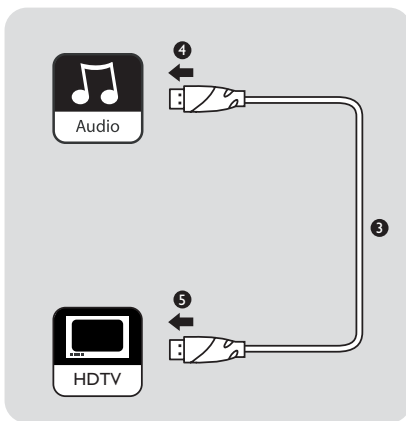

- 3 Take another HDMI cable (not supplied).
- 4 Plug one end of the HDMI cable into the HDMI output of the audio system.
- 5 Plug the other end of the HDMI cable into the TV.

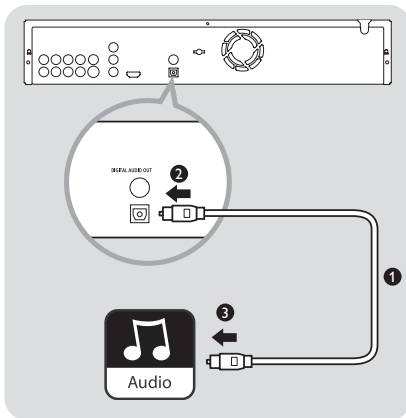

Option 2 - Good quality (digital audio, optical connection)

- 1 Take an optical audio cable (not supplied).
- 2 Plug one end of the optical audio cable into the **OPTICAL** port.
- 3 Plug the other end of the optical audio cable into the audio system.

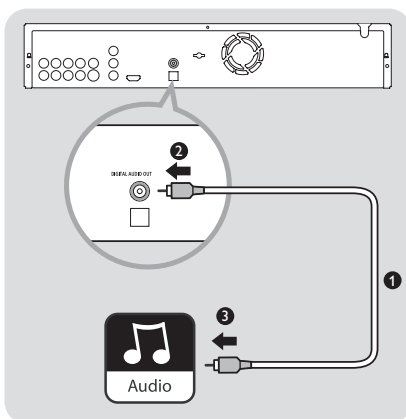

Option 3 - Good quality (digital audio, coaxial connection)

- 1 Take a coaxial audio cable (not supplied).
- 2 Plug one end of the coaxial audio cable into the **COAXIAL** port.
- 3 Plug the other end of the coaxial audio cable into the audio system.

Option 4 - Standard quality (5:1 analog audio)

- 1 If you connected the TV to the **COMPONENT OUT, VIDEO** or **S-VIDEO** ports or used a HDMI-DVI cable, remove the audio cable between the Blu-ray Disc player and the TV.

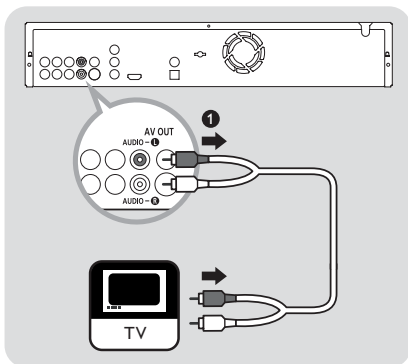

- 2 Take the supplied audio cable.
- 3 Take another two audio cables (not supplied).
- 4 Plug the three audio cables into the **5.1CH ANALOG AUDIO OUT** ports.
- 5 Plug the other ends of the three audio cables into the audio system.

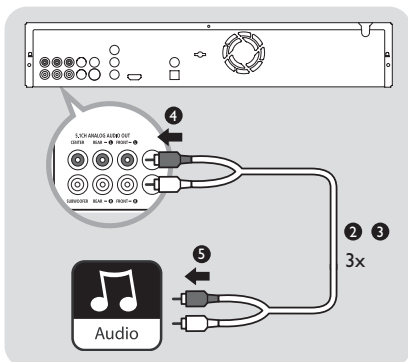

Option 5 - Standard quality (stereo analog audio)

- 1 If you connected the TV to the **COMPONENT OUT, VIDEO** or **S-VIDEO** ports or used a HDMI-DVI cable, unplug the audio cable on the TV.

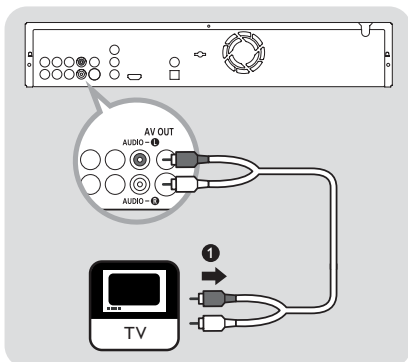

- 2 Plug the ends of the audio cable into the audio system.

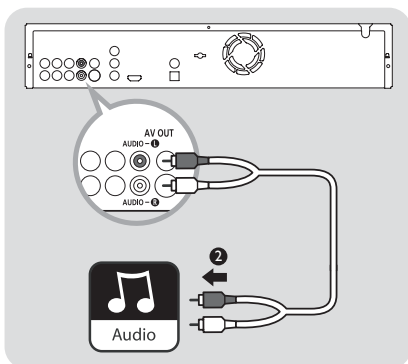

Connect to the power outlet

- I Plug the power cable into the power outlet.
 - > *The standby/on light on the front of the product comes on as red.*

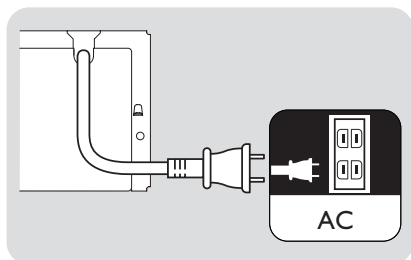

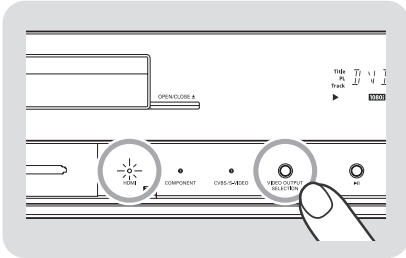

Set the TV connection

- 1 Turn the TV on.
- 2 Set the TV to the correct external input.
- 3 Press the **STANDBY/ON** button.
 - > The **STANDBY/ON** light on the front of the product comes on as blue.
- 4 Open the user access panel.
- 5 Press the video output selection button until the correct light comes on.

TV connection	Light
HDMI	HDMI
Component video	COMPONENT
Composite video	CVBS/S-VIDEO
S-Video	CVSS/S-VIDEO

> The video signal of the Blu-ray Disc player shows.

- 6 Follow the on-screen instructions

Menu language selection

Press 1 for English
 Pulsar 2 para Español
 Touche 3 pour Français

Set the audio connection

- 1 Turn the audio system on.
- 2 Set the audio system to the correct external input.

Open the Settings menu

With the **Settings** menu, you can change the set up of the product.

- 1 Take the supplied universal remote control.
- 2 Press the **STANDBY/ON** button.
 - > The **Home** menu shows.
- 3 Select **Settings** and press **OK**.
 - > The **Settings** menu shows.

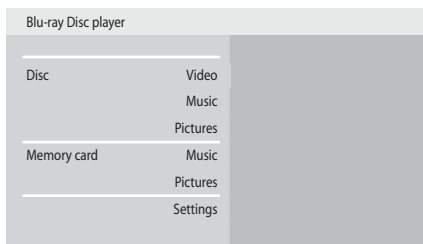

Overview

Language setup	Audio
	Subtitle
	Disc menu
	Player menu
Audio setup	Digital output
	PCM downsampling
	Dynamic compression
	Speaker setup
Display setup	TV shape
	Black level
	Resolution
	HDMI format
	Screen message
	Front display
Parental control	Use PIN
	Rating level
	New PIN

Navigation

Action	Button
Go up or down in a list	▲ ▼
Move a cell in the list	◀ ▶
Confirm a selection	OK

Configure the languages

Open the language menu

- 1 Open the **Settings** menu.
- 2 Select **Language setup** and press **OK**.
> *The **Language setup** menu shows.*

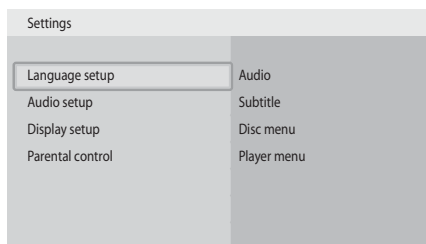

Change the preferred audio language

- 1 Open the **Language setup** menu.
- 2 Select **Audio** and press **OK**.
> *The available languages show.*
- 3 Choose the preferred language and press **OK**.

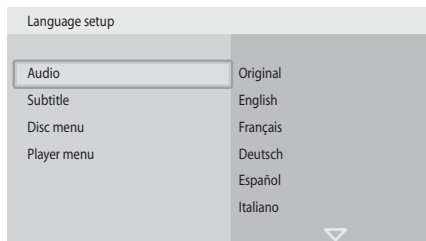

When the preferred language is not available, the default language is used. The default language is English.

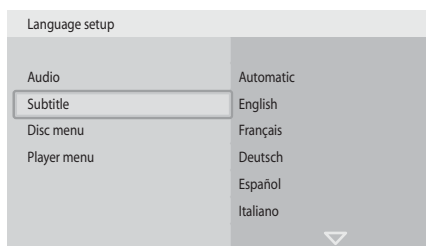

Change the preferred subtitle language

- 1 Open the **Language setup** menu.
- 2 Select **Subtitle** and press **OK**.
> *The available languages show.*
- 3 Choose the preferred language and press **OK**.

When the preferred language is not available, the default language is used. The default language is English.

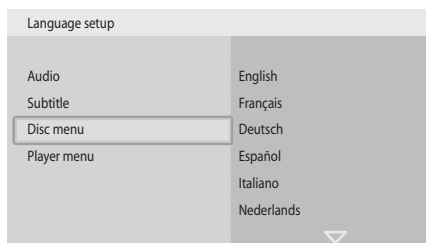

Change the preferred disc menu language

- 1 Open the **Language setup** menu.
- 2 Select **Disc menu** and press **OK**.
> *The available languages show.*
- 3 Choose the preferred language and press **OK**.

When the preferred language is not available, the default language is used. The default language is English.

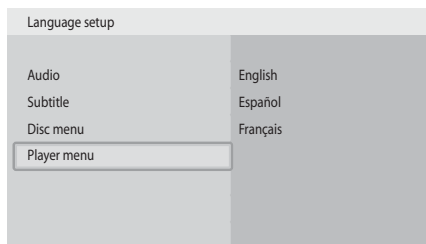

Change the player language

- 1 Open the **Language setup** menu.
- 2 Select **Player menu** and press **OK**.
> *The available languages show.*
- 3 Choose the preferred language and press **OK**.

Configure the audio output

Open the audio menu

- 1 Open the **Settings** menu.
- 2 Select **Audio setup** and press **OK**.
> *The **Audio setup** menu shows.*

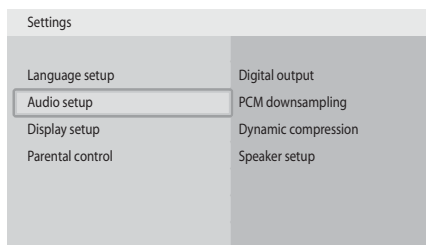

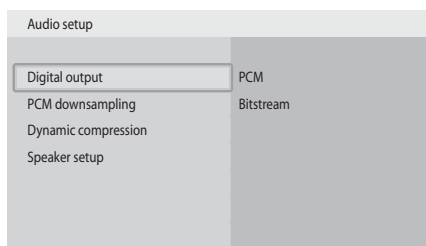

Change the format of the digital audio signal

- 1 Open the **Audio setup** menu.
- 2 Select **Digital output** and press **OK**.
> *The available options show.*
- 3 Choose the preferred option and press **OK**. Refer to 'Audio output' on page 36.

Option	Description
PCM	The format of the digital audio signal is PCM.
Bitstream	The format of the digital audio signal is bitstream.

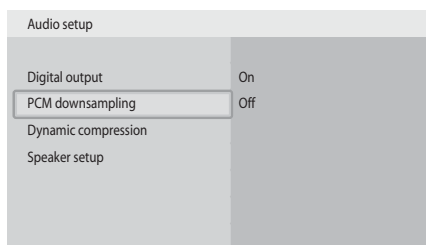

Enable PCM downsampling

- 1 Open the **Audio setup** menu.
- 2 Select **PCM downsampling** and press **OK**.
> *The available options show.*
- 3 Choose the preferred option and press **OK**.

Option	Description
On	If the format of the digital audio signal is 96 kHz PCM, the audio is downsampled to 48 kHz.
Off	Regardless of the sampling frequency of the digital audio signal, the audio is never downsampled.

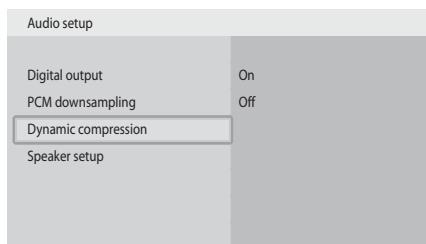

Enable dynamic range compression

- 1 Open the **Audio setup** menu.
- 2 Select **Dynamic compression** and press **OK**.
> *The available options show.*
- 3 Choose the preferred option and press **OK**.

Option	Description
On	The dynamic range compression is enabled.
Off	The dynamic range compression is disabled.

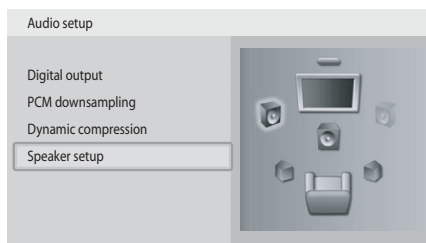

Change the set up of your speakers

- 1 Open the **Audio setup** menu.
- 2 Select **Speaker setup** and press **OK**.
- 3 Select the speakers to change and press **OK**.

Option	Description
Front	Choose between large or small speakers
Center	Choose between no speaker, a large or a small speaker
Rear	Choose between no speakers, large or small speakers
Subwoofer	Choose between on or off. Available when front speakers are set to large.

- 4 Change the size of your speakers and press **OK**.

When the front speakers are set to large and the subwoofer is on, the subwoofer is used for the output of bass sounds (below 100 Hz). Set the subwoofer to off for output of the bass sounds through the front speakers

Configure the video output

Open the video menu

- 1 Open the **Settings** menu.
- 2 Select **Display setup** and press **OK**.
 - > The **Display setup** menu shows.

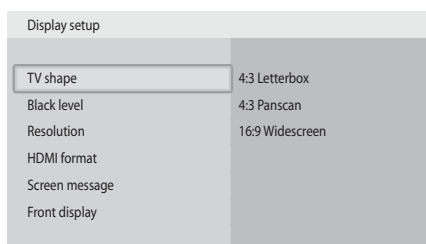
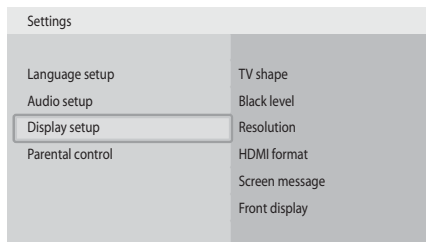

Change the aspect ratio

- 1 Open the **Display setup** menu.
- 2 Select **TV shape** and press **OK**.
 - > The available options show.

- 3 Choose the preferred option and press **OK**.

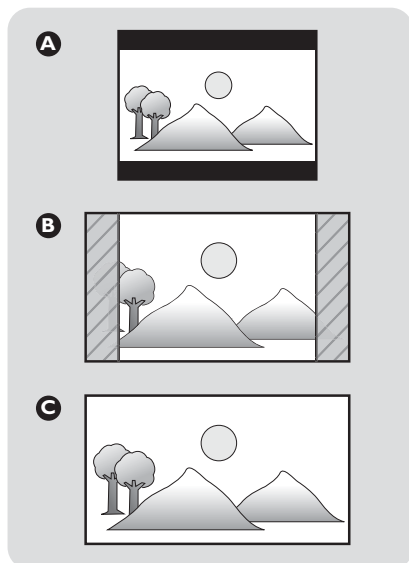

Option	Description
4:3 Letterbox	The TV shape is 4:3. The top and bottom parts of widescreen images show black bars. Refer to A.
4:3 Panscan	The TV shape is 4:3. The left and right parts of widescreen images do not show. Refer to B.
16:9 Widescreen	The TV shape is 16:9 (widescreen). Refer to C.

Change the black level

Only applicable when the connection to the TV is composite video or S-Video.

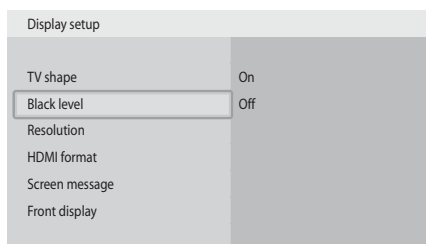

- 1 Open the **Display setup** menu.
- 2 Select **Black level** and press **OK**.
> *The available options show.*
- 3 Choose the preferred option and press **OK**.

Option	Description
On	Increases the darkness of black sections in the picture.
Off	Decreases the darkness of black sections in the picture.

Change the resolution

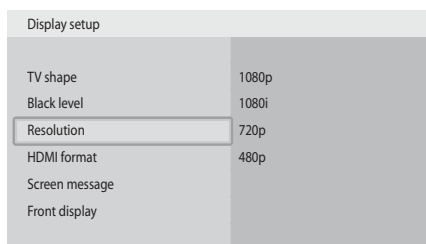

- 1 Open the **Display setup** menu.
- 2 Select **Resolution** and press **OK**.
> *The available options show.*
- 3 Choose the preferred option and press **OK**.

HDMI connection

Disc type	Supported resolutions
BD (without token)	720p, 1080i, 1080p
BD, Image Constraint Token (ICT)	720p, 1080i, 1080p
BD, Digital Only Token (DOT)	720p, 1080i, 1080p
DVD	480p, 720p, 1080i, 1080p

Component video connection

Disc type	Supported resolutions
BD (without token)	720p, 1080i
BD, Image Constraint Token (ICT)	Not supported
BD, Digital Only Token (DOT)	Not supported
DVD	480i, 480p

Composite video/S-Video connection

Disc type	Supported resolutions
BD (without token)	Not supported
BD, Image Constraint Token (ICT)	Not supported
BD, Digital Only Token (DOT)	Not supported
DVD	480i

When a resolution is selected that is not supported by the TV, the product must be reset. Press-and-hold the ►►-button on the front panel for 5 seconds to restore the factory settings (with no disc in the disc tray).

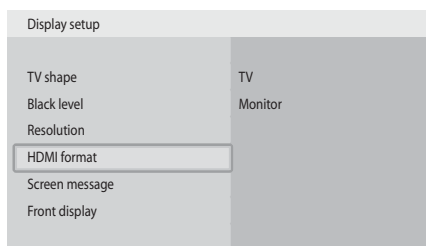

Change the HDMI format

- 1 Open the **Display setup** menu.
- 2 Select **HDMI format** and press **OK**.
> *The available options show.*
- 3 Choose the preferred option and press **OK**.

Option	Description
TV	The format of the HDMI signal is TV. Use this if you connected the HDMI port to a TV.
Monitor	The format of the HDMI signal is monitor. Use this if you connected the HDMI port to a monitor.

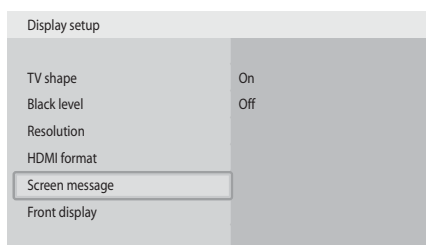

Enable screen messages

- 1 Open the **Display setup** menu.
- 2 Select **Screen message** and press **OK**.
> *The available options show.*
- 3 Choose the preferred option and press **OK**.

Option	Description
On	The screen messages are enabled.
Off	The screen messages are disabled.

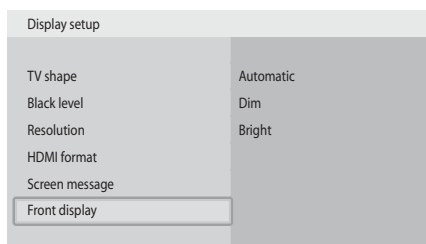

Configure the front display

- 1 Open the **Display setup** menu.
- 2 Select **Front display** and press **OK**.
> *The available options show.*
- 3 Choose the preferred option and press **OK**.

Option	Description
Automatic	Low brightness of the front display during playback.
Dim	Low brightness of the front display.
Bright	High brightness of the front display.

Change the parental control

Open the parental control menu

- 1 Open the **Settings** menu.
- 2 Select **Parental control** and press **OK**.
- 3 Enter your PIN.

The default PIN is 0000.

- 4 Follow the on-screen instructions.
> *The **Parental control** menu shows.*

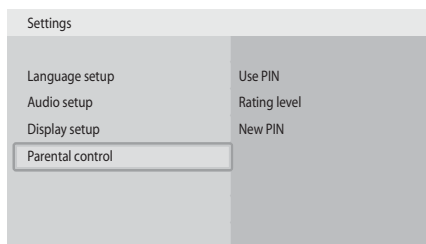

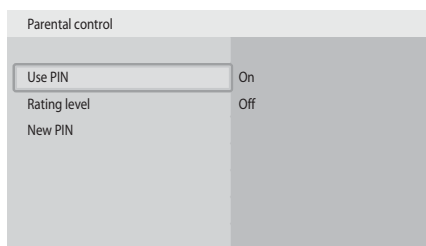

Enable the PIN

- 1 Open the **Parental control** menu.
- 2 Select **Use PIN** and press **OK**.
> *The available options show.*
- 3 Choose the preferred option and press **OK**.

Option	Description
On	The PIN is enabled.
Off	The PIN is disabled.

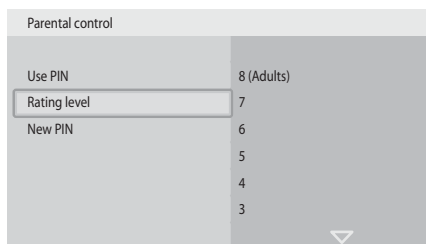

Change the rating level

- 1 Open the **Parental control** menu.
- 2 Select **Rating level** and press **OK**.
> *The available options show.*
- 3 Choose the preferred option and press **OK**.

For example, when you set the rating level to 6, discs with rating levels 7 and 8 cannot be played.

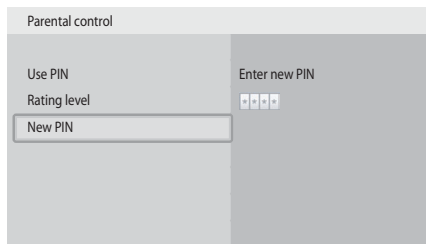

Change the PIN

- 1 Open the **Parental control** menu.
- 2 Select **New PIN** and press **OK**.
- 3 Follow the on-screen instructions.

Turn the product on

- 1 Set the TV to the correct external input.
- 2 On the front of the product, press the **STANDBY/ON** button.
 - > The **STANDBY/ON** light comes on as blue.

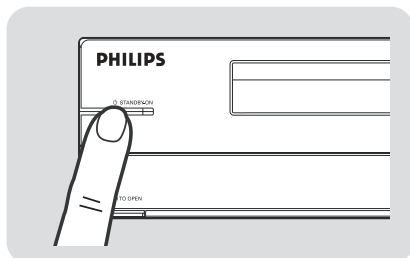

Load a disc

Before you load a disc into the Blu-ray Disc player, make sure that the disc type is supported. Refer to 'Playable discs' on page 37.

- 1 Turn the product on.
- 2 Press the **OPEN/CLOSE** button.
 - > The disc tray opens.

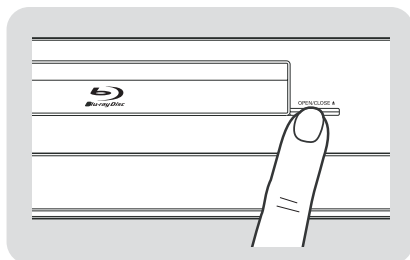

- 3 Place the disc in the disc tray.
- 4 Press the **OPEN/CLOSE** button again.
 - > The disc tray closes.

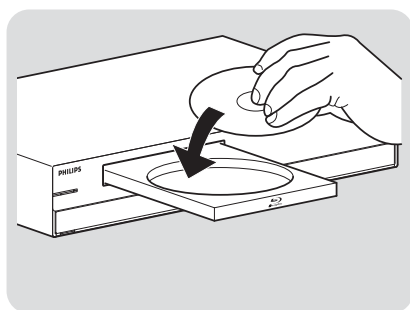

Videos

Play a title

- 1 Turn the product on.
- 2 Load the video disc.
 - > *The **Home** menu shows.*

Discs that contain a disc menu show the disc menu. If the disc contains a disc menu, the rest of the procedure is not applicable. Refer to the documentation that came with the disc for instructions that tell you how to operate the disc menu.

- 3 From the home menu, select **Video**.
 - > *The **Title** list shows.*
- 4 Use the universal remote control to go to the title.

Action	Button
Previous title	▲
Next title	▼

- 5 Press the **OK** button.

Control titles

- 1 Play the title.
- 2 Use the universal remote control to control the title.

Action	Button
Play the title	▶
Pause the title	▶
Stop the title	■
Restart the title	▶
Jump to the previous title/chapter	◀
Jump to the next title/chapter	▶
Repeat the title/chapter	REPEAT
Repeat a defined selection	REPEAT A-B
Bookmark a point on the disc	BOOKMARK

Jump to the next or previous title

Tip You can use the universal remote control to jump to the next or previous title. Refer to 'Control titles' on page 28 for instructions.

- 1 Play the title.
- 2 Press the **INFO** button.
 - > *The **Info** menu shows.*
- 3 Select **Title**.
- 4 Select the preferred option and press **OK**.

Option	Button
Previous title	◀
Next title	▶

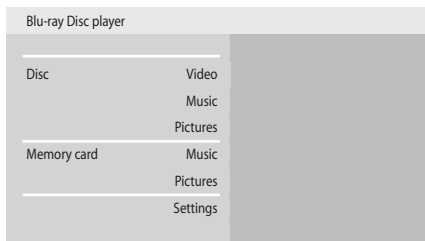

Jump to the next or previous chapter

Tip You can use the universal remote control to jump to the next or previous chapter. Refer to 'Control titles' on page 28 for instructions.

- 1 Play the title.
- 2 Press the **INFO** button.
> *The Info menu shows.*
- 3 Select **Chapter**.
- 4 Select the preferred option and press **OK**.

Option	Button
Previous chapter	◀
Next chapter	▶

Jump to a point of time

- 1 Play the title.
- 2 Press the **INFO** button.
> *The Info menu shows.*
- 3 Select **Playing time**.
- 4 With the number keys, enter the point of time.
- 5 Press **OK**.

Search through a chapter

When you search through a chapter, the audio is muted.

- 1 Play the title.
- 2 Go to the chapter.
- 3 Set the speed.

Option	Button
Search forwards	⏩
Search backwards	⏪

Search for a scene

This feature is not applicable to all video discs.



- 1 Play a title.
- 2 Press the **SCENE SEARCH** button.
> *The Scene search menu shows.*
- 3 Select the type of scene search.
- 4 Press **OK**.
- 5 Select the category of the search.
- 6 Press **OK**.
- 7 Select the scene from the selection.
- 8 Press **OK**.

Option	Button
Previous scene in the category	◀
Next scene in the category	▶

Play a title frame by frame

- When you play a title frame by frame, the audio is muted.
- For BD, only jump to the next frame is possible.



- 1 Pause the title.
- 2 Jump to the frame.

Option	Button
Jump to the next frame	
Jump to the previous frame	

Play a title in slow motion



- When you play a title in slow motion, the audio is muted.
- For BD, only jump slow forward is possible.

- 1 Pause the title.
- 2 Set the speed.

Option	Button
Slow forward	
Slow backward	

Change the audio language

- 1 Play the title.
- 2 Press the **AUDIO** button.
> *The on-screen display shows.*
- 3 Select the audio language.
- 4 Press **OK**.

Action	Button
Up	
Down	

Change the camera angle

This feature is not applicable to all video discs.

- 1 Play a title.
- 2 Press the **TITLE/POPUP MENU** button.
> *The disc menu shows.*
- 3 Control the disc menu with the universal remote control.

Change the subtitle language

- 1 Play the title.
- 2 Press the **SUBTITLE** button.
> *The on-screen display shows.*
- 3 Select the subtitle language.
- 4 Press **OK**.

Action	Button
Up	▲
Down	▼

Music

Play a track

- 1 Turn the product on.
- 2 Load the audio disc or insert the memory card. To insert a memory card, refer to page 33.
> *The home menu shows.*
- 3 From the home menu, select **Music**.
> *The **Music** list shows.*
- 4 Use the universal remote control to go to the track.

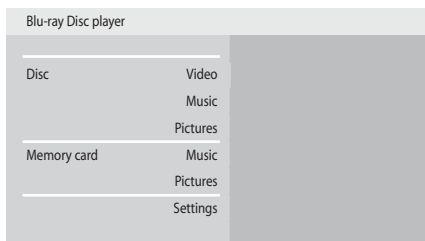

Action	Button
Next track	▲
Previous track	▼

- 5 Press the **OK** button.

Control tracks

- 1 Play the track.
- 2 Use the universal remote control to control the track.

Action	Button
Play the track	▶
Pause the track	⏸
Stop the track	■
Restart the track	▶
Play the previous track	◀
Play the next track	▶
Repeat the track	REPEAT (1x)
Repeat the audio disc	REPEAT (2x)
Play the tracks in random order	REPEAT (3x)

Pictures

View a picture

- 1 Turn the product on.
- 2 Load the disc or insert the memory card. To insert a memory card, refer to page 33.
> *The home menu shows.*
- 3 From the home menu, select **Picture**.
> *The **Picture** list shows.*
- 4 Use the universal remote control to go to the picture.
- 5 Press the **OK** button.

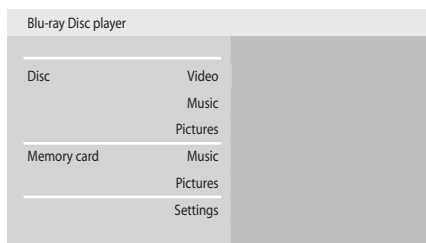

Start a slideshow

- 1 View the first picture of the slideshow.
- 2 Press the **INFO** button.
> *The **Info** menu shows.*
- 3 Select **Slideshow**.
> *The available options show.*
- 4 Choose the preferred speed and press **OK**.

Rotate a picture

Tip You can use up-down arrow keys of the universal remote control to rotate a picture. The function is not available in a slideshow.

- 1 View the picture or stop the slide show.
- 2 Press the **INFO** button.
> *The **Info** menu shows.*
- 3 Select **Rotate**.
> *The available options show.*
- 4 Choose the preferred option and press **OK**.

Option	Description
Rotate	▲ ▼

Zoom in and out on a picture

- 1 View the photo or stop the slide show.
- 2 Press the **INFO** button.
> *The **Info** menu shows.*
- 3 Select **Zoom**.
> *The available options show.*
- 4 Choose the preferred option and press **OK**.

Option	Description
On	Zoom in
Off	Normal size (100%)
Scroll	▲ ▼ ◀ ▶

Memory cards

Insert memory cards

CAUTION DO NOT INSERT AN MS DUO, RS-MMC OR MINI SD INTO THE MEMORY CARD READER WITHOUT AN ADAPTER. IF YOU DO, YOU CAN DAMAGE THE BLU-RAY DISC PLAYER AND THE MEMORY CARD.

Before you insert a memory card into the Blu-ray Disc player, make sure that the memory card is supported. Refer to 'Playable memory cards' on page 38.

- 1 Turn the product on.

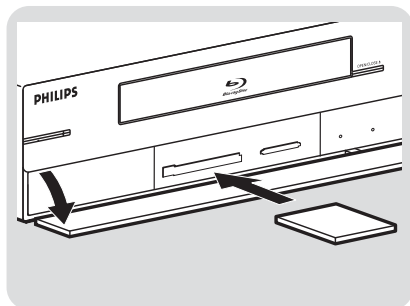
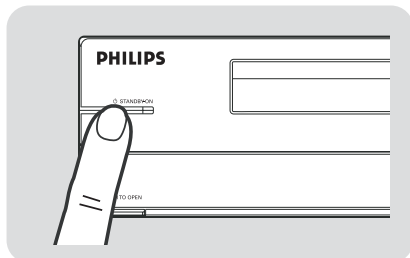

- 2 Open the user access panel.
- 3 Insert the memory card into the correct slot.

Left slot	Right slot
CF Type I	MS
MD	MS PRO
	MS Duo (only with adapter)
	MMC
	RS-MMC (only with adapter)
	SD
	Mini SD (only with adapter)

Music

Refer to 'Music' on page 31.

Pictures

Refer to 'Pictures' on page 32.

Set to stand-by

- 1 On the front of the product, press the **STANDBY/ON** button.
 - > The **STANDBY/ON** light on the front of your product comes on as red.

When the product is switched to stand-by, it still uses some power. To turn the product off, remove the power cord from the power outlet.

Troubleshooting

Online help

Refer to www.usasupport.philips.com for:

- Interactive help
- Frequently asked questions

Helpline

Language	Telephone number
English	1-888-PHILIPS (1-888-744-5477)
French	1-800-661-6162
Spanish	1-888-PHILIPS (1-888-744-5477)

Be prepared to give this information:

- A description of the problem and when it occurs
- The type number on the label of the product
- The date of purchase

Problems and tips

Problem	Tip
No reaction to the supplied universal remote control.	<p>Connect the product to the power outlet.</p> <p>Point the remote control at the product.</p> <p>Insert the batteries correctly.</p> <p>Insert new batteries in the universal remote control.</p>
No video signal on the TV.	<p>Turn the TV on.</p> <p>Set the TV to the correct external input.</p> <p>Select the correct video output with the VIDEO OUTPUT SELECTION button on the front panel.</p> <p>Change the resolution of the output to the TV.</p> <p>Press-and-hold the -button on the front panel for 5 seconds to restore the factory settings (with no disc in the disc tray).</p>
No high-definition video signal on the TV via component video.	<p>Does the disc contain high-definition video? High-definition video is not available when the disc does not contain it.</p> <p>Does the TV support high-definition video? High-definition video is not available when the TV does not support it.</p>
No audio signal from the loudspeakers of the TV.	<p>Assign the audio input of the TV to the corresponding video input.</p>
No audio signal from the loudspeakers of the audio system.	<p>Turn the audio system on.</p> <p>Set the audio system to the correct external input.</p> <p>Increase the volume level of the audio system.</p>

Problem	Tip
No 5.1-channel audio from the loudspeakers of the audio system	<p>Does the disc or memory card contain 5.1-channel audio? The 5.1-channel audio is not available when the disc or memory card does not contain it.</p> <p>Does the audio system support 5.1-channel audio? The 5.1-channel audio is not available when the audio system does not contain it.</p> <p>In the SETTINGS menu, set Digital out to PCM.</p>
Cannot play a disc.	<p>Make sure that the product supports the disc.</p> <p>Make sure that the Blu-ray Disc player supports the region code of the DVD or BD. (BD: A; DVD: All or I)</p> <p>For DVD+R discs, make sure that the disc is finalized.</p> <p>Clean the disc.</p>
Cannot play JPEG files from a disc.	<p>Make sure that the disc was recorded in the UDF, ISO9660 or JOLIET format.</p>
Cannot play MP3 files from a disc or a memory card.	<p>Make sure that the disc was recorded in the UDF, ISO9660 or JOLIET format.</p> <p>Make sure that the bit rate of the MP3 files is between 56 and 320 kbps.</p> <p>Make sure that the sample rate of the MP3 files is 32 kHz, 44.1 kHz or 48 kHz.</p>
Cannot play a memory card.	<p>Make sure the memory card is supported by the product.</p>
Red cross in the upper right hand corner of the screen.	<p>The operation is not possible.</p>
Cannot find a JPEG file.	<p>Make sure that the selected folder does not contain more than 1500 files. Only the first 1500 files are shown.</p> <p>Make sure that the file extension is .jpg, .JPG, .jpeg or .JPEG.</p>
Cannot find an MP3 file.	<p>Make sure that the selected folder does not contain more than 1500 files. Only the first 1500 files are shown.</p> <p>Make sure that the file extension is .mp3 or .MP3</p>
The product gives no response to any control.	<p>Press and hold the standby/on button for 5 seconds to set the product to stand-by.</p>

Technical data

Dimensions

Product dimensions (W x D x H)	16.9 x 12.8 x 3.1 in (430 x 325 x 789 mm)
Product weight	9.3 lbs (4.2 kg)

Operating environment

Operating temperature	41 to 104 F (+5 to 40 °C)
Operating humidity	10 to 75 % (non-condensing)

Power

Mains power	AC, 120 V, 60 Hz
Standby/on switch	
Power consumption	51 W (< 10 W stand-by)
Standby/on light	Red/blue

Video output

HDMI	480p, 720p, 1080i, 1080p
Component video	Y: 1.0 Vp-p (75 Ω load), Pb: 0.70 Vp-p (75 Ω load), Pr: 0.70 Vp-p (75 Ω load)
Composite video	1 channel: 1.0 Vp-p (75 Ω load)
S-Video	Luminance: 1.0 Vp-p (75 Ω load), Chrominance: 0.3 Vp-p (75 Ω load)

Audio output

HDMI	PCM multi-channel audio, PCM audio, bitstream audio,
Digital audio output	Optical, coaxial (S/PDIF)
5.1-Channel	Front and rear left, front and rear right, center, subwoofer
2-Channel	Left, right
Frequency response	48 kHz sampling: 4 Hz to 22 kHz, 96 kHz sampling: 4 Hz to 44 kHz
Signal-to-noise ratio	110 dB
Dynamic range	100 dB
Total harmonic distortion	0.004%

When you play a video from a disc, the audio is dependent upon:

- The type of audio connection
- The disc type and the audio on the disc
- The selected digital audio format (only for S/PDIF and HDMI connections)

2-Channel analog

Disc type	Output
BD	2-Channel
DVD with Dolby Digital	2-Channel
DVD with DTS	Mute

5.1-Channel analog

Disc type	Output
BD	5.1-Channel
DVD with Dolby Digital	2-Channel (front left, front right)
DVD with DTS	Mute

S/PDIF

Disc type	Output
BD	PCM: 2-Channel; Bitstream: bitstream from disc
DVD with Dolby Digital	2-Channel (front left, front right); Bitstream: bitstream from disc
DVD with DTS	PCM: Mute; Bitstream: bitstream from disc

HDMI

Disc type	Output
BD	PCM: 2-Channel/5.1-Channel; Bitstream: bitstream from disc
DVD with Dolby Digital	2-Channel (front left, front right); Bitstream: bitstream from disc
DVD with DTS	PCM: Mute; Bitstream: bitstream from disc

Playable discs

Types	BD: BD-ROM, BD-RE; DVD: DVD-VIDEO, DVD+RW (4.7 GB), DVD-RW (4.7 GB), DVD+R (4.7 GB) DVD-R (4.7 GB); CD: AUDIO-CD, CD-RW, CD-R
Region codes	BD: A; DVD: All or I

PRODUCT IS FULLY COMPATIBLE WITH THE FOLLOWING CURRENT FORMATS:

- BD-ROM / BD-R / BD-RE*
- DVD-Video / DVD-R / DVD-RW
- Audio CD / CD-R / CD-RW

PRODUCT IS COMPATIBLE WITH THE FOLLOWING FORMATS, WITH LIMITED FUNCTIONALITY:

- DVD+R / DVD+RW

PRODUCT WILL NOT PLAY DISCS WITH THE FOLLOWING FORMATS:

- HD-DVD
- Any other

* Due to the intentional progression of the Blu-ray Disc format by its standard setting authority, Philips cannot guarantee or warrant the playability of future extensions of the Blu-ray Disc format with this product.

Playable memory cards

Types

CF Type I, MD, SM, MS PRO, MS Duo
(with adapter), MMC, RS-MMC (with
adapter), SD, Mini SD (with adapter),

Trademarks and licenses



Dolby Laboratories

Manufactured under license from Dolby Laboratories. "Dolby", "Pro-logic" and the double-D symbol are trademarks of Dolby Laboratories.



DTS

"DTS" and "DTS DIGITAL SURROUND" are registered trademarks of Digital Theater Systems, Inc.



HDMI

HDMI, the HDMI logo and High-Definition-Multimedia Interface are trademarks or registered trademarks of HDMI licensing LLC.

Environmental information

All unnecessary packaging has been omitted. The packaging has been made easy to separate into two materials: cardboard (box, buffer) and polyethylene (bags, protective foam sheet). Your product consists of materials which can be recycled and reused if disassembled by a specialized company. Please observe the local regulations regarding the disposal of packaging materials, exhausted batteries and old equipment.

Dispose of in accordance with local - state and federal regulation. For additional information on recycling contact www.eia.org (Consumer Education Initiative).

Maintenance and service

If the product is defective and needs repair, but the warranty period has expired, you can consult our specialists (refer to page 10).

Philips limited warranty one (1) year

Warranty coverage:

PHILIPS warranty obligation is limited to the terms set forth below.

Who is covered:

Philips warrants the product to the original purchaser or the person receiving the product as a gift against defects in materials and workmanship as based on the date of original purchase ("Warranty Period") from an Authorized Dealer. The original sales receipt showing the product name and the purchase date from an authorized retailer is considered such proof.

What is covered:

The Philips warranty covers new products if a defect arises and a valid claim is received by Philips within the Warranty Period. At its option, Philips will either (1) repair the product at no charge, using new or refurbished replacement parts, or (2) exchange the product with a product that is new or which has been manufactured from new, or serviceable used parts and is at least functionally equivalent or most comparable to the original product in Philips current inventory, or (3) refund the original purchase price of the product.

Philips warrants replacement products or parts provided under this warranty against defects in materials and workmanship from the date of the replacement or repair for ninety (90) days or for the remaining portion of the original product's warranty, whichever provides longer coverage for you. When a product or part is exchanged, any replacement item becomes your property and the replaced item becomes Philips' property. When a refund is given, your product becomes Philips' property.

Note:

- Any product sold and identified as refurbished or renewed carries a ninety (90) day limited warranty.
- Replacement product can only be sent if all warranty requirements are met. Failure to follow all requirements can result in delay.

What is not covered - Exclusions and limitations:

This Limited Warranty applies only to the new products manufactured by or for Philips that can be identified by the trademark, trade name, or logo affixed to it. This Limited Warranty does not apply to any non-Philips hardware product or any software, even if packaged or sold with the product. Non-Philips manufacturers, suppliers, or publishers may provide a separate warranty for their own products packaged with the bundled product.

Philips is not liable for any damage to or loss of any programs, data, or other information stored on any media contained within the product, or any non-Philips product or part not covered by this warranty. Recovery or reinstallation of programs, data or other information is not covered under this Limited Warranty.

This warranty does not apply (a) to damage caused by accident, abuse, misuse, misapplication, or non-Philips product, (b) to damage caused by service performed by anyone other than Philips or Philips Authorized Service Location, (c) to a product or a part that has been modified without the written permission of Philips, or (d) if any Philips serial number has been removed or defaced, or (e) product, accessories or consumables sold "AS IS" without warranty of any kind by including refurbished Philips product sold "AS IS" by some retailers.

This limited warranty does not cover:

- Shipping charges to return defective product to Philips.
- Labor charges for installation or setup of the product, adjustment of customer controls on the product, and installation or repair of antenna systems outside of the product.
- Product repair and/or part replacement because of improper installation, connections to improper voltage supply, abuse, neglect, misuse, accident, unauthorized repair or other cause not within the control of Philips.
- Damage or claims for products not being available for use, or for lost data or lost software.
- Damage occurring to product during shipping.
- A product that requires modification or adaptation to enable it to operate in any country other than the country for which it was designed, manufactured, approved and/or authorized, or repair of products damaged by these modifications.
- A product used for commercial or institutional purposes (including but not limited to rental purposes).
- Product lost in shipment and no signature verification receipt can be provided.
- Failure to operate per Owner's Manual.

If you need information or if you have a problem, please visit the Philips website at www.philips.com/support or contact the Philips Customer Care Centre in your country (you find the phone numbers in this user manual). If there is no Customer Care Centre in your country, please turn to your local Philips dealer or contact Consumer Electronics B.V.

To obtain assistance in the U.S.A., Puerto Rico or U.S. Virgin Islands...

Contact Philips Customer Care Center at:

1-888-PHILIPS (1-888-744-5477)

To obtain assistance in Canada...

1-800-661-6162 (French Speaking)

1-888-PHILIPS (1-888-744-5477) - (English or Spanish Speaking)

REPAIR OR REPLACEMENT AS PROVIDED UNDER THIS WARRANTY IS THE EXCLUSIVE REMEDY FOR THE CONSUMER. PHILIPS SHALL NOT BE LIABLE FOR ANY INCIDENTAL OR CONSEQUENTIAL DAMAGES FOR BREACH OF ANY EXPRESS OR IMPLIED WARRANTY ON THIS PRODUCT. EXCEPT TO THE EXTENT PROHIBITED BY APPLICABLE LAW, ANY IMPLIED WARRANTY OF MERCHANTABILITY OR FITNESS FOR A PARTICULAR PURPOSE ON THIS PRODUCT IS LIMITED IN DURATION TO THE DURATION OF THIS WARRANTY.

Some states do not allow the exclusions or limitation of incidental or consequential damages, or allow limitations on how long an implied warranty lasts, so the above limitations or exclusions may not apply to you.

This warranty gives you specific legal rights. You may have other rights which vary from state/province to state/province.

Philips, P.O. Box 671539, Marietta, GA. 30006-0026

Glossary

Terms and definitions

Term	Definition
BD	Blu-ray Disc.
BD-ROM	BD Read Only Memory. A BD-ROM contains recorded data. For example, high-definition videos.
BD-RE	BD Rewritable. You can record a BD-RE over and over again. For example, you can use a BD-RE to make sequential back-ups.
DVD-VIDEO	DVD Video.
DVD	Digital Versatile Disc.
DVD+/-R	DVD Recordable. You can record a DVD+/-R once and you cannot erase it. For example, you can use it to archive data.
DVD+/-RW	DVD Rewritable. You can record a DVD+/-RW over and over again. For example, you can use a DVD+/-RW to make sequential back-ups.
CD	Compact Disc.
CD-R	CD Recordable. You can record a CD-R once and you cannot erase it. For example, you can use it to archive data.
CD-RW	CD Rewritable. You can record a CD-RW over and over again. For example, you can use a CD-RW to make sequential back-ups.
AUDIO-CD	Audio CD.
HDMI	High Definition Media Interface. It is a direct digital connection that can carry digital high-definition as well as digital multi-channel audio.
kbps	Kilobit per second (1000 bit/s).
JPEG	Data compression standard for digital images.
MP3	Data compression standard for digital audio.
CVBS	Composite video. A type of video signal.
CF	CompactFlash. A memory card with a flash memory.
MD	Microdrive. A type of memory card with a miniature harddisk.
SM	SmartMedia. A type of memory card with a flash memory.
MS	Memory Stick. A type of memory card with a flash memory.
SD	Secure Digital. A type of memory card with a flash memory.
MMC	MultimediaCard. A type of memory card with a flash memory.
RS-MMC	Reduced size MMC.
Chapter	Sections of a video or a music track.

Term	Definition
Title	A complete video on a disc
Track	A music track on a disc.
GB	Gigabyte.

RC4380



www.usasupport.philips.com

For support call:

1-888-744-5477 (English, Español)

1-800-661-6162 (Français)

EN	Universal remote control	3
ES	Control remoto universal	27
FR	Télécommande universelle	41

PHILIPS



Your product	4
Universal remote control.....	4
Need help?	4
Troubleshooting.....	4
Online help	4
Helpline.....	4
Overview	5
Universal remote control.....	5
Prepare	7
Prepare the remote control.....	7
Set up	7
Test the remote control	7
Identify devices	7
Enjoy	9
Volume buttons	9
Copy functions.....	11
Restore the factory default settings.....	13
Replace the batteries.....	14
Troubleshooting	15
Problems and tips.....	15
Technical data	15
Infra-red capabilities.....	15
Dimensions	15
Power	15
Codes	16
TV	16
Amplifiers	19
Set-top boxes	20
DVD	22
VCR.....	23

Your product

Universal remote control

The universal remote control can operate in 5 modes. In each mode, you can control another type of device.

Mode	Device
BD	BDP9000 Blu-ray Disc player
TV	TV
AMP	Amplifier OR Receiver
SAT	Satellite set-top box OR Cable set-top box
DVD	DVD Recorder OR DVD Player OR VCR

Need help?

Troubleshooting

Refer to page 15.

Online help

Refer to www.usasupport.philips.com for:

- Interactive help
- Frequently asked questions

Helpline

Language	Telephone number
English	1-888-PHILIPS (1-888-744-5477)
French	1-800-661-6162
Spanish	1-888-PHILIPS (1-888-744-5477)

Be prepared to give this information:

- A description of the problem and when it occurs
- The type number on the label of the product
- The date of purchase

Universal remote control

Overview of the functions of the buttons in the different modes. It is possible that a function is not available for the device or disc you control.

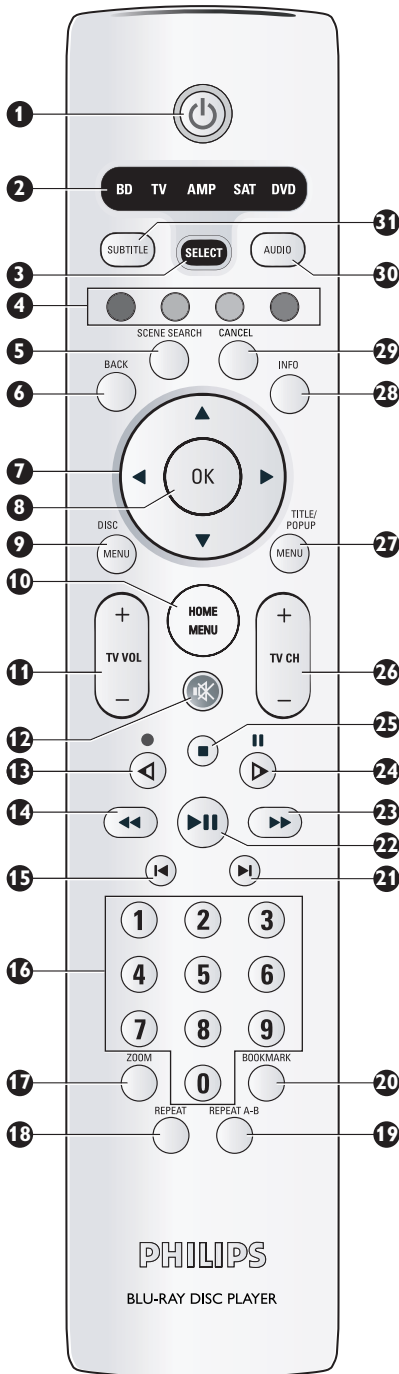

1 Stand-by button

Turns the selected device on and off.

2 Mode lights

Show the selected mode.

- **BD** - Philips BDP9000 Blu-ray Disc player
- **TV** - TV
- **AMP** - Amplifier or receiver
- **SAT** - Cable or satellite set-top box
- **DVD** - DVD player, DVD recorder or VCR

3 Mode selector

- **BD** - Philips BDP9000 Blu-ray Disc player
- **TV** - TV
- **AMP** - Amplifier or receiver
- **SAT** - Cable or satellite set-top box
- **DVD** - DVD player, DVD recorder or VCR

4 Color buttons

The TV shows the functions of the color buttons.

5 Scene search button

- **BD** - Scene search

6 Back button

- **BD, SAT, DVD** - Back

7 Up, down, left and right buttons

Move the cursor in the specified direction.

8 OK button

Confirms a choice.

9 Disc menu button

- **BD, DVD** - Disc menu

10 Home menu button

- **BD** - Home menu
- **TV, AMP, SAT, DVD** - Set-up menu

11 Volume button

- **BD, TV, SAT, DVD** - TV volume up/down.
- **AMP** - Amplifier volume up/down.

12 Mute button

- **BD, TV, SAT, DVD** - Mute TV.
- **AMP** - Mute amplifier.

13 Rewind slow/Record button

- **BD** - Rewind slow
- **DVD** - Record

14 Rewind button

- **BD, SAT, DVD** - Rewind
- **AMP** - Decrease the volume of the center loudspeaker

15 Previous button

- **BD, DVD** - Previous
- **AMP** - Decrease the volume of the rear loudspeakers

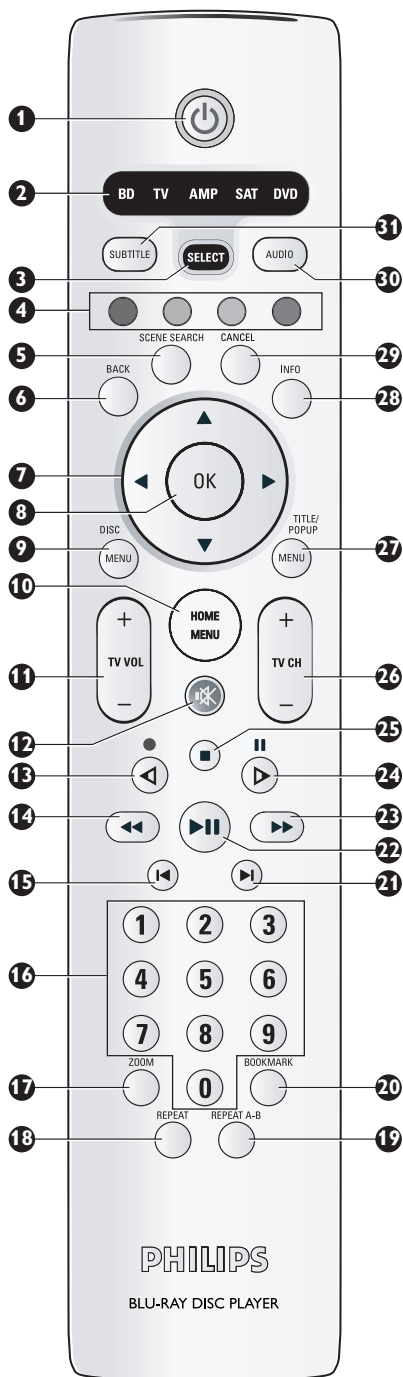

16 Number keys

- BD, TV, SAT, DVD - Enter digits
- AMP - Chooses the audio source (1 = TV, 2 = DVD, 3 = VCR, 4 = Tuner, 5 = CD, 6 = Aux/SAT/MD, 7 = Tape).

17 Zoom button

- BD, DVD - Zoom
- AMP - Surround mode

18 Repeat button

- BD - Repeat title, chapter, track or disc, random

19 Repeat A-B

- BD, DVD - Repeat a defined selection

20 Bookmark button

- BD - Bookmark a position on the disc.
- DVD - Select a chapter

21 Next button

- BD, DVD - Next
- AMP - Increase the volume of the rear loudspeakers.

22 Play/Pause button

- BD - Play/Pause
- SAT, DVD - Play

23 Fast forward button

- BD, SAT, DVD - Fast forward
- AMP - Increase the volume of the center loudspeaker

24 Slow forward button

- BD - Slow forward
- DVD - Pause

25 Stop button

- BD, SAT, DVD - Stop

26 Channel button

- BD, TV, SAT, DVD - TV Channel up/down

27 Title/Pop-up menu button

- BD - Title/pop-up menu
- SAT, DVD - Guide

28 Info button

- BD, TV, SAT, DVD - Info

29 Cancel button

- BD - Cancel

30 Audio button

- BD, DVD - Audio
- AMP - Surround on/off

31 Subtitle button

- BD, SAT, DVD - Subtitles

Prepare

Prepare the remote control

- 1 Open the battery compartment of the remote control.
- 2 Insert the batteries correctly.
- 3 Close the battery compartment.

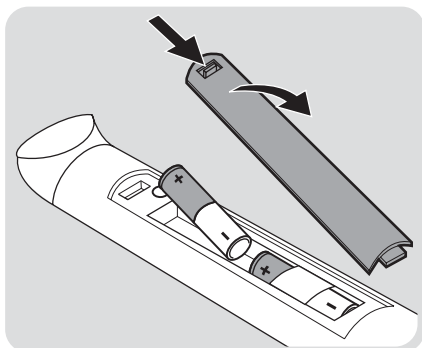

Set up

Test the remote control

The instructions are applicable to a TV. You can use the same procedure to test other devices (for example, DVD players or home theater systems).

- 1 Turn the TV on with the controls on the TV or its own remote control.
- 2 Select the **TV** mode.
 - > The **TV** mode light comes on.
- 3 Make sure that you can operate the TV with the universal remote control. Refer to 'Overview' on page 5 for an overview of the functions of the keys and the buttons.

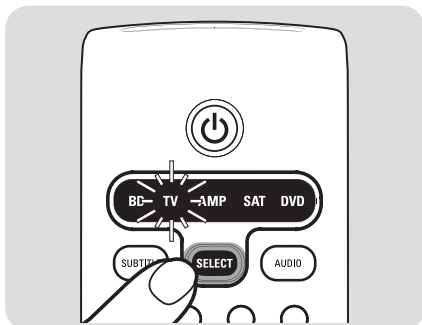

If the device does not react correctly to the universal remote control, you must identify the device yourself (refer to 'Identify devices').

Identify devices

Manually

If a device does not react correctly to the universal remote control, you must identify the device yourself. The instructions are applicable to a TV. You can use the same procedure to identify other devices (for example, DVD players or home theater systems).

- 1 Turn the TV with its own remote control or the TV.
- 2 Go to the first TV channel.

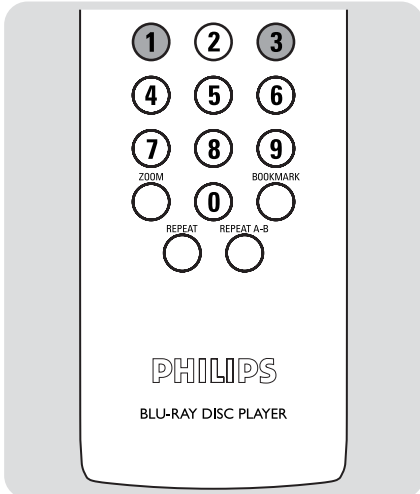
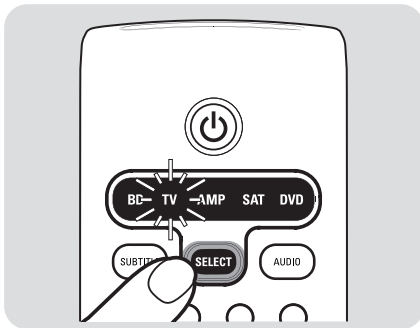

- 3 Press the mode selector until the **TV** light comes on.
- 4 Find the first code for the TV in the TV code list (refer to 'Codes' on page 16).

- 5 Press-and-hold the **1** and **3**.
- 6 When the **TV** light flashes two times, release the **1** and **3**.
- 7 Enter the code from step 4.

After the first and second digits, the **TV** light flashes one time. After the third digit, the **TV** light goes off and flashes two times.

- 8 Make sure that you can operate the TV with the universal remote control. Refer to 'Overview' on page 5 for an overview of the functions of the keys and the buttons.

If the device does not react correctly to the universal remote control:

- 1 Find the next code in the code list.
- 2 Go back to step 5.

OR:

- 1 Search automatically for the correct code.

Search automatically for the correct code

- 1 Turn the TV on with its own remote control or the controls on the TV.
- 2 Go to the first TV channel.
- 3 Press the mode selector until the **TV** light comes on.

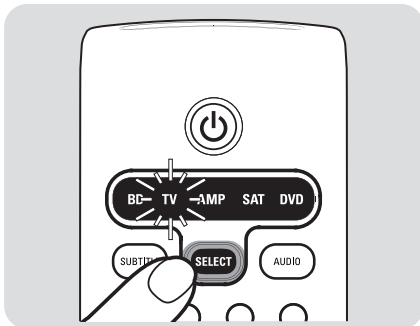

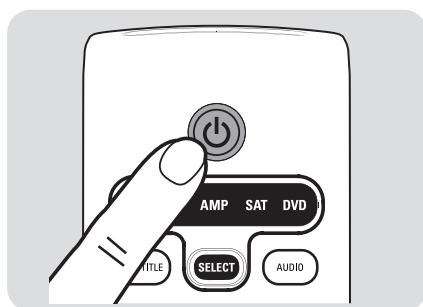
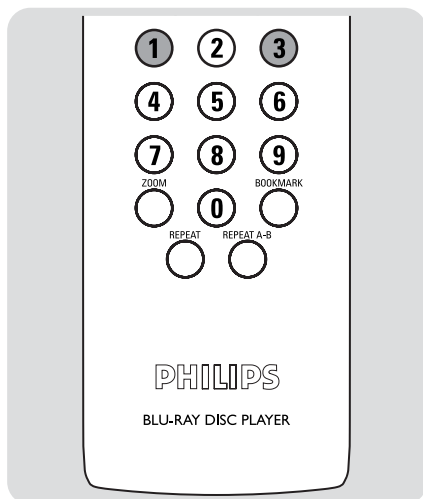

- 4 Press-and-hold the **1** and **3**.
- 5 When the **TV** light flashes two times, release the **1** and **3**.

- 6 Press the stand-by button.
 - > The universal remote control searches automatically for the signal that turns the TV off. Each time that the universal remote control transmits a signal, the **TV** light in the display flashes.
- 7 When the TV is turned off, press the stand-by key.
- 8 Make sure that you can operate the TV with the universal remote control. Refer to 'Overview' on page 5 for an overview of the functions of the keys and the buttons.

Enjoy

Volume buttons

Depending on the selected mode, the volume buttons are assigned to the TV or the amplifier: These are the factory settings:

Mode	Volume buttons
BD	TV
TV	TV
AMP	Amplifier
SAT	TV
DVD	TV

You can change the assignment of the volume controls. For example, you can assign the volume button in the **TV** mode to the amplifier:

- 1 Select the **TV** mode.

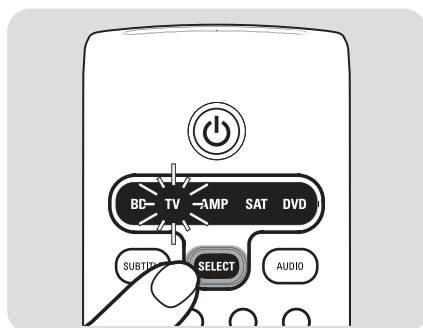

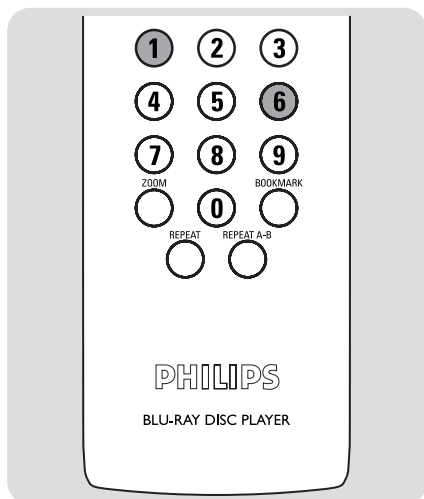

2 Press-and-hold the **1** and **6** until the **TV** mode light flashes two times.

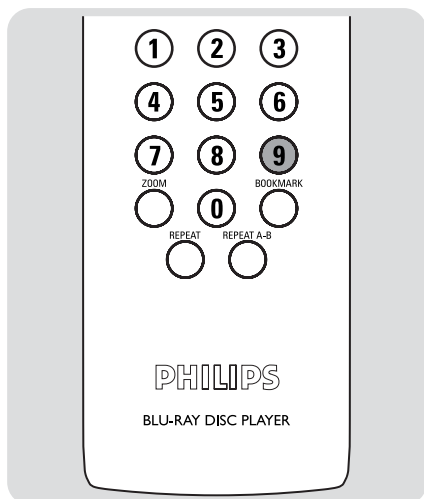

3 Press the **9**.

> *The mode light flashes one time.*

4 Press the **9** again.

> *The mode light flashes one time.*

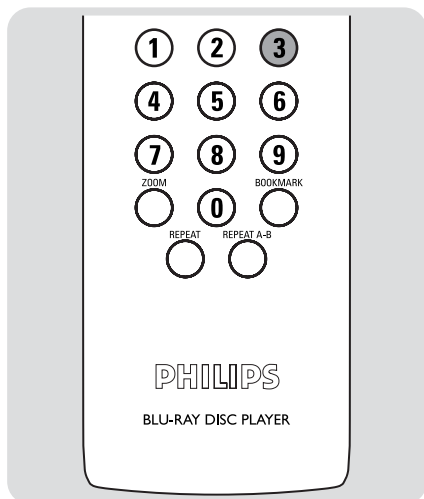

5 Press the **3**.

> *The mode light flashes two times.*

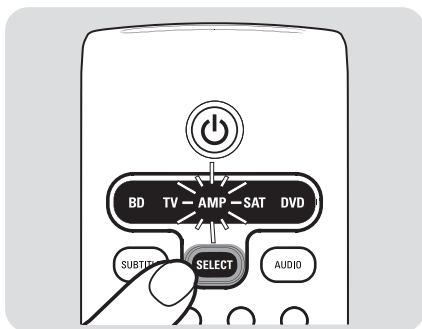

- 6 Select the **AMP** mode.
- 7 Press any button.
 - > The volume button is assigned to the amplifier.

Copy functions

You can copy the function of a device from its own mode to another mode. For example, the mute button of the **AMP** mode to the **TV** mode. Then, you can mute the amplifier in the TV mode.

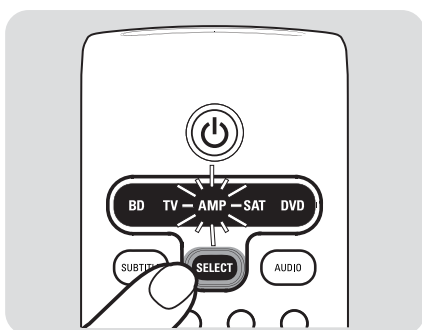

- 1 Select the **AMP** mode.

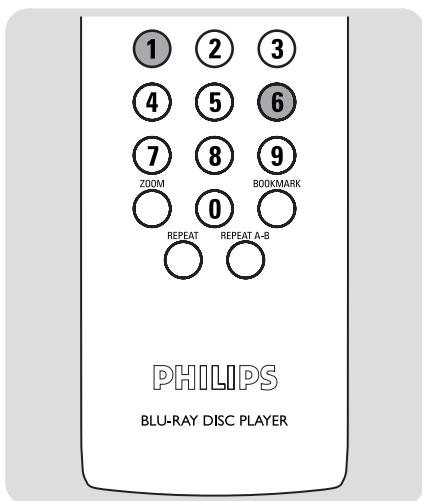

- 2 Press-and-hold the **1** and **6** until the **AMP** mode light flashes two times.

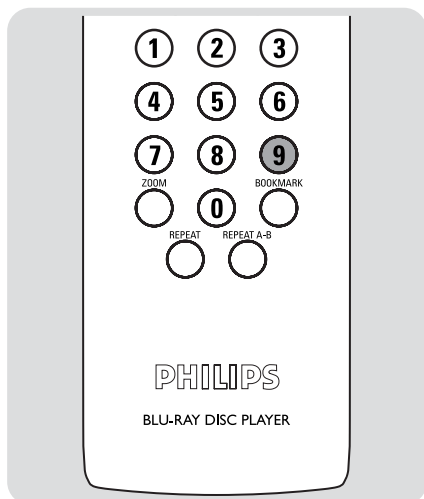

- 3 Press the **9**.
 - > *The mode light flashes one time.*
- 4 Press the **9** again.
 - > *The mode light flashes one time.*

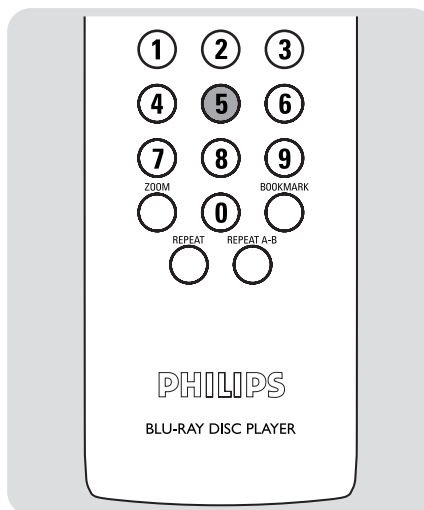

- 5 Press the **5**.
 - > *The mode light flashes one time.*
- 6 Press the mute button (the source button).
 - > *The mode light flashes one time.*

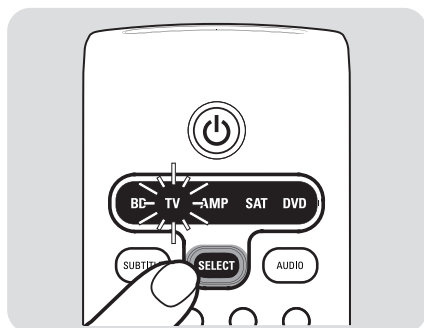

- 7 Select the **TV** mode.
 - > *The TV mode light comes on.*
- 8 Press the target button.
 - > *The function is copied.*

Restore the factory default settings

1 Press-and-hold the **1** and **6** until the mode light flashes two times.

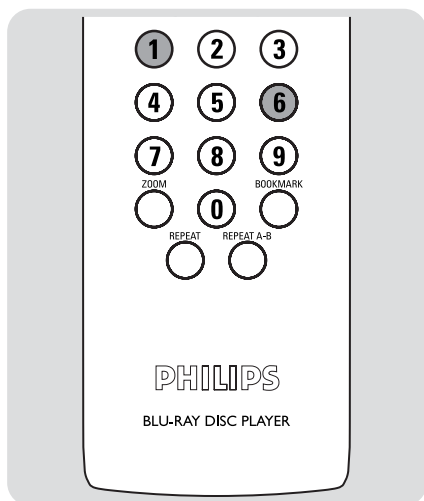

2 Press the **9**.

> *The mode light flashes one time.*

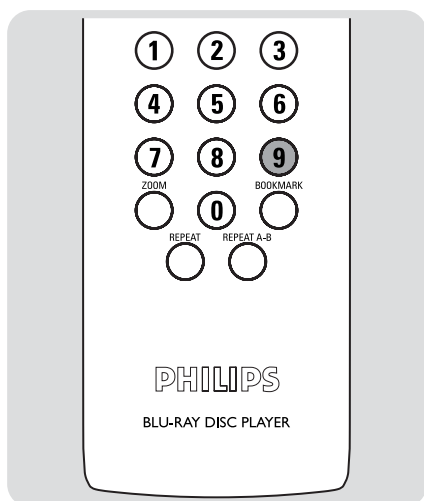

3 Press the **8**.

> *The mode light flashes one time.*

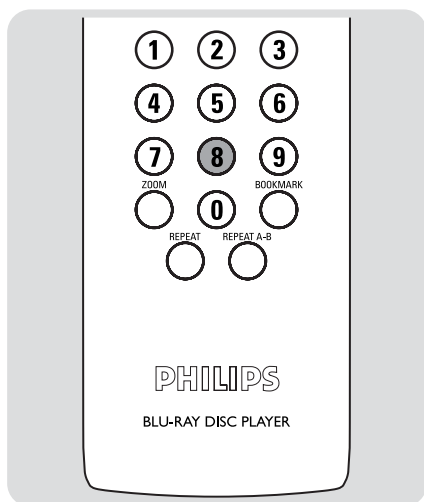

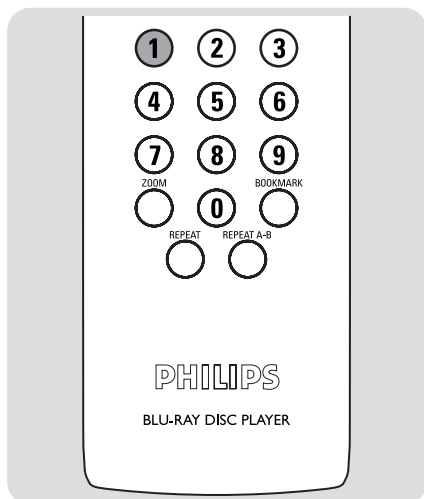

4 Press the 1.

> The mode light flashes two times and the factory default settings are restored.

Replace the batteries

WARNING DO NOT USE OLD AND NEW BATTERIES OR DIFFERENT TYPES OF BATTERIES IN COMBINATION. IF YOU DO, THE BATTERIES CAN LEAK CHEMICALS. THE CHEMICALS CAN CAUSE DAMAGE TO THE PRODUCT AND CAUSE INJURIES.

- When you replace the batteries, make sure you replace them within 5 minutes. The memory of the universal remote control holds all programmed settings for 5 minutes. After 5 minutes, the programmed settings are replaced with the factory default settings.
- When you replace the batteries, make sure that you do not press any key or button. If you do, the programmed settings can be replaced with the factory default settings.
- To prevent battery leakage which may result in bodily injury, property damage, or damage to the unit:
 - Install all batteries correctly, + and - as marked on the unit.
 - Do not mix batteries (old and new, or carbon and alkaline, etc.)
 - Remove batteries when the unit is not used for a long time.

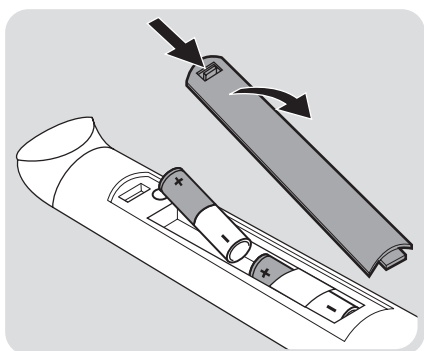

- 1 Open the battery compartment.
- 2 Remove the used batteries.
- 3 Insert the new batteries correctly.
- 4 Close the battery compartment.

Problems and tips

Problem	Tip
The device indicator flashes four times when you press a key or button.	Replace the batteries. Refer to page 14.
The device that you want to operate does not respond AND the device indicator does not flash when you press a key or button.	Replace the batteries. Refer to page 14.
The device that you want to operate does not respond AND the device indicator flashes when you press a key or button.	Remove any obstructions between the remote control and the device.
The universal remote control does not correctly operate the device.	Identify the device again. Refer to page 7.
You cannot copy functions.	The function copy keys is limited to six keys. Restore the factory default settings to delete the copy keys. Refer to page 13.

Technical data

Infra-red capabilities

Operating distance	30 ft (10 m)
Transmitting LEDs	1
Carrier frequency range	36 kHz
Transmission angle	± 22.5 degrees

Dimensions

Product dimensions (WxDxH)	1.9 x 1.1 x 9.3 in (47 x 29 x 237 mm)
Product weight	8 oz (226 g)

Power

Number of batteries	2
Battery type	AA

Codes

TV

Abex	018
Acer	027
Admiral	000 019
Adventura	020
Aiko	008
Aiwa	049
Akai	001
Alleron	011
Amtron	010
Anam National	002 010
AOC	003 004
Apex	043 044 056 083
Audiovox	010
Bell & Howell	000
Benq	042 068
Bradford	010
Broksonic	053 057
Candle	004 005 020
Celebrity	001
Citizen	004 005 008 010 016 017
Colortyme	004
Concerto	004
Contec/Cony	006 010
Craig	010
Crown	010 014
Curtis Mathes	004 007 016 017 024
CXC	010
Daewoo	003 004 008 017 041 067
Daytron	004 017
Dell	071 072
Dimensia	024
Electroband	001
Electrohome	001 002 004
Emerson	004 006 009 010 011 017 022 041
Envision	004
Fisher	040
Fujitsu	011 026
Funai	010 011
Futuretech	010
Gateway	045
GE	002 004 012 013 024 073 084
Goldstar	003 004 006 017 018
Grunpy	010 011
Hallmark	004
Harvard	010
Hisense	051
Hitachi	004 006 023 039 064 065 066
IMA	010
Infinity	014

Janeil	020
JBL	014
JC Penney	003 004 005 012 013 016 017 018 024
JCB	001
Jensen	004
JVC	006 013 015 038 054 063
Kawasho	001 004
Kenwood	004
Kloss Novabeam	010 020
KTV	010 017
LG	003
Loewe	014
Logik	000
Luxman	004
LXI	004 014 024
Magnavox	004 005 014 075
Majestic	000
Marantz	004 014
Megatron	004
Memorex	000 003 004 037
MGA	003 004
Midland	013 017 018
Minutz	012
Mitsubishi	003 004 036
Montgomery Ward	000
Motorola	002 019
MTC	003 004 016
Multitech	010
NAD	004 023
NEC	002 003 004
NET-TV	046
Nikko	004 008
NTC	008
Onwa	010
Optimus	023
Optonica	019
Orion	009 022 035
Panasonic	002 013 014 034 059
Philco	002 003 004 005 006 014
Philips	002 005 006 014 033 047 060 076
Philips Magnavox	076
Pilot	017
Pioneer	004 023 048
Portland	003 004 008 017
Price Club	016
Prima	052
Prism	013
Proscan	024
Proton	004 006
Quasar	002 013 032 085
Radio Shack	024
Radio Shack/Realistic	004 006 010 017 018
RCA	002 003 004 024 086
Realistic	024
Sampo	004 017 018
Samsung	003 004 006 007 016 017 018 031 081 082
Sansui	022 035 058

Scotch	004									
Scott	004	006	009	010	011					
Sears	004	011	015	021	024					
Sharp	004	006	017	019	030	069	079			
Signature	000									
Simpson	005									
Sony	001	047	062							
Soundesign	004	005	010	011						
Squareview	021									
SSS	010									
Starlite	010									
Supre-Macy	020									
Supreme	001									
Sylvania	004	005	014	025	074	078				
Symphonic	010	021	029							
Tandy	019									
Tatung	002									
Technics	013									
Techwood	004	013								
Teknika	000	003	004	005	006	008	010	011	016	017
TMK	004									
Toshiba	016	028	061	080						
Totevision	017									
Universal	012									
Victor	015									
Vidtech	003	004								
Viewsonic	077									
Viking	020									
Wards	000	003	004	011	012	014	024			
White Westinghouse	041									
Yamaha	003	004								
Zenith	000	050	055	070						

Amplifiers

Aiwa	003	020	037	038	052		
BOSE	049	063					
Carver	002	052					
Citizen	026						
Denon	014	053					
Fisher	002						
GE	028						
Goldstar	016	021					
Harmon/Kardon	013	043	052				
Hitachi	034						
JBL	043						
JVC	018	024	064				
Kenwood	015	022	039	057	058		
Koss	065						
Linn	052						
Magnavox	035	052					
Marantz	000	052					
Nakamichi	012						
NEC	033						
Onkyo	005	006	017	044	066		
Optimus	008						
Panasonic	001	045	046				
Philips	052	067	071				
Pioneer	004	009	010	023	036	042	056 068
Proton	035						
Quasar	001						
RCA	025	040	050	051	069		
RePlay	028						
Sansui	052						
Sharp	029	030	031	032			
Sherwood	011	048					
Sony	020	041	047	055	060	061	062
Teac	019						
Technics	001	045	046	054			
Toshiba	027						
Venturer	070						
Victor	024						
Wards	042	052					
Yamaha	007	042	059				

Set-top boxes

Satellite

Alphastar	023							
Chaparral	002	003						
DISH Network	053							
Dishnet	022							
Drake	004	005						
Echostar	030							
GE	000	001	016	033				
General Instruments	006	007	008					
Hitachi	026	027						
Hughes	051							
Hughes Network Systems	021	031						
JVC	025							
Mitsubishi	040							
Panasonic	019	045	048	049				
Philips	028	037	044	051	054	109		
Primestar	020							
Proscan	000	001	016	033				
RCA	000	001	016	024	033	038	050	051
Realistic	009							
Samsung	041	042	051					
Sony	017	034	036	039	043	052		
STS	032							
STS1	010							
STS2	011							
STS3	012							
STS4	013							
Toshiba	014	018	046					
Uniden	015	029						
Zenith	035	047						

Cable

ABC	055	056	057	059	101				
Antronix	061	062							
Archer	062	063							
Cabletenna	061								
Cableview	060								
Colour Voice	065	066							
Comtronics	067								
Contec	069								
Eastern	070								
GC Electronics	062								
GE	055	056							
Gemini	071	072							
General Instruments	056	103	106						
Hamlin	073	074	075	081	088	094	102		
Hitachi	056								
Jerrold	056	071	076	077	095	101	103		
Magnavox	078								
Memorex	079								
Motorola	107								
Movie Time	080								
NEC	058								
NSC	080								
Oak	069	082							
Panasonic	097	100							
Philips	064	065	066	068	072	078	083	084	085
Pioneer	086	087							
Proscan	055	056							
RCA	060	096	098	100	103				
Realistic	062								
Regal	075	088	102						
Regency	070								
Rembrandt	056								
Samsung	087								
Scientific Atlanta	059	089	090	091	104				
Signal	071								
Signature	056								
Sony	105								
Sprucer	100								
Standard Component	092	093							
Starcom	071	101							
Stargate	071								
Starquest	071								
TIME WARNER	108								
Tocom	057	076							
Tusa	071								
TV86	080								
Unika	061	062							
United Cable	101								
Universal	061	062	063						
View Star	069	078	080						
Zenith	099								

DVD

Players

Memorex	008
Mintek	009
Mitsubishi	084 100
NAD	040 094
Nakamichi	078
Nexxtech	095
Norcent	010 079
Onkyo	002 011
Oritron	013
Panasonic	047 054 072 073
Philips	021 027 033 171
Pioneer	003 012
Polaroid	001
Proscan	080 099
Qwestar	013
RCA	024 030 036 044 055 069 074 080
Sampo	081
Samsung	014 031 053
Sansui	050
Sanyo	032 082
Sharp	015 016 026 060 062
Sherwood	083
Sony	017 018 046 048 049 063
Sylvania	045 056 066
Techwood	096
Toshiba	019 058 067
Venturer	004
Yamaha	101
Zenith	034 088

Recorders

Apex Digital	181
Panasonic	175
Philips	173 176 178 179
Pioneer	177
RCA	172
Sony	174
Yamaha	180

VCR

Adventura	115									
Aiko	116									
Aiwa	115									
Akai	103	125								
American High	113									
Asha	108									
Audio Dynamics	104	105								
Audiovox	109									
Beaumarck	107	108								
Bell & Howell	106									
Broksonic	107	145	146							
Calix	109									
Candle	108	109	110	111	112					
Canon	113									
Capehart	124									
Carver	121									
CCE	116	120								
Citizen	108	109	110	111	112	116				
Colortyme	104									
Colt	120									
Craig	108	109	114	120						
Curtis Mathes	104	108	111	112	113	127				
Cybernex	108									
Daewoo	110	115	116	124	140					
Daytron	124									
DBX	104	105								
Dimensia	127									
Dynatech	115									
Electrohome	109	117								
Electroponic	109									
Emerson	107	109	110	113	115	117	147			
Fisher	106	114								
Fuji	103	113								
Funai	115	128								
Garrard	115									
GE	108	113	127	153						
Go Video	130	137	167							
Goldstar	104	109	112							
Gradiente	115									
Harley Davidson	115									
Harmon/Kardon	104									
Harwood	120									
Headquarter	106									
Hi-Q	114									
Hitachi	119	125	169							
Instant Replay	113									
JC Penney	104	105	106	107	108	109	113	119	120	121
JCL	113									
Jensen	119	125								
JVC	104	105	106	112	125	131				
Kenwood	104	105	106	111	112	125				
KLH	120									
Kodak	109	113								
LG	109									

Lloyd's	115								
Logik	120								
LXI	109								
Magnavox	113	121	123						
Magnin	109								
Marantz	104	105	106	111	112	113	121		
Marta	109								
Matsushita	113								
MEI	113								
Memorex	106	108	109	113	114	115	123	129	
MGA	117								
MGN Technology	108								
Midland	118								
Minolta	119								
Mitsubishi	117	119	166						
Motorola	113								
MTC	108								
Multitech	108	111	115	118	120				
NEC	104	105	106	111	112	125			
Nikko	109								
Noblex	108								
Olympus	113								
Optimus	109								
Optonica	122								
Orion	129								
Panasonic	113	141	142	143	150	165			
Pentax	111	119							
Pentex Research	112								
Philco	113	121							
Philips	113	121	122	135					
Pilot	109								
Pioneer	105	119							
Polaroid	168								
Portland	111	124							
Proscan	127								
Protec	120								
Pulsar	123								
Quarter	106								
Quartz	106								
Quasar	113	154							
Radio Shack	109	122							
Radio Shack/Realistic	106	108	109	113	114	115	117	122	
Radix	109								
Randex	109								
RCA	108	113	119	127	132	139	155		
Realistic	106	108	109	110	113	114	115	117	122
Ricoh	126								
Runco	123								
Samsung	108	110	118	133	148	152			
Sanky	123								
Sansui	105	125	129						
Sanyo	106	108	114	134					
Scott	107	110							
Sears	106	109	113	114	119				
Sharp	117	122	144	161					
Shintom	103	120							
Shogun	108								

Singer	113	120	126							
Sony	103	149	163							
STS	113									
Sylvania	113	115	121	151	156	164				
Symphonic	115	128								
Tandy	106									
Tashiko	109									
Tatung	125									
Teac	115	125								
Technics	113									
Teknika	109	113	115							
Tivo	138									
TMK	108									
Toshiba	110	119	157	159	160	162				
Totevision	108	109								
Unitech	108									
Vector Research	104	105	110	111						
Victor	105									
Video Concepts	104	105	110	111						
Videosonic	108									
Wards	108	109	110	113	114	115	117	119	120	122
White Westinghouse	128									
XR-1000	113	115	120							
Yamaha	104	105	106	112	125					
Zenith	103	123	126	136	158	170				

Free Manuals Download Website

<http://myh66.com>

<http://usermanuals.us>

<http://www.somanuals.com>

<http://www.4manuals.cc>

<http://www.manual-lib.com>

<http://www.404manual.com>

<http://www.luxmanual.com>

<http://aubethermostatmanual.com>

Golf course search by state

<http://golfingnear.com>

Email search by domain

<http://emailbydomain.com>

Auto manuals search

<http://auto.somanuals.com>

TV manuals search

<http://tv.somanuals.com>