



Congratulations on becoming the proud owner of a Philips CTV.

Your television set has been designed, engineered and tested to very high standards to provide superior quality Picture and Sound for your enjoyment

Philips Colour Television means that the best design, reliability and quality are ensured with every set manufactured. In addition, your set complies with International Safety Standards - IEC 65.

Your television set has a host of features. Please read this 'Operating Instructions' booklet carefully and get to know about your set.

We wish you a very enjoyable viewing on your new Philips Colour Television.

Superior Picture Clarity

Features depends on specific to type no. of model. Specification are subject to change without notice.

PHILIPS

3115 116 15963

**B Safety information**

- Disconnect mains plug when :
  - the indicator light below the TV screen is flashing continuously,
  - a bright white line is displayed across the screen,
  - there is a lightning storm,
  - the set is left unattended for a prolonged period of time.
- cleaning the TV screen. Never use abrasive cleaning agents. Use a slight damp chamois leather or soft cloth.
- No naked flame sources, such as lighted candles, should be placed on top of the TV or in the vicinity.
- Do not place your TV set under direct sunlight or heat.
- Leave at least 10 cm around each side of TV set to allow for proper ventilation.
- Avoid placing your set (e.g. near the window) where it is likely to be exposed to rain or water.
- No objects filled with liquids should be placed on top the TV so as to avoid dripping or splashing of liquids on the set.

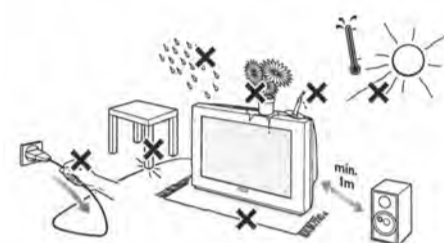

**Useful information**

- Do not leave your set on standby mode for a prolonged period of time. Switch off set to allow it to be demagnetised. A demagnetised set supports good picture quality.
- Do not shift or move the set around when it is switched on. Unevenness in colour in some parts of the screen may occur.
- Never attempt to repair a defective TV yourself. Always consult a skilled service personnel.

**D Connecting peripheral equipment**

**Other equipment**

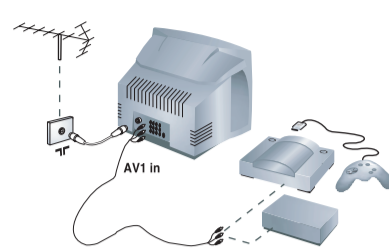

- 1 Carry out the connections as shown.
- 2 To optimise picture quality, connect the equipment which produces the video signals (digital decoder, games, etc) to AV1 in and equipment which produces the S-Video signals S-Video and Hi-8 video recorders, certain DVD drives to AV2 in and all other equipment to either AV1 in or AV2 in.

**Amplifier**



- 1 To connect to a hi-fi system, use an audio connection cable and connect the "L" and "R" outputs on the TV set to the "AUDIO IN" "L" and "R" input on your hi-fi amplifier. Make the connections as shown.

**Side connections**

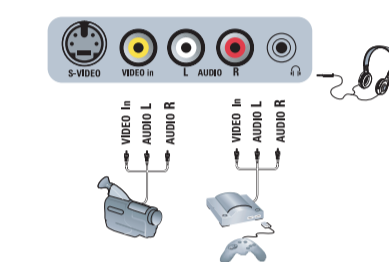

With the **Side** key, select the channel Side. For a monophonic device, connect the audio signal to the AUDIO L input. Use the **Left** key to reproduce the sound on the left and right speakers of the TV set.

**Headphones**  
When headphones are connected, the sound on the TV set will be cut. The VOL + or - keys are used to adjust the volume level. The headphone impedance must be between 32 and 600 Ohms.

**F Before Calling Service**

Below is a list of frequently occurred symptoms. Before you call for service, make these simple checks. Some of these symptoms can easily be rectified if you know what to do.

Symptom	What you should do
Colour patch (unevenness)	<ul style="list-style-type: none"> <li>• Switch off the TV by the mains power button. Wait for 20 minutes before switching on again.</li> <li>• Check the TV is not placed too near speakers or magnetic objects.</li> </ul>
No power	<ul style="list-style-type: none"> <li>• Check the TV's AC power cord is plugged into the mains socket. If there is still no power, disconnect plug. Wait for 60 seconds and re-insert plug. Switch on the TV again.</li> </ul>
No picture	<ul style="list-style-type: none"> <li>• Check the antenna connection at the rear of the TV.</li> <li>• Possible TV station problem. Try another channel.</li> </ul>
Good picture but no sound	<ul style="list-style-type: none"> <li>• Try increasing the volume.</li> <li>• Check that the sound is not muted. If it is muted, press the <b>Mute</b> button on the remote control to restore sound.</li> </ul>
Good sound but poor colour or no picture	<ul style="list-style-type: none"> <li>• Try increasing the contrast and brightness setting.</li> </ul>
Snowish picture and noise	<ul style="list-style-type: none"> <li>• Check antenna connection at the rear of the TV.</li> </ul>
Horizontal dotted lines	<ul style="list-style-type: none"> <li>• Possible electrical interference e.g. hairdryer, vacuum cleaner, etc. Switch off appliances.</li> </ul>
Double images or "Ghost" images	<ul style="list-style-type: none"> <li>• Possible poor positioning of antenna. Using a highly directional antenna may improve reception.</li> </ul>
TV not responding to remote control handset	<ul style="list-style-type: none"> <li>• Check life span of batteries of remote control handset.</li> <li>• Aim remote control handset directly at remote control sensor lens on the TV.</li> </ul>
No colour in picture	<ul style="list-style-type: none"> <li>• Select your desired colour system manually if reception is poor in Auto mode.</li> </ul>
One white line across	<ul style="list-style-type: none"> <li>• Switch-off the TV immediately and call for after-sales service</li> </ul>
Doming	<ul style="list-style-type: none"> <li>• A prolonged view of very bright static picture can lead to development of uneven colour patches in some portions of the screen. This is not a defect and will disappear in few minutes after moving picture resumes</li> </ul>

**A Installing your television set**

**Positioning the television set**

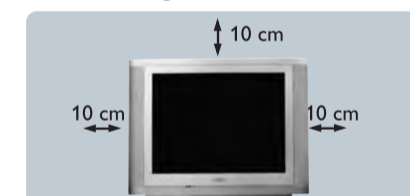

Place your TV on a solid, stable surface, leaving a space of at least 10 cm around the appliance.

**Remote control**

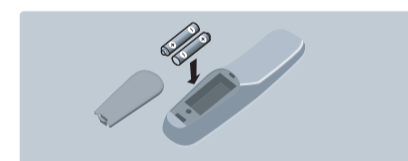

Insert the two R6-type batteries making sure that they are the right way round.

If remote control is not used for a long period of time remove the batteries and store it in a cool, dry place.

**Connections**

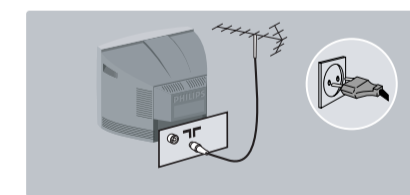

- Insert the aerial plug into the **T** socket at the rear of the set. If you are using an indoor aerial, reception may be difficult in certain conditions. You can improve reception by rotating the aerial. If the reception remains poor, you will need to use an external aerial.
- Insert the mains plug into a wall socket.

**Switching on**



To switch on the set, press the on/off key. A red indicator means that the television is on standby mode. Refer to the next page on 'Remote Control keys' for the various keys that you could use to switch on the set. An indicator light will flash when it is receiving signal from the remote control.

**The keys on the TV set**

The television set has 4 keys which are located at the top or front.

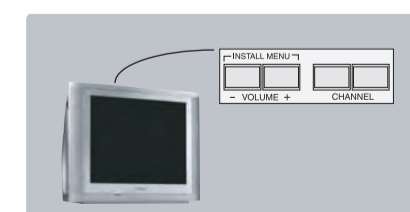

The **Volume +/-** keys are used to adjust the sound levels. The **Channel +/-** keys are used to select channels. To access or exit the main menu, press down the **Volume +/-** keys, simultaneously. To select an item in the main menu, press the **Channel +/-** key. To select an adjustment, press down the **Volume +/-** key.

**C Connecting peripheral equipment**

**DVD player**

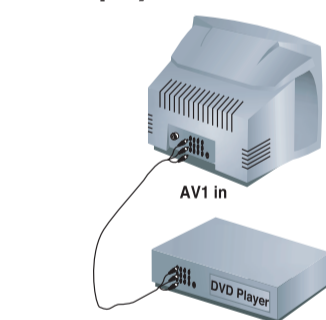

- 1 Connect the TV's green, blue and red Y Pb Pr (AV1 in) jacks to the corresponding COMPONENT VIDEO OUT jacks on the player.
- 2 Connect the TV's red and white (R and L) AUDIO IN jacks to the corresponding AUDIO OUT jacks on the player. Match the cable colour to the jacks' colour. The red jack is the Right audio channel and the white jack is the Left audio channel.
- 3 Turn on the TV and DVD player. Set the TV to CVI and DVD background screen will come on the screen. You can now play your disc. Note: You need to select the channel CVI manually to playback DVD disc.

**Video recorder**

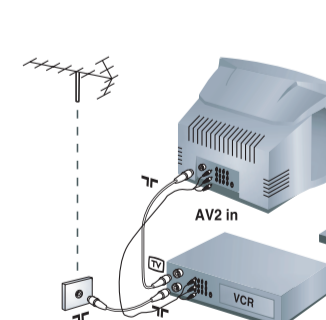

- 1 Connect the TV's yellow, white and red (AV2 in) jacks to the corresponding Video and Audio jacks on the player.
- 2 Connect the TV's red and white (R and L) AUDIO IN jacks to the corresponding AUDIO OUT jacks on the player. Match the cable colour to the jacks' colour. The red jack is the Right audio channel and the white jack is the Left audio channel.
- 3 Turn on the TV and VCR player. Set the TV to channel AV2. You can now play your video cassette tape. Connection is also possible via the aerial cable. You will therefore need to tune in your video recorder's test signal and assign a channel number 0. Select channel 0 to playback.

**E Remote control keys**

- Personal Zapping**: You can surf up to 10 personal channels for each key.
- Sleeptimer**: Selects a period of time after which the TV will go into standby mode automatically.
- Add Personal Zapping list**: Adds and stores channels into Personal Zapping list.
- Smart Sound**: Used to access a series of stored settings: Theatre, Music, Voice, Hall, Indipop, Raga, Orchestra, Bhajan, Disco, Opera, Bhanga, Gazal, Personal.
- Menu**: To call up or exits menus.
- Cursor**: These 4 keys are used to move around the menus or provide direct access to the different picture formats.
- Volume**: To adjust the sound level.
- Digit keys**: Direct access to the channels. For a 2-digit channel, enter the 2nd digit before the dash disappears.
- Alternate channel**: Switched between the current and the previous channel.
- Standby**: Lets you place the TV set on standby. To turn on the TV, press CH + or -, AV, A/CH or digit keys.
- AV channel selection**: Press several times to select AV1, CVI, AV2, YPbPr or Side.
- Delete Personal Zapping list**: Deletes stored channels from Personal Zapping list.
- Smart Picture**: Used to access a series of stored settings: Rich, Natural, Soft, DVD/VCD or Personal.
- Incredible Surround**: To activate/disable the Incredible Surround feature. In stereo, the speakers appear further apart. In mono, a pseudo-spatial effect is obtained.
- I/II**: During stereo transmission (in AV mode), to switch from Stereo to Mono. During dual sound transmission, to switch between language I or II.
- Channel selection**: To access the next or previous channel. The number and sound mode are displayed for a few moments whenever you select a new channel.
- Mute**: To mute or restore sound.
- On screen display**: To display/clear the on screen information. Press the key for 3 seconds to activate permanent display of channel number. This key is also used to exit from the menu.

**G Auto Store**

This menu is used to store all available channels automatically. Press the **Auto Store** key. With the cursor, select the **Install** menu and follow by the **Auto Store**.

- 1 Use the **Auto Store** key to start auto store. All the available TV channels will be stored automatically. This operation takes a few minutes. The display shows the progress of the search and the number of channels found.
- 2 To quit the menus, press **Exit**.

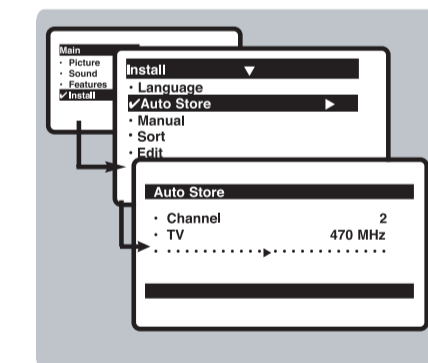

**Manual Store**

This menu is used to store channels one at a time.

- 1 Press the **Manual Store** key.
- 2 With the cursor, select the **Install** menu and follow by the **Manual**.
- 3 **Colour Sys(tem)**: use the **Left** or **Right** key to select the desired colour system: Auto, PAL, NTSC 3.58 or NTSC 4.43.
- 4 **Sound Sys(tem)**: use the **Left** or **Right** key to select the desired sound system: BG, I, DK or M.
- 5 **Search**: Press **Search**. The search starts. Once a channel is found, the scanning stops. Go to the next step.
- 6 **Channel**: enter the required channel with the **Left**, **Right** or digit keys.
- 7 **Fine Tune**: if the reception is not satisfactory, adjust using the **Left** or **Right** keys.
- 8 **Store**: Press **Store**. The channel is stored.
- 9 Repeat steps **3** to **4** for each channel you wish to store.
- 10 To quit the menus, press **Exit**.

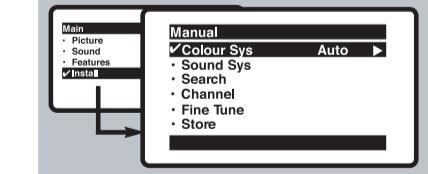



## H Sort

This feature allows you to rearrange channels according to your preference.

- Press the **Home** key. The **Main menu** is displayed on the screen.
- With the cursor, select the **Install menu** followed by the **Sort menu**.
- Use the **Left** or **Right** key to select the channel number you want to change

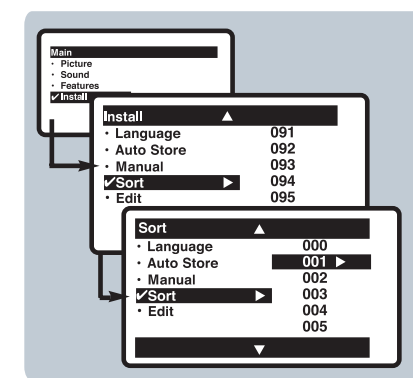

from (e.g. 001) and confirm selection with the **Enter** key.

- Use the **Left** or **Right** key to select the channel number you want to change to (e.g. 004) and confirm selection with the **Enter** key.
- The change is done. Channel 4 will move up to channel 3 and channel 3 will move up to channel 2.
- Repeat steps 1 and 2 for each channel you wish to change.
- To quit the menus, press **Exit**.

## Channel edit

This feature allows you to skip or edit channels which have bad or weak TV signal or channels you do not watch often.

Once a channel is skipped, you cannot have access to it by the Channel + or - key. You can only access the channels by the digit (0-9) keys.

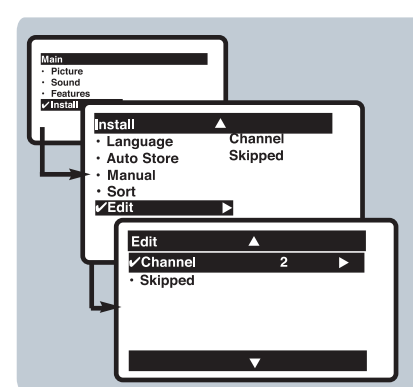

- Press the **Home** key. The **Main menu** is displayed on the screen.
- With the cursor, select the **Install menu** followed by the **Edit menu**.
- Enter into the menu and select the channel number you wish to skip by the digit keys.
- Then use the **Left** key to select **Skipped**. Use the **Enter** key to select **On**.
- Repeat steps 1 and 2 for each channel you wish to skip.
- To quit the menus, press **Exit**.

### To restore skipped channels

- Repeat steps 1 to 3 above.
- Use the **Left** key to select **Skipped** and the **Right** key to select **Off**.
- Repeat steps 1 and 2 for each channel you wish to skip.
- To quit the menus, press **Exit**.

## J Timer Function

This feature allows you to set the timer to switch to a channel at a specified time while you are watching another channel or when the TV is on standby mode.

Note: Timer will be disabled once the set is switched off.

- Press **Home**, use the **Left** or **Right** key to select **Features** and press the **Enter** key. The **Features menu** is displayed.

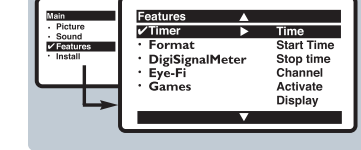

- Use the **Left** key to select **Timer**.

**Description of function:**  
**Time:** enter the current time.

**Start Time:** enter the time for the TV to switch to on or to switch channel.

**Stop Time:** enter the time to switch to standby.

Note: If Stop Time is not keyed in, TV will go to standby mode after 4 hours. To switch on the TV from standby, press Channel + or -, digit or Power key.

**Channel:** enter the channel to switch to. **Activate:** enter mode of activating timer; Once, Daily or Off.

**Display:** select **On** to display the time on the TV screen.

- Press the **Enter** key to exit.

## Child Lock

You can block certain channels or inhibit use of the TV set completely.

Note: You can only access the locked channels via the remote control. Keep the remote control in a safe place.

- Press **Home**, use the **Left** or **Right** key to select **Features** and press the **Enter** key. The **Features menu** is displayed.

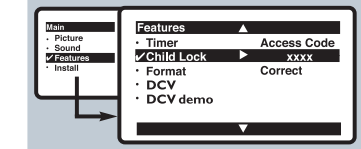

- Use the **Left** key to select **Child Lock** and press the **Enter** key to enter.

Key in the 4-digit access code, for the first time or if you have forgotten the code, enter **0711** twice.

There will be a prompt to key in the **New Code**.

- Key in your preferred code once and again to confirm.

The Child Lock menu is displayed.

- Use the **Left** or **Right** key to select a function and the **Enter** key to enter or confirm selection.

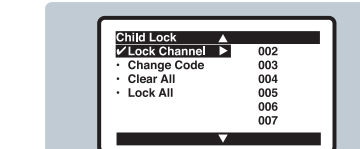

### Description of function:

**Lock Channel:** use the **Left** or **Right** key to select a channel number to lock and press the **Enter** key to confirm. The **Lock** symbol will display next to the channel that was locked.

**Change Code:** enter a new code and again to confirm.

**Clear All:** use to unlock all locked channels. Select **On** to activate.

**Lock All:** use to lock all TV and external channels. Select **On** to activate.

## I Picture settings

- Press **Home** then **Picture**. The **Picture menu** will be called up.

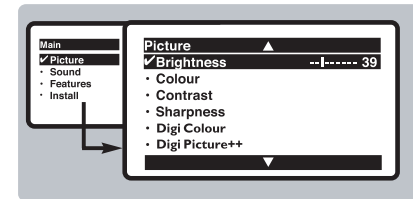

- Use the **Left** or **Right** keys to select a setting and the **Left** or **Right** key.

Note: during the picture adjustment, only the selected line remains displayed. Press **Left** or **Right** to display the menu again.

- Press **Exit** to exit.

### Description of the adjustments:

**Brightness:** this changes picture brilliance.

**Colour:** this changes the intensity of the colour.

**Contrast:** this changes the difference between the light and dark tones.

**Sharpness:** this changes the picture definition.

**Hue:** this adjusts the skin colour tone in NTSC channel.

**Digi Color +:** this changes the colour rendering; Cold(bluer), Normal(balanced) or Warm (redder).

**Digi Picture++:** attenuates picture noise (snow) in difficult reception conditions.

**Digi Contrast:** automatic adjustment of the picture contrast which permanently sets the darkest part of the picture black.

## Sound settings

- Press **Home**, select **Sound** and press **Enter**. The **Sound menu** will be called up.

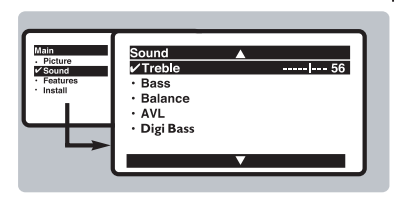

- Use the **Left** or **Right** key to select a setting and the **Left** or **Right** key to adjust.
- Press **Exit** to exit.

### Description of the adjustments:

**Treble:** this alters the high frequency sounds.

**Bass:** this alters the low frequency sounds.

**Balance:** this balances the sound on the left and right speakers.

**AVL (Automatic Volume Leveller):** this is used to limit increases in sound, especially on channel change or advertising slots.

**Digi Real Audio (Incredible Surround):** this boost the effect of stereo sound.

**Digi Bass:** this is used to enhance bass output.

## Features settings

- Press **Home**, select **Features** and press **Enter**. The **Features menu** will be called up.

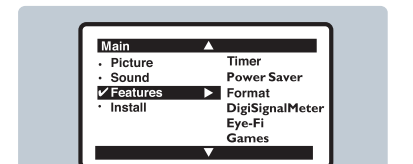

### Description of the features:

**Timer, Child Lock, Format, Eye-Fi, Dcv, Dcv demo, Power Saver, DigiSignalMeter, Game:** see explanation on the next few pages.

## K Format

This feature enhances your viewing pleasure by providing you with a choice of two picture formats: **4:3** and **Expand 4:3**.

- Press **Home**, use the **Left** or **Right** key to select **Features** and press the **Enter** key. The **Features menu** is displayed.
- Use the **Left** key to select **Format** and press the **Left** key to select **4:3** or **Expand 4:3**.
- Press the **Enter** key to exit.

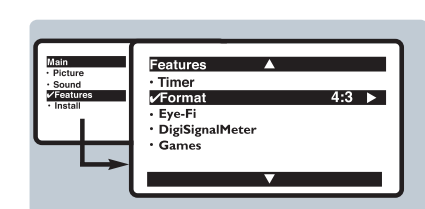

**Description of function:**  
**4:3** – select this format if you want to display a conventional picture using the full surface of the screen.

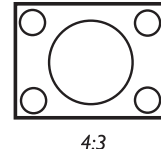

**Expand 4:3** – select this format if you want to expand pictures transmitted in a 'letterbox' format (black horizontal bars at the top and bottom of the screen) to fill up the entire screen.

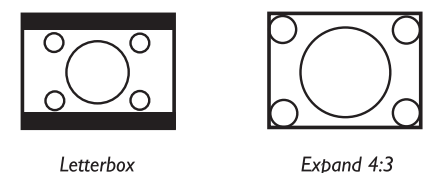

## Eye-Fi

The Eye-Fi monitors and adjusts incoming video signals to help provide the best picture quality. When you choose to turn the Eye-Fi On or Display On, the Brightness, Colour, Contrast, Sharpness, Digi Contrast and Digi Picture++ features are controlled automatically. Eye-Fi adjusts these picture settings continuously and automatically.

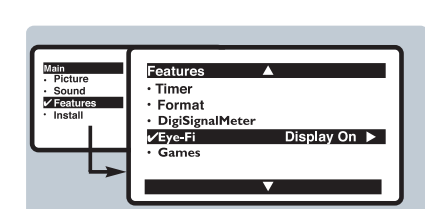

- Enter Features menu as described in "Features settings" on the previous page.
- Use the **Left** key to select **Eye-Fi** and press the **Enter** key to select **Off**, **On** or **Display On**.
- Press the **Enter** key to exit.

**Description of option:**  
**Off:** the Eye-Fi will not be activated.

**On:** the Eye-Fi will work to give the viewer the best possible picture, but will not display the monitoring screen when channels are changed.

**Display On:** an Eye-Fi monitoring screen will be shown for a few seconds whenever a channel is changed.

**DigiSignalMeter** is an intelligent feature which measures the incoming signal and graphically represents the signal strength on your TV screen.

Note: Default mode for Intelligent TV (visible under Picture sub-menu only when Eye-Fi is switched On) is either Auto/Off depending upon the signal condition. It can be switched On (if default Off) for further improvement in picture quality (switch off Intelligent TV if it interferes with the picture, status is stored per channel).

## L DCV

The DCV monitors and adjusts incoming video signals to help provide the best picture quality. When you choose to turn the DCV to On or Display On, the Brightness, Colour, Contrast, Sharpness, Digi Contrast and Digi Picture++ features are controlled automatically. DCV adjusts these picture settings continuously and automatically.

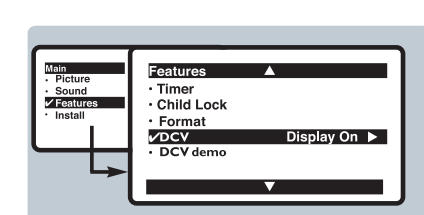

- Enter Features menu as described in "Features settings" on the previous page.
- Use the **Left** key to select **DCV** and press the **Enter** key to select **Off**, **On** or **Display On**.
- Press the **Enter** key to exit.

**Description of option:**  
**Off:** the DCV will not be activated.

**On:** the DCV will work to give the viewer the best possible picture, but will not display the monitoring screen when channels are changed.

**Display On:** a DCV monitoring screen will be shown for a few seconds whenever a channel is changed.

**Light Sensor On:** The picture gets adjusted to ambient room light.

Note: Intelligent TV On-Off allows for further improvement in picture quality (switch off Intelligent TV if it interferes with the picture).

## DCV Demo

The split screen display shows the image performance before and after enhancements to present clearly the effects of the picture enhancement features.

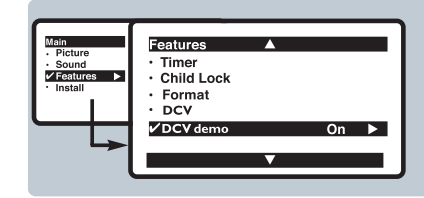

The screen is split to dramatically show the comparative images side by side.



- Enter Features menu as described in "Features settings" on the previous page.
- Use the **Left** key to select **Demo** and press the **Enter** key to select **On** or **Off**.

## M Personal Zapping

A list or series of favourite TV programs can be selected and stored in the 4 coloured keys with the Personal Zapping feature. With this feature you can easily view up to a total of 10 preferred channels for each coloured key.

**To add channels:**

- Select a channel with the digit keys.
- Press **Home** to display list.
- Press your favourite colour key to store the channel in step 1.
- Repeat steps 1 to 3 to store more channels.
- Press **Exit** to exit.



**To delete channels:**

- Select and press a colour key that has stored channels repeatedly to select the channel you want to delete.
- Press **Home** to display list.
- Press **Home** to remove channel.
- Repeat steps 1 to 3 delete more channels.
- Press **Exit** to exit.

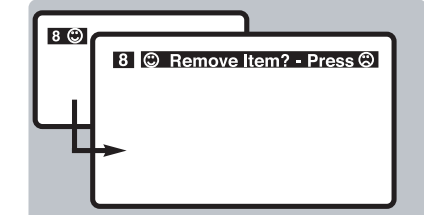

**To view channels:**  
Select and press a colour key that has stored channels repeatedly to select the channel you want to view.

## Power Saver

Power Saver is an environmentally friendly feature which reduces power consumption of your TV by switching to optimal settings for picture and sound.

- Select **Power Saver** on or
- Select steps of 30 minutes (upto 180 minutes).

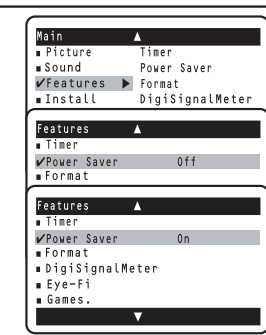

## Games

- Select **Game**

(Toggle Between Super Race ↔ Power Ludo ↔ Cricket ↔ Power Word)

- Select **Play** to start playing or **Help-Line** for Rules

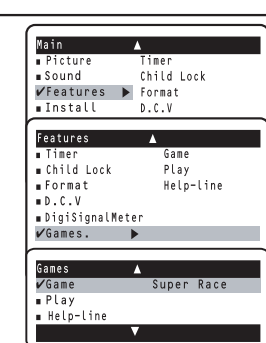

## N SPECIFICATIONS

Specifications		
Model Type	14 Vardaan, & 14PT1415	20 Vardaan
Picture tube screen size (Diagonal)	36 cm	51 cm
Picture tube visible size (Diagonal)	35.7 cm	50.3 cm
Audio Output (PMPO)	80 W	80 W
TV System	PAL B/G	PAL B/G
Colour System	NTSC 4.43, 3.58 Playback	NTSC 4.43, 3.58 Playback
Sound System	B/G 5.5	B/G 5.5
Antenna Input	75 Ohms coaxial	75 Ohms Coaxial
External connections	Rear AV IN & OUT	Rear AV IN & OUT
Operating Voltage / Frequency	150 - 276 Volts / 50Hz	150 - 276 Volts / 50Hz
Power consumption (normal)	38W +/- 10%	59W +/- 10%
Standby Power	< 3W	< 3W
Set Dimensions :	Width 36 cm	49.5 cm
	Depth 38 cm	48.5 cm
	Height 35 cm	45.5 cm
Net Weight (appx. only)	9.5 Kg	18 Kg

Specifications			
Model Type	15PT2536	21PT2216	21RF Vardaan
Picture tube screen size (Diagonal)	53 CM	53 CM	53 cm
Picture tube visible size (Diagonal)	36.8 CM	52.7 CM	51.6 cm
Audio Output (PMPO)	140 W	200 W	200 W
TV System	PAL B/G	PAL B/G	PAL B/G, ECO AV Stereo
Colour System	NTSC 4.43, 3.58 Playback	NTSC 4.43, 3.58 Playback	NTSC 4.43, 3.58 Playback
Sound System	BG 5.5	BG 5.5	BG 5.5
Antenna Input	75 Ohms Coaxial	75 Ohms Coaxial	75 Ohms coaxial
External connections	Rear AV IN & OUT	Rear AV IN & OUT	Rear AV IN & OUT
Operating Voltage / Frequency	150 - 276 Volts / 50 Hz	150 - 276 Volts / 50 Hz	150 - 276 Volts / 50Hz
Power consumption (normal)	59 W +/- 10%	55 W +/- 10%	55W +/- 10%
Standby Power	< 3 W	< 3 W	< 3 W
Set Dimensions :	Width 44.4 CM	52.2 CM	60 cm
	Depth 40.3 CM	46.1 CM	52 cm
	Height 35.7 CM	23.5 CM	46 cm
Net Weight (appx. only)	13 Kg	23.5 Kg	25 Kg

Specifications			
Model Type	21PT2446	21PT2443	21PT3442
Picture tube screen size (Diagonal)	53 CM	53 cm	53 cm
Picture tube visible size (Diagonal)	51.6 CM	51.6 cm	52.3 cm
Audio Output (PMPO)	250 W	200 W	400 W
TV System	PAL B/G	PAL B/G, AV Stereo	PAL B/G, AV Stereo
Colour System	NTSC 4.43, 3.58 Playback	NTSC 4.43, 3.58 Playback	NTSC 4.43, 3.58 Playback
Sound System	BG 5.5	BG 5.5	BG 5.5
Antenna Input	75 Ohms Coaxial	75 Ohms coaxial	75 Ohms coaxial
External connections	Rear AV IN & OUT	Rear AV IN & OUT	Rear AV IN & OUT
Operating Voltage / Frequency	150 - 276 Volts / 50 Hz	150 - 276 Volts / 50Hz	150 - 276 Volts / 50Hz
Power consumption (normal)	55 W +/- 10%	55W +/- 10%	60W +/- 10%
Standby Power	< 3 W	< 1W	< 1W
Set Dimensions :	Width 60 CM	60 CM	62.7 cm
	Depth 52 CM	52 cm	50.5 cm
	Height 46 CM	46 cm	46.5 cm
Net Weight (appx. only)	25 Kg	25 Kg	25 Kg

## O SPECIFICATIONS

Specifications	
Model Type	21PT2404
Picture tube screen size (Diagonal)	53 cm
Picture tube visible size (Diagonal)	52.3 cm
Audio Output (PMPO)	1000 W
TV System	Multi System, AV Stereo
Colour System	PAL, NTSC 3.58, NTSC 4.43, SECAM
Sound System	B/G, I, DK, M
Antenna Input	75 Ohms coaxial
External connections	Rear AV IN & OUT & YUV, Side AV IN
Operating Voltage / Frequency	150 - 276 Volts / 50Hz
Power consumption (normal)	84W +/- 10%
Standby Power	< 1W
Set Dimensions :	Width 62.7 cm
	Depth 59.5 cm
	Height 48.7 cm
Net Weight (appx. only)	28 Kg

Specifications	
Model Type	29PT2204
Picture tube screen size (Diagonal)	72 cm
Picture tube visible size (Diagonal)	69 cm
Audio Output (PMPO)	1000 W
TV System	Multi System, AV Stereo
Colour System	PAL, NTSC 3.58, NTSC 4.43, SECAM
Sound System	B/G, I, DK, M
Antenna Input	75 Ohms coaxial
External connections	Rear AV IN & OUT & YUV, Side AV IN
Operating Voltage / Frequency	150 - 276 Volts / 50Hz
Power consumption (normal)	114W +/- 10%
Standby Power	< 1W
Set Dimensions :	Width 75.7 cm
	Depth 49.3 cm
	Height 58.2 cm
Net Weight (appx. only)	45.5 Kg

Specifications	
Model Type	29PT2552
Picture tube screen size (Diagonal)	72 cm
Picture tube visible size (Diagonal)	69 cm
Audio Output (PMPO)	400 W
TV System	Multi System, AV Stereo
Colour System	PAL, NTSC 3.58, NTSC 4.43, SECAM
Sound System	B/G, I, DK, M
Antenna Input	75 Ohms coaxial
External connections	Rear AV IN & OUT & YUV, SVHS IN
Operating Voltage / Frequency	150 - 276 Volts / 50Hz
Power consumption (normal)	85W +/- 10%
Standby Power	< 1W
Set Dimensions :	Width 74.2 cm
	Depth 49.8 cm

## Free Manuals Download Website

<http://myh66.com>

<http://usermanuals.us>

<http://www.somanuals.com>

<http://www.4manuals.cc>

<http://www.manual-lib.com>

<http://www.404manual.com>

<http://www.luxmanual.com>

<http://aubethermostatmanual.com>

Golf course search by state

<http://golfingnear.com>

Email search by domain

<http://emailbydomain.com>

Auto manuals search

<http://auto.somanuals.com>

TV manuals search

<http://tv.somanuals.com>