

Register your product and get support at

[www.philips.com/welcome](http://www.philips.com/welcome)

S10

S10A



# Quick start guide

**PHILIPS**

load from [www.somanuals.com](http://www.somanuals.com). All Manuals Search And Down

# 1 Get started

## Connect the base

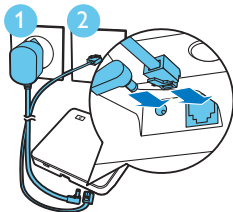

## Charge your phone

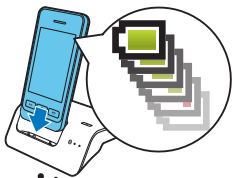

Charge 6 hours

## Configure your phone

- 1 Press  until you see the Philips wordmark.
- 2 Set country and language.
- 3 Set date and time.



> 84%



36% - 52%



68% - 84%



20% - 36%



52% - 68%





< 20%

Flashing: low battery

Scrolling: charging in progress

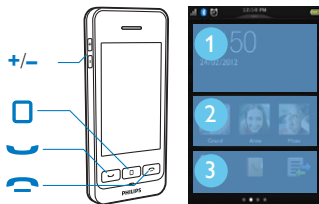
## 2 Overview

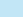

 Enter the center home screen in standby mode.

-  • Make and receive calls.
-  • Show the dial pad.

 • End a call.

 Adjust the volume during a call.

### Center home screen

- 1 Notifications/date and time
- 2 Top 3 contacts
- 3 Favorite applications

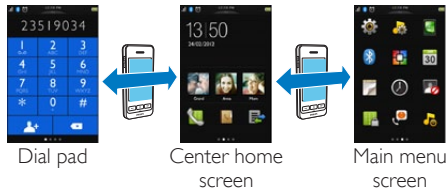

## Home screens

### Swipe

Access the dial pad by swiping the screen to the right and the main menu screen by swiping the screen to the left.

### Press and hold

Press and hold an icon on the main menu screen to drag it to the favorite applications area, or to a new area of the main menu screen.

### Tap

- Open the selected menu item.
- View notifications on the center home screen.

## 3 Bluetooth

### Pair your S10/S10A with your mobile phones



Your S10/S10A features MobileLink technology to:

- receive and make both landline and mobile calls
- download your mobile phone contacts

To use MobileLink first pair your mobile phone to your S10/S10A using Bluetooth:

- 1 Make sure Bluetooth is activated on your mobile phone and in searching status.
- 2 Press and hold  on the base station until the Bluetooth LEDs on the base station flash.
- 3 On the mobile phone, select **Philips S10** and connect.

4 Enter the PIN code (0000) on the mobile phone, if necessary.

- ↳ When S10/S10A and the mobile phone are paired,  or  is displayed on the handset screen. The corresponding LED on the base station remains steadily on.
- ↳ You are now ready to receive and make calls from your S10 using a mobile line.





#### Note

- The Bluetooth antenna is located in the base. Make sure your mobile phone is within a 10 metre (without obstruction between the handset and base) radius of the base.
- Your S10/S10A can connect to up to two mobile phones simultaneously.

## 4 Enjoy

### Call

#### Dial a number

- 1 Press .
- 2 Dial the phone number, then press .
- 3 Select the landline or mobile line from which you want to make an outgoing call.

#### Answer a call

To answer a call, press  when the phone rings.



#### End a call

- Press .
- Place the handset to the base station.



### Adjust the earpiece volume

Press **+** or **-** on the left side of the handset to adjust the volume during a call.

### Add a contact

- 1 Press .
- 2 Tap  from the main menu screen.
- 3 Tap the drop-down menu on top of the screen to select the landline contact list or a mobile contact list.
- 4 Tap  to access the options menu.
- 5 Select **[Add new contact]**.
- 6 Follow on-screen instructions.

### Transfer contacts from your mobile phone

- 1 Tap  from the main menu screen.
- 2 Tap on the drop-down menu on the top of the screen () and select a mobile phone.
- 3 Select **[Update]**.

### Transfer contacts, pictures and ringtones from your computer

Go to [www.philips.com/support](http://www.philips.com/support) to download the Philips Phone Manager software. After installing the software, connect your phone through a micro USB cable (sold separately). Then you can transfer data and update your phone to the latest software (if available).

### Telephone answering machine (S10A only)

#### Record an announcement

- 1 Tap  from the main menu screen.
- 2 Select **[Announcement]**.
- 3 Follow on-screen instructions.

#### Listen to the incoming messages

- 1 Tap  from the main menu screen.
- 2 Select **[Play]**.

#### Delete an incoming message

When you listen to the message, tap .



## User manual

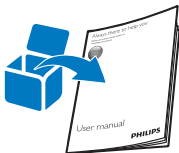

Refer to the user manual that came with your new phone or download the latest version from [www.philips.com/support](http://www.philips.com/support).

## Online

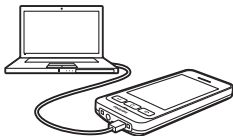

Register at [www.philips.com/support](http://www.philips.com/support) to get the free Philips Phone Manager software for your computer and the latest phone software for your phone.

When this crossed-out wheeled bin symbol is attached to a product it means that the product is covered by the European Directive 2002/96/EC.  
2013 © WOOX Innovations Limited.

All rights reserved.  
Philips and the Philips' Shield Emblem are registered trademarks of Koninklijke Philips N.V. and are used by WOOX Innovations Limited under license from Koninklijke Philips N.V.

# CE 0168



QSG\_S10A  
05\_EN\_V4.0  
WK13405



## Free Manuals Download Website

<http://myh66.com>

<http://usermanuals.us>

<http://www.somanuals.com>

<http://www.4manuals.cc>

<http://www.manual-lib.com>

<http://www.404manual.com>

<http://www.luxmanual.com>

<http://aubethermostatmanual.com>

Golf course search by state

<http://golfingnear.com>

Email search by domain

<http://emailbydomain.com>

Auto manuals search

<http://auto.somanuals.com>

TV manuals search

<http://tv.somanuals.com>