

Event time and date

Note

Ensure that you set the current time and date of the PhotoFrame before you set time and date for an event reminder.

In the main menu, select [Setup] and then press OK to confirm.

Select [Event Reminder], and then press OK to confirm.

Select [Set time] / [Set date], and then press OK to confirm.

Press **▲▼/▶◀** and OK to set the time/date, and then press OK to confirm.

Tip

When the reminder alerts, you can press any button once to stop the reminder. If you want to stop the function, press the same button twice.

on/off a reminder

In the main menu, select [Setup] and then press OK to confirm, and then select [Set On/Off] and then press OK to confirm.

Select a reminder, and then press [Set] and then press OK to confirm.

Select [On] to set the reminder on, and then press OK to confirm.

To set the reminder off, select [Off] and then press OK to confirm.

Note

You can configure the time for the PhotoFrame to turn on or off the display automatically.

Note

- Ensure that you set the current time and date of the PhotoFrame before you set the auto on/off function.

- In the main menu, select [Setup] and then press OK to confirm.
- Select [Smart power], and then press OK to confirm.
- Select [Set time], and then press OK to confirm.
- Select [Weekday] / [Weekend], and then press OK to confirm.

5 Select [Auto on] / [Auto off], and then press OK to confirm, and then select [Set On/Off] > [Off], and then press OK to confirm.

6 Press **▲▼/▶◀** and OK to set the time for auto-on/auto-off function, and then press OK to confirm.

Tip

- Weekday: Monday 00:00 to Friday 23:59
- Weekend: Saturday 00:00 to Sunday 23:59
- Auto-on and auto-off function can press any control button to a correct it.

Frequently asked questions

- Is the LCD screen touch-enabled?**
- The LCD screen is not touch-enabled. You can touch the screen on the back to control the PhotoFrame.
- Will the LCD be damaged if I keep showing the same photo for a long time?**
- Yes, the LCD will be damaged if you show the same photo continuously for 72 hours without any damage to the LCD screen.
- Why does my PhotoFrame not show photos?**
- The PhotoFrame supports only JPEG photos. Ensure that these JPEG photos are not damaged.
- Why does the PhotoFrame not go into auto-off status after I set it?**
- Ensure that you set the current time, auto-off time, and auto-on time correctly. The PhotoFrame automatically turns off the display when the auto-off time if the time has already passed for the day. It starts to enter auto-off status at the specified time from the next day.



© Royal Philips Electronics NV 2009
All rights reserved.

Specifications are subject to change without notice.
Trademarks are the property of Koninklijke Philips Electronics NV or their respective owners.

QSG_V110 Printed in China

100% recycled paper
100% paper recyclable

Register your product and get support at www.philips.com/welcome

PhotoFrame

SFP72017
SFP72027



Quick start guide

- 1 Get started
- 2 Play
- 3 Setup

What's in the box

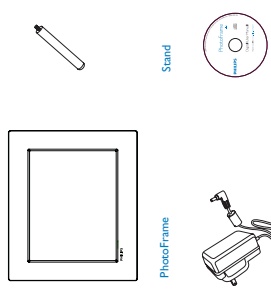

Overview of your PhotoFrame

- Turn on/off the PhotoFrame
- Play slideshow
- Toggle between slideshow mode, browse mode, and calendar mode
- Select the previous/next/left/right option
- Confirm a selection
- Enter the main menu
- Enter/Exit photo menu
- Slot for a USB flash drive
- Kensington lock
- Slot for a USB cable to PC
- SD/MMC/AD/MS Pro
- MS Pro card
- DC socket for the AC-DC power adapter
- Stand hole
- Wall mounting hole



1 Get started

Install the stand

To place the PhotoFrame on a flat surface, attach the supplied stand to the back of the PhotoFrame.

- Insert the stand into the PhotoFrame.

2. Screw the stand into the stand hole firmly.

Connect power

When you position the PhotoFrame, ensure that the power Plug and outlet are easily accessible.

- Connect the power cord to the DC socket of the PhotoFrame.



- Connect the power cord to a power supply socket.

Turn on the PhotoFrame

You can only turn off the PhotoFrame after all copy and save actions are complete.

For the first time use:

- Press and hold **OK** for more than 1 second.
 - The language setting menu is displayed.



- Select a language, and press **OK** to confirm.
 - Help message for control keys is displayed.



- Press any button to exit the help message.
 - Photos are displayed in slideshow mode.

For other times:

- Press and hold **OK** for more than 1 second.
 - Help message for control keys is displayed.

- Press any button to exit the help message.

Photos are displayed in slideshow mode.

- To turn off the PhotoFrame, press and hold **OK**.

Connect a storage device

Caution

- Do not remove a storage device from the PhotoFrame as the contents are being transferred to the storage device.

You can play JPEG photos in one of the following storage devices which is connected to the PhotoFrame.

- Secure Digital (SD/SDHC)
 - MultiMedia Card
 - AD card
 - Stick
 - Memory Stick Pro (with adapter)
 - USB memory drive
- However, we do not guarantee the PhotoFrame for all types of memory card media.

- Insert a storage device firmly.

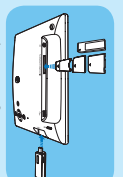

Photos in the storage device are displayed in slideshow mode.

- To remove a storage device, pull it out from the PhotoFrame.

2 Play

Display photos

Note

- You can play only JPEG photos on the PhotoFrame.

- In the main menu, select [Photo] and then press **OK** to confirm.



- Available photo sources are displayed.

- Select a photo source, and then press **OK** to confirm.

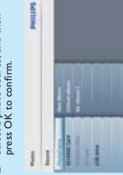

- Select an album, and then press **OK** to confirm.
 - Photos in the album are displayed in thumbnail mode.

- Select a photo from a photo source, and then press **OK** to confirm.
 - Photos are displayed in slideshow mode.

- Press **Left** (Left) to select [Photo 1].
 - Photo source options are displayed.

- Select a photo from a photo source, and then press **OK** to confirm.

- Repeat steps 5 to 7 until all photos are selected for the format.

- Press **Left** to start collage display.
 - Press **Left** to select [Collage] on the screen of the PhotoFrame.

- In the main menu, select [Slideshow] and then press **OK** to confirm.
 - Press **Left** to select [Collage] > [Single] and then press **OK** to confirm.

Tip

- If you select a collage layout, the PhotoFrame displays a static slideshow mode is deactivated.

- If you select [Random] format, the PhotoFrame displays the optimal layout of photos and displays the collage in slideshow mode.

Display collage photos

- Select [Collage], and then press **OK** to confirm.



- Select [Multi], and then press **OK** to confirm.



- Select a layout.

- Press **Left** (Right) to select [Photo 1].
 - Photo source options are displayed.

- Select a photo from a photo source, and then press **OK** to confirm.

Select photo background

You can select background color of the PhotoFrame.

- In the main menu, select [Slideshow] and then press **OK** to confirm.

- Select [Background Color], and then press **OK** to confirm.
 - Press **Left** (Right) to select [Auto] / [Random Color], and then press **OK** to confirm.

- Select a background color (Auto / Random Color), and then press **OK** to confirm.
 - Background color of the PhotoFrame display photo with background color or black bar.



- If you select [Auto] (Right), the PhotoFrame displays the background color of the screen with picture distortion.



If you select [Random Color], the PhotoFrame extends the color on the edges of a photo that is displayed. To prevent this, press **Left** to select [Black Bar] and then press **OK** to confirm.

Tip

- Even when you set the current time and date of the PhotoFrame before you set an event reminder.

Create an event reminder

- In the main menu, select [Setup] and then press **OK** to confirm.

- Select [Event Reminder], and then press **OK** to confirm.

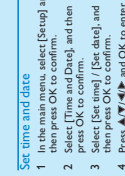

- Select [New reminder], and then press **OK** to confirm.
 - A keypad is displayed.

- To enter the new name (up to 24 characters), select an upper/lower character and then press **OK** to confirm.
 - To switch between uppercase and lowercase characters, press the displayed keypad and then press **OK** to confirm.

- When the name is complete, select [Enter] and then press **OK** to confirm.

Free Manuals Download Website

<http://myh66.com>

<http://usermanuals.us>

<http://www.somanuals.com>

<http://www.4manuals.cc>

<http://www.manual-lib.com>

<http://www.404manual.com>

<http://www.luxmanual.com>

<http://aubethermostatmanual.com>

Golf course search by state

<http://golfingnear.com>

Email search by domain

<http://emailbydomain.com>

Auto manuals search

<http://auto.somanuals.com>

TV manuals search

<http://tv.somanuals.com>