

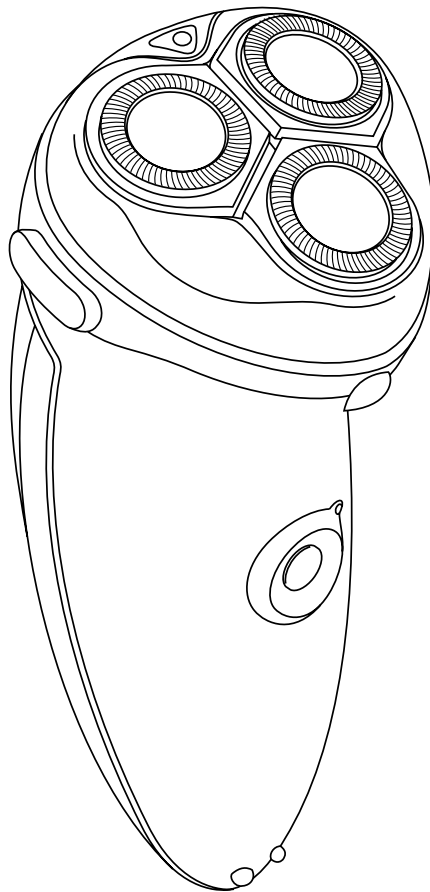

**Advantage
Rechargeable
Cordless Razor
5616X
With Nivea
for Men
Shaving Lotion
Instructions for use**



**If you need help, answers or
service, please call us at
1-800-243-3050**



PHILIPS

IMPORTANT SAFEGUARDS

When using an electric razor, basic precautions should always be followed, including the following:

Read all instructions before using this appliance.

DANGER

To reduce the risk of electric shock:

1. Do not reach for a charging base that has fallen into water. Unplug immediately.
2. Do not use charging base while bathing or in a shower.
3. Do not place or store charging base where it can fall or be pulled into a tub or sink. Do not place charging base in or drop into water or other liquid.
4. Except when charging, always unplug charging base from electrical outlet immediately after using.
5. Unplug charging base before cleaning.

WARNING

To reduce the risk of burns, fire, electric shock, or injury to persons:

1. Close supervision is necessary when this razor is used by, on, or near children or the disabled.
2. Use this razor for its intended household use as described in this manual. Do not use attachments not recommended by Philips Electronics North America Corporation.

3. Never operate this razor/charging base if it has a damaged cord or plug, if it is not working properly, if it has been dropped or damaged, or if charging base has been dropped into water. Return the razor or stand to an Authorized Norelco Service Location for examination and repair.
4. Keep the cord away from heated surfaces.
5. Never drop or insert any object into any opening.
6. Do not charge razor or plug in charging base outdoors or operate where aerosol (spray) products are being used or where oxygen is being administered.
7. Do not use this razor with a damaged or broken comb, as facial injury may occur.
8. Always place razor in base first, then plug base into outlet. To disconnect, turn razor off then remove plug from base from outlet.
9. To prevent possible damage to the cord, do not wrap cord around the charging base.
10. Never store razor or charging base in direct sunlight or store in pouch at a temperature above 140°F.
11. Razor is water-safe and can be rinsed under running tap water. Do not submerge razor in water.

SAVE THESE INSTRUCTIONS

Product Assistance

For assistance or the Authorized Norelco Service Location nearest you, call toll free: 1-800-243-3050. Authorized Norelco Service Location information is available 24 hours a day, 7 days a week.

IMPORTANT

Invest two weeks for the shave of a lifetime!

The Norelco Advantage Razor with the patented Lift and Cut[®] System is unlike any other shaving system you've ever tried. The unique application of Nivea for Men shaving lotion over the razor heads and face as you shave sets your beard up to give you a close, comfortable shave while leaving your face feeling cool and refreshed. This system is so different, that it can take your skin and beard a little time to adapt. But it's an investment worth making.

Use your new razor exclusively for 2 weeks to fully enjoy the performance and comfort of a Norelco shave.

Stick with it! If you alternate shaving methods during the adjustment period, it may make it more difficult to adapt to the Norelco shaving system.

Your Norelco Advantage Razor features a special compartment for cartridges containing Nivea for Men shaving lotion. This unique lotion is applied to your skin while you're shaving to offer you the most comfortable, smoothest shaving experience ever from Norelco. This continuous moisturizing prepares the skin, sets up your beard and ensures that the razor moves smoothly over the skin, offering optimal skin contact.

- Before using the razor for the first time or if razor has not been used for a month or more, razor must be charged for a full 8 hours.

Important Razor Information

Important Battery Disposal Information

A full charge will give up to 36 minutes of shaving time.

- Razor must be placed in the charging base before plugging cord into outlet.
- **IMPORTANT:** To insure optimum battery performance, razor should be run until battery completely discharges twice a year.
- The charging base operates on either 120 or 240V AC current. Be sure switch located on bottom of base is in the correct voltage position before plugging base into outlet. An adaptor plug may be necessary for use in foreign countries.
- Clean razor after every use following Maintenance instructions.

When discarding your razor:

THIS NORELCO RAZOR CONTAINS RECHARGEABLE NICKEL-CADMIUM BATTERIES WHICH MUST BE RECYCLED OR DISPOSED OF PROPERLY.

Refer to enclosed instruction sheet for directions on removing rechargeable batteries.

CAUTION:

- **Batteries should be removed only when razor is to be discarded.**
- Remove razor from charging base and unplug base before dismantling for battery removal.
- All servicing or battery replacement should be performed by an Authorized Norelco Service Location only.



60 - DAY MONEY-BACK GUARANTEE

To enjoy the closest and most comfortable shave from your new Norelco Men's Razor, the razor should be used exclusively for 2 weeks. This allows your hair and skin enough time to adapt to the Norelco Shaving System. If, after that period of time, you are not fully satisfied with your Norelco Men's Razor, send the product back and we'll refund you the full purchase price.

The razor must be shipped prepaid by insured mail, insurance prepaid, and have the sales slip, indicating purchase price and the date of purchase, enclosed.

The razor must be postmarked no later than 60 days after the date of purchase. Norelco reserves the right to verify the purchase price of the razor and limit refunds not to exceed suggested retail price.

Send dated sales slip, your complete name and address as indicated below, and the razor, prepaid to:

**Norelco Consumer Products Company
A Division of Philips Electronics North America Corporation
P.O. Box 1116
Skokie, IL 60076**

Please allow 4-6 weeks for delivery of check.

Name _____
Please Print

Address _____

City _____

State _____ Zip _____

Telephone No. (_____)
AREA CODE

REASON FOR RETURNING: _____

Features

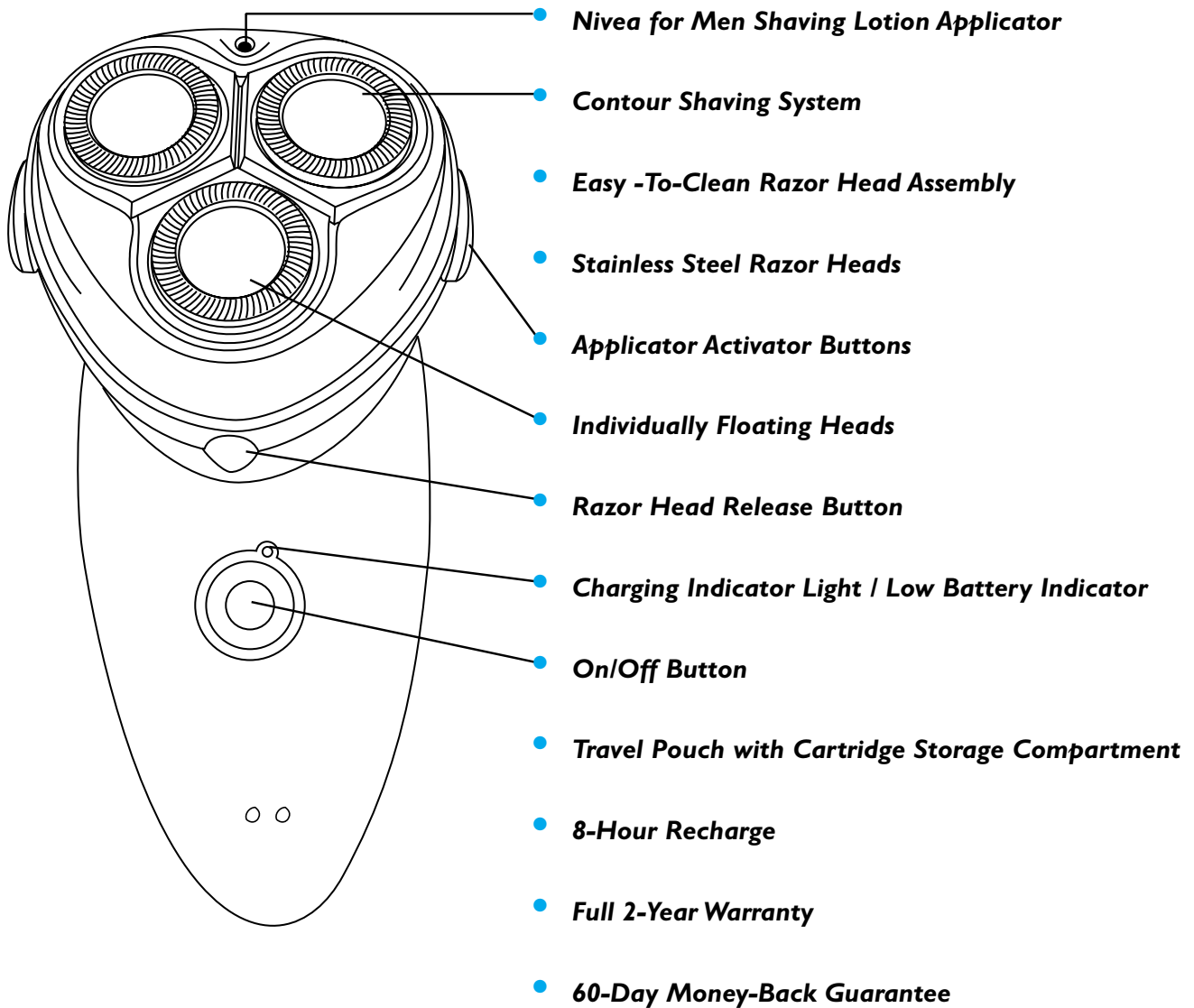

3.

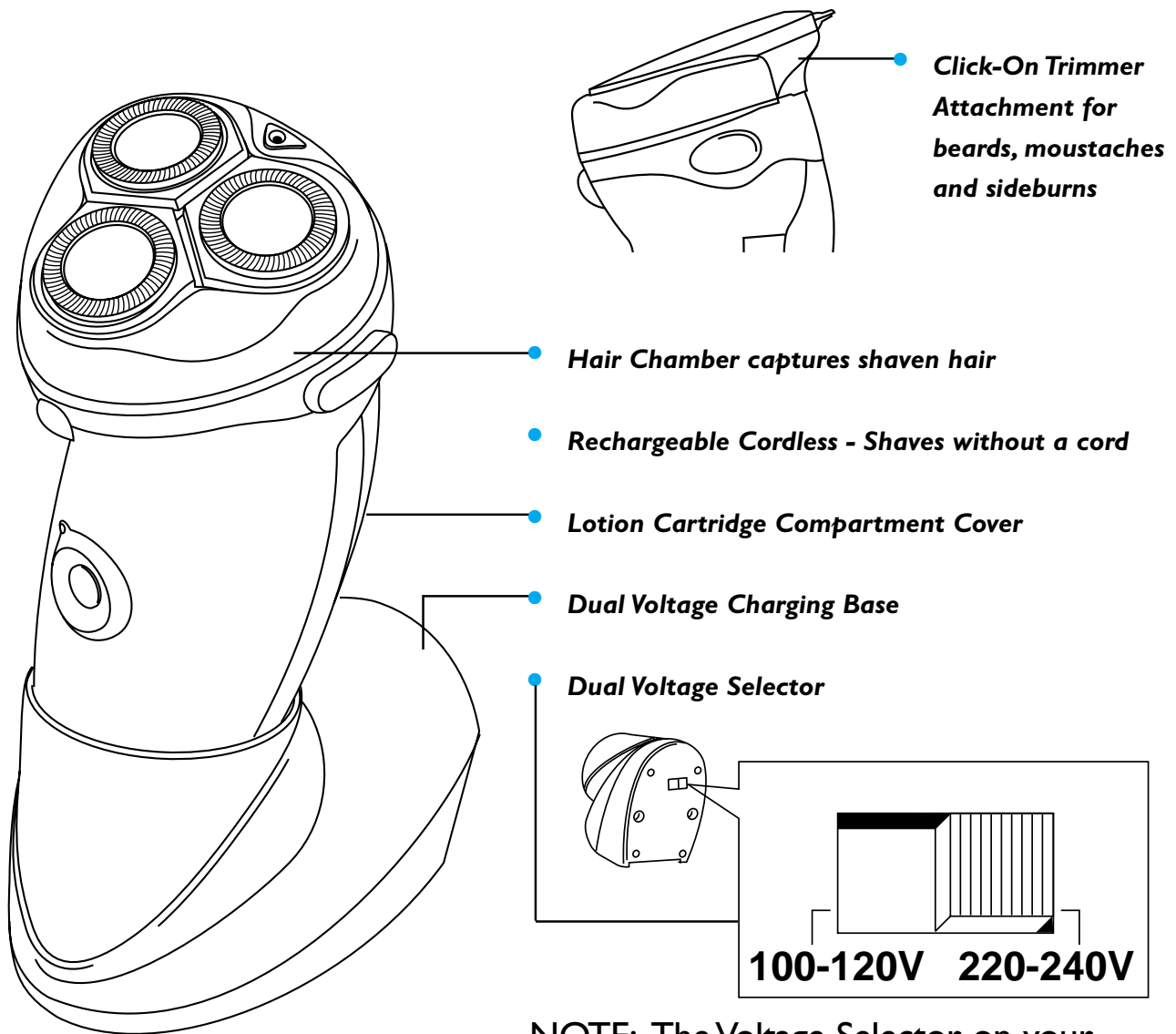

NOTE: The Voltage Selector on your Charging Base makes it possible to charge/recharge the razor on either 110-120V AC or 220-240V AC. Do not use with Direct Current (DC).

Voltage

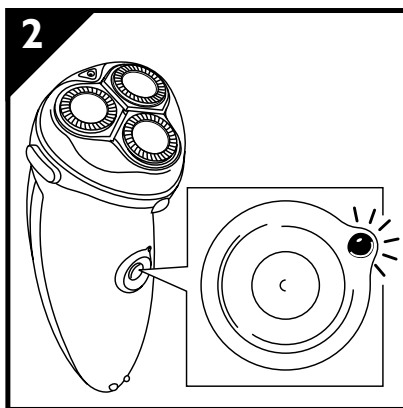
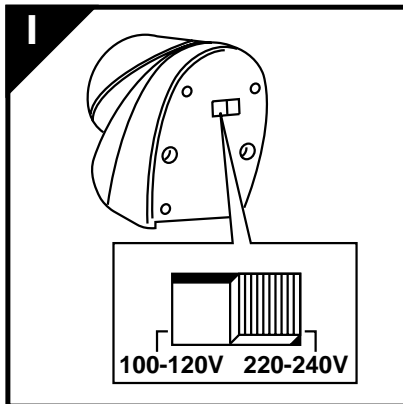

To (Re)Charge

In North America, Central America and South America, the most common voltage is between 110V and 130V AC. Set Voltage Selector to 100-120V setting. When traveling to other countries, common voltage may range to 240V AC. Set Voltage Selector to 220-240V setting. By setting Voltage Selector accordingly, razor may be charged on either 100 to 120 volt AC or 220 to 240 volt AC. **Be sure to check the voltage setting located on the charging base. Slide switch to correct voltage setting before plugging base into outlet.** (Fig. 1)

An adaptor plug may be necessary for cord usage in some foreign countries. It is suggested that you take all adaptor plugs with you when traveling overseas to ensure compatibility with most foreign outlet configurations. Norelco Travel Adaptor Plug Kit, Model TP5, may be purchased at a store near you or at an Authorized Norelco Service Location.

- 1 First time **charging** requires a full **8** hours. Green Charge Indicator Light may begin to blink before 8 hours has elapsed, however, continue charging razor for the full 8 hours. After the initial charge, the razor should be kept in the charging base and will recharge continuously.
 - Recharge at temperatures between 40° and 95° F. Charging at lower or higher temperatures adversely affects the life of the batteries.
 - A fully charged razor will give approximately 36 minutes of shaving time.
- 2 Press ON/OFF button OFF. Place razor in Charging Base and plug Base into outlet. The ON/OFF Button light will light.
- 3 When razor is fully charged, the light will blink green (Fig. 2).
- 4 Return razor to Charging Base after shaving.
- 5 When the light starts blinking red, you need to recharge your razor. You will be able to complete the shave.

5.

Inserting Lotion Cartridge

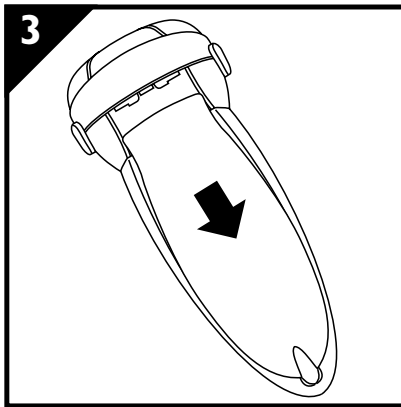
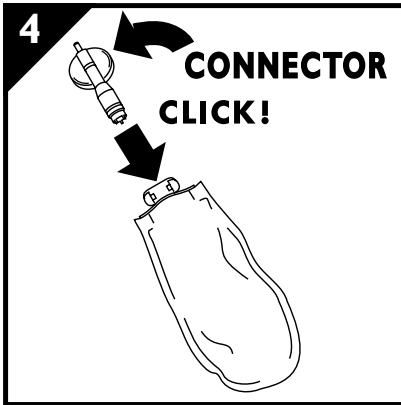

Replacing Used Cartridge

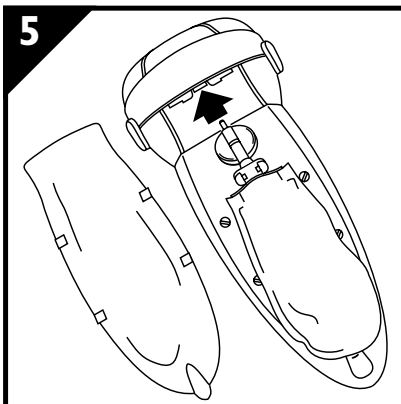

FIRST USE

- 1 Take one cartridge from the box.
- 2 Remove the supplied connector out of the little bag. Push it into the plastic cap of cartridge until you hear it “click” into place (Fig. 3).
- 3 Slide the back cover of razor down to remove from razor (Fig. 4).
- 4 Slide the cartridge, with the connector in place, into position in razor. The connector should slide into the recess area with hole located at the top of razor. The white round dot on the connector must face down towards the razor (Fig. 5).
- 5 Replace back cover on razor and press it down into position until it snaps shut.

- 1 Slide back cover off razor.
- 2 Remove the empty cartridge from the cover and pull out the connector. **DO NOT** discard the connector.
- 3 Rinse out the cartridge compartment with hot water before replacing cartridge. Air dry thoroughly.
- 4 Insert the connector into the new cartridge. Push connector into the plastic cap of cartridge until you hear it “click” into position.

6.

- 5 Slide the new cartridge, with connector in place, into razor.
- 6 Slide the back cover of razor back into position until it snaps shut.

Use only Norelco Advantage Nivea for Men Shaving Lotion Cartridges, Model HQ150, with your Norelco Advantage Razor.

Shaving

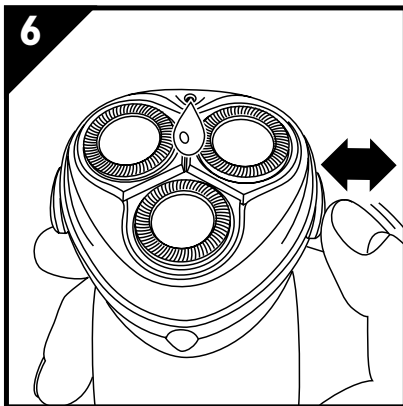

- 1 Remove Protective Razor Head Cap.
Turn razor ON.
- 2 Hold the razor against the skin and press either of the pump buttons located on opposite sides of razor head to dispense shaving lotion. You may press one button at a time, on either side, or both buttons simultaneously (Fig. 6). Once a sufficient amount of lotion has pumped out, move the razor heads quickly over the skin.
- 3 Shave against the direction of beard growth using quick and both straight and circular motions.
- 4 You may use this shaving system on either wet or dry skin. The shaving lotion provides immediate hydrating action and lessens drag or pull against skin.
- 5 Easy does it. Gently press the razor to your skin so the floating heads can follow the contours of your face.
- 6 Turn razor OFF when finished shaving.
- 7 After shaving, you may rinse and dry your skin. Flip open Razor Head Assembly and clean heads and hair chamber by running under hot water.
- 8 You may leave the cartridge in place in your razor if you plan on using razor regularly. When

7.

you will not be using your razor for an extended period of time, it is recommended that you remove the cartridge and clean the razor following maintenance instructions before storing.

Click-On Trimmer

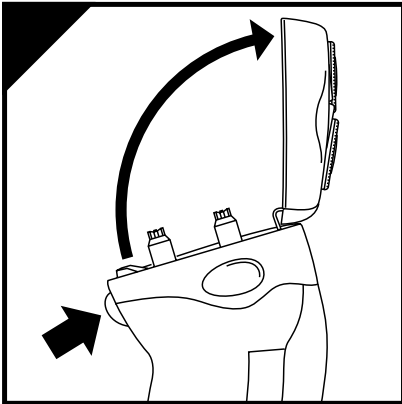

To Connect Trimmer

- 1 Switch the razor OFF.
- 2 Clean the razor and razor head assembly by running under hot water before installing Trimmer.
- 3 Press the button located on front side of razor, directly under the shaving heads to remove head assembly from razor (Fig. 7).
- 4 Remove razor head assembly from razor by pulling up and away from razor.
- 5 Connect Trimmer assembly to razor body (Fig. 8).

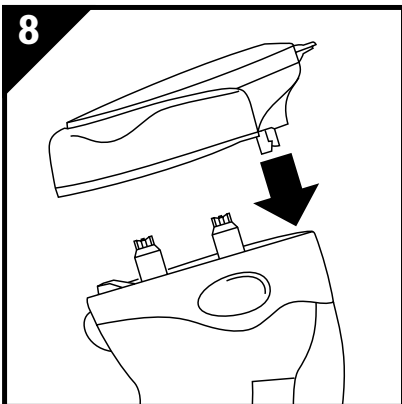

To Use Trimmer

- 1 Turn razor on.
- 2 Hold Trimmer to exact hairline desired.
Move Trimmer downward with gentle pressure.
- 3 Trim beard, moustache or sideburns using the Trimmer.
- 4 Turn razor OFF when finished.

To Remove Trimmer

- 1 Turn razor OFF.
- 2 Press button located on front side of razor, directly under the shaving heads, to unlock and remove Trimmer assembly from razor.
- 3 Replace razor head assembly.

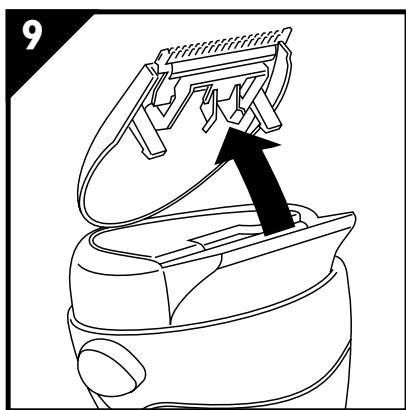

To Clean Trimmer

- 1 Brush the outside of Trimmer after every use.
- 2 Lubricate Trimmer teeth twice a year with Norelco Razor Lubricant, model AL80, or one drop of mineral oil.
- 3 The Trimmer may be flipped open to clean the inside (Fig. 9).

Maintenance Instructions

Important

- Always switch Razor OFF and remove from charging base before cleaning.
- Always store Razor with Protective Razor Head Cap on shaving heads.
- Never clean, remove or replace head assembly while motor is on.
- Do not apply pressure to combs. Do not touch razor heads with hard objects as this may dent or damage precision-made slotted combs.
- Do not use razor if combs are damaged or broken. Facial injury may occur.

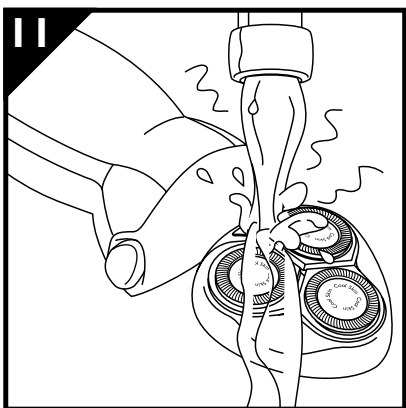
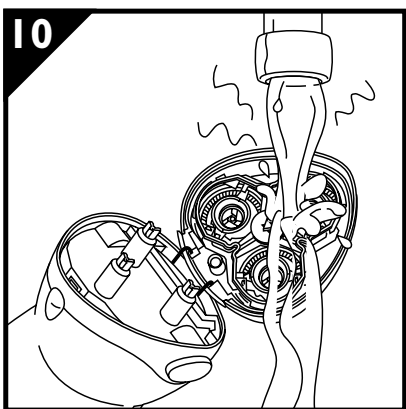

After Each Use

- 1 Switch Razor OFF.
- 2 Press the Razor Head Release Button located under razor heads on front side of Razor (Fig. 7).
- 3 Flip open the Razor Head Assembly and clean the razor heads and hair chamber by running under hot water (Fig. 10 & Fig. 11). Water from the tap should be on a hot setting BUT BE CAREFUL TO TEST WATER FIRST SO AS NOT TO BURN OR SCALD HANDS.
- 4 Shake off excess water and close Razor Head Assembly.

When Replacing Cartridge

- 1 Slide back cover off razor. Remove empty cartridge from razor cover and pull out the connector. Insert the connector into a new cartridge. The connector is secured when you hear it click into place.
- 2 Rinse out razor cartridge compartment with hot water. Shake off excess water and slide new cartridge with connector into the Razor. Close back cover.

When Replacing Cartridge or Once Every Month

For consistently close and comfortable shaves, razor heads should be cleaned in a degreasing liquid or alcohol and then lubricated.

IMPORTANT: Do NOT interchange the cutters and combs. They are a matched set and if interchanged may adversely affect shaving performance until cutters reseat themselves. Therefore, remove, clean and replace each set individually.

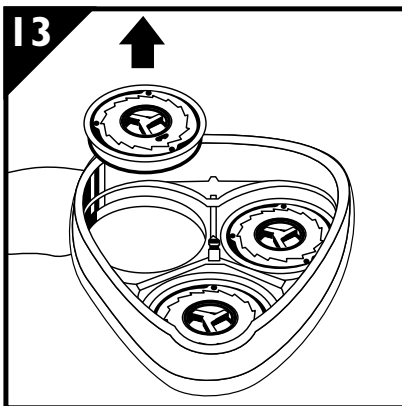
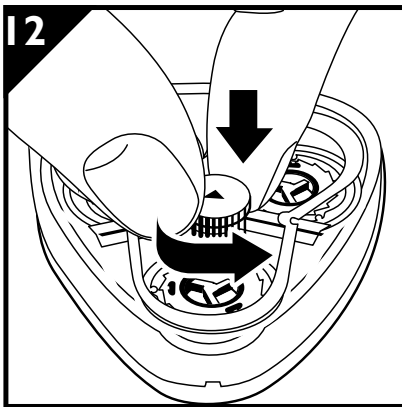

- 1 Switch Razor OFF.
- 2 Press the Razor Head Release Button located under razor heads on front side of Razor.
- 3 Remove the Razor Head Assembly and clean the razor heads and hair chamber by running under hot water. Be sure water is not too hot so as to cause burns or scalding.
- 4 While holding Razor Head Assembly in one hand, press center wheel down while turning counterclockwise to release and lift out frame. Set frame aside (Fig. 12).
- 5 Remove one cutter/comb, at a time, out of frame (Fig. 13).

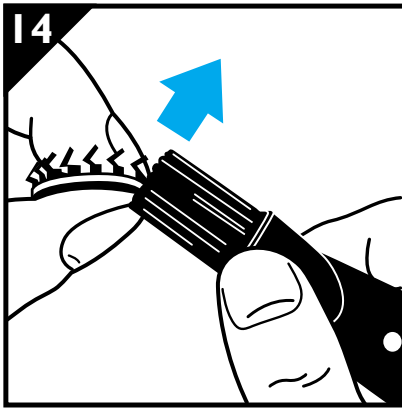

6 Cutter should be held with cutters facing up and brushed in an upward motion (Fig. 14). Clean razor comb with long bristles of brush in a circular motion.

7 For consistently close and comfortable shaves, razor heads should be cleaned and lubricated every 4 weeks. Clean heads in a degreasing liquid or alcohol.

8 While holding Razor Head Assembly in one hand, gently place one cutter/comb back into Assembly (Fig. 15).

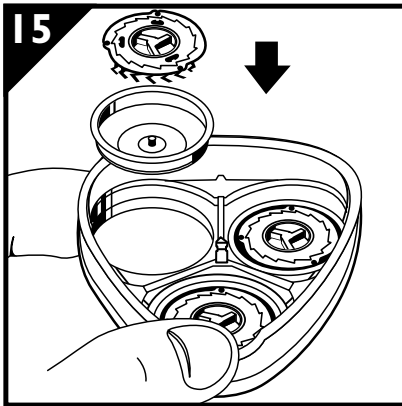

9 Repeat procedure for other two cutting heads.

10 Replace frame back into Razor Head Assembly. While pressing down, turn wheel clockwise to lock frame into place (Fig. 16).

11 Press Razor Head assembly back on razor housing.

12 Spread Norelco Razor Lubricant, model AL80, or one drop of mineral oil over floating heads with your finger.

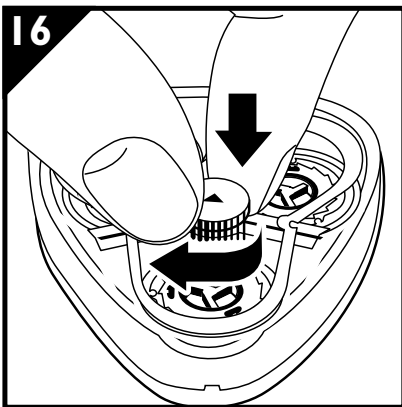

Charging Base & Pouch

1 The charging base can be placed on countertop. You may clean the charging base using a damp cloth.

2 The pouch stores the razor and two spare cartridges. The pouch can be washed, see washing instructions inside pouch before cleaning.

II.

Replacement Heads And Razor Accessories

HQ156 Advantage Replacement Heads:

The self-sharpening rotary blades in your Norelco razor are precision-made to give closer shaves. When they finally do need replacing, specify only Norelco brand replacement cutters and combs, model HQ156.

DO NOT USE shaver sharpeners as this will damage your blades and lifters and will adversely affect the shaving performance.

NOTE: It is recommended that you replace your razor heads once a year.

Nivea for Men Shaving Lotion Replacement Cartridges

Advantage Nivea for Men Shaving Lotion Cartridges, 5 to a box, model HQ150.

Razor Lubricant:

Norelco Razor Lubricant, model AL80.

FULL TWO YEAR WARRANTY

Philips Electronics North America Corporation warrants each new Norelco Product, Model 5615X (except cutters and combs), against defects in materials or workmanship for a period of two years from the date of purchase, and agrees to repair or replace any defective product without charge.

IMPORTANT: This warranty does not cover damage resulting from accident, misuse or abuse, lack of reasonable care, the affixing of any attachment not provided with the product or loss of parts or subjecting the product to any but the specified voltage.* Use of unauthorized replacement parts will void this warranty.

PHILIPS ELECTRONICS NORTH AMERICA CORPORATION WILL NOT PAY FOR WARRANTY SERVICE PERFORMED BY A NON-AUTHORIZED REPAIR SERVICE AND WILL NOT REIMBURSE THE CONSUMER FOR DAMAGE RESULTING FROM WARRANTY SERVICE PERFORMED BY A NON-AUTHORIZED REPAIR SERVICE.

NO RESPONSIBILITY IS ASSUMED FOR ANY SPECIAL, INCIDENTAL OR CONSEQUENTIAL DAMAGES.

In order to obtain warranty service, simply take or ship the product postage prepaid to the nearest Authorized Norelco Service Location. It is suggested that for your protection you return shipments of product by insured mail, insurance prepaid. Damage occurring during shipment is not covered by this warranty.

NOTE: No other warranty, written or oral, is authorized by Philips Electronics North America Corporation.

This warranty gives you specific legal rights, and you may also have other rights which vary from state to state. Some states do not allow the exclusion or limitation of incidental or consequential damages, so the above exclusion and limitations may not apply to you.

* Read enclosed instructions carefully.

Manufactured for:

Norelco Consumer Products Company

A Division of Philips Electronics North America Corporation

1010 Washington Blvd., Stamford, CT 06912-0015

MADE IN HOLLAND.

Norelco and Lift and Cut are Registered Trademarks of Philips Electronics North America Corporation.

Advantage is a Trademark of Philips Electronics North America Corporation.

Nivea for Men is a Registered Trademark of Beiersdorf AG.

PHILIPS and Philips Shield are Registered Trademarks of Philips Electronics N.V.

© 1998 Philips Electronics North America Corporation,
All Rights Reserved.



EVERYTHING YOU WANT FROM A WET SHAVE
EXPERIENCE AND NOTHING YOU DON'T

Free Manuals Download Website

<http://myh66.com>

<http://usermanuals.us>

<http://www.somanuals.com>

<http://www.4manuals.cc>

<http://www.manual-lib.com>

<http://www.404manual.com>

<http://www.luxmanual.com>

<http://aubethermostatmanual.com>

Golf course search by state

<http://golfingnear.com>

Email search by domain

<http://emailbydomain.com>

Auto manuals search

<http://auto.somanuals.com>

TV manuals search

<http://tv.somanuals.com>