

User Manual



I7PF9946/37



**Thank you for choosing Philips.
Need help fast?**

*Read your User Manual and/or Quick-Use Guide first
for quick tips that make using your Philips product
more enjoyable. If you have read your instructions and
still need assistance you may access our online help at
www.p4c.philips.com*

*or
call **1-800-531-0039**
while with your product.*

PHILIPS

Model No.:	_____
Serial No.:	_____

3139 125 31972

Return your Product Registration Card today to get the very most from your purchase.

Registering your model with PHILIPS makes you eligible for all of the valuable benefits listed below, so don't miss out. Complete and return your Product Registration Card at once to ensure:

*Proof of Purchase

Returning the enclosed card guarantees that your date of purchase will be on file, so no additional paperwork will be required from you to obtain warranty service.

*Product Safety Notification

By registering your product, you'll receive notification - directly from the manufacturer - in the rare case of a product recall or safety defect.

*Additional Benefits of Product Ownership

Registering your product guarantees that you'll receive all of the privileges to which you're entitled, including special money-saving offers.

PHILIPS

Congratulations on your purchase, and welcome to the "family!"

Dear PHILIPS product owner:

Thank you for your confidence in PHILIPS. You've selected one of the best-built, best-backed products available today. We'll do everything in our power to keep you happy with your purchase for many years to come.

As a member of the PHILIPS "family," you're entitled to protection by one of the most comprehensive warranties and outstanding service networks in the industry. What's more, your purchase guarantees you'll receive all the information and special offers for which you qualify, plus easy access to accessories from our convenient home shopping network.

Most importantly, you can count on our uncompromising commitment to your total satisfaction.

All of this is our way of saying welcome - and thanks for investing in a PHILIPS product.

P.S. To get the most from your PHILIPS purchase, be sure to complete and return your Product Registration Card at once.

Know these **safety symbols**



 This "bolt of lightning" indicates uninsulated material within your unit may cause an electrical shock. For the safety of everyone in your household, please do not remove product covering.

 The "exclamation point" calls attention to features for which you should read the enclosed literature closely to prevent operating and maintenance problems.

CAUTION: To prevent electric shock, match wide blade of plug to wide slot, fully insert.

ATTENTION: Pour éviter les choc électriques, introduire la lame la plus large de la fiche dans la borne correspondante de la prise et pousser jusqu'au fond.

For Customer Use

Enter below the Serial No. which is located on the rear of the cabinet. Retain this information for future reference.

Model No. _____

Serial No. _____

PHILIPS

Visit our World Wide Web Site at <http://www.philips.com>

IMPORTANT SAFETY INSTRUCTIONS

Read before operating equipment

1. Read these instructions.
2. Keep these instructions.
3. Heed all warnings.
4. Follow all instructions.
5. Do not use this apparatus near water.
6. Clean only with a dry cloth.
7. Do not block any of the ventilation openings. Install in accordance with the manufacturers instructions.
8. Do not install near any heat sources such as radiators, heat registers, stoves, or other apparatus (including amplifiers) that produce heat.
9. Do not defeat the safety purpose of the polarized or grounding-type plug. A polarized plug has two blades with one wider than the other. A grounding type plug has two blades and third grounding prong. The wide blade or third prong are provided for your safety. If the provided plug does not fit into your outlet, consult an electrician for replacement of the obsolete outlet.
10. Protect the power cord from being walked on or pinched particularly at plugs, convenience receptacles, and the point where they exit from the apparatus.
11. Only use attachments/accessories specified by the manufacturer.
12.  Use only with a cart, stand, tripod, bracket, or table specified by the manufacturer, or sold with the apparatus. When a cart is used, use caution when moving the cart/apparatus combination to avoid injury from tip-over.
13. Unplug this apparatus during lightning storms or when unused for long periods of time.
14. Refer all servicing to qualified service personnel. Servicing is required when the apparatus has been damaged in any way, such as power-supply cord or plug is damaged, liquid has been spilled or objects have fallen into apparatus, the apparatus has been exposed to rain or moisture, does not operate normally, or has been dropped.
15. This product may contain lead and mercury. Disposal of these materials may be regulated due to environmental considerations. For disposal or recycling information, please contact your local authorities or the Electronic Industries Alliance: www.eiae.org
16. **Damage Requiring Service** - The appliance should be serviced by qualified service personnel when:
 - A. The power supply cord or the plug has been damaged; or
 - B. Objects have fallen, or liquid has been spilled into the appliance; or
 - C. The appliance has been exposed to rain; or
 - D. The appliance does not appear to operate normally or exhibits a marked change in performance; or
 - E. The appliance has been dropped, or the enclosure damaged.
17. **Tilt/Stability** - All televisions must comply with recommended international global safety standards for tilt and stability properties of its cabinet design.
 - Do not compromise these design standards by applying excessive pull force to the front, or top, of the cabinet which could ultimately overturn the product.
 - Also, do not endanger yourself, or children, by placing electronic equipment/toys on the top of the cabinet. Such items could unsuspectingly fall from the top of the set and cause product damage and/or personal injury.
18. **Wall or Ceiling Mounting** - The appliance should be mounted to a wall or ceiling only as recommended by the manufacturer.
19. **Power Lines** - An outdoor antenna should be located away from power lines.
20. **Outdoor Antenna Grounding** - If an outside antenna is connected to the receiver, be sure the antenna system is grounded so as to provide some protection against voltage surges and built up static charges. Section 810 of the National Electric Code, ANSI/NFPA No. 70-1984, provides information with respect to proper grounding of the mast and supporting structure, grounding of the lead-in wire to an antenna discharge unit, size of grounding connectors, location of antenna-discharge unit, connection to grounding electrodes, and requirements for the grounding electrode. See Figure below.
21. **Object and Liquid Entry** - Care should be taken so that objects do not fall and liquids are not spilled into the enclosure through openings.
 - a) Warning: To reduce the risk of fire or electric shock, this apparatus should not be exposed to rain or moisture and objects filled with liquids, such as vases, should not be placed on this apparatus.
22. **Battery Usage CAUTION** - To prevent battery leakage that may result in bodily injury, property damage, or damage to the unit:
 - Install all batteries correctly, with + and - aligned as marked on the unit.
 - Do not mix batteries (old and new or carbon and alkaline, etc.).
 - Remove batteries when the unit is not used for a long time.

Note to the CATV system installer: This reminder is provided to call the CATV system installer's attention to Article 820-40 of the NEC that provides guidelines for proper grounding and, in particular, specifies that the cable ground shall be connected to the grounding system of the building, as close to the point of cable entry as practical.

Example of Antenna Grounding as per NEC - National Electric Code

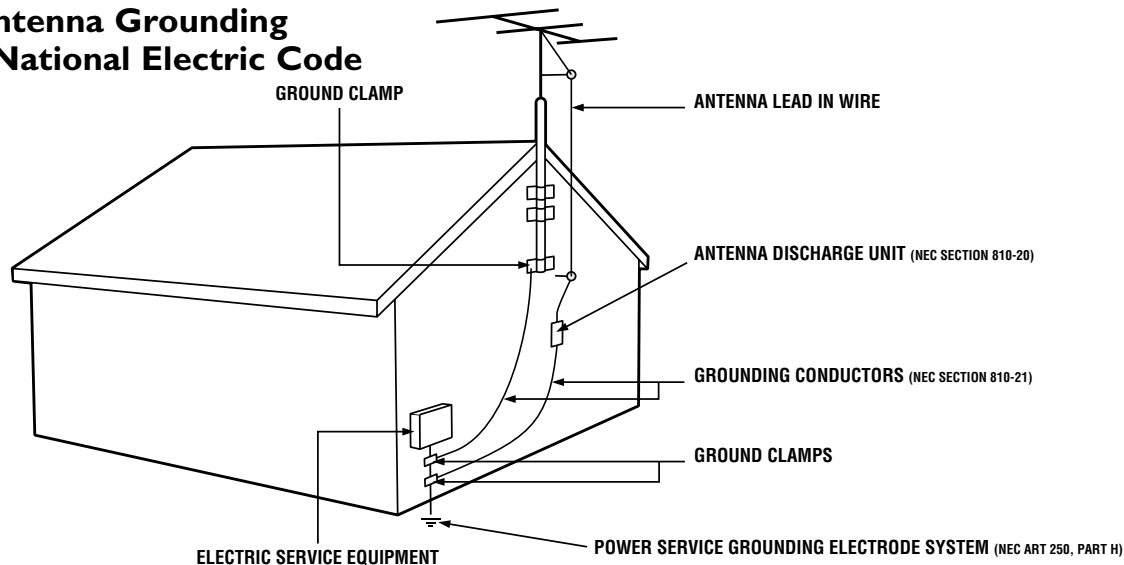

PRECAUTIONS

ADDITIONAL SAFETY PRECAUTIONS

- ENSURE that LCD TV stand is tightened properly to the set (See Quick Guide on the right way of tightening of the screw of the stand to the set. Improper tightening of screw may render the set unsafe.
- If LCD TV is installed on the wall, installation should be carried out by qualified servicemen. Improper or incorrect installation may render the set unsafe.
- Disconnect mains plug when :
 - cleaning the TV screen, never use abrasive cleaning agents.
 - there is a lightning storm.
 - the set is left unattended for a prolonged period of time.
- Do not shift or move the LCD TV around when it is powered on.
- Do not touch, push or rub the surface of the LCD screen with any sharp or hard objects.
- When the surface of the LCD screen becomes dusty, wipe it gently with an absorbent cotton cloth or other soft material like chamois. DO NOT USE acetone, toluene or alcohol to clean the surface of the screen. These chemicals will cause damage to the surface.
- Wipe off water, or saliva as soon as possible. These liquids can cause deformation and color fading of the LCD screen when left exposed for some time.
- Be careful of condensation when temperature changes occur. Condensation can cause damage to the LCD screen and electrically parts. After condensation fades, spots or blemishes will be present on the LCD screen.
- CAUTION information is located on the inside of the VESA cover (see diagram below). To read information, open the VESA cover.

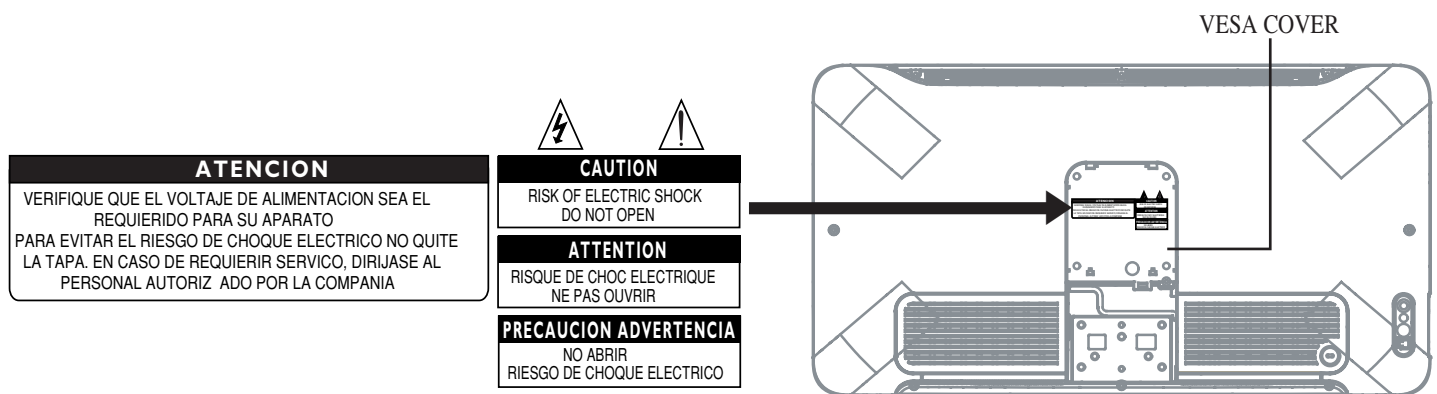

POSITIONING THE LCD TELEVISION

- Place the LCD TV on a solid, sturdy base or stand. Be sure the stand is strong enough to handle the weight of the LCD TV.
- Try to leave at least 6" of space around each side of the LCD TV cabinet to allow for proper ventilation.
- Do not place the LCD TV near a radiator or other sources of heat.
- Do not place the LCD TV where it can be exposed to rain or excessive moisture.

RECYCLING PROCEDURE/END OF LIFE DISPOSAL

- To minimize harm to the environment, the batteries supplied with the LCD TV do not contain mercury or nickel cadmium. If possible, when disposing of batteries, use recycling means available in your area.
- The LCD TV uses materials that can be recycled. To minimize the amount of waste in the environment, check your area for companies that will recover used televisions for dismantling and collection of reusable materials, or contact your dealer for TV recycling tips.
- Please dispose of the carton and packing material through the proper waste disposal management in your area.

CONTENTS

INTRODUCTION

Welcome/Registration of Your TV	2
Safety/Precautions	3-4
Features	4
Contents	5



INSTALLATION MENU

How to use the Language Controls	6
How to use the Tuner Mode Controls	6
How to use the Auto Program Controls	7
How to use the Channel Edit Controls	7



PICTURE MENU CONTROLS

How to use the Picture Menu Controls	8
--------------------------------------	---



SOUND MENU CONTROLS

How to use the Sound Menu Controls	9
------------------------------------	---



FEATURE MENU CONTROLS

How to use the Timer Menu Controls	10
Understanding the AutoLock™ Controls	11
Setting up an AutoLock™ Access Code	12
How to block channels using AutoLock™	13
How to lock HD Channel using AutoLock™	14
How to clear all locked channels at the same time	15
How to block programming using the Movie Ratings Controls	16
How to block programming using the TV Ratings Controls	17
Other AutoLock™ Blocking options	18
Using the AutoLock™ Review screen	19
How to use the Contrast+ Control	20
How to use the DNR Control	20
How to use the PIP Control	21
How to use the Mode Control	22



REMOTE CONTROL RELATED FEATURES

How to use the Format Control	22
How to use the Sleptimer Controls	23
How to use the Closed Captioning Controls	23
How to use the Program List Control	24
How to use the Active Control feature	24
How to use the Surf Control	25
How to use the AutoPicture™ Control	26
How to use the AutoSound™ Control	26
Using the Remote Control with accessory devices	
Direct Method	27
Code-Entry Method	28
Search Method	29
Direct-Entry Code list for accessory devices	30-32
Remote Control Accessory Device Specific Buttons	33



SETTING UP THE FM RADIO MODE

How to use the Mode Select Control	34
How to use the Install Controls	34
How to use the Timer Controls	35
How to use the Sound Controls	36
How to use the ScreenSaver Control	37
How to use the AutoSound™ Control	37



SETTING UP THE PC (PERSONAL COMPUTER) MODE

How to use the Picture Controls	38
How to use the Audio Selection Control	38
How to use the PC Features Controls	39
How to use the PIP Control	40



SETTING UP THE HD (HIGH DEFINITION) MODE

How to use the HD Select Control	41
How to use the Picture Controls	42
How to use the Sound Controls	43
How to lock the HD Channel	44



IMPORTANT INFORMATION

Troubleshooting	45
Care and Cleaning	46
Index	47
Limited Warranty	48

Features

Active Control™ continuously measures and corrects all incoming signals to help provide the best picture quality. This feature monitors and corrects both the sharpness control and noise reduction control.

Audio/Video Jack Panel allows direct connections with VCRs, DVDs, or other devices, providing quality TV picture and sound playback.

Audio Volume Leveler (AVL) Control keeps the TV sound at an even level. Peaks and valleys that occur during program changes or commercial breaks are reduced, making for a more consistent, comfortable sound.

AutoLock™ allows you to block the viewing of certain channels or programs with certain ratings if you do not want your children to view inappropriate materials.

AutoPicture™ allows you to change the picture settings (color, tint, contrast, etc.) for various types of programming, such as sports, movies, multimedia (games), or weak signals with the push of one button.

AutoSound™ allows you to select from three factory-set controls and a personal control that you set according to your own preferences through the onscreen Sound menu. The three factory-set controls (Movie, Voice and Theatre) enable you to tailor the TV sound so as to enhance the particular programming you are watching.

Channel Edit allows you to add or delete channels from the list stored in the TV's memory. Channel Edit makes it easy to limit or expand the number of channels that are available to you when you press the Channel (+) or (-) buttons on your remote control.

Closed Captioning allows the viewer to read TV program dialogue or voice conversations as onscreen text.

Infrared Remote Control works your TV and other remote-controlled devices, such as VCRs, DVD players, cable converters, and satellite receivers.

Onscreen Menu shows helpful messages and instructions for setting TV feature controls (can be viewed in English, French, or Spanish).

Sleep Timer automatically turns the TV OFF after a set amount of time that you choose.

Timer allows you to set your TV to turn itself ON and OFF once or daily like an alarm clock.



As an Energy Star® Partner, Philips Consumer Electronics has determined this product meets the Energy Star® guidelines for energy efficiency. Energy Star® is a U.S. registered mark. Using products with the Energy Star® label can save energy. Saving energy reduces air pollution and lowers utility bills.

Active Control, AutoPicture, and AutoSound Surround are trademarks of Philips Consumer Electronics Company. Copyright 2001 Philips Consumer Electronics.

*Manufactured under license from Dolby Laboratories. "Dolby" and the double-D symbol are trademarks of Dolby Laboratories.

QUICK USE AND SETUP GUIDE

Refer to the simple **Quick Use and Setup Guide** (supplied with your TV) for details on making connections and Remote Control Operation.

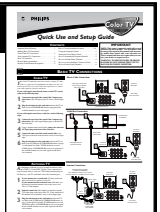



HOW TO USE THE INSTALLATION FEATURES

LANGUAGE

For our Spanish and French-speaking TV owners, an onscreen Language option is present. The Language control enables you to set the TV's onscreen menu to be shown in either English, Spanish, or French.

- 1 Press the **MENU** button on the remote control to show the onscreen menu.
- 2 Press the **CURSOR DOWN** button repeatedly until **Install** is highlighted.
- 3 Press the **CURSOR RIGHT** button to access the Install menu. Language will be highlighted.
- 4 Press the **CURSOR RIGHT** or **CURSOR LEFT** button to select **English**, **Francais**, or **Español**.
- 5 Press the **STATUS/EXIT** button to remove the menu from the screen.

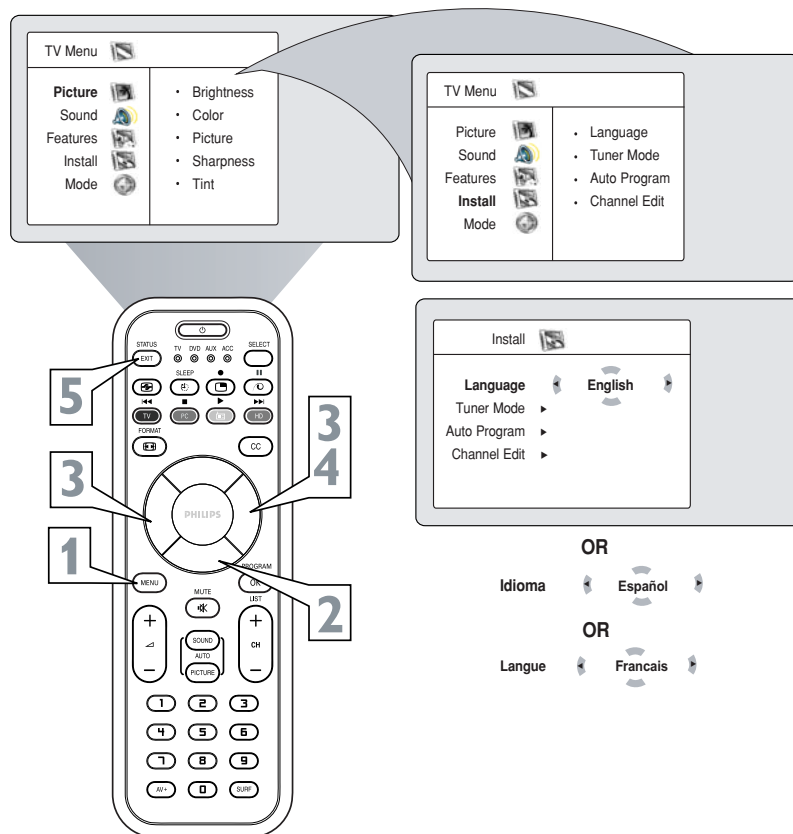

HELPFUL HINT

Remember, the **Language** control makes only the TV's onscreen Menu items appear in English, Spanish, or French text. It does not change the other onscreen text features, such as Closed Captioning (CC), with TV shows.

TUNER MODE

The Tuner Mode allows you to change the TV's signal input to Cable, Antenna, or Auto Mode. It's important for the TV to know what type of signal is connected, either Antenna or Cable.

- 1 Press the **MENU** button on the remote control to show the onscreen menu.
- 2 Press the **CURSOR DOWN** button repeatedly until **Install** is highlighted.
- 3 Press the **CURSOR RIGHT** button to access the Install menu. Language is highlighted.
- 4 Press the **CURSOR DOWN** button to select the **Tuner Mode** control.
- 5 Press the **CURSOR RIGHT** or **CURSOR LEFT** button to select **Cable**, **Antenna**, or **Auto**. If Tuner Mode is set to Auto, Auto Program will detect if a cable signal is present.
- 6 Press the **STATUS/EXIT** button to remove the menu from the screen.

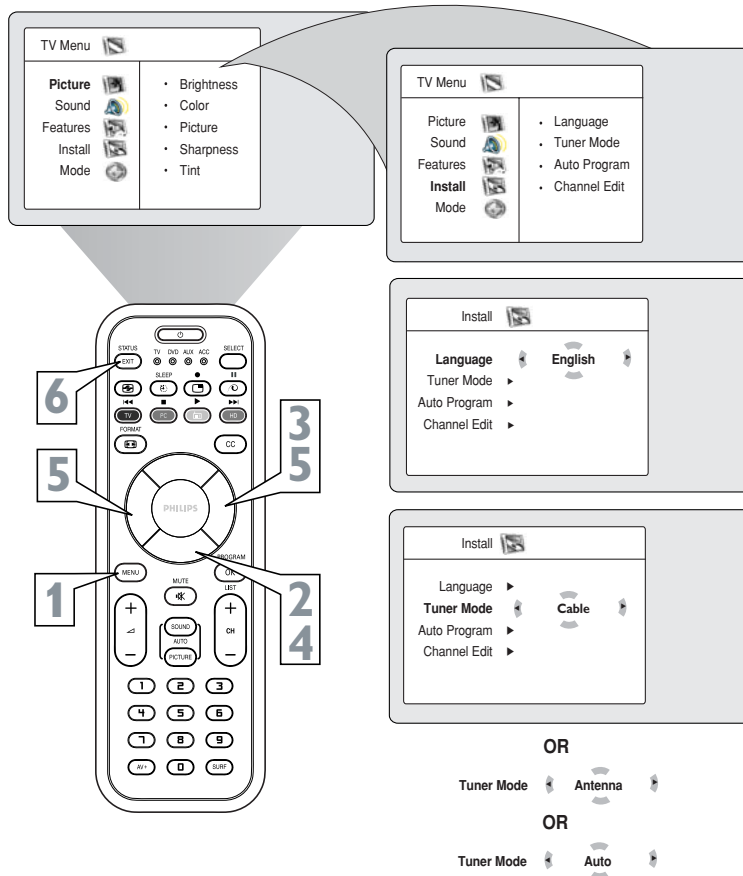

HELPFUL HINT

When Cable is selected, channels 1-125 are available.
When Antenna is selected, channels 2-69 are available.

HOW TO USE THE INSTALLATION FEATURES



AUTO PROGRAM

Your TV can automatically set itself for local area (or cable TV) channels. This makes it easy for you to select only the TV stations in your area by pressing the CHANNEL (+) or (-) button.

- 1 Press the **MENU** button on the remote control to show the onscreen menu.
- 2 Press the **CURSOR DOWN** button repeatedly until **Install** is highlighted.
- 3 Press the **CURSOR RIGHT** button to enter the **Install** menu. Language will be highlighted.
- 4 Press the **CURSOR DOWN** button repeatedly until **Auto Program** is selected. "Search ?" will appear.
- 5 Press the **CURSOR RIGHT** button to start the Auto Programming process.
- 6 Press the **STATUS/EXIT** button to remove the menu from the screen when the Auto programming process has finished.

HELPFUL HINT

After you've run Auto Program, check out the results. Press the CHANNEL (+) or (-) button and see which channels you can select. Remember, an antenna or cable TV signal must first be connected to your TV, see Quick-Use Guide for making connections.

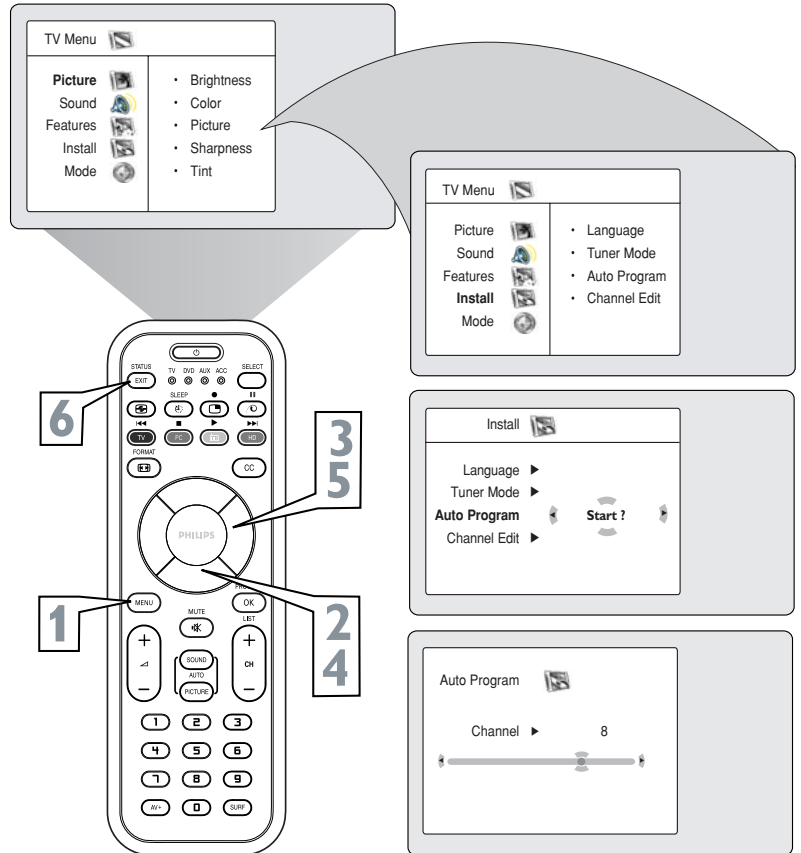

CHANNEL EDIT

Channel Edit makes it easy for you to add or delete channels from the list of channels stored in the TV's memory.

- 1 Press the **MENU** button on the remote control to show the onscreen menu.
- 2 Press the **CURSOR DOWN** button repeatedly until **Install** is highlighted.
- 3 Press the **CURSOR RIGHT** button to enter the Install menu. Language will be highlighted.
- 4 Press the **CURSOR DOWN** button repeatedly until **Channel Edit** is selected.
- 5 Press the **CURSOR RIGHT** button to enter the **Channel Edit** menu. Channel will be highlighted.
- 6 Press the **CURSOR RIGHT** or **CURSOR LEFT** buttons to scroll through the list of available channels, you can also press the CH+ or CH- to scroll through the list of channels. Or, press the numbered buttons to select a specific numbered channel.
- 7 Press the **CURSOR DOWN** button to select **Skipped** while you are tuned to the channel to be skipped.
- 8 Press the **CURSOR LEFT** or **CURSOR RIGHT** button to select **On** to activate the skipping of a channel. Or, select **Off**, to deactivate the skipping of a channel.
- 9 Press the **STATUS/EXIT** button to remove the onscreen menu from the screen.

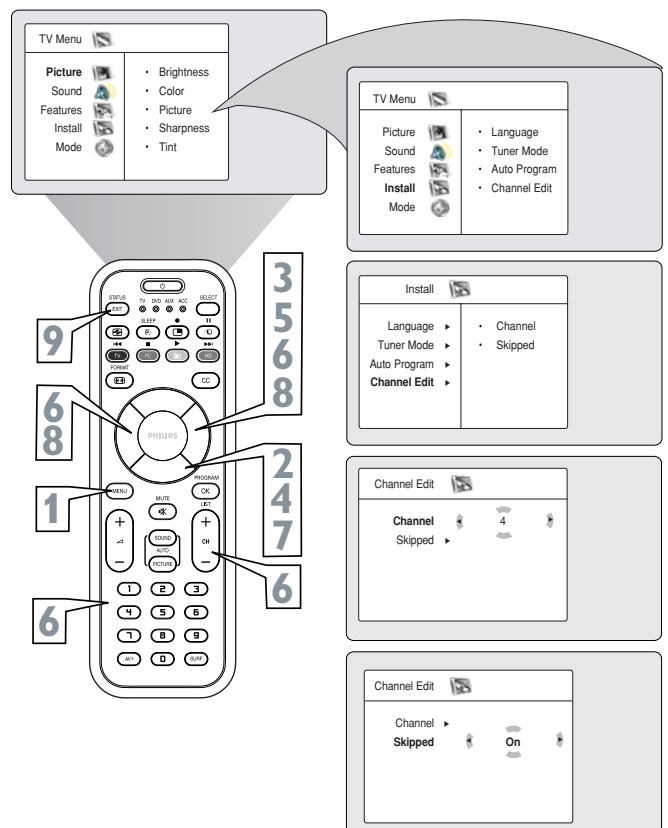





HOW TO USE THE PICTURE ADJUSTMENT CONTROLS

To adjust your TV picture controls, select a channel and follow these steps.

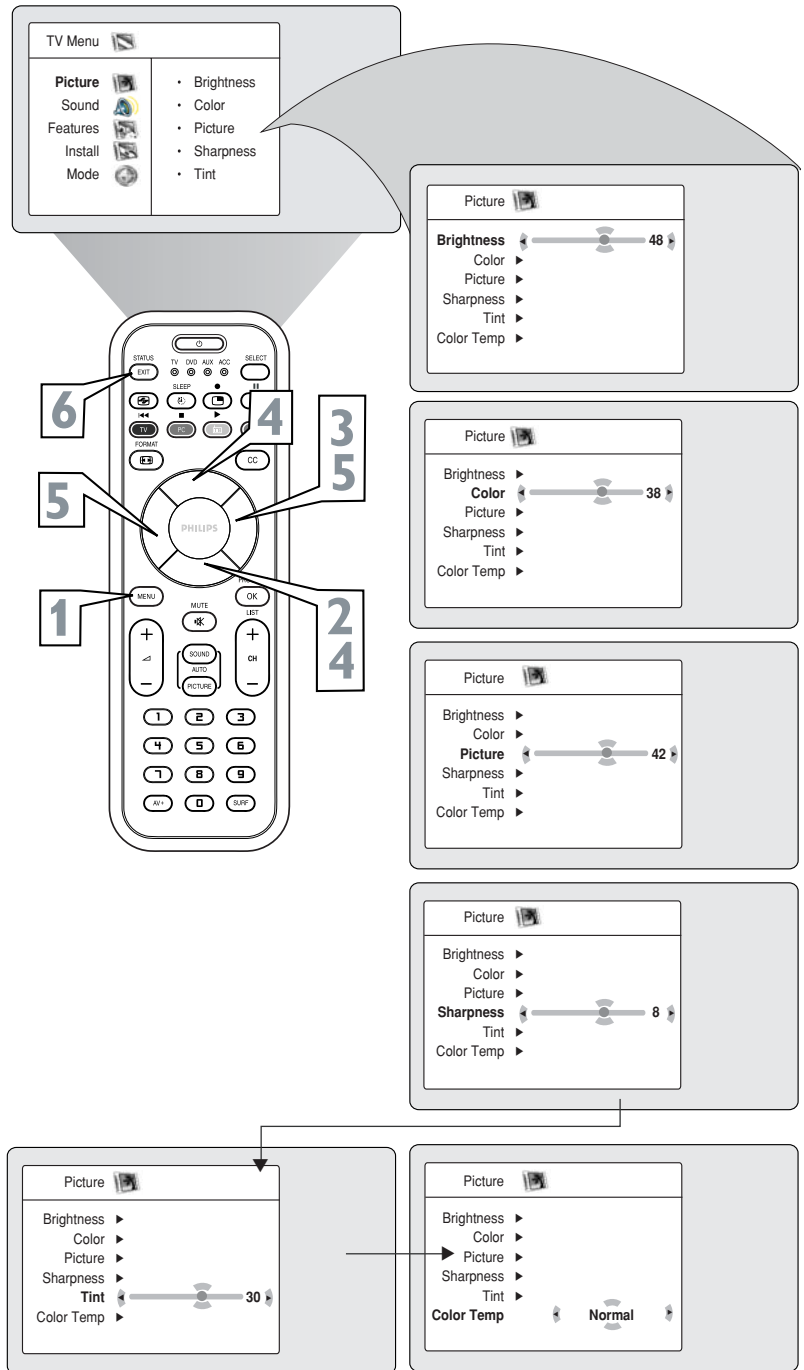
- 1** Press the **MENU** button on the remote control to show the onscreen menu.
- 2** Press the **CURSOR DOWN** button to highlight Picture.
- 3** Press the **CURSOR RIGHT** button to enter the Picture menu. Brightness will be highlighted.
- 4** Press the **CURSOR UP** or **CURSOR DOWN** button to select the picture adjustment you want to change: **Brightness, Color, Picture, Sharpness, Tint, or Color Temp.**
- 5** Press the **CURSOR LEFT** or **CURSOR RIGHT** button to adjust the selected control.
- 6** Press the **STATUS/EXIT** button when finished to remove the menu from the screen.



HELPFUL HINT

Remember, when the bar scale is centered , the control settings are at normal, mid-range levels.

NOTE: The Sharpness and Tint Controls will not be available for adjustments when tuned to the CVI Inputs.

Brightness – adds or subtracts light from the darkest part of the picture.

Color – adds or eliminates color.

Picture – improves the detail of the lightest parts of the picture.

Sharpness – improves the detail in the picture.

Tint – adjusts the picture to obtain natural skin tones.

Color Temp. - offers NORMAL, COOL, or WARM picture preferences. (Normal will keep the whites, white; Cool will make the whites, bluish; and Warm will make the whites, reddish.)

HOW TO USE THE SOUND ADJUSTMENT CONTROLS



To adjust your TV sound controls, select a channel and follow these steps.

- 1** Press the **MENU** button on the remote control to show the onscreen menu. Picture will be highlighted.
- 2** Press the **CURSOR DOWN** button to highlight Sound.
- 3** Press the **CURSOR RIGHT** button to enter the sound menu.
- 4** Press the **CURSOR UP** or **CURSOR DOWN** button to select the sound adjustment you want to change: **Equalizer**, **Balance**, **AVL**, **Dolby Virtual**, **SAP**, or **Sound**.
- 5** Press the **CURSOR LEFT** or **CURSOR RIGHT** button to adjust the selected control.
- 6** Press the **STATUS/EXIT** button when finished to remove the menu from the screen.

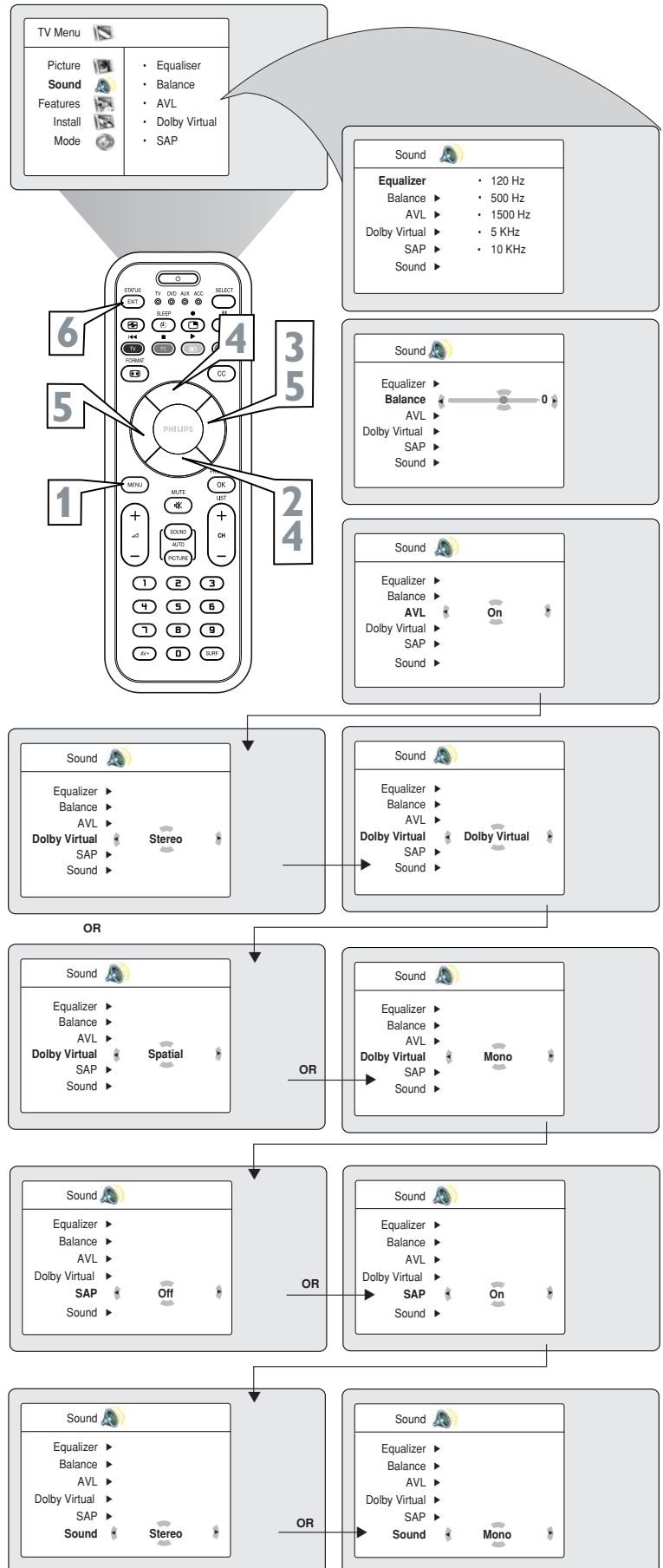

HELPFUL HINT

Equalizer – adjusts the sound tones. Select 120Hz to 10KHz.

Balance – adjusts the level of sound coming from the left and right speakers.

AVL (Auto Volume Leveler) - when On, AVL will level out the sound being heard when sudden changes in volume occur during commercial breaks or channel changes.

Dolby Virtual - adds greater depth and dimension to TV sound. Select from Dolby Virtual or Stereo sound (if Stereo) or Spatial or Mono (if Mono).

SAP (Secondary Audio Programming)– sent as a third audio channel, a SAP signal can be heard apart from the current TV program sound. Note: If SAP is not available, “Not Available” will appear on the screen.

Sound – select from Stereo or Mono.



HOW TO USE THE TIMER MENU CONTROLS

Your television comes with an onscreen clock. The TV can also be set to turn on or off at a specific time and tune to a specific channel when it powers itself on.

- 1** Press the **MENU** button on the remote control to show the onscreen menu.
- 2** Press the **CURSOR DOWN** button to highlight **Features**.
- 3** Press the **CURSOR RIGHT** button to enter the Features menu.
- 4** Press the **CURSOR UP** or **CURSOR DOWN** button to highlight one of the Timer controls. These controls are **Time**, **Start Time**, **Stop Time**, **Program No.**, **Activate**, or **Display**.
- 5** Press the **CURSOR RIGHT** or **CURSOR LEFT** button to make adjustments or to toggle the On or Off options.

Time: Enter the current time using the Numbered buttons. Use the **CURSOR RIGHT** to move to the AM/PM slot and use the **CURSOR LEFT** or **CURSOR RIGHT** buttons to toggle the AM and PM setting.

Start Time: Use the numbered buttons to enter the time you want the TV to turn itself On. Use the **CURSOR RIGHT** and **CURSOR LEFT** buttons to toggle the AM and PM setting.

Stop Time: Use the numbered buttons to enter the time you want the TV to turn itself Off. Use the **CURSOR RIGHT** and **CURSOR LEFT** buttons to toggle the AM and PM setting.

Program No.: Use the **NUMBERED** buttons or the **CH +** or **CH -** buttons to enter the desired start-up channel. You can also press the **CURSOR RIGHT** or **CURSOR LEFT** buttons to enter the desired start-up channel.

Activate: Set the timer to turn itself On (Once or Daily) or Off. Press the **CURSOR RIGHT** and **CURSOR LEFT** buttons to select Once, Daily, or Off.

Display: Press the **CURSOR RIGHT** or **CURSOR LEFT** to toggle between On or Off. If On is selected, the time will be displayed all the time when the TV is on. When Off is selected, the time will only appear when the **STATUS/EXIT** button is pressed.

- 6** Press the **STATUS/EXIT** button to remove the menu from the screen.

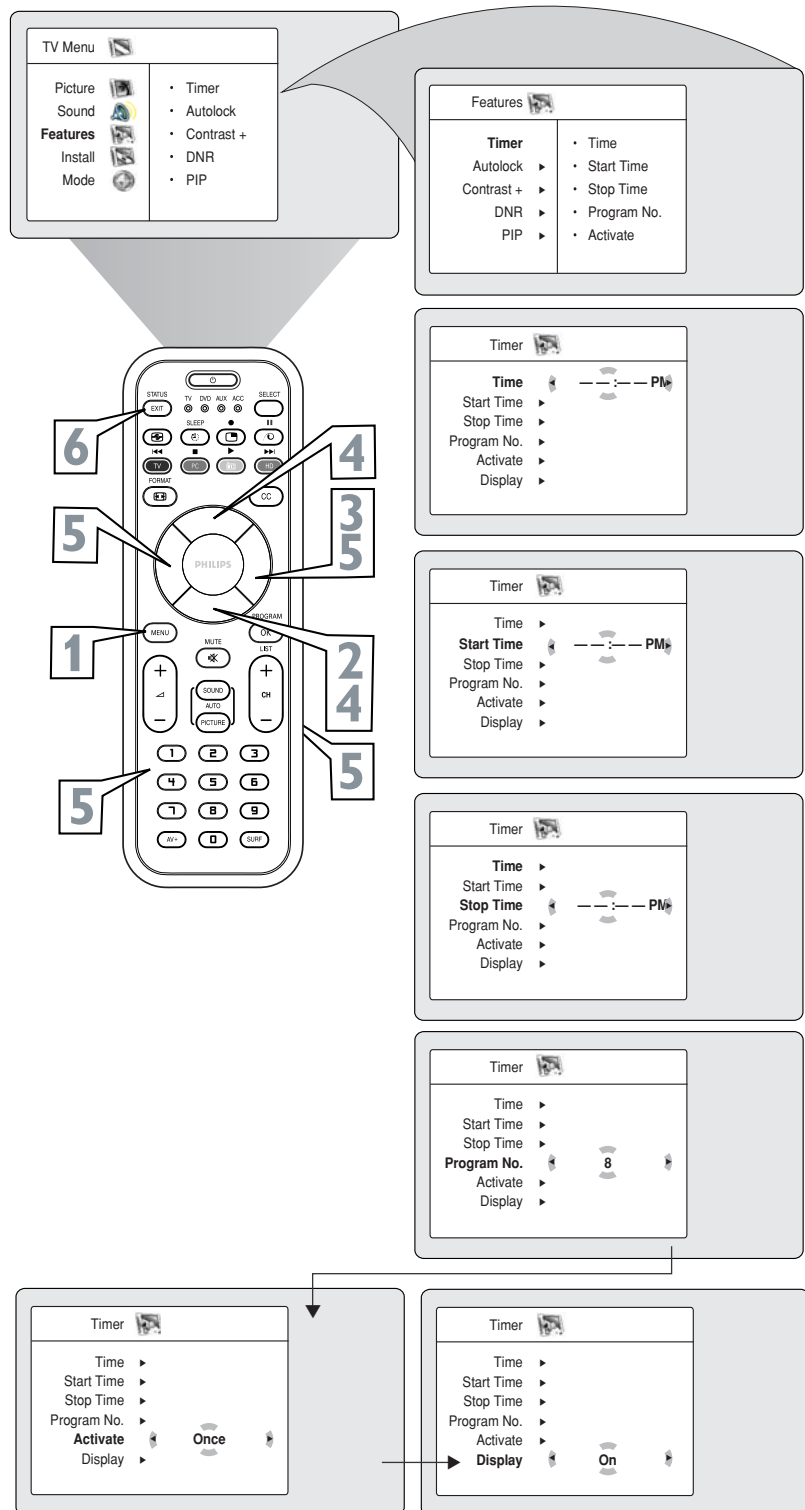



The AutoLock™ feature receives and processes data sent by broadcasters or other program providers that contain program content advisories. When programmed by the viewer, a TV with AutoLock™ can respond to the content advisories and block program content that may be found objectionable (such as offensive language, violence, sexual situations, etc.). This is a great feature to censor the type of programming children may watch.

In the AutoLock™ section, you'll learn how to block channels and programming that is not rated, is unrated, or has no rating. You will also find out how to turn these blocking features ON or OFF. Following are brief explanations of some terms and ratings related to the AutoLock™ feature.

AutoLock™ offers various Blocking Options from which to choose:

BLOCKING: The BLOCKING control is what can be thought of as the "master switch" for AutoLock™. This control affects the settings you have chosen for blocking programs according to movie ratings or TV ratings, or for blocking programs that have no rating or are unrated. When the BLOCKING control is OFF, the blocking or censoring of programs is disabled. When the BLOCKING control is ON, blocking will occur according to the settings you have chosen.

NO RATING: ALL programming with no content advisory data can be blocked if NO RATING is set to ON.

Programming that has No Rating is not encoded with any rating information from the MPAA or the Parental Guidelines. Any programming could fall into this category.

You also can block individual channels or block programming based on ratings of the MPAA and TV broadcasters. (See a description of the ratings on this page.)

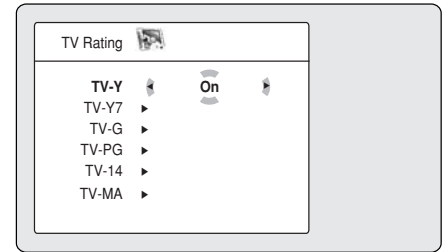
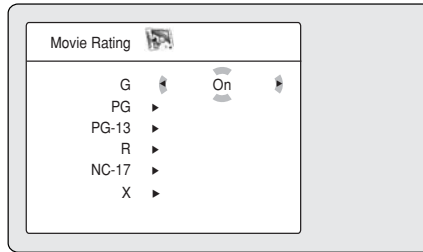

MOVIE RATINGS (MOTION PICTURE ASSOCIATION OF AMERICA)

G: General Audience - All ages admitted. Most parents would find this programming suitable for all ages. This type of programming contains little or no violence, no strong language, and little or no sexual dialogue or sexual situations.

PG: Parental Guidance Suggested - This programming contains material that parents may find unsuitable for younger children. It may contain one or more of the following: Moderate violence, some sexual situations, infrequent coarse language, or some suggestive dialogue.

PG-13: Parents Strongly Cautioned - This programming contains material that parents may find unsuitable for children under the age of 13. It contains one or more of the following: violence, sexual situations, coarse language, or suggestive dialogue.

R: Restricted - This programming is specifically designed for adults. Anyone under the age of 17 should view this programming only with an accompanying parent or adult guardian. It contains one or more of the following: intense violence; intense sexual situations; strong, coarse language; or intensely suggestive dialogue.

NC-17: No one under the age of 17 will be admitted. - This type of programming should be viewed by adults only. It contains graphic violence; explicit sex; or crude, indecent language.

X: Adults Only - This type of programming contains one or more of the following: very graphic violence, very graphic and explicit or indecent sexual acts, very coarse and intensely suggestive language.

TV PARENTAL GUIDELINES (TV BROADCASTERS)

TV-Y: (All children -- This program is designed to be appropriate for all children.) Designed for a very young audience, including children ages 2-6. This type of programming is not expected to frighten younger children.

TV-Y7: (Directed to Older Children -- This program is designed for children ages 7 and above.) It may be more appropriate for children who have acquired the development skills needed to distinguish between make-believe and reality. This programming may include mild fantasy and comic violence (FV).

TV-G: (General Audience -- Most parents would find this program suitable for all ages.) This type of programming contains little or no violence, no strong language, and little or no sexual dialogue or sexual situations.

TV-PG: (Parental Guidance Suggested -- This program contains material that parents may find unsuitable for younger children.) This type of programming contains one or more of the following: Moderate violence (V), some sexual situations (S), infrequent coarse language (L), or some suggestive dialogue (D).

TV-14: (Parents Strongly Cautioned -- This program contains some material that many parents would find unsuitable for children under 14 years of age.) This type of programming contains one or more of the following: intense violence (V); intense sexual situations (S); strong, coarse language (L); or intensely suggestive dialogue (D).

TV-MA: (Mature Audience Only -- This program is specifically designed to be viewed by adults and therefore may be unsuitable for children under 17.) This type of programming contains one or more of the following: graphic violence (V); explicit sexual situations (S); or crude, indecent language (L).



SETTING UP AN AUTOLOCK™ ACCESS CODE

AutoLock™ allows parents to block out or “censor” any channels they think children should not watch. A channel blocked by the AutoLock™ control cannot be viewed until a correct access code is used to unlock the channel for viewing. First, let’s set your AutoLock access code.

- 1** Press the **MENU** button on the remote control to show the onscreen menu.
- 2** Press the **CURSOR DOWN** button to highlight **Features**.
- 3** Press the **CURSOR RIGHT** button to display the Features menu.
- 4** Press the **CURSOR DOWN** button to highlight the **AutoLock** control.
- 5** Press the **CURSOR RIGHT** button to enter the AutoLock mode. “Access Code ----” will appear.
- 6** Using the numbered buttons on the remote control, enter the access code. If you do not know your code, **0,7,1,1** is the default code. After you have entered the code once, *Incorrect* will appear on the screen. Enter the code a second time, *Correct* will appear. When “Correct” appears, the AutoLock menu is accessible and you can proceed to change the access code.
- 7** Press the **CURSOR DOWN** button to highlight **Change Code**.
- 8** Press the **CURSOR RIGHT** button to enter the Change Code menu, “Enter New Code ----” will appear. Enter a new four-digit code using the number buttons, “Confirm Code----” will appear on the screen.
- 9** Using the numbered buttons, re-enter your new four-digit code, “Confirm Code” will appear. After re-entering your new code, *Correct* will flash on the screen briefly and the highlight bar goes back to AutoLock.
- 10** Press the **STATUS/EXIT** button to remove the menu from the screen.

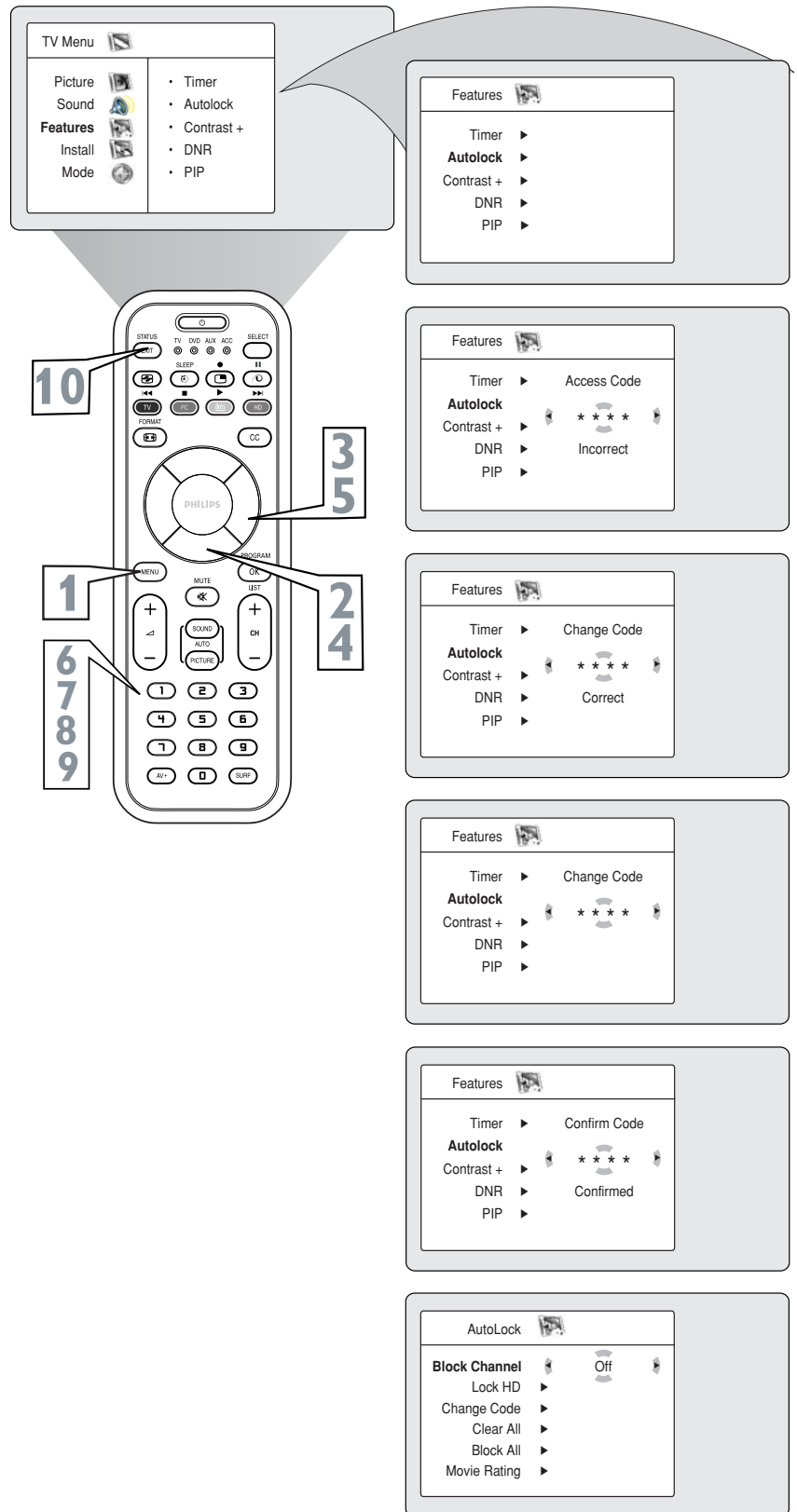

HELPFUL HINT

Remember that 0711 is the default AutoLock™ code. If your access code has been changed by someone other than you (a child, for example) or you have forgotten the code, you can always get in by inputting the default code.

NOTE TO PARENTS: It isn't possible for your child to unblock a channel without knowing your access code or changing it to a new one. If your code has been changed without your knowledge, then you will become aware that blocked channels may have been viewed.



After your personal access code has been set (see the previous page), you are ready to select the channels or inputs you want to block out or censor.

- 1** Press the **MENU** button on the remote control to show the onscreen menu.
 - 2** Press the **CURSOR DOWN** button to highlight **Features**.
 - 3** Press the **CURSOR RIGHT** button to display the **Features** menu.
 - 4** Press the **CURSOR DOWN** button to highlight **AutoLock™**.
 - 5** Press the **CURSOR RIGHT** button again display the Access Code menu prompt.
 - 6** Enter your four-digit **ACCESS CODE**. Correct will flash very briefly and the AutoLock™ will be accessible.
 - 7** You can choose to block individual channels or all channels at the same time. For individual channels, **press the CURSOR RIGHT** to enter the Lock Channel menu.
 - 8** Using the numbered buttons or the **CH+** or **CH-** buttons enter the channel you wish to lock.
- Repeat step 8 for any channels you want to lock.
- 9** To block all channels, **press the CURSOR DOWN** button until **Block All** is selected.
 - 10** Press the **CURSOR RIGHT** button to select **On** to activate the blocking of all channels. To deactivate the blocking of all channels, select **Off**.
 - 11** Press the **STATUS/EXIT** button to remove the menu from the screen.

NOTE TO PARENTS: It isn't possible for your child to unblock a channel without knowing your access code or changing it to a new one. If your code has been changed without your knowledge, then you will become aware that blocked channels may have been viewed.

HELPFUL HINT

Remember that 0711 is the default AutoLock™ code. If your access code has been changed by someone other than you (a child, for example) or you have forgotten the code, you can always get in by inputting the default code.

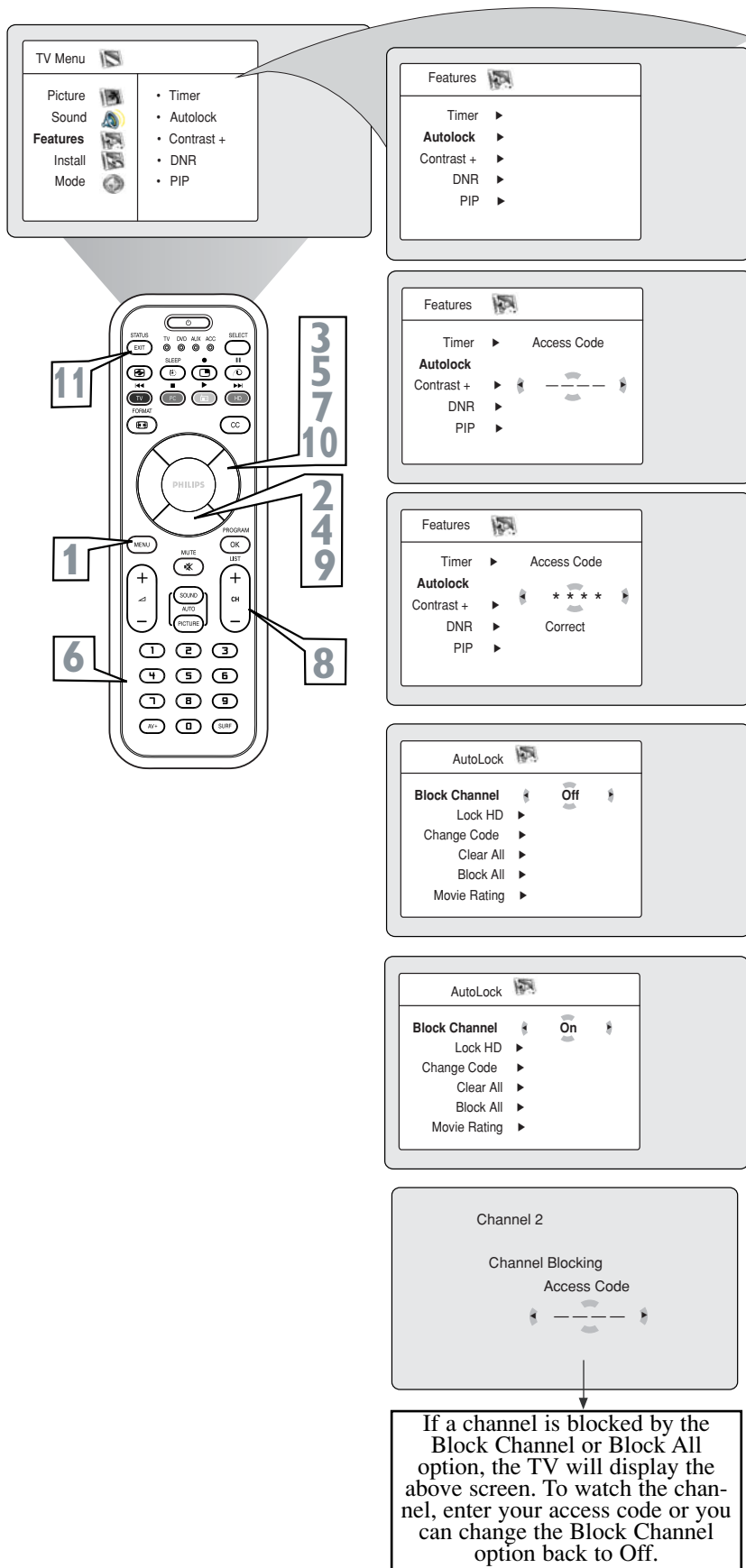



HOW TO LOCK A HD (HIGH DEFINITION) CHANNEL IN TV MODE

You can also lock the HD (High Definition) channel while in TV Mode using the AutoLock™ feature.

- 1** Press the **MENU** button on the remote control to show the onscreen menu.
- 2** Press the **CURSOR DOWN** button to highlight **Features**.
- 3** Press the **CURSOR RIGHT** button to display the Features menu.
- 4** Press the **CURSOR DOWN** button to select the **AutoLock™** control.
- 5** Press the **CURSOR RIGHT** button again to highlight **Access Code**.
- 6** Enter your four-digit **Access Code**, "Correct" will briefly appear on the screen and the AutoLock menu will be accessible.
- 7** Press the **CURSOR DOWN** button to select **Lock HD**.
- 8** Press the **CURSOR RIGHT** button to select **On** to activate the blocking of the HD channel.
- 9** Press the **STATUS/EXIT** button to remove the menu from the screen.

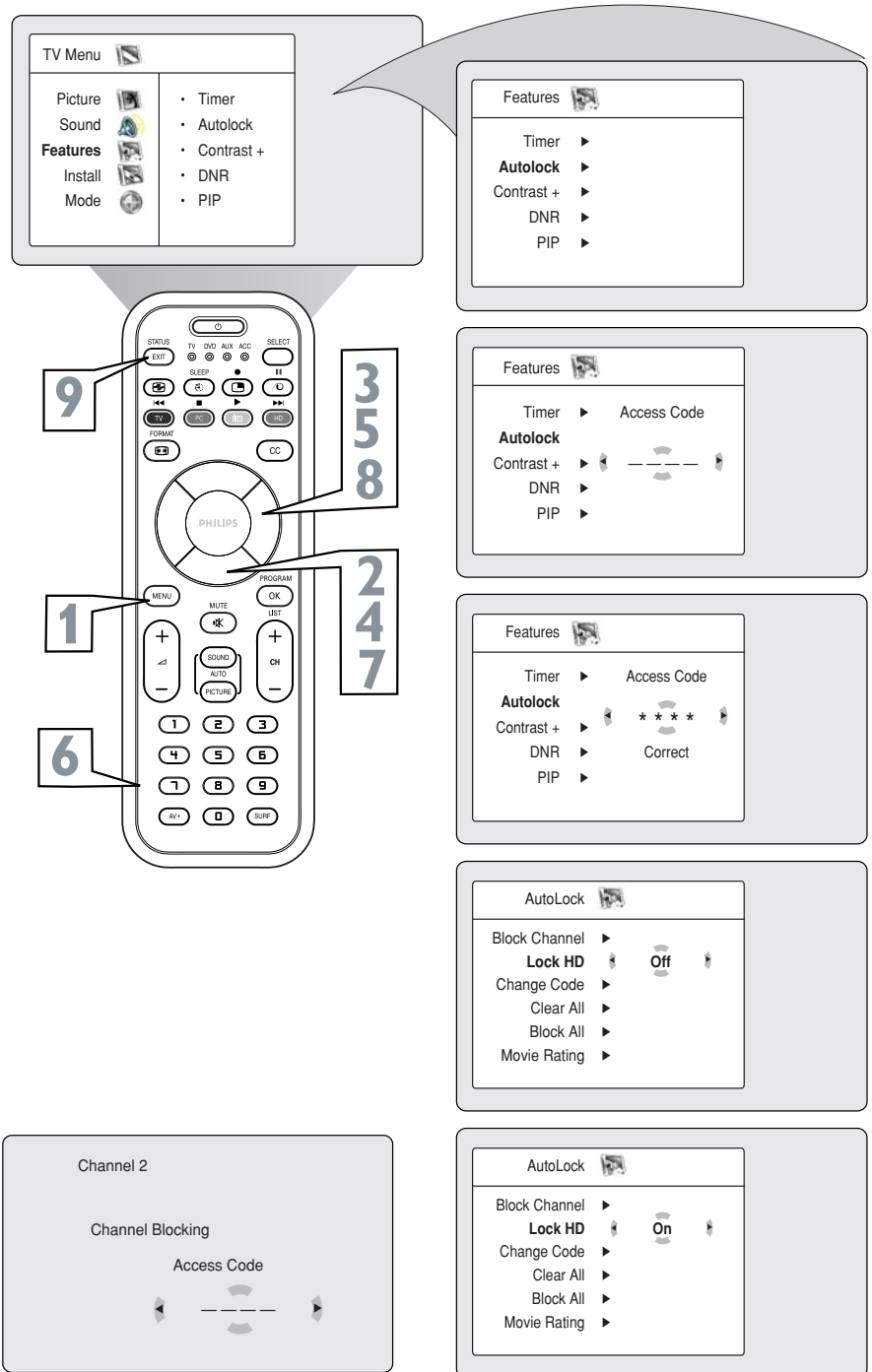

If a channel is blocked by the Block Channel or Block All option, the TV will display the screen shown above. To watch the selected blocked channel or all the blocked channels, enter your Access Code or change the Block Channel or Block All option to Off.

HELPFUL HINT

Remember that 0711 is the default AutoLock™ code. If your access code has been changed by someone other than you (a child, for example) or you have forgotten the code, you can always get in by inputting the default code.

HOW TO CLEAR ALL LOCKED CHANNELS AT THE SAME TIME



Various onscreen messages will appear when someone tries to view blocked programming. The message is determined by how the current programming is blocked. You may view the blocked programming and turn OFF the AutoLock™ feature by using the Clear All control or by entering your access code.

- 1** Press the **MENU** button on the remote control to show the onscreen menu.
- 2** Press the **CURSOR DOWN** button to highlight **Features**.
- 3** Press the **CURSOR RIGHT** button to display the Features menu.
- 4** Press the **CURSOR DOWN** button to select the **AutoLock™** control.
- 5** Press the **CURSOR RIGHT** button again to highlight **Access Code**.
- 6** Enter your four-digit **Access Code**, "Correct" will briefly appear on the screen and the AutoLock menu will be accessible.
- 7** Press the **CURSOR RIGHT** button to enter the AutoLock menu.
- 8** Press the **CURSOR DOWN** button to select **Clear All**. **Clear?** will appear on the screen.
- 9** Press the **CURSOR RIGHT** button to activate the clearing of all channels.
- 10** Press the **STATUS/EXIT** button to remove the menu from the screen.

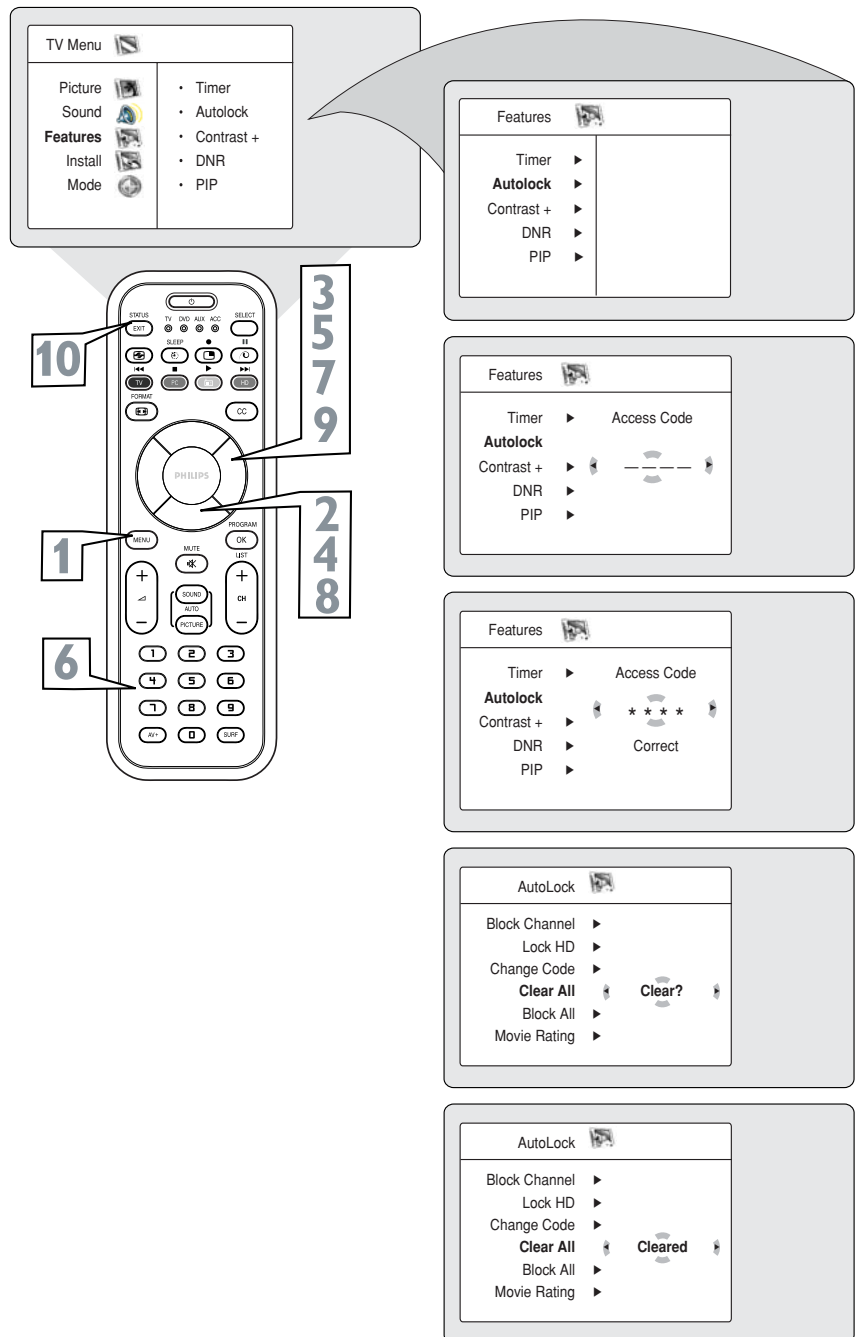

HELPFUL HINT

If you tune to a specific channel that has been blocked by Block Channel or any of the AutoLock™ Rating options, simply enter your four-digit access code to view the channel.

NOTE : This will unblock ALL channels until the TV is shut OFF. When powered back ON, all previously blocked channels will be blocked again.



BLOCKING PROGRAMS BASED ON MOVIE RATINGS

After your personal access code has been set, you can select specific movie ratings that you want to censor.

- 1** Press the **MENU** button on the remote control to show the onscreen menu.
- 2** Press the **CURSOR DOWN** button to highlight **Features**.
- 3** Press the **CURSOR RIGHT** button to display the Features menu.
- 4** Press the **CURSOR DOWN** button to highlight the AutoLock™ control.
- 5** Press the **CURSOR RIGHT** button again to highlight Access Code.
- 6** Enter your four-digit Access Code. Correct will flash very briefly and the menu will move to the left with the AutoLock menu now accessible.
- 7** Press the **CURSOR RIGHT** button to display the AutoLock menu.
- 8** Press the **CURSOR DOWN** repeatedly until Movie Rating is highlighted.
- 9** Press the **CURSOR RIGHT** button and the Rating menu shifts to the left with G highlighted.
- 10** Press the **CURSOR UP** or **DOWN** buttons to highlight each rating you want.
- 11** Press the **CURSOR RIGHT** button to turn the rating ON or OFF. Turning the rating ON will block programs with that rating from being seen.
- 12** Press the **STATUS/EXIT** button to remove the menu from the screen.

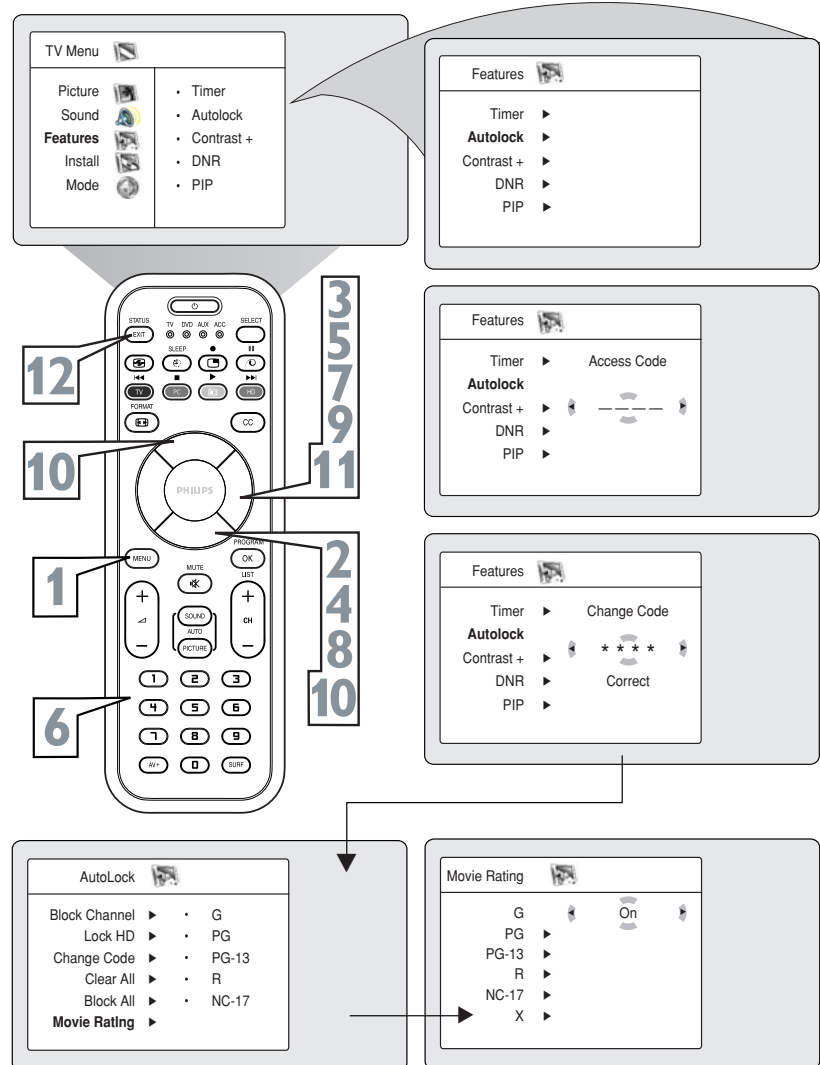

BLOCKING PROGRAMS BASED ON TV RATINGS



You can select specific TV ratings that you want to censor by following these steps.

- 1** Press the **MENU** button on the remote control to show the onscreen menu.
- 2** Press the **CURSOR DOWN** button to highlight **Features**.
- 3** Press the **CURSOR RIGHT** button to display the Features menu.
- 4** Press the **CURSOR DOWN** button to highlight the **AutoLock™** control.
- 5** Press the **CURSOR RIGHT** button again to highlight **Access Code**.
- 6** Enter your four-digit **Access Code**. *Correct* will flash very briefly and the menu will move to the left with the **AutoLock** menu now accessible.
- 7** Press the **CURSOR RIGHT** button to display the **AutoLock** menu.
- 8** Press the **CURSOR DOWN** button repeatedly until **TV Rating** is highlighted.
- 9** Press the **CURSOR RIGHT** button to enter the **TV RATING** menu.
- 10** Press the **CURSOR UP** or **DOWN** to select a desired rating (**TV-Y**, **TV-Y7**, **TV-G**, **TV-PG**, **TV-14**, or **TV-MA**).
- 11** Press the **CURSOR RIGHT** or **LEFT** to turn the block on the rating **On** or **Off**.

NOTE: More specific subratings (for violence, sexual content, dialogue, or fantasy violence) are available for **TV-Y7**, **TV-PG**, **TV-14**, and **TV-MA**. (Refer to page 11 for definitions.)

- 12** To access these subratings, with the main rating selected, **press the CURSOR RIGHT**. Then, repeat steps 10-11 to turn the sub-ratings **ON** or **OFF**.

- 13** Press the **STATUS/EXIT** button to remove the menu from the screen.

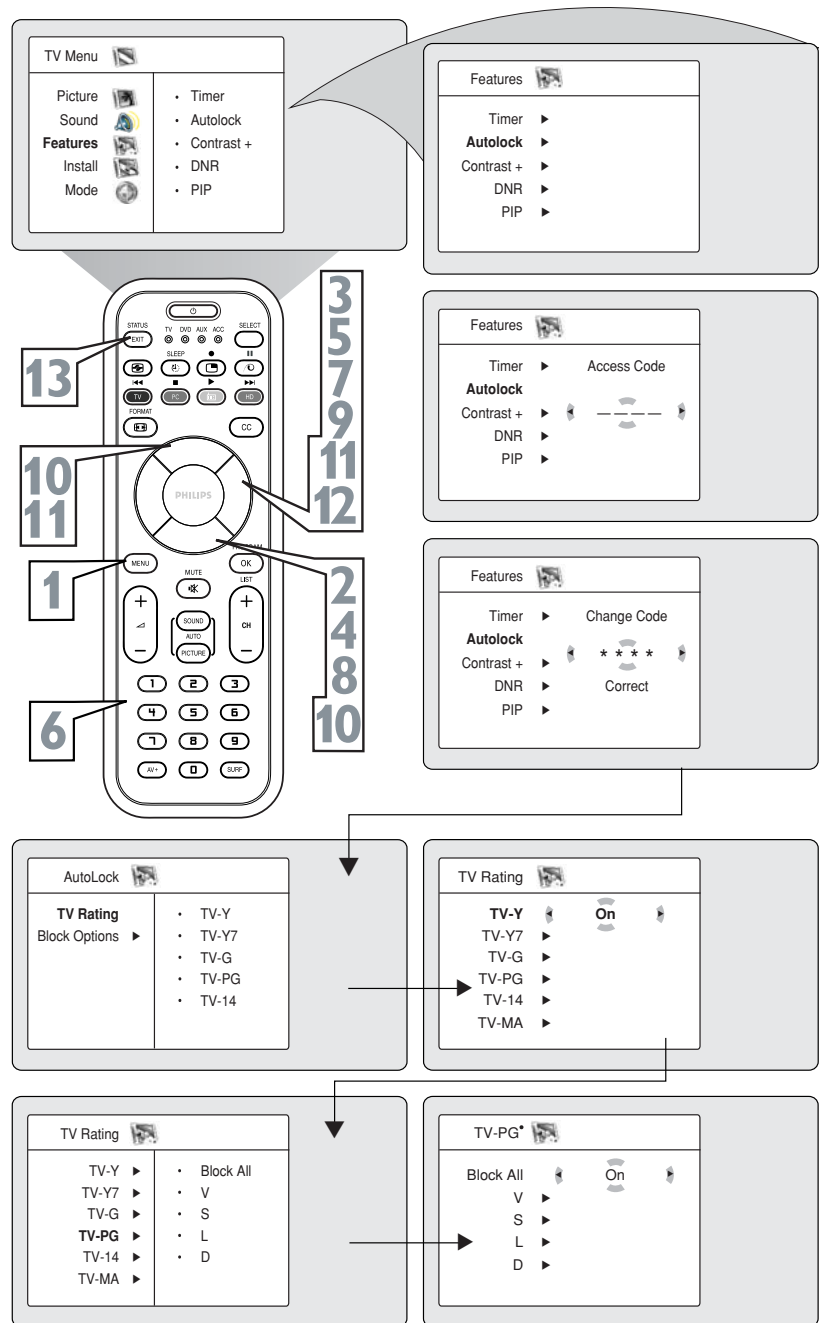



OTHER AUTOLOCK™ BLOCKING OPTIONS

The AutoLock™ control offers the viewer other blocking options as well! With Block Options, the censoring can be turned On or Off.

- 1 Press the **MENU/SELECT** button on the remote control to show the onscreen menu.
- 2 Press the **CURSOR UP** or **CURSOR DOWN** button to highlight Features.
- 3 Press the **CURSOR RIGHT** button to display the Features menu.
- 4 Press the **CURSOR DOWN** button to highlight the AutoLock™ control.
- 5 Press the **CURSOR RIGHT** button again to highlight Access Code.
- 6 Enter your four-digit Access Code. Correct will flash very briefly and the menu will move to the left with the AutoLock menu now accessible.
- 7 Press the **CURSOR RIGHT** button to display the AutoLock menu.
- 8 Press the **CURSOR DOWN** button repeatedly until Block Options is highlighted.
- 9 Press the **CURSOR RIGHT** button to enter the Block Options menu.
- 10 Press the **CURSOR UP** or **DOWN** buttons to select the desired block option.
Blocking: Might be called the “master switch” for AutoLock™. When On, ALL blocking/censoring will take place. When Off, ALL blocking is disabled.
Block Unrated: ALL unrated programs based on the Movie Ratings or Parental (TV) Guidelines can be blocked if this feature is set to On and the Blocking feature is set to OFF.
No Rating: ALL programming with NO content advisory data can be blocked if set to On and the Blocking feature is set to OFF.
- 11 Press the **CURSOR RIGHT** or **LEFT** to toggle BLOCKING ON or OFF.
- 12 Press the **STATUS/EXIT** button to remove the menu from the screen.

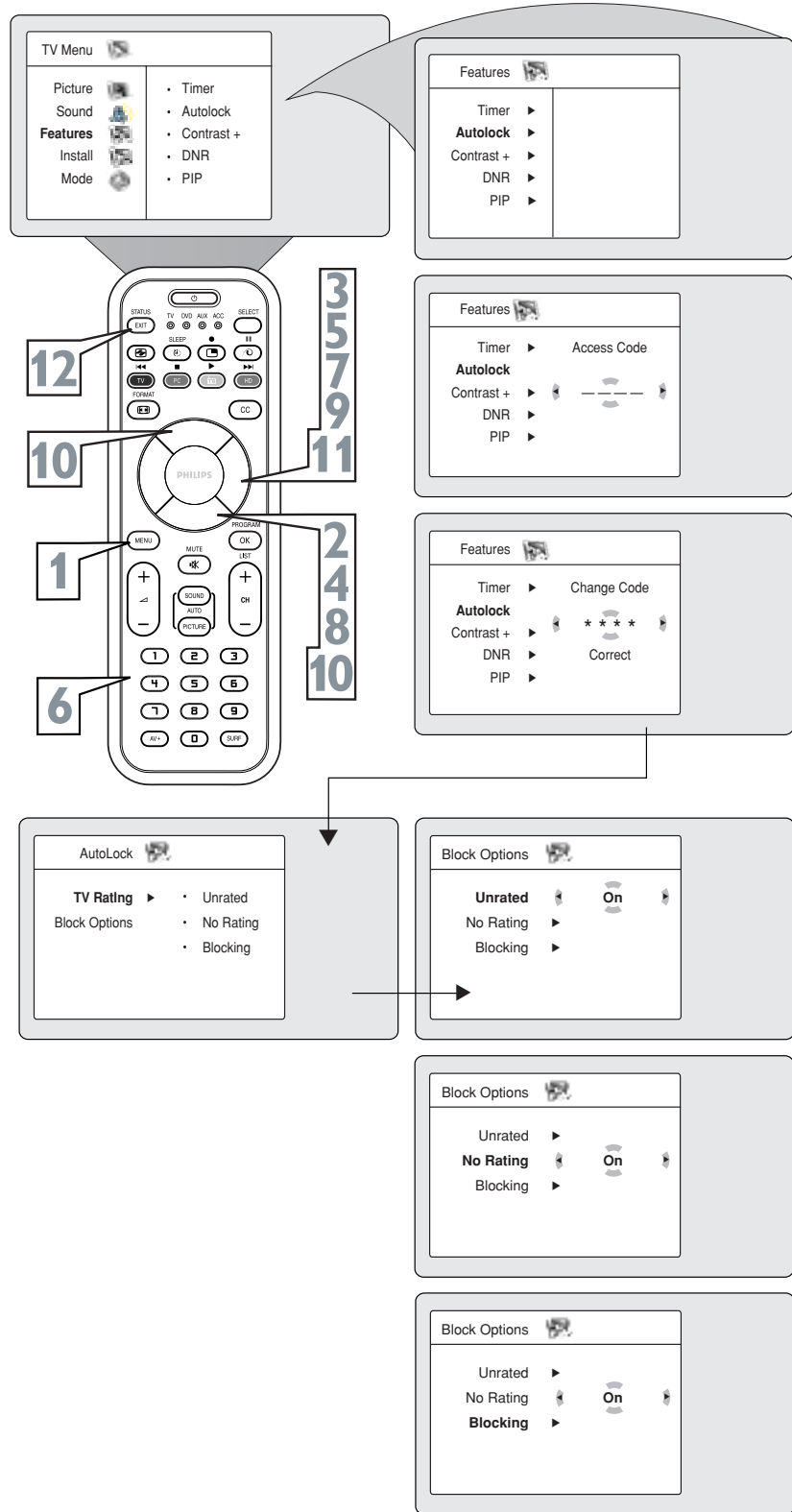

HELPFUL HINT

Remember, when the BLOCKING control is OFF, the blocking or censoring of programs is disabled. When the BLOCKING control is ON, blocking will occur according to the settings you have chosen.



To remind you which rating you have locked and which Block Options you have selected, a review screen is available to review your AutoLock™ settings. To access this screen follow the steps below.

- 1 Press the **STATUS/EXIT** button on the remote control TWICE. Your AutoLock™ settings will appear on the screen.

NOTE: If you have blocked specific subratings, such as V for violence in the TV-PG category, these blocked subratings will not appear in the review. The subratings however are still blocked according to your selections.

- 2 After a few seconds, the settings will leave the screen automatically, or you can press the **STATUS/EXIT** button a third time to remove them from the screen.

HELPFUL HINT

The AutoLock™ status screen will only appear if the Block option is set to On. See previous page for details.

AutoLock is set to Off by default.

Movie Rating	TV Rating
• G Off	• TV-7 Off
• PG On	• TV-Y7 On
• PG-13 On	• TV-G On
• R On	• TV-PG On
• NC-17 Off	• TV-14 On
• X Off	• MA On
	• Unrated On
	• No Rating On

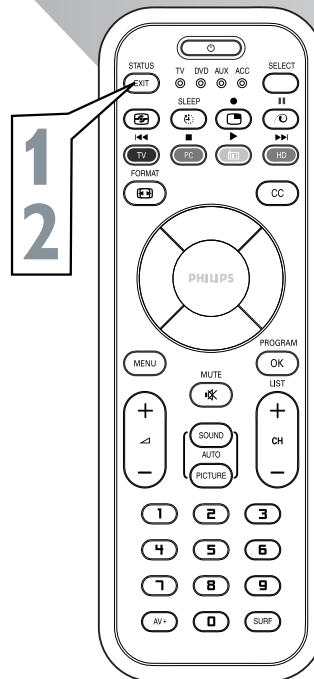

This display will appear after Step One (above) is completed if the AutoLock™ Block Option is set to **On**.

Movie Rating	TV Rating
• G Off	• TV-7 Off
• PG On	• TV-Y7 On
• PG-13 On	• TV-G On
• R On	• TV-PG On
• NC-17 Off	• TV-14 On
• X Off	• MA On
	• Unrated On
	• No Rating On

This display will appear after Step One (above) is completed if the AutoLock™ Block Option is set to **Off**.

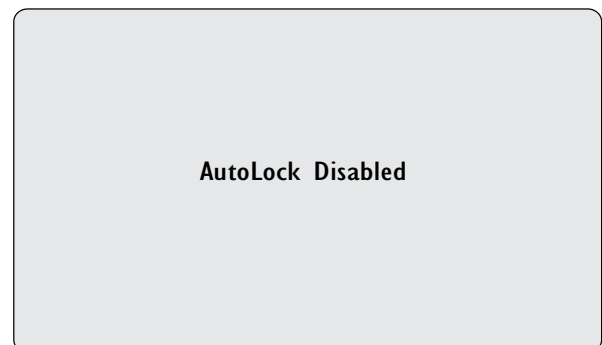



HOW TO USE THE CONTRAST+ CONTROL

The Contrast + function helps to sharpen the picture quality. The black portions of the picture become richer in darkness and the white portions become brighter.

- 1** Press the **MENU** button on the remote control to show the on-screen menu.
- 2** Press the **CURSOR DOWN** to highlight **Features**.
- 3** Press the **CURSOR RIGHT** to access the **Features** menu.
- 4** Press the **CURSOR DOWN** button until the **Contrast +** control is highlighted.
- 5** Press the **CURSOR RIGHT** or **LEFT** to toggle the **On** or **Off** option.
- 6** Press the **STATUS/EXIT** button to remove the menu from the screen.

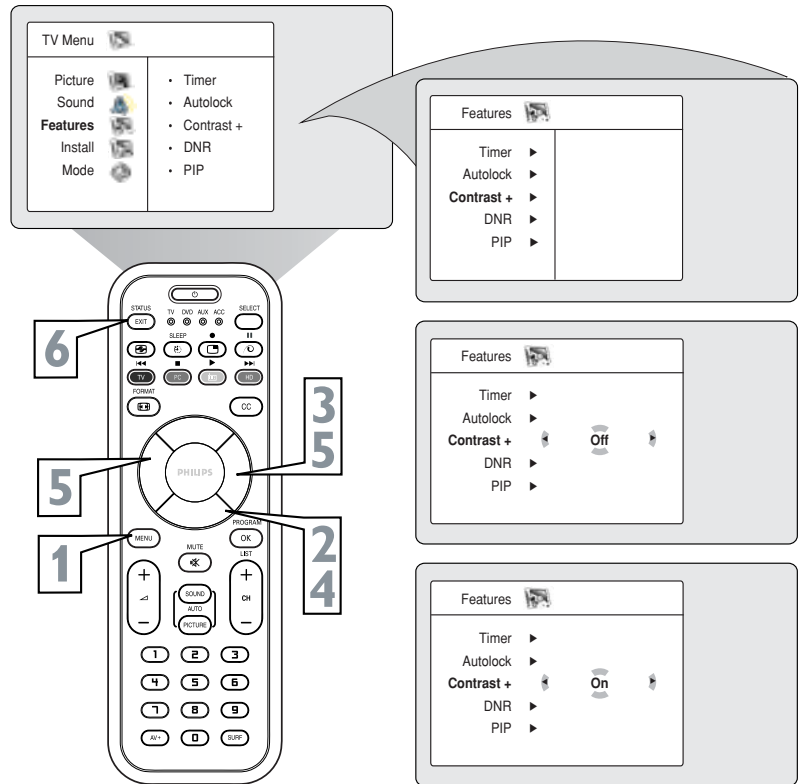

HOW TO USE THE DNR CONTROLS

The DNR (Dynamic Noise Reduction) function helps to diminish signal "noise" in the picture or what is known as "speckled" picture.

- 1** Press the **MENU** button on the remote control to show the on-screen menu.
- 2** Press the **CURSOR DOWN** to highlight **Features**.
- 3** Press the **CURSOR RIGHT** to access the **Features** menu.
- 4** Press the **CURSOR DOWN** button until the **DNR** is highlighted.
- 5** Press the **CURSOR RIGHT** or **LEFT** to toggle the **On** or **Off** option.
- 6** Press the **STATUS/EXIT** button to remove the menu from the screen.

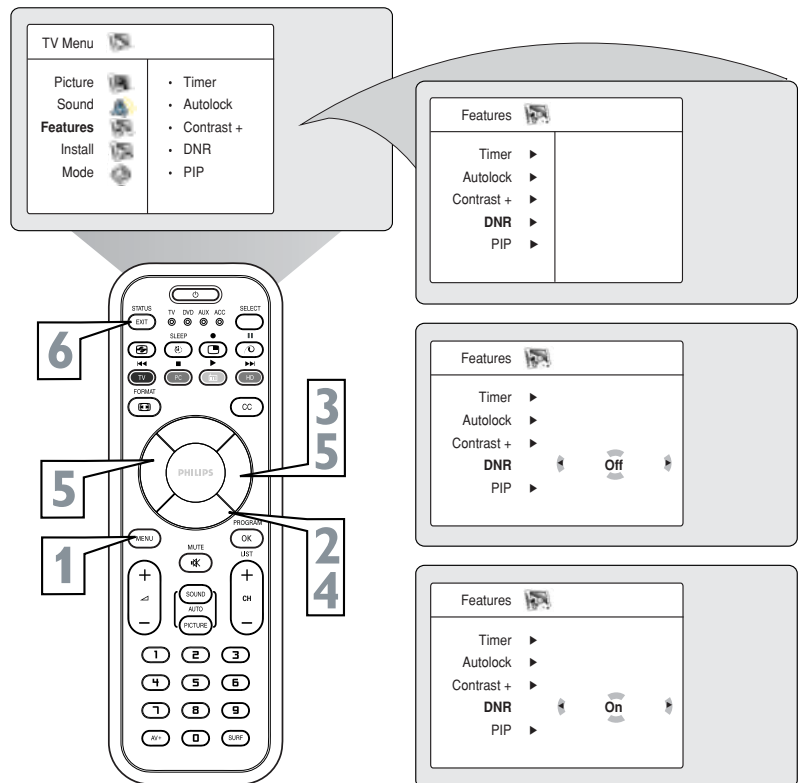

HOW TO USE THE PIP (PICTURE IN PICTURE) CONTROL



While you are in TV mode, you can call up a PIP window for the PC. To enable the PIP to function a DVI Input source must be selected. (Refer to the QUG for details on connections.)

- 1** Press the **MENU** button on the remote control to show the onscreen menu.
- 2** Press the **CURSOR DOWN** button to highlight **Features**.
- 3** Press the **CURSOR RIGHT** button access the Features menu.
- 4** Press the **CURSOR DOWN** button until **PIP** is highlighted.
- 5** Press the **CURSOR RIGHT** button to enter the PIP menu. PIP Size will be highlighted.
- 6** Press the **CURSOR LEFT** or **CURSOR RIGHT** button to select the available PIP Size options including Off, On, Small, Medium, Large, or Side-by-Side.
- 7** Press the **CURSOR DOWN** button to highlight **Horizontal**.
- 8** Press the **CURSOR LEFT** or **CURSOR RIGHT** button to move the PIP screen horizontally to the desired position.
- 9** If you want to move the PIP screen vertically, press the **CURSOR DOWN** button to highlight **Vertical**.
- 10** Press the **CURSOR LEFT** or **CURSOR RIGHT** button to move the PIP screen up or down.
- 11** Press the **STATUS/EXIT** button to exit the menu from the screen.

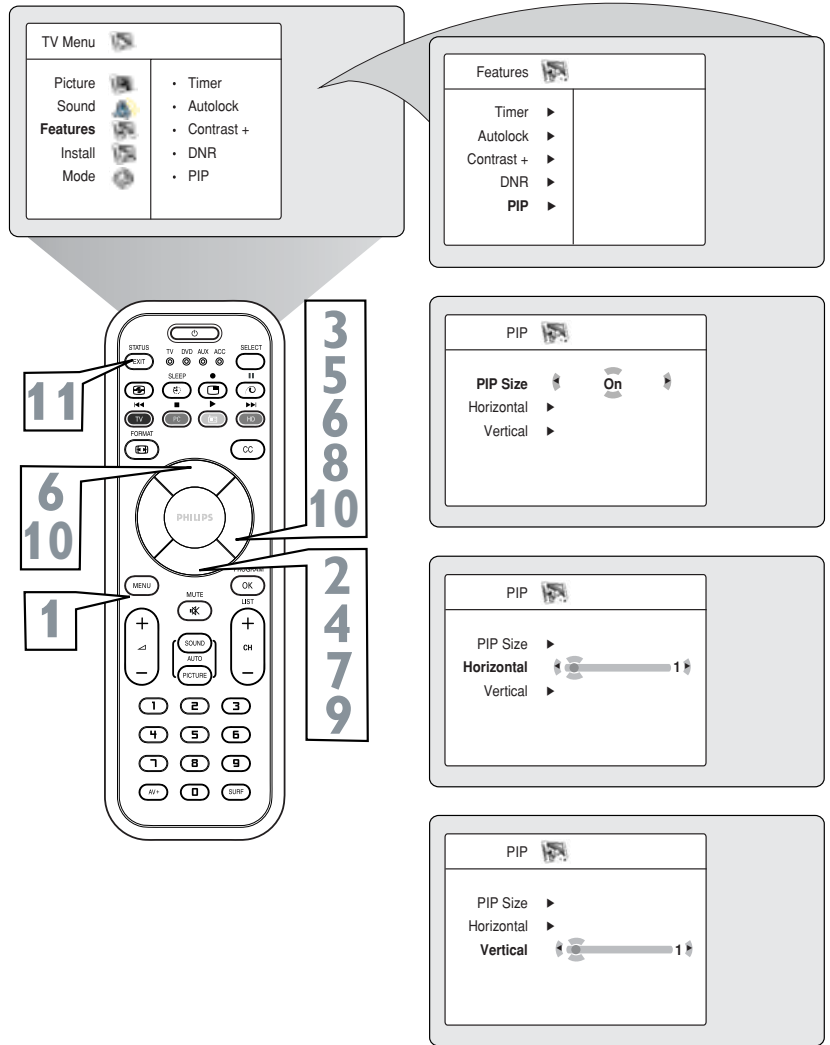

HELPFUL HINT

To turn off the PIP window, select PIP Size and select the Off option.

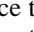
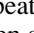
NOTE: You can also access the PIP window by pressing the  button on the remote control. Press  once to display the PIP screen. Press  repeatedly to toggle through the various PIP screen sizes.



HOW TO USE THE MODE CONTROL

The Mode Control will allow you to use the TV into the TV, FM, HD, or PC Modes. Depending on how the TV will be used, these modes may have their own onscreen menu controls to optimize capability when used with computers, radios, or high-definition receivers.

- 1** Press the **MENU** button on the remote control to show the onscreen menu.
- 2** Press the **CURSOR DOWN** to highlight **Mode**.
- 3** Press the **CURSOR RIGHT** to access the **Mode** menu.
- 4** Press the **CURSOR DOWN** button until the desired Mode (TV, FM Radio, PC, or HD) is highlighted.
- 5** After you have highlighted the desired mode is selected, press the **CURSOR RIGHT** button to enter the selected Mode.

NOTE: You can also press the dedicated button on the remote control to change the Mode.

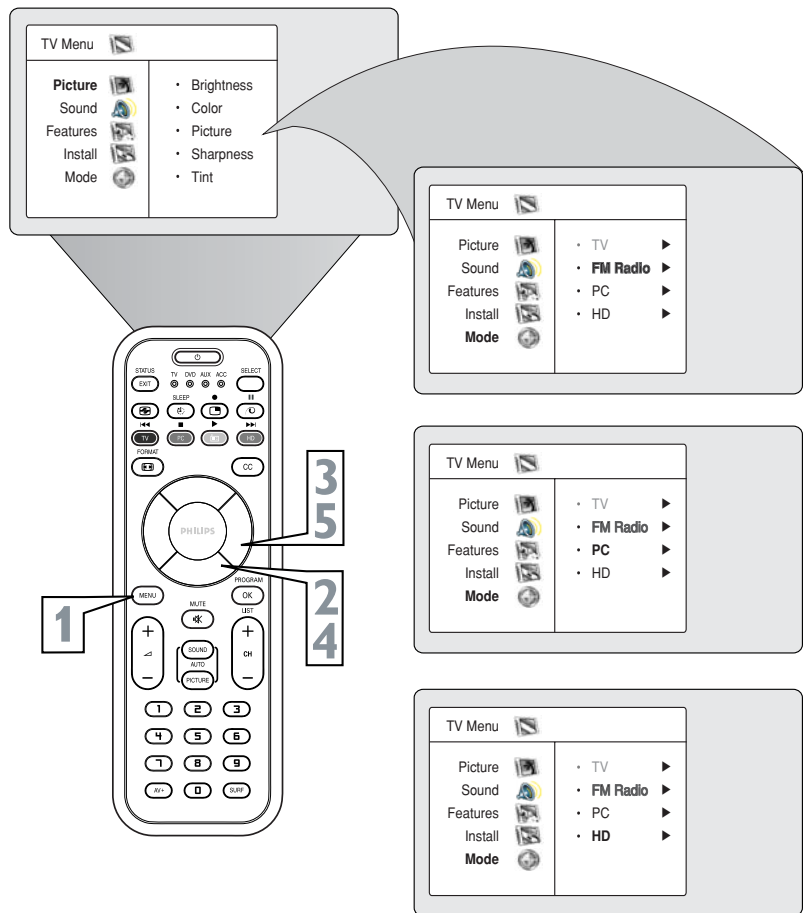

HOW TO USE THE FORMAT CONTROL

You can change the screen format size to match the type of program you're watching. Select the normal 4:3, Zoom 14:9, Zoom 16:9, Subtitle Zoom, Super Zoom, or Fullscreen.

- 1** Press the **FORMAT** button repeatedly to toggle the different format modes. You can select from normal 4:3, Zoom 14:9, Zoom 16:9, Subtitle Zoom, Super Zoom, or Fullscreen.

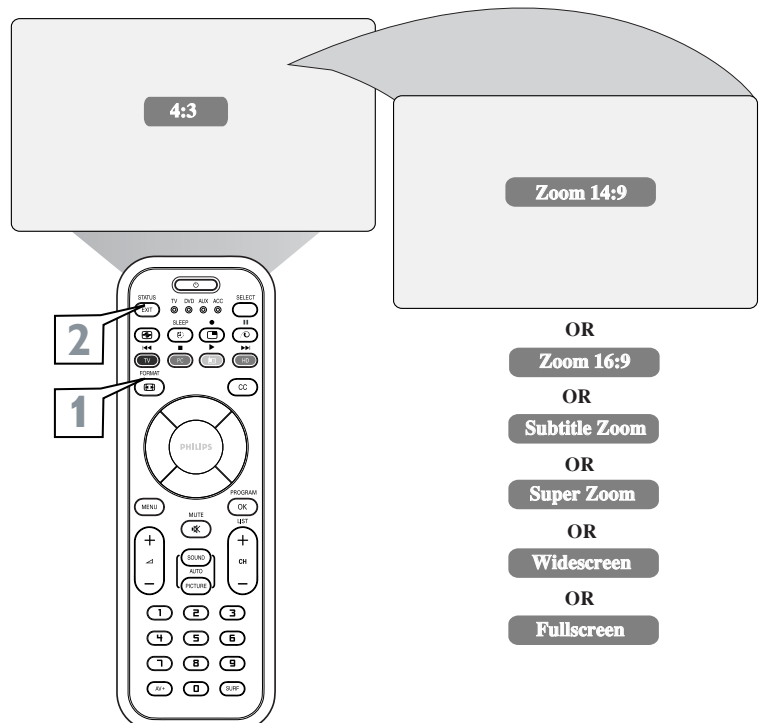

HOW TO USE THE CLOSED CAPTIONING CONTROL



Closed Captioning (CC) allows you to read the voice content of television programs on the TV screen. Designed to help the hearing impaired, this feature uses onscreen "text boxes" to show dialogue and conversations while the TV program is in progress.

- 1 Press the CC button** on the remote control to select a caption mode: CC Off, CC1, CC2, or CC Mute if the TV station broadcasting on the channel is making Closed Captioning available. To turn the Closed Captioning off, select CC Off.
- 2 Press the STATUS/EXIT button** to remove the menu from the screen.

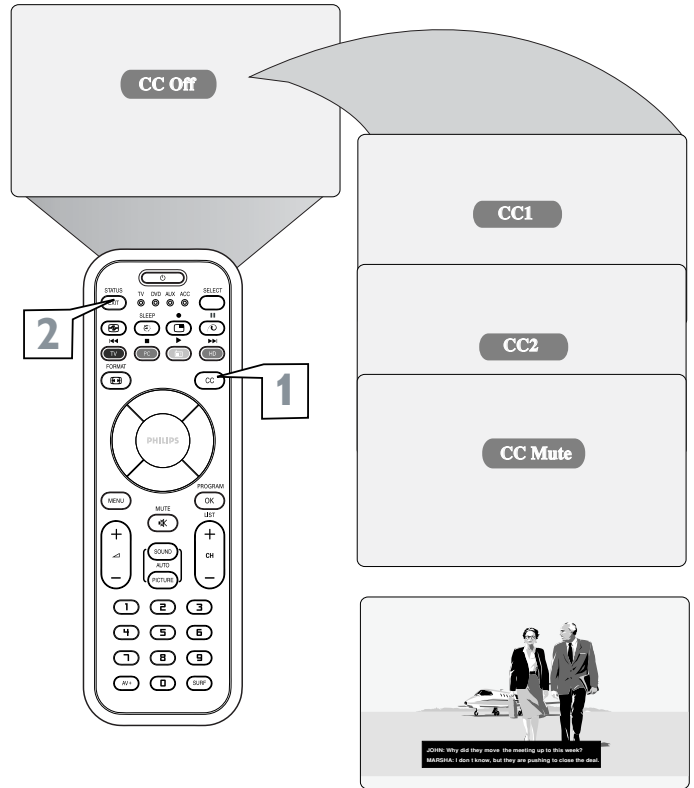

HELPFUL HINT

NOTE: Not all TV programs and product commercials are broadcast with Closed Captioning (CC). Nor are all Closed Captioning MODEs (CAPTION 1-4 or TEXT 1-4) necessarily being used by broadcast stations during the transmission of a program offering Closed Captioning. Refer to your area's TV program listings for the stations and times of shows being broadcast with Closed Captioning.

HOW TO USE THE SLEEPTIMER CONTROL



Have you ever fallen asleep in front of the TV, only to have it wake you up at two in the morning with a test pattern sound screeching in your ears? Well, your TV can enable you to avoid that discomfort by automatically turning itself off. With the Sleep timer feature, you can set a timer to automatically switch the TV off after a period of time you choose (15-minute increments up to 60 minutes, then 30-minute increments up to 90 minute increments, and 60-minute increments up to 240 minutes).

- 1 Press the SLEEP button** on the remote control. The Sleep timer will appear in the lower part of the screen.
- 2 Within five seconds, press the SLEEP button repeatedly** to pick the amount of time (15-minute increments up to 60 minutes, then 30-minute increments up to 90 minute increments, and 60-minute increments up to 240 minutes) before the TV will turn itself off.

An onscreen countdown will appear during the last minute before the TV shuts itself off.

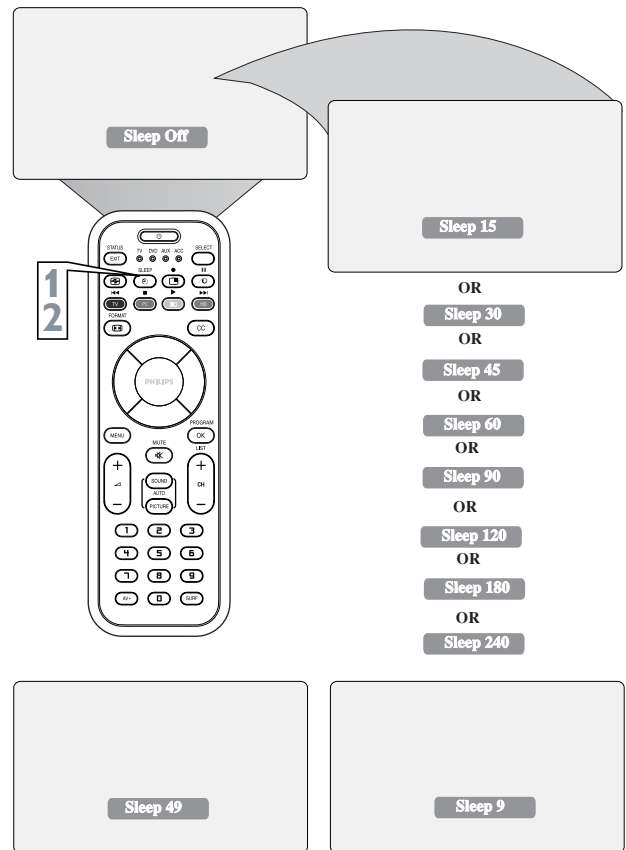

HELPFUL HINT

To see how many minutes remain before the TV shuts itself off, press the STATUS/EXIT button. A Sleep timer setting can be cancelled by pressing any button during the last minute of the operation.

During the last minute of a SLEEP timer setting, an onscreen countdown will be displayed.



HOW TO USE THE PROGRAM LIST CONTROL

The Program List Control will allow you to quickly overview all the programmed channels that have been placed into the televisions memory (see the Auto Programming section of this manual for more details). Program List will let you easily select the desired channels your looking for. Program List will display the channel number, the name of the channel if you have given it one, and whether it have AutoLock turn on or off.

- 1** Press the **PROGRAM LIST** button on the remote control to show the current list of installed channels (the current channel will be highlighted).
- 2** Press the **CURSOR UP** or **DOWN** buttons to scroll the list of channel, highlighting the one you want to activate.
- 3** Press the **CURSOR RIGHT** button to activate the channel. The TV will tune to that channel.
- 4** Press the **STATUS/EXIT** button to remove the menu from the screen.

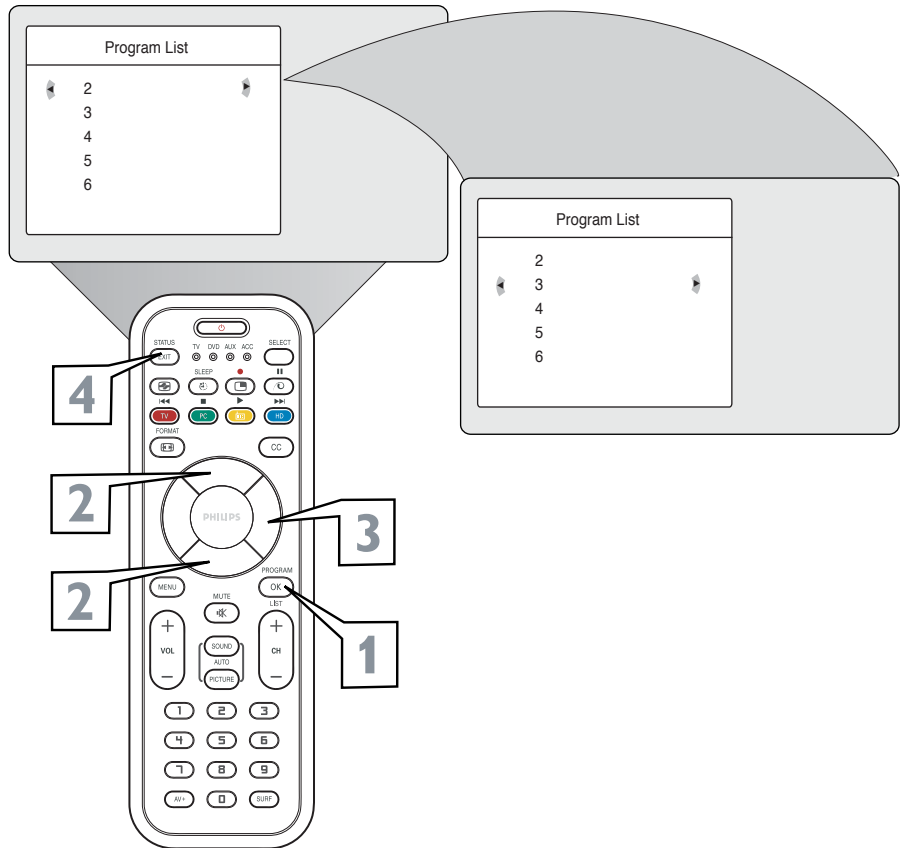

HOW TO SET THE ACTIVE CONTROL

The Active Control monitors and adjusts incoming video signals to help provide the best picture quality.

When you choose to turn the Active Control ON, the picture sharpness and noise reduction are controlled automatically. Active Control adjusts these picture settings continuously and automatically.

You have a choice of three modes: Active Control Off, Active Control On, or Active Control On with Sensor.

- 1** Press the **Active Control** button on the remote control to toggle the three options and select the desired option.
- 2** Press the **STATUS/EXIT** button to remove the menu from the screen.

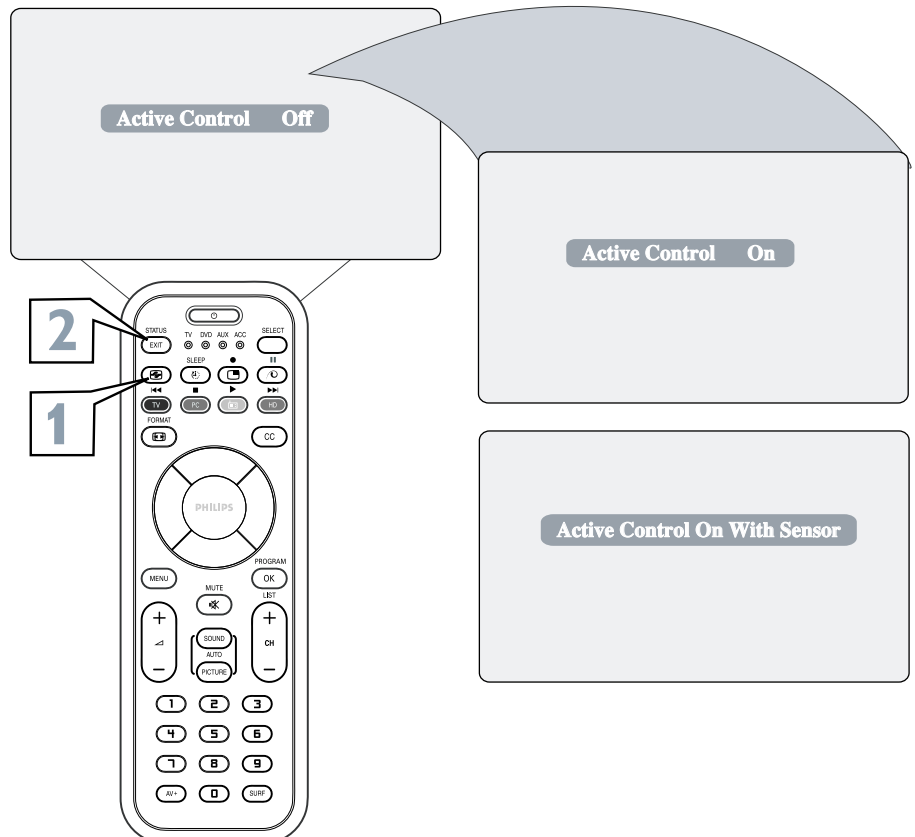

HOW TO USE THE SURF CONTROL



A list or series of previously viewed channels can be selected with the SURF button on your remote control. With this feature, you can easily switch between different TV channels that currently interest you. The SURF control allows you to set up to ten channels in its quick viewing list.

- 1** Press the CHANNEL(+) or (-) button (or the numbered buttons) to select a channel to add to the SURF list.
- 2** Press the SURF button on the remote control. The onscreen display may read, "SURF LIST EMPTY." The number of the current channel will be shown with "ADD?" to the right.
- 3** While the SURF list message or the SURF channel list appears on the screen, press the CURSOR RIGHT button to add the present channel to the SURF list.
- 4** If you want to delete the present channel from the SURF list, press the CURSOR RIGHT button again.

Repeat steps 1 through 3 to add more channels (up to 10) to the SURF list.

HELPFUL HINT

Along with regularly programmed channels, the external video source connections can be added to the SURF list. This means that the external A/V Jacks and their channels can be added to your SURF list. Use the Source button to tune their channel and use the same steps described on this page to add those channels to the Surf list.

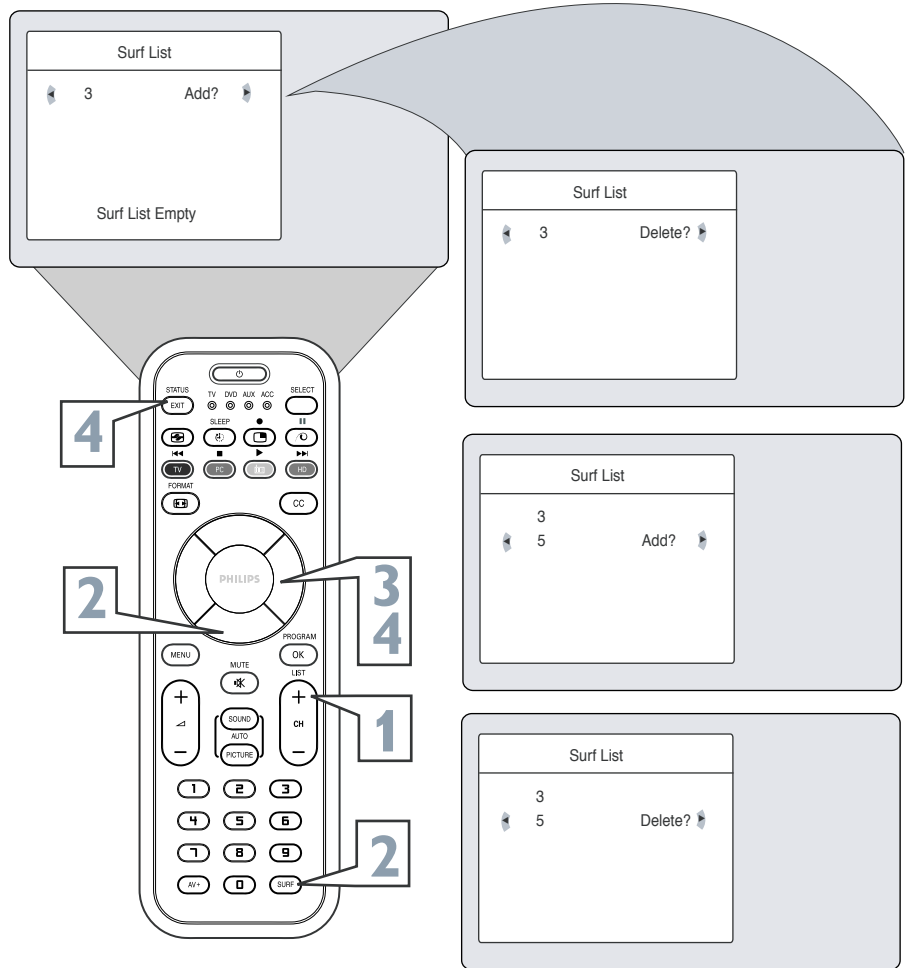



HOW TO USE THE AUTO PICTURE™ CONTROL

Whether you're watching a movie or a video game, your TV has automatic video control settings that will match with your current program source or content. AutoPicture™ quickly resets your TV's video controls for a number of different types of programs and viewing conditions that you may have in your home. The Movies, Sports, Weak Signal, and Multimedia AutoPicture™ controls have been preset at the factory to automatically adjust the TV's brightness, color, picture, sharpness, tint, and color temperature levels. The Personal AutoPicture™ settings are the ones that you made through the PICTURE options within the onscreen menu

- 1 Press the **PICTURE** button on the remote control. The current AutoPicture™ setting will appear in the middle of the screen.
- 2 Press the **PICTURE** button repeatedly to select either Personal, Movies, Sports, Weak Signal, or Multimedia picture settings.

NOTE: The Personal setting and the Picture options within the onscreen menu are the same. This is the only option in AutoPicture™ that can be changed. To adjust these settings, use the Picture options within the onscreen menu. All other settings are set up at the factory during production and cannot be adjusted.

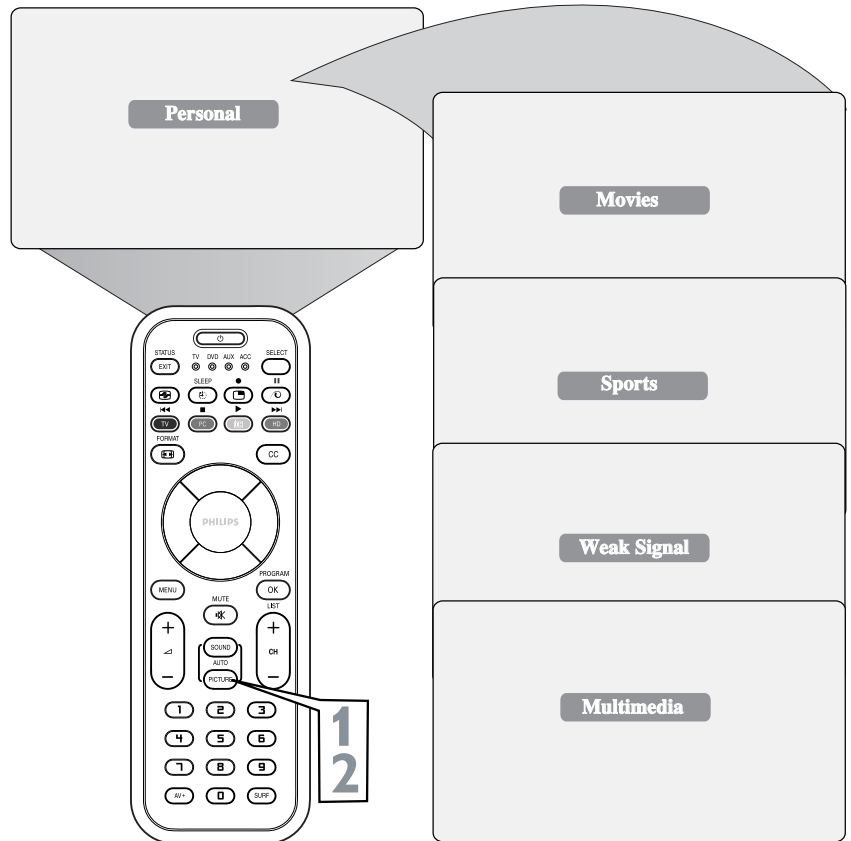

HOW TO USE THE AUTO SOUND™ CONTROL

AutoSound™ allows you to select from three factory-set controls and a personal control that you set according to your own preferences through the onscreen Sound menu. The three factory-set controls (Voice, Music, and Theatre) enable you to tailor the TV sound so as to enhance the particular program you are watching. Follow these steps to select any of the options.

- 1 Press the **SOUND** button on the remote control. The current AutoSound™ setting will appear in the middle of the screen.
- 2 Press the **SOUND** button repeatedly to toggle among the four settings: Personal, Voice, Music, or Theatre.

Remember, only the Personal control can be changed by the viewer. This changes the settings in the main onscreen menu's Sound controls

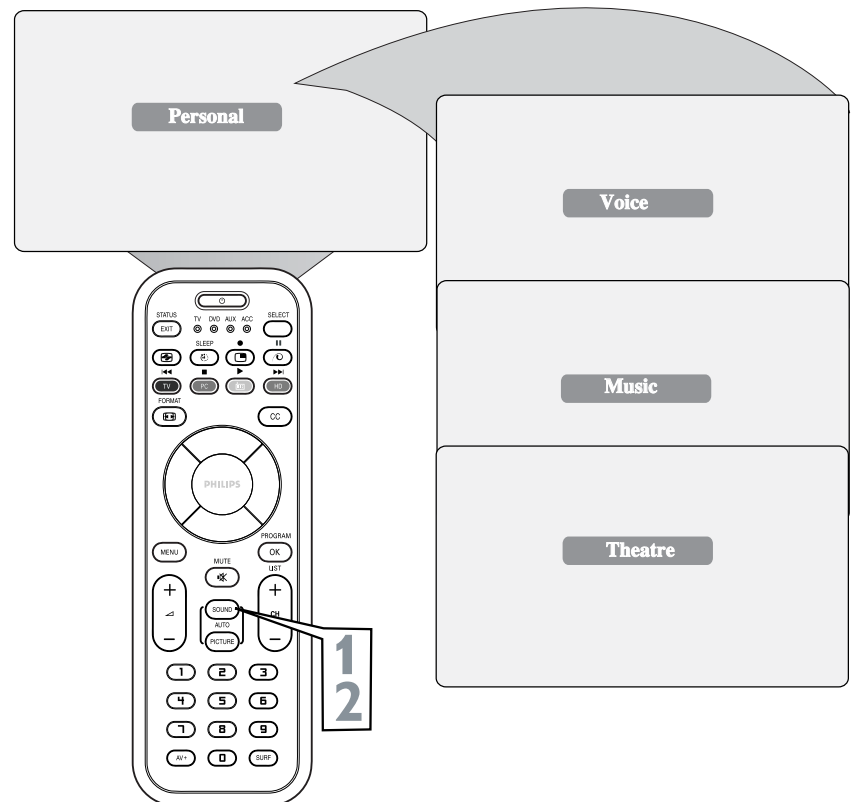

HELPFUL HINT

AutoSound™ works only with the programs coming through the ANTENNA/CABLE (ANT) input on the rear of the TV (RF audio). It will not control the sound levels for the external connections.



Your remote control is set to work your TV and many infrared remote (IR) control VCRs, Cable Boxes, Satellite Systems, DBS, DVD, etc. However, an easy onetime step may be necessary before the remote will work your VCR.

Try this initial Direct Access Method to see if going on to the following section is necessary.

1 Place the TV/DVD/AUX/ACC SELECT button to select the desired mode.

2 Point the remote control at the device and press the POWER button.

Does the remote turn the device ON?

If YES, stop and try other function buttons on the remote. If they also work the device, then the remote is ready and no further steps are needed.

If NO, continue...

3 First look up a **FOUR-DIGIT remote control number** for your brand of Device before going through the simple steps on the following page.

Find your Four-Digit Code on pages 30-32.

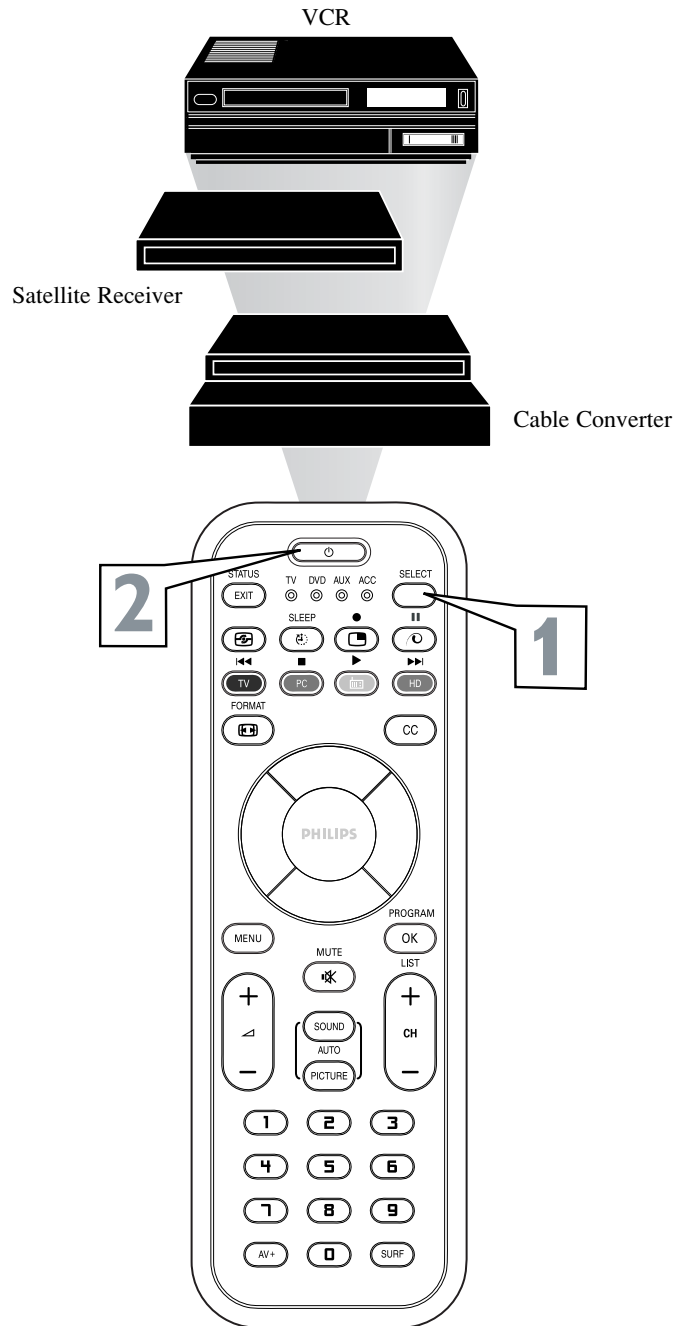

HELPFUL HINT

If more than one number is listed, you may have to try more than the first Four-Digit code given in order to locate your Device's remote code.

NOTE: Setting up the remote is for use with external accessory devices only and not for use with other television brands.



REMOTE CONTROL USE WITH ACCESSORY DEVICES - CODE ENTRY METHOD

Now that you have looked up the three-digit Remote Code Number for your brand of device, you are ready to follow the four simple steps below.

Please read through steps 1-4 before beginning.

- 1** Press the **TV/DVD/AUX/ACC SELECT** button repeatedly to select the desired mode.
- 2** Press the **RECORD** button on the remote control and release.
- 3** Press the **AUTO SOUND** button on the remote within 30 seconds, then release.
- 4** Enter the **FOUR-DIGIT REMOTE CODE NUMBER** (page 30-32) for your desired device. The remote is now ready to send commands to the unit.
- 5** Point the remote at the Device. Press the **POWER** button on the remote to turn the unit ON. If this works you are finished. If it does not work the first time, repeat the steps using a different remote code number.

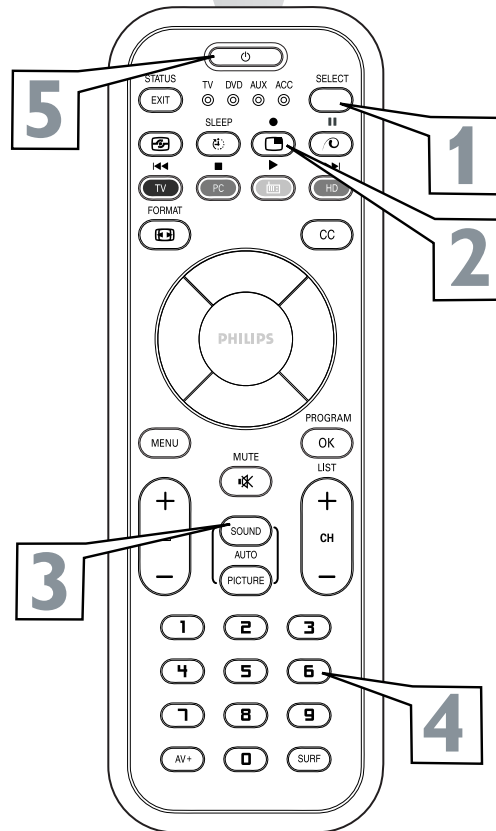
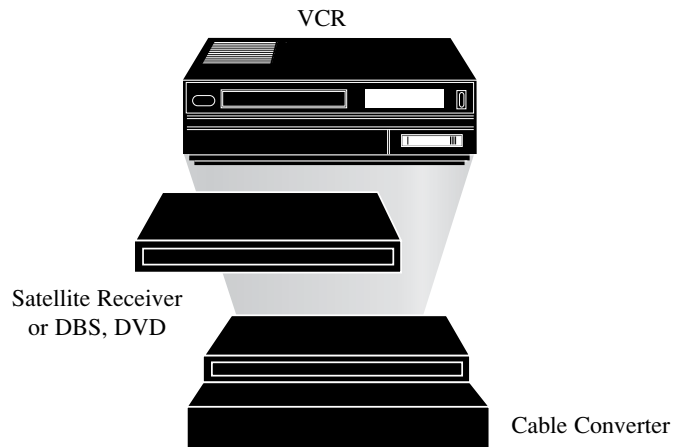

HELPFUL HINT

After a second try and the remote does not operate your device, see if there is another four-digit code number (pages 30-32) listed for your device and repeat the steps above using the new number.

If after repeated attempts the code number method does not work you device, try the **SEARCH METHOD** on the next page.

NOTE: Setting up the remote is for use with external accessory devices only and not for use with other television brands.



Your TV remote can be set to work various external devices such as VCRs, Cable Boxes, Satellite Receivers, DBS, DVD, etc. by what is called the search method of remote control programming.

If the "Remote Code" number method shown on the previous page did not set your remote to work your external device, then follow the easy steps listed below.

Please read steps 1-4 before beginning.

- 1** Press the **POWER** button on the device your are attempting to program to turn it ON.
- 2** Press the **TV/DVD/AUX/ACC SELECT** button repeatedly to select the desired mode.
- 3** Press the **• RECORD** and the **AUTO SOUND** buttons **simultaneously** and hold them down. The remote will continue to send programming codes, one ever 1.5 seconds.
- 4** The device will begin to change channels after the remote identifies the correct code. When the channels start to change release the **• RECORD** and **AUTO SOUND** buttons. The remote should be ready to operate the device.

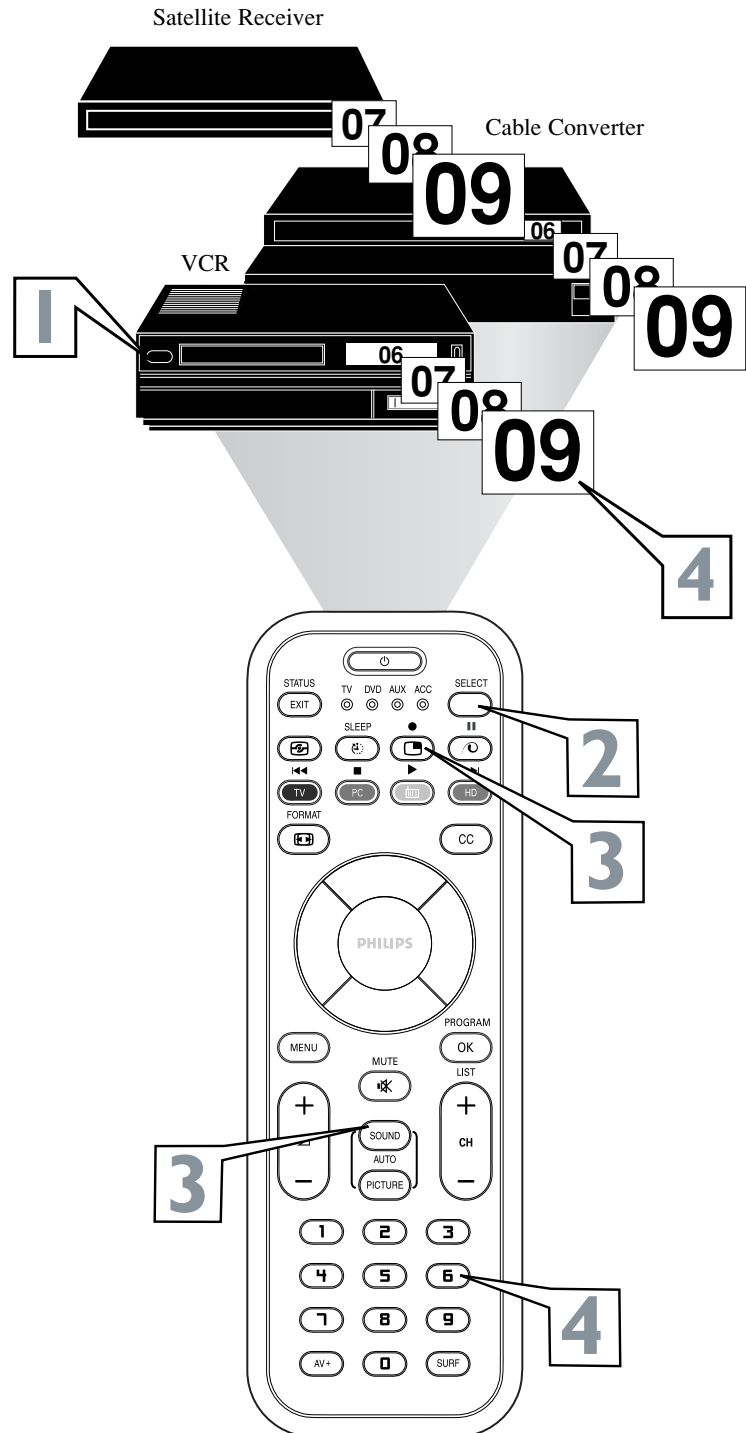

HELPFUL HINT

This method can take several minutes to perform.

Don't let the device scan up more than five channels. If you do the remote may pass up the right code and another search cycle will have to be repeated.

If no channel change happens within two minutes, repeat steps 1-4. Should a channel change still not occur, the remote will not work the desired device.

NOTE: Setting up the remote is for use with external accessory devices only and not for use with other television brands.



REMOTE CONTROL DIRECT ENTRY CODES

VCR CODES

Admiral	.2027, 2052	Electroponic	.2017	Lloyd's	.2001, 2051
Adventura	.2001	Emerex	.2012	Loewe	.2004, 2005, 2017, 2035
Aiko	.2059	Emerson	.2001, 2002, 2017, 2023, .2040, 2046, 2051, 2052, .2059, 2078, 2083	Logik	.2004, 2034, 2057
Aiwa	.2001, 2017, 2062, 2070, 2072	ESC	.2057, 2059	Luxor	.2023, 2025, 2027, 2037, 2038
Akai	.2021, 2029, 2038, 2060, 2063	Ferguson	.2021, 2039, 2064, 2065	LXI	.2017
Akiba	.2034	Fidelity	.2001	M Electronic	.2001
Alba	.2011, 2034, 2052, .2059, 2063, 2072	Finlandia	.2035, 2037	Magnasonic	.2059
Ambassador	.2011	Finlux	.2001, 2022, 2035, 2037	Magnavox	.2001, 2015, 2019, 2035
American Action	.2059	Firstline	.2017, 2023, 2024, 2034, 2052	Magnin	.2057
American High	.2015	Fisher	.2025, 2026, 2030, 2037	Manesth	.2024, 2034
Amstrad	.2001, 2059, 2067, 2068	Frontech	.2011	Marantz	.2003, 2005, 2015, 2035
Anam	.2017, 2042, 2054, .2057, 2059, 2082, 2084	Fuji	.2015	Marta	.2017
Anam National	.2042, 2054, 2087	Funai	.2001	Matsui	.2004, 2016, 2036, .2052, 2070, 2072
Anitech	.2034	Garrard	.2001	Matsushita	.2015, 2042, 2055
Asa	.2017, 2035	GE	.2015, 2027, 2032, 2057	Mei	.2015
Asha	.2057	GEC	.2035	Melectronic	.2018
Asuka	.2017	General	.2011	Memorex	.2001, 2015, 2017, 2019, .2025, 2026, 2027, 2037, 2052, .2057, 2062, 2085, 2087, 2088
Audiovox	.2017	Go Video	.2077, 2081	Memphis	.2034
Baird	.2001, 2021, 2037, 2039	Goldhand	.2034	Metz	.2003, 2005, 2017, .2042, 2048, 2055, 2069
Basic Line	.2011, 2034, 2059	Goldstar	.2017, 2018, 2053, 2079	MGA	.2023, 2057
Beaumarck	.2057	Goodmans	2001, 2017, 2034, 2059, 2075	MGN Technology	.2057
Bell & Howell	.2037	Gradiente	.2001, 2008	Mincrva	.2048
Blaupunkt	.2003, 2005, 2010, 2014, .2041, 2042, 2048, 2054, 2055, 2075	Graetz	.2005, 2021, 2037, 2057	Minerva	.2005, 2010, 2048
Brandt	.2047, 2064, 2065	Granada	.2025, 2035, 2037	Minolta	.2022
Brandt Electronic	.2021	Grandin	.2001, 2017, 2034	Mitsubishi	2023, 2027, 2033, 2035, 2045
Broksonic	2002, 2040, 2046, 2052, 2078	Grundig	.2003, 2005, 2007, 2010, .2034, 2035, 2048, 2050, .2054, 2069, 2071, 2075	Motorola	.2015, 2027
Bush	.2034, 2052, 2059, 2072	Hanseatic	.2017	MTC	.2001, 2057
Calix	.2017	Harley Davidson	.2001	Multitech	.2001, 2034
Canon	.2015	Harman/Kardon	.2018, 2035	Murphy	.2001
Capehart	.2011	Harwood	.2034	NAD	.2031
Carver	.2035	HCM	.2034	National	.2054
Catron	.2011	Headquarter	.2025	NEC	.2018, 2020, 2021, 2033, 2037
CCE	.2034, 2059	Hinari	.2004, 2034, 2057, 2072	Neckermann	.2035
CGE	.2001	Hi-Q	.2026	Nesco	.2034
Cimline	.2034	Hitachi	.2001, 2004, 2021, .2022, 2043, 2057	Nikko	.2017
Cineral	.2059	Hughes Network Systems	.2022	Nikon	.2014
Citizen	.2017, 2059	Hypson	.2034	Noblex	.2057
Clatronic	.2011	Imperial	.2001	Nokia	.2025, 2037, 2038, 2057
Colt	.2034	Ingersol	.2004	Nokia	.2021, 2025, 2037, 2038, 2057
Combitech	.2072	Interfunk	.2035	Nordmende	.2021, 2061, 2064, .2065, 2074
Condor	.2011	ITT	.2005, 2021, 2025, 2037, .2038, 2057, 2074	Oceanic	.2001, 2021
Craig	.2017, 2026, 2034, 2057, 2058	ITV	.2017, 2059	Okano	.2063, 2070
Crown	.2011, 2034, 2059	Jensen	.2021	Olympus	.2015, 2054
Curtis Mathes	.2015, 2021, 2032, 2042	JVC	.2008, 2021, 2033, 2049, .2050, 2074, 2080	Optimus	.2017, 2027, 2031, 2037, .2042, 2077, 2086, 2087, 2088
Cybernex	.2057	Kaisui	.2034	Orion	.2002, 2004, 2016, 2036, .2046, 2052, 2070, 2072, 2078
Cyrus	.2035	KEC	.2017, 2059	Osaki	.2001, 2017, 2034
Daewoo	.2011, 2024, 2025, 2059, 2083	Kendo	.2038, 2052	Otto Versand	.2035
Dansai	.2034	Kenwood	.2018, 2021, 2033	Palladium	.2005, 2017, 2021, 2034
Daytron	.2011	KLH	.2034	Panasonic	.2015, 2042, 2053, .2054, 2055, 2087
De Graaf	.2022, 2043	Kodak	.2015, 2017	Pathe Cinema	.2016
Decca	.2001, 2035	Korpel	.2034	Pathe Marconi	.2021
Denon	.2022	Layco	.2034	Penny	.2015, 2017, 2018, .2020, 2022, 2057
Dual	.2021	Lenco	.2059		
Dumont	.2001, 2035, 2037	LG	.2079		
Dynatech	.2001				
Elbe	.2018				
Elcotech	.2034				
Electrohome	.2017				

REMOTE CONTROL DIRECT ENTRY CODES



VCR CODES (continued)

Pentax	.2022	Sanky	.2019, 2027	TEC	.2011
Perdio	.2001	Sansui	.2001, 2021, 2033,	Technics	.2015, 2042, 2054
Philco	.2015, 2018, 2052, 2078		.2052, 2058, 2078	Teknika	.2001, 2015, 2007, 2017
Philips	.2015, 2035 (DEFAULT VCR),	Sanyo	.2025, 2026, 2037, 2057	Teleavia	.2021
	.2074, 2075	Saville	.2072	Telefunken	2021, 2047, 2058, 2064, 2074
Phonola	.2035	SBR 2035		Tenosal	.2034
Pilot	.2017	Schaub Lorenz	.2001, 2005, 2021, 2037	Tensai	.2001, 2066
Pioneer	.2031, 2033, 2035	Schneider	.2001, 2034, 2035	Thomas	.2001
Portland	.2011	Scott	.2023, 2024, 2040, 2046	Thomson	.2021, 2064, 2074
Profex	.2066	Sears	.2001, 2015, 2017,	Thorn	.2016, 2021, 2037
Profitronic	.2057		.2022, 2025, 2026, 2037	TMK	.2051, 2057
Proline	.2001	SEG	.2057, 2066	Toshiba	.2021, 2023, 2024, 2035, 2074
Proscan	.2032	SEI	.2004, 2035	Totelevision	.2017, 2057
Protec	.2034	Seleco	.2021	Towada	.2066
Pulsar	.2019	Semp	.2024	Uher	.2057
Pye	.2035	Sentra	.2011	Unitech	.2057
Quarter	.2025	Sharp	.2027, 2073	Universum	.2001, 2006, 2010, 2017,
Quartz	.2025	Shintom	.2034, 2037		.2035, 2038, 2048, 2057, 2067
Quasar	.2015, 2042, 2087	Shogun	.2057	Vector	.2024
Quelle	.2035	Shorai	.2004	Vector Research	.2018, 2020
Radio Shack	.2001, 2085	Silva	.2017	Victor	.2008, 2021, 2033
Radiola	.2035	Singer	.2024, 2034	Video Concepts	.2020, 2024
Radix	.2017	Sinudyne	.2004, 2035	Videosonic	.2057
RCA 2015, 2022, 2027, 2032, 2038, 2057		Solavox	.2011	Wards	.2001, 2015, 2022, 2026,
Realistic	.2001, 2015, 2017,	Sonorlor	.2025		.2027, 2032, 2034, 2035, 2057
	.2025, 2026, 2027, 2037	Sontec	.2017	White Westinghouse	.2052, 2059
REX	.2021, 2074	Sony	.2001, 2012, 2013, 2014, 2015	XR-1000	.2001
RFT	.2075	STS	.2022	XR-1001	.2015
Ricoh	.2014	Sunkai	.2070	XR-1002	.2034
Roadstar	.2017, 2034, 2057, 2059	Sunstar	.2001	Yamaha	.2018
Runco	.2019	Suntronic	.2001	Yamishi	.2034
Saba	.2021, 2049, 2050, 2061, 2	Sylvania	.2001, 2015, 2023, 2035	Yokan	.2034
	.064, 2065, 2074	Symphonic	.2001	Yoko	.2011, 2057
Saisho	.2004, 2016, 2036, 2052	Tashiko	.2001	Zenith	.2001, 2014, 2019, 2052, 2078
Salora	.2023, 2025, 2038	Tatung	.2001, 2021, 2035		
Samsung	.2024, 2057, 2076, 2077	Teac	.2001, 2021		

DIGITAL VIDEO DISC CODES

Akai	.5316	Panasonic	.5301, 5322	Sony	.5306
Harman/Kardon	.5314	Philips	.5302, 5308 (DEFAULT DVD)	Technics	.5301
JVC	.5311, 5318	Pioneer	.5305, 5312, 5321	Theta Digital	.5312
Kenwood	.5307	Proscan	.5304	Thomson	.5310
Magnavox	.5302	RCA	.5304	Toshiba	.5302
Mitsubishi	.5303	Samsung	.5313	Yamaha	.5301, 5309
Onkyo	.5302, 5317, 5319	Sharp	.5320		

CABLE CODES

ABC	.3002, 3003, 3004, 3006, 3008	Decsat	.3027	Jerrold	.3002, 3004, 3005, 3006,
Andover	.3037	Everquesst	.3007		.3007, 3020, 3031, 3046
Bell & Howell	.3006	Filmnet	.3028	LG Alps	.3044
Birmingham Cable Communication	.3020	France Telecom	.3030	Memorex	.3001
British Telecom	.3002, 3012	GEC	.3011	Mnet	.3009, 3028
Cabletime	.3016, 3019, 3025, 3029	Gemini	.3007	Now	.3041
Clyde	.3011	General Instrument	.3004, 3020,	Oak	.3009
Contec	.3009		.3031, 3046	Pacific	.3039
Cryptovision	.3038	Goldstar	.3014, 3047	Panasonic	.3001, 3013
Daehan	.3043	Grundig	.3035	Paragon	.3001
Daeryung	.3003	Hitachi	.3004	Pioneer	.3014, 3036
		Jasco	.3007	Pulsar	.3001



REMOTE CONTROL DIRECT ENTRY CODES

CABLE CODES (continued)

PVP Stereo Visual Matrix	.3002	Signal	.3007	Toshiba	.3001
Quasar	.3001	Signature	.3004	Tudi	.3023
Radio Shack	.3007	Starcom	.3002, 3007	Tusa	.3007
Rembrandt	.3004	Stargate	.3007	United Cable	.3002
Runco	.3001	Starquest	.3007	Videoway	.3017
Salora	.3026	STS	.3015	Visicable+	.3033
Samsung	.3014, 3040	Taihan	.3043	Westminster	.3012
Satbox	.3024	Tele+1	.3028	Wolsey Gene	.3037
Scientific	.3003, 3032, 3049	Teleservice	.3022	Zenith	.3001, 3034
Scientific Atlanta	.3003, 3008, 3021	Tocom	.3005		
Seawoo	.3045	Tongkook 3	.042, 3048		

SATELLITE CODES

Absat	.4006	Grundig	.4008, 4010, 4048	Pioneer	.4021, 4059
Alba	.4029, 4034, 4037, 4052	G-sat	.4009	Planet	.4061
Aldes	.4019	Hinari	.4009	Promax	.4037
Amstrad	.4003, 4016, 4025, .4038, 4039, 4042	Hirschmann	.4008, 4032, 4039, .4040, 4049	Prosat	.4019
Ankard	.4013, 4019, 4030, 4044	Hitachi	.4037	Quadral	.4029, 4044
Anttron	.4009, 4034	Houston	.4053	Radiola	.4011
Armstrong	.4015	Huth	.4013, 4015, 4019, 4026	Radix	.4031, 4064
AST	.4027	Intervision	.4050	RFT	.4011, 4013, 4019
Astra	.4005	Invideo	.4061	Saba	.4023, 4045
Astro	.4008, 4039, 4045	ITT	.4005	Sabre	.4037
Avalon	.4031	Johansson	.4022	Sagem	.4056
Axis	.4030, 4046	JVC	.4048	Salora	.4005
Beko	.4010	Kathrein	.4004, 4006, 4008, .4011, 4035, 4041	SAT	.4027, 4038
Best	.4030	Kreiselmeier	.4008	Satcom	.4026, 4051
Blaupunkt	.4008	Kyostar	.4034	Satec	.4009
Boca	.4015, 4043	La Sat	.4043, 4045	Satmaster	.4026
Brain Wave	.4022	Lenco	.4034	Satpartner	.4022, 4034, 4040, 4045
British Sky Broadcasting	.4058	Lennox	.4050	Schwaiger	.4009, 4041
BT	.4053	Lupus	.4030	Seemann	.4031, 4046
Bush	.4002	Luxor	.4005, 4049	SEG	.4030, 4034
Cambridge	.4024	Manhattan	.4037, 4045, 4050	Siemens	.4008
Canal Satellite	.4059	Marantz	.4011	Skymaster	.4019, 4044, 4051
Canal+	.4059	Maspro	.4004, 4023	Sony	.4017, 4018
Channel Master	.4029	Matsui	.4024, 4048	Strong	.4062
CNT	.4045	Mediamarkt	.4015	Sunstar	.4043
Comlink	.4019	Mediasat	.4059	Tantec	.4023, 4037
Connexions	.4031	Minerva	.4048	Techniland	.4026
Crown	.4015	Morgan's	.4015, 4043	Technisat	.4001, 4039
Cyrus	.4011	Navex	.4022	Telefunken	.4034
D-Box	.4054	Neuhaus	.4039	Teleka	.4015, 4052
DDC	.4029	Neusat	.4057	Telesat	.4051
DNT	.4011, 4031	Newhaus	.4013	Thomson	.4037, 4059
Echostar	.4031, 4036, 4061	Nokia	.4005, 4032, 4037, .4049, 4054, 4063	Tonna	.4026, 4053
Emanon	.4034	Nordmende	.4029	TPS	.4056
Ferguson	.4002, 4009, 4010, 4023	Orbitech	.4039	Triad	.4027
Fidelity	.4016	Oxford	.4024	Triasat	.4040
Finlux	.4005, 4024, 4032, 4037	Pace	.4002, 4009, 4014, 4023, .4037, 4055, 4058	Unitor	.4022
Fracarro	.4061	Palladium	.4048	Universum	.4008, 4049
Freecom	.4034	Palsat	.4039	Ventana	.4011
FTE Humax	.4060	Panda	.4037	Vortec	.4034
Fube	.4030, 4031, 4034	Philips	.4007, 4011, 4020, .4037, 4048, 4059	Vtech	.4027
Galaxis	.4019, 4057, 4060	Phonotrend	.4019, 4050	Winersat	.4022
General Instrument	.4012			Wisi	.4008, 4027, 4031, 4037
Gold Box	.4059			Xcom Multimedia	.4065
Gooding	.4048			Xsat	.4006, 4065
Goodmans	.4010			Zehnder	.4033, 4045

REMOTE CONTROL ACCESSORY DEVICE RELATED BUTTONS



When using the TV remote with an accessory device, first make certain it is set to control your accessory device (by the REMOTE CODE or SEARCH method).

- 1** Set the TV/DVD/AUX/ACC select button and select the desired mode.
- 2** Point the top of the remote toward the front of the accessory device (remote sensor window) when pressing the buttons.

POWER BUTTON

Press to turn the accessory device ON and OFF.

RECORD • BUTTON

Hold the VCR • RECORD button down to begin a VCR recording.

REWIND BUTTON ◀◀

Press to rewind tapes. For some VCR's the STOP button may have to be pressed first, then REWIND. May be used to scan back through chapters or titles on DVD movies.

STOP BUTTON ■

Press to stop the motion of a tape or to stop the playback of a DVD.

NUMBER BUTTON

Press buttons for direct channel selections. May also be used for direct number entries in certain onscreen menu feature settings.

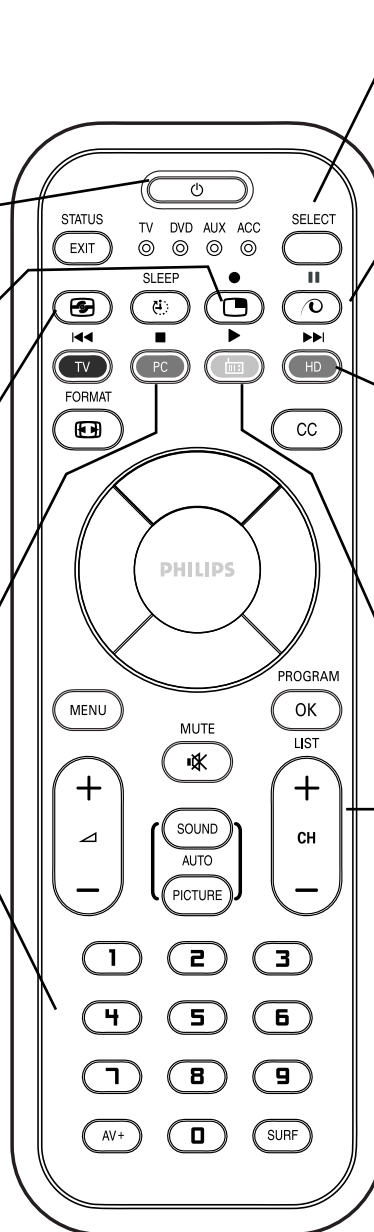

SELECT BUTTON

Select the correct mode to send remote commands to the accessory device. A light will appear above the selected mode.

PAUSE BUTTON ||

Press to temporarily stop the tape during a playback or recording or pause the playback of a DVD. Press again to release Pause.

FAST FORWARD BUTTON ▶▶

Press to rapidly advance a tape or DVD. For some accessory devices, you may need to press the STOP button first, then the FAST FORWARD button. In playback mode hold the button down to view the picture moving rapidly in the forward direction.

PLAY BUTTON ▶

Press to begin playback of a video tape, DVD, etc.

CHANNEL + / - BUTTONS

Press to scan up or down through the channel numbers if your accessory device will change channels.

HELPFUL HINT

The buttons on the remote will not operate your accessory device if those features are not found on your accessory's remote control.

Note: All functions (particularly Search, Rewind, Fast Forward, etc.) will operate the same as with the original remote control provided with your accessory device.



SETTING UP THE FM MODE (FM RADIO)

MODE SELECT CONTROLS

The Mode options allow you to move to other operating modes within the TV. When in the FM Radio Mode, choose from TV, PC, or HD Modes.

- 1** If in the FM Radio mode, press the **MENU** button on the remote control to display the FM Radio Mode onscreen menu.
- 2** Press the **CURSOR DOWN** button until **MODE SELECT** is highlighted.
- 3** Press the **CURSOR RIGHT** button to shift the menu to the left, accessing the Mode onscreen menu options.
- 4** Press the **CURSOR UP** or **DOWN** buttons to choose **TV**, **PC**, or **HD**.
TV - This will switch the TV back to the TV Mode of operation.
PC - This control will switch the TV to the PC Mode of operation. Note a PC signal must be present for this to work, or the TV will go into standby mode.
HD - This control will set the TV to the High Definition Mode.
- 5** Press the **CURSOR RIGHT** button to activate the selected control and change to the highlighted mode.
- 6** Press the **STATUS/EXIT** button to remove the onscreen menu from the TV screen when finished.

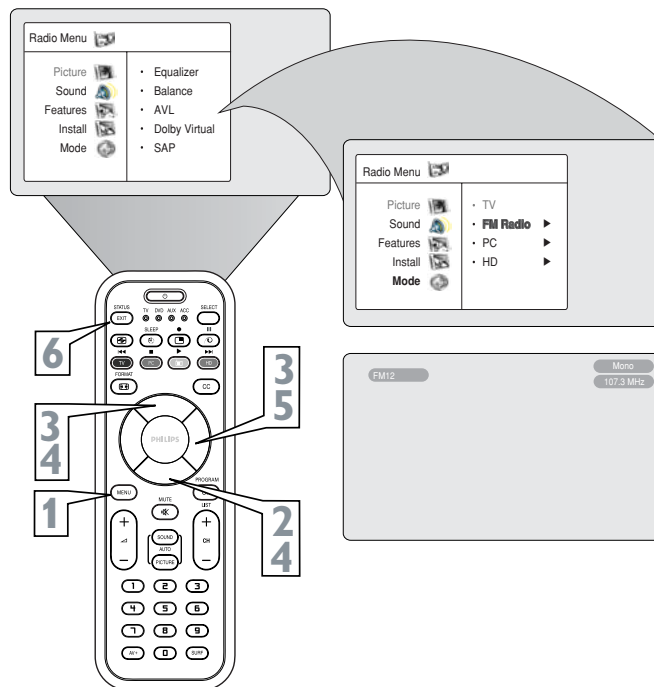

INSTALL CONTROLS

This TV also provides you with an FM Radio. An FM Radio signal must be connected to the FM Antenna 75Ω Jack located on the bottom of the TV.

- 1** To enter the FM Mode, press the **RADIO** button on the remote control. The FM Mode has its own onscreen menu options.
- 2** Press the **MENU** button on the remote control to display the FM Mode onscreen menu.
- 3** Press the **CURSOR UP** or **DOWN** buttons to scroll through the available FM Mode onscreen options. These options include: **Language**, **Auto Program**, or **Manual Program**.
LANGUAGE - Choose to view the onscreen menu in English, French or Spanish.
AUTO PROGRAM - The Auto Program control will search the FM antenna signal and store any FM channel it finds in the TV's memory.
MANUAL PROGRAM - This control will allow you to manually tune any available FM signals.
- 4** Press the **CURSOR RIGHT** button to adjust or select items within the highlighted feature sub-menu.
- 5** Press the **STATUS/EXIT** button to remove the onscreen menu from the TV screen when finished. Or, let the display time out and the menu will disappear after a few seconds.

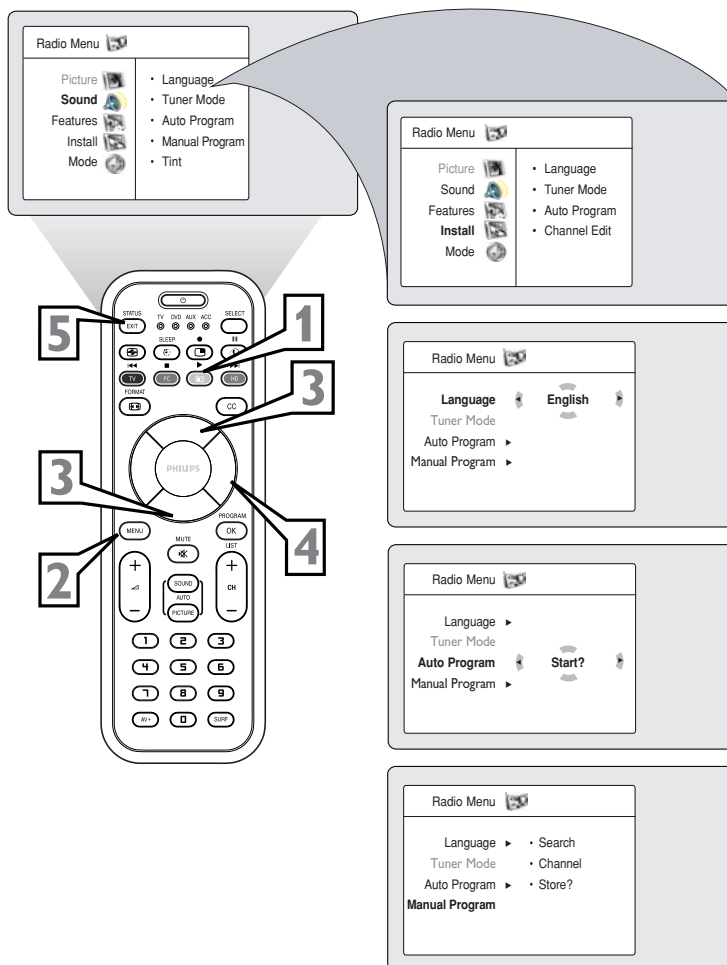



FM RADIO TIMER CONTROLS

Your TV or FM Radio comes with an onscreen clock. The FM Radio can also be set to turn on or off at a specific time and tune to a specific channel when it powers itself on.

- 1** Press the **MENU** button on the remote control to show the onscreen menu.
- 2** Press the **CURSOR DOWN** button to highlight **Features**.
- 3** Press the **CURSOR RIGHT** button to enter the **Features** menu.
- 4** Press the **CURSOR UP** or **CURSOR DOWN** button to highlight one of the **Timer** controls. These controls are **Time**, **Start Time**, **Stop Time**, **Program No.**, **Activate**, or **Display**.
- 5** Press the **CURSOR RIGHT** or **CURSOR LEFT** button to make adjustments or to toggle the On or Off options.
 - Time:** Enter the current time using the Numbered buttons. Use the **CURSOR RIGHT** to move to the AM/PM slot and use the **CURSOR LEFT** or **CURSOR RIGHT** buttons to toggle the AM and PM setting.
 - Start Time:** Use the numbered buttons to enter the time you want the TV to turn itself On. Use the **CURSOR RIGHT** and **CURSOR LEFT** buttons to toggle the AM and PM setting.
 - Stop Time:** Use the numbered buttons to enter the time you want the TV to turn itself Off. Use the **CURSOR RIGHT** and **CURSOR LEFT** buttons to toggle the AM and PM setting.
 - Program No.:** Use the **NUMBERED** buttons or the **CH +** or **CH -** buttons to enter the desired start-up channel. You can also press the **CURSOR RIGHT** or **CURSOR LEFT** buttons to enter the desired start-up channel.
 - Activate:** Set the timer to turn itself On (Once or Daily) or Off. Press the **CURSOR RIGHT** and **CURSOR LEFT** buttons to select Once, Daily, or Off.
 - Display:** Press the **CURSOR RIGHT** or **CURSOR LEFT** button to toggle between On or Off. If On is selected, the time will be displayed all the time when the TV is on. When Off is selected, the time will only appear when the **STATUS/EXIT** button is pressed.
- 6** Press the **STATUS/EXIT** button to remove the menu from the screen.

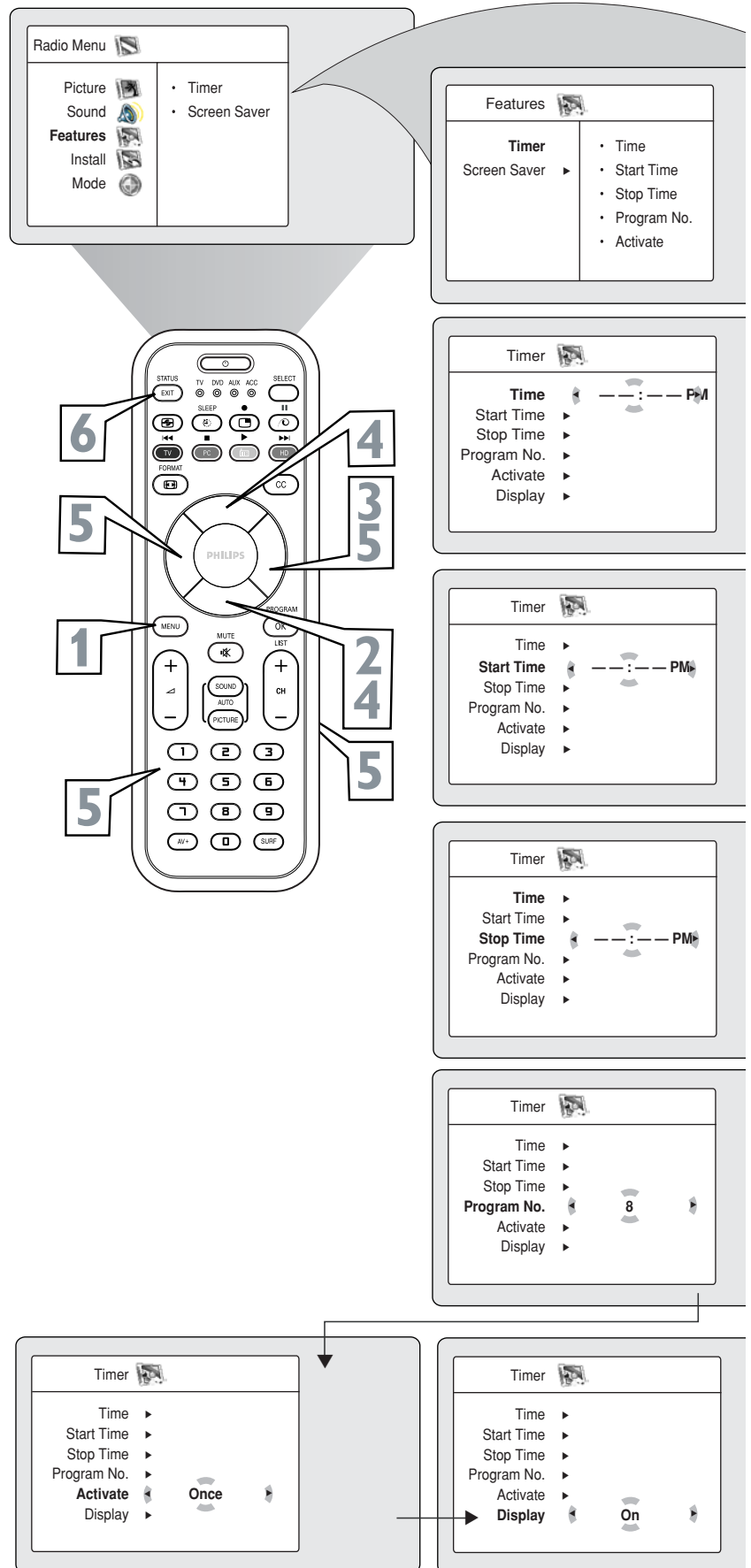



SETTING UP THE FM MODE (FM RADIO)

FM RADIO SOUND CONTROLS

To ensure the best sound quality from the FM Radio feature of this TV, several Sound Controls are available for adjustment.

- To enter the FM Mode, press the RADIO button** on the remote control. The FM Mode has its own onscreen menu options.
- Press the MENU button** on the remote control to display the FM Mode onscreen menu.
- Press the CURSOR DOWN button** until **SOUND** is highlighted
- Press the CURSOR RIGHT button** to shift menu to the left, accessing the **SOUND** onscreen menu options. These options include : **EQUALIZER, BALANCE, AVL, DOLBY VIRTUAL** or **SOUND**.

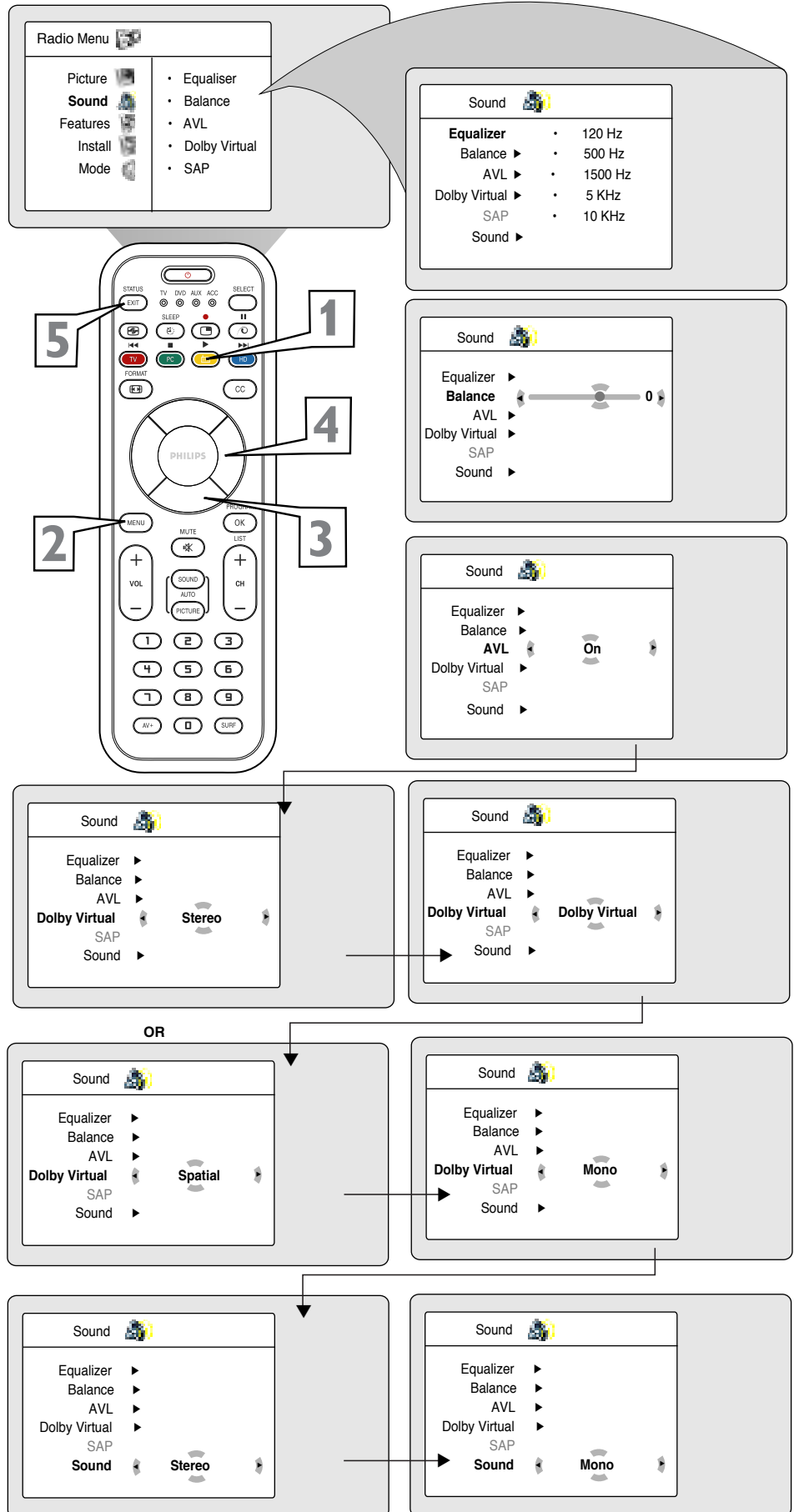

EQUALIZER - Allows the listener to change the sound frequencies to their liking.

BALANCE - This controls the sound level balance between the right and left TV speakers.

AVL - Automatic Volume Leveler, when ON, will keep the volume level at a consistent level should there be sudden peaks and valleys in sound levels during commercial breaks or channel changes.

DOLBY VIRTUAL - Adds greater depth and dimension to TV sound. Select from Dolby Virtual or Stereo (if Stereo) or Spatial or Mono (if Mono).

SOUND - Select Stereo or Mono. If the signal is being received in Mono, the Sound cannot be placed in Stereo.

- Press the STATUS/EXIT button** to exit the menu from the screen.

SETTING UP THE FM MODE (FM RADIO)



SCREENSAVER CONTROL

While in the FM Mode, there is a Screensaver option that can be used. The Screensaver control, when on, will circulate the screen station indication around the display.

- 1** If in the FM mode, press the MENU button on the remote control to display the FM Mode onscreen menu.
- 2** Press the CURSOR DOWN button until FEATURES is highlighted.
- 3** Press the CURSOR RIGHT button to shift the menu to the left. TIMER will be highlighted.
- 4** Press the CURSOR DOWN button until SCREENSAVER is highlighted.
- 5** Press the CURSOR RIGHT or LEFT button to toggle the Screensaver control ON or OFF.

With the Screensaver control set to ON, the display will shift around the screen pausing in one place for a brief moment.

- 6** Press the STATUS/EXIT button to remove the onscreen menu from the TV screen when finished. Or, let the display time out and the menu will disappear after a few second.

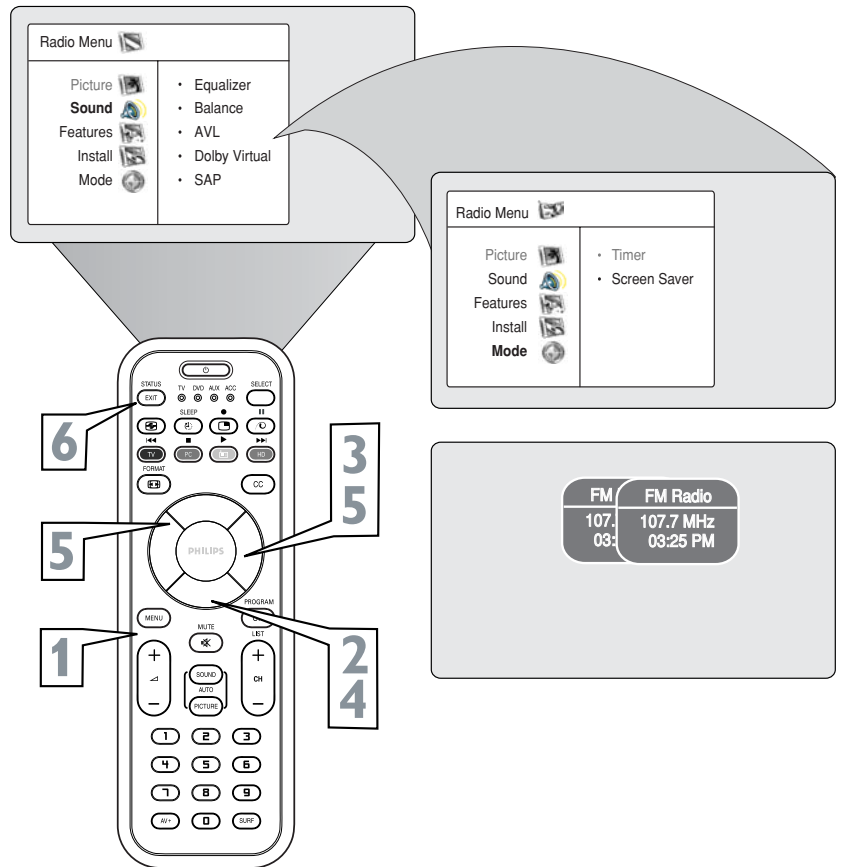

AUTO SOUND™ CONTROLS

AutoSound™ allows you to select from four factory-set controls and a personal control that you set according to your own preferences through the onscreen Sound menu within the FM Mode. The four factory-set controls (Classical, Jazz Pop, or Rock) enable you to tailor the sound so as to enhance the particular program you are listening to.

- 1** If in the FM mode, press the AUTO SOUND button on the remote control to display the first AutoSound™ option on the screen.
- 2** Press the AUTO SOUND button repeatedly to toggle through the factory pre-defined setting for the following musical styles: CLASSICAL, JAZZ, POP, ROCK or PERSONAL (the way you set the equalizer).

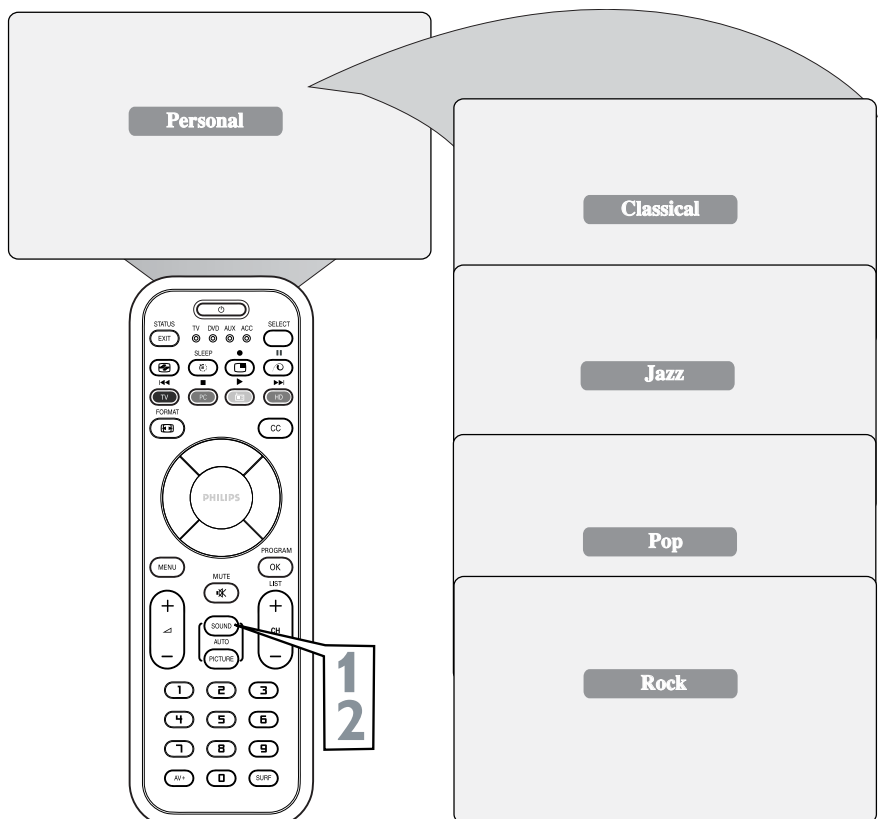



SETTING UP THE PC MODE (PERSONAL COMPUTER MONITOR)

PC PICTURE CONTROLS

To ensure the best picture quality from the PC feature of this TV, several Picture Controls are available for adjustment.

- 1** Press the **MENU** button on the remote control to display the Picture menu.
- 2** Press the **CURSOR RIGHT** button to access the **Picture** menu.
- 3** Press the **CURSOR UP** or **CURSOR DOWN** button repeatedly to select any of the picture items:
 Brightness- adds or subtracts light from the darkest part of the picture.
 Picture- improves the detail of the lightest parts of the picture.
 Horizontal- Allows you to adjust the horizontal placement of the image.
 Vertical- allows you to adjust the vertical placement of the image.
 Colour Temp.- Allows you to adjust the color temperature of the picture. Select from Normal, Cool, or Warm.
- 4** Once you have highlighted a selection, press the **CURSOR LEFT** or **CURSOR RIGHT** button to navigate, adjust, or activate the specific controls.
- 5** Press the **STATUS/EXIT** button to remove the onscreen menu from the TV screen when finished.

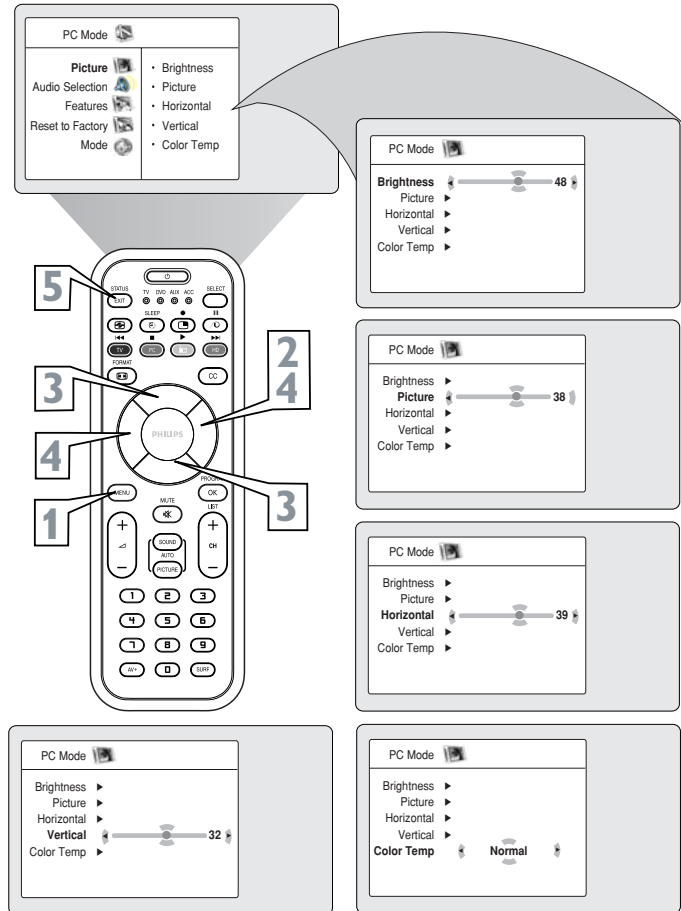

PC AUDIO SELECTION

This TV lets you choose the sound that is heard while in PC Mode. You can select TV, PC, or FM Radio. For example, you can listen to the radio while you use the computer.

NOTE: You must select the source before selecting PC. You cannot change the channel or station while in PC Mode. Also, you cannot listen to the radio when the PIP screen is displayed.

- 1** Press the **MENU** button on the remote control to display onscreen menu.
- 2** Press the **CURSOR DOWN** button repeatedly to highlight **Audio Selection**.
- 3** Press the **CURSOR LEFT** or **CURSOR RIGHT** button repeatedly to select **FM Radio**, **PC**, or **TV**.
- 4** Press the **STATUS/EXIT** button to remove the onscreen menu from the TV screen when finished.

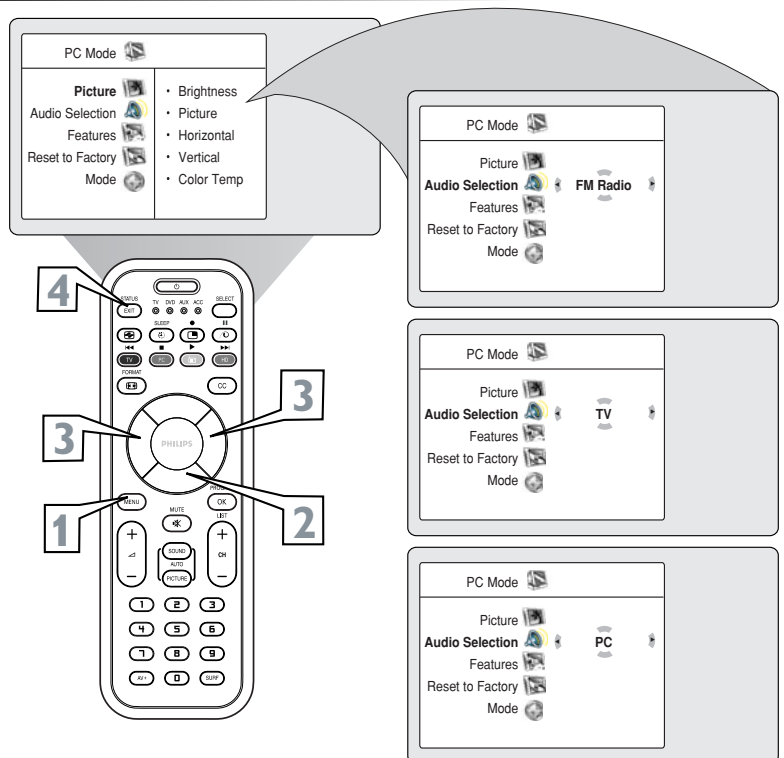

USING THE PC MODE (PERSONAL COMPUTER MONITOR)



PC FEATURES

- 1** Press the **MENU** button to the remote control to display menu.
- 2** Press the **CURSOR DOWN** button **REPEATEDLY** to highlight **FEAT-URES**.
- 3** Press the **CURSOR RIGHT** button to access the Features menu.
- 4** Press the **CURSOR UP and DOWN** buttons to access the items in the **Features** menu:
Phase – eliminates the horizontal interfering lines
Clock – eliminates the vertical interfering lines
Format – choose between Full Screen and the original format (Native) of the PC screen
PIP – call up a PIP window for TV, HD or FM Radio (refer to page 40 for more additional details).
Auto Adjustment – automatically adjusts the control based on the signal being received to give the best possible picture.
- 5** Press the **CURSOR LEFT** or **CURSOR RIGHT** button to make the desired adjustments.
- 6** Press the **STATUS/EXIT** button to exit the menu from the screen.

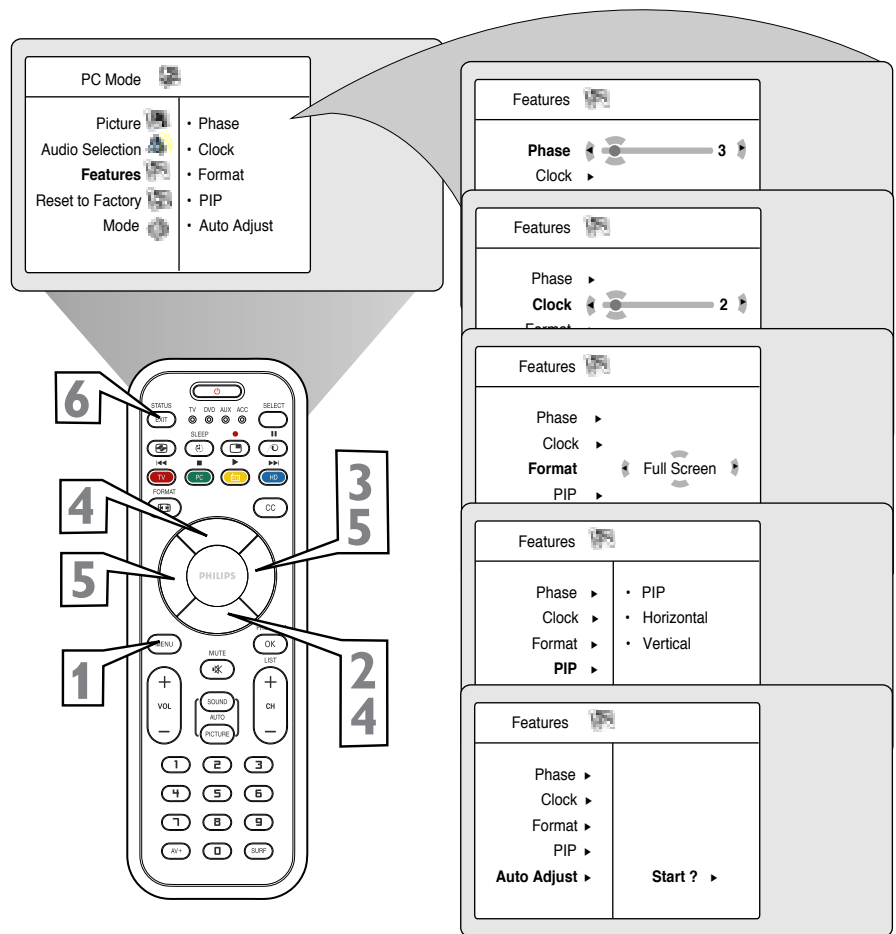

Before using the PIP feature configure the computer for optimum resolution (1024 x 768, 60Hz).

Note: if you select another resolution, the PIP feature may not work.

No.	Resolution	Refresh Rate
1	640 x 350	70 Hz
2		85 Hz
3	640 x 480	60 Hz
4		67 Hz
5		72 Hz
6		75 Hz
7		85 Hz

No.	Resolution	Refresh Rate
8	720 x 400	70 Hz
9		85 Hz
10	800 x 600	56 Hz
11		60 Hz
12		72 Hz
13		75 Hz
14		85 Hz
15	800 x 624	75 Hz

No.	Resolution	Refresh Rate
16	1024 x 768	60 Hz
17		70 Hz
18		75 Hz
19		85 Hz
20	1152 x 864	75 Hz
21	1280 x 960	60 Hz
22	1280 x 1024	60 Hz
23	1280 x 1024	75 Hz



SETTING UP THE PC MODE (PERSONAL COMPUTER MONITOR)

PC PIP CONTROLS

While in PC mode, you can bring up a PIP window for the TV, HD or FM Radio channel. For example, you can listen to the radio while you use the computer. For PIP to function, an accessory must be connected to the DVI Input (See Quick-Guide for connection). Press the PC button on the remote control repeatedly until PC-D appears in the top left hand corner of the screen.

- 1** Press the **MENU** button to access the PC Mode menu.
- 2** Press the **CURSOR DOWN** button repeatedly to highlight **PIP**.
- 3** Press the **CURSOR RIGHT** button to access **PIP** menu.
- 4** Press the **CURSOR LEFT** or **CURSOR RIGHT** buttons to select the PIP Size options : Off, On, Small, Medium, Large or Side-by-Side.
- 5** If you want to move the PIP screen horizontally. **press the CURSOR DOWN** button again to highlight Horizontal.
- 6** Press the **CURSOR LEFT** or **CURSOR RIGHT** buttons to move the picture horizontally.
- 7** If you want to move the PIP screen vertically or side-by-side. **press the CURSOR DOWN** button to highlight Vertical.
- 8** Press the **CURSOR LEFT** or **CURSOR RIGHT** buttons to move the picture vertically.
- 9** Press the **STATUS/EXIT** button to exit the menu from the screen.

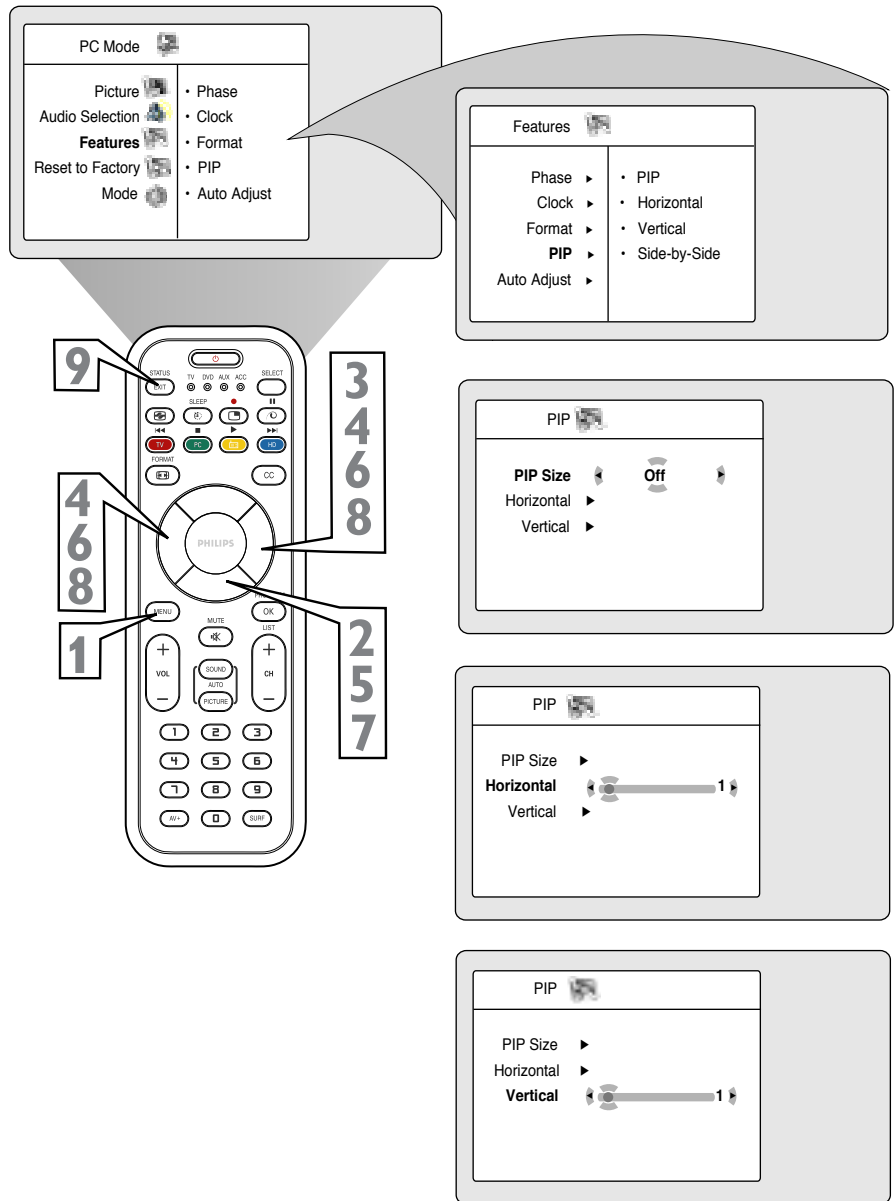

SETTING UP THE HD MODE (HIGH DEFINITION)



HD SELECT CONTROL

The HD Select Control will allow you to quickly change from the HD Mode of operation to the TV, FM Radio, or PC Modes.

- 1** If in the HD Mode, press the **MENU** button on the remote control to display the HD Mode onscreen menu. The **PICTURE** option will be highlighted.
- 2** Press the **CURSOR UP** or **DOWN** buttons until **Mode** is highlighted.
- 3** Press the **CURSOR RIGHT** button to highlight the **Mode** options. **TV** mode is highlighted.
- 4** Press the **CURSOR UP** or **DOWN** button to choose **TV**, **FM Radio** or **PC** mode.
- 5** Press the **CURSOR RIGHT** button to activate the highlighted mode control.

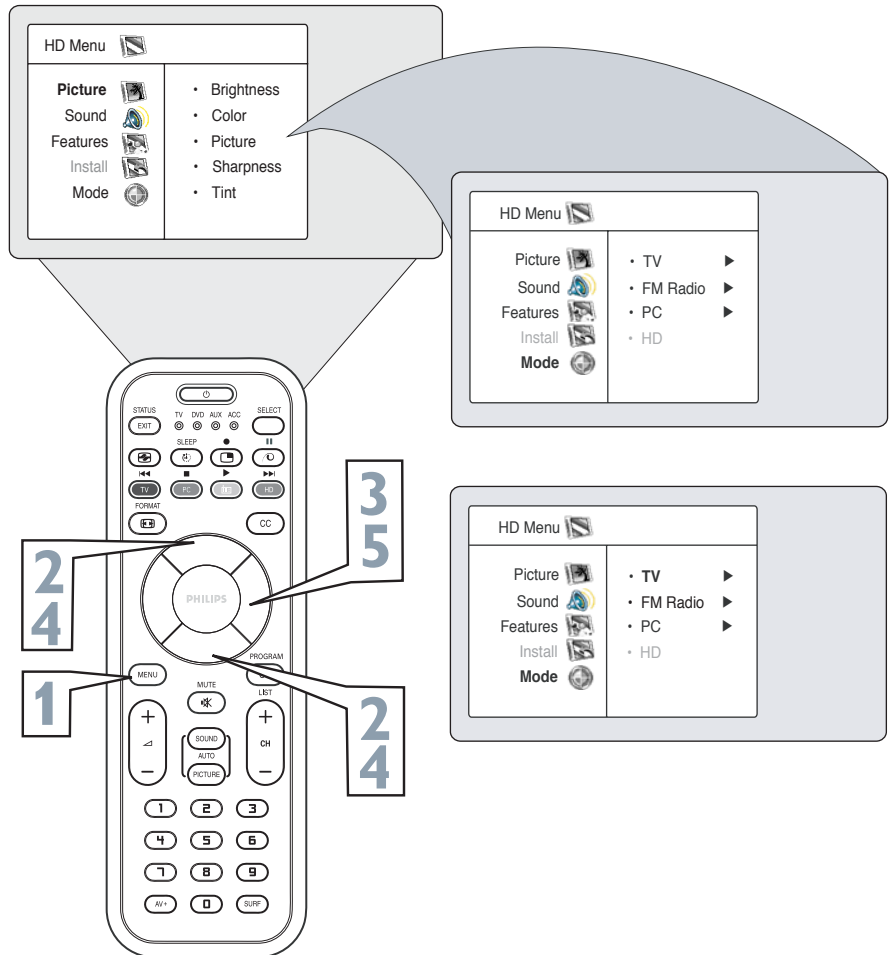



SETTING UP THE HD MODE (HIGH DEFINITION)

PICTURE CONTROLS

The HD Mode offers certain Picture, Sound and Blocking options within its onscreen menu. Below is a list of Picture Menu options.

- 1** Press the **HD** button on the remote control to place the TV in the HD Mode (HD1).
- 2** Press the **MENU** button on the remote control to display the HD Mode onscreen menu. The **PICTURE** option will be highlighted.
- 3** Press the **CURSOR DOWN** buttons until **Picture** is highlighted.
- 4** Press the **CURSOR RIGHT** button to shift the menu to the left, accessing the Picture onscreen menu options.
- 5** Press the **CURSOR UP** or **DOWN** buttons to highlight any of the HD Mode Picture Controls. Choose from: **BRIGHTNESS, COLOR, PICTURE, SHARPNESS, TINT, COLOR TEMP.**

BRIGHTNESS - This control will add or subtracts light from the darkest part of the picture.

COLOR - This control adds or eliminates color intensity from the picture.

PICTURE - This control improves the detail of the lightest parts of the picture.

SHARPNESS - This control improves the detail in the picture.

TINT - This control adjusts the picture to obtain natural skin tones.

COLOR TEMP - Choose from **NORMAL** (keeps whites, white), **COOL** (makes whites, bluish), or **WARM** (makes whites, reddish) picture preferences.

f

- 6** Press the **CURSOR RIGHT** or **LEFT** buttons to adjust the selected control.
- 7** Press the **STATUS/EXIT** button to remove the onscreen menu from the TV screen when finished. Or, let the display time out and the menu will disappear after a few second.

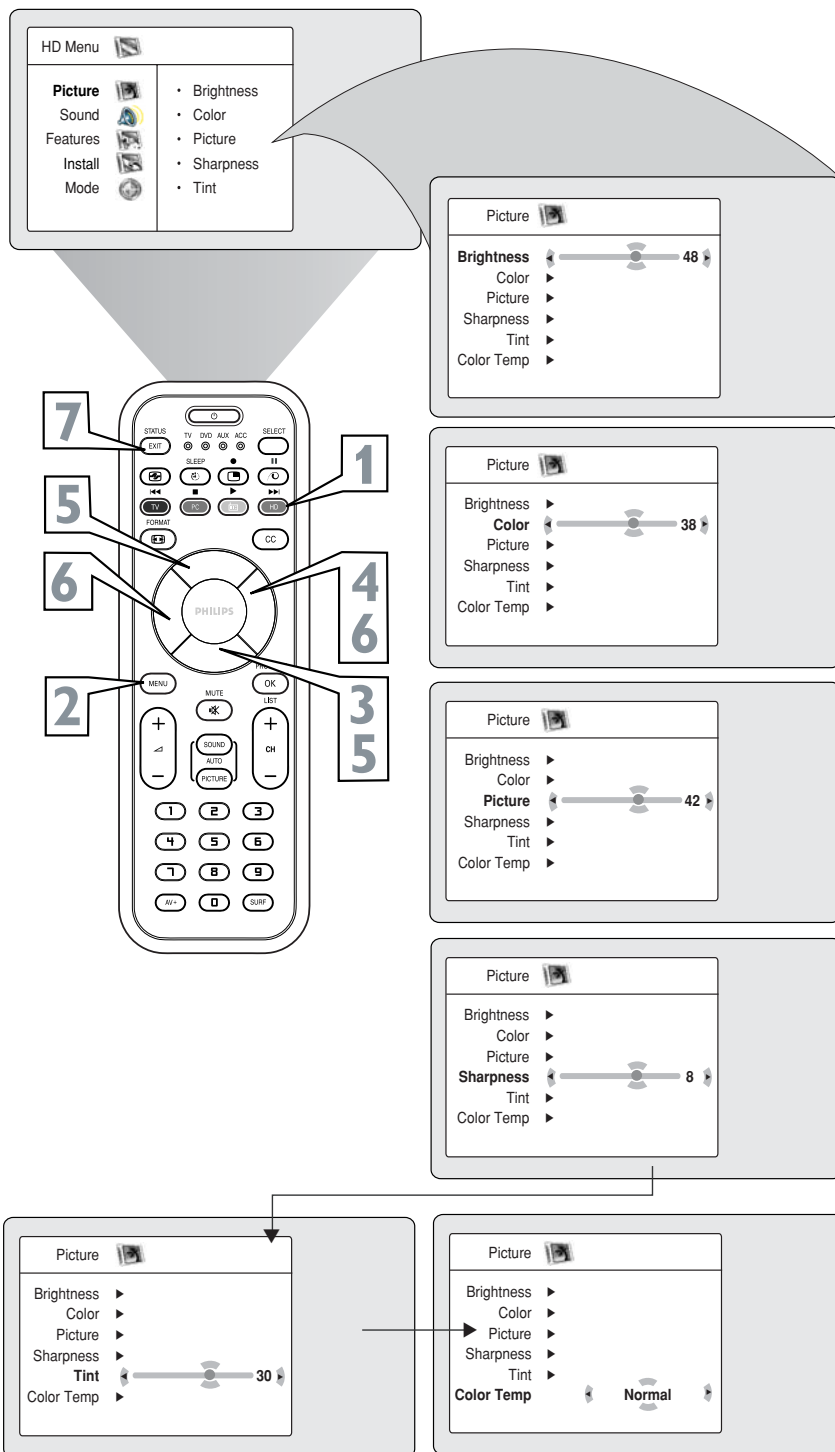

SETTING UP THE HD MODE (HIGH DEFINITION)



SOUND CONTROLS

The HD Mode also offers certain Sound control adjustments to fine tune the sound being heard when in the HD Mode.

- 1** Press the **HD** button on the remote control to place the TV in the HD Mode (HD1).
- 2** Press the **MENU** button on the remote control to display the HD Mode onscreen menu. The PICTURE option will be highlighted.
- 3** Press the **CURSOR DOWN** buttons until **Sound** is highlighted.
- 4** Press the **CURSOR RIGHT** button to shift the menu to the left, accessing the Sound menu options.
- 5** Press the **CURSOR UP** or **DOWN** buttons to highlight any of the HD Mode Sound Controls. Choose from: **EQUALIZER**, **BALANCE**, **AVL** or **DOLBY VIRTUAL**.

EQUALIZER - Allows the listener to change the sound frequencies to their liking.

BALANCE - This controls the sound level balance between the right and left TV speakers.

AVL - Automatic Volume Leveler, when ON, will keep the volume level at a consistent level should there be sudden peaks and valleys in sound levels during commercial breaks or channel changes.

DOLBY VIRTUAL - Adds greater depth and dimension to TV sound. Select from Dolby Virtual or Stereo (if Stereo) or Spatial or Mono (if Mono).

- 6** Press the **CURSOR RIGHT** or **LEFT** buttons to adjust the selected control.
- 7** Press the **STATUS/EXIT** button to remove the onscreen menu from the TV screen when finished. Or, let the display time out and the menu will disappear after a few second.

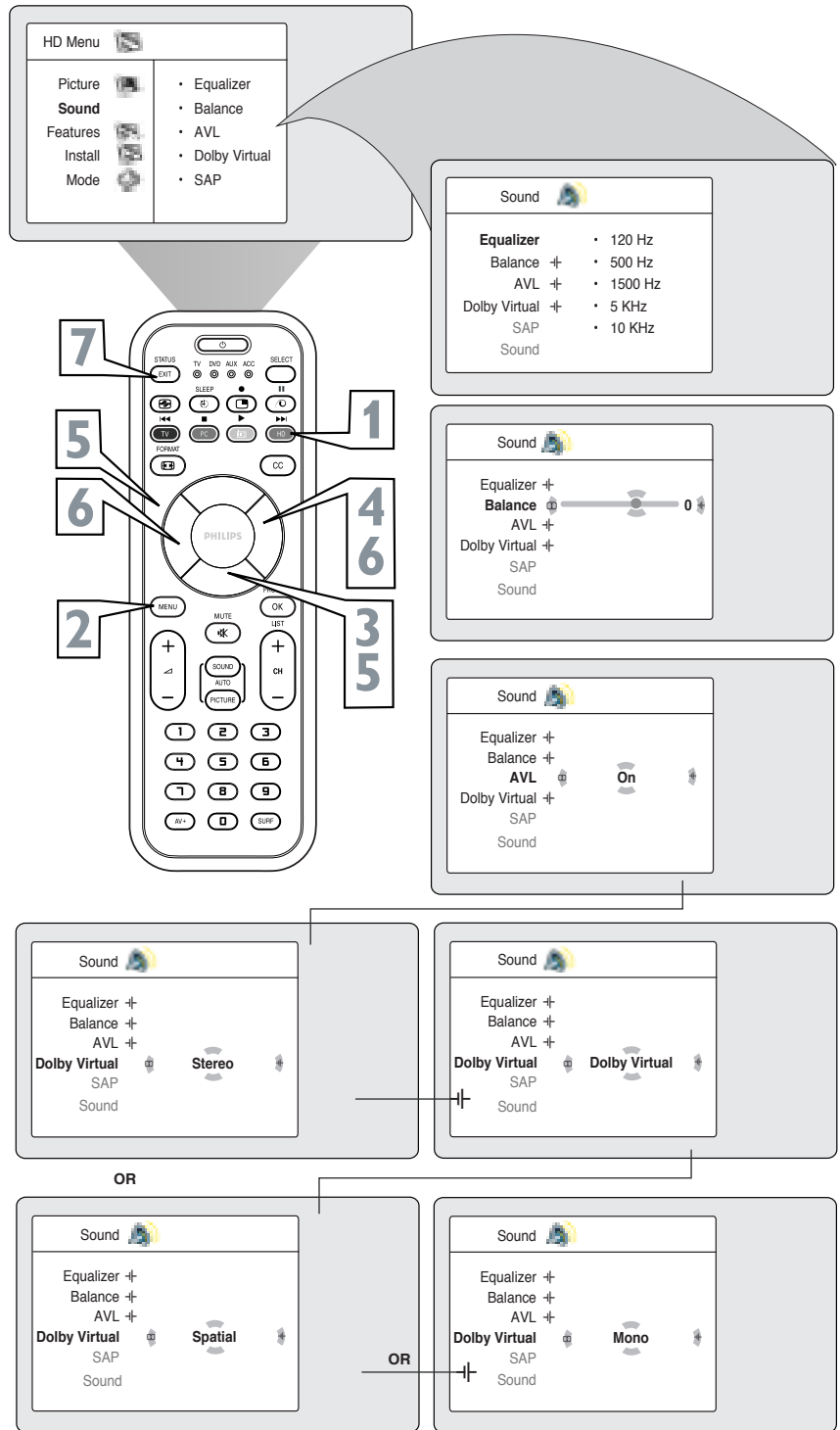



SETTING UP THE HD MODE (HIGH DEFINITION)

LOCK HD CHANNEL

The HD Mode channel can be blocked to censor the viewing of programming not suitable for children. To block the HD Mode channel, follow the steps below.

- 1** Press the **HD** button on the remote control to place the TV in the HD Mode (HD1).
- 2** Press the **MENU** button on the remote control to display the HD Mode onscreen menu. The PICTURE option will be highlighted.
- 3** Press the **CURSOR DOWN** buttons until **BLOCK CHANNEL** is highlighted.
- 4** Press the **NUMBERED** buttons and enter your four digit Access Code that was setup for the TV AutoLock feature. The Block Channel Control will be available for adjustment
- 5** Press the **CURSOR RIGHT** button to toggle the control ON or OFF. If set to ON, the HD1 channel (mode) will not allow viewing of programs. This control would have to be set to OFF to make the HD1 channel (mode) viewable.
- 6** Press the **STATUS/EXIT** button to remove the onscreen menu from the TV screen when finished.

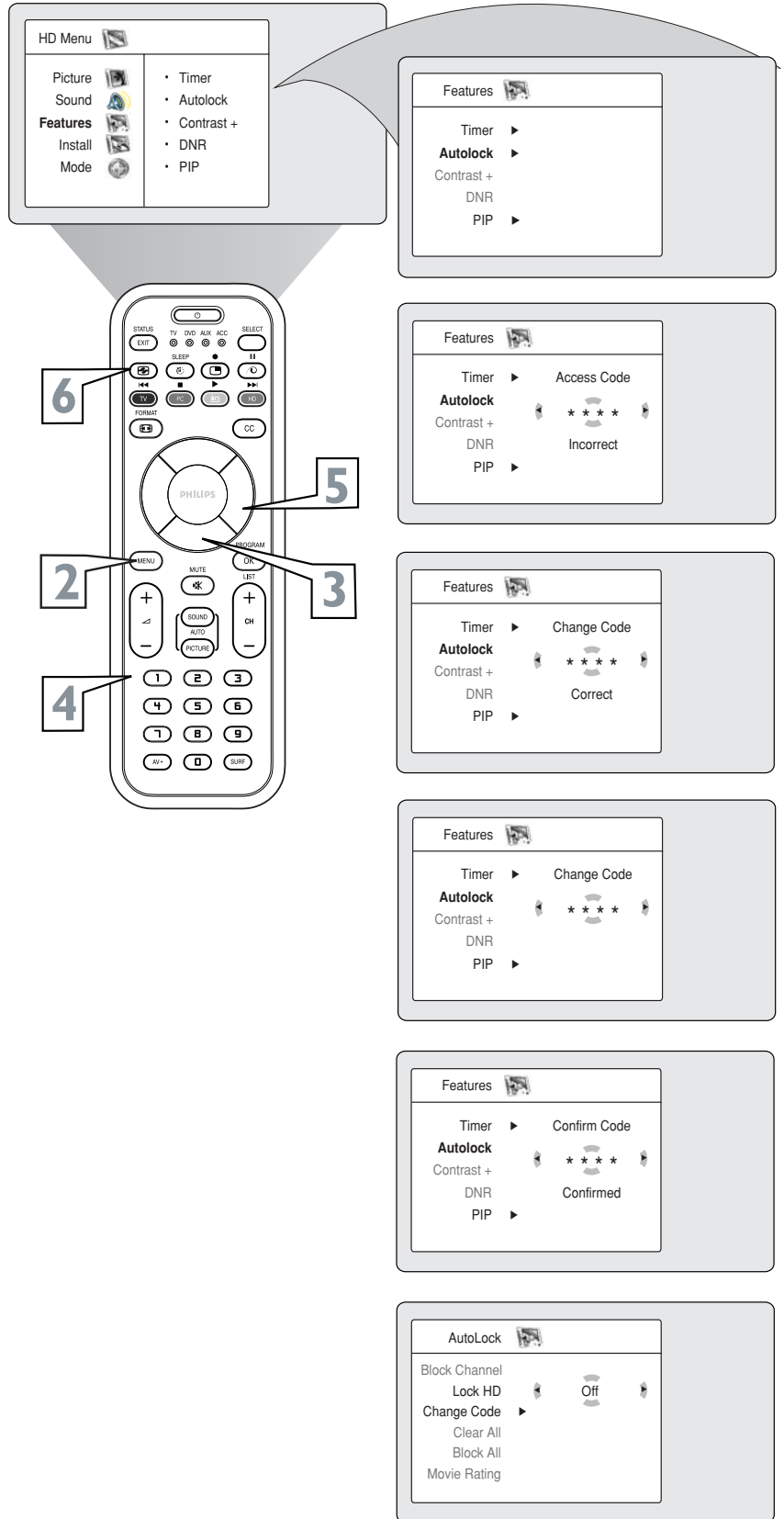



No Power

- Check the TV power cord. Unplug the TV, wait 10 seconds, then reinsert the plug into the outlet and push the POWER button again.
- Check that the outlet is not on a wall switch.
- Be sure the fuse is not blown on the AC power strip, if one is being used.

No Picture

- Check antenna/cable connections. Are they properly secured to the TV's ANT 75Ω plug?
- Check the TUNER MODE control for the correct tuner setting.
- Try running the Auto Program feature to find all available channels.
- Press the SOURCE button on the remote to make sure the correct signal source is selected.
- If using an accessory device, be sure that it is functioning properly.
- If in PC Mode, a video signal MUST BE present or the TV will turn off.

No Sound

- Check the VOLUME buttons.
- Check the MUTE button on the remote control.
- If you're attempting to hook up auxiliary equipment, check the audio jack connections.

TV Only Produces MONO Sound

- If using a cable box with RF only type connections, the signal coming from the cable box will be produced in MONO only.
- Check Sound control setting. Change setting to Stereo.

Remote Does Not Work

- Check the batteries. If necessary, replace them with AA Heavy Duty (Zinc Chloride) or Alkaline batteries.
- Clean the remote control and the remote control sensor window on the TV.
- Check the TV power cord. Unplug the TV, wait 10 seconds, then reinsert the plug into the outlet and push the POWER button again.
- Be sure the fuse is not blown on the AC power strip, if one is being used.
- Check to be sure the TV outlet is not on a wall switch.
- Be sure that the remote is in the correct operating mode.
- Be sure the remote is pointed at the Remote Sensor Window on the TV. See page 1 of the *Quick Use Guide* for details.

TV Displays Wrong Channel or No Channels Above 13

- Repeat channel selection.
- Add the desired channel numbers (using the CHANNEL EDIT control) into the TV's memory.
- Check to be sure the TUNER MODES are set to the CABLE option and run the Auto Program feature to find all available channels.



WARNING Concerning Stationary Images on the TV Screen:

Do not leave stationary or letterbox images on screen for extended periods of time. This can cause uneven display aging.

Normal use of the TV should involve the showing of pictures that contain constantly moving and changing images that fill the screen. Be careful not to leave nonmoving images on screen for extended periods of time, or to display the same images on screen too frequently, because subtle ghost images can be left on the picture tubes. Sources of stationary images may be DVD disks, laser disks, video games, CD-i disks, videotapes, digital television boxes, broadcast channels, cable channels, satellite channels, and others. **Here are some examples of stationary images (this is not an all-inclusive list; you may encounter others in your viewing):**

- **DVD menus**—listings of DVD disk content
- **Letterbox black bars**—shown at the top and bottom of the TV screen when a wide screen (16:9) movie is viewed on a TV with standard (4:3) aspect ratio.
- **Video-game images and scoreboards**
- **Television station logos**—present a problem if they are bright and stationary; moving or low-contrast graphics are less likely to cause uneven aging of the picture tube
- **Stock-market tickers**—presented at the bottom of the TV screen
- **Shopping channel logos and pricing displays**—bright and shown constantly or repeatedly in the same location on the TV screen.

PLACEMENT OF THE TV

- To avoid cabinet warping, cabinet color changes, and increased chance of set failure, do not place the TV where temperatures can become excessively hot; for example, in direct sunlight or near a heating appliance.
- Be sure to allow a free flow of air to and from the perforated back cover of the set.

CLEANING

- To avoid possible shock hazard, be sure the TV is unplugged from the electrical outlet before cleaning.
- Regularly dust the TV with a dry, nonscratching duster to keep the TV clean.
- When cleaning the TV, take care not to scratch or damage the screen surface. Avoid wearing jewelry or using anything abrasive. Do not use household cleaners. Wipe the front screen with a clean cloth dampened with water. Use even, easy, vertical strokes when cleaning.
- Gently wipe the cabinet surfaces with a clean cloth or sponge dampened in a solution of cool, clear water and a mild soap or detergent. Use a clean, dry cloth to dry the wiped surfaces. Do not use acetone, toluene, or alcohol to clean the screen.
- Occasionally vacuum the ventilation holes or slots in the back cover of the set.
- Never use thinners, insecticide sprays, or other chemicals on or near the cabinet, as they might cause permanent marring of the cabinet finish.



<p>Cleaning and Care 46</p> <p>FM Radio Mode Controls</p> <p> <i>AutoSound™ Control</i> 37</p> <p> Install Menu Controls</p> <p> Auto Program Control 34</p> <p> Language Control 34</p> <p> Manual Store Control 34</p> <p> <i>Mode Select Control</i> 34</p> <p> <i>Screensaver Control</i> 37</p> <p> Sound Adjustment Controls</p> <p> AVL (Auto Volume Leveler) Control 36</p> <p> Balance Control 36</p> <p> Equalizer Controls 36</p> <p> Dolby Virtual Control 36</p> <p> SAP 36</p> <p> Stereo Control 36</p> <p> Timer Controls 35</p> <p>HD Mode Controls</p> <p> <i>Lock HD Control</i> 44</p> <p> <i>Mode Select Control</i> 42</p> <p> Picture Adjustment Controls 42</p> <p> Sound Adjustment Controls 43</p> <p>Index 47</p> <p>PC Mode Controls</p> <p> Audio Selection Controls 38</p> <p> PC Feature Controls 39</p> <p> Picture Adjustment Controls 38</p> <p> PIP Controls 40</p> <p>Registration Information 2</p> <p>Safety/Precautions 3-4</p> <p>Table of Contents 5</p> <p>Troubleshooting Tips 45</p> <p>TV Mode Controls</p> <p> <i>Active Control</i> 24</p> <p> <i>Audio Out Control</i> 9</p> <p> AutoLock Controls</p> <p> Access Code 12</p> <p> Block Channels 13</p> <p> Blocking Options 18</p> <p> Clear All Locked Channels 15</p> <p> Lock HD Channel 14</p> <p> Movie Ratings 16</p> <p> Review Screen 18</p>	<p> TV Ratings 17</p> <p> Understanding the AutoLock™ Control 12</p> <p> <i>AutoSound™ Control</i> 26</p> <p> <i>Auto Program Control</i> 7</p> <p> <i>AutoPicture™ Control</i> 26</p> <p> <i>AVL (Auto Volume Leveler) Control</i> 9</p> <p> <i>Balance Control</i> 9</p> <p> <i>Channel Edit (Add or Delete Channels) Control</i> 7</p> <p> <i>Closed Captioning Control</i> 23</p> <p> <i>Dolby Virtual Control</i> 9</p> <p> <i>Equalizer Control</i> 9</p> <p> <i>Language Control</i> 6</p> <p> <i>Mode Control</i> 22</p> <p> Picture Adjustment Controls 8</p> <p> <i>Program List Control</i> 24</p> <p> Remote Control Programming for Accessory Devices</p> <p> Accessory Device Remote Control Buttons 33</p> <p> Code Entry Method 28</p> <p> Code List 30-32</p> <p> Direct Method 27</p> <p> Search Method 29</p> <p> <i>SAP (Secondary Audio Programming) Control</i> 9</p> <p> <i>Sleeptimer Control</i> 23</p> <p> <i>Stereo/Mono Control</i> 9</p> <p> <i>Surf Control</i> 25</p> <p> Timer Controls 10</p> <p> <i>Tuner Mode Control</i> 6</p> <p> <i>Widescreen (Screen Format) Control</i> 22</p> <p>Warranty 48</p>
--	--

PHILIPS LIMITED WARRANTY

One (1) Year Labor and Parts Repair

PHILIPS CONSUMER ELECTRONICS warrants this product against defect in material or workmanship, subject to any conditions set forth as follows:

PROOF OF PURCHASE:

You must have proof of the date of purchase to receive warranted repair on the product. A sales receipt or other document showing the product and the date that you purchased the product as well as the authorized retailer included, is considered such proof.

COVERAGE:

(If this product is determined to be defective)

LABOR: For a period of one (1) year from the date of purchase, Philips will repair or replace the product, at its option, at no charge, or pay the labor charges to any Philips authorized repair facility. After the period of one (1) year, Philips will no longer be responsible for charges incurred.

PARTS: For a period of one (1) year from the date of purchase, Philips will supply, at no charge, new or rebuilt replacement parts in exchange for defective parts, through a Philips authorized service center.

Note: If Philips is unable to provide service in your area, receipt of the paid service can be submitted for consideration of adjustment or full reimbursement at Philips discretion.

EXCLUDED FROM WARRANTY COVERAGE

Your warranty does not cover:

- Labor charges for installation or setup of the product, adjustment of customer controls on the product, and installation or repair of antenna systems outside of the product.
- Product repair and/or part replacement because of improper installation, connections to improper voltage supply, abuse, neglect, misuse, accident, unauthorized repair or other cause not within the control of Philips.
- A product that requires modification or adaptation to enable it to operate in any country other than the country for which it was designed, manufactured, approved and/or authorized, or repair of products damaged by these modifications.
- Damage occurring to product during shipping when improperly packaged or cost associated with packaging
- Product lost in shipment and no signature verification of receipt can be provided.
- A product used for commercial or institutional purposes (including but not limited to rental purposes).
- Products sold AS IS or RENEWED.

CARRY-IN / SHIP-IN WARRANTY

For Carry-In warranty repair, take the product to a Philips authorized service center for repair. When the product has been repaired, you must pick up the unit at the center. For Ship-In warranty repair, ship the product to a Philips authorized service center for repair in its original carton and packing material. If you do not have the original carton or packing material, have your product professionally packed for shipping. Ship product via a traceable carrier. When it is necessary for you to ship the product to Philips for repair, you will pay the shipping cost for shipment to Philips. Philips will pay the shipping costs when returning the product to you.

TO OBTAIN WARRANTY SERVICE IN THE U.S.A., PUERTO RICO, OR U.S. VIRGIN ISLANDS...

Contact Philips Customer Care Center at:
1-800-531-0039

TO OBTAIN WARRANTY SERVICE IN CANADA...

1-800-661-6162 (French Speaking)
1-800-531-0039 (English or Spanish Speaking)

REPAIR OR REPLACEMENT AS PROVIDED UNDER THIS WARRANTY IS THE EXCLUSIVE REMEDY FOR THE CONSUMER. PHILIPS SHALL NOT BE LIABLE FOR ANY INCIDENTAL OR CONSEQUENTIAL DAMAGES FOR BREACH OF ANY EXPRESS OR IMPLIED WARRANTY ON THIS PRODUCT. EXCEPT TO THE EXTENT PROHIBITED BY APPLICABLE LAW, ANY IMPLIED WARRANTY OF MERCHANTABILITY OR FITNESS FOR A PARTICULAR PURPOSE ON THIS PRODUCT IS LIMITED IN DURATION TO THE DURATION OF THIS WARRANTY.

Some states do not allow the exclusions or limitation of incidental or consequential damages, or allow limitations on how long an implied warranty lasts, so the above limitations or exclusions may not apply to you. In addition, if you enter into a service contract agreement with the PHILIPS partnership within ninety (90) days of the date of sale, the limitation on how long an implied warranty lasts does not apply.

This warranty gives you specific legal rights. You may have other rights which vary from state/province to state/province.

Philips, P.O. Box 520890, Miami, FL 33152 (402) 536-4171

EL6585E001 / 01-04

Free Manuals Download Website

<http://myh66.com>

<http://usermanuals.us>

<http://www.somanuals.com>

<http://www.4manuals.cc>

<http://www.manual-lib.com>

<http://www.404manual.com>

<http://www.luxmanual.com>

<http://aubethermostatmanual.com>

Golf course search by state

<http://golfingnear.com>

Email search by domain

<http://emailbydomain.com>

Auto manuals search

<http://auto.somanuals.com>

TV manuals search

<http://tv.somanuals.com>