

**PHILIPS**

***NORELCO***

**180°  
Hair Clipper**



**QC5170**

**Rechargeable  
Cordless/Cord**

Register your product and get support at

[www.philips.com/norelco](http://www.philips.com/norelco)

# IMPORTANT SAFETY INSTRUCTIONS

When using an electrical appliance, basic safety precautions should always be followed, including the following:

**Read all instructions before using this appliance.**

## DANGER

**To reduce the risk of electric shock:**

1. Do not reach for a clipper that has fallen into water. Unplug immediately.
2. Do not use while bathing or in a shower.
3. Do not place or store clipper where it can fall or be pulled into a tub or sink. Do not place in or drop into water or other liquid.
4. Always unplug this clipper from the electrical outlet immediately after using, except when clipper is (re)charging.
5. Unplug clipper before cleaning.

## WARNING

**To reduce the risk of burns, fire, electric shock or injury to persons:**

1. Close supervision is necessary when this appliance is used by, on, or near children or invalids.
2. Use this clipper for its intended household use as described in this manual. Do not use attachments not recommended by Philips Electronics North America Corporation.
3. Never operate this clipper if it has a damaged cord or plug, if it is not working properly, if it has been dropped, damaged, or dropped into water. For assistance call 1-800-243-3050.
4. Do not rinse or immerse the clipper in water or any other liquid.
5. Keep the clipper, cord and any attachments away from heated surfaces.
6. Never drop or insert any object into any opening.
7. Do not operate, charge or plug in clipper outdoors or where aerosol (spray) products are being used or where oxygen is being administered.
8. Always check cutters, cutting unit and combs before using the clipper. Do not use the clipper if cutters, cutting unit or combs are damaged, as injury may occur.
9. Always attach plug to clipper first, then to outlet. To disconnect, turn on/off switch to "OFF" position, then remove plug from outlet.
10. To prevent possible damage to the cord, do not wrap cord around the clipper.
11. Never put clipper in direct sunlight or store at a temperature above 140°F.
12. This clipper is for use on human hair only. Do not use this clipper for any other purpose.
13. Always store your clipper, attachments and power plug in a moisture-free area. Make sure the cord is disconnected from the clipper.

# SAVE THESE INSTRUCTIONS

**IMPORTANT:** The power plug contains a transformer. Do not cut off the power plug to replace it with another plug as this will cause a hazardous condition.

## Registration

Congratulations on your purchase and welcome to Philips Norelco!

To fully benefit from the support that Philips Norelco offers, register your product at

# Features

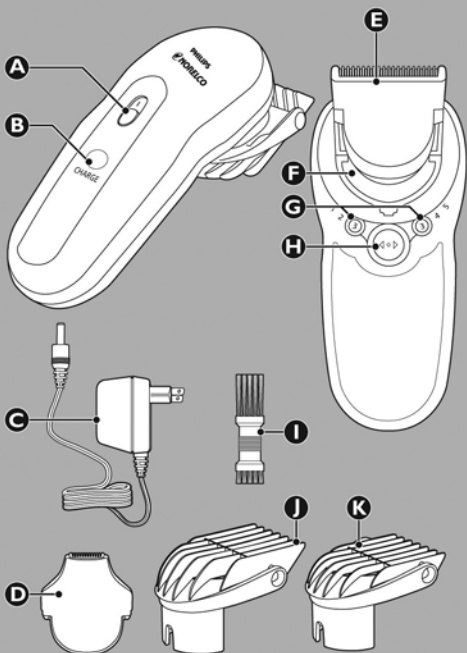

- A ON/OFF Switch
- B Charging Light
- C Adapter
- D Precision Trimmer
- E Stainless Steel Cutter Blades
- F Swivel Head
- G Hair Length Setting Indicator
- H Hair Length Selector
- I Cleaning Brush
- J Large Comb
- K Small Comb

Full Two-Year Warranty  
45-Day Money-Back Guarantee

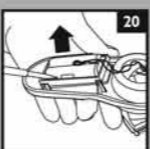
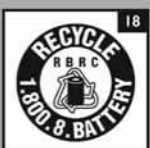
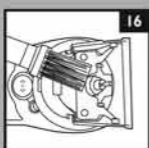
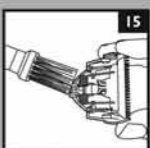
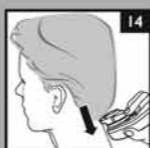
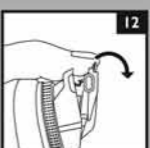
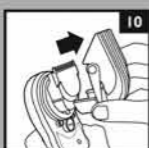
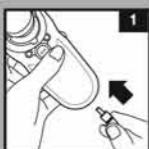

## Put It To The Test

Like many new products, your Philips Norelco 180° Hair Clipper may take a little getting used to. If you are using an electric Clipper for the first time, or if you've been using a different brand, take the time to acquaint yourself with your new Hair Clipper.

Your Hair Clipper features a 180° pivoting head to comfortably clip even hard-to-reach areas of your head.

Throw your scissors away and put your new Hair Clipper to the test. We guarantee precise, professional results or Philips Norelco will refund you the full purchase price as long as the request is received within 45 days of purchase.

## To Charge/Recharge

- ▶ Fully charge Clipper before using for the first time or after non-use for a long period of time.
- ▶ Battery performance is best if you recharge only when the battery is (almost) completely empty.
- ▶ Charging, recharging, or using Clipper at temperatures below 40°F or higher than 95°F adversely affects lifespan of the battery.
- ▶ Continuously recharging Clipper will reduce lifespan of battery.

- 1** Be certain Clipper is OFF.
- 2** Insert the appliance plug directly into the Clipper and plug the adapter into any 120VAC outlet (fig 1). Use only the cord provided.
- 3** After a few moments, the Charging Light on the appliance will light to indicate the Clipper is charging.

- ▶ It will take approximately 8 hours to fully charge the Clipper for a cordless clipping time of up to 60 minutes.

NOTE: After the Clipper is fully charged, the Charging Light will remain lit.

- 4** Disconnect the cord and unplug from electrical outlet.

## Optimize the working life of the battery

- ▶ After the Clipper has been charged for the first time, do not recharge the Clipper between clipping sessions. Continue using it until the battery is completely empty.
- ▶ Do not charge for more than 24 hours.
- ▶ Do not keep cord permanently plugged in.
- ▶ Discharge/run down the battery completely twice a year by letting the motor run until it stops.
- ▶ If the Clipper hasn't been used for a long period of time, it must be recharged for a full 8 hours.
- ▶ If the Clipper is exposed to a major change in temperature, pressure or humidity, wait 30 minutes before using.

## Corded Hair Clipping

- ▶ Only use the Clipper corded when the battery is empty.
- ▶ Clipper does not recharge during corded clipping.

- 1** Connect cord provided to Clipper and plug Clipper into electrical outlet (fig. 1).
- 2** If battery is completely empty, wait a few minutes before switching Clipper ON.
- 3** Slide ON/OFF switch ON to begin clipping.
- 4** Turn Clipper OFF and unplug.

## Cordless Hair Clipping

- 1** Charge according to directions. Unplug Clipper from outlet and remove cord.
- 2** Slide ON/OFF switch ON to begin clipping.

- 3** If the charge runs out while clipping, simply connect cord provided to Clipper and outlet to continue clipping.

## Hair Clipping

- ▶ Use this Clipper for its intended household use as described in this manual.
- ▶ Make sure that the appliance is fully charged before you start clipping hair.
- ▶ Before you start clipping, make sure that the head of the person whose hair you are cutting is at the same level as your chest so that all parts of his/her head are clearly visible and within easy reach.
- ▶ Only use the appliance on clean, dry hair.
- ▶ Do not use on freshly washed hair.
- ▶ Before you begin, comb the hair in the direction of growth (fig. 2).
- ▶ To achieve optimal clipping results, always move the appliance slowly through the hair against the direction of hair growth.

### Clipping with small or large comb

---

**1** Be certain the Clipper is in the OFF position.

**2** Select the comb attachment. The table shows the remaining hair length after clipping at the different settings of the small or large comb.

The remaining hair length is also indicated on each comb:

- Small comb: 3-11mm (1/8 – 11/25 in.)
- Large comb: 13-21mm (1/2 – 7/8 in.)

**3** Slide the selected comb into the guiding grooves on both sides of the Clipper swivel head and push until you hear it 'click' into place (fig. 3).

Make sure the comb attachment locks properly into position.

**4** Press the Hair Length Selector (1) and slide it left or right to the desired setting (2) (fig. 4). See Table 1 for settings.

Do not slide the length selector beyond the highest hair length setting (5).

**5** The selected hair length setting (1-5) is shown in the two length setting indication windows on both sides of the length selector (fig. 5).

When you are clipping for the first time, start at the maximum clipping length setting (#5) of the large comb to familiarize yourself with the appliance and prevent accidentally trimming hairs too short. As you become familiar with the settings, adjust the Hair Length Selector to desired trimming length.

## Using the swivel head

- At the starting clipping position of  $0^\circ$  (pointing forward), turn the swivel head  $45^\circ$  or  $90^\circ$  to the left or right to adjust the position of the cutter blades to the part of your head you are clipping (fig. 6).
- Turn the swivel head left or right to the desired clipping position. At each position you will hear a 'click' (fig. 7).  
Always adjust the position of the cutter blades with the swivel head. Do not turn the cutter blades or the comb attachment.
- The swivel head allows you to hold and use the Clipper like a brush (fig. 8).  
Do not turn the swivel head more than  $90^\circ$  to the left or right.
- Make sure that the flat part of the comb is always in full contact with the scalp to obtain an even result.
- Since all hairs do not grow in the same direction, move the Clipper slowly over the crown from different directions (i.e. upwards, downwards and across) to achieve an even result (fig. 9).
- Always move the Clipper against the direction of hair growth.
- Make overlapping passes over the head to ensure that all hair that should be cut has been cut.
- As you clip different areas of your head, adjust the position of the swivel head so that the swivel head position is most comfortable for you.
- For best results with curly, sparse or long hair, use a styling comb to guide the hair towards the Clipper.
- Turn the Clipper off regularly during clipping and remove the hair comb to blow and/or shake out hair that has accumulated.

*TIP: Write down the settings you have used to create a certain hairstyle as a reminder for future clipping sessions.*

**Table 1. Small and Large Combs**

Setting	Hair length after clipping with small comb	Hair length after clipping with large comb
1	1/8 in./3mm	1/2 in./13mm
2	1/5 in./5mm	5/8 in./15mm
3	7/25 in./7mm	17/25 in./17mm
4	3/8 in./9mm	3/4 in./19mm

## Contouring without a comb attachment

---

- ▶ Use the Clipper without a comb attachment to clip very close to the skin (0.03 in/0.8mm).
- ▶ Be careful when you are clipping without a comb attachment as when the Clipper is turned on it will remove every hair it touches.

**1** Remove the comb attachment by pulling it off the swivel head (fig. 10).

Never pull at the flexible top of the comb attachment. Always pull at the bottom part.

**2** To contour the hairline around the ears, comb the hair ends over the ears.

**3** Tilt the Clipper in such a way that only one edge of the cutter blades touches the hair ends. Only cut the hair ends. The hairline should be close to the ear (fig. 11).

## Contouring with the precision trimmer

---

- ▶ Use the Clipper with the precision trimmer to contour the neckline, sideburns and area around the ears.

**1** Be certain Clipper is in the OFF position.

**2** Remove the comb attachment by pulling it off the swivel head (fig. 10).

**3** Push the center of the cutter blade with your thumb until it releases from the swivel head (fig. 12).

**4** Insert the lug of the precision trimmer into the slot on the swivel head and push until the trimmer 'clicks' into place (fig. 13).

**5** To contour the neckline and sideburns, turn the Clipper and make downward strokes (fig. 14). Adjust the position of the swivel head so that it is most comfortable.

**6** Move the Clipper slowly and smoothly following the natural hairline.



## Cleaning

- ▶ Clean the attachments after each use.
- ▶ Always switch Clipper OFF, unplug and remove power supply cord from Clipper before cleaning.
- ▶ Do not use compressed air, abrasive cleaning agents, scourers or liquids such as alcohol, benzene, bleach or acetone to clean the Clipper and attachments.
- ▶ Never clean, replace or remove Clipper attachments with motor ON.
- ▶ Never rinse or immerse the Clipper in water or any other liquid.
- ▶ Do not apply pressure to cutters.
- ▶ Do not touch cutters with hard objects as this may damage them.
- ▶ Use a soft, dry cloth to clean Clipper handle.

### During Use:

---

- ▶ If cut hairs have accumulated in the comb area or precision trimmer, remove hairs by shaking, blowing or using cleaning brush provided.

### After Each Use:

---

- 1** Make sure the Clipper is switched OFF and disconnected from the electrical outlet.
- 2** Remove any comb attachment.
- 3** Blow and/or shake out any hair that may have accumulated in the attachment.
- 4** Push the center of the cutter blade with your thumb until it releases from the swivel head (fig. 12).  
Be careful that the cutter blade does not fall to the floor.
- 5** Clean the cutter blade with the brush supplied (fig. 15).
- 6** Clean the inside and outside of the swivel head with the brush supplied (fig. 16).
- 7** Clean the handle and the adapter with the cleaning brush supplied or with a dry cloth.
- 8** Insert the lug of the cutter blade into the slot on the swivel head and push until the cutter blade 'clicks' into place (fig. 17).

This Clipper has no other user-serviceable parts.  
For assistance call 1-800-243-3050.

## Assistance

For assistance, call toll free:

**1-800-243-3050**

**or visit our website:**

**[www.philips.com/norelco](http://www.philips.com/norelco)**

Information is available 24 hours a day,  
7 days a week.

## Storage

- ▶ Be sure Clipper is turned OFF. Remove cord from outlet and Clipper before storing in a safe, dry location where it will not be crushed, banged, or subject to damage.
- ▶ Do not wrap cord around Clipper when storing.
- ▶ Store cord in a safe location where it will not be cut or damaged.
- ▶ Do not place or store Clipper where it can fall or be pulled into a tub or sink, water or other liquid.

## Battery Removal

- ▶ This Philips Norelco Clipper contains rechargeable Nickel Metal Hydride batteries which must be disposed of properly (fig. 18).
  - ▶ Batteries should only be removed when Clipper is to be discarded.
  - ▶ For assistance, call toll free: 1-800-243-3050 or visit our website, [www.philips.com/norelco](http://www.philips.com/norelco).
- 1** Unplug electrical cord from outlet and Clipper before dismantling Clipper.
  - 2** Allow Clipper to run until the battery is empty/depleted.
  - 3** Turn Clipper OFF.
  - 4** Remove any comb attachment from the handle.
  - 5** Use a screwdriver to remove the upper housing part of the Clipper (fig. 19).
  - 6** Use a screwdriver to pry the batteries out of the Clipper (fig. 20).
  - 7** Cut the wires with household scissors.
  - 8** Do not attempt to replace batteries. Insulate battery ends by covering with tape and/or place batteries in a small plastic bag.
  - 9** Discard your Clipper. Do not attempt to plug electrical cord into the outlet or recharge the Clipper after the batteries have been removed.
  - 10** Contact your local town or city officials for battery disposal information or call 1-800-8-BATTERY or [www.rbrbc.com](http://www.rbrbc.com) for battery drop-off locations.

## Full Two-Year Warranty

Philips Electronics North America Corporation warrants each new Philips Norelco product, Model QC5170 against defects in materials or workmanship for a period of two years from the date of purchase, and agrees to repair or replace any defective product without charge.

**IMPORTANT:** This warranty does not cover damage resulting from accident, misuse or abuse, lack of reasonable care, the affixing of any attachment not provided with the product or loss of parts or subjecting the product to any but the specific voltage.\* Use of unauthorized replacement parts will void this warranty.

**PHILIPS ELECTRONICS NORTH AMERICA CORPORATION WILL NOT PAY FOR WARRANTY SERVICE PERFORMED BY A NON-AUTHORIZED REPAIR SERVICE AND WILL NOT REIMBURSE THE CONSUMER FOR DAMAGE RESULTING FROM WARRANTY SERVICE PERFORMED BY A NON-AUTHORIZED REPAIR SERVICE.**

**NO RESPONSIBILITY IS ASSUMED FOR ANY SPECIAL, INCIDENTAL OR CONSEQUENTIAL DAMAGES.**

In order to obtain warranty service, simply go to [www.philips.com/norelco](http://www.philips.com/norelco) or call 1-800-243-3050 for assistance. It is suggested that for your protection you return shipments of product by insured mail, insurance prepaid. Damage occurring during shipment is not covered by this warranty. **NOTE:** No other warranty, written or oral, is authorized by Philips Electronics North America Corporation. This warranty gives you specific legal rights, and you may also have other rights which vary from state to state. Some states do not allow the exclusion or limitation of incidental or consequential damages, so the above exclusion and limitations may not apply to you.

\*Read enclosed instructions carefully.

Manufactured for:

Philips Consumer Lifestyle

A Division of Philips Electronics North America Corporation

1600 Summer Street – 5th Floor; Stamford, CT 06905-5125



This symbol on the product's nameplate means it is listed by Underwriters' Laboratories, Inc.

Norelco is a Registered Trademark of Philips Electronics North America Corporation.

PHILIPS is a Registered Trademark of Koninklijke Philips Electronics N.V.

© 2009 Philips Electronics North America Corporation. All Rights Reserved.

# PHILIPS

# NORELCO

## 45-DAY MONEY-BACK GUARANTEE

If you are not fully satisfied with your Philips Norelco Hair Clipper, send the product back along with dated sales receipt and we'll refund you the full purchase price.

***The Clipper must be shipped prepaid by insured mail, insurance prepaid, and have the original sales receipt, indicating purchase price and the date of purchase, enclosed. We cannot be responsible for lost mail. The Clipper must be postmarked no later than 45 days after the date of purchase. Philips Norelco reserves the right to verify the purchase price of the Clipper and limit refunds not to exceed suggested retail price.***

To obtain Money-Back Guarantee Return Authorization Form, call 1-800-243-3050 for assistance. Please allow 4-6 weeks for delivery of check.

## Free Manuals Download Website

<http://myh66.com>

<http://usermanuals.us>

<http://www.somanuals.com>

<http://www.4manuals.cc>

<http://www.manual-lib.com>

<http://www.404manual.com>

<http://www.luxmanual.com>

<http://aubethermostatmanual.com>

Golf course search by state

<http://golfingnear.com>

Email search by domain

<http://emailbydomain.com>

Auto manuals search

<http://auto.somanuals.com>

TV manuals search

<http://tv.somanuals.com>