

Quick Start Guide



Step A **Connect**

Step B **Setup**

Step C **Enjoy**

What's in the Box?

You should find these items upon opening the box.

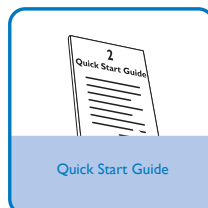
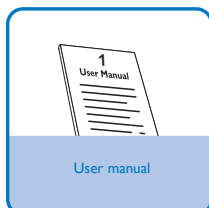
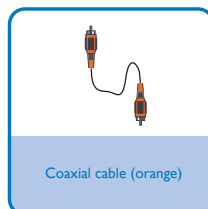
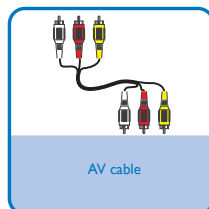
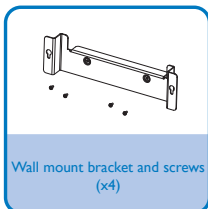
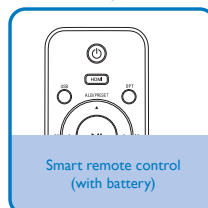
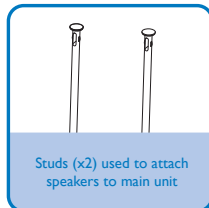
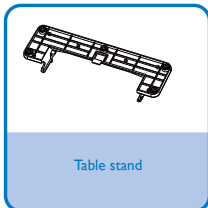

PHILIPS

Step A Connect

Tips

- See the User Manual for how to mount the main unit and speakers onto wall.
- See “Connect AV devices” for more AV connection options.
- For connection and operation of your AV devices, see the respective user manuals.

1

Attach speakers to the main unit.

2

Slide the table stand onto the bottom of the main unit.

3

Place the main unit and speakers.

4

Connect AV devices

5

Connect power:

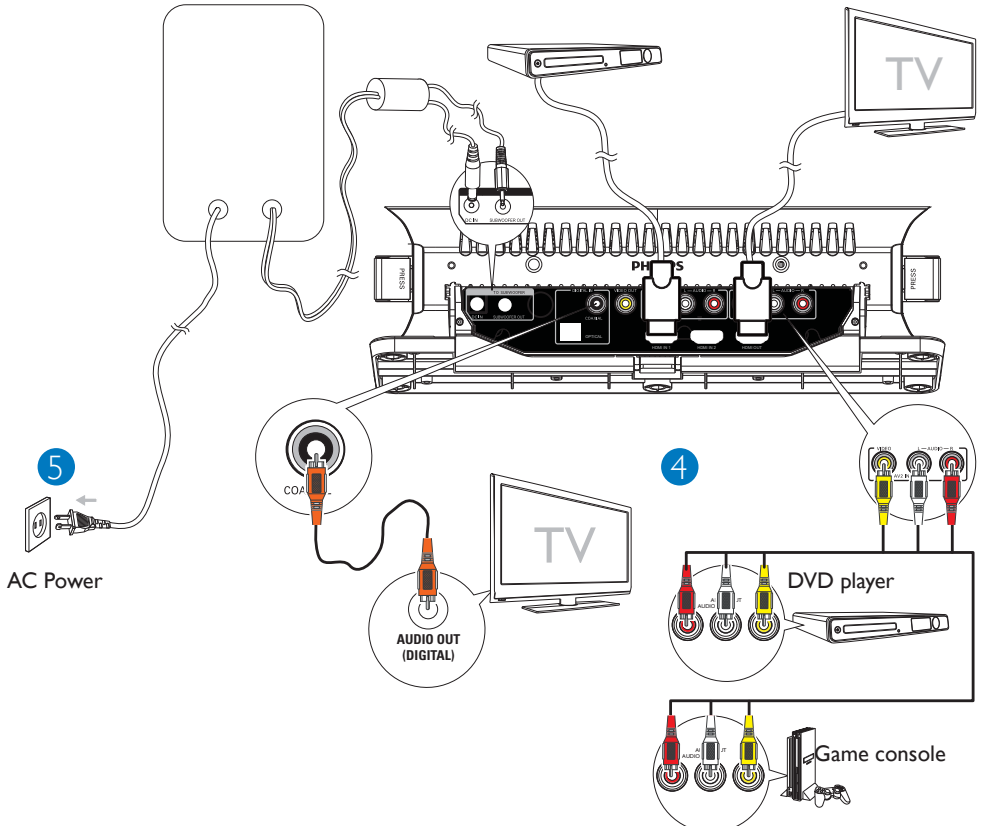
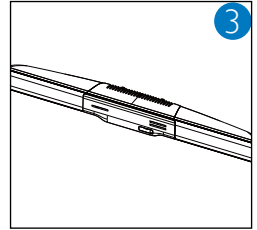
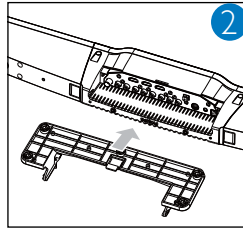
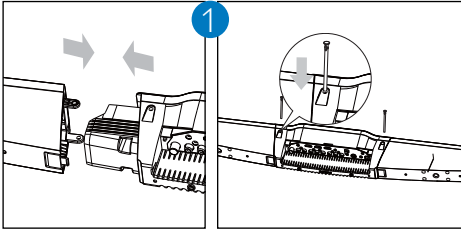

Step B Setup

Set clock

IMPORTANT!

– To set clock in the Eco Power Standby mode, first press and hold  for more than 2 seconds to switch to the standby mode.

1

In the standby mode, press and hold **CLOCK** to enter the clock setting mode.
→ **Clock** is displayed and the hour digits begin to blink.

2

Press **+VOL** - to set the hour.

3

Press **CLOCK** to confirm.
→ The minute digits begin to blink.

4

Press **+VOL** - to set the minute.

5

Press **CLOCK** to confirm the clock setting.

Step C Enjoy

Play from USB

1

Flip open the cover on the front panel.

2

Insert the USB plug of a USB device into the  socket.

3

Press **USB** to select the USB source.

4

Press **ALB/PRESET/▲▼** to select a folder.

5

Press **◀/▶** to select a file.

6

Press **▶||** to start play.

Step C Enjoy

Play connected AV devices

1

Press **AV**, **HDMI**, or **COAX/OPT** to select an AV source.

Listen to radio

1

Ensure that you have connected and fully extended the supplied FM antenna.

2

Press **RADIO**.

3

Press and hold **◀▶** for over 3 seconds.

→ The FM tuner tunes to a station with strong reception automatically.

4

Repeat steps 3 to find more stations.

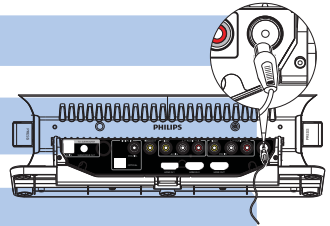

Tip

Detailed playback features and additional functions are described in the accompany owner's manual.



© Royal Philips Consumer Lifestyle N.V.
2009

All rights reserved.

<http://www.philips.com>



Free Manuals Download Website

<http://myh66.com>

<http://usermanuals.us>

<http://www.somanuals.com>

<http://www.4manuals.cc>

<http://www.manual-lib.com>

<http://www.404manual.com>

<http://www.luxmanual.com>

<http://aubethermostatmanual.com>

Golf course search by state

<http://golfingnear.com>

Email search by domain

<http://emailbydomain.com>

Auto manuals search

<http://auto.somanuals.com>

TV manuals search

<http://tv.somanuals.com>