

Register your product and get support at
www.philips.com/welcome



HTS2200

EN User manual

ZH-CN 用户手册

PHILIPS

Contents

| | | |
|----------|------------------------|---|
| 1 | Notice | 2 |
| | Copyright | 2 |
| | About Progressive Scan | 2 |
| | Trademarks | 2 |

| | | |
|----------|--|---|
| 2 | Important | 3 |
| | Safety | 3 |
| | Product care | 3 |
| | Disposal of your old product and batteries | 4 |

| | | |
|----------|--------------------------|---|
| 3 | Your home theater | 4 |
| | Main unit | 4 |
| | Remote control | 5 |

| | | |
|----------|--|---|
| 4 | Connect your home theater | 6 |
| | Connectors | 6 |
| | Connect to the TV | 6 |
| | Connect audio from TV or other devices | 7 |

| | | |
|----------|-------------------------------------|----|
| 5 | Use your home theater | 7 |
| | Before you start | 7 |
| | Choose your sound | 7 |
| | Play a disc | 8 |
| | Play from a USB storage device | 9 |
| | More play features for disc or USB | 9 |
| | Play from radio | 10 |
| | Play audio from TV or other devices | 10 |

| | | |
|----------|----------------------------|----|
| 6 | Change settings | 11 |
| | Change general settings | 11 |
| | Change video settings | 11 |
| | Change preference settings | 12 |

| | | |
|----------|------------------------------------|----|
| 7 | Update software | 12 |
| | Check software version | 12 |
| | Update software from a CD-R or USB | 12 |

| | | |
|----------|-------------------------------|----|
| 8 | Product specifications | 13 |
|----------|-------------------------------|----|

| | | |
|----------|------------------------|----|
| 9 | Troubleshooting | 14 |
|----------|------------------------|----|

| | | |
|-----------|--------------|----|
| 10 | Index | 15 |
|-----------|--------------|----|

1 Notice

Copyright



This item incorporates copy protection technology that is protected by U.S. patents and other intellectual property rights of Rovi Corporation. Reverse engineering and disassembly are prohibited.

About Progressive Scan

Consumers should note that not all high definition television sets are fully compatible with this product and may cause artifacts to be displayed in the picture. In case of 525 or 625 progressive scan picture problems, it is recommended that the user switch the connection to the 'standard definition' output. If there are questions regarding our TV set compatibility with this model 525p and 625p DVD player, please contact our customer service center.

Trademarks



Manufactured under license from Dolby Laboratories. Dolby and the double-D symbol are trademarks of Dolby Laboratories.



DivX®, DivX Certified® and associated logos are registered trademarks of DivX, Inc. and are used under license.

DivX Ultra® Certified to play DivX® video with advanced features and premium content.

ABOUT DIVX VIDEO: DivX® is a digital video format created by DivX, Inc. This is an official DivX Certified device that plays DivX video. Visit www.divx.com for more information and software tools to convert your files into DivX video.

ABOUT DIVX VIDEO-ON-DEMAND: This DivX Certified® device must be registered in order to play DivX Video-on-Demand (VOD) content. To generate the registration code, locate the DivX VOD section in your device setup menu. Go to vod.divx.com with this code to complete the registration process and learn more about DivX VOD.



2 Important

Read and understand all instructions before you use your home theater. If damage is caused by failure to follow instructions, the warranty does not apply.

Safety

Risk of electric shock or fire!

- Never expose the product and accessories to rain or water. Never place liquid containers, such as vases, near the product. If liquids are spilt on or into the product, disconnect it from the power outlet immediately. Contact Philips Consumer Care to have the product checked before use.
- Never place the product and accessories near naked flames or other heat sources, including direct sunlight.
- Never insert objects into the ventilation slots or other openings on the product.
- Where the mains plug or an appliance coupler is used as the disconnect device, the disconnect device shall remain readily operable.
- Disconnect the product from the power outlet before lightning storms.
- When you disconnect the power cord, always pull the plug, never the cable.

Risk of short circuit or fire!

- Before you connect the product to the power outlet, ensure that the power voltage matches the value printed on the back or bottom of the product. Never connect the product to the power outlet if the voltage is different.

Risk of injury or damage to the home theater!

- For wall-mountable products, use only the supplied wall mount bracket. Secure the wall mount to a wall that can support the combined weight of the product and the wall mount. Koninklijke Philips Electronics N.V. bears no responsibility for improper wall mounting that results in accident, injury or damage.

- For speakers with stands, use only the supplied stands. Secure the stands to the speakers tightly. Place the assembled stands on flat, level surfaces that can support the combined weight of the speaker and stand.
- Never place the product or any objects on power cords or on other electrical equipment.
- If the product is transported in temperatures below 5°C, unpack the product and wait until its temperature matches room temperature before connecting it to the power outlet.
- Visible and invisible laser radiation when open. Avoid exposure to beam.
- Do not touch the disc optical lens inside the disc compartment.

Risk of overheating!

- Never install this product in a confined space. Always leave a space of at least four inches around the product for ventilation. Ensure curtains or other objects never cover the ventilation slots on the product.

Risk of contamination!

- Do not mix batteries (old and new or carbon and alkaline, etc.).
- Remove batteries if they are exhausted or if the remote control is not to be used for a long time.
- Batteries contain chemical substances, they should be disposed of properly.

Product care

- Do not insert any objects other than discs into the disc compartment.
- Do not insert warped or cracked discs into the disc compartment.
- Remove discs from the disc compartment if you are not using the product for an extended period of time.
- Only use microfiber cloth to clean the product.

Disposal of your old product and batteries



Your product is designed and manufactured with high quality materials and components, which can be recycled and reused.



When this crossed-out wheeled bin symbol is attached to a product it means that the product is covered by the European Directive 2002/96/EC. Please inform yourself about the local separate collection system for electrical and electronic products.

Please act according to your local rules and do not dispose of your old products with your normal household waste.

Correct disposal of your old product helps to prevent potential negative consequences for the environment and human health.



Your product contains batteries covered by the European Directive 2006/66/EC, which cannot be disposed with normal household waste.

Please inform yourself about the local rules on separate collection of batteries because correct disposal helps to prevent negative consequences for the environmental and human health.

3 Your home theater

Congratulations on your purchase, and welcome to Philips! To fully benefit from the support that Philips offers, register your home theater at www.philips.com/welcome.

Main unit

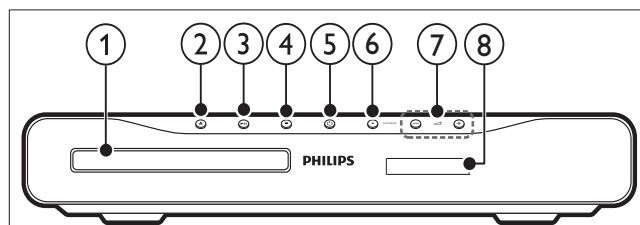

- ① **Disc compartment**
- ② **▲ (Open/Close)**
Opens or closes the disc compartment.
- ③ **▶|| (Play/Pause)**
Starts, pauses or resumes play.
- ④ **■ (Stop)**
 - Stops play.
 - In radio mode, erases the current preset radio station.
- ⑤ **⏻ (Standby-On)**
Switches the home theater on or to standby.
- ⑥ **SOURCE**
Selects an audio/video source for the home theater.
- ⑦ **▲ +/-**
Increases or decreases volume.
- ⑧ **Display panel**

Remote control

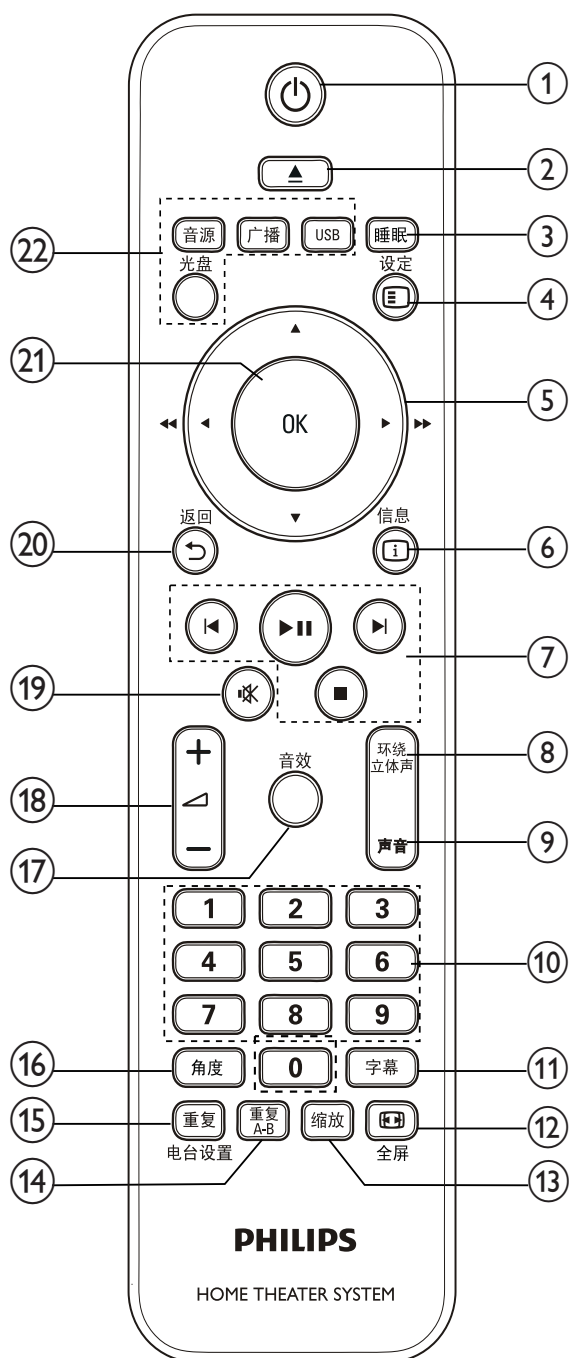

- ① **⏻ (Standby-On)**
Switches the home theater on or to standby.
- ② **▲ (Open/Close)**
Opens or closes the disc compartment.
- ③ **睡眠**
Switches the home theater to standby after the preset time selected.
- ④ **☰ - 设定**
Accesses or exits the setup menu.
- ⑤ **▲▼◀▶ (Navigation buttons)**
 - Navigate menus.
 - In video mode, press left or right to fast backward or fast forward.
 - In radio mode, press left or right to search a radio station; press up or down to fine tune a radio frequency.
- ⑥ **ⓘ - 信息**
Displays information about what is playing.
- ⑦ **Playback buttons**
Control playback.
- ⑧ **环绕立体声 (Surround Sound)**
Switches to surround sound or stereo sound.
- ⑨ **声音**
Selects an audio language or channel.
- ⑩ **Numeric buttons**
Selects an item to play.
- ⑪ **字幕**
Selects subtitle language for video.
- ⑫ **☒ - 全屏**
Fits the picture format to the TV screen.
- ⑬ **缩放**
Zooms into a video scene or picture.
- ⑭ **重复 A-B**
Marks two points within a chapter or track for repeat play, or turns off repeat mode.
- ⑮ **重复 / 电台设置**
 - Selects a repeat mode.
 - In radio mode, programs radio stations.
- ⑯ **角度**
Displays options for different camera angles.
- ⑰ **音效**
Selects a sound mode.
- ⑱ **🔊 +/-**
Increases or decreases volume.
- ⑲ **🔇 (Mute)**
Mutes or restores volume.
- ⑳ **↶ - 返回**
Returns to a previous menu screen.
- ㉑ **OK**
Confirms an entry or selection.
- ㉒ **Source buttons**
 - 音源 : Selects an audio input source.
 - 广播: Switches to FM radio.
 - **USB**: Switches to USB storage device.
 - 光盘 : Switches to disc source.

4 Connect your home theater

This section helps you connect your home theater to a TV and other devices. The basic connections of the home theater with its accessories are provided in the Quick Start. For a comprehensive interactive guide, see www.connectivityguide.philips.com.

Note

- Refer to the type plate at the back or bottom of the product for identification and supply ratings.
- Before you make or change any connections, ensure that all devices are disconnected from the power outlet.

Connectors

Side connectors

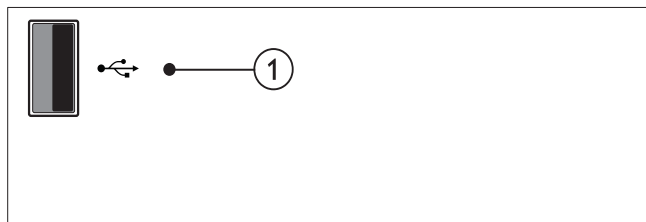

- ① **USB**
Audio, video or picture input from a USB storage device.

Back connectors

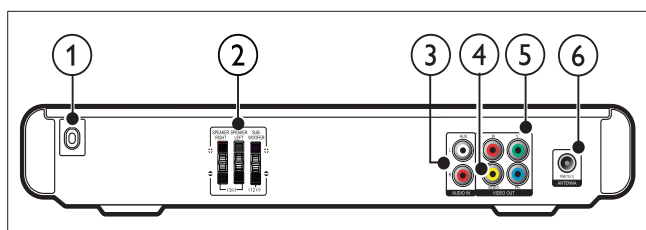

- ① **AC MAINS~ (交流输入)**
Connects to the power supply.
- ② **SPEAKERS**
Connects to the supplied speakers and subwoofer.

- ③ **AUDIO IN-AUX**
Connects to the analog audio output on the TV or an analog device.
- ④ **VIDEO OUT-VIDEO**
Connects to the composite video input on the TV.
- ⑤ **VIDEO OUT-Y Pb Pr**
Connects to the component video input on the TV.
- ⑥ **FM ANTENNA**
Connects the FM antenna for radio reception.

Connect to the TV

Connect your home theater directly to a TV through one of the following connectors (from highest to basic quality video):

- ① Component video
- ② Composite video

Option 1: Connect to the TV through YPbPr (component video)

Note

- The component video cable or connector might be labeled **Y Cb Cr** or **YUV**.

(Cable not supplied)

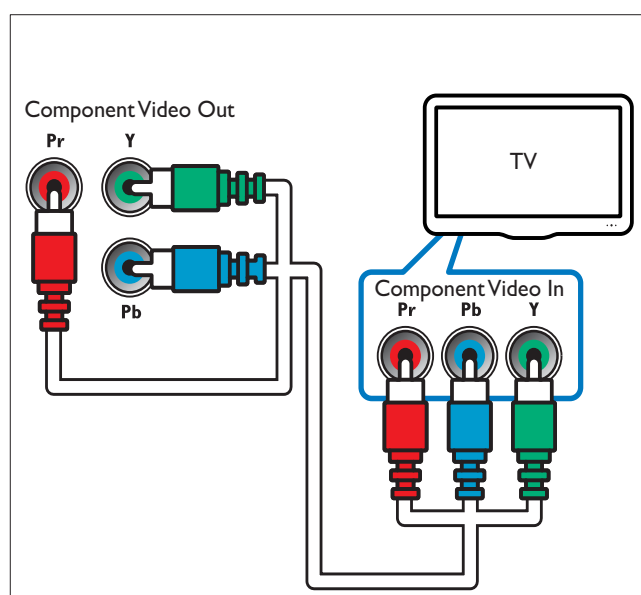

Option 2: Connect to the TV through composite video (CVBS)

Note

- The composite video cable or connector might be labeled **AV IN**, **VIDEO IN**, **COMPOSITE** or **BASEBAND**.

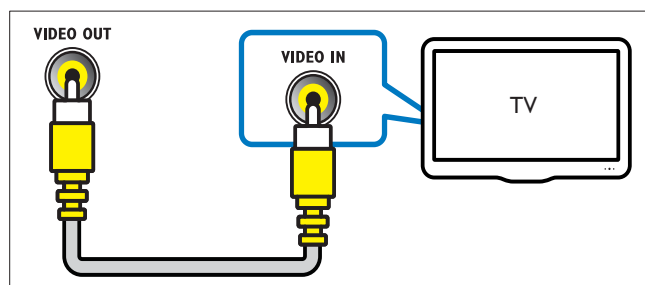

Connect audio from TV or other devices

Use your home theater to play audio from the TV or other devices such as a cable box.

Tip

- Press **音源** repeatedly to select the audio output of your connection.

(Cable not supplied)

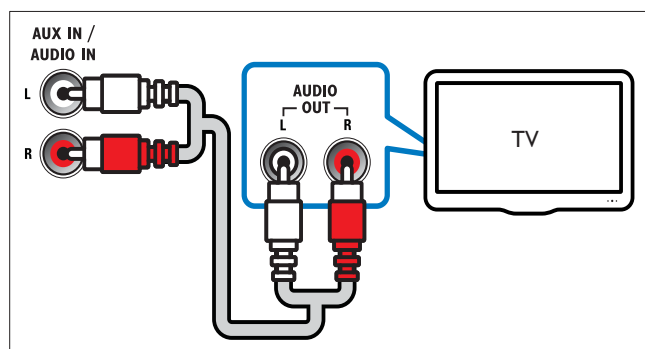

5 Use your home theater

This section helps you use the home theater to play media from a wide range of sources.

Before you start

Check that you:

- Make the necessary connections and complete the setup as described in the Quick Start.
- Switch the TV to the correct source for the home theater.

Choose your sound

This section helps you choose the ideal sound for your video or music.

Change sound mode

Select predefined sound modes to suit your video or music.

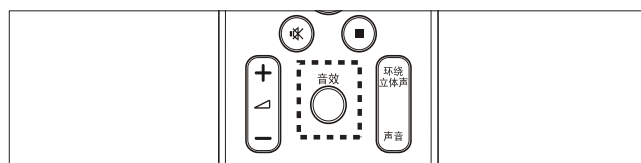

Press **音效** repeatedly to cycle through the available sound modes.

| Sound mode | Description |
|--------------------------|--|
| ACTION / ROCK | Enhanced low and high-range. Ideal for action movies and rock or pop music. |
| DRAMA / JAZZ | Clear mid and high-range. Ideal for drama movies and jazz music. |
| CONCERT / CLASSIC | Neutral sound. Ideal for live concerts and classical music. |
| SPORTS | Moderate mid-range and surround effects for clear vocals and the atmosphere of a live sport venue. |
| NIGHT | Dynamically controlled sound mode suitable for watching movies at night or for non-intrusive background music. |

Change surround sound mode

Experience an immersive audio experience with surround sound modes.

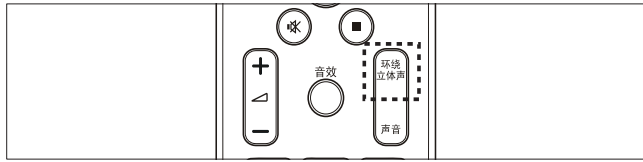

Press **环绕立体声** repeatedly to cycle through the available surround modes.

| Option | Description |
|---------------------|---|
| VIRTUAL SURR | Creates a highly compelling 5.1 channel listening experience. |
| STEREO | Two-channel stereo sound. Ideal for listening to music. |

Play a disc

The home theater can play a wide variety of discs, including video, audio and mixed media (for example, a CD-R that contains JPEG pictures and MP3 music).

- 1 Insert a disc into the home theater.
- 2 Press **光盘**.
↳ The disc plays or the disc main menu appears.
- 3 Press the following buttons to control play:

| Button | Action |
|---------------------------|---|
| Navigation buttons | Navigate menus. |
| OK | Confirms an entry or selection. |
| ▶ | Starts, pauses or resumes play. |
| ■ | Stops play. |
| ◀/▶ | Skips to the previous or next track, chapter or file. |
| ◀◀/▶▶ | Fast backwards or fast forwards. Press repeatedly to change the search speed. |
| 缩放 | Zooms into a video scene or picture. |
| 重复 A-B | Marks two points within a chapter or track for repeat play, or turns off repeat mode. |
| ◻ - 全屏 | Fits the picture format to the TV screen. |

Use video options

Access several useful features while viewing video.

Note

- Available video options depend on the video source.

| Button | Action |
|---------------|---|
| ▲ / ▼ | Searches slow-backward or slow-forward. Press repeatedly to change the search speed. For VCD/SVCD, slow-backward search is not available. |
| 声音 | Selects an audio language or channel. |
| 字幕 | Selects subtitle language for video. |
| i - 信息 | Displays information about what is playing. |
| 重复 | Repeats a chapter or title. |
| 重复 A-B | Marks two points within a chapter for repeat play, or turns off repeat mode. |
| 角度 | Displays options for different camera angles. |

Use picture options

Access several useful features while viewing pictures.

| Button | Action |
|---------------|---|
| ▲ / ▼ | Rotates the picture counter-clockwise or clockwise. |
| ◀ / ▶ | Skips to the previous or next picture. |
| 重复 | Repeats a single file in the folder or repeats the entire folder. |
| i - 信息 | Displays photo albums in a thumbnail overview. |

Use audio options

Access several useful features while audio is played.

| Button | Action |
|--------|--|
| 重复 | Repeats a track or the entire disc. |
| 重复 A-B | Marks two points within a track for repeat play, or turns off repeat mode. |

Play from a USB storage device

The home theater is fitted with a USB connector that allows you to view pictures, listen to music or watch movies stored on a USB storage device.

- 1 Connect the USB storage device to the home theater.
- 2 Press **USB**.
↳ A content browser appears.
- 3 Select a file, then press **OK**.
- 4 Press the playback buttons to control play (see 'Play a disc' on page 8).

Note

- If the USB storage device does not fit into the connector, use a USB extension cable.
- The home theater does not support digital cameras that need a computer program to display photos.
- The USB storage device must be FAT or DOS-formatted, and Mass Storage Class compliant.

More play features for disc or USB

Several advanced features are available for video or picture playback from a disc or USB storage device.

Play a musical slideshow

Play music and pictures simultaneously to create a musical slideshow. The files must be stored on the same disc or USB storage device.

- 1 Play a music track.
- 2 Navigate to the picture file, then press **OK** to start slideshow.
- 3 Press **■** to stop slideshow.
- 4 Press **■** again to stop music.

Quick skip play to a specific time

Quick skip to a specific part of a video by entering the time of a scene.

- 1 During video play, press **i** - 信息.
- 2 Press the **Navigation buttons** and **OK** to select:
 - **[TT Time]** : Title time.
 - **[Ch Time]** : Chapter time.
 - **[Disc Time]** : Disc time.
 - **[Track Time]** : Track time.
- 3 Enter the time of the scene, then press **OK**.

Play from radio

The home theater can store up to 40 radio stations.

- 1 Check that the FM antenna is connected.
- 2 Press 广播.
 - ↳ “AUTO INSTALL...PRESS PLAY” appears on the display panel if you have not installed any radio stations. Press ►||.
- 3 Press the following buttons to control play:

| Button | Action |
|--------|---|
| ◀/▶ | Selects a preset radio station. |
| ◀◀/▶▶ | Searches for a radio station. |
| ▲▼ | Fine tunes a radio frequency. |
| ■ | Press and hold to erase the preset radio station. Press to stop the installation of radio stations. |
| 电台设置 | Manual: Press once to access program mode, and press again to store the radio station. Automatic: Press and hold for five seconds to reinstall radio stations. |

Note

- AM and digital radio are not supported.
- If no stereo signal is detected, or if fewer than five stations are found, you are prompted to install the radio stations again.
- For the best reception, place the antenna away from the TV or other sources of radiation.

Change tuning grid

In some countries, you can switch the FM tuning grid between 50 kHz and 100 kHz. Changing tuning grid erases all preset radio stations.

- 1 Press 广播.
- 2 Press ■.
- 3 Press and hold ►|| until ‘GRID 9’ (50 kHz) or ‘GRID 10’ (100 kHz) is displayed.

Play audio from TV or other devices

Press 音源 repeatedly to select the audio output of the connected device.



6 Change settings



This section helps you to change the settings of your home theater.

! Caution

- Most of the settings are already configured with the best value for the home theater. Unless you have a specific reason to change a setting, it is best to leave it at the default value.

- 1 Press  - 設定.
↳ The following menu appears.

| Symbol | Description |
|---|--------------------|
|  | [General Setup] |
|  | [Video Setup] |
|  | [Preference Setup] |

- 2 Select a setup menu, then press **OK**.
See the following sections for information about how to change the settings of your home theater.
- 3 Press  - 返回 to return to the previous menu, or press  - 設定 to exit.

≡ Note

- You cannot change a setting that is grayed out.

Change general settings

- 1 Press  - 設定.
- 2 Select **[General Setup]**, then press **OK**.
- 3 Select and adjust the following settings:
 - **[OSD Language]** : Selects the on-screen display menu language.
 - **[Screen Saver]** : Enables or disables screen saver mode. If enabled, the screen enters idle mode after 10 minutes of inactivity (for example, in pause or stop mode).
 - **[DivX® VOD Code]** : Displays the DivX VOD registration code for the home theater.
- 4 Press **OK** to confirm your choice.

≡ Note

- Before you purchase DivX videos and play them on the home theater, register the home theater on www.divx.com using the DivX VOD code.

Change video settings

- 1 Press  - 設定.
- 2 Select **[Video Setup]**, then press **OK**.
- 3 Select and adjust the following settings:
 - **[TV System]** : Selects a TV system that is compatible with the TV.
 - **[TV Display]** : Selects a picture display format to fit the TV screen.
 - **[Screen Fit]** : Selects a full screen format that best fits to the TV screen.
 - **[Picture Settings]** : Selects a predefined color setting.
 - **[Progressive]** : Enables or disables progressive scan mode.
- 4 Press **OK** to confirm your choice.

≡ Note

- The best setting is automatically selected for the TV. If you need to change the setting, ensure that the TV supports the new setting.
- Some video settings depend on the video source, ensure that the disc and the TV support the setting or feature.

Change preference settings

- 1 Press  - 设定.
- 2 Select **[Preference Setup]**, then press **OK**.
- 3 Select and adjust the following settings:
 - **[Audio]** : Selects audio language for video.
 - **[Subtitle]** : Selects subtitle language for video.
 - **[Disc Menu]** : Selects menu language for video disc.
 - **[Parental]** : Restricts access to discs that are recorded with ratings. To play all discs irrespective of the rating, select level '8'.
 - **[PBC]** : Displays or skips the content menu for VCD and SVCD discs.
 - **[Password]** : Sets or changes a PIN code to play a restricted disc. Enter '0000' if you do not have a PIN or if you have forgotten your PIN.
 - **[DivX Subtitle]** : Selects a character set that supports the DivX subtitle.
 - **[Version Info.]** : Displays the software version for the home theater.
 - **[Default]** : Resets the home theater to the default settings programmed at the factory.
- 4 Press **OK** to confirm your choice.

Note

- If your preferred disc language is not available, you can select **[Other]** from the list and enter the 4-digit language code which can be found at the back of this manual.
- If you select a language that is not available on a disc, the home theater uses the default language of the disc.
- You cannot reset disc lock, password (PIN code) and parental control settings to their default values.

7 Update software

To check for new updates, compare the current software version of your home theater with the latest software version (if available) on the Philips web site.

Check software version

- 1 Press  - 设定.
- 2 Select **[Preference Setup]** > **[Version Info.]**, then press **OK**.
 - ↳ The software version is displayed.

Update software from a CD-R or USB

- 1 Check for the latest software version on www.philips.com/support.
 - Search for your model and click on 'software&drivers'.
- 2 Download the software onto a CD-R or USB storage device.
- 3 Insert the CD-R or connect the USB storage device to the home theater.
- 4 Follow the instructions on the TV to confirm the update.
 - ↳ When complete, the home theater automatically switches off and on again.
 - If not, disconnect the power cord for a few seconds and then reconnect it.

Caution

- Do not turn off the power or remove the CD-R or USB storage device when the software update is in progress because you might damage the home theater.

8 Product specifications



Note

- Specification and design are subject to change without notice.

Region code

The type plate on the back or bottom of the home theater shows which regions it supports

| Country | DVD |
|-----------------------------|-----|
| Europe, United Kingdom | |
| Asia Pacific, Taiwan, Korea | |
| Latin America | |
| Australia, New Zealand | |
| Russia, India | |
| China | |

Playback media

DVD-Video, DVD+R/+RW, DVD-R/-RW, CD-R/CD-RW, Audio CD, Video CD/SVCD, Picture CD, MP3-CD, WMA-CD, DivX-CD, USB storage device

File Format

- Audio: .mp3, .wma
- Video: .divx, .divx ultra, .mpeg, .mpg, .wmv (simple profile)
- Picture: .jpeg, .jpg

Amplifier

- Total output power: 150 W RMS (30% THD), 120 W RMS (10% THD)
- Frequency response: 20 Hz-20 kHz / ± 3 dB
- Signal-to-noise ratio: > 65 dB (CCIR) / (A-weighted)
- Input sensitivity:
 - AUX: 1 mV

Video

- Signal system: PAL / NTSC

Audio

- Sampling frequency:
 - MP3: 32 kHz, 44.1 kHz, 48 kHz
 - WMA: 44.1 kHz, 48 kHz
- Constant bit rate:
 - MP3: 112 kbps - 320 kbps
 - WMA: 48 kbps - 192 kbps

Radio

- Tuning range: FM 87.5-108 MHz (50 kHz)
- Signal-to-noise ratio: FM 50 dB
- Frequency response: FM 180 Hz-10 kHz / ± 6 dB

USB

- Compatibility: USB
- Class support: UMS (USB Mass Storage Class)
- File system: FAT16, FAT32
- Maximum memory support: < 160GB

Main Unit

- Power supply: 110-240V, ~50-60 Hz;
- Power consumption: 50 W
- Standby power consumption: ≤ 0.9 W
- Dimensions (WxHxD): 360 x 58 x 303 (mm)
- Weight: 2.3 kg

Subwoofer

- Impedance: 12 ohm
- Speaker drivers: 165 mm (6.5") woofer
- Frequency response: 40 Hz-150 kHz
- Dimensions (WxHxD): 123 x 309 x 369 (mm)
- Weight: 3.81 kg
- Cable length: 4 m

Speakers

- System: full range satellite
- Speaker impedance: 3 ohm
- Speaker drivers: 76 mm (3") full range
- Frequency response: 150 Hz-20 kHz
- Dimensions (WxHxD): 254 x 1001 x 254 (mm)
- Weight: 3.71 kg
- Cable length: 4 m

Laser specification

- Type: Semiconductor laser GaAlAs (CD)
- Wave length: 645 - 665 nm (DVD), 770 - 800 nm (CD)
- Output power: 6 mW (DVD), 7 mW (VCD/CD)
- Beam divergence: 60 degrees.

9 Troubleshooting



Warning

- Risk of electric shock. Never remove the casing of the product.

To keep the warranty valid, never try to repair the product yourself.

If you have problems using this product, check the following points before you request service. If you still have a problem, register your product and get support at www.philips.com/welcome.

If you contact Philips, you will be asked for the model and serial number of your product. The model number and serial number are on the back or bottom of your product. Write the numbers here:

Model No. _____

Serial No. _____

Main unit

The buttons on this home theater do not work.

- Disconnect the home theater from the power outlet for a few minutes, then reconnect.

Picture

No picture.

- Ensure that the TV is switched to the correct source for this home theater.
- If this happens when you change the TV system, switch to its default mode: 1) Press ▲. 2) Press ◀. 3) Press 字幕.
- If this happens when you switch on the progressive scan mode, switch to its default mode: 1) Press ▲. 2) Press ◀. 3) Press 声音.

Sound

No sound.

- Ensure that the audio cables are connected and select the correct input source (for example, 音源) for the device you want to play.

No sound from TV program.

- Connect an audio cable from the audio input on the home theater to the audio output on the TV, then press 音源 repeatedly to select the correct audio source.

Distorted sound or echo.

- Ensure that the TV volume is muted or set to minimum if you are playing audio through the home theater.

Play

Disc cannot be played.

- Clean the disc.
- Ensure that the home theater supports the disc (see 'Product specifications' on page 13).
- Ensure that the home theater supports the region code of the DVD.
- For DVD±RW or DVD±R, ensure that the disc is finalized.

DivX video files cannot be played.

- Ensure that the DivX file is encoded according to the 'Home Theater Profile' with the DivX encoder.
- Ensure that the DivX video file is complete.

DivX subtitles do not display correctly.

- Ensure that the subtitle file name is the same as the movie file name.
- Select the correct character set: 1) Press 設定 - 設定. 2) Select [Preference Setup]. 3) Select [DivX Subtitle]. 4) Select a supported character set. 5) Press OK.

The contents of a USB storage device cannot be read.

- Ensure that the format of the USB storage device is compatible with the home theater (see 'Product specifications' on page 13).
- Ensure that the USB storage device is formatted with a file system that is supported by the home theater.

'No entry' or 'x' sign appears on the TV.

- The operation is not possible.

10 Index

| | |
|--------------------------|-------|
| A | |
| amplifier | 13 |
| audio | |
| connection | 7 |
| <hr/> | |
| C | |
| care | 3 |
| change settings | 11 |
| connect | |
| audio from TV | 7, 10 |
| guide | 6 |
| other devices | 7 |
| TV | 6 |
| connectors | 6 |
| contact us | 14 |
| <hr/> | |
| D | |
| disc | |
| play | 8 |
| supported discs | 13 |
| disposal of your product | 4 |
| <hr/> | |
| F | |
| file formats | 13 |
| <hr/> | |
| O | |
| overview | |
| connectors | 6 |
| main unit | 4 |
| remote control | 5 |
| <hr/> | |
| P | |
| picture | |
| slide show | 9 |
| troubleshooting | 14 |
| play | |
| disc | 8 |
| options | 8 |
| radio | 10 |
| troubleshooting | 14 |
| USB storage device | 9 |
| product care | 3 |
| product specifications | 13 |
| progressive scan | 2 |
| <hr/> | |
| R | |
| radio | |
| play | 10 |
| program | 10 |
| tune | 10 |
| tuning grid | 10 |
| recycle | 4 |
| region code | 13 |
| remote control | 5 |
| repeat | 8 |
| <hr/> | |
| S | |
| safety | 3 |
| slideshow | |
| play musical slideshow | 9 |
| software | |
| update | 12 |
| version | 12 |
| sound | |
| mode | 7 |
| surround | 8 |
| troubleshooting | 14 |
| <hr/> | |
| T | |
| time search video | 9 |
| troubleshooting | 14 |
| TV | |
| audio from TV | 7, 10 |
| connect | 6 |
| <hr/> | |
| U | |
| USB | |
| play | 9 |
| software update | 12 |

Language Code

| | | | | | |
|-----------------------------|------|-----------------------------|------|-----------------------|------|
| Abkhazian | 6566 | Inupiaq | 7375 | Pushto | 8083 |
| Afar | 6565 | Irish | 7165 | Russian | 8285 |
| Afrikaans | 6570 | Íslenska | 7383 | Quechua | 8185 |
| Amharic | 6577 | Italiano | 7384 | Raeto-Romance | 8277 |
| Arabic | 6582 | Ivrit | 7269 | Romanian | 8279 |
| Armenian | 7289 | Japanese | 7465 | Rundi | 8278 |
| Assamese | 6583 | Javanese | 7486 | Samoaan | 8377 |
| Avestan | 6569 | Kalaallisut | 7576 | Sango | 8371 |
| Aymara | 6589 | Kannada | 7578 | Sanskrit | 8365 |
| Azerhijani | 6590 | Kashmiri | 7583 | Sardinian | 8367 |
| Bahasa Melayu | 7783 | Kazakh | 7575 | Serbian | 8382 |
| Bashkir | 6665 | Kernewek | 7587 | Shona | 8378 |
| Belarusian | 6669 | Khmer | 7577 | Shqip | 8381 |
| Bengali | 6678 | Kinyarwanda | 8287 | Sindhi | 8368 |
| Bihari | 6672 | Kirghiz | 7589 | Sinhalese | 8373 |
| Bislama | 6673 | Komi | 7586 | Slovensky | 8373 |
| Bokmål, Norwegian | 7866 | Korean | 7579 | Slovenian | 8376 |
| Bosanski | 6683 | Kuanyama; Kwanyama | 7574 | Somali | 8379 |
| Brezhoneg | 6682 | Kurdish | 7585 | Sotho; Southern | 8384 |
| Bulgarian | 6671 | Lao | 7679 | South Ndebele | 7882 |
| Burmese | 7789 | Latina | 7665 | Sundanese | 8385 |
| Castellano, Español | 6983 | Latvian | 7686 | Suomi | 7073 |
| Catalán | 6765 | Letzeburgesch; | 7666 | Swahili | 8387 |
| Chamorro | 6772 | Limburgan; Limburger | 7673 | Swati | 8383 |
| Chechen | 6769 | Lingala | 7678 | Svenska | 8386 |
| Chewa; Chichewa; Nyanja | 7889 | Lithuanian | 7684 | Tagalog | 8476 |
| 中文 | 9072 | Luxembourgish; | 7666 | Tahitian | 8489 |
| Chuang; Zhuang | 9065 | Macedonian | 7775 | Tajik | 8471 |
| Church Slavic; Slavonic | 6785 | Malagasy | 7771 | Tamil | 8465 |
| Chuvash | 6786 | Magyar | 7285 | Tatar | 8484 |
| Corsican | 6779 | Malayalam | 7776 | Telugu | 8469 |
| Česky | 6783 | Maltese | 7784 | Thai | 8472 |
| Dansk | 6865 | Manx | 7186 | Tibetan | 6679 |
| Deutsch | 6869 | Maori | 7773 | Tigrinya | 8473 |
| Dzongkha | 6890 | Marathi | 7782 | Tonga (Tonga Islands) | 8479 |
| English | 6978 | Marshallese | 7772 | Tsonga | 8483 |
| Esperanto | 6979 | Moldavian | 7779 | Tswana | 8478 |
| Estonian | 6984 | Mongolian | 7778 | Türkçe | 8482 |
| Euskara | 6985 | Nauru | 7865 | Turkmen | 8475 |
| Ελληνικά | 6976 | Navaho; Navajo | 7886 | Twi | 8487 |
| Faroese | 7079 | Ndebele, North | 7868 | Uighur | 8571 |
| Français | 7082 | Ndebele, South | 7882 | Ukrainian | 8575 |
| Frysk | 7089 | Ndonga | 7871 | Urdu | 8582 |
| Fijian | 7074 | Nederlands | 7876 | Uzbek | 8590 |
| Gaelic; Scottish Gaelic | 7168 | Nepali | 7869 | Vietnamese | 8673 |
| Galleghán | 7176 | Norsk | 7879 | Volapuk | 8679 |
| Georgian | 7565 | Northern Sami | 8369 | Walloon | 8765 |
| Gikuyu; Kikuyu | 7573 | North Ndebele | 7868 | Welsh | 6789 |
| Guarani | 7178 | Norwegian Nynorsk; | 7878 | Wolof | 8779 |
| Gujarati | 7185 | Occitan; Provençal | 7967 | Xhosa | 8872 |
| Hausa | 7265 | Old Bulgarian; Old Slavonic | 6785 | Yiddish | 8973 |
| Herero | 7290 | Oriya | 7982 | Yoruba | 8979 |
| Hindi | 7273 | Oromo | 7977 | Zulu | 9085 |
| Hiri Motu | 7279 | Ossetian; Ossetic | 7983 | | |
| Hrvatski | 6779 | Pali | 8073 | | |
| Ido | 7379 | Panjabi | 8065 | | |
| Interlingua (International) | 7365 | Persian | 7065 | | |
| Interlingue | 7365 | Polski | 8076 | | |
| Inuktitut | 7385 | Português | 8084 | | |

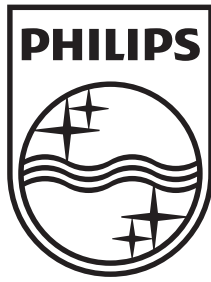

© 2010 Koninklijke Philips Electronics N.V.

All rights reserved.

sgptt_1028/93_v1

Free Manuals Download Website

<http://myh66.com>

<http://usermanuals.us>

<http://www.somanuals.com>

<http://www.4manuals.cc>

<http://www.manual-lib.com>

<http://www.404manual.com>

<http://www.luxmanual.com>

<http://aubethermostatmanual.com>

Golf course search by state

<http://golfingnear.com>

Email search by domain

<http://emailbydomain.com>

Auto manuals search

<http://auto.somanuals.com>

TV manuals search

<http://tv.somanuals.com>