

Projection Television

43"/50"/ 55"

Instructions for Use

43PP925

50PP925

55PP925



Let's make things better.



PHILIPS



3135 015 22191

INTRODUCTION

Thank you for purchasing this television set. You are now the proud owner of a **PHILIPS** TV set, which promises full value to you as a customer. Please read the instruction manual carefully and thoroughly to help you install and operate your TV set.

TABLE OF CONTENTS

SAFETY INFORMATION/USEFUL TIPS	3
BEFORE CALLING SERVICE	3
INSTALLATION	4
CONNECTING THE AUDIO/VIDEO SOCKETS	
Playback	5-6
Recording	7
EXTERNAL SPEAKER CONNECTIONS	8-9
FUNCTIONS OF REMOTE CONTROL	10-11
FUNCTIONS OF TV CONTROLS	12-13
SELECTING THE MENU LANGUAGE, TUNER MODE AND AUTOMATIC TUNING OF CHANNELS	14
FINE TUNING OF CHANNELS	15
EDITING OF CHANNELS	16
NAMING OF CHANNELS	17
USING THE PICTURE MENU	18
USING THE SOUND MENU	19
CONVERGENCE	
Converge Red/Blue	20
Multipoint Red/Blue	21-22
Undo Multipoint	23
ACTIVATING THE TIMER	24-25
ACTIVATING THE CHILD LOCK	
Access Code	26
Change Code	27
Lock Channel	28
Clear All	29
USING THE CLOSED CAPTIONING CONTROL	30-31
USING THE SURF CONTROL	32
ACTIVATING THE BLUE MUTE CONTROL	33
USING THE PROGRAM LIST FEATURE	33
SMART PICTURE AND SMART SOUND	34
ACTIVATING THE PIP (PICTURE-IN-PICTURE) AND DOUBLE WINDOW CONTROL	35-37
SPECIFICATIONS	38

SAFETY INFORMATION/USEFUL TIPS

Safety

Disconnect mains plug when :

- the red light below the TV screen is flashing continuously.
- a bright white line is displayed across the screen.
- cleaning the TV screen. Never use abrasive cleaning agents. Use a slightly damp chamois leather or soft cloth.
- there is a lightning storm.
- the set is left unattended for a prolonged period of time.

Useful Tips

- Do not place your TV set under direct sunlight or heat.
- Avoid placing your set (e.g., near the window) where it is likely to be exposed to rain or water.
- Do not leave your set on standby mode for a prolonged period of time. Switch off set to allow it to be demagnetised. A demagnetised set supports good picture quality.
- Do not shift or move the set around when it is switched on. Unevenness in colour in some parts of the screen may occur.
- Never attempt to repair a defective TV yourself. Always consult a skilled service person.

BEFORE CALLING SERVICE

Below is a list of frequently occurring symptoms. Before you call for service, make these simple checks. Some of these symptoms can easily be rectified if you know what to do.

Symptom	What you should do
Colour patch (unevenness)	<ul style="list-style-type: none">• Switch off the TV by the mains power button. Wait for 20 minutes before switching on again.• Check the TV is not placed too near speakers or magnetic objects.
No power	<ul style="list-style-type: none">• Check the TV's AC power cord is plugged into the mains socket. If there is still no power, disconnect plug. Wait for 60 seconds and re-insert plug. Switch on the TV again.
No picture	<ul style="list-style-type: none">• Check the antenna connection at the rear of the TV.• Possible TV station problem. Try another channel.
Good picture but no sound	<ul style="list-style-type: none">• Try increasing the volume.• Check that the sound is not muted. If it is muted, press the mute button on the remote control to restore sound.
Good sound but poor colour or no picture	<ul style="list-style-type: none">• Try increasing the contrast and brightness setting.
Snowish picture and noise	<ul style="list-style-type: none">• Check antenna connection at the rear of the TV.
Horizontal dotted lines	<ul style="list-style-type: none">• Possible electrical interference (e.g., hairdryer, vacuum cleaner). Switch off appliances.
Double images or "Ghost" images	<ul style="list-style-type: none">• Possible poor positioning of antenna. Using a highly directional antenna may improve reception.
TV not responding to remote control handset	<ul style="list-style-type: none">• Check life span of batteries of remote control handset.• Aim remote control handset directly at remote control sensor lens on the TV.

INSTALLATION

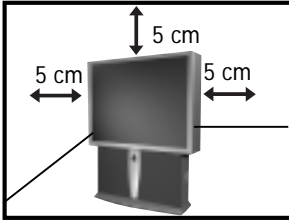

Positioning of the TV set

- Place your TV set on a solid base, strong enough to withstand the weight of the set.
- Leave a space of at least 5 cm around each side of the TV set to allow for proper ventilation.
- Do not place TV set near a radiator or other sources of heat.
- Do not place TV set where it can be exposed to rain or excessive moisture.

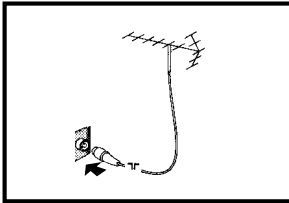

Connecting the Aerial

- Insert the aerial plug into the socket  at the rear of the set.

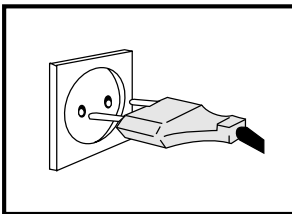

Connecting to the mains

- Insert the mains plug into the wall socket. (For correct mains voltage, refer to the type sticker at the rear of the set.)

Note : This diagram is not representative of the actual plug and socket.

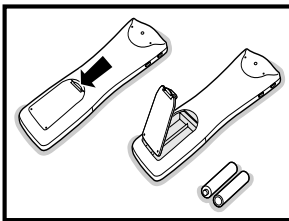

Using the Remote Control

Battery Usage CAUTION - To prevent battery leakage which may result in bodily injury or damage to the remote:

- Install ALL batteries correctly, + and - as marked on the remote control.
- Do not mix batteries: (OLD and NEW or CARBON and ALKALINE, etc.).
- Remove batteries when the remote is not used for a long time.

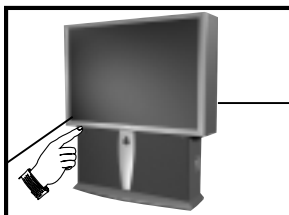

Switching on the TV set

- Press the mains power button to switch on/off the TV set.
- If the set is on standby mode (indicator light is red), press the Standby button on the remote control to switch on set.

CONNECTING THE AUDIO/VIDEO SOCKETS (PLAYBACK)

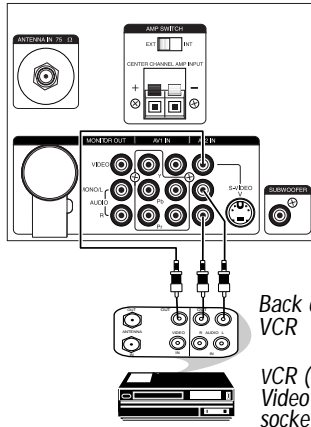

AV sockets
on rear of
TV

Back of
VCR

VCR (Equipped with
Video and Audio Output
sockets)

You can view the playback of VCR tapes (Video Disc players, camcorders, etc.) by using the AUDIO and VIDEO INPUT sockets on the rear of the TV.

- Connect the **VIDEO** and **AUDIO IN** sockets on the rear of the TV to the **AUDIO** and **VIDEO OUT** sockets on the VCR.

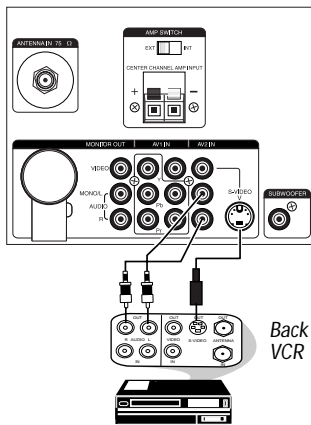

AV sockets
on rear of
TV

Back of S-VHS
VCR

The S-Video connection on the rear of the TV is used for the playback of S-VHS VCR tapes, Video Discs, Video Games or Compact Disc-Interactive (cd-i) discs. Better picture detail and clarity is possible with the S-Video playback as compared to the picture from a normal antenna (RF) connection.

- Connect the **S-VIDEO** socket on the rear of the TV to the **S-VHS OUT** socket on a S-VHS VCR.
- Connect the **AUDIO IN** sockets from the rear of the TV to the **AUDIO OUT** sockets on the VCR.

Note: You need not connect the **VIDEO IN** socket of the TV if **S-VIDEO IN** socket is connected.

CONNECTING THE AUDIO/VIDEO SOCKETS (PLAYBACK)

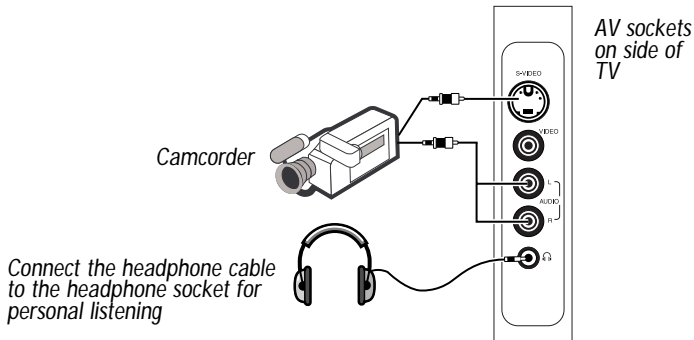

For more convenient direct playback connections, the Side Audio/Video Input sockets allow for quick and easy connections, particularly Camcorder tape recordings.

- Connect the **S-VIDEO** socket (if available) from the Camcorder to the Side **S-VIDEO** socket of the TV. You need not connect the Side **VIDEO IN** socket of the TV if the **S-VIDEO** socket is connected.
- Connect the **AUDIO OUT** sockets (Right and Left) from the Camcorder to the Side **AUDIO IN** sockets.

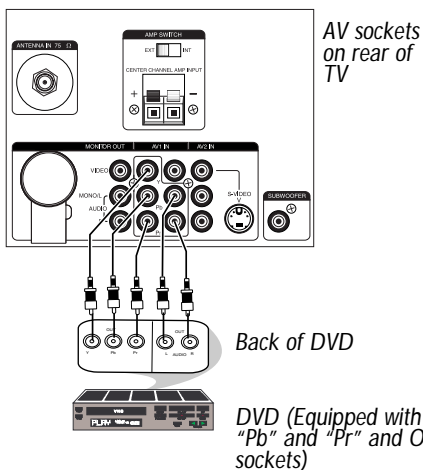

You can view the playback of DVD discs by using the **COMPONENT VIDEO INPUT** sockets on the rear of the TV.

- Connect the “**Y**,” “**Pb**” and the “**Pr**” **INPUT** sockets on the TV to the “**Y**,” “**Pb**” and “**Pr**” **OUTPUT** sockets on the DVD to view playback of DVD discs.

CONNECTING THE AUDIO/VIDEO SOCKETS (RECORDING)

Connection for recording from the TV channel

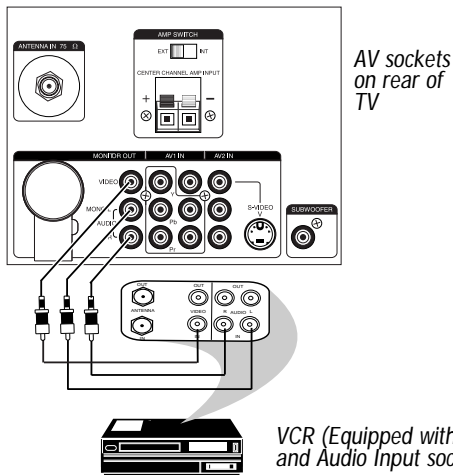

- Connect the corresponding **INPUT** sockets of the VCR to the **MONITOR OUTPUT** sockets on the rear of the TV.
- To enhance the sound of your TV, connect the **AUDIO L** and **R** sockets to an external audio system instead of the VCR. For mono equipment, connect only the **AUDIO L** socket.

Connection for recording from one VCR to another VCR

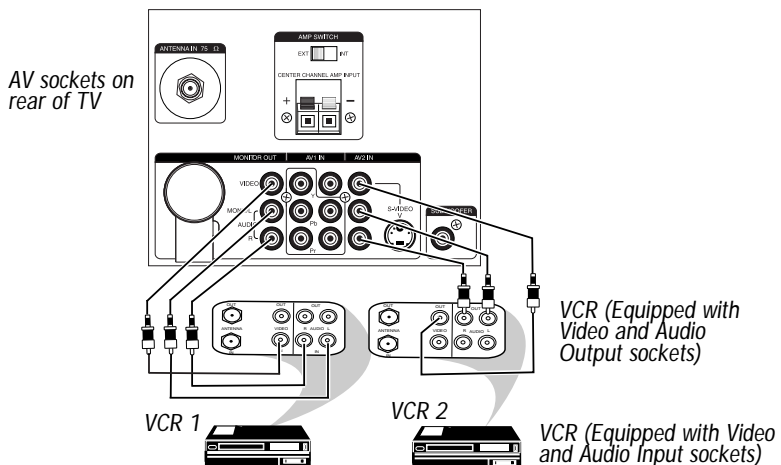

- Connect the sockets of the VCR which you wish to record from, to the corresponding sockets at either **AV1** or **AV2**.
- Connect the sockets of the receiving VCR to the **MONITOR OUTPUT** sockets on the rear of the TV.

EXTERNAL SPEAKER CONNECTIONS

Center Channel Amp Input

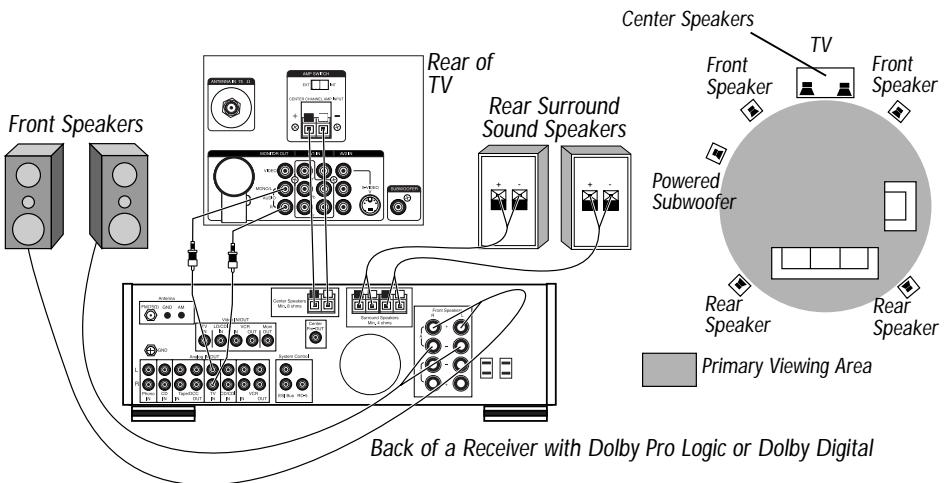

By adding an external audio system, you can create the feeling of reflected sound that surrounds you at a movie theater or concert hall.

- Connect the corresponding **OUTPUT** sockets of a receiver with Dolby Pro Logic* or Dolby Digital to the **CENTER CHANNEL AMP INPUT** sockets on the rear of the TV.
- Connect the corresponding **INPUT** sockets of the receiver to the **AUDIO L** and **R** sockets on the rear of the TV.
- Connect the front speakers and the rear surround sound speakers to the receiver.

Note

- To use a receiver with Dolby Pro Logic or Dolby Digital with your TV, the TV's **AUDIO OUT** control must be set to **"FIXED."** (Refer to the sections on "Using the Picture Menu" and "Using the Sound Menu.")
- You must have the **AMP SWITCH** on the rear of the TV in the **EXT** position for the center channel speakers to operate.

*"Dolby," "Pro Logic," and the double-D symbol  are trademarks of Dolby Laboratories.

EXTERNAL SPEAKER CONNECTIONS (CONTINUED)

External Powered Subwoofer Connection

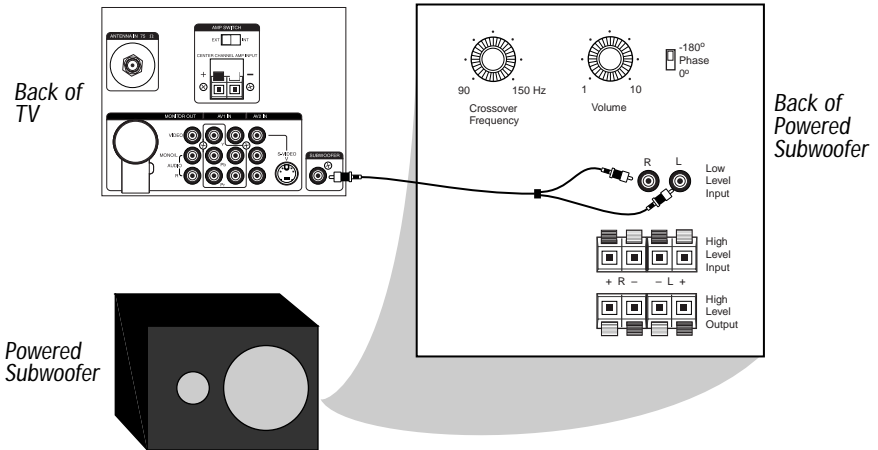

- Connect the **INPUT** sockets of a powered subwoofer to the **SUBWOOFER** socket on the rear of the TV. You can use a y-shaped cable to make the connection. You can also use a single cable and connect to either the **R** or **L Low Level Input** sockets.

Note

- If you use a single cable to make the connection to the powered subwoofer, you will need to increase the volume on the back of the subwoofer to compensate for the absence of the second cable.
- The powered subwoofer trim must be adjusted from the external powered subwoofer.

FUNCTIONS OF REMOTE CONTROL

- 1 **SLEEP**
Allows you to select a time period after which the set will switch to standby mode automatically.
- 2 **OSD**
– Displays the channel number, sound and colour transmission mode, status of the sleep timer, channel name (if channel is named) and the current time (if current time is being entered in the Timer menu).
– Also allows you to exit menu from screen.
- 3 **AV**
Allows you to select the AV channels.
- 4 **DIGIT (0-9)**
Allows you select a channel. **Note** : For a 2-digit number, the second digit must be entered before the “-” sign disappears.
- 5 **SMART SOUND**
Allows you to select your desired sound setting from 4 types of sound settings.
- 6 **MENU**
Displays main menu. Also exits menu from screen.
- 7 **CURSOR UP**
Allows you to select the next item on the menu.
- 8 **CURSOR LEFT**
Allows you to access the sub-menus and adjust the settings.
- 9 **VOLUME + / -**
Increases or decreases volume.
- 10 **A/CH**
Allows you to alternate between the last viewed channel and the present channel.
- 11 **VIRTUAL DOLBY SURROUND***
– Allows you to select Stereo, Incredible Surround, or Virtual Dolby Surround sound when transmission is in Stereo.
Note: Selecting Virtual Dolby Surround will allow you to enjoy the sensation of Home Cinema surround sound with just 2 front speakers.
– Allows you to select Spatial or Mono when transmission is in Mono.
- 12 **STEREO/SAP**
– Allows you to select Stereo or Mono when transmission is in Stereo.
– Allows you to select Dual I or Dual II during dual sound transmission.

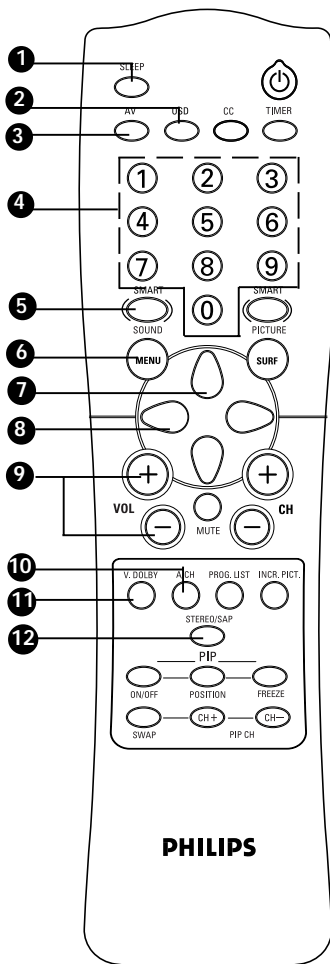

*Manufactured under license from Dolby Laboratories.
“Dolby,” “Virtual Dolby Surround” and the double-D symbol  are trademarks of Dolby Laboratories.

FUNCTIONS OF REMOTE CONTROL

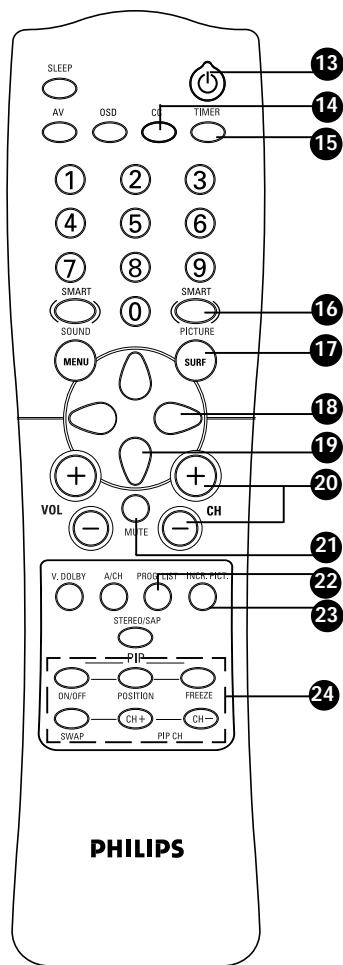

- 13 STANDBY**
- Switch set off temporarily to standby mode. (The red light indicator lights up when set is in standby mode.)
 - To switch on set from standby mode, press Channel Up/Down, Digit (0-9) or Standby button.
- 14 CC (Closed Captioning) Button**
- Allows the hearing impaired to read the voice content of television programs when "ON" option is selected. To select your desired caption mode, refer to the section on "Using the Closed Captioning Control."
- 15 TIMER**
- Allows you to set the clock to switch to another channel at a specified time while you are watching a channel or when the set is in standby mode.
- 16 SMART PICTURE**
- Allows you to select your desired picture setting from 5 types of picture settings.
- 17 SURF**
- Allows you to select up to a maximum of 10 channels and view quickly the selected channels.
- 18 CURSOR RIGHT**
- Allows you to access the sub-menus and adjust the settings.
- 19 CURSOR DOWN**
- Allows you to select the next item on the menu.
- 20 CHANNEL + / -**
- Selects channel in ascending or descending order.
- 21 MUTE**
- Mutes sound. To restore sound, press button again.
- 22 PROGRAM LIST**
- Allows you to navigate through a list of installed programmes for a quick overview of the channels and activate the channel you have selected.
- 23 INCREDIBLE PICTURE**
- Allows you to view a more vivid and realistic picture with better contrast when the "ON" function is selected.
- 24 PIP**
- Allows you to access the Picture-in-Picture and Double Window features. (For more detailed description of functions, refer to section on "Activating the PIP and Double Window Control.")

FUNCTIONS OF TV CONTROLS (43PP925)

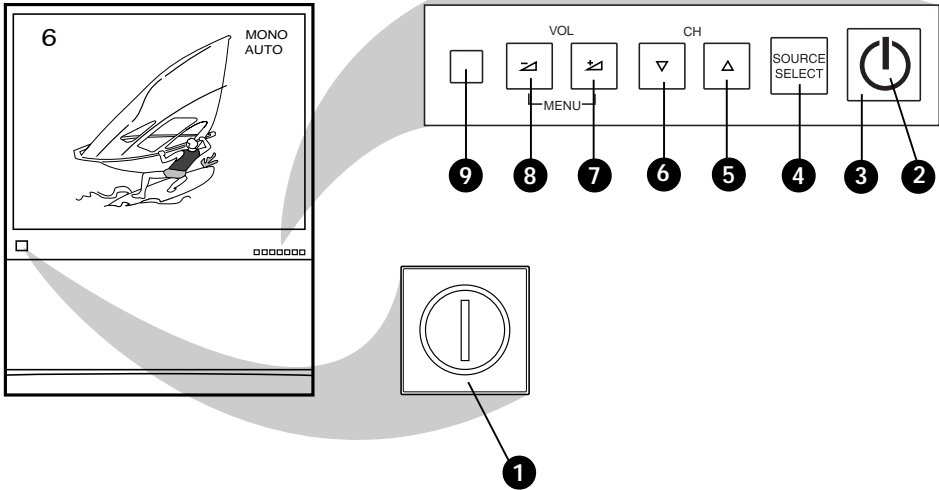

1	Mains Power button	Switch mains power on or off.
2	Power/Standby button	Switch TV on or activate standby mode.
3	Standby Light Indicator	Indicates red light when standby mode is activated.
4	Source Select button	Cycle through the signal sources.
5	Channel Δ button	Select channel in ascending order.
6	Channel ∇ button	Select channel in descending order.
7	Volume \nearrow button	Adjust the sound volume louder.
8	Volume \searrow button	Adjust the sound volume softer. Note <ul style="list-style-type: none"> You can enter the main menu by pressing both the Volume \nearrow and \searrow buttons at the same time. Press the Channel Δ or ∇ button to select the next item on the menu. Press the Volume \nearrow or \searrow button to access the sub-menus and adjust the settings.
9	Remote Sensor	Acts as a sensor for activating the controls of the TV when the remote control handset is aimed at it.

Note: When the Mains Power button has been pressed so that the TV is in Power/Standby mode, you can press any of the TV's other controls to turn the set on.

FUNCTIONS OF TV CONTROLS (50PP925 AND 55PP925)

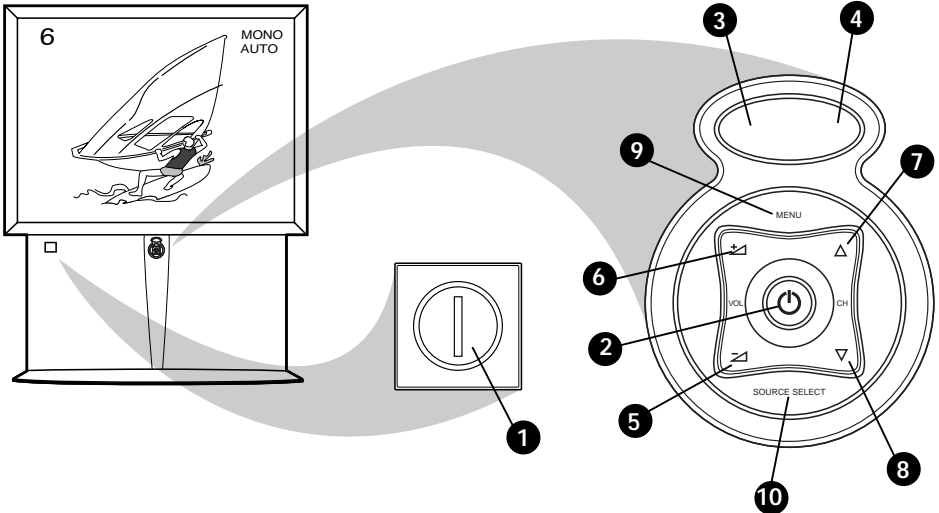

1	Mains Power button	Switch mains power on or off.
2	Power/Standby button	Switch TV on or activate standby mode.
3	Standby Light Indicator	Indicates red light when standby mode is activated.
4	Remote Sensor	Acts as a sensor for activating the controls of the TV when the remote control handset is aimed at it.
5	Volume ∇ button	Adjust sound volume softer.
6	Volume \blacktriangle button	Adjust sound volume louder.
7	Channel \blacktriangle button	Select channel in ascending order.
8	Channel ∇ button	Select channel in descending order.
9	Menu button	Display the main menu. Note <ul style="list-style-type: none"> • Press the Channel \blacktriangle or ∇ button to select the next item on the menu. • Press the Volume \blacktriangle or ∇ button to access the sub-menus and adjust the settings.
10	Source Select button	Cycle through the signal sources.

Note: When the Mains Power button has been pressed so that the TV is in Power/Standby mode, you can press any of the TV's other controls to turn the set on.

SELECTING THE MENU LANGUAGE, TUNER MODE AND AUTOMATIC TUNING OF CHANNELS

Before you tune in the channels by the Auto Store method, select the desired menu language and tuner mode. **Note:** The available menu languages will vary based on region.

Press button

Result on TV Screen

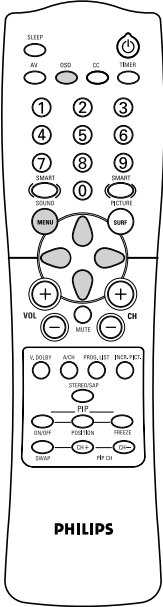

1. Enter main menu.
2. Press button repeatedly until **INSTALL** is selected.
3. Enter **INSTALL** menu.
4. Enter **LANGUAGE** mode.
5. Select desired language.
- OR
6. Exit from language mode.
7. Select **TUNER MODE**.
8. Enter **TUNER MODE** menu.
9. Select desired tuner mode (**AUTO**, **CABLE** or **ANTENNA**).
- OR
10. Exit tuner mode.
11. Select **AUTO PROGRAM**.
12. Enter **AUTO PROGRAM** mode.
13. Start automatic tuning.
- OSD
14. When tuning is completed, exit menu from screen.

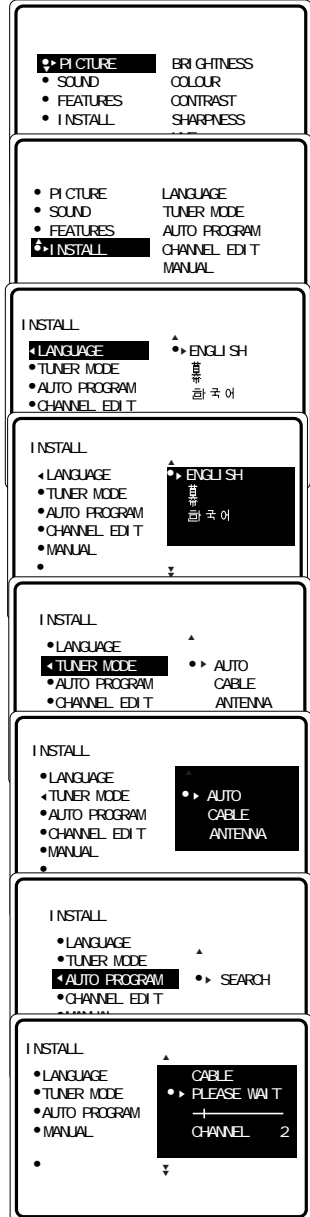

FINE TUNING OF CHANNELS

This feature allows you to adjust picture reception in areas of weak reception.

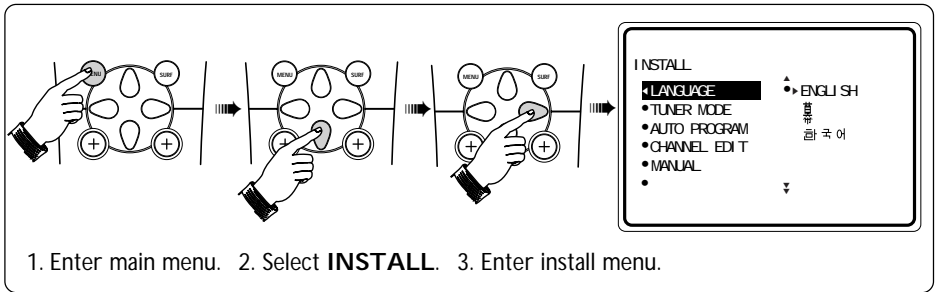

Press button

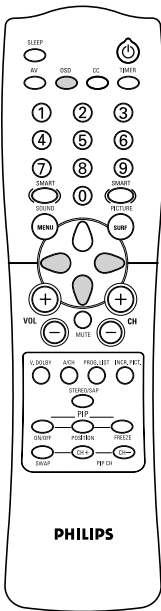

4. Press button repeatedly until **MANUAL** is selected.
5. Enter **MANUAL** menu.
6. Start fine-tuning until desired picture and sound are obtained.
7. Select **STORE**.
8. Store last fine-tuned status.
9. Exit menu from screen.

Result on TV Screen

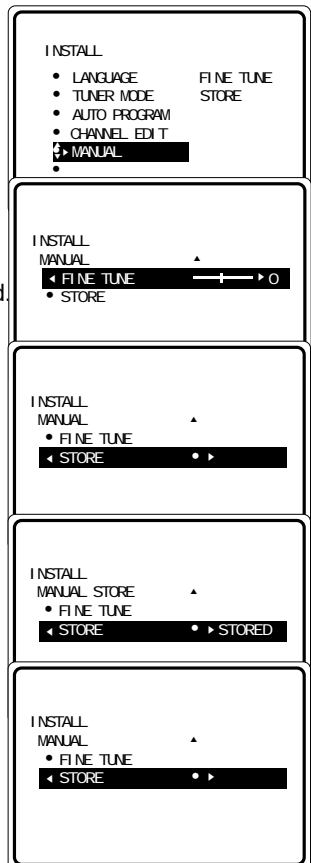

EDITING OF CHANNELS

This feature allows you to edit or skip channels which have bad or weak TV signal or channels that you do not watch often.

Note : Once a channel is skipped, you cannot have access to it by the **CHANNEL +** or **-** button. You can only access the channel by the **DIGIT (0-9)** button.

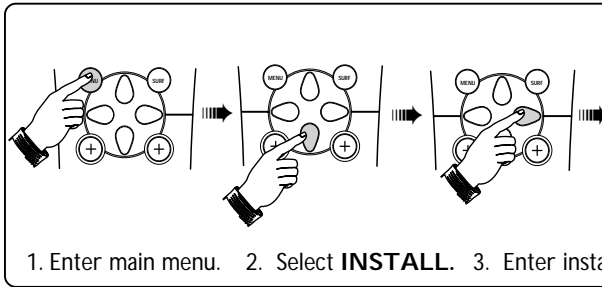

I INSTALL

- LANGUAGE
- TUNER MODE
- AUTO PROGRAM
- CHANNEL EDIT
- MANUAL

▲ ENGLISH
▶ 한국어

1. Enter main menu. 2. Select **INSTALL**. 3. Enter install mode.

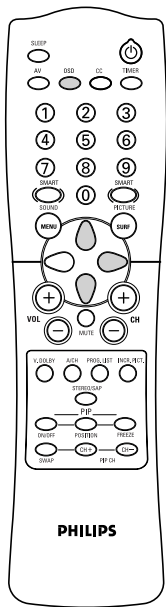

Press button

4. Press button repeatedly until **CHANNEL EDIT** is selected.
5. Enter channel edit mode.
6. Select the channel you want to skip.
- OR
7. Activate skipped mode.
8. Exit menu from screen.

Result on TV Screen

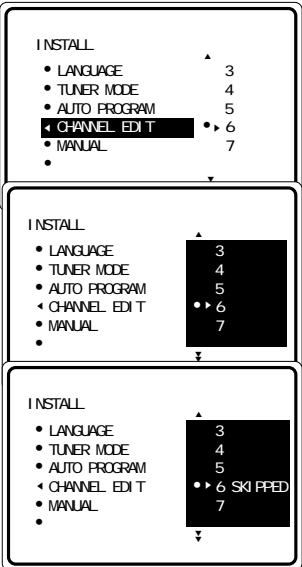

I INSTALL

- LANGUAGE
- TUNER MODE
- AUTO PROGRAM
- CHANNEL EDIT
- MANUAL

I INSTALL

- LANGUAGE
- TUNER MODE
- AUTO PROGRAM
- CHANNEL EDIT
- MANUAL

I INSTALL

- LANGUAGE
- TUNER MODE
- AUTO PROGRAM
- CHANNEL EDIT
- MANUAL

How to add back channels

- Repeat steps 1 to 5 as in "Editing of Channels."
- Select the channel you want to add back by the **UP** (CURSOR UP) or **DOWN** (CURSOR DOWN) button.
- Press the **RIGHT** (CURSOR RIGHT) button to activate adding back of channel.
- Exit menu from screen by the **OSD** (OSD) button.

NAMING OF CHANNELS

This feature allows a selection of 50 pre-defined names. It also allows you to enter a new name or modify an existing name according to your personal preference.

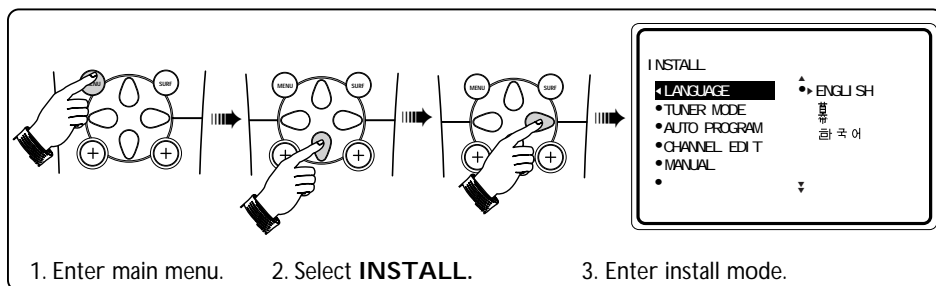

Press button

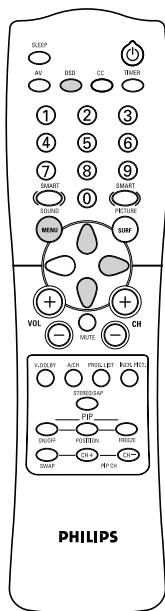

4. Press button repeatedly until **NAME** is highlighted.



5. Enter **NAME** mode.



6. Select desired preset name and press (**CURSOR RIGHT**) button to store selected pre-set name.

OR



7. If you select **PERSONAL**, move to first character slot



8. Press button repeatedly to cycle through the characters and select desired character. Move to next character slot by the (**CURSOR RIGHT**) button and select in the next character. (You can enter up to a maximum of 5 characters.)



OR



9. Store named channel.







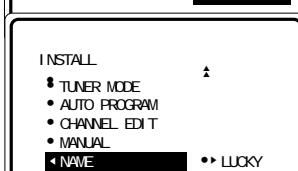
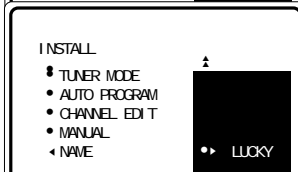
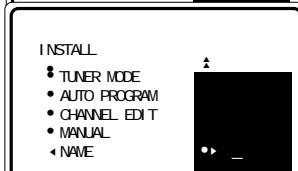
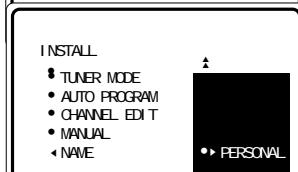
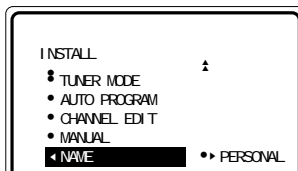

10. Exit menu from screen.

Result on TV Screen



USING THE PICTURE MENU

The picture menu allows you to make adjustments to the picture. It also allows you to select and activate other features in the menu.

1. Press the  (**MENU**) button to enter main menu.
2. Press the  (**CURSOR RIGHT**) button to enter the **PICTURE** menu.
3. Press the  or  (**CURSOR UP/DOWN**) buttons to select the items on the **PICTURE** menu.
4. Press the  or  (**CURSOR LEFT/RIGHT**) buttons to adjust or change settings.





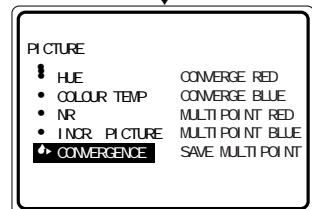
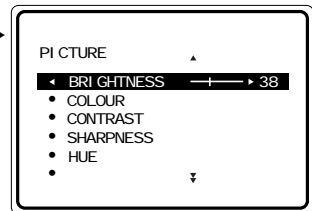

Note: To enter the **CONVERGENCE** sub-menu, select **CONVERGENCE** and press the  (**CURSOR RIGHT**) button. See the section on **CONVERGENCE** for instructions in how to adjust the **CONVERGENCE** controls.

Picture menu items	Activities
Brightness	Increase or decrease brightness level.
Colour	Increase or decrease color level.
Contrast	Increase or decrease contrast level until lightest parts of the picture show good detail.
Sharpness	Increase or decrease sharpness level to improve detail in the picture.
Hue	Increase or decrease hue level.
Colour Temp	Allows you a choice of 3 picture settings (NORMAL, WARM and COOL).
NR (Noise Reduction)	Allows you to reduce the "noise" (little dots on the picture) from weak signal broadcast. Selecting the "ON" option will make the picture clearer.
Incredible Picture	Selecting the "ON" option enhances the details in the picture. The result is a more dynamic and vivid picture.
Convergence	Allows you to adjust how the red, green, and blue colour components of the picture come together on the screen.



USING THE SOUND MENU

The sound menu allows you to make adjustments to the sound. It also allows you to select and activate other features in the menu.





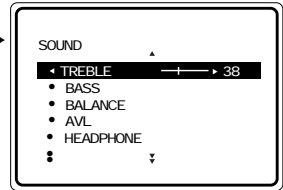

1. Press the  (**MENU**) button to enter main menu.
2. Press the  (**CURSOR DOWN**) button to select the **SOUND** menu.
3. Press the  (**CURSOR RIGHT**) button to enter the **SOUND** menu.
4. Press the  or  (**CURSOR DOWN/UP**) buttons to select the items on the **SOUND** menu.
5. Press the  or  (**CURSOR LEFT/RIGHT**) buttons to adjust or change settings.

Note: See the instructions below for adjusting the **HEADPHONE** settings.

Sound menu items	Activities
Treble	Increase or decrease the high frequency level.
Bass	Increase or decrease the low frequency level.
Balance	Adjusts the balance of the right and left speakers' sound output.
AVL (Auto Volume Leveller)	As variation in signal conditions can result in a sudden change in volume during commercial breaks or channel switching, selecting the "ON" function will enable the volume to remain at a standard volume level.
Incredible Surround	Allows you to dramatically expand the wall of sound that surrounds the listener and heighten overall viewing pleasure.
Headphone	Allows you to adjust the volume and balance of the headphone.
Audio Out	You can connect an external audio system to enhance the sound of your TV. Selecting "VARIABLE" allows you to change the volume at the TV using the TV's remote control. Choosing "FIXED" allows you to adjust the volume at the receiver using the receiver's controls.
Note: You may have to set your external audio system to Auxiliary mode to play sound from your TV.	
Speakers	Allows you to turn the TV's speakers "ON" or "OFF."
Bass Boost	Increases the low frequency range. This creates a deeper, fuller sound.



How to adjust the HEADPHONE settings

- With **HEADPHONE** selected, press the  (**CURSOR RIGHT**) button to enter the **HEADPHONE** sub-menu.
- Press the  or  (**CURSOR DOWN/UP**) buttons to select **VOLUME** or **BALANCE**.
- Press the  or  (**CURSOR LEFT/RIGHT**) buttons to adjust settings.
- Press the  (**MENU**) button to return to the **SOUND** menu.

Note: **STEREO** and **SAP** (Second Audio Program) features are offered in some areas. SAP is an additional audio channel. The SAP channel usually is used to provide a second language translation for a programme that is being shown.

CONVERGENCE (CONVERGE RED/BLUE)

Due to the influence of magnetic fields and changes in the position of the TV, the red, blue, and green screen colours may not align properly. The result is that red or blue colours may appear around the edges of images. If various images on the entire picture have red outlines, adjust **CONVERGE RED**. Then if any red outlines remain, adjust **MULTIPOINT RED**. If various images on the entire picture have blue outlines, adjust **CONVERGE BLUE**. Then if any blue outlines remain, adjust **MULTIPOINT BLUE**. Use **UNDO MULTIPOINT** if you want to restore the picture screen to the way it was before you made Multipoint adjustments.

Note

- After turning the TV set on, allow it to warm up for 15 minutes before adjusting Convergence.
- If you adjust Convergence and then change your signal source from PAL to NTSC or from NTSC to PAL, you may need to readjust Convergence for the new signal source.

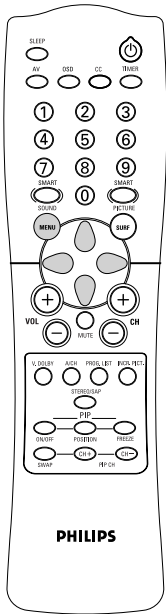

Press button

1. Enter main menu.
2. Enter **PICTURE** menu.
3. Press button repeatedly until **CONVERGENCE** is selected.
4. Enter **CONVERGENCE** menu.
5. Enter **CONVERGE RED** mode.
6. Adjust cross image until colour outline is gone.
7. Exit menu from screen.

Result on TV Screen

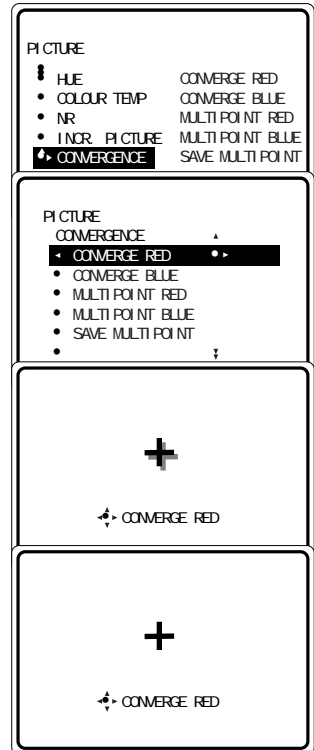

Note: You can adjust **CONVERGE BLUE** similar to the way you would adjust **CONVERGE RED**.

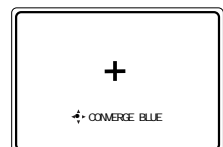
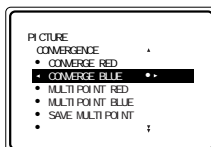
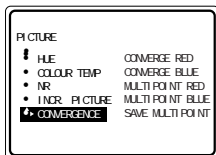









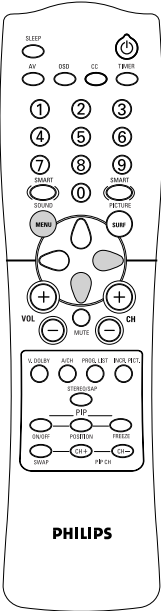

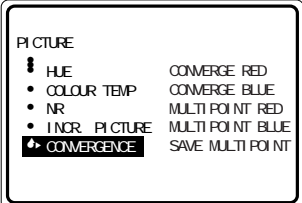
CONVERGENCE (MULTIPOINT RED/BLUE)

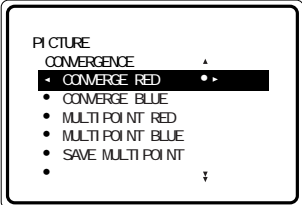
If various images on the entire picture have red outlines, adjust **CONVERGE RED**. Then if any red outlines remain, adjust **MULTIPOINT RED**. If various images on the entire picture have blue outlines, adjust **CONVERGE BLUE**. Then if any blue outlines remain, adjust **MULTIPOINT BLUE**. Use **UNDO MULTIPOINT** if you want to restore the picture screen to the way it was before you made Multipoint adjustments.

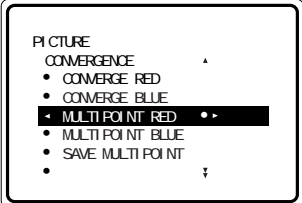
Note

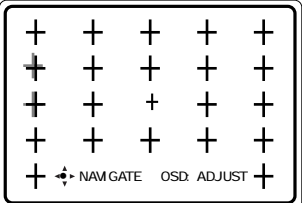
- After turning the TV set on, allow it to warm up for 15 minutes before adjusting Convergence.
- You can use Multipoint Red and Multipoint Blue controls to adjust 25 Convergence points on the screen.
- If you adjust Convergence and then change your signal source from PAL to NTSC or from NTSC to PAL, you may need to readjust Convergence for the new signal source.

	Press button		Result on TV Screen
 <p style="text-align: center;">PHILIPS</p>		1. Enter main menu.	
		2. Enter PICTURE menu.	
		3. Press button repeatedly until CONVERGENCE is selected.	
		4. Enter CONVERGENCE menu.	
		5. Press button repeatedly until MULTIPOINT RED is selected.	
		6. Enter NAVIGATE mode.	

CONVERGENCE (MULTIPOINT RED/BLUE) (CONTINUED)

Press button

Result on TV Screen

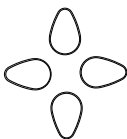
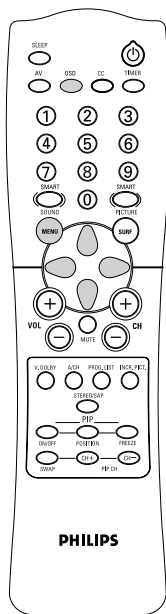

7. Navigate to a cross image that has a colour outline.
Note: To display three hidden cross images, navigate to bottom row.

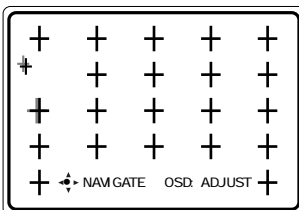

8. Enter **ADJUST** mode.

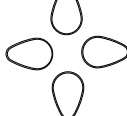

9. Adjust cross image until colour outline is gone.

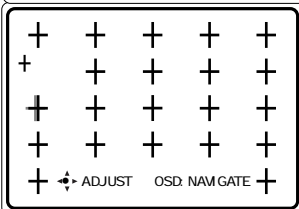

10. Return to **NAVIGATE** mode.

Repeat steps 7 to 10 until all misaligned crosses have been adjusted.

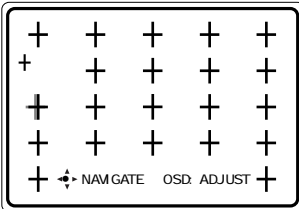

11. Return to **CONVERGENCE** menu.

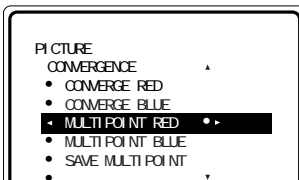

12. Press button repeatedly until **SAVE MULTIPOINT** is selected.

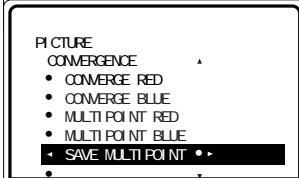

13. Activate storing of Multipoint adjustments.

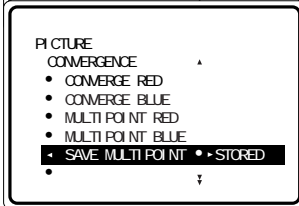

14. Exit menu from screen.

Note: You can adjust **MULTIPOINT BLUE** similarly to the way you would adjust **MULTIPOINT RED**.

CONVERGENCE (UNDO MULTIPOINT)

UNDO MULTIPOINT allows you to restore the TV's picture screen to the way it was before you made Multipoint adjustments.

Press button

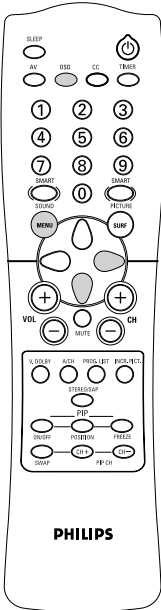

1. Enter main menu.
2. Enter **PICTURE** menu.
3. Press button repeatedly until **CONVERGENCE** is selected.
4. Enter **CONVERGENCE** menu.
5. Press button repeatedly until **UNDO MULTIPOINT** is selected.
6. Activate restoring of previous picture screen.
7. Exit menu from screen.

Result on TV Screen

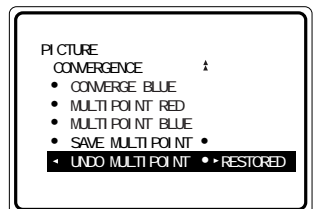
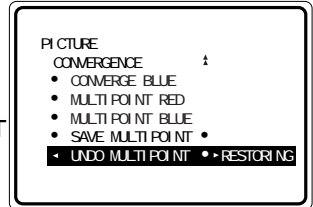
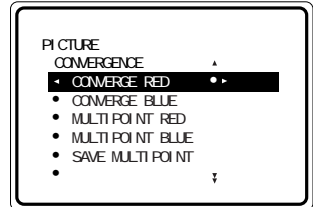
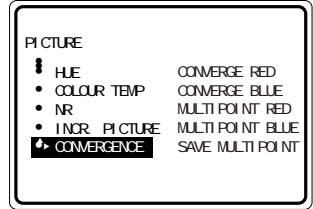

ACTIVATING THE TIMER

The Timer feature allows you to set the timer to switch to another channel at a specified time while you are watching another channel or when the TV is on standby mode.

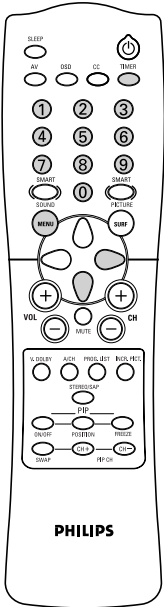

Press button

1. Enter **TIMER** menu.
2. Enter **TIME** mode.
3. Key in the current time
For example, if the current time is 12:30, key digit 1 and 2 in the hour column, followed by digit 3 and 0 in the minute column.
4. Exit from **TIME** mode.
5. Select **START TIME**.
6. Enter the **START TIME** mode.
7. Key in the time you want the programme to be switched on.
8. Exit from **START TIME** mode.
9. Select **STOP TIME**.
10. Enter **STOP TIME** mode.
11. Key in the time you want the programme to be switched off.

Result on TV Screen

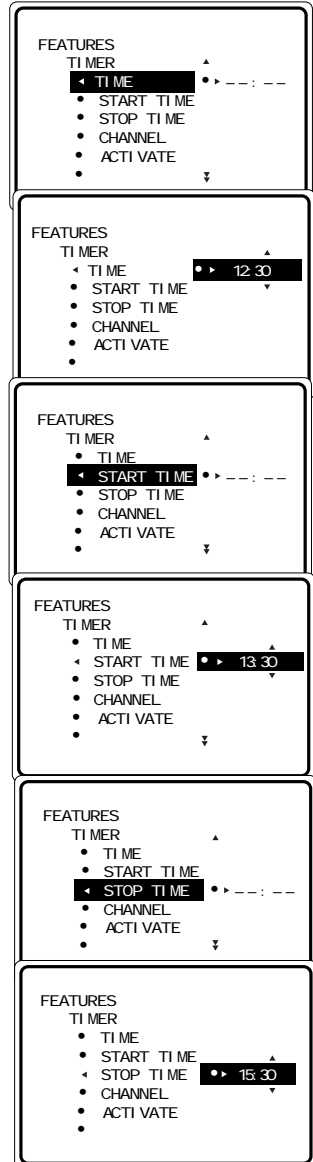

ACTIVATING THE TIMER (CONTINUED)

Press button

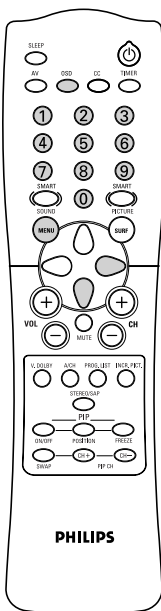

12. Exit from **STOP TIME** mode.



13. Select **CHANNEL**.



14. Key in the channel you want to switch to.



15. Select **ACTIVATE**.



16. Activate timer. You can select to activate timer by **DAILY** or **ONCE** mode.



17. Select **DISPLAY**.



18. Select **ON** mode if you want to display the current time on the TV screen.



19. Exit menu from screen.

Result on TV Screen

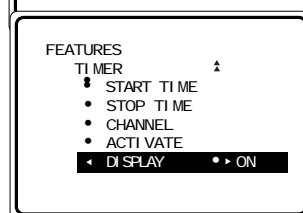
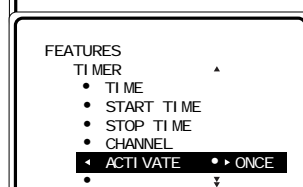
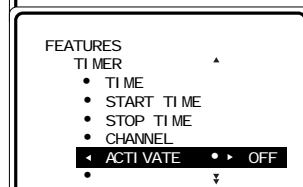
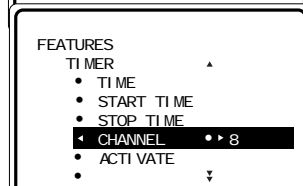
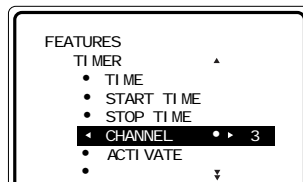

Note

30 seconds before the timer is activated, a message indicating the time left for the channel switch will appear on the screen. To disable the channel switch, press any button on the remote control.

ACTIVATING THE CHILD LOCK (ACCESS CODE)

The Child Lock feature allows you to lock channels to prevent your children from watching programmes you deem undesirable.

Note : You cannot have access to the locked channels via the TV set's controls.

You can only have access to the locked channels via the remote control. Keep the remote control out of reach so as to prevent your children from having access to it.

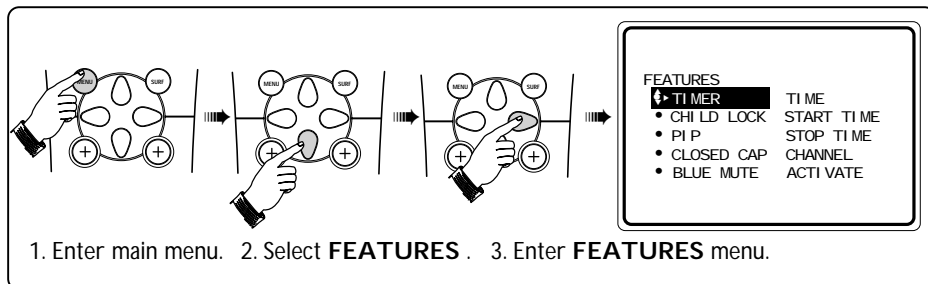

Press button

Result on TV Screen

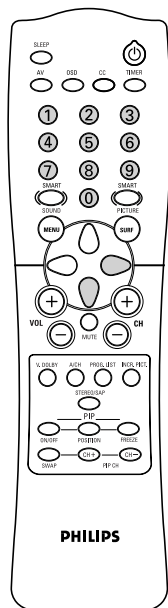

4. Select **CHILD LOCK**.

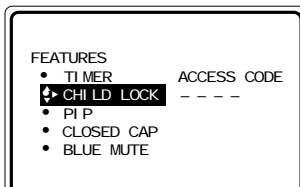

5. Enter **ACCESS CODE** mode.

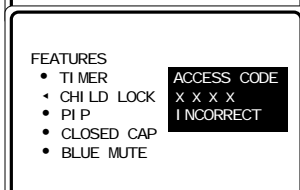

6. Key in access code **0711** (0711 is the default access code). A message **INCORRECT** will appear.

7. Key in **0711** the second time. When the message **CORRECT** appears, the **CHILD LOCK** menu is now accessible.

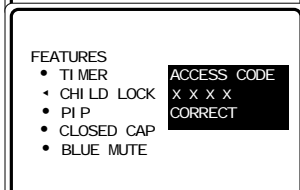

You can now proceed to change the access code of your choice.

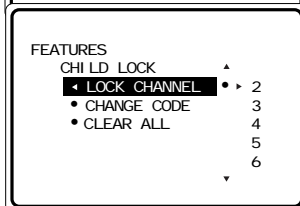

ACTIVATING THE CHILD LOCK (CHANGE CODE)

Press button

Result on TV Screen

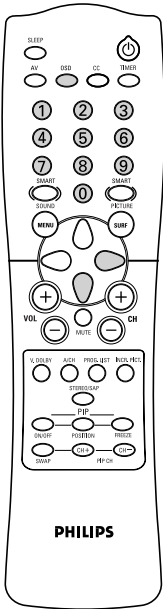

8. Select **CHANGE CODE**.

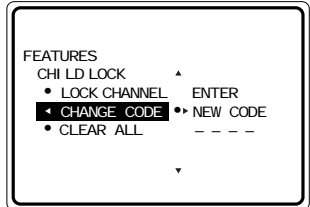

9. Enter **CHANGE CODE** mode.

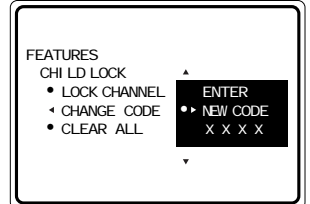

10. Key in the access code of your choice.

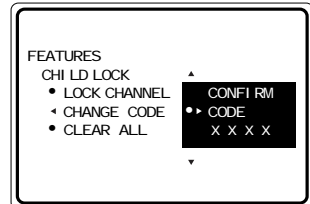

11. Confirm access code.

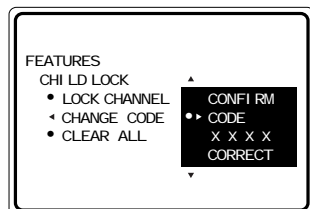

When the new code is confirmed, the message **CORRECT** will appear.



12. Exit menu from screen.

Note : After you have exited menu from screen and you want to enter child lock menu again, you need to key the new access code only once. If you have forgotten the new access code, key in 0711 twice to enter the child lock menu. Upon entering the child lock menu, you can proceed to change code again.

ACTIVATING THE CHILD LOCK (LOCK CHANNEL)

1. Enter main menu. 2. Select **FEATURES**. 3. Enter **FEATURES** menu.

FEATURES

- ▶ **TIMER** TIME
- **CHILD LOCK** START TIME
- **PIP** STOP TIME
- **CLOSED CAP** CHANNEL
- **BLUE MUTE** ACTIVATE

Press button

Result on TV Screen

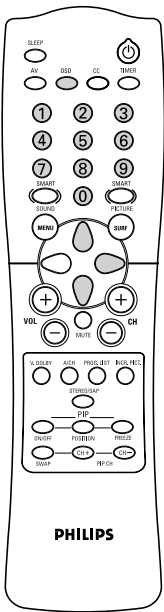

4. Select **CHILD LOCK**.
5. Enter **ACCESS CODE** mode.
6. Key in access code.
7. Enter **LOCK CHANNEL** mode.
8. Select the channel you want to block.
9. Activate blocking of channel. A keylock symbol will appear beside the channel number indicating that it is locked.
10. Exit menu from screen.

FEATURES

- **TIMER** ACCESS CODE
- ▶ **CHILD LOCK** -----
- **PIP**
- **CLOSED CAP**
- **BLUE MUTE**

FEATURES

- **TIMER** ACCESS CODE
- **CHILD LOCK** X X X X
- **PIP** CORRECT
- **CLOSED CAP**
- **BLUE MUTE**

FEATURES

CHILD LOCK

- ▶ LOCK CHANNEL
- CHANGE CODE
- CLEAR ALL

FEATURES

CHILD LOCK

- ▶ LOCK CHANNEL
- CHANGE CODE
- CLEAR ALL

Note : You cannot have access to the locked channels via the TV set's controls. You can only have access to the locked channels via the remote control. When AV1 source is locked, CV1 source is automatically locked. Likewise, if CV1 source is locked, AV1 source is also automatically locked, as they share the same audio input.

If you attempt to enter the **INSTALL** menu after locking a channel, a message "Enter **ACCESS CODE**" will appear on the screen. You need to enter the **ACCESS CODE** to enable you to enter the **INSTALL** menu.

ACTIVATING THE CHILD LOCK (CLEAR ALL)

To unlock all channels that you have locked, enter the Child Lock menu and activate the **CLEAR ALL** mode.

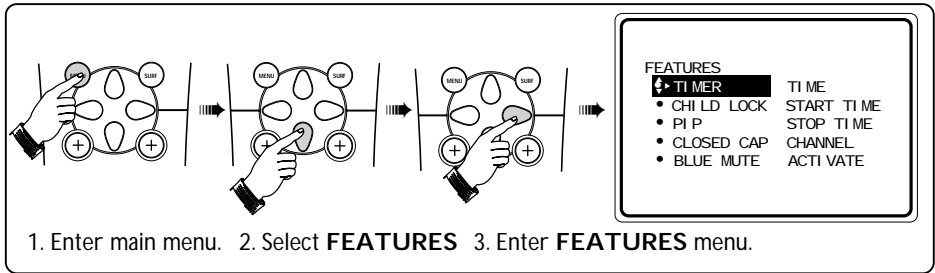

Press button	Result on TV Screen
4. Select CHILD LOCK .	
5. Enter ACCESS CODE mode.	
① ② ③ ④ ⑤ ⑥ ⑦ ⑧ ⑨ ⑩	6. Key in access code.
7. Press button repeatedly until CLEAR ALL is selected.	
8. Activate clearing of all locked channels.	
9. Exit menu from screen.	

Note

You can also unlock individual channels by the **LOCK CHANNEL** menu.

- Repeat **step 1 to 7** as in “**ACTIVATING THE CHILD LOCK (LOCK CHANNEL).**”
- Select the channel you want to unlock by the or (**CURSOR UP / DOWN**) buttons.
- Press the (**CURSOR RIGHT**) button to unlock channel (the keylock symbol will disappear).

USING THE CLOSED CAPTIONING CONTROL

Closed Captioning (CC) allows you to read the voice content of television programmes on the TV. Designed to help the hearing impaired, this feature uses on-screen "text boxes" to show dialogue and conversations while the TV programme is in progress.

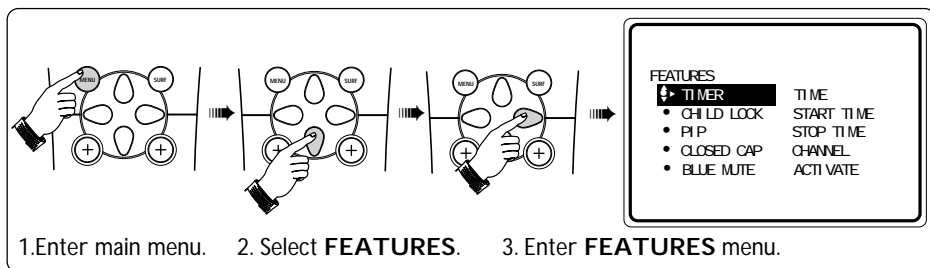

Press button

Result on TV Screen

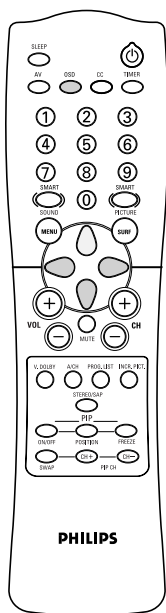

4. Select **CLOSED CAP**.

5. Enter **CLOSED CAP** menu.

6. Enter **CAPTION MODE** mode.

7. Select your desired caption mode. You can choose caption or in text mode. There are 5 types of caption (**CC1, CC2, CC3, CC4** and **CC MUTE**) and 4 types of text (**TXT1, TXT2, TXT3** and **TXT4**).

8. Exit from **CAPTION MODE**.

9. Select **CC DISPLAY**.

10. Select **ON** to display Closed Captioning on screen.

11. Exit menu from screen.

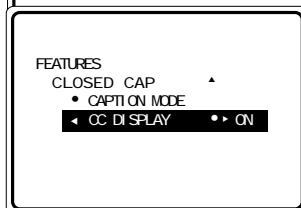
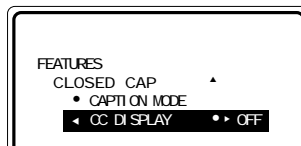
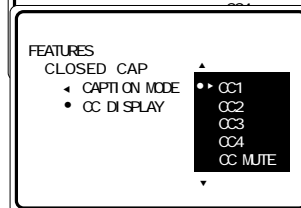
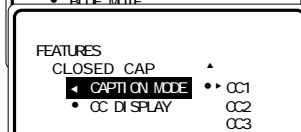
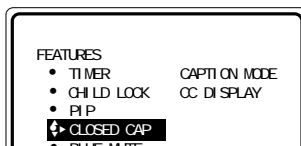

USING THE CLOSED CAPTIONING CONTROL

Example of a CAPTION mode



Caption 1, 2, 3 or 4

During screening, dialogues (or descriptions) for the captioned television programme appear on the screen. The text can appear up to 4 rows simultaneously anywhere on the screen.

Example of a TEXT mode

Closed Caption Programme on TCS

All items are based on standard time (est). Check local listings for the time in your area.

08 : 00 Things People Do

10 : 00 Dining in Style

12 : 00 News at Noon

12 : 30 The Animal Kingdom

TEXT 1, 2, 3 or 4

Text mode is often used for channel guides, schedules or bulletin board information when programmes with Closed Captioning are shown. The complete screen is used for displaying the text.

IMPORTANT

1. Not all television programmes and product commercials are made for broadcast with Closed Captioning information included. Neither are all Closed Captioning modes (Caption 1 to 4 or TEXT 1 to 4) necessarily being used by a broadcast station during transmission of a programme with Closed Captioning. Check with your local listings for details.
2. A broadcast station will often use spelling abbreviations, symbols and other grammatical short-cuts in order to keep pace with the on-screen action. These vary with the source of the captioned text material and do not indicate a need for the service of the television.

USING THE SURF CONTROL

A list or series of previously viewed channels can be selected with the **SURF** button. This feature allows you to switch between different TV programmes that currently interest you. You can set up to a maximum of ten channels in the **SURF** list.

How to add a channel to the surf list

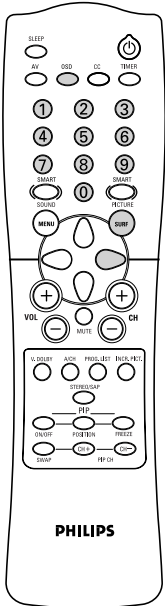

Press button



1. Select a channel you want to add to the surf list.



2. Enter **SURF** menu.



3. Add selected channel to the surf list.

Repeat steps 1 - 3 to add more channels to the surf list.



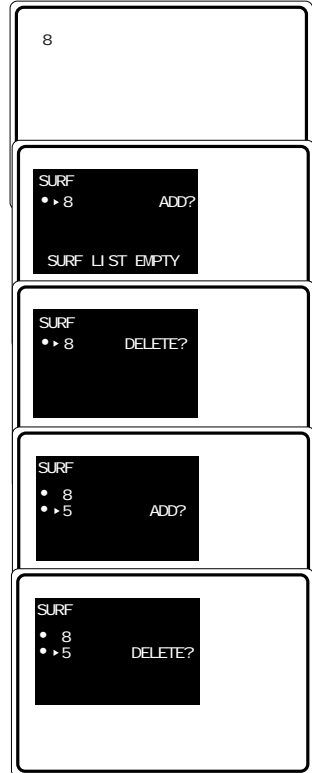

4. After you have completed adding the selected channels to the surf list, exit menu from screen.

Result on TV Screen



Note : To view the the selected channels in the surf list, press the **SURF** button repeatedly to cycle through the channels.

How to delete a channel from the surf list

1. Press the  (**SURF**) button to display surf list.
2. Press the  (**SURF**) button repeatedly to cycle through the surf list and select the channel you want to delete.
3. Press the  (**CURSOR RIGHT**) button to delete channel from the surf list.
4. Repeat all the above steps if you want to delete more channels from the surf list.

ACTIVATING THE BLUE MUTE CONTROL

The Blue Mute feature indicates to you the absence of signal in the transmission when the "ON" option is activated. Upon the detection of absence of signal, the TV screen will turn blue in colour.

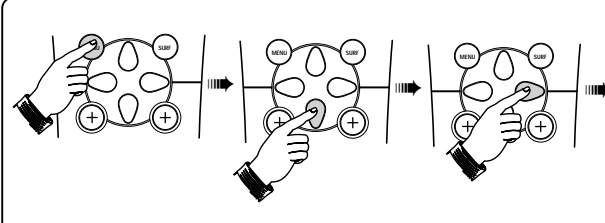



FEATURES

- TI MER
- CHI LD LOCK
- PI P
- CLOSED CAP
- BLUE MUTE

TI ME
START TI ME
STOP TI ME
CHANNEL
ACTI VATE

1. Enter main menu. 2. Select **FEATURES**. 3. Enter the **FEATURES** menu.

4. Press the  (**CURSOR DOWN**) button repeatedly until **BLUE MUTE** is selected.
5. Press the  (**CURSOR RIGHT**) button to select **ON** to activate blue mute feature.
6. Press the  (**OSD**) button to exit menu from screen.

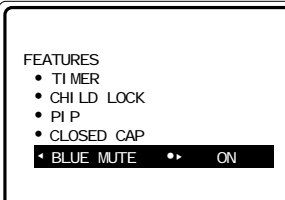

FEATURES





- TI MER
- CHI LD LOCK
- PI P
- CLOSED CAP
- BLUE MUTE

TI ME
START TI ME
STOP TI ME
CHANNEL
ACTI VATE

◀ BLUE MUTE ▶▶ ON

USING THE PROGRAM LIST FEATURE

The Program List feature allows you to navigate through a list of installed programmes for a quick overview of the channels and activate the channel you have selected.

1. Press the  (**PROGRAM LIST**) button to display the list of installed programmes. The current channel is highlighted.
2. Press the  (**CURSOR UP**) or  (**CURSOR DOWN**) button to cycle through the programme list and highlight the channel number you want to activate.
3. Press the  (**CURSOR RIGHT**) button to activate the channel you have selected.
4. Press the  (**OSD**) button to exit menu from screen.

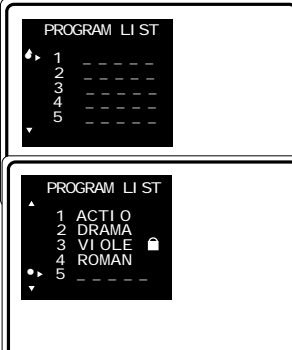

PROGRAM LI ST

1 - - - - -

2 - - - - -

3 - - - - -

4 - - - - -

5 - - - - -

PROGRAM LI ST

1 ACTIO

2 DRAMA

3 VIOLE



4 ROMAN

5 - - - - -

SMART PICTURE AND SMART SOUND CONTROL

SMART PICTURE feature offers you a choice of 5 picture settings, namely, **PERSONAL**, **RICH**, **NATURAL**, **SOFT** and **MULTIMEDIA**.

SMART SOUND feature offers you a choice of 4 sound settings, namely, **PERSONAL**, **VOICE**, **MUSIC** and **THEATRE**.

Press  (**SMART PICTURE**) or  (**SMART SOUND**) button repeatedly to cycle through the settings to select your desired mode.

Definition of Picture Settings

- PERSONAL** : Picture settings are set to your preference.
RICH : Emphasize very vibrant colours (suitable for AV mode in brightly lit room).
NATURAL : Emphasize original colours.
SOFT : Emphasize “warm” colours (suitable for dimly lit room condition and gives cinema-like effect when light is switched off).
MULTIMEDIA: Emphasize “soft” colours (suitable for playing computer games, surfing, etc.).

Note: The **PERSONAL** setting is the setting that you set up using the Picture menu in the main menu. This is the only setting in the Smart Picture settings that can be changed. All the other settings are pre-set at the factory.

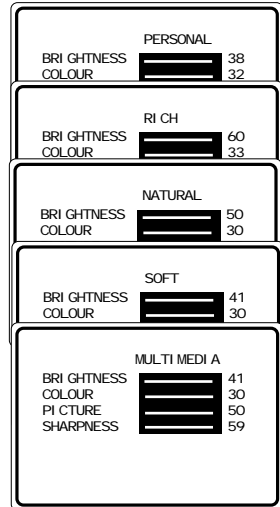

Definition of Sound Settings

- PERSONAL** : Sound settings are set to your preference.
VOICE : Emphasize high tone (treble boosted).
MUSIC : Emphasize low tone (bass boosted).
THEATRE : Emphasize sensation to action (bass and treble boosted).

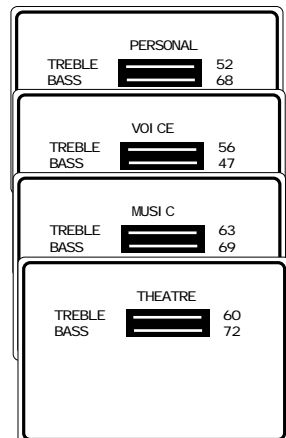



ACTIVATING THE PIP (PICTURE-IN-PICTURE) AND DOUBLE WINDOW CONTROL

Picture-in-Picture feature allows you to call up a sub-screen within your main screen, enabling you to watch two channels at the same time.

Double Window feature allows you to divide the main screen into two sub-screens, enabling two channels to be watched simultaneously.

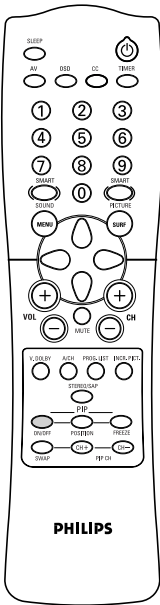
How to switch on the PIP/Double Window screen



- Press the  (PIP On/Off) button to switch on PIP mode. (A normal size PIP screen appears.)



- Press the  button the second time to change the normal size PIP screen to a smaller size.



- Press the  button the third time to switch to Double Window screens in 4:3 format.



How to hear PIP sound

- Press the  (PIP On/Off) button to switch on PIP mode.
- Connect the headphone cable to the headphone socket to hear PIP sound. (The **HEADPHONE** control within the **SOUND** menu allows you to adjust the headphone volume. Refer to the section on "Using the Picture/Sound Menu" for instructions.)



AV sockets on side of TV

ACTIVATING THE PIP (PICTURE-IN-PICTURE) CONTROL

How to select a PIP channel

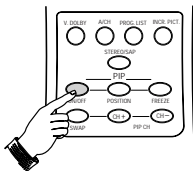

- Press the **ON/OFF** (PIP On/Off) button to switch on PIP screen.

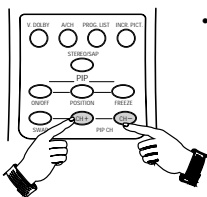
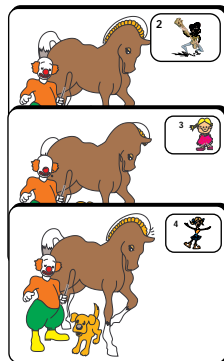

- Press the **CH+** (PIP CH +) or **CH-** (PIP CH -) button to select a PIP channel in ascending or descending order.

How to freeze the PIP screen

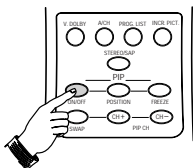

- Press the **ON/OFF** (PIP On/Off) button to switch on PIP screen.

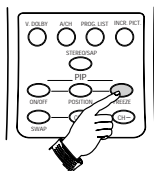
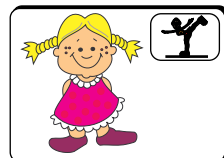

- Press **FREEZE** (PIP Freeze) button once to freeze the PIP screen. Freezing the PIP screen allows you to view a programme in the still mode. For example, you may want to write down some information from the PIP screen, freezing the screen will allow you time to do so.

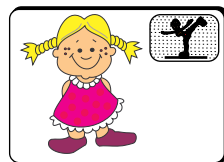

PIP Freeze

- Press the **FREEZE** (PIP Freeze) button the second time to unfreeze the PIP screen.

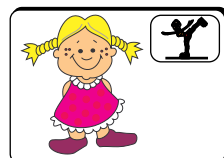

PIP Unfreeze

ACTIVATING THE PIP (PICTURE-IN-PICTURE) CONTROL

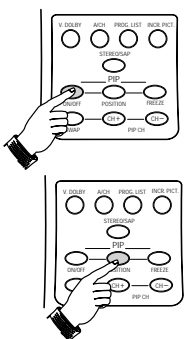

How to position the PIP screen

- Press the **ON/OFF** (PIP On/Off) button to switch on PIP screen.
- Press the **POSITION** (PIP Position) button repeatedly to your desired position. (You can choose the PIP screen to be on the top left corner, top right corner, bottom right corner or the bottom left corner.)

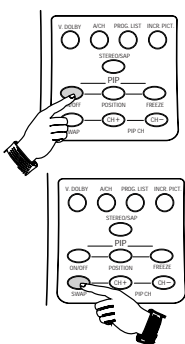
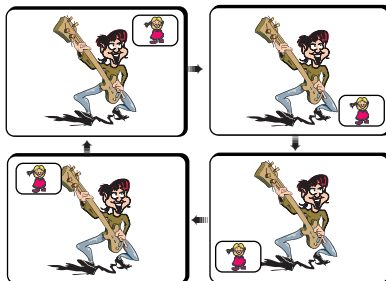

How to swap the PIP screen and the main screen

- Press the **ON/OFF** (PIP On/Off) button to switch on PIP screen.
- Press the **SWAP** (PIP Swap) button to swap the programme in the PIP screen and the programme in the main screen.

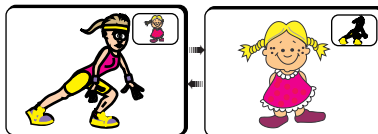

How to adjust the PIP Hue setting

1. Press the **MENU** (MENU) button to enter main menu.
2. Press the **CURSOR DOWN** button repeatedly until **FEATURES** is selected.
3. Press the **CURSOR RIGHT** button to enter the **FEATURES** menu.
4. Press the **CURSOR DOWN** button repeatedly until **PIP** is selected.
5. Press the **CURSOR RIGHT** button to enter **PIP** menu.
6. Press the **CURSOR LEFT** or **CURSOR RIGHT** button to adjust **HUE** setting to your desired level.
7. Press the **OSD** button to exit menu from screen.

Note : Hue adjustments in the PIP programmes will only take effect if programmes are in NTSC mode.

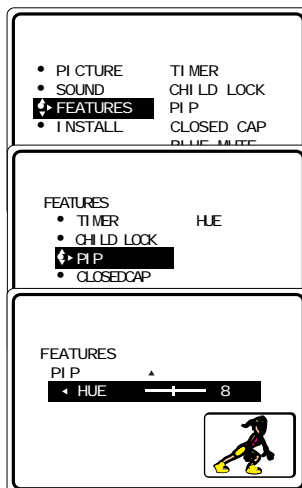

SPECIFICATIONS

	43PP925	50PP925	55PP925
Picture visible area	109 cm	127 cm	140 cm
Audio Output	2 x 15 W		
TV System	NTSC M		
Set Dimensions			
Width	950 cm	1130 cm	1222 cm
Depth	540 cm	613 cm	612 cm
Height	1142 cm	1476 cm	1549 cm
Net weight of set	approx. 58 kg	approx. 83 kg	approx. 90 kg

Note

For Operating Voltage, Frequency, Power Consumption and Version Number, refer to the type number at the rear of the set.

Free Manuals Download Website

<http://myh66.com>

<http://usermanuals.us>

<http://www.somanuals.com>

<http://www.4manuals.cc>

<http://www.manual-lib.com>

<http://www.404manual.com>

<http://www.luxmanual.com>

<http://aubethermostatmanual.com>

Golf course search by state

<http://golfingnear.com>

Email search by domain

<http://emailbydomain.com>

Auto manuals search

<http://auto.somanuals.com>

TV manuals search

<http://tv.somanuals.com>